

## Limit switch attachments DAPZ

**FESTO**



## Type codes

<b>001</b>	<b>Series</b>	
<b>DAPZ</b>	Limit switch attachment	
<b>002</b>	<b>Design type</b>	
<b>SB</b>	Sensor box	
<b>003</b>	<b>Sensor principle</b>	
<b>I</b>	Proximity switch, inductive	
<b>M</b>	Micro switch, antivalent	

<b>004</b>	<b>Nominal operating voltage</b>	
<b>30DC</b>	30 V DC	
<b>250AC</b>	250 V AC	
<b>005</b>	<b>Display type</b>	
<b>D</b>	Switching position indication	
<b>006</b>	<b>Housing shape</b>	
<b>R</b>	Round	
<b>007</b>	<b>Additional features</b>	
<b>AR</b>	Foot height adjustable	

## Data sheet

- Actuator interface to Namur VDI/VDE 3845
- Quick and easy assembly and connection
- Integrated solenoid valve control



General technical data			DAPZ-SB-M-250AC-DR-AR	DAPZ-SB-I-30DC-DR-AR
Measuring principle			Mechanical, electrical	Inductive
Based on standard			EN 60947-5-1 VDI/VDE 3845 (NAMUR)	EN 60947-5-2
Design			Round	
Mounting position			Any	
Short circuit current rating			No	Pulsed
Switching element function			Changeover switch	N/O contact
Reverse polarity protection			No	For all electrical connections
Switching position indication			Yes	
Switching output			–	PNP
Operating voltage range	Direct current DC	[V]	4 ... 250	10 ... 30
	Alternating current AC	[V]	4 ... 250	–
Intrinsic current consumption at operating voltage		[mA]	1 ... 5	0 ... 100
Insulation voltage		[V]	250	50
Surge resistance		[kV]	2.5	0.5
Max. output current		[mA]	5 000	100
Minimum load current			1 mA at 4 V / DC	–
Electrical connection			Screw terminal	
Permissible cable diameter		[mm]	7 ... 13	
Cable connector			M20x1.5	

Operating and environmental conditions			DAPZ-SB-M-250AC-DR-AR	DAPZ-SB-I-30DC-DR-AR
Ambient temperature		[°C]	–20 ... +70 °C	
Degree of protection			IP67	
CE marking (see declaration of conformity)			To EU Low Voltage Directive	–
Pollution degree			3	
Corrosion resistance CRC <sup>1)</sup>			2	

1) Corrosion resistance class CRC 2 to Festo standard FN 940070

Moderate corrosion stress. Indoor applications in which condensation can occur. External visible parts with primarily decorative surface requirements which are in direct contact with a normal industrial environment.

Materials	
Housing cover	PC
Housing socket, console	ABS, PC
Seals	NBR
Note on materials	RoHS-compliant

Data sheet

Dimensions

Download CAD data → [www.festo.com](http://www.festo.com)

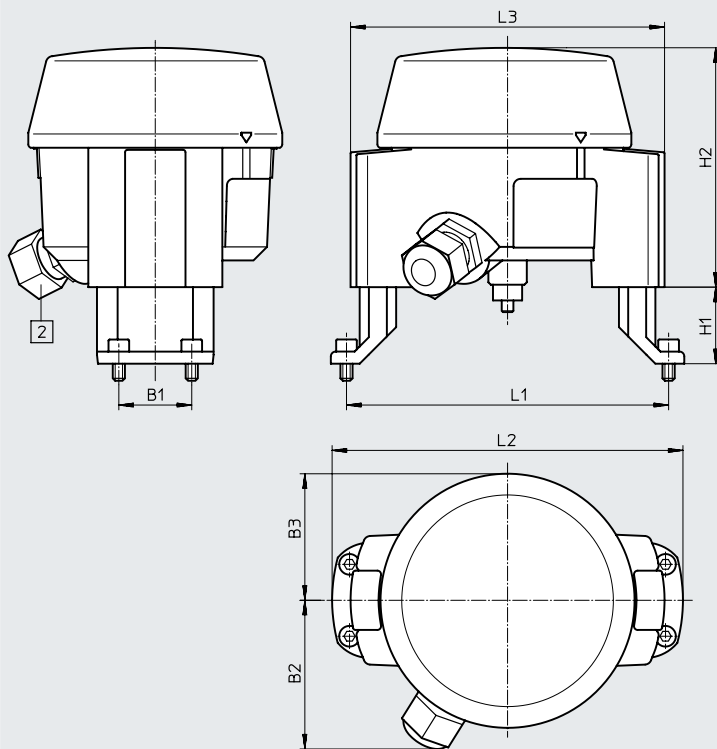





[2] Cable connector M20x1.5

	B1	B2	B3	H1	H2	L1	L2	L3
<b>Feet mounted inwards</b>								
Foot height adjustable	30	62	52.5	20, 30, 50	100	80	66	130
<b>Feet mounted outwards</b>								
Foot height adjustable	30	62	52.5	20, 30, 50	100	130	144	130

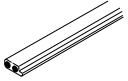
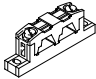
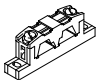
<b>Ordering data</b>				
Sensing type	Variant	Measuring principle	Part no.	Type
Mechanical	Basic type	Mechanical, electrical	534474	DAPZ-SB-M-250AC-DR-AR
Non-contacting	Basic type	Inductive	534475	DAPZ-SB-I-30DC-DR-AR

## Accessories

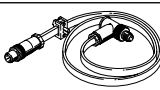
Ordering data	Brief description	Part no.	Type
<b>Bus connection</b>			
	Flat cable for AS-Interface components, yellow, 100 m	<b>18940</b>	<b>KASI-1.5-Y-100</b>
	Cable distributor for flat cables, rotatable cables	<b>18786</b>	<b>ASI-KVT-FK</b>
	Cable distributor for flat cables, symmetrical cables	<b>18797</b>	<b>ASI-KVT-FK-S</b>
	Cable cap for flat cable (50 included in the scope of delivery)	<b>18787</b>	<b>ASI-KK-FK</b>
	Cable sleeve (20 included in the scope of delivery)	<b>165593</b>	<b>ASI-KT-FK</b>
<b>Other</b>			
	Addressing device for AS-Interface stations	<b>18959</b>	<b>ASI-PRG-ADR</b>
	Addressing cable for addressing device	<b>18960</b>	<b>KASI-ADR</b>