

Product range overview

Function	Electrical connection	Type	Cable connector	Design	→ Page/Internet
Round plug	Plug				
	M8 3-pin	SEA-3GS-M8-S	PG7	<ul style="list-style-type: none"> • Straight • Screw terminal 	2
		SEA-GS-M8	PG7	<ul style="list-style-type: none"> • Straight • Solder lug 	2
	M12, 4-pin	SEA-GS-7	PG7	<ul style="list-style-type: none"> • Straight • Screw terminal 	4
		SEA-GS-9	PG9	<ul style="list-style-type: none"> • Straight • Screw terminal 	4
		SEA-GS-11-DUO	PG11	<ul style="list-style-type: none"> • Straight • Screw terminal 	4
		SEA-GS-HAR	PG9	<ul style="list-style-type: none"> • Straight • Insulation displacement connector 	4
		SEA-4GS-7-2.5	PG7	<ul style="list-style-type: none"> • Straight • Screw terminal 	4
	M12, 5-pin	SAE-M12-5GS	PG7	<ul style="list-style-type: none"> • Straight • Screw terminal 	6
		SEA-5GS-11-DUO	PG11	<ul style="list-style-type: none"> • Straight • Screw terminal 	6

Data sheet

Plug
SEA-GS-M8

- Sensor plug for inputs/outputs
- Can be assembled with any cable lengths
- 3-pin
- With screw terminals or soldered connection
- Wire cross section up to 0.5 mm²



General technical data			
Type	SEA-GS-M8		SEA-3GS-M8-S
Electrical connection	Straight plug, 3-pin, M8x1		
	Solder lug		Screw terminal
Type of mounting	Via threaded sleeve		
Mounting position	Any		
Max. tightening torque of interlock [Nm]	0.3		
Permissible cable ø [mm]	3.5 ... 5		2.5 ... 5
Connection cross section [mm ²]	0.25		0.14 ... 0.5
Current rating at 40°C [A]	3		
Surge resistance [kV]	1.5		
Operating voltage range	[V AC]		60
	[V DC]		60
Degree of protection to EN 60529	IP67 (assembled)		IP65 (assembled)
Based on standard	EN 61076-2-101, EN 61984		

Materials			
Type	SEA-GS-M8		SEA-3GS-M8-S
Housing colour	Black		
Information on materials: Housing	PA		
Information on materials: Contacts	Gold-plated brass		
Information on materials: Union nut	Nickel-plated brass		Nickel-plated/chrome-plated brass
Note on materials	RoHS-compliant		
Max. tightening torque of interlock [Nm]	0.3		

Operating and environmental conditions		
Ambient temperature [°C]	-40 ... +85	
Corrosion resistance class CRC ¹⁾	2	
CE marking (see declaration of conformity)	To EU Low Voltage Directive	
Pollution degree	3	

1) Corrosion resistance class CRC 2 to Festo standard FN 940070

Moderate corrosion stress. Indoor applications in which condensation can occur. External visible parts with primarily decorative surface requirements which are in direct contact with a normal industrial environment.

Data sheet

Dimensions

Download CAD data → www.festo.com

SEA-3GS-M8-S

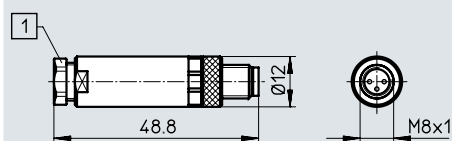

- [1] Cable connector:
- Black for cable 3.5 ... 5 mm
 - Blue for cable 2.5 ... 4 mm

SEA-GS-M8

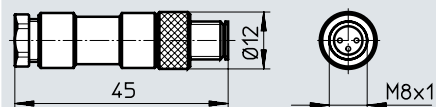

Ordering data

Electrical connection	Cable connector	Product weight [g]	Part no.	Type
Straight plug, 3-pin Screw terminal	Pg7	11	192009	SEA-3GS-M8-S
Straight plug, 3-pin Solder lug	Pg7	9	18696	SEA-GS-M8

Data sheet

Plug

SEA-GS

SEA-GS-HAR

SEA-4GS

- Sensor plug for inputs/outputs
- Can be assembled with any cable lengths
- 4-pin
- Wire cross section up to 0.75 mm²



General technical data

Type	SEA-GS-7	SEA-4GS-7-2.5	SEA-GS-9	SEA-GS-11-DUO	SEA-GS-HAR-4POL
Based on standard	EN 61076-2-101	EN 61076-2-101	EN 61076-2-101	EN 61076-2-101	EN 61076-2-101
	–	EN 61984	EN 61984	EN 61984	EN 61984
Type of mounting	Via threaded sleeve	Via threaded sleeve	Via threaded sleeve	Via threaded sleeve	Via thread
Mounting position	–	Any	Any	Any	Any
Product weight [g]	17	18	18	24	11.5

Electrical connection 1

Connection type	Plug	Plug	Plug	Plug	Plug
Cable outlet	Straight	Straight	Straight	Straight	Straight
Design type	Round	–	–	–	–
Connection technology	M12x1, A-coded, to EN 61076-2-101	M12x1, type A	M12x1, type A	M12x1, type A	M12x1
Number of pins/wires	4	4	4	4	4
Type of mounting	Screw-type lock with longitudinal knurl	–	–	–	–

Electrical connection 2

Connection technology	Screw terminal	Screw terminal	Screw terminal	Screw terminal	Insulation displacement connector
Number of pins/wires	4	–	–	–	–
Permissible insulating sheath	–	–	–	–	PVC
Cable connector	Pg7	Pg7	Pg9	Pg11	Pg9
Cable diameter [mm]	3.3 ... 6	–	–	–	–
Permissible cable diameter [mm]	4 ... 6	2.5 ... 2.9	6 ... 8	2 x 3 or 2 x 5	4 ... 5.1
Nominal conductor cross section [mm ²]	0.14 ... 0.75	–	–	–	–
Connection cross section [mm ²]	–	0.14 ... 0.5	0.75	0.75	0.25 ... 0.5
Wire diameter [mm]	–	–	–	–	1.2 ... 1.6
Individual wire diameter [mm]	–	–	–	–	0.1

Technical data – Electrics

Type	SEA-GS-7	SEA-4GS-7-2.5	SEA-GS-9	SEA-GS-11-DUO	SEA-GS-HAR-4POL
Operating voltage range [V DC]	0 ... 250	≤ 250	≤ 250	≤ 250	≤ 32
[V AC]	0 ... 250	≤ 250	≤ 250	≤ 250	≤ 32
Surge resistance [kV]	2.5	2.5	2.5	2.5	0.8
Current rating at 40°C [A]	4	4	4	4	4

Materials

Type	SEA-GS-7	SEA-4GS-7-2.5	SEA-GS-9	SEA-GS-11-DUO	SEA-GS-HAR-4POL
Housing	PBT	PA	PBT	PBT	Die-cast zinc Nickel-plated
Housing colour	Black	Black	Black	Black	–
Screw-type lock	PBT	–	–	–	–
Union nut	–	PA	PBT	PBT	–
Seals	CR	–	–	–	–
	FPM	–	–	–	–
Pin contacts	Brass	Brass	Brass	Brass	–
	Coated white bronze	Coated white bronze	Coated white bronze	Coated white bronze	–
Note on materials	RoHS-compliant	RoHS-compliant	RoHS-compliant	RoHS-compliant	RoHS-compliant

Data sheet

Operating and environmental conditions					
Type	SEA-GS-7	SEA-4GS-7-2.5	SEA-GS-9	SEA-GS-11-DUO	SEA-GS-HAR-4POL
Ambient temperature [°C]	−40 ... 85	−40 ... 85	−40 ... 85	−40 ... 85	−25 ... 85
Corrosion resistance class CRC ¹⁾	2	2	2	2	2
CE marking (see declaration of conformity)	To EU Low Voltage Directive	To EU Low Voltage Directive	To EU Low Voltage Directive	To EU Low Voltage Directive	–
Pollution degree	3	3	3	3	3
Degree of protection	IP67	IP65	IP67	IP67	IP67
Note on degree of protection	In assembled state	–	–	–	–

1) Corrosion resistance class CRC 2 to Festo standard FN 940070

Moderate corrosion stress. Indoor applications in which condensation can occur. External visible parts with primarily decorative surface requirements which are in direct contact with a normal industrial environment.

Dimensions

Download CAD data → www.festo.com

SEA-GS-7

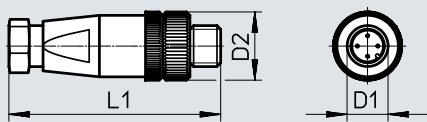

Type	D1	D2 Ø	L1
SEA-GS-7	M12x1	20	60

SEA-4GS-7-2.5

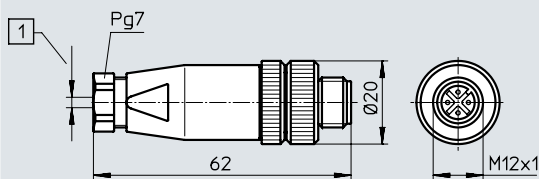

[1] 2.5 ... 2.9 mm

SEA-GS-9

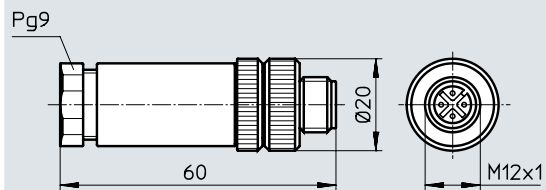

SEA-GS-11-DUO

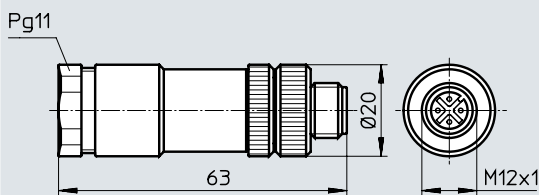

SEA-GS-HAR

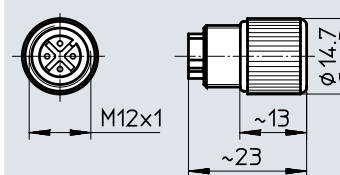

Ordering data

Electrical connection 1	Electrical connection 2	Cable connector	Permissible cable Ø [mm]	Product weight [g]	Part no.	Type
Plug Straight M12x1 4-pin,	Screw terminal	Pg7	4 ... 6	17	18666	SEA-GS-7
			2.5 ... 2.9	18	192008	SEA-4GS-7-2.5
		Pg9	6 ... 8	18	18778	SEA-GS-9
		Pg11	2 x 3 or 2 x 5	24	18779	SEA-GS-11-DUO
	Insulation displacement connector	Pg9	4 ... 5.1	11.5	525928	SEA-GS-HAR-4POL

Data sheet

Plug

SEA-M12-5GS

SEA-5GS

- Sensor plug for inputs/outputs
- Can be assembled with any cable lengths
- 5-pin
- Wire cross section up to 0.75 mm²



General technical data		
Type	SEA-M12-5GS-PG7	SEA-5GS-11-DUO
Electrical connection	Straight plug (type A), 5-pin M12, screw terminal	
Type of mounting	Via threaded sleeve	
Max. tightening torque of interlock [Nm]	0.5	
Mounting position	Any	
Permissible cable ø [mm]	4 ... 6	2 x 2.5 ... 2.9 or 2 x 5
Connection cross section [mm ²]	0.75	0.14 ... 0.5
Current rating at 40°C [A]	4	
Surge resistance [kV]	1.5	
Operating voltage range	[V AC]	60
	[V DC]	60
Degree of protection to EN 60529	IP67 (assembled)	IP65 (assembled)
Based on standard	EN 61076-2-101, EN 61984	

Materials		
Type	SEA-M12-5GS-PG7	SEA-5GS-11-DUO
Housing colour	Black	
Housing	PBT	PA
Contacts	Brass, coated with white bronze	
Union nut	Nickel-plated die-cast zinc	PA
Note on materials	RoHS-compliant	

Operating and environmental conditions		
Ambient temperature [°C]	-40 ... +85	
Corrosion resistance class CRC ¹⁾	2	
CE marking (see declaration of conformity)	To EU Low Voltage Directive	
Pollution degree	3	

1) Corrosion resistance class CRC 2 to Festo standard FN 940070

Moderate corrosion stress. Indoor applications in which condensation can occur. External visible parts with primarily decorative surface requirements which are in direct contact with a normal industrial environment.

Data sheet

Dimensions

Download CAD data → www.festo.com

SEA-M12-5GS-PG7

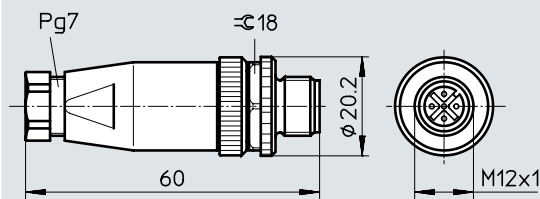

SEA-5GS-11-DUO

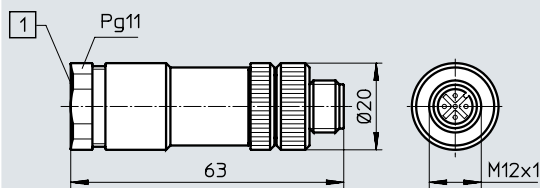

[1] Included in the scope of delivery:

- 1 seal insert for 2 cables with a diameter of 2.5 ... 2.9 mm
- 1 seal insert for 2 cables with a diameter of 5 mm
- 1 cable binder

Ordering data

Electrical connection	Cable connector	Product weight [g]	Part no.	Type
Straight plug (type A), 5-pin	Pg7	21.5	175487	SEA-M12-5GS-PG7
Screw terminal	Pg11	24	192010	SEA-5GS-11-DUO

Festo - Your Partner in Automation



1 Festo Inc.
5300 Explorer Drive
Mississauga, ON L4W 5G4
Canada

Festo Customer Interaction Center
Tel: 1 877 463 3786
Fax: 1 877 393 3786
Email: customer.service.ca@festo.com



2 Festo Pneumatic
Av. Ceylán 3,
Col. Tequesquináhuac
54020 Tlalnepantla,
Estado de México

Multinational Contact Center
01 800 337 8669
ventas.mexico@festo.com



3 Festo Corporation
1377 Motor Parkway
Suite 310
Islandia, NY 11749

Festo Customer Interaction Center
1 800 993 3786
1 800 963 3786
customer.service.us@festo.com



4 Regional Service Center
7777 Columbia Road
Mason, OH 45040

Connect with us

www.festo.com/socialmedia



www.festo.com

Subject to change