



## **Electrical Connection Technology, for AS-interface**



# Electrical connection technology, for AS-interface

Product range overview

**FESTO**

AS-interface – Product range overview							
Designation	Type	Master	AS1	CPV-ASI	CPA-ASI	ASI-EVA	→ Page
<b>Bus connection</b>							
Flat cable for AS-interface components, yellow, 100 m	KASI-1,5-Y-100	■	■	■	■	■	4 / 5.1-198
Flat cable for AS-interface components, black, 100 m	KASI-1,5-Z-100	–	■	■	■	■	4 / 5.1-198
Cable cap for flat cable (scope of delivery 50 pieces) <sup>2)</sup>	ASI-KK-FK	–	■	■	■	■	4 / 5.1-198
Cable sleeve (scope of delivery 20 pieces) <sup>2)</sup>	ASI-KT-FK	–	■	■	■	■	4 / 5.1-198
Cable socket for flat cable <sup>1)</sup>	ASI-SD-FK	■	–	■	■	■	4 / 5.1-189
Cable socket for flat cable, profile turned 180° <sup>1)</sup>	ASI-SD-FK180	–	–	■	■	■	4 / 5.1-189
Flat cable blanking plug <sup>1)</sup>	AS-SD-FK-BL	–	–	■	■	■	4 / 5.1-189
Addressing cable for addressing device	KASI-ADR	–	–	–	–	–	4 / 5.1-195
AS-interface cable distributor for flat cables, cables parallel	ASI-KVT-FK	■	–	■	■	■	4 / 5.1-191
Cable distributor for flat cables, cables symmetrical	ASI-KVT-FK-S	■	–	■	■	■	4 / 5.1-191
Cable distributors for flat cables, on 2x M12 plug sockets, 4-pin	ASI-KVT-FKx2-M12	–	–	■	■	–	4 / 5.1-193
Cable socket M12x1 for flat cable	ASI-SD-FK-M12	■	■	■	■	–	4 / 5.1-187
Cable socket M12x1 for flat cable, with PG13.5	ASI-SD-PG-M12	–	■	■	■	–	4 / 5.1-187
<b>Sensor plugs</b>							
Sensor plug M12 for inputs and outputs, straight, Pg7, 5-pin	SEA-M12-5GS-PG7	–	–	–	■	■	4 / 5.1-166
Sensor plug for inputs and outputs, straight, M12, 4-pin, Pg7	SEA-GS-7	–	–	–	■	■	4 / 5.1-162
Sensor plug for inputs and outputs, straight, M12, 4-pin, Pg9	SEA-GS-9	–	–	–	■	■	4 / 5.1-162
Sensor plug for inputs and outputs, angled, M12, 4-pin, Pg7	SEA-M12-4WD-PG7	–	–	–	–	■	2 / 7.2-25
Sensor plug for inputs and outputs, straight, M12, 4-pin, for cable dia. 2.5 mm	SEA-4GS-7-2,5	–	–	–	■	■	4 / 5.1-164
Sensor plug for inputs and outputs, straight, M8, screw-in	SEA-3GS-M8-S	–	–	■	■	–	4 / 5.1-160
Sensor plug for inputs and outputs, straight, M8, solderable	SEA-GS-M8	–	–	■	■	–	4 / 5.1-160
Sensor plug for inputs and outputs, Harax, 4-pin	SEA-GS-HAR-4POL	–	–	–	■	–	4 / 5.1-168
Plug, Sub-D, 25-pin	SD-SUB-D-ST25	–	–	–	■	–	4 / 5.1-158
Protective cap M12	ISK-M12	–	–	–	■	■	www.festo.com
Protective cap M8	ISK-M8	–	–	–	■	–	www.festo.com
<b>DUO plug</b>							
DUO plug for inputs and outputs, straight, 4-pin, for 2 cables	SEA-GS-11-DUO	–	–	–	■	■	4 / 5.1-162
DUO plug for inputs and outputs, straight, 5-pin, for 2 cables	SEA-5GS-11-DUO	–	–	–	■	■	4 / 5.1-162
<b>DUO cable M12 with 2x M8</b>							
DUO cable, straight sockets	KM12-DUO-M8-GDGD	–	–	–	■	■	4 / 5.1-154
DUO cable, straight socket/angled socket	KM12-DUO-M8-GDWD	–	–	–	■	■	4 / 5.1-154
DUO cable, angled sockets	KM12-DUO-M8-WDWD	–	–	–	■	■	4 / 5.1-154

1) Two flat cable connections per ASI-EVA must be connected or covered.

2) Achieves IP65 on open cable end in the field.

# Electrical connection technology, for AS-interface

Product range overview

**FESTO**

AS-interface – Product range overview							
Designation	Type	Master	AS1	CPV-ASI	CPA-ASI	ASI-EVA	➔ Page
Extension cables							
Extension cable, straight plug, straight socket, 4-pin, 2.5 m	KM12-M12-GSGD-2.5	–	■	–	■	■	4 / 5.1-23
Extension cable, straight plug, straight socket, 4-pin, 5 m	KM12-M12-GSGD-5	–	■	–	■	■	4 / 5.1-23
Extension cable, straight plug, angled socket, 4-pin	KM12-M12-GSWD-1-4	–	■	–	■	■	4 / 5.1-23
Connecting cables							
AS-interface connection for DNCV M12, 8-pin	ASI-EVA-3E2A-M12-8POL-Z	■	■	–	–	■	Info 220 AS-interface
Connecting cable M12, 8-pin	KM12-8GD8GS-2-PU	–	–	–	–	■	LEERER MERKER
Connecting cable, straight plug, M8, straight socket, 4-pin M12	KM8-M12-GSGD-...	–	–	■	■	■	4 / 5.1-150
Connecting cable, straight plug, M8, straight socket, 3-pin M8	KM8-M8-GSGD-...	–	–	■	■	■	4 / 5.1-150
Other accessories							
Combi power pack	ASI-CNT-115/230VAC-B	■	■	■	■	■	Info 220 AS-interface
Addressing device for AS-interface stations	ASI-PRG-ADR	–	■	■	■	■	Info 220 AS-interface
Addressing cable for addressing device	KASI-ADR	–	■	■	■	■	4 / 5.1-195
Configuration plug for AS-interface master type 03	ASI-SS-CONFIG	■	–	–	–	–	4 / 5.1-197
Serial data cable for AS-interface software tool	KDI-SB202-BU9	■	–	–	–	–	4 / 5.1-112
Inscription labels 6x10 mm in frames (64 pieces)	IBS-6x10	–	–	■	■	■	www.festo.com
Inscription labels 10x17 mm in frames (30 pieces)	IBS-10x17	–	–	–	–	–	www.festo.com
Inscription labels 9x20 mm in frames (20 pieces)	IBS-9x20	–	–	■	■	–	www.festo.com
H-rail mounting (mounting set)	CP-TS-HS35	–	–	–	–	■	www.festo.com
Attachment for H-rail mounting	CPA-BG-NRH	–	–	–	■	–	www.festo.com
H-rail to EN 60715	NRH-35-2000	■	■	■	■	■	www.festo.com
T-adapter, plug and socket							
T-adapter	FB-TA-M12-5POL	■	–	–	■	–	4 / 5.1-100
Plug for T-adapter	FBS-M12-5GS-PG9	■	–	–	■	–	4 / 5.1-90
Socket, straight, with screw terminal	FBSD-GD-9-5POL	■	–	–	■	–	4 / 5.1-90

# Electrical connection technology, for AS-interface

Peripherals overview

**FESTO**

## AS-interface components for bus interface and power supply

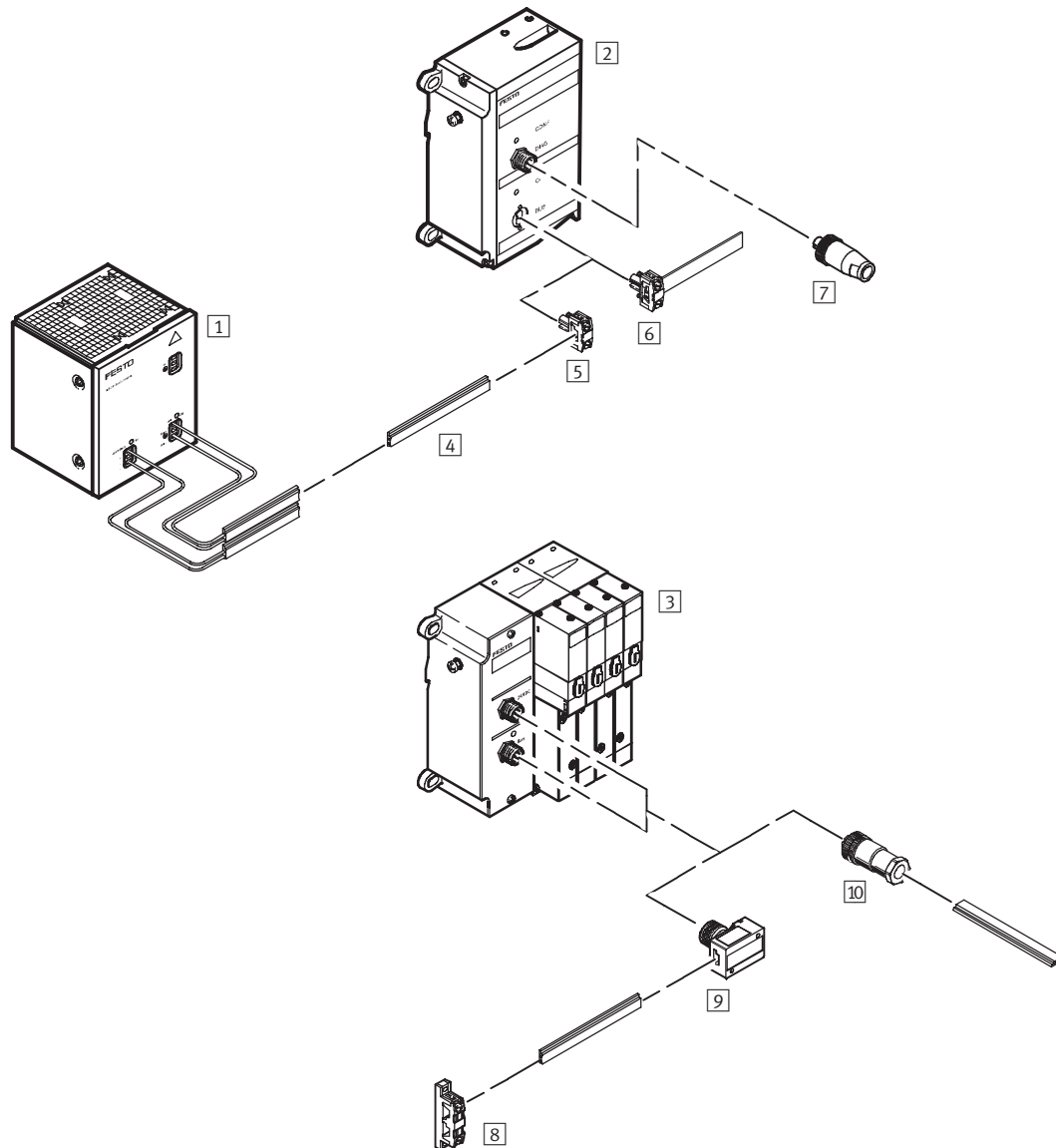

Accessories		
	Brief description	→ Page
1	ASI-CNT-115/230VAC-B	Combi power pack Info 220 AS-interface
2	VIASI-03-M	AS-i master interface Info 220 AS-interface
3	AS1	AS-interface for 4 coils Info 220 AS-interface
4	KASI-1,5-Y-100	Flat cable for AS-interface components 4 / 5.1-198
5	ASI-SD-FK	Cable socket for flat cable 4 / 5.1-189
6	ASI-SD-FK-180	Cable socket for flat cable, profile turned 180° 4 / 5.1-189
7	ASI-SS-CONFIG	Configuration plug for AS-interface master type 03 4 / 5.1-197
8	ASI-KVT-FK-S	Cable distributor for flat cables, symmetrical 4 / 5.1-191
9	ASI-SD-FK-M12	Cable socket M12x1 4 / 5.1-187
10	ASI-SD-PG-M12	Cable socket M12x1, Pg13.5 4 / 5.1-187

# Electrical connection technology, for AS-interface

Peripherals overview

FESTO

## Valve terminal type 10 CPV with AS-interface connection without inputs

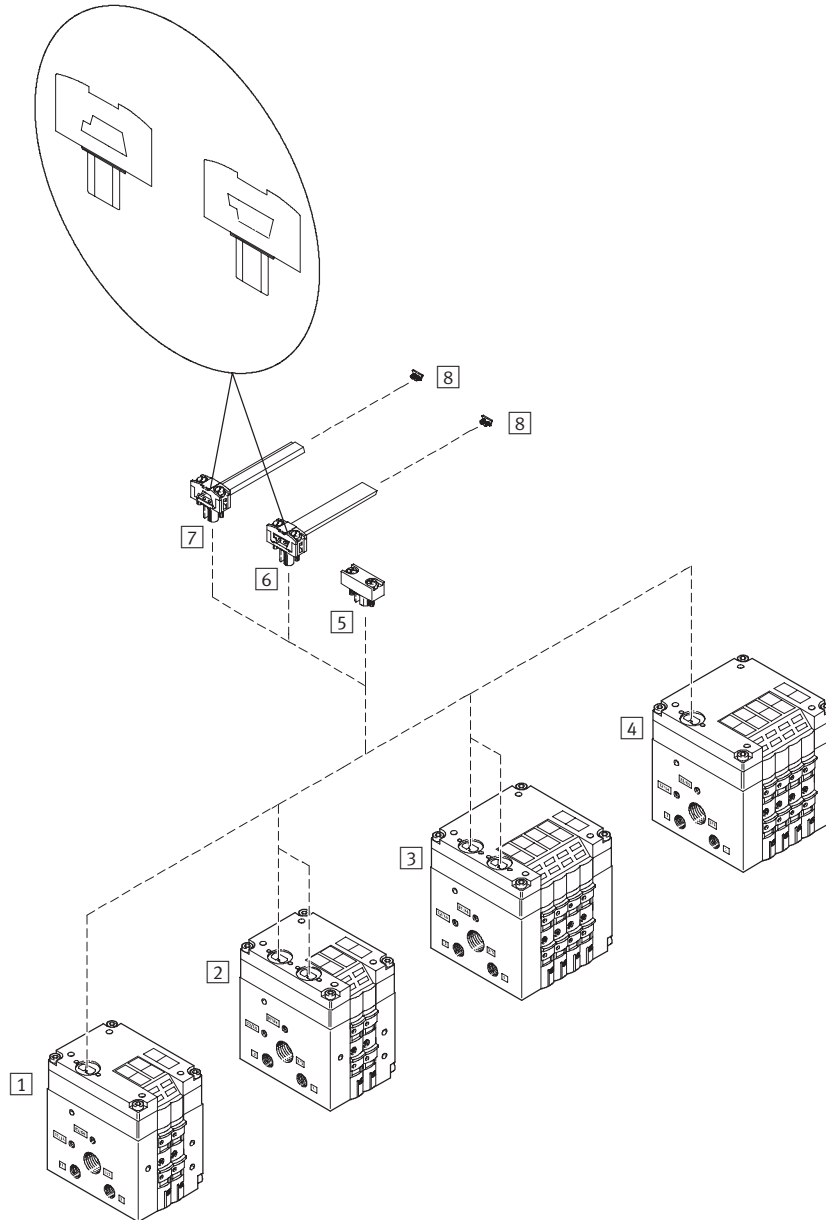

Accessories		
	Brief description	→ Page
1	CPV...	Valve terminal type 10, Compact Performance with AS-interface connection
2	CPV...	Valve terminal type 10, Compact Performance with AS-interface connection, auxiliary power supply
3	CPV...	Valve terminal type 10, Compact Performance with AS-interface connection, auxiliary power supply
4	CPV...	Valve terminal type 10, Compact Performance with AS-interface connection
5	AS-SD-FK-BL	Flat cable blanking plug
6	ASI-SD-FK-180	Cable socket for flat cable, profile turned 180°
7	ASI-SD-FK	Cable socket for flat cable
8	ASI-KK-FK	Cable cap for flat cable

# Electrical connection technology, for AS-interface

Peripherals overview

**FESTO**

## Valve terminal type 10 CPV with AS-interface connection with inputs

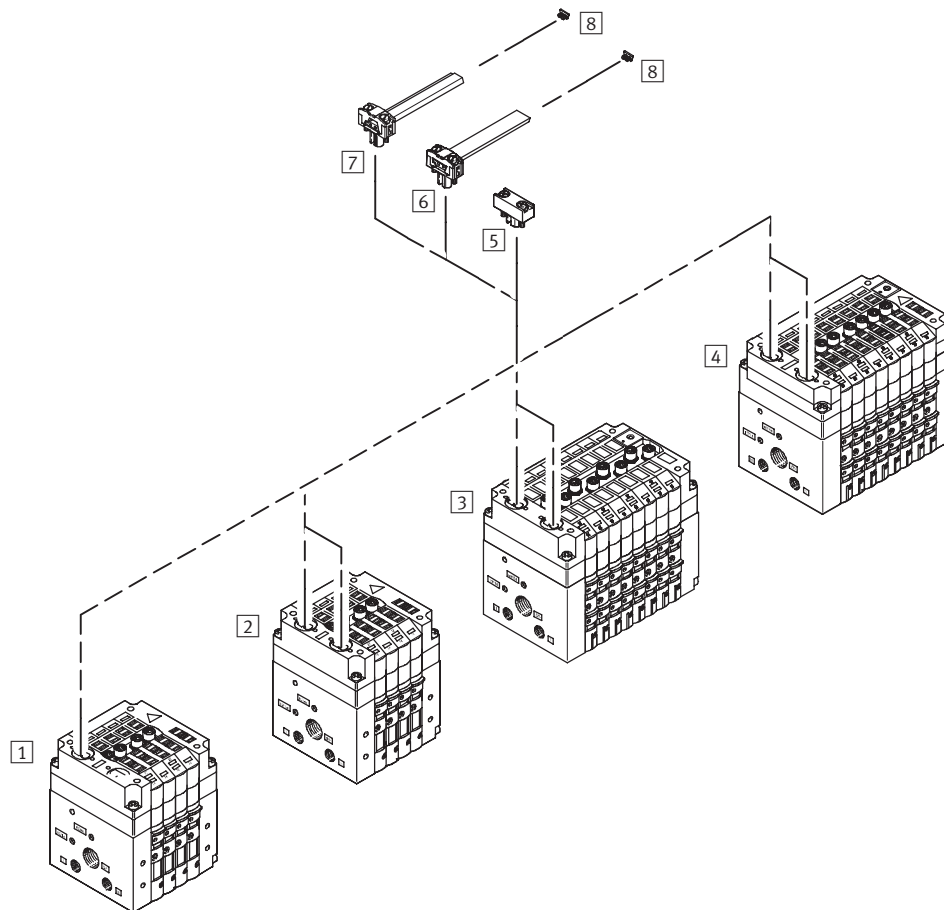

Accessories		
	Brief description	→ Page
1	CPV...	Valve terminal type 10, Compact Performance with AS-interface connection and inputs
2	CPV...	Valve terminal type 10, Compact Performance with AS-interface connection, auxiliary power supply and inputs
3	CPV...	Valve terminal type 10, Compact Performance with AS-interface connection, auxiliary power supply and inputs
4	CPV...	Valve terminal type 10, Compact Performance with AS-interface connection and inputs
5	AS-SD-FK-BL	Flat cable blanking plug
6	ASI-SD-FK-180	Cable socket for flat cable, profile turned 180°
7	ASI-SD-FK	Cable socket for flat cable
8	ASI-KK-FK	Cable cap for flat cable

# Electrical connection technology, for AS-interface

Peripherals overview

FESTO

Valve terminal type 10 CPV with AS-interface connection with inputs, plug and connecting cable variants

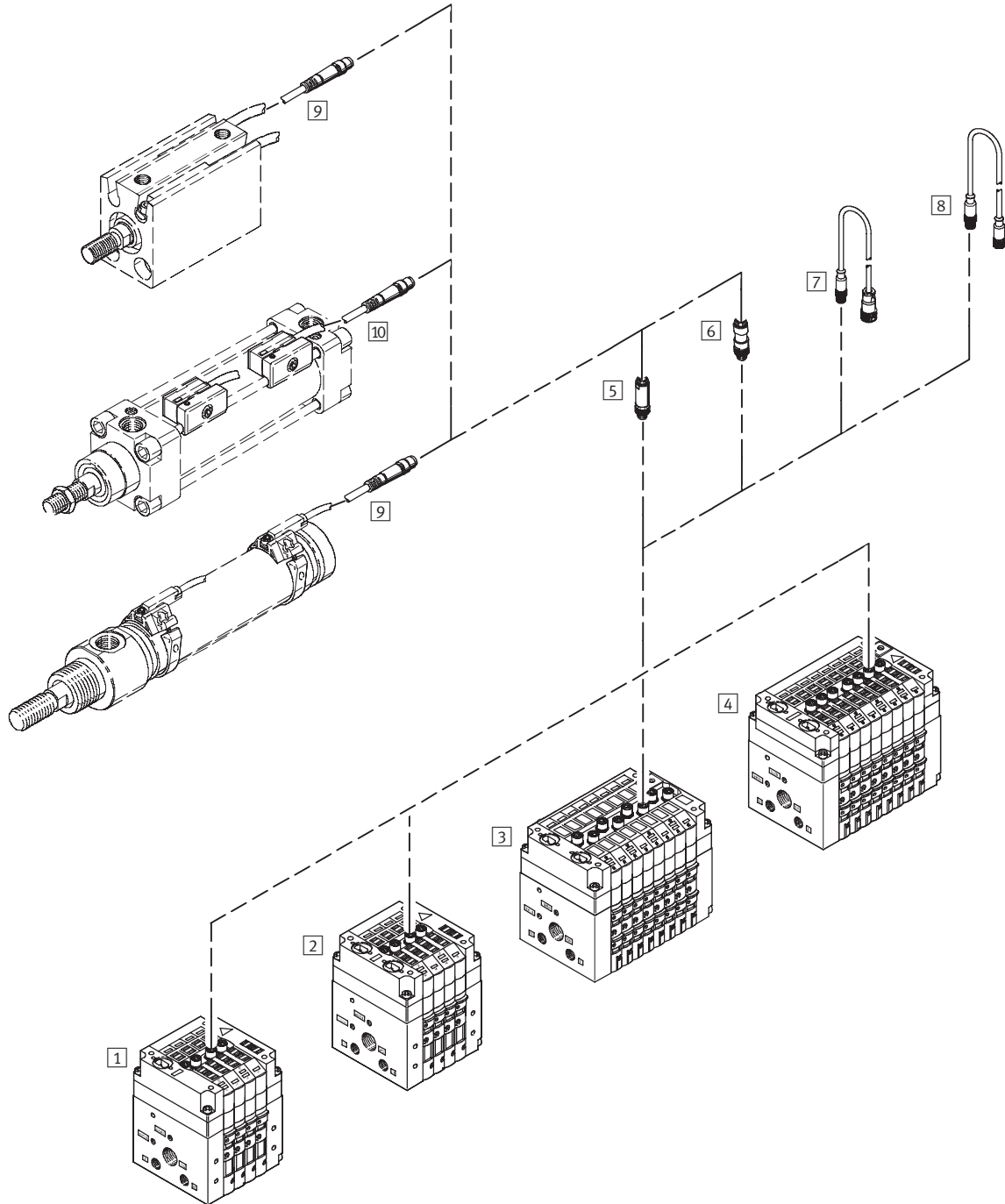

Accessories for valve terminals  
Electrical connector systems

5.1



# Electrical connection technology, for AS-interface

Peripherals overview

**FESTO**

Accessories		
	Brief description	→ Page
1 CPV...	Valve terminal type 10, Compact Performance with AS-interface connection and inputs	Info 220 AS-interface
2 CPV...	Valve terminal type 10, Compact Performance with AS-interface connection, auxiliary power supply and inputs (alternatively for A/B operation)	Info 220 AS-interface
3 CPV...	Valve terminal type 10, Compact Performance with AS-interface connection, auxiliary power supply and inputs	Info 220 AS-interface
4 CPV...	Valve terminal type 10, Compact Performance with AS-interface connection	Info 220 AS-interface
5 SEA-3GS-M8-S	Sensor plug for inputs and outputs, straight, M8, screw-in	4 / 5.1-160
6 SEA-GS-M8	Sensor plug for inputs and outputs, straight, M8, solderable	4 / 5.1-160
7 KM8-M12-GSGD-...	Connecting cable, straight plug M8, straight socket, 4-pin M12	4 / 5.1-150
8 KM8-M8-GSGD-...	Connecting cable, straight plug M8, straight socket, 3-pin M8	4 / 5.1-150
9 SMEO-...	Proximity sensor, electrical	www.festo.com
10 SMT-10	Proximity sensor, electrical	www.festo.com

# Electrical connection technology, for AS-interface

Peripherals overview

FESTO

## Valve terminal type 12 CPA with bus interface and power supply

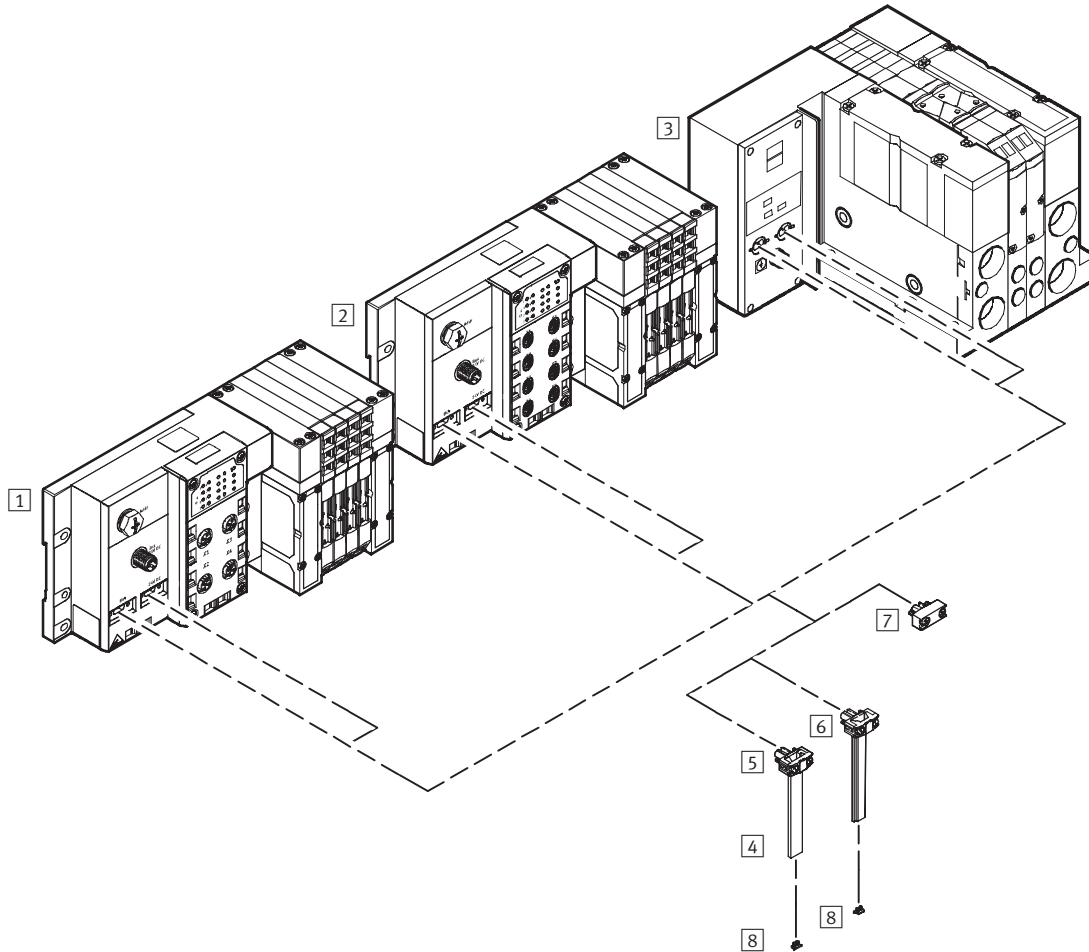

Accessories		
	Brief description	→ Page
1 CPA...	Valve terminal type 12, Compact Performance with AS-interface connection and inputs	Info 220 AS-interface
2 CPA...	Valve terminal type 12, Compact Performance with AS-interface connection, auxiliary power supply without inputs	Info 220 AS-interface
3 CPA...	Valve terminal type 12, Compact Performance with AS-interface connection, auxiliary power supply and inputs	Info 220 AS-interface
4 KASI-1,5-Y-100	Flat cable for AS-interface components	4 / 5.1-198
5 ASI-SD-FK-180	Cable socket for flat cable, profile turned 180°	4 / 5.1-189
6 ASI-SD-FK	Cable socket for flat cable	4 / 5.1-189
7 AS-SD-FK-BL	Flat cable blanking plug	4 / 5.1-189
8 ASI-KK-FK	Cable cap for flat cable	4 / 5.1-198

# Electrical connection technology, for AS-interface

Peripherals overview



Valve terminal type 12 CPA with bus interface, power supply, diagnostics and addressing interface

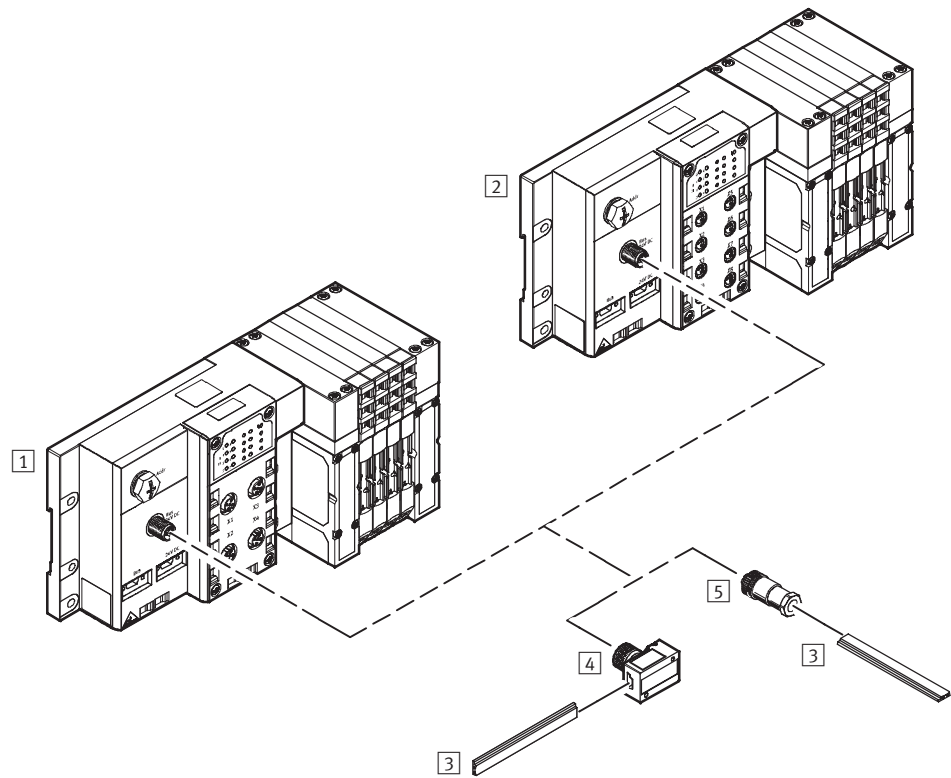

Accessories		
	Brief description	→ Page
1	CPA...	Valve terminal type 12, Compact Performance with AS-interface connection and inputs
2	CPA...	Valve terminal type 12, Compact Performance with AS-interface connection and inputs
3	KASI-1,5-Y-100	Flat cable for AS-interface components
4	ASI-SD-PG-M12	Cable socket M12x1, Pg13.5
5	ASI-SD-FK-M12	Cable socket M12x1

# Electrical connection technology, for AS-interface

Peripherals overview

FESTO

Valve terminal type 12 CPA with connection options including plugs, sockets and cables

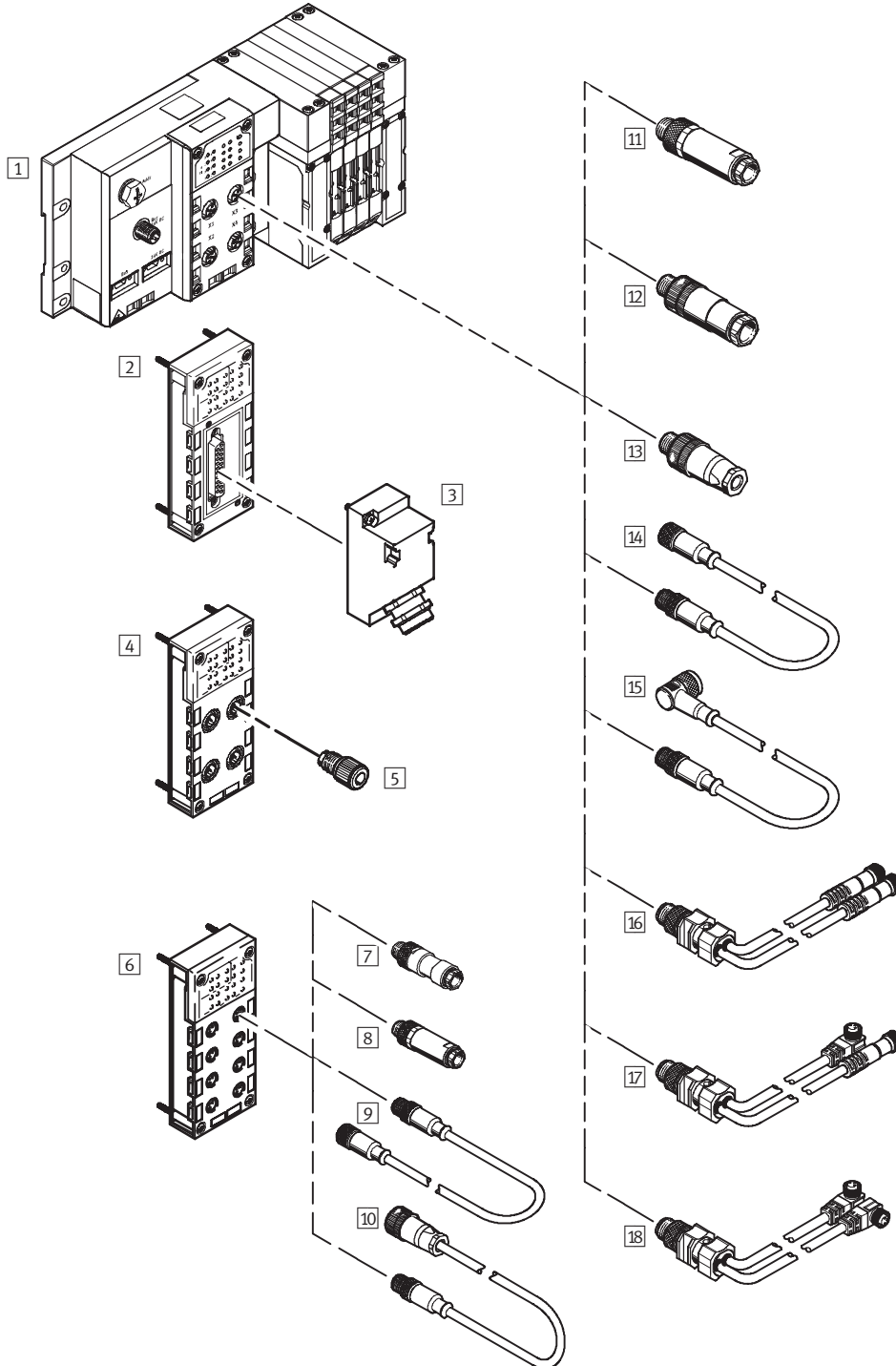

# Electrical connection technology, for AS-interface

Peripherals overview

**FESTO**

Accessories		
	Brief description	→ Page
1 CPA...	Valve terminal type 12 CPA...-ASI with 8 inputs M12	Info 220 AS-interface
2 CPX-AB-1-SUB-BU-25POL	Connection block, CPX terminal, clamps, IP20	Info 210 Modular electrical terminal CPX
3 SD-SUB-D-ST25	Plug, Sub-D, 25-pin	4 / 5.1-158
4 CPX-AB-4-HAR-4POL	Connection block, CPX terminal, Harax	Info 210 Modular electrical terminal CPX
5 SEA-GS-HAR-4POL	Sensor plug for inputs and outputs, Harax, 4-pin	4 / 5.1-168
6 CPX-AB-8-M8-3POL	Connection block, CPX terminal	Info 210 Modular electrical terminal CPX
7 SEA-GS-M8	Sensor plug for inputs and outputs, straight, M8, solderable	4 / 5.1-160
8 SEA-3GS-M8-S	Sensor plug for inputs and outputs, straight, M8, screw-in	4 / 5.1-160
9 KM8-M8-GSGD-...	Connecting cable, straight plug M8, straight socket, 3-pin M8	4 / 5.1-150
10 KM8-M12-GSGD-...	Connecting cable, straight plug M8, straight socket, 4-pin M12	4 / 5.1-150
11 SEA-GS-7	Sensor plug for inputs and outputs, straight, 4-pin	4 / 5.1-162
SEA-4GS-7-2,5	Sensor plug for inputs and outputs, straight, 4-pin	4 / 5.1-164
SEA-GS-9	Sensor plug for inputs and outputs, straight, 4-pin	4 / 5.1-162
12 SEA-GS-11-DUO	DUO plug for inputs and outputs, straight, 4-pin, for 2 cables	4 / 5.1-162
SEA-5GS-11-DUO	DUO plug for inputs and outputs, straight, 5-pin, for 2 cables	4 / 5.1-164
13 SEA-M12-5GS-PG7	Sensor plug M12 for inputs and outputs, straight, Pg7, 5-pin	4 / 5.1-166
14 KM12-M12-GSGD-...	Extension cable, straight plug, straight socket, 4-pin	4 / 5.1-23
15 KM12-M12-GSWD-1-4	Extension cable, straight plug, angled socket, 4-pin	4 / 5.1-23
16 KM12-DUO-M8-GDGD	DUO cable, straight sockets	4 / 5.1-154
17 KM12-DUO-M8-GDWD	DUO cable, straight socket/angled socket	4 / 5.1-154
18 KM12-DUO-M8-WDWD	DUO cable, angled sockets	4 / 5.1-154

# Electrical connection technology, for AS-interface

Peripherals overview



## Valve terminal type 12 CPA with connection options for electrical inputs

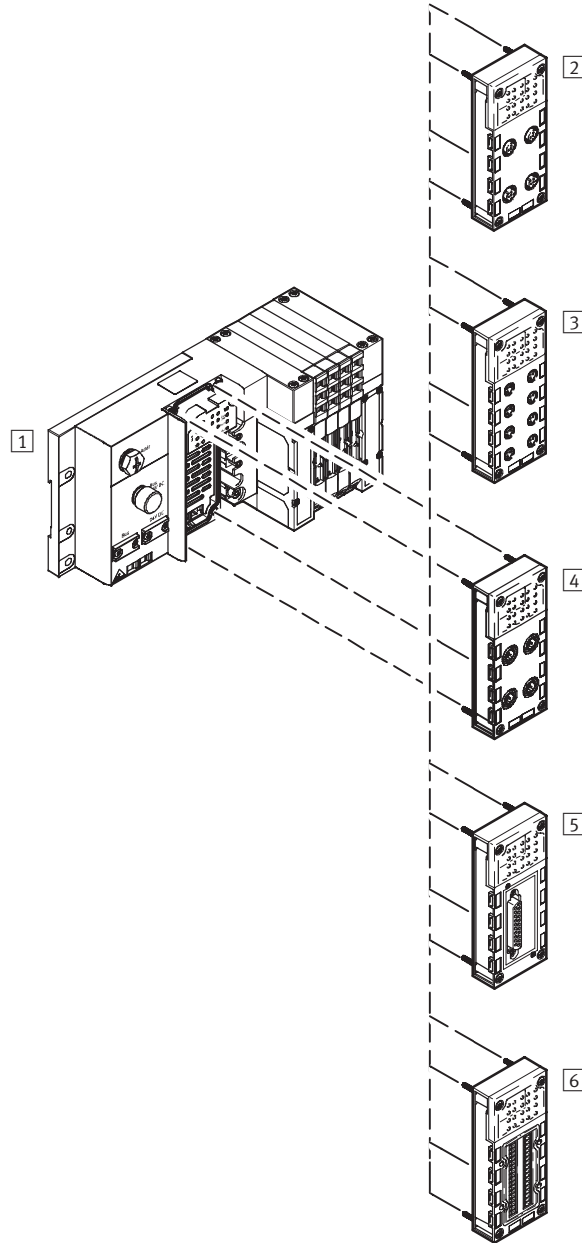

Accessories		
	Brief description	→ Page
1 CPA...	Valve terminal type 12, Compact Performance with AS-interface connection and inputs	Info 220 AS-interface
2 CPX-AB-4-M12x2-5POL	Connection block, CPX terminal, M12, 5-pin	Info 210 CPX terminal
3 CPX-AB-8-M8x2-3POL	Connection block, CPX terminal, M8, 3-pin	Info 210 CPX terminal
4 CPX-AB-4-HAR-POL	Connection block, CPX terminal, Harax	Info 210 CPX terminal
5 CPX-AB-4-8-...	Connection block, CPX terminal, Sub-D, 25 pin, IP65	Info 210 CPX terminal
6 CPX-AB-1-SUB-BU-25POL	Connection block CPX terminal, clamps, IP20	Info 210 CPX terminal

# Electrical connection technology, for AS-interface

Peripherals overview

FESTO

Accessories for valve terminals  
Electrical connector systems

5.1

## Valve terminal type 12 CPA with AS-interface distributors

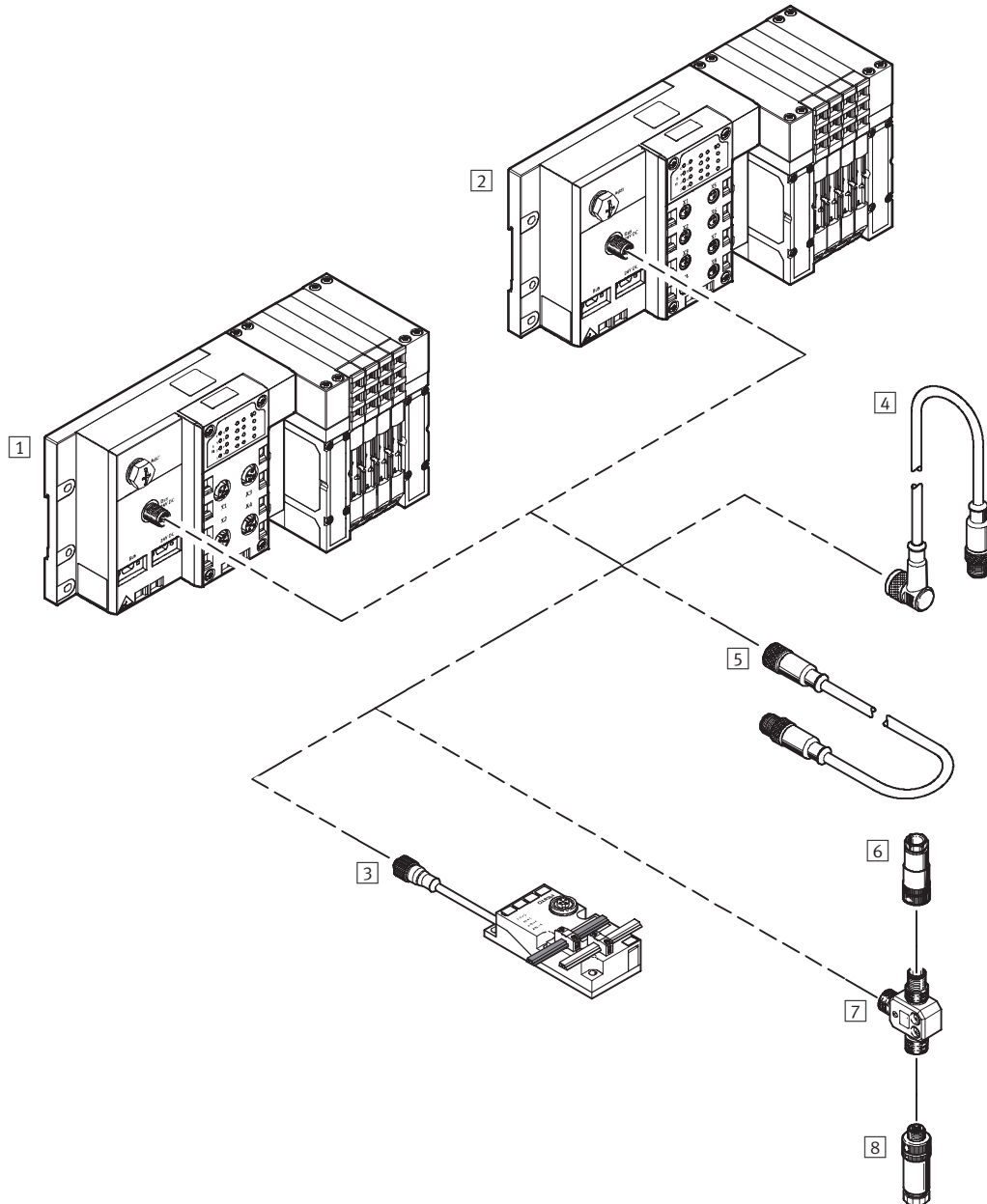

Accessories		
	Brief description	→ Page
1	CPA...	Valve terminal type 12, Compact Performance with AS-interface connection and inputs and auxiliary power supply
2	CPA...	Valve terminal type 12, Compact Performance with AS-interface connection and inputs and auxiliary power supply
3	ASI-KVT-FKx2-M12	Cable distributor for flat cables, plug socket M12
4	KM12-M12-GSWD-1-4	Extension cable, straight plug, angled socket, 4-pin
5	KM12-M12-GSGD-...	Extension cable, straight plug, straight socket, 4-pin
6	FBS-M12-5GS-PG9	Plug for T-adaptor
7	FB-TA-M12-5POL	T-adaptor
8	FBSD-GD-9-5POL	Socket, straight, with screw terminal

# Electrical connection technology, for AS-interface

Peripherals overview

FESTO

## AS-interface components and distributors

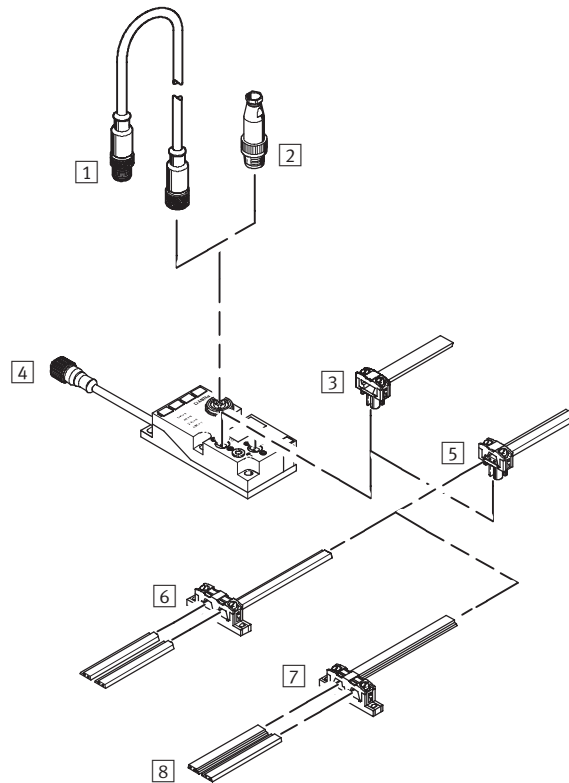

Accessories		
	Brief description	→ Page
1	KM12-M12-GSGD-...	Extension cable, straight plug, straight socket, 4-pin
2	SEA-M12-5GS-PG7	Sensor plug M12 for inputs and outputs, straight, Pg7, 5-pin
3	ASI-SD-FK-180	Cable socket for flat cable, profile turned 180°
4	ASI-KVT-FKx2-M12	Cable distributor for flat cables, plug socket M12
5	ASI-SD-FK	Cable socket for flat cable
6	ASI-KVT-FK	Cable distributor for flat cables, parallel
7	ASI-KVT-FK-S	Cable distributor for flat cables, symmetrical
8	KASI-1,5-Y-100	Flat cable for AS-interface components



# Electrical connection technology, for AS-interface

Peripherals overview



## AS-interface components with accessories

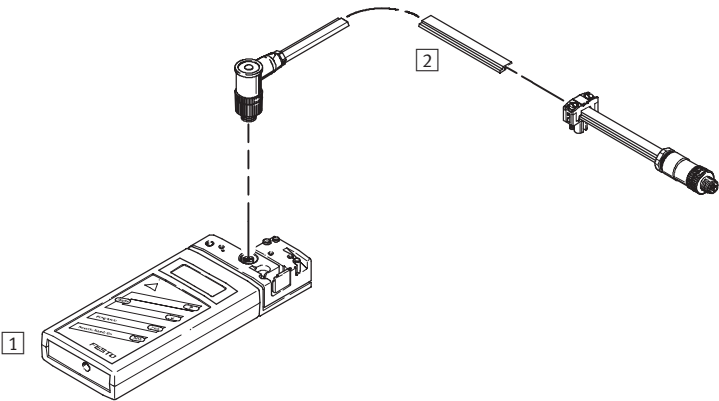

Accessories		
	Brief description	→ Page
1	ASI-PRG-ADR	Addressing device for AS-interface stations
2	KASI-ADR	Addressing cable for addressing device

# Electrical connection technology, for AS-interface

Peripherals overview

FESTO

AS-interface components, ASI-EVA individual valve interface, bus interface, power supply, plug and cable variants

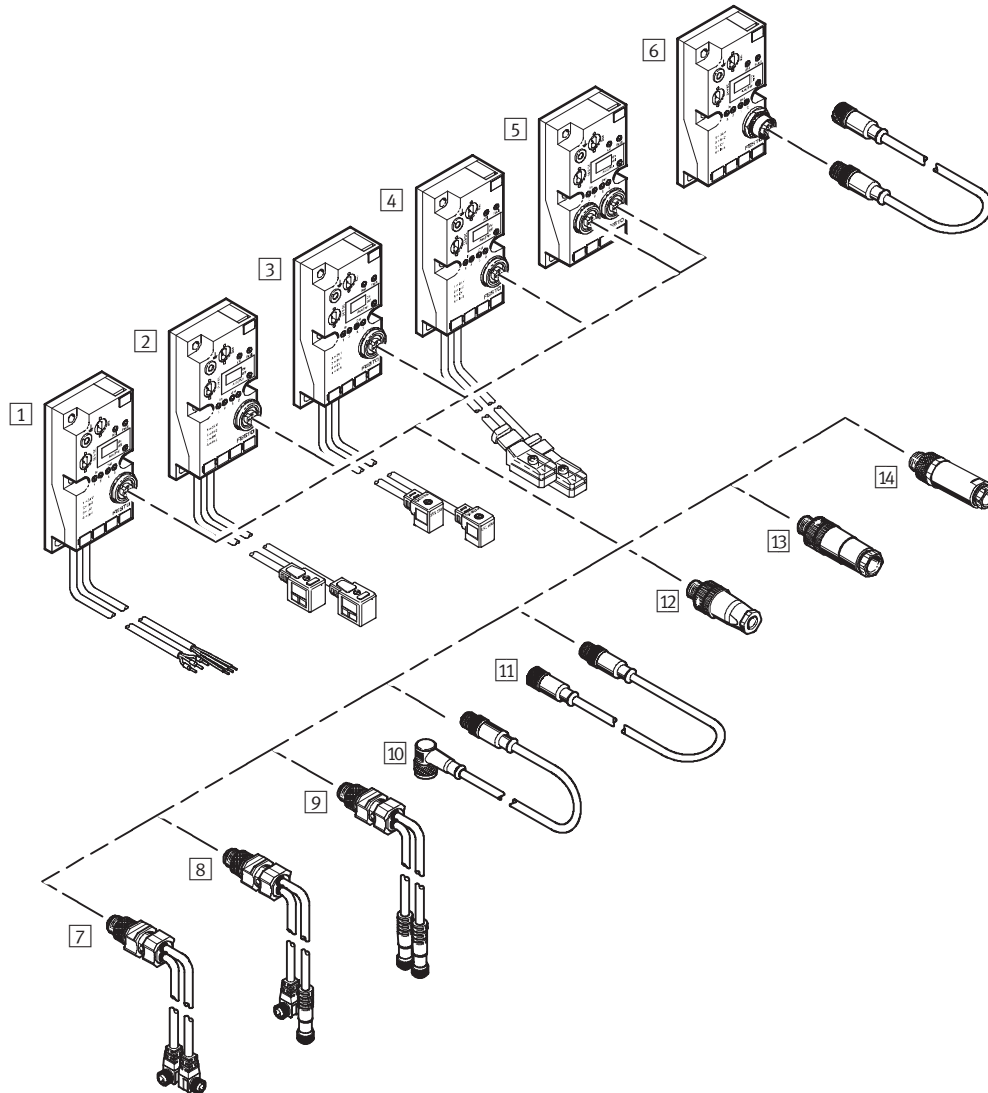

# Electrical connection technology, for AS-interface

Peripherals overview

**FESTO**

Accessories		
	Brief description	→ Page
1 ASI-EVA-K1-...	AS-interface individual valve interface for any valves up to 6 W (12 W)	Info 220 AS-interface
2 ASI-EVA-MF-...	AS-interface individual valve interface for F solenoid	Info 220 AS-interface
3 ASI-EVA-MEB-...	AS-interface individual valve interface for EB solenoid	Info 220 AS-interface
4 ASI-EVA-MZB-...	AS-interface individual valve interface for valves CPE10/14-M1BH	Info 220 AS-interface
5 ASI-EVA-4E-M12-5POL	AS-interface for 4 inputs	Info 220 AS-interface
6 ASI-EVA-3E2A-M12-8POL-Z	AS-interface connection for DNCV	Info 220 AS-interface
7 KM12-DUO-M8-WDWD	DUO cable, angled sockets	4 / 5.1-154
8 KM12-DUO-M8-GDWD	DUO cable, straight socket/angled socket	4 / 5.1-154
9 KM12-DUO-M8-GDGD	DUO cable, straight sockets	4 / 5.1-154
10 KM12-M12-GSWD-1-4	Extension cable, straight plug, angled socket, 4-pin	4 / 5.1-23
11 KM12-M12-GSGD-...	Extension cable, straight plug, straight socket, 4-pin	4 / 5.1-23
12 SEA-M12-5GS-PG7	Sensor plug M12 for inputs and outputs, straight, Pg7, 5-pin	4 / 5.1-166
13 SEA-GS-11-DUO SEA-5GS-11-DUO	DUO plug for inputs and outputs, straight, 4-pin, for 2 cables DUO plug for inputs and outputs, straight, 5-pin, for 2 cables	4 / 5.1-162 4 / 5.1-164
14 SEA-GS-7 SEA-4GS-7-2,5 SEA-GS-9	Sensor plug for inputs and outputs, straight	4 / 5.1-162 4 / 5.1-164 4 / 5.1-162

# Electrical connection technology, for AS-interface

Peripherals overview

FESTO

AS-interface components, ASI-EVA individual valve interface, bus interface, power supply

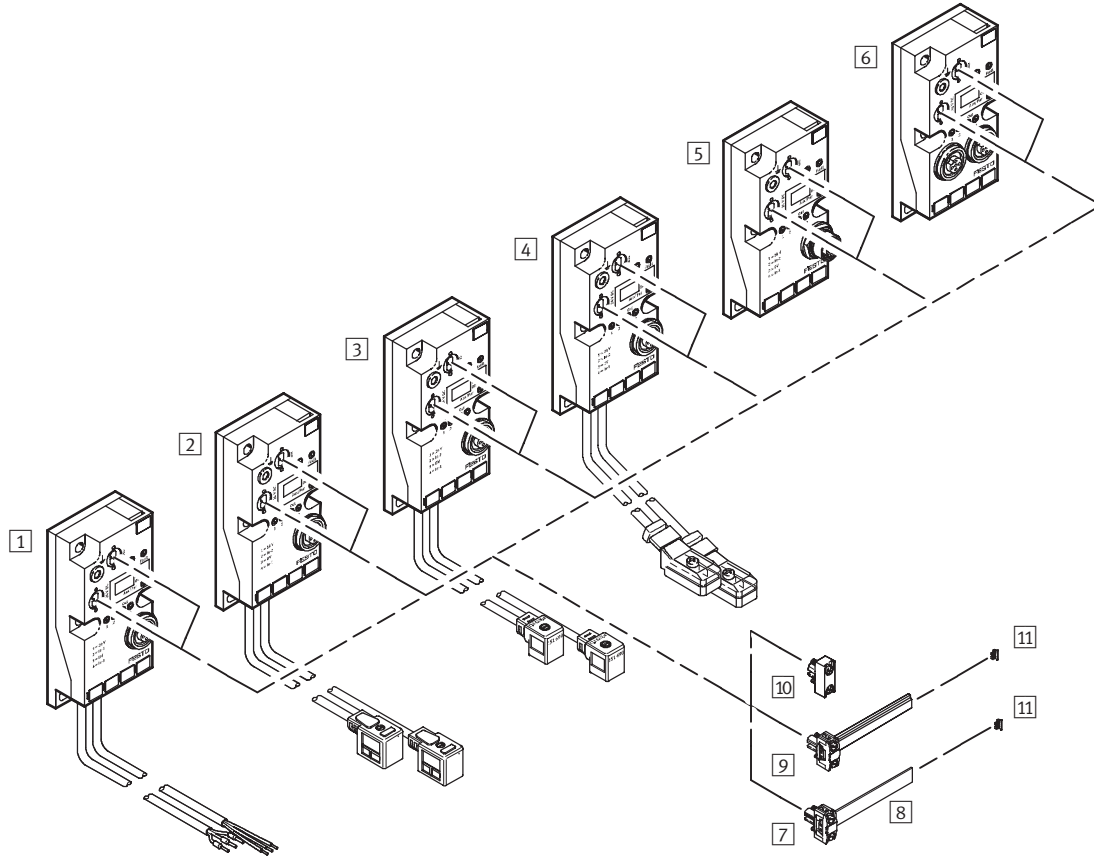

Accessories		
	Brief description	→ Page
1	ASI-EVA-K1-...	AS-interface individual valve interface for any valves up to 6 W Info 220 AS-interface
2	ASI-EVA-MF-...	AS-interface individual valve interface for F solenoid Info 220 AS-interface
3	ASI-EVA-MEB-...	AS-interface individual valve interface for EB solenoid Info 220 AS-interface
4	ASI-EVA-MZB-...	AS-interface individual valve interface for valves CPE10/14-M1BH Info 220 AS-interface
5	ASI-EVA-3E2A-M12-8POL-Z	AS-interface connection for DNCV Info 220 AS-interface
6	ASI-EVA-4E-M12-5POL	AS-interface for 4 inputs Info 220 AS-interface
7	ASI-SD-FK-180	Cable socket for flat cable, profile turned 180° 4 / 5.1-189
8	KASI-1,5-Y-100	Flat cable for AS-interface components 4 / 5.1-198
9	ASI-SD-FK	Cable socket for flat cable 4 / 5.1-189
10	ASI-SD-FK-BL	Blanking plug 4 / 5.1-189
11	ASI-KK-FK	Cable cap for flat cable 4 / 5.1-198

## Electrical connection technology, for AS-interface

Technical data – ASI-SD

**FESTO**

- Flat cable socket for the connection of AS-interface stations to the AS-interface bus system
- M12 connection
- Reverse polarity protected
- Detachable connection
- 2-pin or 4-pin

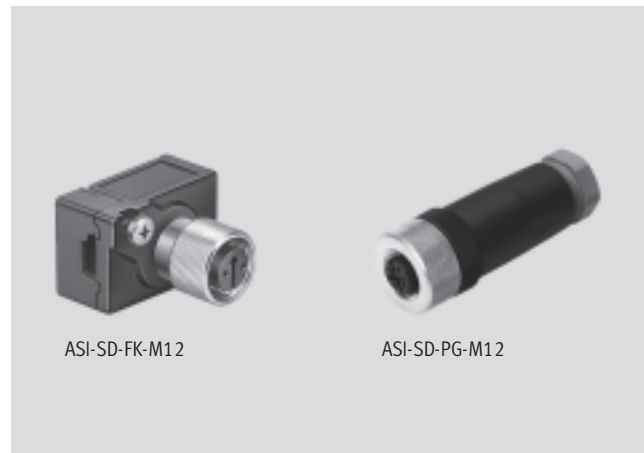

ASI-SD-FK-M12

ASI-SD-PG-M12

Accessories for valve terminals  
Electrical connector systems

**5.1**

General technical data		
Type	ASI-SD-FK-M12	ASI-SD-PG-M12
Mounting position	Any	
Connection type	Insulation displacement technology	Screw terminal
Connection cross-section [mm <sup>2</sup> ]	1.5	0.75
Cable gland fitting	–	Pg9
Protection class	IP67	
Material of housing	Polyamide	
Material of contacts	Gold-plated copper base alloy	Bronze
Material of union nut	Nickel-plated surface	
Operating temperature [°C]	–25 ... +60	–40 ... +85

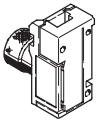
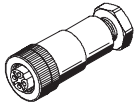
Ordering data							
	Electrical connection	Type of mounting	Operating voltage range [V]	Current-carrying capacity [A]	Product weight [g]	Type	Part No.
	Straight plug, 2-pin	Knurled screw	40 AC	2	16.8	ASI-SD-FK-M12	18 788
	Straight plug, 4-pin, screw terminal		125 AC	3	27.6	ASI-SD-PG-M12	18 789

# Electrical connection technology, for AS-interface

Technical data – ASI-SD

FESTO

## Dimensions

Download CAD data → [www.festo.com/en/engineering](http://www.festo.com/en/engineering)

ASI-SD-FK-M12

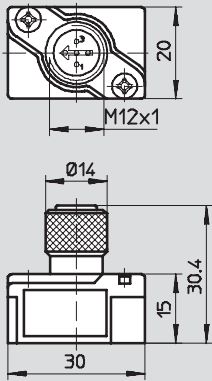

ASI-SD-PG-M12

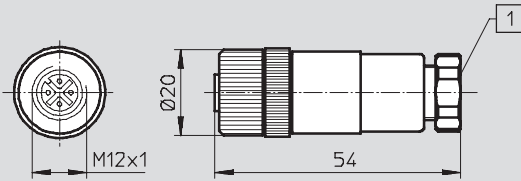

1 Seal for AS-interface cable

# Electrical connection technology, for AS-interface

Technical data – ASI-SD-FK

**FESTO**

- Flat cable socket for the connection of AS-interface stations to the AS-interface bus system
- 0° and 180° version
- Reverse polarity protected
- Detachable connection
- 2-pin
- Blanking plugs for sealing unused connections

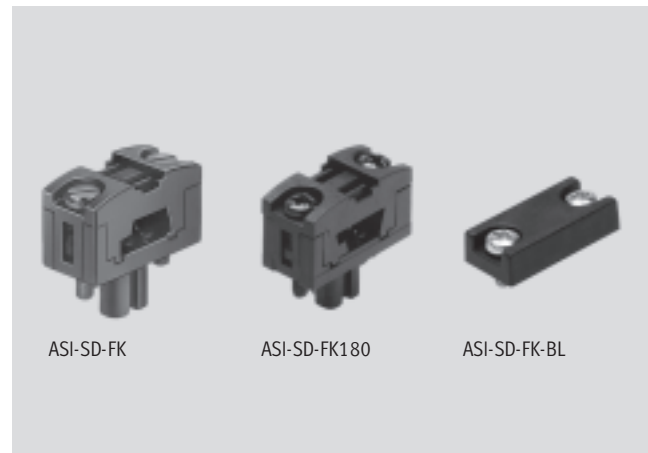

Accessories for valve terminals  
Electrical connector systems

**5.1**

General technical data			
Type	ASI-SD-FK	ASI-SD-FK180	ASI-SD-FK-BL
Mounting position	Any		
Version	Cable guide 0°	Cable guide 180°	–
Connection type	Insulation displacement technology		
Connection cross-section [mm <sup>2</sup> ]	1.5		
Protection class	IP65		
Material of housing	Polyamide		
Material of contacts	Bronze		
Ambient temperature [°C]	–5 ... +50		
Storage temperature [°C]	–30 ... +85		

Ordering data								
	Electrical connection	Type of mounting	Operating voltage range		Current-carrying capacity [A]	Product weight [g]	Type	Part No.
			[V]	[V]				
	Socket, straight, 2-pin	2 screws M2.5	60 AC	75 DC	3	6.8	ASI-SD-FK	18 785
			–	–	–	6.2	ASI-SD-FK180	196 089
	–	2 screws M2.5x6	–	–	–	3	ASI-SD-FK-BL	196 090

# Electrical connection technology, for AS-interface

Technical data – ASI-SD-FK

**FESTO**

## Dimensions

Download CAD data → [www.festo.com/en/engineering](http://www.festo.com/en/engineering)

### ASI-SD-FK

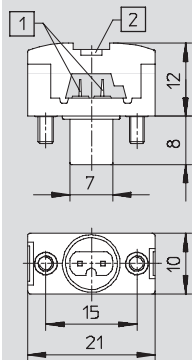

- [1] Contact blades for flat cable contacting
- [2] Inscription label mounting options

### ASI-SD-FK180

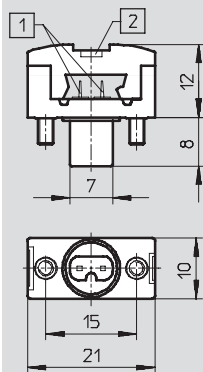

- [1] Contact blades for flat cable contacting
- [2] Inscription label mounting options

### ASI-SD-FK-BL

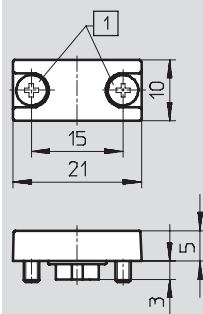

- [1] Mounting screws M2.5x6



## Electrical connection technology, for AS-interface

Technical data – ASI-KVT

**FESTO**

- Flat cable distributor for branching the AS-interface network at any desired point
- For parallel or symmetrical cable installation
- Reverse polarity protected

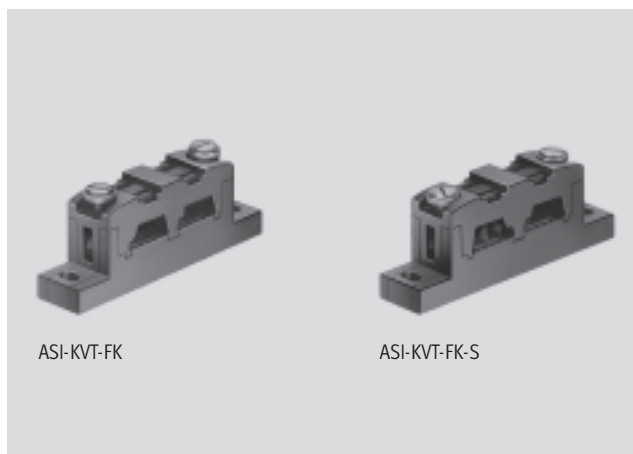

ASI-KVT-FK

ASI-KVT-FK-S

General technical data		
Type	ASI-KVT-FK	ASI-KVT-FK-S
Mounting position	Any	
Version	Cable guide parallel	Cable guide symmetrical
Connection type	Insulation displacement technology	
Connection cross-section [mm <sup>2</sup> ]	1.5	
Protection class	IP65	
Material of housing	Polyamide	
Material of contacts	Bronze	
Ambient temperature [°C]	−5 ... +50	
Storage temperature [°C]	−30 ... +85	

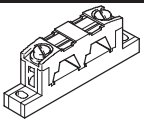
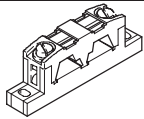
Ordering data							
	Type of mounting	Operating voltage range		Current-carrying capacity	Product weight	Type	Part No.
		[V]	[V]	[A]	[g]		
	2 screws M2.5	60 AC	75 DC	3	7.2	ASI-KVT-FK	18 786
						ASI-KVT-FK-S	18 797

# Electrical connection technology, for AS-interface

Technical data – ASI-KVT

**FESTO**

## Dimensions

Download CAD data → [www.festo.com/en/engineering](http://www.festo.com/en/engineering)

### ASI-KVT-FK

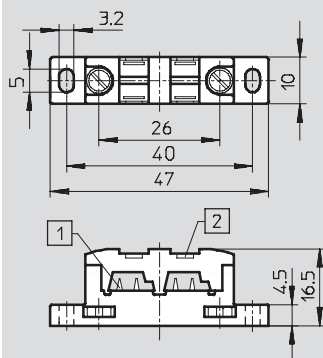

- 1 Contact blades for flat cable contacting
- 2 Inscription label mounting options

### ASI-KVT-FK-S

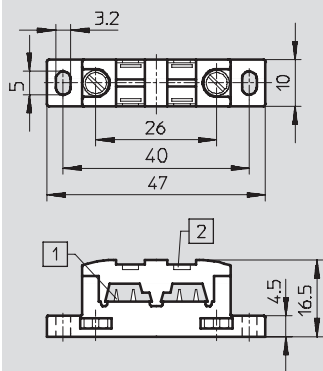

- 1 Contact blades for flat cable contacting
- 2 Inscription label mounting options

## Electrical connection technology, for AS-interface

Technical data – ASI-KVT-FKx2

**FESTO**

- Flat cable distributor for reconnection from AS-interface-flat cable to 4-pin M12 socket
- 2 connections: M12 socket with permanently attached cable, 1 m long, and M12 socket integrated in housing
- Reverse polarity protected



Accessories for valve terminals  
Electrical connector systems

**5.1**

General technical data		
Type	ASI-KVT-FKx2-M12	
Mounting position	Any	
Connection cross-section	[mm <sup>2</sup> ]	4x 0.34
AS-interface connection	Connection type	AS-interface flat cable plug (must be ordered separately)
	Nominal voltage [V]	26.5 ... 31.6 DC
	Residual ripple [mVss]	20
24 V DC connection	Connection type	AS-interface flat cable plug (must be ordered separately)
	Nominal voltage [V]	24 DC ±10%
	Residual ripple [mVss]	4
Protection class to EN 60 529		IP65
Material	Housing	Polyamide
	Cables	Polyurethane
Cable length	[mm]	1000
Ambient temperature	[°C]	−5 ... +50
Storage temperature	[°C]	−20 ... +70
Shock test		To DIN IEC 68; ±30 g at 11 ms, 15 cycles
Continuous shock test		To DIN IEC 68; ±15 g at 6 ms, 1000 cycles
Vibration test		To DIN IEC 68; 0.35 mm at 10 ... 60 Hz, 5 g at 60 ... 150 Hz
Protection against direct and indirect contact		By PELV

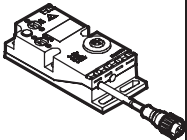
Ordering data				
View	Type of mounting	Product weight [g]	Type	Part No.
	AS-interface flat cable plug (must be ordered separately)	208	ASI-KVT-FKx2-M12	527 474

# Electrical connection technology, for AS-interface

Technical data – ASI-KVT-FKx2

FESTO

## Dimensions

Download CAD data → [www.festo.com/en/engineering](http://www.festo.com/en/engineering)

ASI-KVT-FKx2-M12

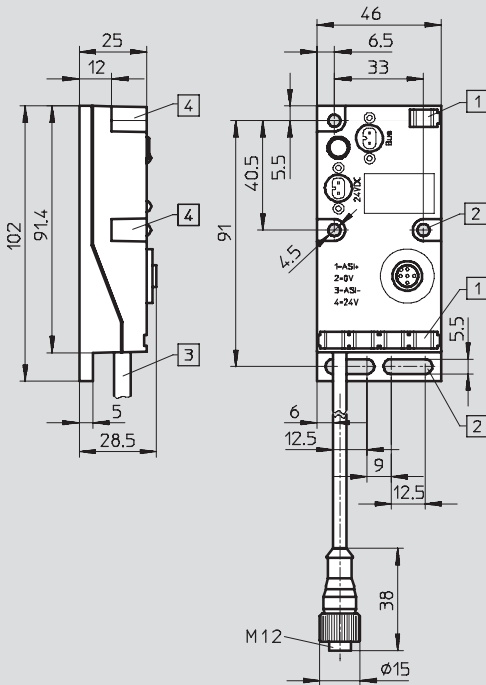

- 1 Inscription label mounting options
- 2 Mounting holes for surface mounting
- 3 Cable PUR-OB, 1 m long
- 4 Mounting holes for ITEM profile 40 mm or other mounting option

## Pin allocation

AS-interface and additional power supply

5-pin M12-socket and socket on the cable

	<p>1 AS-interface bus 1: + (light blue) 2: - (brown)</p> <p>2 Auxiliary power supply 1: 0 V 2: + 24 V DC</p>		<p>Pin 1: AS-interface + Pin 2: 0 V (auxiliary power supply) Pin 3: AS-interface - Pin 4: + 24 V (auxiliary power supply) Pin 5: Unused</p>
--	--	--	---

## Electrical connection technology, for AS-interface

Technical data – KASI

**FESTO**

- Addressing cable for any slaves including
  - Individual valve interface
  - Midi/maxi valve terminal with AS-interface connection
  - CP valve terminals
- Cable length 2.5 m
- Pre-assembled
- Reverse polarity protected



Accessories for valve terminals  
Electrical connector systems

**5.1**

General technical data		
Type	Type	KASI-ADR
Connection type		Plug-in/screw-in
Connection cross-section	[mm <sup>2</sup> ]	2x 1.5
Protection class		IP65
Material of plug, straight	Housing	Polybuteneterephthalate
	Contacts	Copper base alloy
	Union nut	Polybuteneterephthalate
Material of plug, angled	Housing	Polyurethane
	Contacts	Bronze
	Union nut	Nickel-plated brass
Material of flat cable socket	Housing	Polyamide
	Contacts	Bronze
Material of cable sheath		Rubber compound
Ambient temperature	[°C]	–40 ... +85

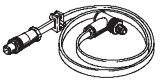
Ordering data						
View	Electrical connection	Operating voltage range		Current-carrying capacity [A]	Type	Part No.
		[V]	[V]			
	Plug, straight, 4-pin Plug, angled, 4-pin Socket, straight, 2-pin	60 AC	75 DC	3	KASI-ADR	18 960

# Electrical connection technology, for AS-interface

Technical data – KASI

FESTO

## Dimensions

Download CAD data → [www.festo.com/en/engineering](http://www.festo.com/en/engineering)

KASI-ADR

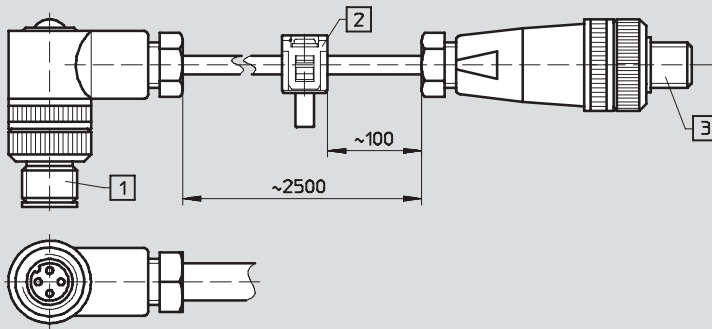

- 1 Round plug connector for connection to addressing device
- 2 Flat cable socket for connecting stations in the AS-interface network with plug-in connection
- 3 Flat cable socket with M12 connection plug for stations in the AS-interface network with M12 interface

# Electrical connection technology, for AS-interface

Technical data – ASI-SS

**FESTO**

- Configuration plug for master: the connector must be plugged into the master before the configuration process. The operating voltage can then be applied. If the plug is removed during operation of the master, the master configuration is stored in non-volatile memory.
- 2-pin



Accessories for valve terminals  
Electrical connector systems

**5.1**

General technical data	
Type	ASI-SS-CONFIG
Mounting position	Any
Protection class	IP65
Material of contact	Bronze
Material of contact surface	Nickel-tin alloy
Material of housing	Polybuteneterephthalate
Operating temperature [°C]	–40 ... +85

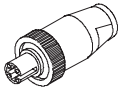
Ordering data						
View	Type of mounting	Nominal voltage [V]	Nominal current per contact [A]	Product weight [g]	Type	Part No.
	Knurled screw	250 AC	3	10.7	ASI-SS-CONFIG	18 961

## Dimensions

Download CAD data → [www.festo.com/en/engineering](http://www.festo.com/en/engineering)

ASI-SS-CONFIG

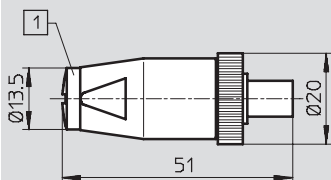

1 Protective cover

# Electrical connection technology, for AS-interface



Technical data – KASI-1,5

FESTO

- Flat cable, 2-core
- Reverse polarity protected
- Contact established using insulation displacement technology – no need to strip cable and wire insulation
- 2 different colours: yellow (preferred for the AS-interface network) and black (for auxiliary power supply)
- Pre-assembled
- Accessories
  - Flat cable sleeve  
For insulating and sealing the AS-interface cable
  - Cable cap  
For insulating and sealing the AS-interface cable at the end of the string

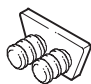

General technical data		
Type	KASI-1,5-Y-100	
Connection cross-section [mm <sup>2</sup> ]	2x 1.5	
Max. cable length [m]	100	
Colour	Yellow	Black
Use	For indoor use only	For outdoor use
Ambient temperature [°C]	–40 ... +85	
Ambient temperature of flexible cable installation [°C]	–25 ... +85	

Ordering data								
View	Material	Protection class	Operating voltage range		Current-carrying capacity [A]	Product weight [g]	Type	Part No.
			[V]	[V]				
	Sheath: Cable: Conductor: tin-plated copper	IP65 with closed wire ends	60 AC	75 DC	3	71	KASI-1,5-Y-100	18 940
							KASI-1,5-Z-100	18 941
	Polyamide	IP65	–	–	–	–	ASI-KK-FK	18 787
			–	–	–	–	ASI-KT-FK	165 593



# Electrical connection technology, for AS-interface

FESTO

Technical data – KASI-1,5

## Dimensions

Download CAD data → [www.festo.com/en/engineering](http://www.festo.com/en/engineering)

Flat cable – KASI-1,5-...-100

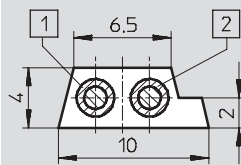

- 1 Blue (-)
- 2 Brown (+)

Cable cap – ASI-KK-FK

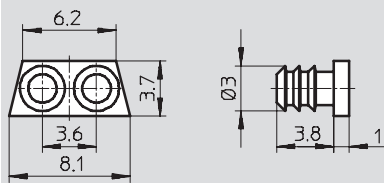

Flat cable sleeve – ASI-KT-FK

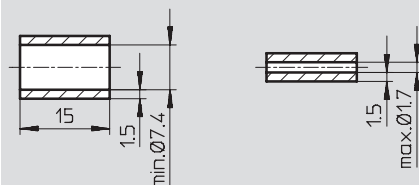



# Product Range and Company Overview

## A Complete Suite of Automation Services

Our experienced engineers provide complete support at every stage of your development process, including: conceptualization, analysis, engineering, design, assembly, documentation, validation, and production.



**Custom Automation Components**  
Complete custom engineered solutions



**Custom Control Cabinets**  
Comprehensive engineering support  
and on-site services



**Complete Systems**  
Shipment, stocking and storage services

## The Broadest Range of Automation Components

With a comprehensive line of more than 30,000 automation components, Festo is capable of solving the most complex automation requirements.



**Electromechanical**  
Electromechanical actuators, motors,  
controllers & drives



**Pneumatics**  
Pneumatic linear and rotary actuators,  
valves, and air supply



**PLCs and I/O Devices**  
PLC's, operator interfaces, sensors  
and I/O devices

## Supporting Advanced Automation... As No One Else Can!

Festo is a leading global manufacturer of pneumatic and electromechanical systems, components and controls for industrial automation, with more than 12,000 employees in 56 national headquarters serving more than 180 countries. For more than 80 years, Festo has continuously elevated the state of manufacturing with innovations and optimized motion control solutions that deliver higher performing, more profitable automated manufacturing and processing equipment. Our dedication to the advancement of automation extends beyond technology to the education and development of current and future automation and robotics designers with simulation tools, teaching programs, and on-site services.

## Quality Assurance, ISO 9001 and ISO 14001 Certifications

Festo Corporation is committed to supply all Festo products and services that will meet or exceed our customers' requirements in product quality, delivery, customer service and satisfaction.

To meet this commitment, we strive to ensure a consistent, integrated, and systematic approach to management that will meet or exceed the requirements of the ISO 9001 standard for Quality Management and the ISO 14001 standard for Environmental Management.



© Copyright 2008, Festo Corporation. While every effort is made to ensure that all dimensions and specifications are correct, Festo cannot guarantee that publications are completely free of any error, in particular typing or printing errors. Accordingly, Festo cannot be held responsible for the same. For Liability and Warranty conditions, refer to our "Terms and Conditions of Sale", available from your local Festo office. All rights reserved. No part of this publication may be reproduced, distributed, or transmitted in any form or by any means, electronic, mechanical, photocopying or otherwise, without the prior written permission of Festo. All technical data subject to change according to technical update.



Printed on recycled paper at New Horizon Graphic, Inc., FSC certified as an environmentally friendly printing plant.

# Festo North America

## United States

### Customer Resource Center

502 Earth City Expy., Suite 125  
Earth City, MO 63045

For ordering assistance, or to find  
your nearest Festo Distributor,

**Call:** 1.800.99.FESTO

**Fax:** 1.800.96.FESTO

**Email:** customer.service@us.festo.com

For technical support,

**Call:** 1.866.GO.FESTO

**Fax:** 1.800.96.FESTO

**Email:** product.support@us.festo.com

### Headquarters

Festo Corporation  
395 Moreland Road  
P.O. Box 18023  
Hauppauge, NY 11788  
[www.festo.com/us](http://www.festo.com/us)

## Sales Offices

### Appleton

N. 922 Tower View Drive, Suite N  
Greenville, WI 54942

### Boston

120 Presidential Way, Suite 330  
Woburn, MA 01801

### Chicago

1441 East Business Center Drive  
Mt. Prospect, IL 60056

### Dallas

1825 Lakeway Drive, Suite 600  
Lewisville, TX 75057

### Detroit - Automotive Engineering Center

2601 Cambridge Court, Suite 320  
Auburn Hills, MI 48326

### New York

395 Moreland Road  
Hauppauge, NY 11788

### Silicon Valley

4935 Southfront Road, Suite F  
Livermore, CA 94550

## Design and Manufacturing Operations



**East:** 395 Moreland Road, Hauppauge, NY 11788



**Central:** 1441 East Business Center Drive, Mt. Prospect, IL 60056



**West:** 4935 Southfront Road, Suite F, Livermore, CA 94550

## Mexico

### Headquarters

Festo Pneumatic, S.A.  
Av. Ceylán 3, Col. Tequesquahuac  
54020 Tlalnepantla, Edo. de México  
Call: 011 52 [55] 53 21 66 00  
Fax: 011 52 [55] 53 21 66 65  
Email: festo.mexico@mx.festo.com  
[www.festo.com/mx](http://www.festo.com/mx)



## Canada

### Headquarters

Festo Inc.  
5300 Explorer Drive  
Mississauga, Ontario L4W 5G4  
Call: 1.905.624.9000  
Fax: 1.905.624.9001  
Email: info.ca@ca.festo.com  
[www.festo.com/ca](http://www.festo.com/ca)



## Festo Worldwide

Argentina Australia Austria Belarus Belgium Brazil Bulgaria Canada Chile China Colombia Croatia Czech Republic Denmark  
Estonia Finland France Germany Great Britain Greece Hong Kong Hungary India Indonesia Iran Ireland Israel Italy Japan  
Latvia Lithuania Malaysia Mexico Netherlands New Zealand Norway Peru Philippines Poland Romania Russia Serbia Singapore  
Slovakia Slovenia South Africa South Korea Spain Sweden Switzerland Taiwan Thailand Turkey Ukraine United States Venezuela

[www.festo.com](http://www.festo.com)