

# Proximity switch for T-slot



Festo Core Range

Solves the majority of your automation tasks

Worldwide:

Simply good:

Fast:

Quickest delivery – wherever, whenever

Expected high Festo quality

Easy and fast to select

With the Festo Core Range, we have selected the most important products and functions from our broad product catalogue, and added the quickest delivery.

The Core Range offers you the best value for your automation tasks.

Just look for the star!

## Product range overview

Design	Type of mounting	Measuring principle	Type	Operating voltage range	Switching output	Switching element function	→ Page	
For T-slot	Standard							
	Screw-clamped, insertable in the slot from above	Magnetic Hall	SDBT-MSX	10 ... 30 V DC	PNP/NPN, switchable	N/O / N/C contact, switchable	–	
	Insertable in the slot from above, flush with the cylinder profile	Magneto-resistive	SMT-8M-A	5 ... 30 V DC	PNP	N/O contact	7	
						N/C contact		
					NPN	N/O contact		
					Non-contacting, 2-wire	N/O contact		
	Insertable in the slot from above, flush with the cylinder profile	Magnetic reed	SME-8M	5 ... 30 V AC/DC	Contacting, bipolar	N/O contact	–	
						N/C contact		
	Insertable in the slot lengthwise, flush with the cylinder profile	Magnetic reed	SME-8	12 ... 30 V AC/DC	Contacting, bipolar	N/O contact	–	
				3 ... 230 V AC/DC		N/C contact	–	
	Insertable in the slot lengthwise	Magneto-resistive	SMT-8G	10 ... 30 V DC	PNP, NPN	N/O contact	–	
		Magneto-resistive	SMT-8-SL	10 ... 30 V DC	PNP	N/O contact	–	
		Magnetic reed	SME-8-SL	10 ... 30 V AC/DC	Contacting, bipolar	N/O contact	–	
	Insertable in the slot from above	Magnetic reed	SME-8-FM	10 ... 30 V AC/DC	Contacting, bipolar	N/O contact	–	
	With accessories	Magneto-resistive	SMT0-8E	10 ... 30 V DC	PNP	N/O contact	–	
					NPN			
		Magnetic reed	SME0-8E	12 ... 30 V DC	Contacting, bipolar	N/O contact	–	
				3 ... 250 V DC				
				3 ... 230 V AC				
	Corrosion-resistant							
	Insertable in the slot from above, flush with the cylinder profile	Magneto-resistive	CRSMT-8M	5 ... 30 V DC	PNP	N/O contact	–	
	Welding-field-resistant							
	Insertable in the slot from above, screw-clamped	Magneto-resistive	SDBT-BSW	10 ... 30 V DC	PNP	N/O contact	–	
					NPN			
					Non-contacting, 2-wire			
	With accessories	Magneto-inductive	SMTSO-8E	10 ... 30 V DC	PNP	N/O contact	–	
					NPN			
	Heat-resistant up to 120°C							
	Insertable in the slot lengthwise, flush with the cylinder profile	Magnetic reed	SME-8-...S6	0 ... 30 V AC/DC	Contacting, bipolar	N/O contact	–	
	With accessories	Magnetic reed	SME0-8E-...S6	0 ... 30 V DC	Contacting	N/O contact	–	
				0 ... 30 V AC				
	To EU Explosion Protection Directive (ATEX)							
	Insertable in the slot from above, screw-clamped	Magneto-resistive	SDBT-MS-...-EX6	8.2 V DC	NAMUR	NAMUR	–	

## Product range overview

Design	Type of mounting	Measuring principle	Type	Operating voltage range	Switching output	Switching element function	→ Page
For C-slot	<b>Standard</b>						
	Insertable in the slot from above, flush with the cylinder profile	Magneto-resistive	SMT-10M	10 ... 30 V DC	PNP	N/O contact	C-slot
					NPN		
					Non-contacting, 2-wire		
	Insertable in the slot lengthwise	Magnetic reed	SME-10M	5 ... 30 V AC/DC	Contacting, bipolar	N/O contact	
		Magneto-resistive	SMT-10G	10 ... 30 V DC	PNP	N/O contact	
		Magnetic reed	SME-10	12 ... 27 V AC/DC	Contacting	N/O contact	

## T-slot switches can be used for drives with T-slot

## Exceptions

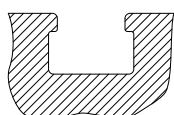

- DFM-B: SMT-8E, SMTSO-8E, SME-8E and SMP-8E cannot be used
- DHDS: SME-8M can only be used on diameter  $\varnothing 50$
- DHPS: SME-8M can only be used on  $\varnothing 20 \dots 35$
- HGDD-63-A: SMT-8M-A cannot be used
- HGPT-B: only SMT-8G can be used from size 40 and upwards
- SDBT-BSW- ... -PU/NU can only be used on a limited number of drive series. Page → 53

## C-slot switches can be used for drives with C-slot

## Exceptions

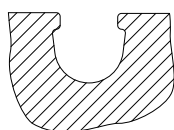

- ADVC  $\varnothing 100$ : SMT-10M and SME-10M cannot be used (ADVC has a T-slot and C-slot)
- DSM/DSM-B-6/8/10: SME-10M cannot be used
- DSM/DSM-B-10/16: SMT-10M cannot be used
- HGPT-B: only SMT-10G can be used for sizes up to and including size 35

## For drives with sensor rail: these are available with 2 cylinder barrel contours

Only T-slot switches CRSMT-8M, SMT-8M-A and SDBT-MS- ... -EX6 can be used, and only with the identified profile.

CRSMT-8M and SMT-8M-A can be used for all diameters; SDBT-MS- ... -EX6 cannot be used for diameters 40 and 50.

Example: DSBF

Example: CDC

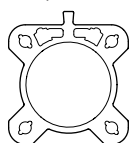

Suitable

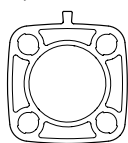

Not suitable

Peripherals overview

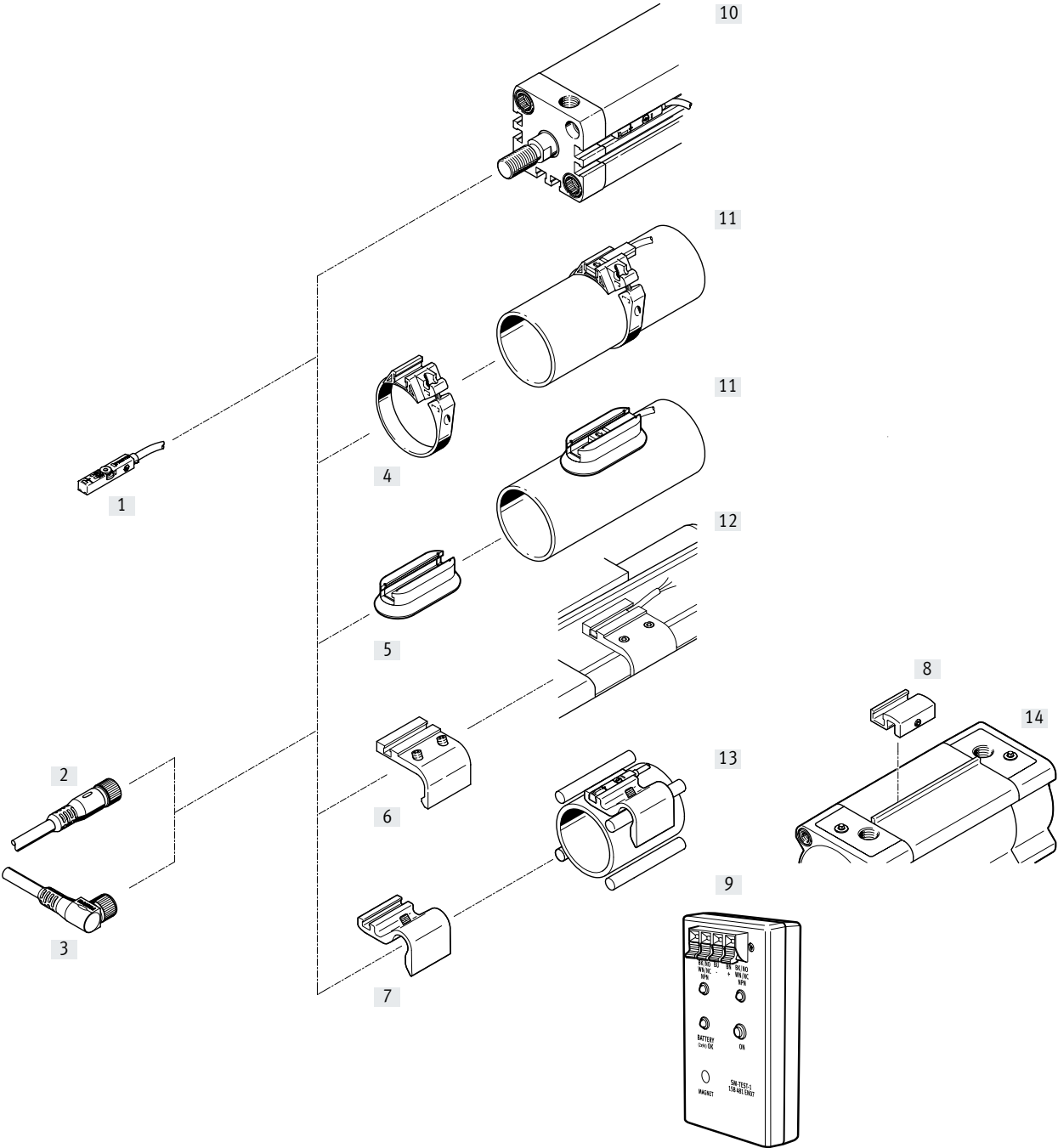

## Peripherals overview

Mounting components and accessories		→ Page	Mounting components and accessories		→ Page
<b>Proximity switches</b>			<b>Mounting kits and accessories</b>		
[1]	SMT-8M-A-..., with cable	7	[4]	Mounting kit SMBR	14
			[5]	Mounting kit CRSMB, corrosion-resistant	14
			[6]	Mounting kit SMB-8-FENG	15
			[7]	Sensor bracket DASP-M4-...	15
			[8]	Mounting kit SMB-8-C	16
			[9]	Sensor tester SM-TEST-1	17
<b>Connecting cables</b>			<b>Drives</b>		
[2]	NEBU-M...G...	17	[10]	Drives with T-slot	–
[3]	NEBU-M...W...	17	[11]	Round cylinders	–
			[12]	Standards-based cylinders DSBC	–
			[13]	Drives with tie or mounting rod	–
			[14]	Standards-based cylinders DSBF	–

## Type codes

001	Series	
SMT	Proximity sensor	

002	Design type	
8	For T-slot	

003	Sensor version	
M	Inserted in the slot from above	

004	Design	
A	Short	

005	Switching output	
NO	3-wire N/C contact NPN	
NS	3-wire NPN N/O contact	
PNS	PNP/NPN, switchable	
PO	3-wire PNP N/C contact	
PS	3-wire PNP N/O contact	
PSO	PNP N/C or N/O contact, switchable	
ZS	2-wire PNP N/O contact	

006	Rated operating voltage	
24V	24 V	

007	Cable characteristic	
E	Suitable for energy chains/robot applications	

008	Cable length [m]	
	0.1 ... 30 m	
0,3	0.3 m	
2,5	2.5 m	
5,0	5 m	
7,5	7.5 m	

009	Cable identification	
	With label holder	
N	Without label holder	

010	Connection technology	
OE	Open end	
M8	M8, snap-on flange	
M8D	M8, rotatable thread	
M12	M12, rotatable thread	

011	EU certification	
	None	
EX2	II 3GD	

## Data sheet – Magneto-resistive

Function

PNP, N/O contact, with cable

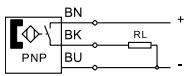

NPN, N/O contact, with cable

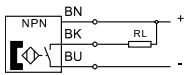

- Magneto-resistive measuring principle
- Insertable in the slot from above, does not protrude over the cylinder profile
- Variant Ex2 for use in potentially explosive areas in zones 2 and 22



General technical data	
Design	For T-slot
Mounting position	Optional
Based on standard	EN 60947-5-2
Certification	c UL us listed (OL) RCM compliance mark
KC mark	KC EMC
CE marking (see declaration of conformity)	To EU EMC Directive To EU RoHS Directive
Note on materials	Cable halogen-free, oil-resistant RoHS-compliant, free of copper and PTFE

Input signal/measuring element	
Measured variable	Position
Measuring principle	Magneto-resistive
Ambient temperature [°C]	-40 ... +85

Switching output							
Type	PS	NS	PO	NO	ZS	PNS	PSO
Switching output	PNP	NPN	PNP	NPN	Non-contacting, 2-wire	PNP, NPN, switchable	PNP
Switching element function	N/O contact	N/O contact	N/C contact	N/C contact	N/O contact	N/O contact	N/C contact, N/O contact, switchable
Repetition accuracy [mm]	±0.1			0.2	±0.1		
Switch-on time [ms]	≤ 1.3				≤ 1.0		
Switch-off time [ms]	≤ 1.4				≤ 1.0		
Max. output current [mA]	100 <sup>1)</sup>	100 <sup>1)</sup>	100 <sup>1)</sup>	100	80 <sup>1)</sup>	100	100
Max. output current in mounting kits [mA]	100				80 <sup>1)</sup>	100	
Max. switching capacity DC [W]	2.8	2.8	2.8	2.8	1.9	2.7	2.7
Max. switching capacity DC in mounting kits [W]	2.8 <sup>2)</sup>	2.8 <sup>2)</sup>	2.8 <sup>2)</sup>	2.8	1.5 <sup>2)</sup>	2.7	2.7
Max. switching frequency [Hz]	180						
Voltage drop <sup>1)</sup> [V]	< 1.5				< 6	< 2.5	

1) Variant ...PS/NS/PO-...Ex2: max. output current in mounting kits 80 mA, T<sub>a</sub> 70°C  
Variant ...ZS-...Ex2: max. output current in mounting kits 50 mA, T<sub>a</sub> 70°C

2) Variant ...PS/NS/PO-...Ex2: max. switching capacity 2.2 W  
Variant ...ZS-...Ex2: max. switching capacity 1.2 W

Output, additional data	
Short circuit protection	Yes
Overload protection	Present

## Data sheet – Magneto-resistive

Electronics					
Type		PS, NS, PO, NO, ZS	PNS, PSO	Ex2	
Operating voltage range	[V DC]	5 ... 30	7 ... 30	5 ... 30	
Rated operating voltage	[V DC]	24			
Reverse polarity protection		For all electrical connections			
Electromechanics					
Electrical connection		M8	M8D	M12	OE Ex2
Connection type		Cable with plug			Cable
Connection technology		Open end	M8x1, A-coded to EN 61076-2-104	M12x1, A-coded to EN 61076-2-101	Open end M8x1, A-coded to EN 61076-2-104
Number of pins/wires		3			2
Type of mounting		–	Screw-type lock		–
Outlet direction of connection		In-line			
Cable test conditions		Cable chain: 5 million cycles, bending radius 28 mm			
		Torsional resistance: > 300,000 cycles, ±270°/0.1 m			
		Resistance to bending: to Festo standard; test conditions on request			
Cable length	[m]	0.1 ... 30			
Cable characteristic		Cable chain + robot			
Information on materials: cable sheath		TPE-U(PUR)			
Cable sheath colour		Grey			
Mechanics					
Electrical connection		M8, M8D, M12			OE
Type of mounting		Screw-clamped, insertable in the slot from above			
Max. tightening torque	[Nm]	0.6			
Housing		black			
		PA-reinforced			
		High-alloy stainless steel			
		Nickel-plated brass			–



## Data sheet – Magneto-resistive

Display/operation	PS, NS, PO, NO, ZS	PNS	PSO
Switching status indication	Yellow LED	Yellow LED (for PNP) / white LED (for NPN)	Yellow LED (for N/O contact) / white LED (for N/C contact)
Function reserve indication	Orange LED	–	

Immission/emission	
Ambient temperature with flexible cable installation [°C]	–20 ... +85
Degree of protection	IP65, IP68, IP69K

ATEX	
SMT-8M-A-...	Ex2
ATEX category for gas	II 3G
Type of ignition protection for gas	Ex nA IIC T4 X Gc
ATEX category for dust	II 3D
Type of ignition protection for dust	Ex tc IIIC T120°C X Dc
Explosion-proof ambient temperature	–40°C ≤ Ta ≤ +70°C
Explosion prevention and protection	Zone 2 (ATEX)
	Zone 22 (ATEX)
CE marking (see declaration of conformity)	To EU Explosion Protection Directive (ATEX)

## Pin allocation to EN 60947-5-2

M8x1, 2-pin  
N/O contact

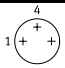
	Pin	Wire colour	Allocation
	1	Brown	+
	4	Black	–

M12x1, 2-pin  
N/O contact

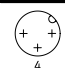
	Pin	Wire colour	Allocation
	1	Brown	+
	4	Black	–

## Pin allocation to EN 60947-5-2

M8x1, 3-pin  
N/O contact / N/C contact

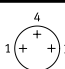
	Pin	Wire colour	Allocation
	1	Brown	+
	3	Blue	–
	4	Black	Output

M12x1, 3-pin  
N/O contact

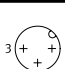
	Pin	Wire colour	Allocation
	1	Brown	+
	3	Blue	–
	4	Black	Output

## Pin allocation to EN 60947-5-2

M12x1, 3-pin  
N/C contact

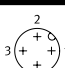
	Pin	Wire colour	Allocation
	1	Brown	+
	3	Blue	–
	2	White	Output

Data sheet – Magneto-resistive

Dimensions

Download CAD data → [www.festo.com](http://www.festo.com)

SMT8-M-A-24V-E-.... (PS, NS, PO, NO, ZS)

Technical drawing of the SMT8-M-A-24V-E-.... (PS, NS, PO, NO, ZS) sensor. The side view shows dimensions L3 (total length), L4 (length to the center of the sensor element), and H1 (height). The front view shows dimensions B1 (width) and a callout 1 pointing to the clamping element. Callouts 2, 3, and 4 point to the sensor element, the yellow light emitting diode, and the orange light emitting diode, respectively.

Yellow light emitting diode for safe switching status.

Yellow and orange light emitting diode for unsafe switching status.

[1] Yellow light emitting diode

[2] Orange light emitting diode

[3] Position of sensor element centre

[4] Clamping element, tightening torque 0.6 Nm

SMT8-M-A-24V-E-.... (PNS, PSO)

Technical drawing of the SMT8-M-A-24V-E-.... (PNS, PSO) sensor. The side view shows dimensions L3 (total length), L4 (length to the center of the sensor element), and H1 (height). The front view shows dimensions B1 (width) and a callout 1 pointing to the clamping element. Callouts 2, 3, and 4 point to the sensor element, the yellow light emitting diode, and the white light emitting diode, respectively.

Switching status indication for PNS:

Yellow light emitting diode for PS switching output.

White light emitting diode for NS switching output.

[1] Yellow light emitting diode

[2] White light emitting diode

[3] Position of sensor element centre

[4] For Allen key

Switching status indication for PSO:

Yellow light emitting diode for PS switching output.

White light emitting diode for PO switching output.

Type	B1	H1	L3	L4	± 1
SMT-8M-A-...-24V-E- (PS, NS, PO, NO, ZS)	5	4.6	29.3	26.3	1.5
SMT-8M-A-...-24V-E- (PNS, PSO)			34.8	31.8	

## Data sheet – Magneto-resistive

## Dimensions

Download CAD data → [www.festo.com](http://www.festo.com)

SMT-8M-A-...-OE/OE-Ex – Cable

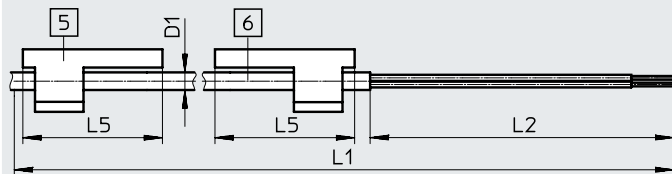

- [5] Inscription label holder drawn turned by 90°
- [6] Connecting cable

L1 Cable length

SMT-8M-A-...-M8D – Cable with plug M8x1, rotatable thread

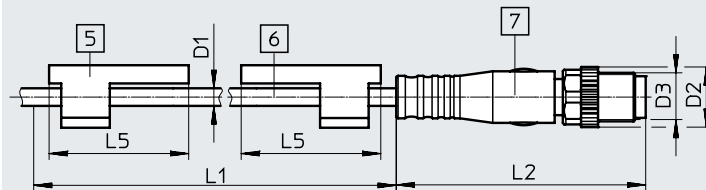

- [5] Inscription label holder drawn turned by 90°
- [6] Connecting cable
- [7] Plug suitable for connecting cable NEBU-M8

L1 Cable length

SMT-8M-A-...-M8 – Cable with plug M8x1, snap-on flange

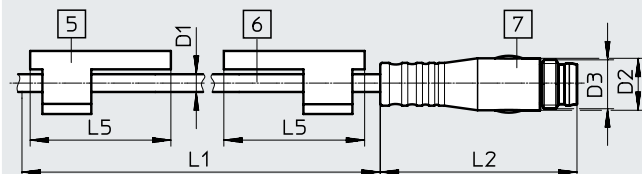

- [5] Inscription label holder drawn turned by 90°
- [6] Connecting cable
- [7] Plug suitable for connecting cable NEBU-M8

L1 Cable length

SMT-8M-A-...-M12 – Cable with plug M12x1, rotatable thread

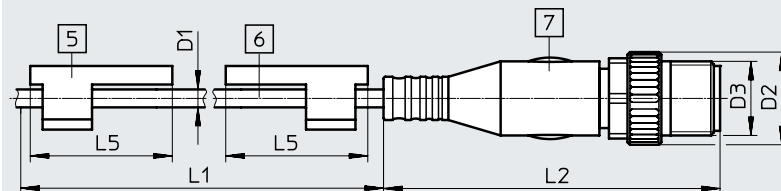

- [5] Inscription label holder drawn turned by 90°
- [6] Connecting cable
- [7] Plug suitable for connecting cable NEBU-M12

L1 Cable length

Type	D1	D2 ø	D3	L1	L2	L5	±1
SMT-8M-A-...-OE	2.9	–	–	2500, 7500	50	23	1.5
SMT-8M-A-...-OE-EX2		–	–	5000	50		
SMT-8M-A-...-M8D		10	M8x1	300	41.1		
SMT-8M-A-...-M8		8.5	M8x1	–	32.7		
SMT-8M-A-...-M12		15	M12x1	–	54.5		

## Data sheet – Magneto-resistive

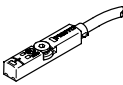
Ordering data								
	Switching output	Electrical connection		Cable length	Weight	Part no.	Type	
		Cable	Cable with plug, rotatable thread					
			M8x1	M12x1	[m]	[g]		
	N/O contact							
	PNP	–	3-pin	–	0.3	8.9	★ 574334	SMT-8M-A-PS-24V-E-0.3-M8D
	PNP	3-wire	–	–	2.5	29.1	★ 574335	SMT-8M-A-PS-24V-E-2.5-OE
	PNP	3-wire	–	–	5	57.1	★ 574336	SMT-8M-A-PS-24V-E-5.0-OE
	PNP	–	–	3-pin	0.3	15.9	★ 574337	SMT-8M-A-PS-24V-E-0.3-M12
	NPN	3-wire	–	–	2.5	29.1	★ 574338	SMT-8M-A-NS-24V-E-2.5-OE
		–	3-pin	–	0.3	8.9	★ 574339	SMT-8M-A-NS-24V-E-0.3-M8D
	N/C contact							
	PNP	3-wire	–	–	7.5	85.1	★ 574340	SMT-8M-A-PO-24V-E-7.5-OE

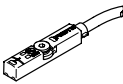
Ordering data								
	Switching output	Electrical connection	Cable with plug, rotatable thread		Cable length	Weight	Part no.	Type
		Cable	M8x1	M12x1	[m]	[g]		
	<b>N/C contact</b>							
	NPN/NO	3-wire, open end	–	–	2.5	29.1	<b>8138000</b>	<b>SMT-8M-A-NO-24V-E-2,5-OE</b>
	NPN/NO	3-wire, open end	–	–	7.5	85.1	<b>8138001</b>	<b>SMT-8M-A-NO-24V-E-7,5-OE</b>
	<b>Switchable</b>							
PNP/NPN	–	3-pin	–	0.3	9	<b>574343</b>	<b>SMT-8M-A-PNS-24V-E-0.3-M8D</b>	
PNP PS/PO	–	3-pin	–	0.3	9	<b>574344</b>	<b>SMT-8M-A-PSO-24V-E-0.3-M8D</b>	

## Ordering data – Modular product system

Ordering table		Conditions	Code	Enter code
Size	8			
Module no.	<b>574333</b>			
Function	Proximity switch for T-slot, electronic		<b>SMT-8M</b>	SMT-8M
			–	–
Series	Short design		<b>A</b>	A
			–	–
Switching output	3-wire PNP N/O contact		<b>PS</b>	
	3-wire NPN N/O contact		<b>NS</b>	
	3-wire PNP N/C contact		<b>PO</b>	
	2-wire PNP N/O contact		<b>ZS</b>	
	PNP / NPN, switchable		<b>PNS</b>	
	PNP N/C contact / N/O contact, switchable		<b>PSO</b>	
	3-wire NPN N/C contact		<b>NO</b>	
			–	–
Rated operating voltage [V DC]	24		<b>24V</b>	24V
			–	–
Cable characteristic	Cable chain + robot		<b>E</b>	E
			–	–
Cable length [m]	0.1 ... 30 (0.1 ... 5.0 in increments of 0.1, 5.0 ... 30 in increments of 0.5)		<b>...</b>	
			–	–
Cable designation	With inscription label holder			
	Without inscription label holder		<b>N</b>	
			–	–
Connection technology	Open end		<b>OE</b>	
	M8, rotatable thread		<b>M8D</b>	
	M8, snap-on flange		<b>M8</b>	
	M12, rotatable thread		<b>M12</b>	
EU certification	II 3GD to EU Directive 2014/34/EU	[1]	<b>-Ex2</b>	

[1] **Ex2** Not with switching output PNS, PSO, minimum cable length 0.2 m

## Accessories

## Mounting kit SMBR

Material:  
Polyacetal  
RoHS-compliant

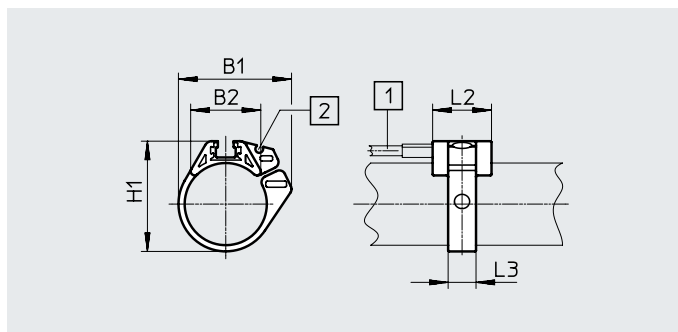

## Dimensions and ordering data

For piston Ø	B1	B2	H1	L2	L3	Part no.	Type
8	18.9	12.3	17.5	19	7	175091	SMBR-8-8
10	20.4	13.7	19.9	19	7	175092	SMBR-8-10
12	22.7	14.3	21.9	19	7	★ 175093	SMBR-8-12
16	28.2	16.9	25.7	19	8	★ 175094	SMBR-8-16
20	34.5	20.8	30.4	19	9	★ 175095	SMBR-8-20
25	36.7	22.7	35.6	19	9	★ 175096	SMBR-8-25
32	41.7	24.6	42.7	19	9	175097	SMBR-8-32
40	47.1	26.5	50.7	19	9	175098	SMBR-8-40
50	56.4	28.6	61.5	19	9	175099	SMBR-8-50
63	69.4	32	74.5	19	9	175100	SMBR-8-63

## Mounting kit CRSMB

Design: for round cylinders  
Type of mounting: bonded using enclosed adhesive tape

Degree of protection: IP65, IP68, IP69K

Ambient temperature: -40 ... +90°C

Material:

Housing: polyurethane

Rail: hard anodised aluminium

Free of copper and PTFE

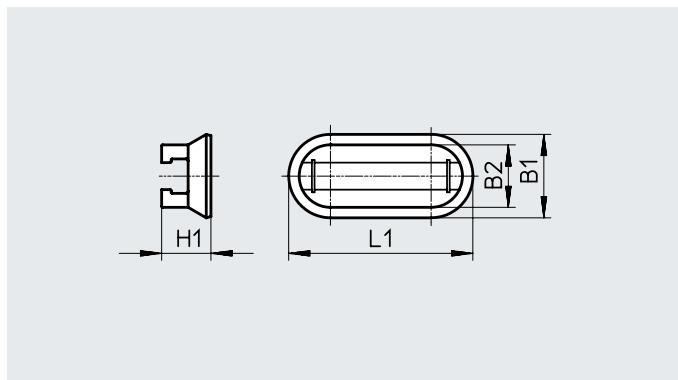

## Ordering data

For piston Ø	B1	B2	H1	L1	CRC <sup>1)</sup>	Part no.	Type
32 ... 100	15.8	11.8	9.3	35	4	525565	CRSMB-8-32/100

1) Corrosion resistance class CRC 4 to Festo standard FN 940070

Particularly high corrosion stress. Outdoor exposure under extreme corrosive conditions. Parts exposed to aggressive media, e.g. in the chemical or food industries. Such applications may need to be safeguarded by means of special testing (→ also FN 940082), using appropriate media.

## Accessories

### Mounting kit SMB-8-FENG

Material:  
Wrought aluminium alloy  
Free of copper and PTFE

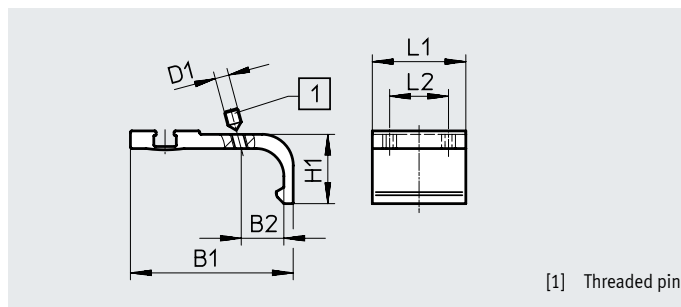
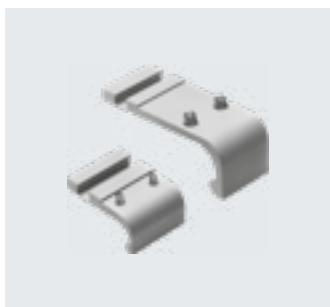

Dimensions and ordering data										
For piston ø	B1	B2	D1	H1	L1	L2	Tightening torque [Nm]	Part no.	Type	
32/40	35.1	8.7	M3	15.5	27	17	0.2	175705	SMB-8-FENG-32/40	
50/63	47	12.3	M4	20	27	17	0.5	175706	SMB-8-FENG-50/63	
80/100	64.3	15.7	M5	24.3	27	17	0.7	175707	SMB-8-FENG-80/100	

### Sensor bracket DASP-M4-...-A

Material:  
Anodised wrought aluminium alloy  
Screws: high-alloy stainless steel  
RoHS-compliant

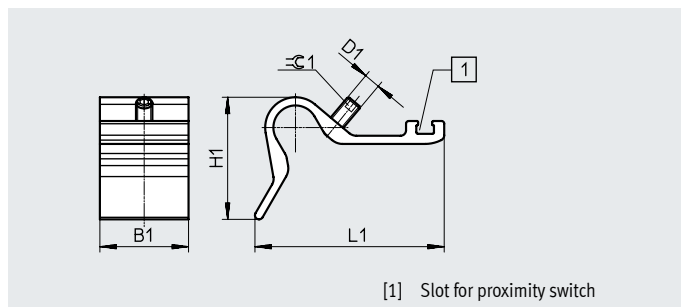

Dimensions and ordering data										
Type	B1	D1	H1	L1	±0.1	Tightening torque [Nm]	CRC <sup>1)</sup>	Weight [g]	Part no.	Type
DASP-M4-125-A	32.5	M5	28	45.4	2.5	1	3	26.5	1451483	DASP-M4-125-A
DASP-M4-160-A	32.5	M6	44.7	69.4	3	1	3	41.5	1553813	DASP-M4-160-A
DASP-M4-250-A	32.5	M6	56.3	88	3	1	3	60	1456781	DASP-M4-250-A
DASP-M4-320-A	32.5	M6	56.3	88	3	1	3	60	3015256	DASP-M4-320-A

1) Corrosion resistance class CRC 3 to Festo standard FN 940070

High corrosion stress. Outdoor exposure under moderate corrosive conditions. Externally visible parts with primarily functional surface requirements which are in direct contact with a normal industrial environment.

Accessories

Mounting kit SMB-8-C

Temperature: -40 ... 120°C  
Material:  
Retaining bracket: anodised wrought aluminium alloy  
Screws: high-alloy stainless steel  
Free of copper and PTFE,  
RoHS-compliant

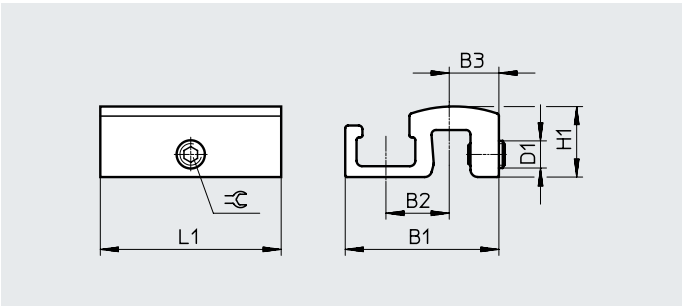

Dimensions and ordering data												
Type	B1	B2	B3	D1	H1	L1	≈ $\varnothing$ 1	Tightening torque [Nm]	CRC <sup>1)</sup>	Weight [g]	Part no.	Type
SMB-8-C	17	7	5.5	M3	7.8	20	1.5	0.2 ... 0.6	3	3.5	1806790	SMB-8-C

1) Corrosion resistance class CRC 3 to Festo standard FN 940070  
High corrosion stress. Outdoor exposure under moderate corrosive conditions. Externally visible parts with primarily functional surface requirements which are in direct contact with a normal industrial environment.

Positioning element SMM

Insertable in the slot lengthwise

Ambient temperature: -40 ... +120°C

Materials:  
Housing: anodised wrought aluminium alloy  
Screws: high-alloy stainless steel  
Note on materials: RoHS-compliant

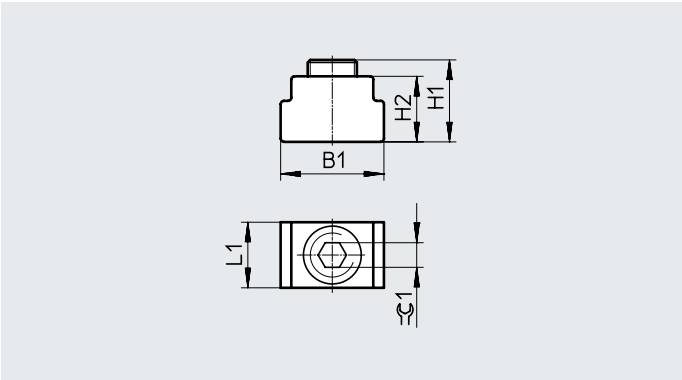





Dimensions and ordering data								
B1	H1	H2	L1	≈ $\varnothing$ 1	CRC <sup>1)</sup>	Part no.	Type	PU <sup>2)</sup>
6.3	5.0	4.0	4.0	1.5	3	547941	SMM-8	10

1) Corrosion resistance class CRC 3 to Festo standard FN 940070  
High corrosion stress. Outdoor exposure under moderate corrosive conditions. Externally visible parts with primarily functional surface requirements which are in direct contact with a normal industrial environment.

2) Packaging unit



## Accessories

Ordering data – Connecting cables			Data sheets → Internet: nebu/sim		
		Number of wires	Cable length [m]	Part no.	Type
Socket M8x1, 3-pin					
	For SMT/SME-8... and SMT0/SMTSO/SME0-8E	3	2.5	★ 541333	NEBU-M8G3-K-2.5-LE3
			5	★ 541334	NEBU-M8G3-K-5-LE3
	For SMT/SME-8... and SMT0/SMTSO/SME0-8E	3	2.5	★ 541338	NEBU-M8W3-K-2.5-LE3
			5	★ 541341	NEBU-M8W3-K-5-LE3
Socket M12x1, 5-pin					
	For SMT/SME-8M and SMT0/SMTSO/SME0-8E	3	2.5	★ 541363	NEBU-M12G5-K-2.5-LE3
			5	★ 541364	NEBU-M12G5-K-5-LE3
	For SMT/SME-8M and SMT0/SMTSO/SME0-8E	3	2.5	541367	NEBU-M12W5-K-2.5-LE3
			5	541370	NEBU-M12W5-K-5-LE3

Ordering data – Safety clip for ATEX zone					
	Size	Description	Part no.	Type	PU <sup>1)</sup>
	M8	<ul style="list-style-type: none"> <li>Protects "equipment that is not intrinsically safe" in zones 2 and 22 against simple disconnection</li> <li>ATEX category: gas: II 3G / dust: II 3D</li> </ul>	548067	NEAU-M8-GD	1
	M12		548068	NEAU-M12-GD	1

1) Packaging unit

Ordering data – Mounting components			
	Description	Part no.	Type
	For fixing connecting cables in place	534254	SMBK-8

Ordering data – Sensor tester			
	Description	Part no.	Type
	<ul style="list-style-type: none"> <li>Testing the functionality of proximity switches using the integrated voltage supply</li> <li>Adjusting proximity switches on the cylinder</li> </ul>	158481	SM-TEST-1

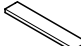
Ordering data – Inscription labels				
	Size	Part no.	Type	PU <sup>1)</sup>
	23x4 mm	541598	ASLR-L-423	34

1) Packaging unit