

Connecting cables for valves, Sub-D socket

Type codes

	K	MP3	-		-		-	
Function								
K	Connecting cable							
Connection technology on the left, field device side								
MP3	Sub-D socket							
Number of pins/wires, left								
9P	9-pin							
25P	25-pin							
Number of pins/wires, right								
08	10							
16	18							
22	24							
Cable length								
5	5 m							
10	10 m							
X	1 ... 99 m							

Connecting cables for valves, Sub-D socket, 9-pin

Technical data

Connecting cable KMP3

- Pre-assembled at one end
- For multi-pin plug connection of valve terminal CPV



Technical data – Electrical connection 1	
Function	Field device side
Connection type	Socket
Cable outlet	Angled
Design type	Square
Connection technology	Sub-D
Number of pins/wires	9
Assigned pins/wires	9
Type of mounting	Via through-hole

Technical data – Electrical connection 2	
Function	Controller side
Connection type	Cable
Connection technology	Open end
Number of pins/wires	10
Assigned pins/wires	9

Technical data – Electrical		
Nominal operating voltage	[V DC]	24
Current rating at 40 °C	[A]	3

Technical data – Cable		
Cable diameter	[mm]	9.5
Cable design	[mm ²]	10x0.34

Materials	
Housing	PA
Seals	NBR
Pin contacts	Gold-plated copper alloy
Cable sheath	PVC
Cable sheath colour	Grey
Note on materials	RoHS-compliant

Operating and environmental conditions		
Ambient temperature	[°C]	-30 ... +80
Ambient temperature with flexible cable installation	[°C]	-5 ... +80
Degree of protection		IP65

Connecting cables for valves, Sub-D socket, 9-pin

Technical data

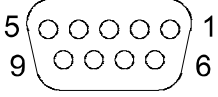
Circuitry (view of socket/plug connector)			
Electrical connection 1	Pin	Wire colour ¹⁾	Electrical connection 2
	1	WH	Open end
	2	GN	Open end
	3	YE	Open end
	4	GY	Open end
	5	PK	Open end
	6	BU	Open end
	7	RD	Open end
	8	VT	Open end
	9	BK	Open end
	-	BN	Open end

1) To IEC 757

Dimensions Download CAD data → www.festo.com

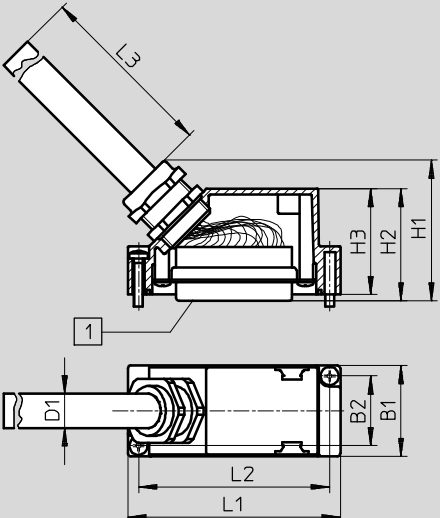

1) Sub-D socket, 9-pin

Type	B1	B2	D1	H1	H2	H3	L1	L2	L3
KMP3-9P-08-5	30	23	9.5	43	37	35	50	43	5000
KMP3-9P-08-10									10000
KMP3-9P-08-X									1000 ... 99000

Ordering data				
Electrical connection	Cable length [m]	Product weight [g]	Part No.	Type
Sub-D socket, 9-pin	5	425	18698	KMP3-9P-08-5
	10	814	18579	KMP3-9P-08-10
	1 ... 99	-	18697	KMP3-9P-08-X

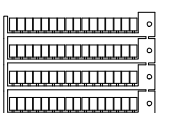
Ordering data – Accessories				
			Part No.	Type
	Inscription labels in frame, pack of 64	6x10 mm	18576	IBS-6x10

Connecting cables for valves, Sub-D socket, 25-pin

Technical data

Connecting cable KMP3

- Pre-assembled at one end
- For multi-pin plug connection of valve terminal CPV

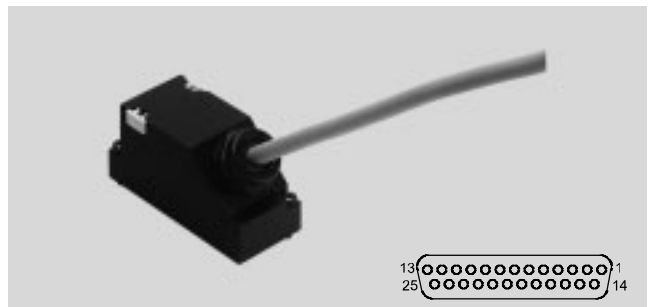

Technical data – Electrical connection 1	
Function	Field device side
Connection type	Socket
Cable outlet	Angled
Design type	Square
Connection technology	Sub-D
Number of pins/wires	25
Type of mounting	Via through-hole

Technical data – Electrical connection 2	
Function	Controller side
Connection type	Cable
Connection technology	Open end

Technical data – Electrical		
Nominal operating voltage	[V DC]	24
Current rating at 40 °C	[A]	3

Technical data – Cable		
Cable diameter	[mm]	12
Cable composition	[mm ²]	18x0.34 24x0.25

Materials	
Housing	PA
Seals	NBR
Pin contacts	Gold-plated copper alloy
Cable sheath	PVC
Cable sheath colour	Grey
Note on materials	RoHS-compliant

Operating and environmental conditions		
Ambient temperature	[°C]	-30 ... +80
Ambient temperature with flexible cable installation	[°C]	-5 ... +80
Degree of protection		IP65

- 7 - Type to be discontinued
Available until 2018

Connecting cables for valves, Sub-D socket, 25-pin

FESTO

Technical data

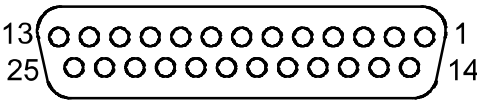
Circuitry (view of socket/plug connector)		Open end, 18-wire		Open end, 24-wire	
Electrical connection 1		Pin	Wire colour ¹⁾	Pin	Wire colour ¹⁾
	1	WH	1	WH	
	2	GN	2	GN	
	3	YE	3	YE	
	4	GY	4	GY	
	5	PK	5	PK	
	6	BU	6	BU	
	7	RD	7	RD	
	8	VT	8	VT	
	9	GY PK	9	GY PK	
	10	RD BU	10	RD BU	
	11	GN WH	11	GN WH	
	12	BN GN	12	BN GN	
	13	YE WH	13	YE WH	
	14	BN YE	14	BN YE	
	15	GY WH	15	GY WH	
	16	BN GY	16	BN GY	
	17	-	17	WH PK	
	18	-	18	BN PK	
	19	-	19	BU WH	
	20	-	20	BN BU	
	21	-	21	RD WH	
	22	-	22	BN RD	
	23	-	23	-	
	24	BN	24	BN	
	25	BK	25	BK	

1) To IEC 757

Dimensions

Download CAD data → www.festo.com

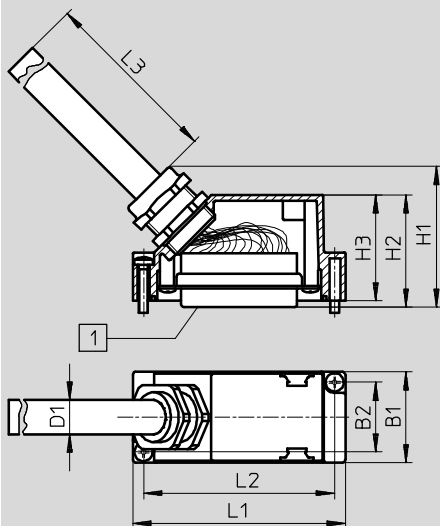

1 Sub-D socket, 25-pin

Type	B1	B2	D1	H1	H2	H3	L1	L2	L3
KMP3-25P-16-5	30	23	12	47	37	35	70	63	5000
KMP3-25P-16-10									10000
KMP3-25P-16-X									1000 ... 99000
KMP3-25P-22-X									1000 ... 99000

- 7 - Type to be discontinued
Available until 2018

FESTO

Connecting cables for valves, Sub-D socket, 25-pin

Technical data

Ordering data					
Electrical connection	Cable composition [mm ²]	Cable length [m]	Product weight [g]	Part No.	Type
Sub-D socket, 25-pin	18x0.34	5	672	18624	KMP3-25P-16-5
		10	1303	18625	KMP3-25P-16-10
		1 ... 99	–	18699	KMP3-25P-16-X
	24x0.25	1 ... 99	–	163971	KMP3-25P-22-X

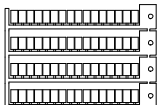
Ordering data – Accessories			Part No.	Type
	Inscription labels in frame, pack of 64	6x10 mm	18576	IBS-6x10