

## Filter regulators LFR-EX4, D series, metal

**FESTO**



# Filter regulators LFR-EX4, D series, metal

Product range overview – Service unit components, D series, metal

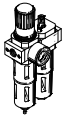
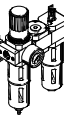
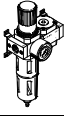
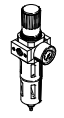
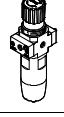
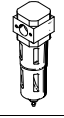
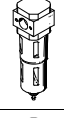
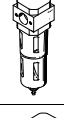
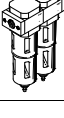
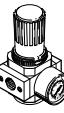
Type code	Size	Pneumatic connection	Pressure regulation range				Grade of filtration				Bowl guard		
			[bar]				[µm]				Metal bowl guard	Plastic bowl	
			0.5 ... 7	0.5 ... 12	2.5 ... 12	0.5 ... 16	0.01	1	5	40			
<b>Service units</b>													
	Micro	M5, M7, G1/8, QS4, QS6	■	-	-	-	-	-	■	-	-	■	
	Mini	G1/8, G1/4, G3/8	■	■	-	-	-	-	■	■	■	-	
	Midi	G1/4, G3/8, G1/2, G3/4	■	■	-	-	-	-	■	■	■	-	
	Maxi	G1/2, G3/4, G1	■	■	-	-	-	-	■	■	■	-	
<b>Service unit combinations</b>													
	Micro	-	-	-	-	-	-	-	-	-	-	-	
	Mini	G1/8, G1/4	-	■	■	-	-	-	-	■	■	-	
	Midi	G1/4, G3/8, G1/2	-	■	■	-	-	-	-	■	■	-	
	Maxi	G1/2, G3/4	-	■	■	-	-	-	-	■	■	-	
	Micro	-	-	-	-	-	-	-	-	-	-	-	
	Mini	G1/8, G1/4	-	■	■	-	-	-	-	■	■	-	
	Midi	G1/4, G3/8, G1/2	-	■	■	-	-	-	-	■	■	-	
	Maxi	G1/2, G3/4	-	■	■	-	-	-	-	■	■	-	
<b>Individual components</b>													
	Micro	M5, M7, G1/8, QS4, QS6	■	-	-	-	-	-	■	-	-	■	
	Mini	G1/8, G1/4, G3/8	■	■	-	-	-	-	■	■	■	-	
	Midi	G1/4, G3/8, G1/2, G3/4	■	■	-	-	-	-	■	■	■	-	
	Maxi	G1/2, G3/4, G1	■	■	-	-	-	-	■	■	■	-	
	Micro	-	-	-	-	-	-	-	-	-	-	-	
	Mini	-	-	-	-	-	-	-	-	-	-	-	
	Midi	G1/4, G1/2, NPT1/4, NPT1/2	-	■	-	■	-	-	■	■	■	-	
	Maxi	-	-	-	-	-	-	-	-	-	-	-	
	Micro	M5, M7, G1/8, QS4, QS6	-	-	-	-	-	-	■	-	-	■	
	Mini	G1/8, G1/4, G3/8	-	-	-	-	-	-	■	■	■	-	
	Midi	G1/4, G3/8, G1/2, G3/4	-	-	-	-	-	-	■	■	■	-	
	Maxi	G1/2, G3/4, G1	-	-	-	-	-	-	■	■	■	-	
	Micro	-	-	-	-	-	-	■	■	-	-	-	
	Mini	G1/8, G1/4, G3/8	-	-	-	-	-	■	■	-	-	■	-
	Midi	G1/4, G3/8, G1/2, G3/4	-	-	-	-	-	■	■	-	-	■	-
	Maxi	G1/2, G3/4, G1	-	-	-	-	-	■	■	-	-	■	-
	Micro	-	-	-	-	-	-	-	-	-	-	-	
	Mini	G1/8, G1/4, G3/8	-	-	-	-	-	-	-	-	-	■	-
	Midi	G1/4, G3/8, G1/2, G3/4	-	-	-	-	-	-	-	-	-	■	-
	Maxi	G1/2, G3/4, G1	-	-	-	-	-	-	-	-	-	■	-
	Micro	-	-	-	-	-	-	■	■	-	-	■	-
	Mini	G1/8, G1/4, G3/8	-	-	-	-	-	■	■	-	-	■	-
	Midi	G1/4, G3/8, G1/2, G3/4	-	-	-	-	-	■	■	-	-	■	-
	Maxi	G1/2, G3/4, G1	-	-	-	-	-	■	■	-	-	■	-
	Micro	M5, M7, G1/8, QS4, QS6	■	-	-	-	-	-	-	-	-	-	-
	Mini	G1/8, G1/4, G3/8	■	■	-	-	-	-	-	-	-	-	-
	Midi	G1/4, G3/8, G1/2, G3/4	■	■	-	-	-	-	-	-	-	-	-
	Maxi	G1/2, G3/4, G1	■	■	-	-	-	-	-	-	-	-	-



# Filter regulators LFR-EX4, D series, metal

Product range overview – Service unit components, D series, metal

Type code	Size	Condensate drain			Pressure indication		Actuator lock		Options			EU certification	→ Page/ Internet
		Manual rotary	Semi-automatic	Fully automatic	With pressure gauge	Without pressure gauge	Rotary knob with detent	Rotary knob with integrated lock	Directly actuated pressure regulator with integrated return flow function	Pilot actuated pressure regulator with integrated return flow function	Differential pressure indicator		
<b>Service units</b>													
FRC/FRCS	Micro	■	■	-	■	■	■	-	-	-	-	-	frc
	Mini	■	-	■	■	■	■	■	-	-	-	-	
	Midi	■	-	■	■	■	■	■	-	-	-	-	
	Maxi	■	-	■	■	■	■	■	■	■	-	-	
<b>Service unit combinations</b>													
FRC-K	Micro	-	-	-	-	-	-	-	-	-	-	-	frc
	Mini	■	-	■	■	-	■	-	-	-	-	-	
	Midi	■	-	■	■	-	■	-	-	-	-	-	
	Maxi	■	-	■	■	-	■	-	■	■	-	-	
LFR-K LFRS-K	Micro	-	-	-	-	-	-	-	-	-	-	-	lfr
	Mini	■	-	■	■	-	■	■	-	-	-	-	
	Midi	■	-	■	■	-	■	■	-	-	-	-	
	Maxi	■	-	■	■	-	■	■	■	■	-	-	
<b>Individual components</b>													
Filter regulators LFR/LFRS	Micro	■	■	-	■	■	■	-	-	-	-	-	lfr
	Mini	■	-	■	■	■	■	■	-	-	-	-	
	Midi	■	-	■	■	■	■	■	-	-	-	-	
	Maxi	■	-	■	■	■	■	■	■	■	-	-	
Filter regulators LFR-EX4	Micro	-	-	-	-	-	-	-	-	-	-	-	6
	Mini	-	-	-	-	-	-	-	-	-	-	-	
	Midi	■	-	-	-	■	■	-	-	-	-	■	
	Maxi	-	-	-	-	-	-	-	-	-	-	-	
Filters LF	Micro	■	■	-	-	-	-	-	-	-	-	-	lf
	Mini	■	-	■	-	-	-	-	-	-	-	-	
	Midi	■	-	■	-	-	-	-	-	-	-	-	
	Maxi	■	-	■	-	-	-	-	-	-	-	-	
Fine and micro filters LFMA/LFMB	Micro	-	-	-	-	-	-	-	-	-	-	-	lfma, lfmb
	Mini	■	-	■	-	-	-	-	-	-	■	-	
	Midi	■	-	■	-	-	-	-	-	-	■	-	
	Maxi	■	-	■	-	-	-	-	-	-	■	-	
Activated carbon filters LFX	Micro	-	-	-	-	-	-	-	-	-	-	-	lfx
	Mini	-	-	-	-	-	-	-	-	-	-	-	
	Midi	-	-	-	-	-	-	-	-	-	-	-	
	Maxi	-	-	-	-	-	-	-	-	-	-	-	
Filter combinations LFMBA	Micro	-	-	-	-	-	-	-	-	-	-	-	lfmba
	Mini	■	-	■	-	-	-	-	-	-	■	-	
	Midi	■	-	■	-	-	-	-	-	-	■	-	
	Maxi	■	-	■	-	-	-	-	-	-	■	-	
Pressure regulators LR/LRS	Micro	-	-	-	■	■	■	-	-	-	-	-	lrr
	Mini	-	-	-	■	■	■	■	■	-	-	-	
	Midi	-	-	-	■	■	■	■	■	-	-	-	
	Maxi	-	-	-	■	■	■	■	■	■	-	-	

## Filter regulators LFR-EX4, D series, metal

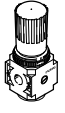
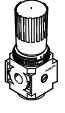
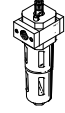
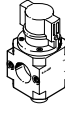
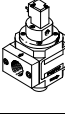
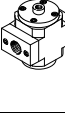
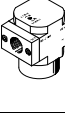
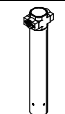
Product range overview – Service unit components, D series, metal

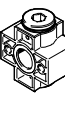
Type code	Size	Pneumatic connection	Pressure regulation range		Bowl guard		
			[bar]				
			0.5	0.5	Metal bowl guard	Plastic bowl	
			...	...			
			7	12			
<b>Individual components</b>							
Pressure regulators <b>LRB/LRBS</b>		Micro	–				
		Mini	G <sup>1</sup> / <sub>4</sub>	■	■	–	–
		Midi	G <sup>3</sup> / <sub>8</sub>	■	■	–	–
		Maxi	–				
Pressure regulator manifolds <b>LRB-K</b>		Micro	–				
		Mini	G <sup>1</sup> / <sub>4</sub> , G <sup>3</sup> / <sub>8</sub>	■	■	–	–
		Midi	G <sup>3</sup> / <sub>8</sub> , G <sup>1</sup> / <sub>2</sub>	■	■	–	–
		Maxi	–				
Lubricators <b>LOE</b>		Micro	M5, M7, G <sup>1</sup> / <sub>8</sub> , QS4, QS6	–	–	–	■
		Mini	G <sup>1</sup> / <sub>8</sub> , G <sup>1</sup> / <sub>4</sub> , G <sup>3</sup> / <sub>8</sub>	–	–	■	–
		Midi	G <sup>1</sup> / <sub>4</sub> , G <sup>3</sup> / <sub>8</sub> , G <sup>1</sup> / <sub>2</sub> , G <sup>3</sup> / <sub>4</sub>	–	–	■	–
		Maxi	G <sup>1</sup> / <sub>2</sub> , G <sup>3</sup> / <sub>4</sub> , G1	–	–	■	–
On/off valves <b>HE</b>		Micro	–				
		Mini	G <sup>1</sup> / <sub>8</sub> , G <sup>1</sup> / <sub>4</sub> , G <sup>3</sup> / <sub>8</sub>	–	–	–	–
		Midi	G <sup>1</sup> / <sub>4</sub> , G <sup>3</sup> / <sub>8</sub> , G <sup>1</sup> / <sub>2</sub> , G <sup>3</sup> / <sub>4</sub>	–	–	–	–
		Maxi	G <sup>1</sup> / <sub>2</sub> , G <sup>3</sup> / <sub>4</sub> , G1	–	–	–	–
On/off valves <b>HEE</b>		Micro	–				
		Mini	G <sup>1</sup> / <sub>8</sub> , G <sup>1</sup> / <sub>4</sub> , G <sup>3</sup> / <sub>8</sub>	–	–	–	–
		Midi	G <sup>1</sup> / <sub>4</sub> , G <sup>3</sup> / <sub>8</sub> , G <sup>1</sup> / <sub>2</sub> , G <sup>3</sup> / <sub>4</sub>	–	–	–	–
		Maxi	G <sup>1</sup> / <sub>2</sub> , G <sup>3</sup> / <sub>4</sub> , G1	–	–	–	–
On/off valves <b>HEP</b>		Micro	–				
		Mini	G <sup>1</sup> / <sub>8</sub> , G <sup>1</sup> / <sub>4</sub> , G <sup>3</sup> / <sub>8</sub>	–	–	–	–
		Midi	G <sup>1</sup> / <sub>4</sub> , G <sup>3</sup> / <sub>8</sub> , G <sup>1</sup> / <sub>2</sub> , G <sup>3</sup> / <sub>4</sub>	–	–	–	–
		Maxi	G <sup>1</sup> / <sub>2</sub> , G <sup>3</sup> / <sub>4</sub> , G1	–	–	–	–
Soft-start valves <b>HEL</b>		Micro	–				
		Mini	G <sup>1</sup> / <sub>8</sub> , G <sup>1</sup> / <sub>4</sub> , G <sup>3</sup> / <sub>8</sub>	–	–	–	–
		Midi	G <sup>1</sup> / <sub>4</sub> , G <sup>3</sup> / <sub>8</sub> , G <sup>1</sup> / <sub>2</sub> , G <sup>3</sup> / <sub>4</sub>	–	–	–	–
		Maxi	G <sup>1</sup> / <sub>2</sub> , G <sup>3</sup> / <sub>4</sub> , G1	–	–	–	–
Membrane air dryers <b>LDM1</b>		Micro	–				
		Mini	–				
		Midi	–				
		Maxi	G <sup>1</sup> / <sub>2</sub> , G <sup>3</sup> / <sub>4</sub> , G1	–	–	■	–
Branching modules <b>FRM</b>		Micro	–				
		Mini	G <sup>1</sup> / <sub>8</sub> , G <sup>1</sup> / <sub>4</sub> , G <sup>3</sup> / <sub>8</sub>	–	–	–	–
		Midi	G <sup>1</sup> / <sub>4</sub> , G <sup>3</sup> / <sub>8</sub> , G <sup>1</sup> / <sub>2</sub> , G <sup>3</sup> / <sub>4</sub>	–	–	–	–
		Maxi	G <sup>1</sup> / <sub>2</sub> , G <sup>3</sup> / <sub>4</sub> , G1	–	–	–	–
Distributor block <b>FRZ</b>		Micro	–				
		Mini	–				
		Midi	–				
		Maxi	–				

## Filter regulators LFR-EX4, D series, metal

Product range overview – Service unit components, D series, metal

Type code	Size	Pressure indication		Actuator lock		Supply voltage			Options		→ Page/ Internet
		With pressure gauge	Without pressure gauge	Rotary knob with detent	Rotary knob with integrated lock	24 V DC	110 V AC	230 V AC	Non-return function	Pressure switch	
<b>Individual components</b>											
Pressure regulators <b>LRB/LRBS</b>	Micro	-				-	-	-	-	-	lrb
	Mini	-	■	■	■	-	-	-	-	-	
	Midi	-	■	■	■	-	-	-	-	-	
	Maxi	-				-	-	-	-	-	
Pressure regulator manifolds <b>LRB-K</b>	Micro	-				-	-	-	-	-	lrb
	Mini	-	■	■	-	-	-	-	-	-	
	Midi	-	■	■	-	-	-	-	-	-	
	Maxi	-				-	-	-	-	-	
Lubricators <b>LOE</b>	Micro	-	■	-	-	-	-	-	-	-	loe
	Mini	-	■	-	-	-	-	-	-	-	
	Midi	-	■	-	-	-	-	-	-	-	
	Maxi	-	■	-	-	-	-	-	-	-	
On/off valves <b>HE</b>	Micro	-				-	-	-	-	-	he
	Mini	-	■	■	-	-	-	-	-	-	
	Midi	-	■	■	-	-	-	-	-	-	
	Maxi	-	■	■	-	-	-	-	-	-	
On/off valves <b>HEE</b>	Micro	-				-	-	-	-	-	hee
	Mini	-	■	-	-	■	■	■	-	-	
	Midi	-	■	-	-	■	■	■	-	-	
	Maxi	-	■	-	-	■	■	■	-	-	
On/off valves <b>HEP</b>	Micro	-				-	-	-	-	-	hep
	Mini	-	■	-	-	-	-	-	-	-	
	Midi	-	■	-	-	-	-	-	-	-	
	Maxi	-	■	-	-	-	-	-	-	-	
Soft-start valves <b>HEL</b>	Micro	-				-	-	-	-	-	hel
	Mini	-	■	-	-	-	-	-	-	-	
	Midi	-	■	-	-	-	-	-	-	-	
	Maxi	-	■	-	-	-	-	-	-	-	
Membrane air dryers <b>LDM1</b>	Micro	-				-	-	-	-	-	ldm1
	Mini	-				-	-	-	-	-	
	Midi	-				-	-	-	-	-	
	Maxi	-	■	-	-	-	-	-	-	-	
Branching modules <b>FRM</b>	Micro	-				-	-	-	■	■	frm
	Mini	-	■	-	-	-	-	-	■	■	
	Midi	-	■	-	-	-	-	-	■	■	
	Maxi	-	■	-	-	-	-	-	■	■	
Distributor block <b>FRZ</b>	Micro	-	■	-	-	-	-	-	-	-	frz
	Mini	-	■	-	-	-	-	-	-	-	
	Midi	-	■	-	-	-	-	-	-	-	
	Maxi	-	■	-	-	-	-	-	-	-	

# Filter regulators LFR-EX4, D series, metal

Peripherals overview

**Midi**

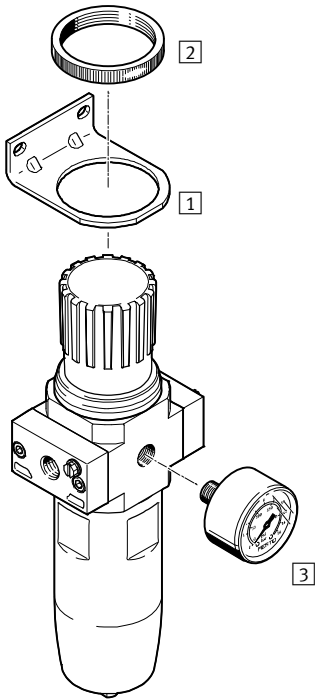

Mounting components and accessories		→ Page/Internet
1	Mounting bracket HR-D-R3	12
2	Knurled nut (included in the delivery) HMR	-
3	Pressure gauge MA	12

# Filter regulators LFR-EX4, D series, metal

Type codes

LFR - 1/2 - D - 16 - 5M - 0 - MIDI - T3 - EX4

**Basic function**

LFR	Filter regulator
-----	------------------

**Pneumatic connection**

1/4	Connecting plates with G1/4 threaded connection
1/2	Connecting plates with G1/2 threaded connection
N1/4	Connecting plates with NPT1/4 threaded connection
N1/2	Connecting plates with NPT1/2 threaded connection

**Series**

D	Series
---	--------

**Pressure regulation range**

	0.5 ... 12 bar
16	0.5 ... 16 bar

**Grade of filtration**

	40 µm
5M	5 µm

**Pressure gauge**

0	Without pressure gauge
---	------------------------

**Size**

MIDI	Grid dimension 55 mm (without connecting plates)
------	--

**Temperature range [°C]**

T18	-20 ... +80
T3	-40 ... +80

**EU certification**



EX4	ATEX II 2GD
-----	-------------

# Filter regulators LFR-EX4, D series, metal

Technical data

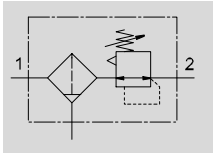
Function



-  - Flow rate  
1150 ... 3400 l/min
-  - Temperature range  
-40 ... +80 °C
-  - Operating pressure  
1 ... 20 bar



- Space-saving design with filter and regulator in a single unit
- Good particle separation and high flow rate
- Good regulation characteristics with minimal hysteresis
- Robust housing for the specific requirements of the process automation industry
- Suitable for use outdoors and at temperatures down to -40 °C
- Resistant to UV radiation and corrosive environments
- Two pressure regulation ranges: 0.5 ... 12 bar and 0.5 ... 16 bar
- Two pressure gauge connections for flexible installation
- Set values are secured by the detent on the rotary knob
- Suitable for use in potentially explosive environments in zones 1 and 21
- New filter cartridges → 12

General technical data				
Size	Midi			
Pneumatic connection 1, 2 <sup>1)</sup>	G $\frac{1}{4}$	G $\frac{1}{2}$	NPT $\frac{1}{4}$ -18	NPT $\frac{1}{2}$ -14
Design	Filter regulator without pressure gauge			
Type of mounting	Via accessories In-line installation			
Mounting position	Vertical $\pm 5^\circ$			
Grade of filtration [ $\mu\text{m}$ ]	5 40			
Air quality class at the outlet	Compressed air to ISO 8573-1:2010 [6:8:4] (grade of filtration 5 $\mu\text{m}$ ) Compressed air to ISO 8573-1:2010 [7:8:4] (grade of filtration 40 $\mu\text{m}$ ) Inert gases			
Bowl guard	Integrated as metal bowl guard			
Condensate drain	Manual rotary			
Actuator lock	Rotary knob with detent			
Pressure regulation range [bar]	0.5 ... 12 0.5 ... 16 (0.5 ... 12 in the temperature range +60 ... +80 °C)			
Max. pressure hysteresis [bar]	0.2			
Pressure indication	G $\frac{1}{4}$ prepared			
Max. condensate volume [ $\text{cm}^3$ ]	42			

1) Connecting plates with female thread

Standard nominal flow rate $q_{nN}^{1)}$ [l/min]					
Type	LFR-...-T18		LFR-...-T3		
Pneumatic connection 1, 2	G $\frac{1}{4}$ , NPT $\frac{1}{4}$ -18	G $\frac{1}{2}$ , NPT $\frac{1}{2}$ -14	G $\frac{1}{4}$ , NPT $\frac{1}{4}$ -18	G $\frac{1}{2}$ , NPT $\frac{1}{2}$ -14	
Pressure regulation range 0.5 ... 12 bar					
Grade of filtration	40 $\mu\text{m}$	2000	3400	2000	3400
	5 $\mu\text{m}$	1600	2600	1600	2600
Pressure regulation range 0.5 ... 16 bar					
Grade of filtration	40 $\mu\text{m}$	1475	1970	1190	1760
	5 $\mu\text{m}$	1370	1665	1150	1660

1) Measured at  $p_1 = 10 \text{ bar}$ ,  $p_2 = 6 \text{ bar}$  and  $\Delta p = 1 \text{ bar}$ .



## Filter regulators LFR-EX4, D series, metal

Technical data

Operating and environmental conditions		
Type	LFR-...-T18	LFR-...-T3
Operating pressure [bar]	1 ... 20	
Operating medium	Compressed air according to ISO 8573-1:2010 [--:9:--]	
	Inert gases	
Ambient temperature [°C]	-20 ... +80	-40 ... +80
Temperature of medium [°C]	-20 ... +80	-40 ... +80
Storage temperature [°C]	-20 ... +80	-40 ... +80
Corrosion resistance class CRC <sup>1)</sup>	3	

1) Corrosion resistance class CRC 3 to Festo standard FN 940070

High corrosion stress. Outdoor exposure under moderate corrosive conditions. External visible parts with primarily functional requirements for the surface and which are in direct contact with a normal industrial environment.

ATEX		
Type code	LFR-...-T18-EX4	LFR-...-T3-EX4
ATEX category for gas	II 2G	
Type of ignition protection for gas	c TX X	
ATEX category for dust	II 2D	
Type of ignition protection for dust	c TX X	
Explosion-proof temperature	-20 °C ≤ Ta ≤ +80 °C	-40 °C ≤ Ta ≤ +80 °C
CE marking (see declaration of conformity)	To EU Explosion Protection Directive (ATEX)	

Weight [g]	
Size	Midi
Filter regulator LFR-...-EX4	1400

Materials	
Housing	Die-cast zinc
Connecting plates	Die-cast zinc/aluminium
Regulating knob	POM
Knurled nut	Aluminium
Bowl	Wrought aluminium alloy
Seals	NBR
Note on materials	RoHS-compliant

# Filter regulators LFR-EX4, D series, metal

Technical data

**Dimensions**

Download CAD data → [www.festo.com](http://www.festo.com)

Midi

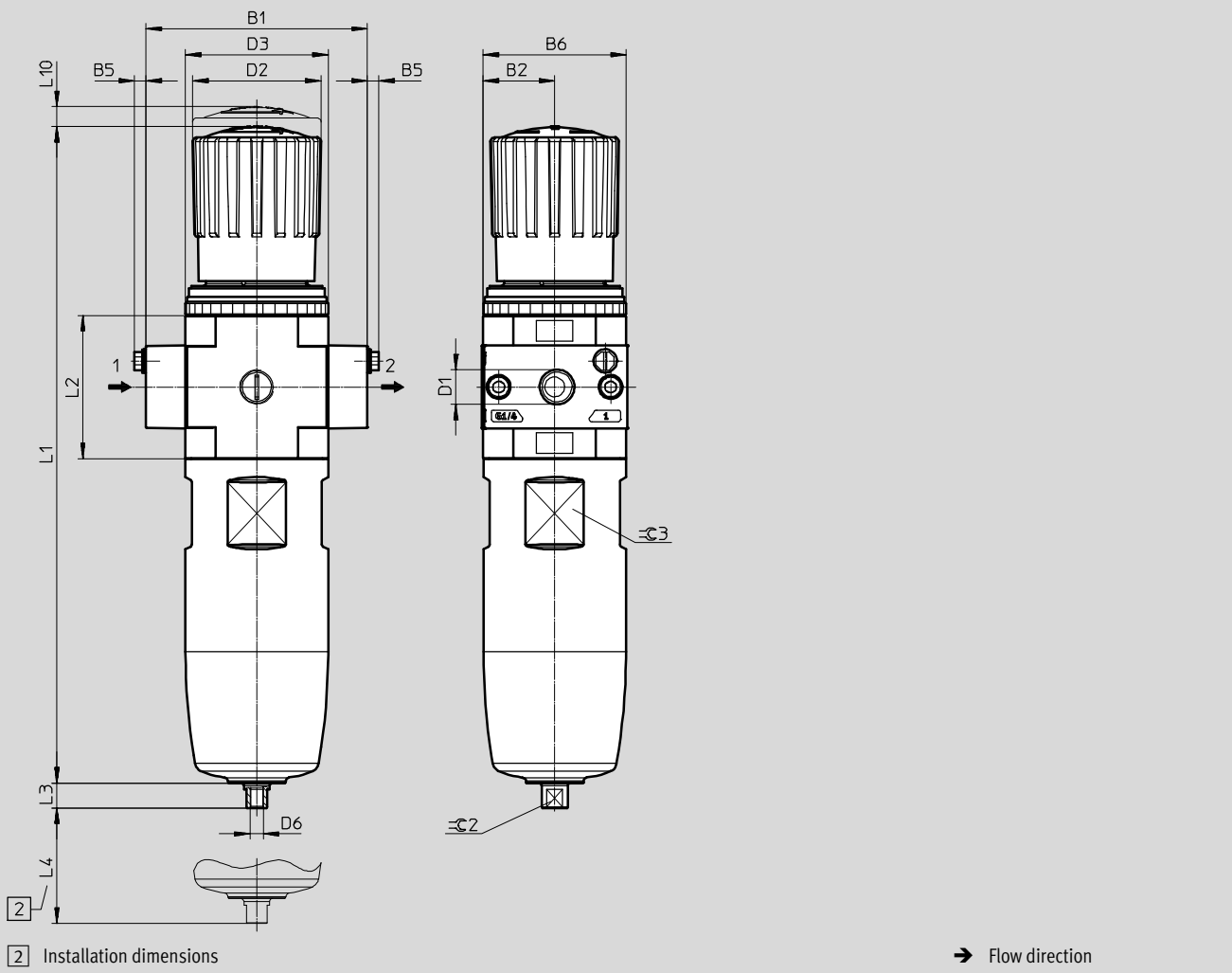

Type code	B1	B2	B5	B6	D1	D2 Ø	D3	D6
LFR-1/4-...-MIDI	85	27.5	~4.5	55	G $\frac{1}{4}$	49	M52x1.5	M5
LFR-1/2-...-MIDI					G $\frac{1}{2}$			
LFR-N1/4-...-MIDI					NPT $\frac{1}{4}$ -18			
LFR-N1/2-...-MIDI					NPT $\frac{1}{2}$ -14			

Type code	L1	L2	L3	L4 min.	L10	⌀ 2	⌀ 3
LFR-1/4-...-MIDI	252.5	55	9.5	80	2.5	8	50
LFR-1/2-...-MIDI							
LFR-N1/4-...-MIDI							
LFR-N1/2-...-MIDI							

◆ Note: This product conforms to ISO 1179-1 and to ISO 228-1

# Filter regulators LFR-EX4, D series, metal

Technical data

**Dimensions – Accessories**

Download CAD data → [www.festo.com](http://www.festo.com)

Using mounting bracket HR-D-R3

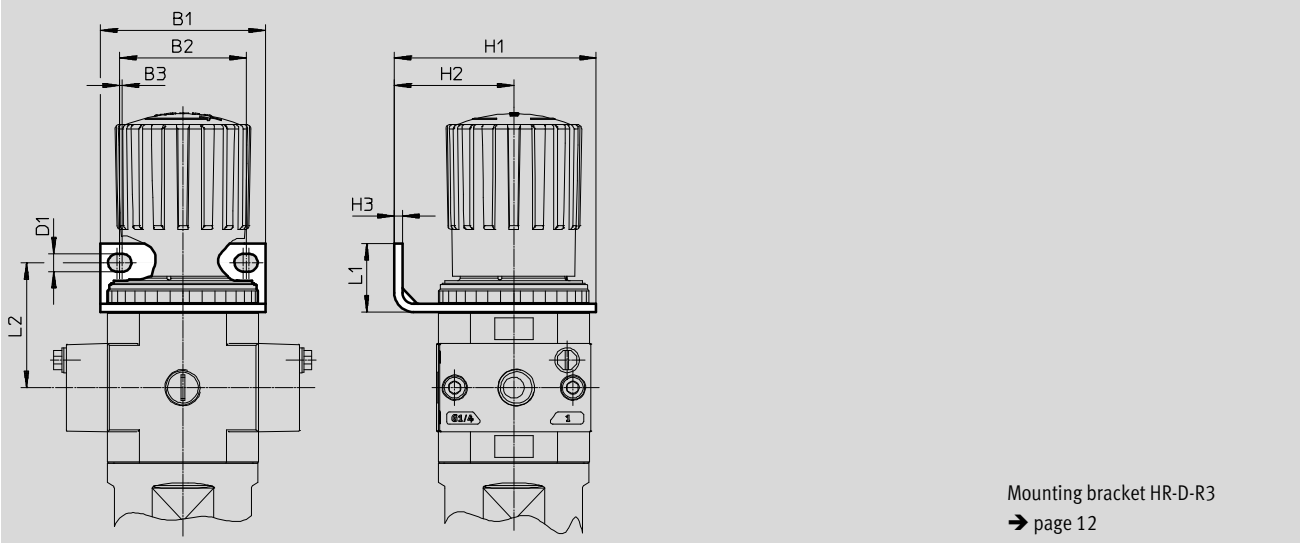

Mounting bracket HR-D-R3  
→ page 12

B1	B2	B3	D1	H1	H2	H3	L1	L2
60	46	1	6.5	73.5	43.5	3	25	45.5

**Ordering data**

Temperature range –20 ... +80 °C, rotary knob with detent, connecting plates with threaded connection

Size	Connection	Grade of filtration 5 µm		Grade of filtration 40 µm	
		Part No.	Type code	Part No.	Type code
Pressure regulation range 0.5 ... 12 bar					
Midi	G1/4	4772764	LFR-1/4-D-5M-O-MIDI-T18-EX4	4772765	LFR-1/4-D-O-MIDI-T18-EX4
	G1/2	4772768	LFR-1/2-D-5M-O-MIDI-T18-EX4	4772769	LFR-1/2-D-O-MIDI-T18-EX4
	NPT1/4-18	4772772	LFR-N1/4-D-5M-O-MIDI-T18-EX4	4772773	LFR-N1/4-D-O-MIDI-T18-EX4
	NPT1/2-14	4772776	LFR-N1/2-D-5M-O-MIDI-T18-EX4	4772777	LFR-N1/2-D-O-MIDI-T18-EX4
Pressure regulation range 0.5 ... 16 bar					
Midi	G1/4	4772766	LFR-1/4-D-16-5M-O-MIDI-T18-EX4	4772767	LFR-1/4-D-16-O-MIDI-T18-EX4
	G1/2	4772770	LFR-1/2-D-16-5M-O-MIDI-T18-EX4	4772771	LFR-1/2-D-16-O-MIDI-T18-EX4
	NPT1/4-18	4772774	LFR-N1/4-D-16-5M-O-MIDI-T18-EX4	4772775	LFR-N1/4-D-16-O-MIDI-T18-EX4
	NPT1/2-14	4772778	LFR-N1/2-D-16-5M-O-MIDI-T18-EX4	4772779	LFR-N1/2-D-16-O-MIDI-T18-EX4

**Ordering data**

Temperature range –40 ... +80 °C, rotary knob with detent, connecting plates with threaded connection

Size	Connection	Grade of filtration 5 µm		Grade of filtration 40 µm	
		Part No.	Type code	Part No.	Type code
Pressure regulation range 0.5 ... 12 bar					
Midi	G1/4	5271792	LFR-1/4-D-5M-O-MIDI-T3-EX4	5271793	LFR-1/4-D-O-MIDI-T3-EX4
	G1/2	5271796	LFR-1/2-D-5M-O-MIDI-T3-EX4	5271797	LFR-1/2-D-O-MIDI-T3-EX4
	NPT1/4-18	5271800	LFR-N1/4-D-5M-O-MIDI-T3-EX4	5271801	LFR-N1/4-D-O-MIDI-T3-EX4
	NPT1/2-14	5271804	LFR-N1/2-D-5M-O-MIDI-T3-EX4	5271805	LFR-N1/2-D-O-MIDI-T3-EX4
Pressure regulation range 0.5 ... 16 bar					
Midi	G1/4	5271794	LFR-1/4-D-16-5M-O-MIDI-T3-EX4	5271795	LFR-1/4-D-16-O-MIDI-T3-EX4
	G1/2	5271798	LFR-1/2-D-16-5M-O-MIDI-T3-EX4	5271799	LFR-1/2-D-16-O-MIDI-T3-EX4
	NPT1/4-18	5271802	LFR-N1/4-D-16-5M-O-MIDI-T3-EX4	5271803	LFR-N1/4-D-16-O-MIDI-T3-EX4
	NPT1/2-14	5271806	LFR-N1/2-D-16-5M-O-MIDI-T3-EX4	5271807	LFR-N1/2-D-16-O-MIDI-T3-EX4

## Filter regulators LFR-EX4, D series, metal

Accessories

### Mounting bracket HR-D-R3

- For wall mounting an individual component

Materials:  
Steel

Note on materials:  
RoHS-compliant

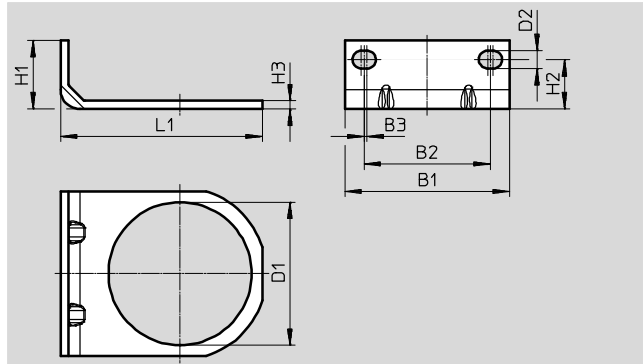

Dimensions								
B1	B2	B3	D1	D2	H1	H2	H3	L1
60	46	1	52.1	6.5	25	18	3	73.5

Ordering data				
Size	CRC <sup>1)</sup>	Weight [g]	Part No.	Type code
Midi	3	73	<b>4650310</b>	<b>HR-D-R3</b>

1) Corrosion resistance class CRC 3 to Festo standard FN 940070  
High corrosion stress. Outdoor exposure under moderate corrosive conditions. External visible parts with primarily functional requirements for the surface and which are in direct contact with a normal industrial environment.

### Filter cartridges, D series, metal design



Ordering data			
Size	Grade of filtration [µm]	Part No.	Type code
Midi	5 (colour: blue)	<b>159594</b>	<b>LFP-D-MIDI-5M</b>
	40 (colour: white)	<b>363667</b>	<b>LFP-D-MIDI-40M</b>

Ordering data – Pressure gauge MA				Technical data → Internet: ma		
	Nominal size	Pneumatic connection	Display range		Part No.	Type code
			[bar]	[psi]		
DIN EN 837-1						
	40	G1/4	0 ... 16	0 ... 230	<b>183901</b>	<b>MA-40-16-G1/4-EN</b>
			0 ... 25	0 ... 360	<b>183902</b>	<b>MA-40-25-G1/4-EN</b>