



Hand slide valves W/VBOH



# Hand slide valves W/VBOH

Product range overview



Version	Valve function	Version	Type	Pneumatic connection 1	Pneumatic connection 2	qnN [l/min]	→ Page/ Internet
Hand slide valves	3/2-way, bi-stable		W	M5, G1/8, G1/4, G3/8, G1/2, G3/4	M5, G1/8, G1/4, G3/8, G1/2, G3/4	120 ... 6,800	3
			VBOH	M5, G1/8, G1/4, G3/8, G1/2, G3/4	M5, G1/8, G1/4, G3/8, G1/2, G3/4	236 ... 7,691	5

# Hand slide valves W

Technical data

FESTO

Function

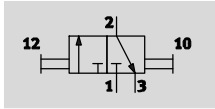

- - Standard nominal flow rate  
120 ... 6,800 l/min
- - Temperature range  
-10 ... +60 °C
- - Operating pressure  
-0.95 ... +10 bar



General technical data						
Pneumatic connection 1	M5	G1/8	G1/4	G3/8	G1/2	G3/4
Pneumatic connection 2	M5	G1/8	G1/4	G3/8	G1/2	G3/4
Nominal size [mm]	2.5	3	7	9	12	18
Design	Sleeve valve					
Valve function	3/2-way, bi-stable					
Actuation type	Manual					
Actuating force [N]	10	10	20	20	20	30
Type of mounting	Screw-in In-line installation					
Mounting position	Any					
Sealing principle	Soft					
Type of control	Direct					
Direction of flow	Reversible					

Flow rate characteristics						
Pneumatic connection 1	M5	G1/8	G1/4	G3/8	G1/2	G3/4
Standard nominal flow rate $q_{nN}^{1)}$ [l/min]	120	600	1,000	1,400	2,000	6,800

1) Measured at  $p_1 = 6$  bar and  $p_2 = 5$  bar,  $\Delta p = 1$  bar

Operating and environmental conditions						
Pneumatic connection 1	M5	G1/8	G1/4	G3/8	G1/2	G3/4
Operating pressure [bar]	-0.95 ... +8	-0.95 ... +10				
Operating medium	Compressed air in accordance with ISO 8573-1:2010 [7:4:4]					
Note on operating/pilot medium	Operation with lubricated medium possible (in which case lubricated operation will always be required)					
Ambient temperature [°C]	-10 ... +60					
Temperature of medium [°C]	-10 ... +60					

## Materials

Sectional view

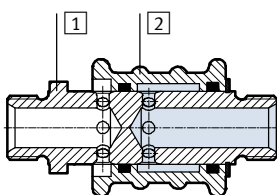

Hand slide valve	
1	Threaded plug Anodised wrought aluminium alloy
2	Housing Brass
-	Seals NBR
Note on materials RoHS-compliant	

# Hand slide valves W

Technical data

FESTO

## Dimensions

Download CAD data → [www.festo.com](http://www.festo.com)

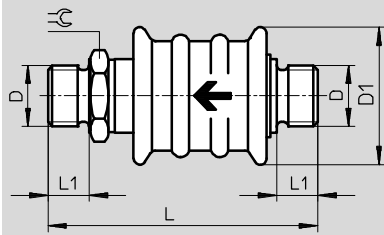

← Flow direction

Type	Connection D	D1 Ø	L	L1	⊘
W-3-M5	M5	20	46.4	5.0	9
W-3-1/8	G1/8	24	51.3	6.5	14
W-3-1/4	G1/4	35	70.4	8.0	17
W-3-3/8	G3/8	45	79.4	9.0	27
W-3-1/2	G1/2	45	82.4	10.5	27
W-3-3/4	G3/4	50	99.0	12.0	32

## Ordering data

	Pneumatic connection		Standard nominal flow rate qnN [l/min]	Weight [g]	Part No.	Type
	1	2				
	M5	M5	120	25	4451	W-3-M5
	G1/8	G1/8	600	40	2339	W-3-1/8
	G1/4	G1/4	1,000	110	2340	W-3-1/4
	G3/8	G3/8	1,400	280	2341	W-3-3/8
	G1/2	G1/2	2,000	300	2342	W-3-1/2
	G3/4	G3/4	6,800	400	4052	W-3-3/4

# Hand slide valves VBOH

## Technical data

### Function

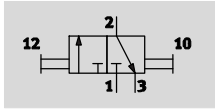

- Standard nominal flow rate  
236 ... 7,691 l/min
- Temperature range  
-10 ... +80 °C
- Operating pressure  
-0.95 ... +12 bar



Hand slide valves VBOH are used as a shut-off function for pressurising and exhausting compressed air systems,

for example upstream of service unit combinations, for air guns and also for exhausting pneumatic cylinders.

- Non-overlapping, so no pressure losses when switching
- Minimal installation
- High flow rate and operating pressure
- Exclusive design

General technical data							
Pneumatic connection 1	M5	G $\frac{1}{8}$	G $\frac{1}{4}$	G $\frac{3}{8}$	G $\frac{1}{2}$	G $\frac{3}{4}$	
Pneumatic connection 2	M5	G $\frac{1}{8}$	G $\frac{1}{4}$	G $\frac{3}{8}$	G $\frac{1}{2}$	G $\frac{3}{4}$	
Grid dimension [mm]	17	24	31	39.5	45	57.5	
Nominal size [mm]	3.6	5.7	8.4	9.9	12.1	19.3	
Design	Sleeve valve						
Valve function	3/2-way, double solenoid						
Actuation type	Manual						
Actuating force [N]	14	17	45	41	37	70	
Type of mounting	Screw-in						
	In-line installation						
Mounting position	Any						
Sealing principle	Soft						
Type of control	Direct						

Flow rate characteristics							
Pneumatic connection 1	M5	G $\frac{1}{8}$	G $\frac{1}{4}$	G $\frac{3}{8}$	G $\frac{1}{2}$	G $\frac{3}{4}$	
Standard nominal flow rate q <sub>nN</sub> <sup>1)</sup> [l/min]	236	777	1,675	2,201	3,420	7,691	

1) Measured at p<sub>1</sub> = 6 bar and p<sub>2</sub> = 5 bar, Δp = 1 bar

Operating and environmental conditions	
Operating pressure [bar]	-0.95 ... +12
Operating medium	Compressed air according to ISO 8573-1:2010 [7:4:4]
Note on operating/pilot medium	Lubricated operation possible (in which case lubricated operation will always be required)
Ambient temperature [°C]	-10 ... +80
Temperature of medium [°C]	-10 ... +80
Corrosion resistance class CRC <sup>1)</sup>	2

1) Corrosion resistance class CRC 2 to Festo standard FN 940070  
Moderate corrosion stress. Indoor applications in which condensation may occur. External visible parts with primarily decorative requirements for the surface and which are in direct contact with the ambient atmosphere typical for industrial applications.

# Hand slide valves VBOH

Technical data

## Materials

Sectional view

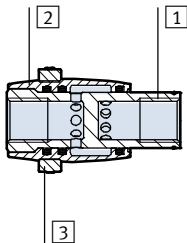

Hand slide valve		
1	Threaded plug	Anodised wrought aluminium alloy
2	Housing	Anodised wrought aluminium alloy
3	Grip ring	Polybutylene terephthalate
-	Seals	Nitrile rubber
Note on materials		RoHS-compliant

## Dimensions

Download CAD data → [www.festo.com](http://www.festo.com)

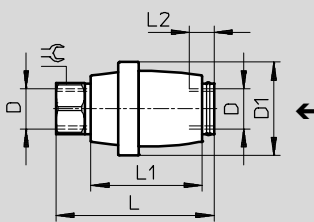

Note  
Grip ring marked with direction arrow for the flow direction.

Type	Connection D	D1 ∅	L	L1	L2	↺
VBOH-32-M5	M5	17	35.6	24.5	5	8
VBOH-32-G18	G1/8	24	38.5	27	9	13
VBOH-32-G14	G1/4	31	52.5	37	13	17
VBOH-32-G38	G3/8	39.5	60.5	42	13.5	22
VBOH-32-G12	G1/2	45	60.5	42	15	27
VBOH-32-G34	G3/4	57.5	82	56.5	17	32

	Pneumatic connection		Standard nominal flow rate qnN [l/min]	Weight [g]	Part No.	Type
	1	2				
	M5	M5	236	8	1609969	VBOH-32-M5
	G1/8	G1/8	777	17	1558073	VBOH-32-G18
	G1/4	G1/4	1,675	35	1302994	VBOH-32-G14
	G3/8	G3/8	2,201	70	1482679	VBOH-32-G38
	G1/2	G1/2	3,420	90	1587988	VBOH-32-G12
	G3/4	G3/4	7,691	183	1629664	VBOH-32-G34

## Product Range and Company Overview

### A Complete Suite and Company Overview

Our experienced engineers provide complete support at every stage of your development process, including: conceptualization, analysis, engineering, design, assembly, documentation, validation, and production.



**Custom Automation Components**  
Complete custom engineered solutions

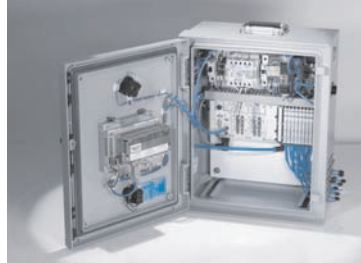

**Custom Control Cabinets**  
Comprehensive engineering support and on-site services



**Complete Systems**  
Shipment, stocking and storage services

### The Broadest Range of Automation Components

With a comprehensive line of more than 30,000 automation components, Festo is capable of solving the most complex automation requirements.



**Electromechanical**  
Electromechanical actuators, motors, controllers & drivers



**Pneumatics**  
Pneumatic linear and rotary actuators, valves, and air supply



**PLCs and I/O Devices**  
PLC's, operator interfaces, sensors and I/O devices

### Supporting Advanced Automation... As No One Else Can!

Festo is a leading global manufacturer of pneumatic and electromechanical systems, components and controls for industrial automation, with more than 16,000 employees in 60 national headquarters serving more than 180 countries. For more than 80 years, Festo has continuously elevated the state of manufacturing with innovations and optimized motion control solutions that deliver higher performing, more profitable automated manufacturing and processing equipment. Our dedication to the advancement of automation extends beyond technology to the education and development of current and future automation and robotics designers with simulation tools, teaching programs, and on-site services.

### Quality Assurance, ISO 9001 and ISO 14001 Certifications

Festo Corporation is committed to supply all Festo products and services that will meet or exceed our customers' requirements in product quality, delivery, customer service and satisfaction.

To meet this commitment, we strive to ensure a consistent, integrated, and systematic approach to management that will meet or exceed the requirements of the ISO 9001 standard for Quality Management and the ISO 14001 standard for Environmental Management.



© Copyright 2013, Festo Corporation. While every effort is made to ensure that all dimensions and specifications are correct, Festo cannot guarantee that publications are completely free of any error, in particular typing or printing errors. Accordingly, Festo cannot be held responsible for the same. For Liability and Warranty conditions, refer to our "Terms and Conditions of Sale", available from your local Festo office. All rights reserved. No part of this publication may be reproduced, distributed, or transmitted in any form or by any means, electronic, mechanical, photocopying or otherwise, without the prior written permission of Festo. All technical data subject to change according to technical update.



Printed on recycled paper at New Horizon Graphic, Inc., FSC certified as an environmental friendly printing plant.

# Festo North America

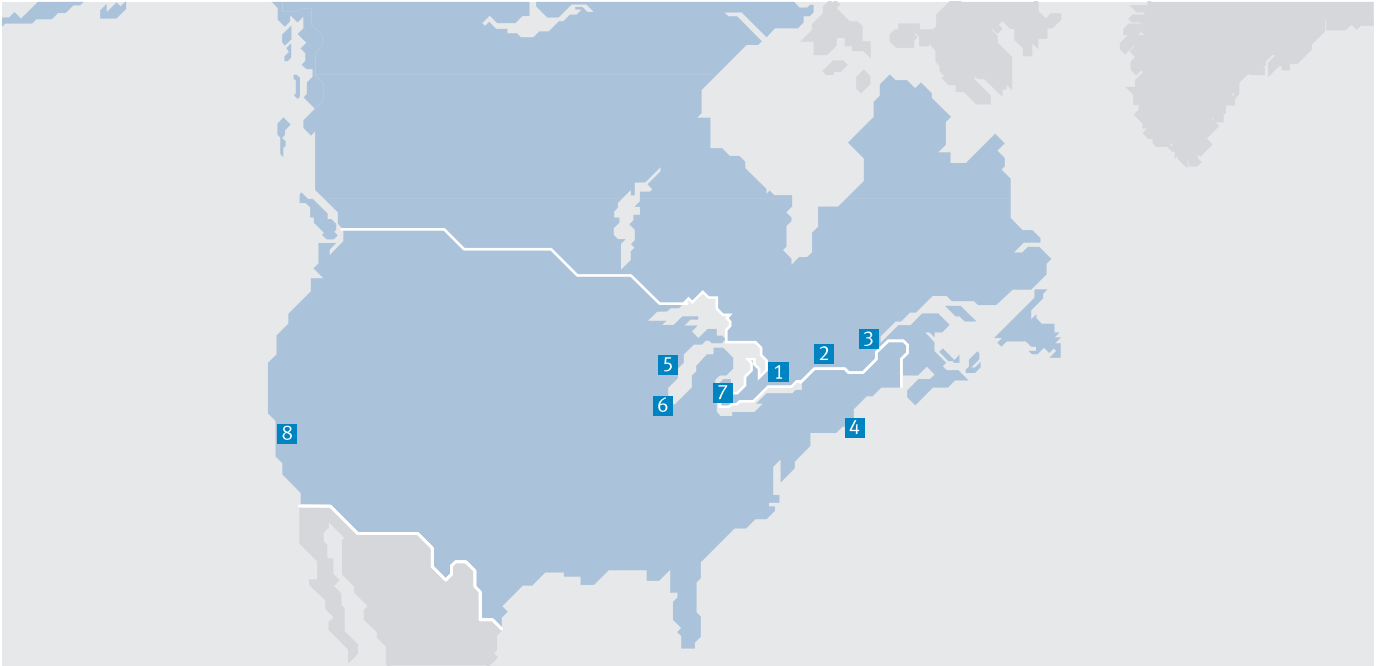

**1 Festo Canada  
Headquarters  
Festo Inc.**  
5300 Explorer Drive  
Mississauga, ON  
L4W 5G4

**2 Montréal**  
5600, Trans-Canada  
Pointe-Claire, QC  
H9R 1B6

**3 Québec City**  
2930, rue Watt#117  
Québec, QC  
G1X 4G3



**4 Festo United States  
Headquarters  
Festo Corporation**  
395 Moreland Road  
Hauppauge, NY  
11788

**5 Appleton**  
North 922 Tower View Drive, Suite N  
Greenville, WI  
54942

**7 Detroit**  
1441 West Long Lake Road  
Troy, MI  
48098

**6 Chicago**  
85 W Algonquin - Suite 340  
Arlington Heights, IL  
60005

**8 Silicon Valley**  
4935 Southfront Road, Suite F  
Livermore, CA  
94550

## Festo Regional Contact Center

### Canadian Customers

Commercial Support:  
Tel: 1 877 GO FESTO (1 877 463 3786)  
Fax: 1 877 FX FESTO (1 877 393 3786)  
Email: festo.canada@ca.festo.com

Technical Support:  
Tel: 1 866 GO FESTO (1 866 463 3786)  
Fax: 1 877 FX FESTO (1 877 393 3786)  
Email: technical.support@ca.festo.com

### USA Customers

Commercial Support:  
Tel: 1 800 99 FESTO (1 800 993 3786)  
Fax: 1 800 96 FESTO (1 800 963 3786)  
Email: customer.service@us.festo.com

Technical Support:  
Tel: 1 866 GO FESTO (1 866 463 3786)  
Fax: 1 800 96 FESTO (1 800 963 3786)  
Email: product.support@us.festo.com

Subject to change

Internet: [www.festo.com/us](http://www.festo.com/us)