

Solenoid valves VZWM-L



Solenoid valves VZWM-L

Key features and type codes

Brief description

- Indirectly controlled poppet valve with diaphragm control
- Connection, valve G $\frac{1}{4}$... G2
- Flow rate 1,400 ... 31,000 l/min
- Available in brass or stainless steel casting
- Varied range of coils

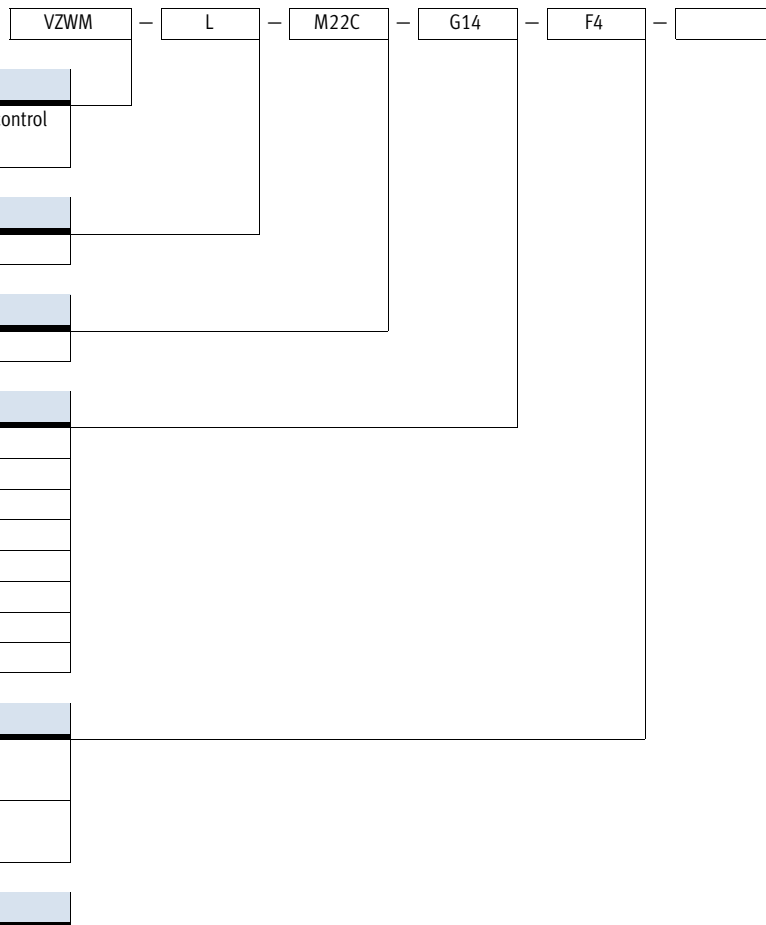

Type	
VZWM	Solenoid valve, process directional control valve

Design	
L	In-line valve

Valve function	
M22C	2/2-way valve, normally closed

Connection, valve	
G14	G $\frac{1}{4}$
G38	G $\frac{3}{8}$
G12	G $\frac{1}{2}$
G34	G $\frac{3}{4}$
G1	G1
G114	G1 $\frac{1}{4}$
G112	G1 $\frac{1}{2}$
G2	G2

Electrical connection	
F4	With armature tube for solenoid coil MD-2- ... -PA
F5	With armature tube for solenoid coil MH-2- ... -PA

Housing material	
R1	Stainless steel casting
	Brass

Solenoid valves VZWM-L

Technical data

Function

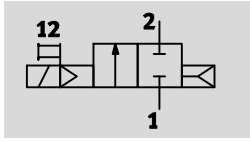

-  - Flow rate
1,400 ... 31,000 l/min

-  - Voltage
24 V DC
110/230 V AC



General technical data		G1/4	G3/8	G1/2	G3/4	G1	G1 1/4	G1 1/2	G2	
Connection, valve										
Nominal size DN (housing: brass)	[mm]	13.5	13.5	13.5	27.5	27.5	40	40	50	
Nominal size DN (housing: stainless steel casting)	[mm]	13	13	13	25	25	40	40	50	
Valve function		2/2, single solenoid								
Constructional design		Poppet valve with diaphragm control								
Sealing principle		Soft								
Actuation type		Electrical								
Reset method		Pneumatic spring								
Control type		Piloted								
Direction of flow		Non-reversible								
Exhaust function		No flow control								
Manual override		None								
Type of mounting		In-line installation								
Mounting position		Preferably vertical								
Standard nominal flow rate	[l/min]	1,400	2,100	2,400	10,000	11,700	24,000	26,400	31,000	
Flow rate Kv	[m ³ /h]	1.6	2	2.4	8.5	10.7	21.3	27.4	39	
C value	[l/sbar]	6	8.8	9.8	39	41	75	82	110	
b value		0.3	0.35	0.37	0.5	0.57	0.6	0.67	0.68	
Differential pressure		[bar]								
		0.5								
Product weight	Brass housing	[g]	500	480	450	1,270	1,200	2,850	2,570	3,800
	Stainless steel casting housing	[g]	400	400	330	1,200	1,100	2,650	2,400	3,660
Materials	Housing	Brass or stainless steel casting								
	Diaphragm	NBR								
	Plunger tube	High-alloy steel								
Note on materials		Contains paint wetting impairment substances								
Max. tightening torque	Connecting thread	[Nm]	35	60	105	200	350	450	540	620
	Cover screw	[Nm]	20	20	20	30	30	30	30	30
	Coil mounting	[Nm]	2	2	2	2	2	2	2	2

Solenoid valves VZWM-L



Technical data

Operating and environmental conditions			G1/4	G3/8	G1/2	G3/4	G1	G1 1/4	G1 1/2	G2	
Connection, valve											
Operating medium			Compressed air in accordance with ISO 8573-1:2010 [7:4:4]								
			Neutral liquids								
			Inert gases								
			Water								
Ambient temperature ¹⁾		[°C]	-10 ... +60								
Operating pressure, valve	Gases	[bar]	0.5 ... 10					0.7 ... 10			
	Fluids	[bar]	0.5 ... 6					0.7 ... 6			
Medium pressure	Gases	[bar]	0.5 ... 10					0.7 ... 10			
	Fluids	[bar]	0.5 ... 6					0.7 ... 6			
Temperature of medium	Gases	[°C]	-10 ... +60								
	Fluids	[°C]	5 ... 50								
Max. viscosity		[mm ² /s]	22								
CE mark (see declaration of conformity)			To EU Pressure Equipment Directive								
Corrosion resistance class CRC ²⁾	Brass		1								
	Stainless steel casting		3								

1) Note ambient temperature of solenoid coils

2) Corrosion resistance class 1 to Festo standard 940 070

Components requiring low corrosion resistance. Transport and storage protection. Parts that do not have primarily decorative surface requirements, e.g. in internal areas that are not visible or behind covers.

Corrosion resistance class 3 to Festo standard 940 070

Components with heavy corrosion exposure. Externally visible components in direct contact with normal industrial atmosphere or media such as solvents and cleaning agents, where the surface requirement is predominantly functional.

Valve response times			G1/4	G3/8	G1/2	G3/4	G1	G1 1/4	G1 1/2	G2
Gases										
Response time	off	[ms]	10	10	10	12	12	20	20	21
	on	[ms]	8	8	8	15	15	26	26	62
Fluids										
Response time	off	[ms]	200	210	220	930	930	1,900	2,000	2,800
	on	[ms]	100	110	110	400	400	1,400	1,400	2,100
Response time, variant R1	off	[ms]	210	190	200	950	950	1,900	2,000	2,800
	on	[ms]	80	110	110	420	300	1,400	1,400	2,100

Electrical data			G1/4	G3/8	G1/2	G3/4	G1	G1 1/4	G1 1/2	G2	
Electrical connection			With armature tube for solenoid coil MD-2- ... -PA, order separately					With armature tube for solenoid coil MH-2- ... -PA, order separately			
Operating voltage	DC voltage	[V DC]	24								
	AC voltage	[V AC]	110/230 (50 ... 60 Hz)								
Coil characteristics	DC voltage	[W]	6.8						7.9		
	AC voltage	[VA]	Pull: 14.5 Hold: 10.5						14		
Protection class to EN 60529			IP65 (with plug socket)								

Solenoid valves VZWM-L

Technical data

Weights [g]			
Brass housing		Stainless steel casting housing	
VZWM-...-G14-F4	500	VZWM-...-G14-F5-R1	400
VZWM-...-G38-F4	480	VZWM-...-G38-F5-R1	400
VZWM-...-G12-F4	450	VZWM-...-G12-F5-R1	360
VZWM-...-G34-F4	1,270	VZWM-...-G34-F5-R1	1,200
VZWM-...-G1-F4	1,200	VZWM-...-G1-F5-R1	1,100
VZWM-...-G114-F5	2,850	VZWM-...-G114-F5-R1	2,650
VZWM-...-G112-F5	2,570	VZWM-...-G112-F5-R1	2,400
VZWM-...-G2-F5	3,800	VZWM-...-G2-F5-R1	3,660

Solenoid valves VZWM-L

Technical data

FESTO

Dimensions

2/2-way valve

Download CAD data → www.festo.com

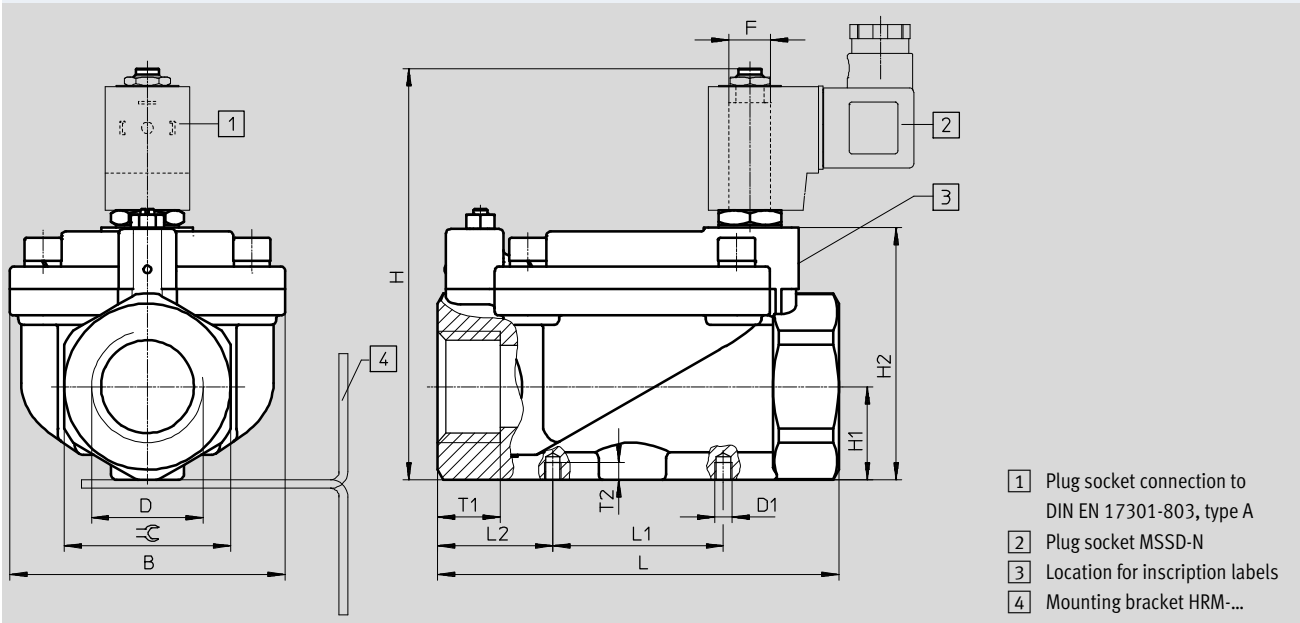

- 1 Plug socket connection to DIN EN 17301-803, type A
- 2 Plug socket MSSD-N
- 3 Location for inscription labels
- 4 Mounting bracket HRM-...

Type	B ±1.5	D	D1	H ±2	H1 ±1.5	H2 ±1	L ±2	L1 ±1.5	L2	F	T1	T2 ±0.5	∅C
VZWM-...-G14-F4	48	G1/4	M4	85.5	15	49	67	25	21	F4	12	4	27
VZWM-...-G38-F4	48	G3/8	M4	85.5	15	49	67	25	21	F4	12	4	27
VZWM-...-G12-F4	48	G1/2	M4	85	15	49	67	25	21	F4	12	4	27
VZWM-...-G34-F4	70	G3/4	M6	107	24.2	70.5	96	40	28	F4	16	6	41
VZWM-...-G1-F4	70	G1	M6	107	24.2	70.5	96	40	28	F4	16	6	41
VZWM-...-G114-F5	96	G1 1/4	M6	143.5	32.5	88	140	59.5	40.25	F5	22	6	58
VZWM-...-G112-F5	96	G1 1/2	M6	143.5	32.5	88	140	59.5	40.25	F5	22	6	58
VZWM-...-G2-F5	112	G2	M6	159	38.5	103.5	168	59.5	54.25	F5	25	6	70
VZWM-...-G14-F5-R1	44	G1/4	M4	106	15.6	51	67	25	21	F5	-	4	27
VZWM-...-G38-F5-R1	44	G3/8	M4	106	15.6	51	67	25	21	F5	-	4	27
VZWM-...-G12-F5-R1	44	G1/2	M4	106	15.6	51	67	25	21	F5	-	4	27
VZWM-...-G34-F5-R1	70	G3/4	M6	126	24.2	70	96	40	28	F5	-	6	41
VZWM-...-G1-F5-R1	70	G1	M6	126	24.2	70	96	40	28	F5	-	6	41
VZWM-...-G114-F5-R1	96	G1 1/4	M6	145	34	89.5	140	59.5	40.25	F5	-	6	58
VZWM-...-G112-F5-R1	96	G1 1/2	M6	145	34	89.5	140	59.5	40.25	F5	-	6	58
VZWM-...-G2-F5-R1	112	G2	M6	159	38.5	104	168	59.5	54.25	F5	-	6	70

Ordering data

Connection, valve	Brass housing		Stainless steel casting housing	
	Part No.	Type	Part No.	Type
G1/4	546 146	VZWM-L-M22C-G14-F4	546162	VZWM-L-M22C-G14-F5-R1
G3/8	546 147	VZWM-L-M22C-G38-F4	546163	VZWM-L-M22C-G38-F5-R1
G1/2	546 148	VZWM-L-M22C-G12-F4	546164	VZWM-L-M22C-G12-F5-R1
G3/4	546 149	VZWM-L-M22C-G34-F4	546165	VZWM-L-M22C-G34-F5-R1
G1	546 150	VZWM-L-M22C-G1-F4	546166	VZWM-L-M22C-G1-F5-R1
G1 1/4	546 151	VZWM-L-M22C-G114-F5	546167	VZWM-L-M22C-G114-F5-R1
G1 1/2	546 152	VZWM-L-M22C-G112-F5	546168	VZWM-L-M22C-G112-F5-R1
G2	546 153	VZWM-L-M22C-G2-F5	546169	VZWM-L-M22C-G2-F5-R1

Solenoid valves VZWM-L

Accessories

Mounting bracket HRM

Material:
Galvanised steel

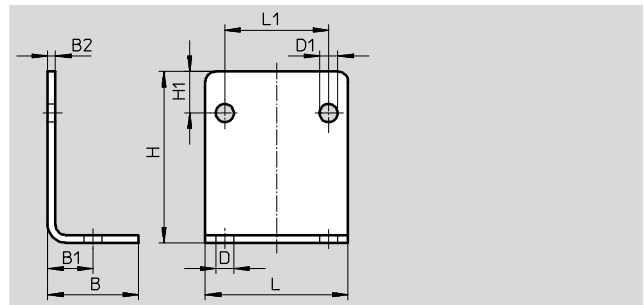

Dimensions and ordering data											
B	B1	B2	D	D1	H	H1	L	L1	Weight [g]	Part No.	Type
25	12.5	2	6	5	37	10	40	25	39	9 769	HRM-1
35	17.5	3	7	7	66	16	55	40	130	9 770	HRM-2
47	23.5	3	9	7	87	23	75	59.5	246	9 771	HRM-3

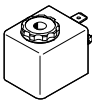
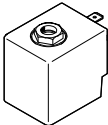
Ordering data – Solenoid coils				Technical data → Internet: md, mh	
	Voltage	Part No.	Type		
Solenoid coil for VZWM- ... -F4- ... ¹⁾					
	24 V DC	549 903	MD-2-24VDC-PA		
	110 V AC, 50 ... 60 Hz	549 904	MD-2-110VAC-PA		
	230 V AC, 50 ... 60 Hz	549 905	MD-2-230VAC-PA		
Solenoid coil for VZWM- ... -F5- ... ¹⁾					
	24 V DC	549 906	MH-2-24VDC-PA		
	110 V AC, 50 ... 60 Hz	549 907	MH-2-110VAC-PA		
	230 V AC, 50 ... 60 Hz	549 908	MH-2-230VAC-PA		

1) Ambient temperature –20 ... +50 °C

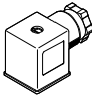
Ordering data – Plug socket				Technical data → Internet: mssd	
		Part No.	Type		
	3-pin, square design MSF	550 067	MSSD-N		

Product Range and Company Overview

A Complete Suite and Company Overview

Our experienced engineers provide complete support at every stage of your development process, including: conceptualization, analysis, engineering, design, assembly, documentation, validation, and production.



Custom Automation Components
Complete custom engineered solutions

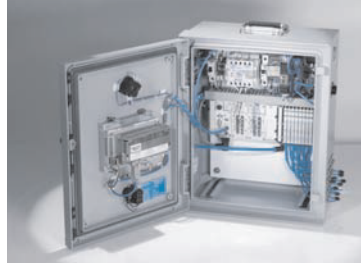

Custom Control Cabinets
Comprehensive engineering support and on-site services



Complete Systems
Shipment, stocking and storage services

The Broadest Range of Automation Components

With a comprehensive line of more than 30,000 automation components, Festo is capable of solving the most complex automation requirements.



Electromechanical
Electromechanical actuators, motors, controllers & drivers



Pneumatics
Pneumatic linear and rotary actuators, valves, and air supply



PLCs and I/O Devices
PLC's, operator interfaces, sensors and I/O devices

Supporting Advanced Automation... As No One Else Can!

Festo is a leading global manufacturer of pneumatic and electromechanical systems, components and controls for industrial automation, with more than 16,000 employees in 60 national headquarters serving more than 180 countries. For more than 80 years, Festo has continuously elevated the state of manufacturing with innovations and optimized motion control solutions that deliver higher performing, more profitable automated manufacturing and processing equipment. Our dedication to the advancement of automation extends beyond technology to the education and development of current and future automation and robotics designers with simulation tools, teaching programs, and on-site services.

Quality Assurance, ISO 9001 and ISO 14001 Certifications

Festo Corporation is committed to supply all Festo products and services that will meet or exceed our customers' requirements in product quality, delivery, customer service and satisfaction.

To meet this commitment, we strive to ensure a consistent, integrated, and systematic approach to management that will meet or exceed the requirements of the ISO 9001 standard for Quality Management and the ISO 14001 standard for Environmental Management.



© Copyright 2013, Festo Corporation. While every effort is made to ensure that all dimensions and specifications are correct, Festo cannot guarantee that publications are completely free of any error, in particular typing or printing errors. Accordingly, Festo cannot be held responsible for the same. For Liability and Warranty conditions, refer to our "Terms and Conditions of Sale", available from your local Festo office. All rights reserved. No part of this publication may be reproduced, distributed, or transmitted in any form or by any means, electronic, mechanical, photocopying or otherwise, without the prior written permission of Festo. All technical data subject to change according to technical update.



Printed on recycled paper at New Horizon Graphic, Inc., FSC certified as an environmental friendly printing plant.

Festo North America

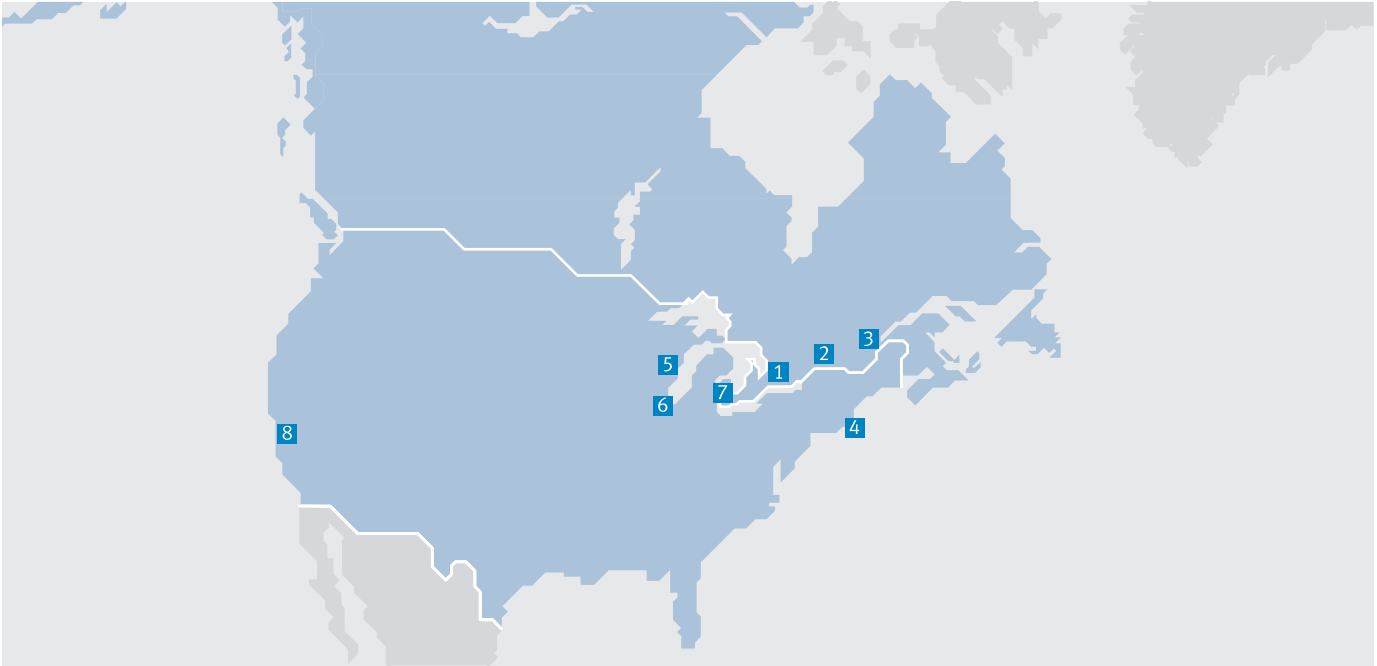

**1 Festo Canada
Headquarters
Festo Inc.**
5300 Explorer Drive
Mississauga, ON
L4W 5G4

2 Montréal
5600, Trans-Canada
Pointe-Claire, QC
H9R 1B6

3 Québec City
2930, rue Watt#117
Québec, QC
G1X 4G3



**4 Festo United States
Headquarters
Festo Corporation**
395 Moreland Road
Hauppauge, NY
11788

5 Appleton
North 922 Tower View Drive, Suite N
Greenville, WI
54942

7 Detroit
1441 West Long Lake Road
Troy, MI
48098

6 Chicago
85 W Algonquin - Suite 340
Arlington Heights, IL
60005

8 Silicon Valley
4935 Southfront Road, Suite F
Livermore, CA
94550

Festo Regional Contact Center

Canadian Customers

Commercial Support:
Tel: 1 877 GO FESTO (1 877 463 3786)
Fax: 1 877 FX FESTO (1 877 393 3786)
Email: festo.canada@ca.festo.com

Technical Support:
Tel: 1 866 GO FESTO (1 866 463 3786)
Fax: 1 877 FX FESTO (1 877 393 3786)
Email: technical.support@ca.festo.com

USA Customers

Commercial Support:
Tel: 1 800 99 FESTO (1 800 993 3786)
Fax: 1 800 96 FESTO (1 800 963 3786)
Email: customer.service@us.festo.com

Technical Support:
Tel: 1 866 GO FESTO (1 866 463 3786)
Fax: 1 800 96 FESTO (1 800 963 3786)
Email: product.support@us.festo.com