

Pressure transmitters SPT



# Pressure transmitters SPTE

Product range overview

Method of measurement	Pressure measuring range [bar]	Measured variable	Pneumatic connection	Analogue output [V]	Electrical connection
Piezoresistive pressure sensor	0 ... -1	Relative pressure	Push-in sleeve 4 mm	1 ... 5	Cable, 3-wire, open end
			Push-in sleeve 6 mm		
			Push-in connector 3 mm		
			Push-in connector 4 mm		
			Flange		
			Push-in sleeve 4 mm	0 ... 10	
			Push-in sleeve 6 mm		
			Push-in connector 3 mm		
			Push-in connector 4 mm		
			Flange		
	0 ... 10	Relative pressure	Push-in sleeve 4 mm	1 ... 5	Cable, 3-wire, open end
			Push-in sleeve 6 mm		
			Push-in connector 3 mm		
			Push-in connector 4 mm		
Flange					
Push-in sleeve 4 mm			0 ... 10		
Push-in sleeve 6 mm					
Push-in connector 3 mm					
Push-in connector 4 mm					
Flange					

# Pressure transmitters SPTE

Peripherals overview

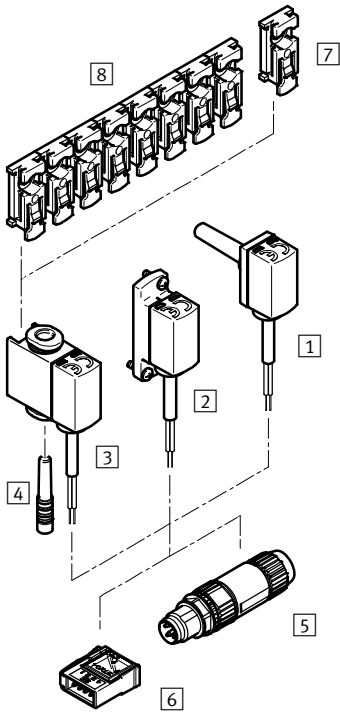

Accessories		→ Page/Internet
1	Pressure transmitter SPTE-...-S...	5
2	Pressure transmitter SPTE-...-F	5
3	Pressure transmitter SPTE-...-Q...	5
4	Blanking plug QSMC-3H (included in the scope of delivery with SPTE-...-Q...)	qs
5	Plug NECU-S-M...G3-HX	9
6	Plug NECU-S-ECG4-HX-Q3	9
7	Mounting clip SAMH-PE-MC-1	9
8	Mounting clip SAMH-PE-MC-8	9

# Pressure transmitters SPTE

Type codes

FESTO

S P T E - P 1 0 R - S 4 - B - 2.5 K

## Function

S P T E	Pressure transmitter
---------	----------------------

## Pressure measuring range

V1	0 ... -1 bar
P10	0 ... 10 bar

## Pressure input

R	Relative pressure
---	-------------------

## Pneumatic connection

S4	Push-in sleeve 4 mm
S6	Push-in sleeve 6 mm
Q3	Push-in connector 3 mm
Q4	Push-in connector 4 mm
F	Flange

## Electrical output

B	1 ... 5 V
V	0 ... 10 V

## Electrical connection

2.5K	2.5 m cable, open end
------	-----------------------

# Pressure transmitters SPTE

Technical data

Function

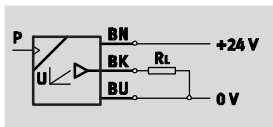

- - Voltage  
10 ... 30 V DC

- - Pressure  
-1 ... +10 bar

- - Temperature range  
0 ... +50 °C



General technical data	
Certification	RCM trademark c UL us - Recognized (OL)
CE mark (see declaration of conformity) <sup>1)</sup>	To EU EMC Directive
Note on materials	RoHS-compliant

1) For information about the applicability of the component see the manufacturer's EC declaration of conformity at: [www.festo.com/sp](http://www.festo.com/sp) → User documentation.  
If the component is subject to restrictions on usage in residential, office or commercial environments or small businesses, further measures to reduce the emitted interference may be necessary.

Input signal/measuring element		
SPTE-	V1	P10
Measured variable	Relative pressure	
Method of measurement	Piezoresistive pressure sensor	
Pressure measuring range starting value [bar]	0	0
Pressure measuring range final value [bar]	-1	10
Max. overload pressure [bar]	5	15
Operating medium	Compressed air in accordance with ISO 8573-1:2010 [7:4:4]	
Note on operating/pilot medium	Operation with lubricated medium possible	
Temperature of medium [°C]	0 ... +50	
Ambient temperature [°C]	0 ... +50	

Output, general		
Accuracy ±FS <sup>1)</sup> [%]	3 (at room temperature of approx. 23 °C) 4 (in the ambient temperature range 0 ... 50 °C)	
Repetition accuracy ±FS <sup>1)</sup> [%]	0.3	
Temperature coefficient ±FS/K <sup>1)</sup> [%]	0.05	

1) % FS = % of the measuring range (full scale)

Analogue output		
SPTE-...-	B	V
Analogue output [V]	1 ... 5	0 ... 10
Rise time [ms]	1	
Min. load resistance of voltage output [kΩ]	15	

Output, additional data	
Protection against short circuit	For all electrical connections

Electronic components		
SPTE-...-	B	V
Operating voltage range DC [V]	10 ... 30	18 ... 30
Reverse polarity protection	For all electrical connections	

# Pressure transmitters SPTE

Technical data

Electromechanical components	
Electrical connection	Cable, 3-wire, open end
Cable length [m]	2.5

Mechanical components					
SPTE-...-	S4	S6	Q3	Q4	F
Type of mounting	Push-in		Via accessories		Via through-hole and screw
Mounting position	Any				
Pneumatic connection	Push-in sleeve QS-4	Push-in sleeve QS-6	QS-3	QS-4	Flange
Product weight [g]	35				
Housing materials	PA, reinforced				

Immissions/emissions	
Protection class	IP40
Corrosion resistance class CRC <sup>1)</sup>	2

1) Corrosion resistance class 2 according to Festo standard 940 070  
 Components subject to moderate corrosion stress. Externally visible parts with primarily decorative surface requirements which are in direct contact with a normal industrial environment or media such as coolants or lubricating agents.

# Pressure transmitters SPTE

Technical data

## Dimensions

Download CAD data → [www.festo.com](http://www.festo.com)

SPTE-...-S...

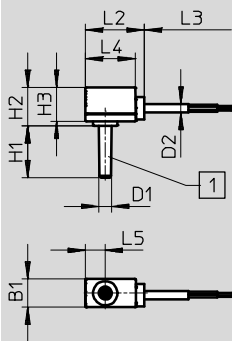

1 Pneumatic connection

SPTE-...-Q...

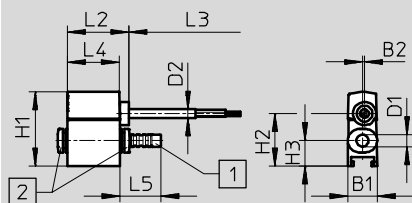

1 Blanking plug  
2 Pneumatic connection

SPTE-...-F

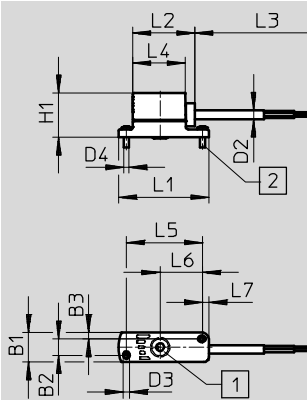

1 Pneumatic connection with O-ring for flat mounting  
2 M2x6 screw

Type	B1	B2	B3	D1 Ø	D2 Ø	D3 Ø	D4	H1	H2	H3	L1	L2	L3	L4	L5	L6	L7
SPTE-...-S4	9.8	-	-	4	2.9	-	-	18	13.3	11.8	-	20.5	2500	17.5	6.9	-	-
SPTE-...-S6		-	-	6		-	-	18	13.3	11.8	-				6.9	-	-
SPTE-...-Q3		0.7	-	3		-	-	24.7	17.5	8.5	-				13.6	-	-
SPTE-...-Q4		0.7	-	4		-	-	24.7	17.5	8.5	-				13.6	-	-
SPTE-...-F		5.4	2.1	-		-	2.1	M2x6	15	-	-				30	25	13.9

# Pressure transmitters SPTE

Technical data

Ordering data									
Pressure measuring range [bar]	Analogue output [V]	Pneumatic connection	Electrical connection	Part No.	Type				
0 ... -1	1 ... 5	Push-in sleeve 4 mm	Cable, 3-wire, open end	<b>571469</b>	<b>SPTE-V1R-S4-B-2.5K</b>				
		Push-in sleeve 6 mm		<b>571470</b>	<b>SPTE-V1R-S6-B-2.5K</b>				
		Push-in connector 3 mm		<b>571471</b>	<b>SPTE-V1R-Q3-B-2.5K</b>				
		Push-in connector 4 mm		<b>571472</b>	<b>SPTE-V1R-Q4-B-2.5K</b>				
		Flange		<b>571473</b>	<b>SPTE-V1R-F-B-2.5K</b>				
	0 ... 10	0 ... 10		Push-in sleeve 4 mm	<b>571474</b>	<b>SPTE-V1R-S4-V-2.5K</b>			
				Push-in sleeve 6 mm	<b>571475</b>	<b>SPTE-V1R-S6-V-2.5K</b>			
				Push-in connector 3 mm	<b>571476</b>	<b>SPTE-V1R-Q3-V-2.5K</b>			
				Push-in connector 4 mm	<b>571477</b>	<b>SPTE-V1R-Q4-V-2.5K</b>			
				Flange	<b>571478</b>	<b>SPTE-V1R-F-V-2.5K</b>			
				0 ... 10	1 ... 5	Push-in sleeve 4 mm	Cable, 3-wire, open end	<b>571479</b>	<b>SPTE-P10R-S4-B-2.5K</b>
						Push-in sleeve 6 mm		<b>571480</b>	<b>SPTE-P10R-S6-B-2.5K</b>
						Push-in connector 3 mm		<b>571481</b>	<b>SPTE-P10R-Q3-B-2.5K</b>
						Push-in connector 4 mm		<b>571482</b>	<b>SPTE-P10R-Q4-B-2.5K</b>
Flange	<b>571483</b>	<b>SPTE-P10R-F-B-2.5K</b>							
0 ... 10	0 ... 10	Push-in sleeve 4 mm	<b>571484</b>		<b>SPTE-P10R-S4-V-2.5K</b>				
		Push-in sleeve 6 mm	<b>571485</b>		<b>SPTE-P10R-S6-V-2.5K</b>				
		Push-in connector 3 mm	<b>571486</b>		<b>SPTE-P10R-Q3-V-2.5K</b>				
		Push-in connector 4 mm	<b>571487</b>		<b>SPTE-P10R-Q4-V-2.5K</b>				
		Flange	<b>571488</b>		<b>SPTE-P10R-F-V-2.5K</b>				



# Pressure transmitters SPTE

Accessories

## Mounting clip SAMH-PE-MC-1

Material:  
POM

Note on materials:  
RoHS-compliant

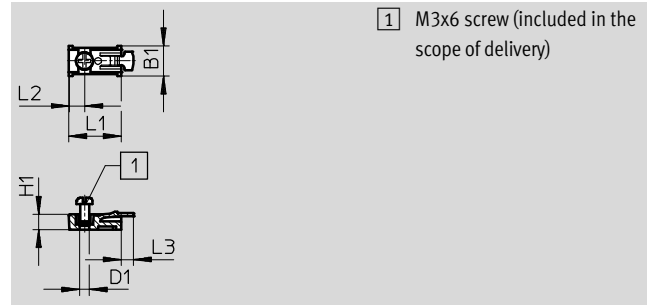

Dimensions and ordering data							Part No.	Type
B1	D1 ∅	H1	L1	L2	L3			
10	3.2	5	17.5	5.3	4	571489	SAMH-PE-MC-1	

## Mounting clip SAMH-PE-MC-8

Material:  
POM

Note on materials:  
RoHS-compliant

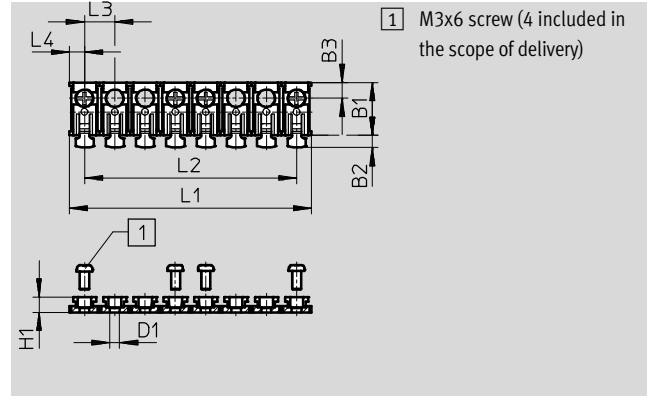

Note  
The mounting clip SAMH-PE-MC-8 can be shortened by the user to the required number of slots.

Dimensions and ordering data										Part No.	Type
B1	B2	B3	D1 ∅	H1	L1	L2	L3	L4			
17.5	4	5.3	3.2	5	80	70	10	5	571490	SAMH-PE-MC-8	

Ordering data – Plugs			
	Electrical connection	Part No.	Type
	Plug M8x1, 3-pin, straight, insulation displacement connector	562024	NECU-S-M8G3-HX
	Plug M12x1, A-coded, 3-pin, straight, insulation displacement connector	562027	NECU-S-M12G3-HX
	Straight plug/insulation displacement connector, 4-pin, square design	570922	NECU-S-ECG4-HX-Q3

## Product Range and Company Overview

### A Complete Suite and Company Overview

Our experienced engineers provide complete support at every stage of your development process, including: conceptualization, analysis, engineering, design, assembly, documentation, validation, and production.



**Custom Automation Components**  
Complete custom engineered solutions



**Custom Control Cabinets**  
Comprehensive engineering support and on-site services



**Complete Systems**  
Shipment, stocking and storage services

### The Broadest Range of Automation Components

With a comprehensive line of more than 30,000 automation components, Festo is capable of solving the most complex automation requirements.



**Electromechanical**  
Electromechanical actuators, motors, controllers & drivers



**Pneumatics**  
Pneumatic linear and rotary actuators, valves, and air supply



**PLCs and I/O Devices**  
PLC's, operator interfaces, sensors and I/O devices

### Supporting Advanced Automation... As No One Else Can!

Festo is a leading global manufacturer of pneumatic and electromechanical systems, components and controls for industrial automation, with more than 16,000 employees in 60 national headquarters serving more than 180 countries. For more than 80 years, Festo has continuously elevated the state of manufacturing with innovations and optimized motion control solutions that deliver higher performing, more profitable automated manufacturing and processing equipment. Our dedication to the advancement of automation extends beyond technology to the education and development of current and future automation and robotics designers with simulation tools, teaching programs, and on-site services.

### Quality Assurance, ISO 9001 and ISO 14001 Certifications

Festo Corporation is committed to supply all Festo products and services that will meet or exceed our customers' requirements in product quality, delivery, customer service and satisfaction.

To meet this commitment, we strive to ensure a consistent, integrated, and systematic approach to management that will meet or exceed the requirements of the ISO 9001 standard for Quality Management and the ISO 14001 standard for Environmental Management.

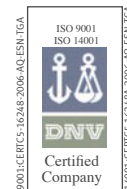

© Copyright 2013, Festo Corporation. While every effort is made to ensure that all dimensions and specifications are correct, Festo cannot guarantee that publications are completely free of any error, in particular typing or printing errors. Accordingly, Festo cannot be held responsible for the same. For Liability and Warranty conditions, refer to our "Terms and Conditions of Sale", available from your local Festo office. All rights reserved. No part of this publication may be reproduced, distributed, or transmitted in any form or by any means, electronic, mechanical, photocopying or otherwise, without the prior written permission of Festo. All technical data subject to change according to technical update.



Printed on recycled paper at New Horizon Graphic, Inc., FSC certified as an environmental friendly printing plant.

# Festo North America

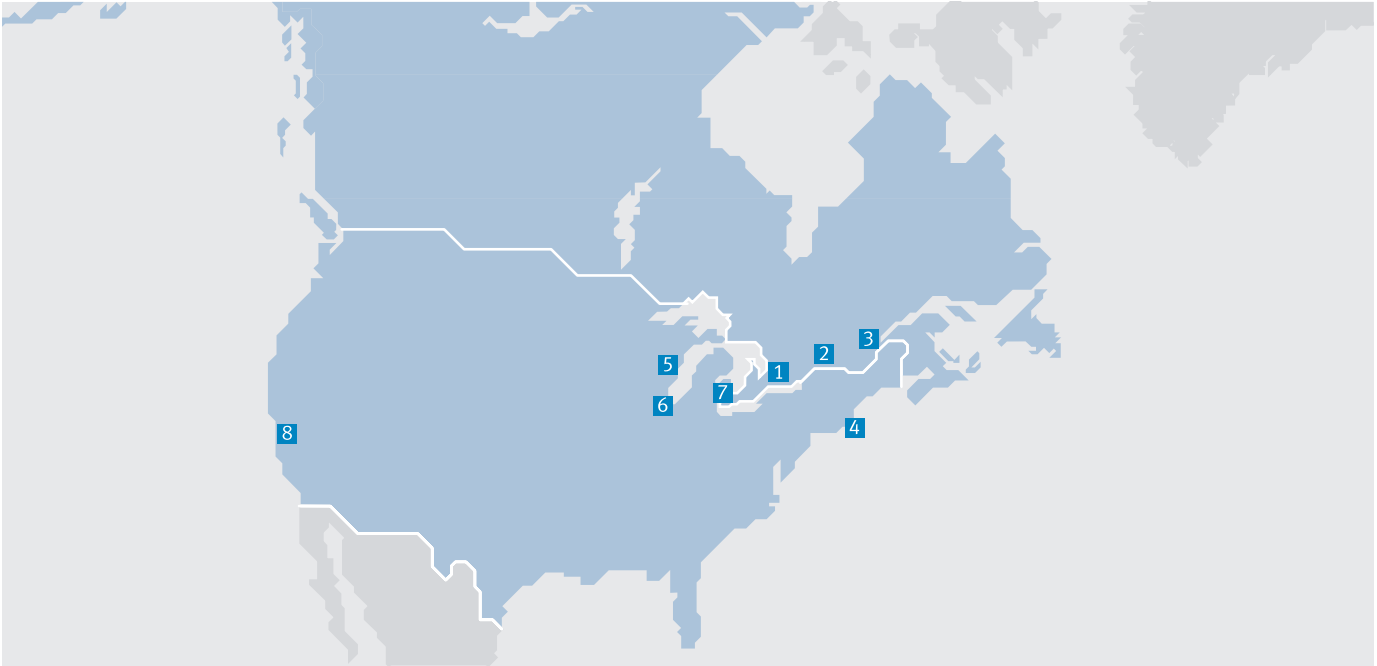

**1 Festo Canada  
Headquarters  
Festo Inc.**  
5300 Explorer Drive  
Mississauga, ON  
L4W 5G4

**2 Montréal**  
5600, Trans-Canada  
Pointe-Claire, QC  
H9R 1B6

**3 Québec City**  
2930, rue Watt#117  
Québec, QC  
G1X 4G3



**4 Festo United States  
Headquarters  
Festo Corporation**  
395 Moreland Road  
Hauppauge, NY  
11788

**5 Appleton**  
North 922 Tower View Drive, Suite N  
Greenville, WI  
54942

**7 Detroit**  
1441 West Long Lake Road  
Troy, MI  
48098

**6 Chicago**  
85 W Algonquin - Suite 340  
Arlington Heights, IL  
60005

**8 Silicon Valley**  
4935 Southfront Road, Suite F  
Livermore, CA  
94550

## Festo Regional Contact Center

### Canadian Customers

Commercial Support:  
Tel: 1 877 GO FESTO (1 877 463 3786)  
Fax: 1 877 FX FESTO (1 877 393 3786)  
Email: festo.canada@ca.festo.com

Technical Support:  
Tel: 1 866 GO FESTO (1 866 463 3786)  
Fax: 1 877 FX FESTO (1 877 393 3786)  
Email: technical.support@ca.festo.com

### USA Customers

Commercial Support:  
Tel: 1 800 99 FESTO (1 800 993 3786)  
Fax: 1 800 96 FESTO (1 800 963 3786)  
Email: customer.service@us.festo.com

Technical Support:  
Tel: 1 866 GO FESTO (1 866 463 3786)  
Fax: 1 800 96 FESTO (1 800 963 3786)  
Email: product.support@us.festo.com