

Pressure sensors SPAU

FESTO



Pressure sensors SPAU

Key features

At a glance

Product description

The pressure sensor SPAU is suitable for monitoring compressed air and non-corrosive gases. The variant with display offers the option of reading the pressure and setting values on-site. The pressure value is transmitted to the connected control system as a switching signal, as an analogue signal or via IO-Link.



The pressure sensor without display transmits the pressure value to the connected control system as an analogue signal. Display of the pressure and parameterisation of the sensor are provided centrally, e.g. via a display forming part of a machine control system. The pressure sensor can be parameterised using IO-Link as a tamper-proof pressure switch without display with up to two switching outputs.



Areas of application

- Network monitoring (pressure present)
- Regulator monitoring (pressure in the target area)
- Vacuum (partial suction)
- Air-pressure test (pressure drop over time)
- Object detection (back pressure present)

Product benefits

An assembly concept with short assembly times that is easy to implement in all installation situations. Female/male thread or QuickStar connection – the perfect pneumatic adapter for every application.

Assembly:

- Threaded mounting
- H-rail mounting
- Front panel mounting
- Mounting bracket
- Wall mounting

Electronic components:

- Maximum versatility and reduced warehousing owing to switchable electrical outputs (PNP/NPN/ normally closed/normally open and current/voltage output)

Pressure sensors SPAU

Key features

Operation

Monitoring and setting of a pressure threshold, a pressure range or a pressure difference using a teach-in function or by entering values.

Variants with display:

- Pressure display, pressure switching outputs and readout of analogue value from an on-site device can be set
- Quick commissioning of the pressure sensor thanks to straightforward menu navigation
- Display colour blue/red as visual feedback about the pressure of the medium
- Min./max. value memory for monitoring compressed air (display of rapid pressure peaks that are not visible to the human eye)
- Adjustable filter attenuates the sensor signal generated by pressure peaks
- Scaling the analogue output to increase the signal dynamics
- Choice of pressure units: bar, MPa, PSI and more
- Offset compensation possible
- ECO function “Switch off display” available
- Optional security code can be freely chosen (4-digit code)
- All settings that have been carried out on one sensor (master) can be transferred (replication) to other, identical sensors (device). This makes it possible to significantly shorten commissioning time

Variants without display:

- Analogue value output and pressure switching outputs proportional to the pressure
- Switching output behaviour can be set on the machine display using IO-Link
- Other functions can be set using IO-Link

Variants with IO-Link:

- With and without display
- Serial communication integrated using IO-Link 1.1
- Analogue process value is provided digitally
- The sensor can be parameterised and maintained remotely at control level using an IO-Link master
- Automatic parameterisation following sensor change: no need to repeat parameterisation and sensor settings after changing the sensor

Pressure sensors SPAU

Key features

Device variants

Variants with display

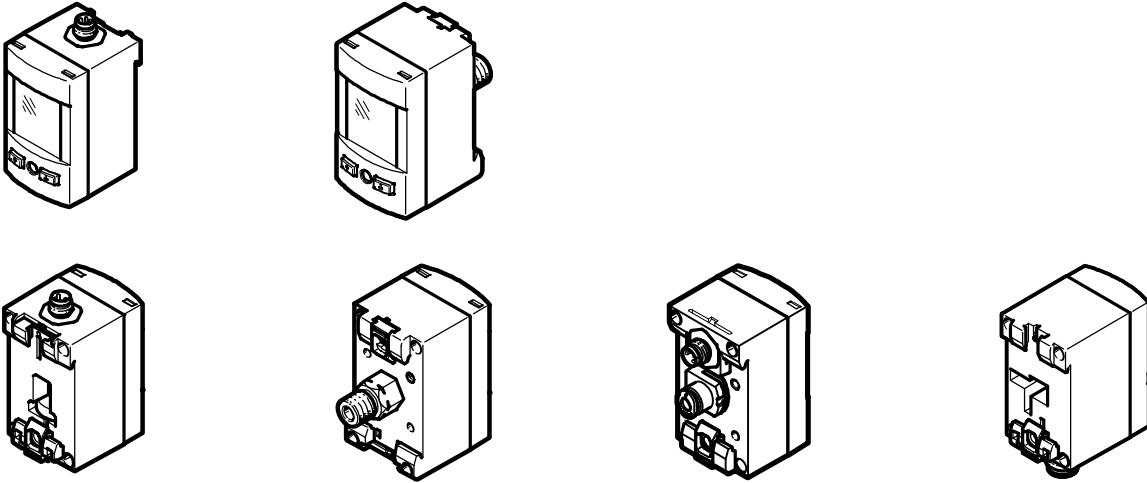

Variants with display for front panel mounting

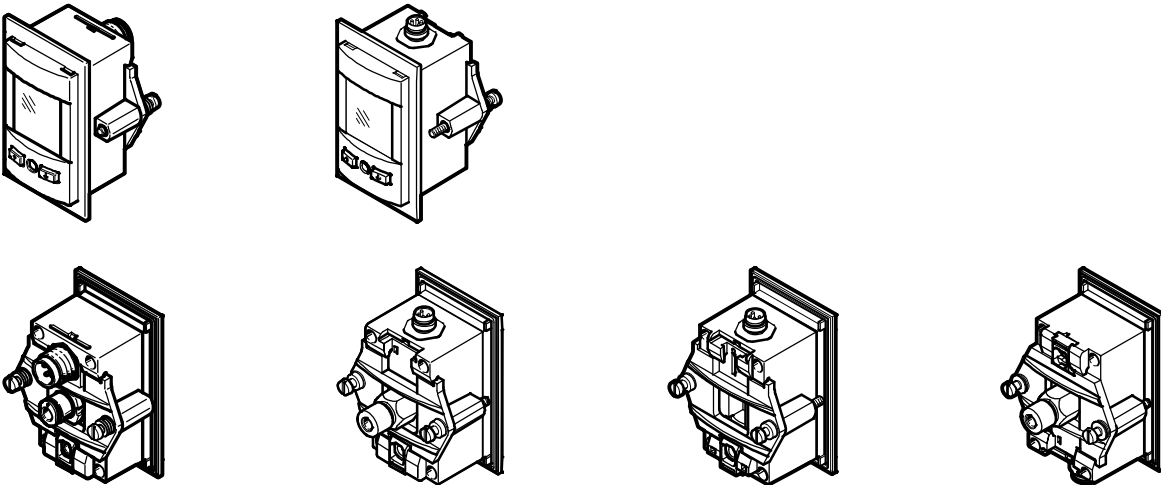

Variants without display

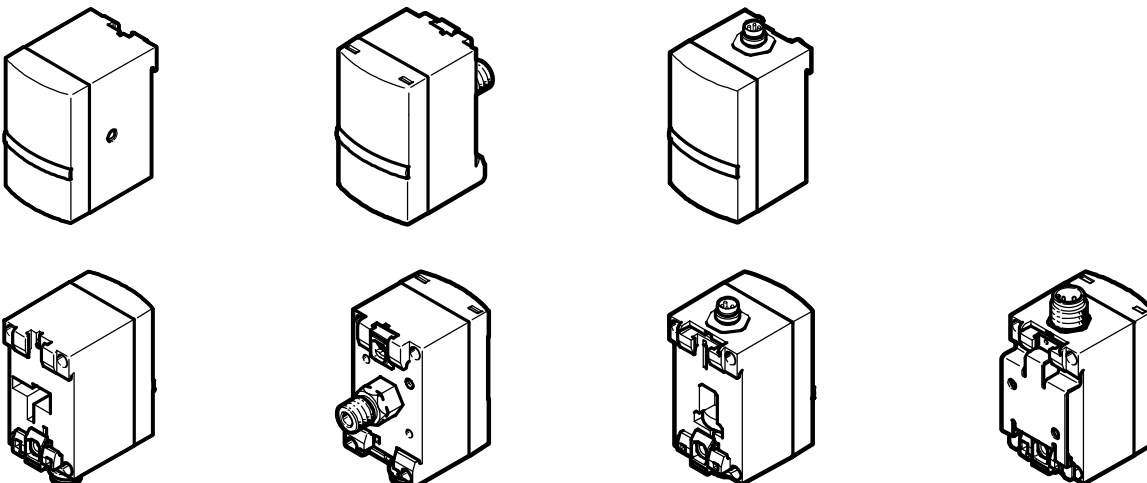

The connections shown are by way of example.

Pressure sensors SPAU

Peripherals overview

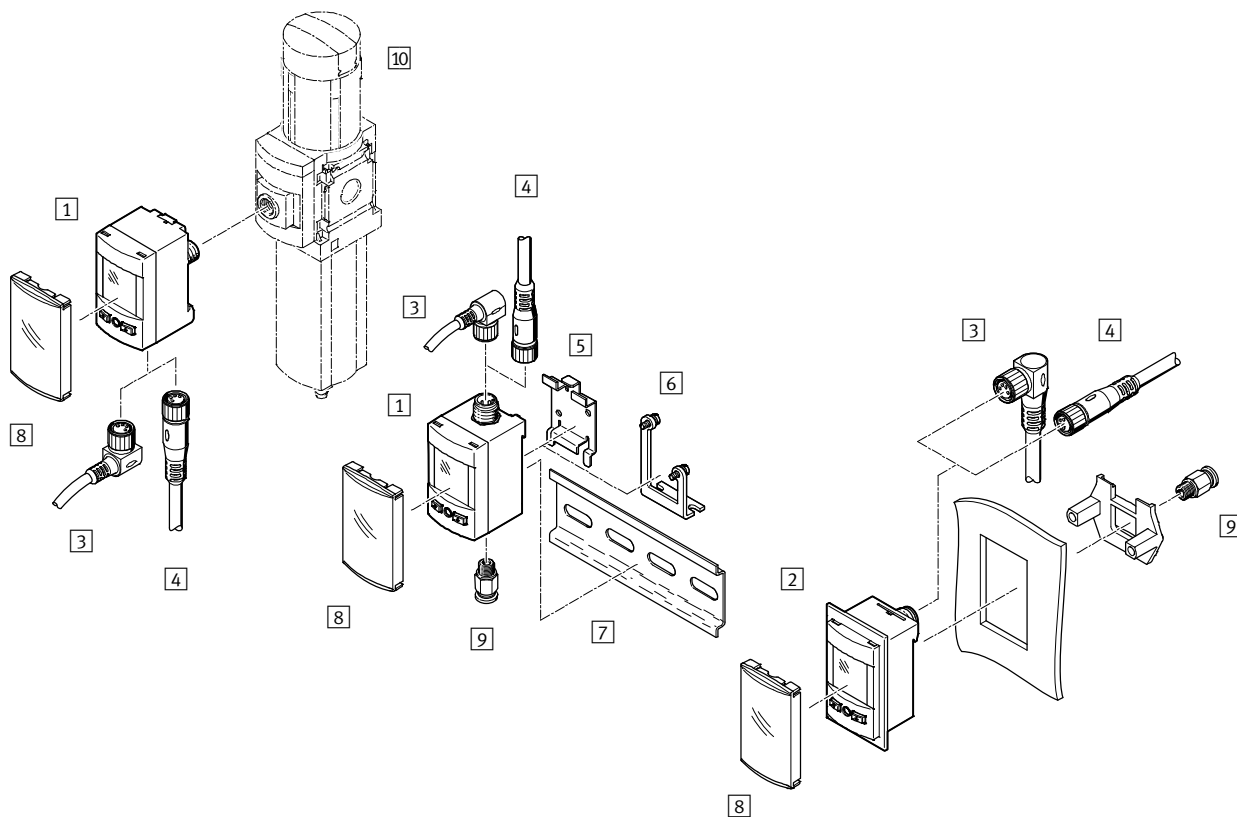

Accessories	→ Page/ Internet
1 Pressure sensors SPAU, display variants	8
2 Pressure sensors SPAU, display variants for front panel mounting	8
3 Connecting cable, angled socket M8x1	21
4 Connecting cable, straight socket M8x1	21
3 Connecting cable, angled socket M12x1	21
4 Connecting cable, straight socket M12x1	21

Accessories	→ Page/ Internet
5 Wall mounting SAMH-PU-W	19
6 Mounting bracket SAMH-PU-A	19
7 Mounting rail To DIN EN 60715	nrh
8 Safety guard SACC-PU-G	20
9 Pressure supply port	-
10 Service unit	ms4

Pressure sensors SPAU

Type codes

SPAU - B2 R - H - Q4 - D -

Type	
SPAU	Pressure sensors

Pressure measuring range [bar]	
P025	0 ... 0.25
P05	0 ... 0.5
P1	0 ... 1
P2	0 ... 2
P6	0 ... 6
P10	0 ... 10
P12	0 ... 12
P16	0 ... 16
B2	-1 ... 1
B11	-1 ... 10
V025	0 ... -0.25
V05	0 ... -0.5
V1	0 ... -1

Pressure input	
R	Relative pressure

Type of mounting	
T	Threaded mounting
H	H-rail mounting
W	Wall mounting
A	Mounting bracket
F	Front panel mounting

Pneumatic connection	
G18	G $\frac{1}{8}$
R14	R $\frac{1}{4}$
R18	R $\frac{1}{8}$
N18	NPT $\frac{1}{8}$
M5	M5
M7	M7
Q4	Push-in connector 4 mm
Q6	Push-in connector 6 mm
T532	Push-in connector 5/32

Thread type	
-	None
M	Male thread
F	Female thread

Outlet direction	
-	At the rear
D	Underneath

Pressure sensors SPAU

Type codes



		-	LK	-	A	+	2,5S	G	T
Display									
-	None								
L	LCD, backlit								
Electrical output 1									
PNLK	PNP, NPN, IO-Link								
LK	IO-Link								
Electrical output 2									
PNVBA	PNP, NPN, 0 ... 10 V, 1 ... 5 V, 4 ... 20 mA								
V	0 ... 10 V								
B	1 ... 5 V								
A	4 ... 20 mA								
Electrical connection									
M8	M8 plug connector								
M12	Plug connector M12, A-coded								
Electrical outlet direction									
-	At the rear								
D	Underneath								
U	Top								
Electrical accessories									
-	None								
2,5A	Angled socket, cable 2.5 m								
2,5S	Straight socket, cable 2.5 m								
5A	Angled socket, cable 5 m								
5S	Straight socket, cable 5 m								
Protective devices									
-	None								
G	Safety guard								
Certificate									
-	None								
T	Test report								

Pressure sensors SPAU

Technical data

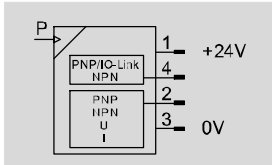
Display ... -L

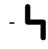

-  Voltage
20 ... 30 V DC
-  Pressure measuring range
-1 ... +16 bar
-  Temperature range
0 ... +50 °C



Variant without display

Output preset to voltage ... -LK-V

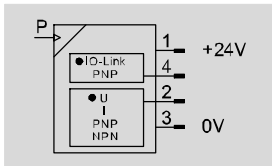

Variant without display

Output preset to current ... -LK-A

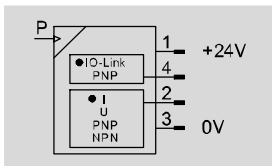

General technical data	
Certification	RCM trademark c UL us listed (OL)
CE marking (see declaration of conformity)	To EU EMC Directive
Electrical connection	To EN 60947-5-2, 4-pin plug connector, round design
Note on materials	RoHS compliant

Input signal, measuring element													
SPAU	-B2	-B11	-V025	-V05	-V1	-P025	-P05	-P1	-P2	-P6	-P10	-P12	-P16
Measured variable	Relative pressure												
Method of measurement	Piezoresistive pressure sensor with display												
Pressure measuring range starting value [bar]	-1		0										
Pressure measuring range final value [bar]	1	10	-0.25	-0.5	-1	0.25	0.5	1	2	6	10	12	16
Overload range [bar]	5	15	1	2	5	1	2	5	6	15	15	15	20
Operating medium	Compressed air to ISO 8573-1:2010 [7:4:4] Inert gases												
Note on operating/pilot medium	Lubricated operation possible												
Temperature of medium [°C]	0 ... +50												
Ambient temperature [°C]	0 ... +50												

Signal processing	
Resolution ADC [bit]	12

Output, general													
	-B2	-B11	-V025	-V05	-V1	-P025	-P05	-P1	-P2	-P6	-P10	-P12	-P16
Precision display FS [%]	1.5												2
Repetition accuracy [%]	0.3												
Temperature coefficient [%FS/K]	0.05												

Pressure sensors SPAU

Technical data

Switching output		
	-PNLK	-LK
Switching output	2x PNP or 2x NPN, switchable	2x PNP ¹⁾
Switching function	Freely programmable	
Switching element function	N/C or N/O contact, switchable	
Protection against short circuit	Yes	

1) Second PNP output can only be activated via IO-Link

Analogue output					
		-PNLK-PNVBA	-LK-A	-LK-V	-LK-B
Analogue output	[V]	0 ... 10	- ¹⁾	0 ... 10	- ¹⁾
	[V]	1 ... 5	- ²⁾	- ²⁾	1 ... 5
	[mA]	4 ... 20	4 ... 20	- ³⁾	- ³⁾
Rise time	[ms]	3			
Max. output current	[mA]	100			
Max. load resistance of current output	[Ω]	500			
Min. load resistance of voltage output	[kΩ]	10			

- 1) 0 ... 10 V analogue output can only be activated using IO-Link
- 2) 1 ... 5 V analogue output can only be activated using IO-Link
- 3) 4 ... 20 mA analogue output can only be activated using IO-Link

Output, additional data	
Protection against short circuit	Yes
Overload protection	Yes

IO-Link device to IEC 61131-9	
Protocol	IO-Link
IO-Link	
Protocol version	Device V 1.1
Profile	Smart Sensor profile
Function classes	Binary data channel (BDC)
	Diagnostics
	Identification
	Process data variable (PDV)
	Teach channel
Communication mode	COM2 (38.4 kbd)
SIO mode support	Yes
Port class	A
Process data width OUT	0 bytes
Process data width IN	2 bytes
Process data content IN	14 bit PDV (pressure reading)
	2 bit BDC (pressure monitoring)
Minimum cycle time	[ms] 3
Data memory required	[KB] 0.5

Pressure sensors SPAU

Technical data

Electronics		
Operating voltage range DC	[V]	20 ... 30
Protection against incorrect polarity		For all electrical connections

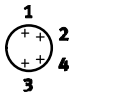
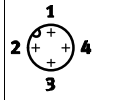
Pin allocation to EN 60947-5-2				
Plug connector, 4-pin				
M8x1	M12x1	Pin	Wire colour	Allocation
		1	Brown	Operating voltage: +24 V DC
		3	Blue	Operating voltage 0 V
		4	Black	Switching output (C/Q...)
		2	White	Switching output or analogue output

Display/operation		
SPAU	-L-PNLK	-LK
Display type	Illuminated LCD	LED
Displayable units	bar	-
	inchH2O	-
	inchHg	-
	kgf/cm ²	-
	kPa	-
	mmHg	-
	MPa	-
	psi	-
Setting options	IO-Link	
	Teach-in	-
	Via display and keys	-
Protection against tampering	PIN code	-
Threshold value setting range	[%]	0 ... 100
Hysteresis setting range	[%]	0 ... 90

Immissions/emissions	
Degree of protection	IP67, IP65 (front panel mounting)
Corrosion resistance class CRC ¹⁾	2

- 1) Corrosion resistance class 2 according to Festo standard 940070
 Components subject to moderate corrosion stress. External visible parts with primarily decorative surface requirements which are in direct contact with the surrounding industrial environment or media such as coolants or lubricating agents.

Pressure sensors SPAU

Technical data

Dimensions

Download CAD data → www.festo.com

SPAU-...-F...-L-PNLK-...

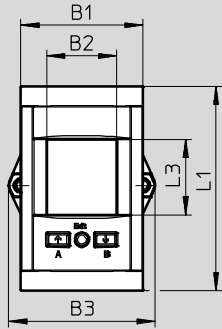

SPAU-...-L-PNLK-...

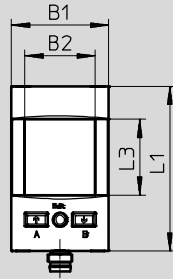

SPAU-...-LK-...

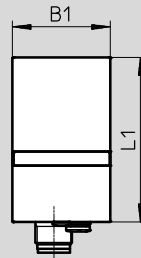

Type	B1	B2	B3	L1	L3
SPAU-...-F...-L-PNLK-...	40	23	48	67	24.8
SPAU-...-L-PNLK-...	32		-	54	
SPAU-...-LK-...					-

Pressure sensors SPAU

Technical data

Dimensions – Pressure supply ports

Download CAD data → www.festo.com

SPAU-...-G18M-...
 SPAU-...-R18M-...
 SPAU-...-N18M-...
 SPAU-...-M5F-...

SPAU-...-R14M-...

SPAU-...-M7F-...

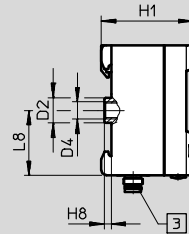
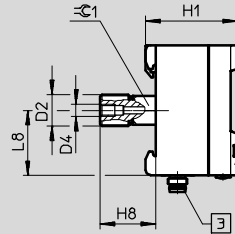
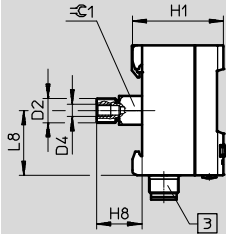

SPAU-...-G18MD-...
 SPAU-...-R18MD-...
 SPAU-...-N18MD-...
 SPAU-...-M7FD-...

SPAU-...-Q4D-...-MxU
 SPAU-...-Q6D-...MxU
 SPAU-...-Q532D-...MxU

SPAU-...-Q4D-...-MxD
 SPAU-...-Q532D-...MxD

SPAU-...-Q4-...-Mx
 SPAU-...-Q532-...Mx

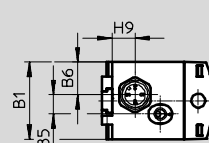
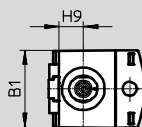
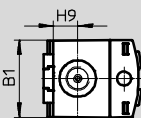
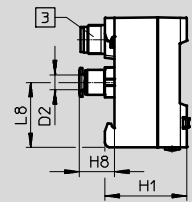
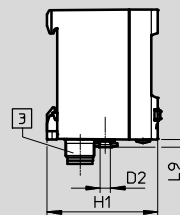
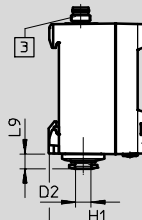
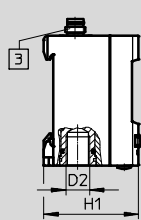

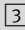
 Pressure supply port
 SPAU-...-M12... M12, 4pin
 SPAU-...-M8... M8, 4pin

Type	B1	B5	B6	D2	Thread length		Thread engagement	D4	H1	H8	H9	L8	L9	⌀C1				
					External (M)	Internal (F)												
SPAU-...-G18M-...-MxD	-			G1/8	8	-	Until stop	M5	37.9	19	-	27		12				
SPAU-...-R18M-...-MxD				R1/8			Min. 6,5											
SPAU-...-N18M-...-MxD				1/8 NPT			Min. 6,9											
SPAU-...-M5F-...-MxD				M5	6	Until stop												
SPAU-...-R14M-...-MxD				R1/4	12	Min. 9,7												
SPAU-...-M7F-...-MxD	32			M7	-	-	Until stop	M7	39.4	-	10	-	-	-				
SPAU-...-G18FD-...-MxU				G1/8			12								Until stop			
SPAU-...-R18FD-...-MxU				R1/8	8	Min. 6,5												
SPAU-...-N18FD-...-MxU				1/8 NPT		Min. 6,9												
SPAU-...-M7FD-...-MxU				M7		Until stop												
SPAU-...-Q4D-...-MxU				8	13.5		QS4	-	-	-	-	45.9	9.5	-	-	3	-	
SPAU-...-Q6D-...-MxU							QS6											6.1
SPAU-...-T532D-...-MxU							T5/32											
SPAU-...-Q4D-...-MxD				-	-		QS4	-	-	-	-	33.9	14.8	-	27	-	-	
SPAU-...-Q6-...-Mx							QS6											
SPAU-...-T532-...-Mx							T5/32											

Pressure sensors SPAU

Technical data

Dimensions – Front panel mounting



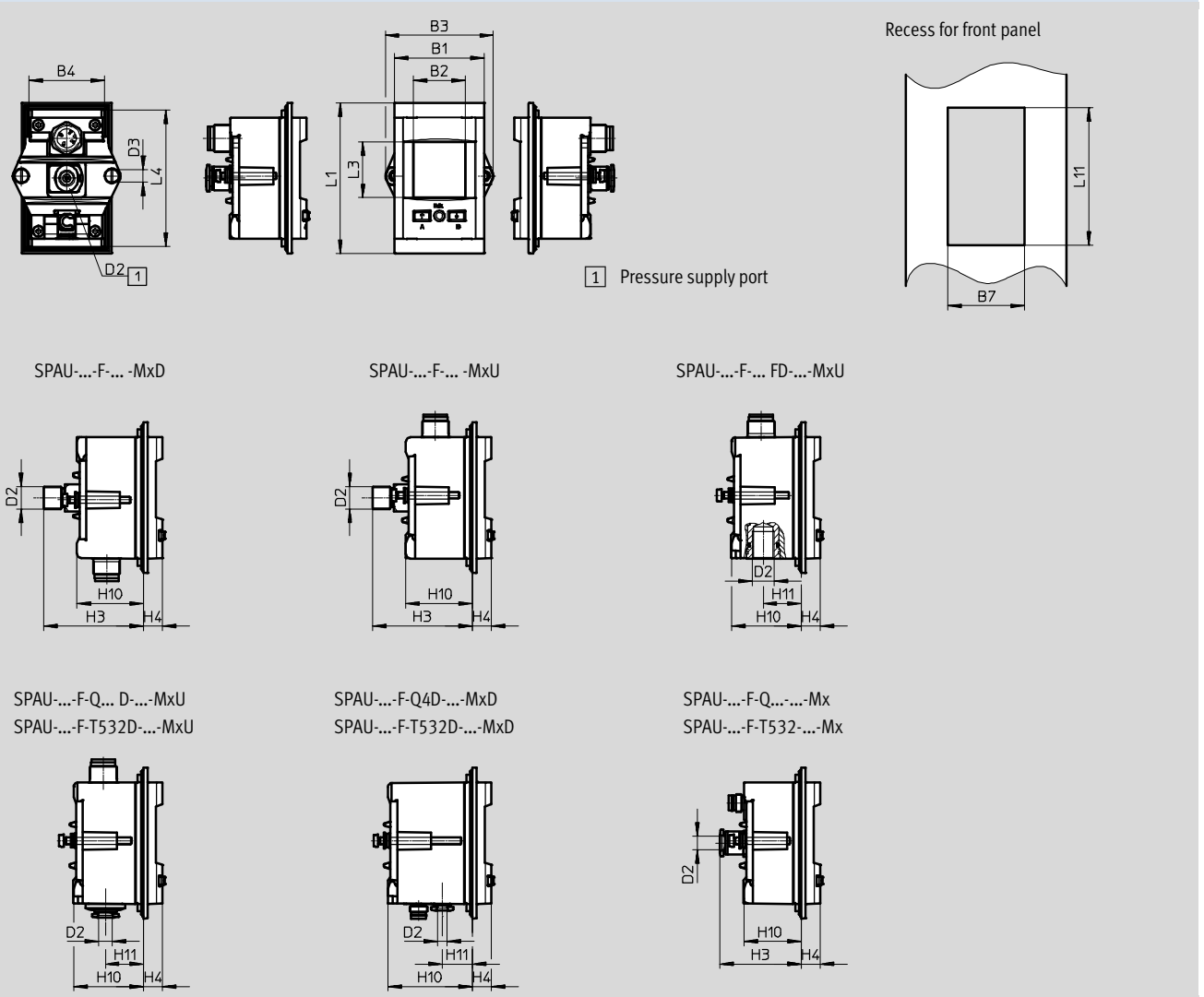



Download CAD data → www.festo.com



Type	B1	B2	B3	B4	B7 ±0.3	D2	D3	H3	H4	H10	H11	L1	L3	L4	L11 ±0.3	
SPAU-...-F-...18M-...-MxD	40	23	48	33.5	34	-	M3	44.4	8.4	29.5	-	67	24.8	60.5	61	
SPAU-...-F-R14M-...-MxD						R3/8		48.4								
SPAU-...-F-M7F-...-MxD						M7		28.4								
SPAU-...-F-M5F-...-MxD						M5		-								
SPAU-...-F-...18M-...-MxU						-		44.4								
SPAU-...-F-R14M-...-MxU						R3/4		48.4								
SPAU-...-F-M7F-...-MxU						M7		28.4								
SPAU-...-F-M5F-...-MxU						M5		-								
SPAU-...-F-...18FD-...-MxU						-		-								
SPAU-...-F-M7FD-...-MxU						M7		31								16.9
SPAU-...-F-Q...D-...-MxU						-		-								
SPAU-...-F-T532D-...-MxU						T5/32		-								
SPAU-...-F-Q4D-...-MxD						QS4		37.5								13.4
SPAU-...-F-T532D-...-MxD						T5/32		-								
SPAU-...-F-Q...-Mx						-		25.5								-
SPAU-...-F-T532-...-Mx						T5/32		-								



Pressure sensors SPAU



Technical data

Ordering data – Display variants							
	Type of mounting	Pneumatic connection	Outlet direction	Electrical connection	Outlet direction	Product weight	Part No. Type
Pressure measuring range –1 ... +1							
	Thread	R $\frac{1}{8}$	At the rear	M8x1	Underneath	80	8001207 SPAU-B2R-T-R18M-L-PNLK-PNVBA-M8D
		NPT1/8-27	At the rear	M8x1	Underneath	80	8001202 SPAU-P10R-T-N18M-L-PNLK-PNVBA-M8D
		NPT1/8-27	At the rear	M12x1	Underneath	80	8001205 SPAU-P10R-T-N18M-L-PNLK-PNVBA-M12D
	H-rail	G $\frac{1}{8}$	Underneath	M8x1	Top	70	8001219 SPAU-B2R-H-G18FD-L-PNLK-PNVBA-M8U
Pressure measuring range 0 ... –1							
	H-rail	G $\frac{1}{8}$	Underneath	M8x1	Top	70	8001223 SPAU-V1R-H-G18FD-L-PNLK-PNVBA-M8U
		QS-4	Underneath	M8x1	Underneath	65	8001213 SPAU-V1R-H-Q4D-L-PNLK-PNVBA-M8D
		QS-5/32	Underneath	M8x1	Underneath	65	8001217 SPAU-V1R-H-T532D-L-PNLK-PNVBA-M8D
		QS-5/32	Underneath	M12x1	Underneath	65	8001218 SPAU-V1R-H-T532D-L-PNLK-PNVBA-M12D
	Wall/surface bracket	G $\frac{1}{8}$	Underneath	M8x1	Top	70	8001235 SPAU-V1R-W-G18FD-L-PNLK-PNVBA-M8U
		G $\frac{1}{8}$	Underneath	M12x1	Top	70	8001234 SPAU-V1R-W-G18FD-L-PNLK-PNVBA-M12U
		QS-4	Underneath	M8x1	Underneath	65	8001239 SPAU-V1R-W-Q4D-L-PNLK-PNVBA-M8D
		QS-4	Underneath	M12x1	Underneath	65	8001214 SPAU-V1R-H-Q4D-L-PNLK-PNVBA-M12D
		QS-4	Underneath	M12x1	Underneath	65	8001238 SPAU-V1R-W-Q4D-L-PNLK-PNVBA-M12D
	Front panel mounting	QS-4	At the rear	M12x1	At the rear	70	8001227 SPAU-V1R-F-Q4-L-PNLK-PNVBA-M12
		QS-6	At the rear	M12x1	At the rear	70	8001228 SPAU-V1R-F-Q6-L-PNLK-PNVBA-M12
		QS-5/32	At the rear	M12x1	At the rear	70	8001229 SPAU-V1R-F-T532-L-PNLK-PNVBA-M12
Pressure measuring range 0 ... 2							
	Wall/surface bracket	G $\frac{1}{8}$	Underneath	M8x1	Top	70	8001232 SPAU-P2R-W-G18FD-L-PNLK-PNVBA-M8U
Pressure measuring range 0 ... 6							
	Wall/surface bracket	G $\frac{1}{8}$	Underneath	M8x1	Top	70	8001233 SPAU-P6R-W-G18FD-L-PNLK-PNVBA-M8U

Pressure sensors SPAU

Technical data

Ordering data – Display variants									
	Type of mounting	Pneumatic connection	Outlet direction	Electrical connection	Outlet direction	Product weight	Part No.	Type	
Pressure measuring range 0 ... 10									
	Thread	G $\frac{1}{8}$	At the rear	M8x1	Underneath	80	8001201	SPAU-P10R-T-G18M-L-PNLK-PNVBA-M8D	
		G $\frac{1}{8}$	At the rear	M12x1	Underneath	80	8001204	SPAU-P10R-T-G18M-L-PNLK-PNVBA-M12D	
		R $\frac{1}{8}$	At the rear	M8x1	Underneath	80	8001203	SPAU-P10R-T-R18M-L-PNLK-PNVBA-M8D	
		R $\frac{1}{8}$	At the rear	M12x1	Underneath	80	8001206	SPAU-P10R-T-R18M-L-PNLK-PNVBA-M12D	
		R $\frac{1}{4}$	At the rear	M8x1	Underneath	80	8001209	SPAU-P10R-T-R14M-L-PNLK-PNVBA-M8D	
		R $\frac{1}{4}$	At the rear	M12x1	Underneath	80	8001208	SPAU-P10R-T-R14M-L-PNLK-PNVBA-M12D	
	H-rail	G $\frac{1}{8}$	Underneath	M8x1	Top	70	8001221	SPAU-P10R-H-G18FD-L-PNLK-PNVBA-M8U	
		G $\frac{1}{8}$	Underneath	M12x1	Top	70	8001220	SPAU-P10R-H-G18FD-L-PNLK-PNVBA-M12U	
		QS-4	Underneath	M8x1	Underneath	65	8001211	SPAU-P10R-H-Q4D-L-PNLK-PNVBA-M8D	
		QS-4	Underneath	M12x1	Underneath	65	8001212	SPAU-P10R-H-Q4D-L-PNLK-PNVBA-M12D	
		QS-5/32	Underneath	M8x1	Underneath	65	8001215	SPAU-P10R-H-T532D-L-PNLK-PNVBA-M8D	
	Wall/surface bracket	QS-5/32	Underneath	M12x1	Underneath	65	8001216	SPAU-P10R-H-T532D-L-PNLK-PNVBA-M12D	
		G $\frac{1}{8}$	Underneath	M8x1	Top	70	8001231	SPAU-P10R-W-G18FD-L-PNLK-PNVBA-M8U	
		G $\frac{1}{8}$	Underneath	M12x1	Top	70	8001230	SPAU-P10R-W-G18FD-L-PNLK-PNVBA-M12U	
QS-4		Underneath	M8x1	Underneath	70	8001236	SPAU-P10R-W-Q4D-L-PNLK-PNVBA-M12D		
Front panel mounting	QS-4	Underneath	M12x1	Underneath	70	8001237	SPAU-P10R-W-Q4D-L-PNLK-PNVBA-M8D		
	QS-4	Underneath	M12x1	Underneath	70	8001224	SPAU-P10R-F-Q4-L-PNLK-PNVBA-M12		
	QS-6	Underneath	M12x1	Underneath	70	8001225	SPAU-P10R-F-Q6-L-PNLK-PNVBA-M12		
	QS-5/32	Underneath	M12x1	Underneath	70	8001226	SPAU-P10R-F-T532-L-PNLK-PNVBA-M12		
	Pressure measuring range 0 ... 16								
		Thread	R $\frac{1}{4}$	At the rear	M8x1	Underneath	80	8001210	SPAU-P16R-T-R14M-L-PNLK-PNVBA-M8D
H-rail		G $\frac{1}{8}$	Underneath	M12x1	Top	70	8001222	SPAU-P16R-H-G18FD-L-PNLK-PNVBA-M12U	

Ordering data – Variants without display								
	Type of mounting	Pneumatic connection	Outlet direction	Electrical connection	Analogue output	Product weight	Part No.	Type
Pressure measuring range 0 ... -1								
	Thread	G $\frac{1}{8}$	At the rear	M12x1	0 ... 10 V	80	8003347	SPAU-V1R-T-G18M-LK-V-M12D
			At the rear		4 ... 20 mA		8003348	SPAU-V1R-T-G18M-LK-A-M12D
	H-rail	QS-4	Underneath	Underneath	0 ... 10 V	65	8003351	SPAU-V1R-H-Q4D-LK-V-M12D
			Underneath		4 ... 20 mA		8003352	SPAU-V1R-H-Q4D-LK-A-M12D
Pressure measuring range 0 ... 10								
	Thread	G $\frac{1}{8}$	At the rear	M12x1	0 ... 10 V	80	8003345	SPAU-P10R-T-G18M-LK-V-M12D
			At the rear		4 ... 20 mA		8003346	SPAU-P10R-T-G18M-LK-A-M12D
	H-rail	QS-4	Underneath	Underneath	0 ... 10 V	65	8003349	SPAU-P10R-H-Q4D-LK-V-M12D
			Underneath		4 ... 20 mA		8003350	SPAU-P10R-H-Q4D-LK-A-M12D

Pressure sensors SPAU

Ordering data – Modular product system

M Mandatory data →

Module no.	Product type		Supply port	
8001200	Pressure measuring range		Type of mounting	
	Pressure sensor SPAU	-1 ... 1 bar -1 ... 10 bar 0 ... -0.25 bar 0 ... -0.5 bar 0 ... -1 bar 0 ... 0.25 bar 0 ... 0.5 bar 0 ... 1 bar 0 ... 2 bar 0 ... 6 bar 0 ... 10 bar 0 ... 12 bar 0 ... 16 bar	Relative pressure	Threaded mounting Mounting bracket Front panel mounting H-rail mounting Wall mounting
Order example				
8001200	SPAU	- P10	R	- H

Ordering table

Pressure sensor SPAU		Condi- tions	Code	Entry code
M Module no.	8001200			
Product type	SPAU, U series	SPAU		SPAU
Pressure measuring range	-1 ... 1 bar	-B2		
	-1 ... 10 bar	-B11		
	0 ... -0.25 bar	-V025		
	0 ... -0.5 bar	-V05		
	0 ... -1 bar	-V1		
	0 ... 0.25 bar	-P025		
	0 ... 0.5 bar	-P05		
	0 ... 1 bar	-P1		
	0 ... 2 bar	-P2		
	0 ... 6 bar	-P6		
	0 ... 10 bar	-P10		
	0 ... 12 bar	-P12		
	0 ... 16 bar	-P16		
	Supply port	Relative pressure	R	
Type of mounting	Threaded mounting	-T		
	Mounting bracket	-A		
	Front panel mounting	-F		
	H-rail mounting	-H		
	Wall mounting	-W		

Transfer order code

Pressure sensors SPAU

Ordering data – Modular product system

➔ **M Mandatory data**

Pneumatic connection		Outlet direction	
Thread type		Display	
G 1/8 M5 M7 NPT 1/8 Push-in connector 4 mm Push-in connector 6 mm R 1/4 R 1/8 Push-in connector 5/32	None Male thread Female thread	At the rear Underneath	None LCD, backlit
G18	F	D	L

Ordering table					
Pressure sensor SPAU		Condi- tions	Code	Entry code	
M Pneumatic connection	G 1/8	-G18			
	M5	-M5	1		
	M7	-M7			
	NPT 1/8	-N18			
	Push-in connector 4 mm	-Q4	2		
	Push-in connector 6 mm	-Q6	2		
	R 1/4	-R14	15		
	R 1/8	-R18			
	Push-in connector 5/32	-T532	2		
	Thread type	None			
		Male thread	M		3 , 4
		Female thread	F		3 , 5
	Outlet direction	At the rear			6
		Underneath	D		7
	Display	Without			
LCD, backlit		-L	8		

- 1** Only with mounting type A, F
- 2** Not with mounting type T
Not with pressure measuring range P16
- 3** Mandatory in combination with G1/8, N1/8, R1/8, R1/4, M7, M5
- 4** Not with mounting type W, H
Not with pneumatic connection Q4, Q6, T532, M7, M5
- 5** Not with mounting type A if pneumatic connection G1/8, R1/8, N1/8
- 6** Not with mounting type W, H
Not with thread type F if pneumatic connection G1/8, R1/8, N1/8
- 7** Not with pneumatic connection M5
Not with mounting type A
Not with thread type M
- 8** In combination with mounting type F

Transfer order code

– – – –

Pressure sensors SPAU

Ordering data – Modular product system

→ **M** **Mandatory data**

Electrical output 1		Electrical connection		Electrical accessories	
Electrical output 2		Electrical outlet direction		Protective devices	
IO-Link PNP or NPN or IO-Link	4 ... 20 mA 1 ... 5 V PNP or NPN or 0 ... 10 V or 1 ... 5 V 4 ... 20 mA	M8 plug connector M12 plug connector, A-coded	Top Underneath At the rear	None Angled socket, cable 2.5 m Straight socket, cable 2.5 m Angled socket, cable 5 m Straight socket, cable 5 m	None Safety guard
- PNLK	- PNVBA	- M8	U	+	

Ordering table					
SPA		Condi- tions	Code	Entry code	
M	Electrical output 1	PNP or NPN or IO-Link	-PNLK	<u>10</u>	
		IO-Link	-LK	<u>9</u>	
	Electrical output 2	PNP or NPN or 0 ... 10 V or 1 ... 5 V or 4 ... 20 mA	-PNVBA	<u>10</u>	
		0 ... 10 V	-V	<u>9</u>	
		1 ... 5 V	-B	<u>9</u>	
		4 ... 20 mA	-A	<u>9</u>	
	Electrical connection	M8 plug connector	-M8		
		M12 plug connector, A-coded	-M12		
	Electrical outlet direction	Top	U	<u>13</u>	
		Underneath	D	<u>12</u>	
		At the rear		<u>11</u>	
	Electrical accessories	None			
		Angled socket, cable 2.5 m	+2,5A		
		Straight socket, cable 2.5 m	+2,5S		
		Angled socket, cable 5 m	+5A		
		Straight socket, cable 5 m	+5S		
	Protective devices	None			
		Safety guard	G	<u>16</u>	
	Certificate	None			
		Test report	T		

- 9 Not with display L
- 10 Not without display
- 11 Only with mounting type A, F
Not with G18, N18, R18, M7, M5
Not with outlet direction D, U
Only with thread type None
- 12 Only with outlet direction D if QS4
or T532 selected
Not with outlet direction at the rear
if QS4, QS6, T532
- 13 Only with outlet direction U if QS4
or T532 selected
Not with outlet direction at the rear
if QS4, QS6, T532
- 15 Only with thread type M
Outlet direction at the rear only
Not with mounting type W/H
Not with electrical outlet direction at the rear
- 16 Only with display L

Transfer order code

- - - +

Pressure sensors SPAU

Accessories – Ordering data

Mounting bracket SAMH-PU-A

on even surfaces

Type of mounting: With through-hole and template

Material: High-alloy stainless steel

Note on materials: RoHS compliant

Only for variants with:
Pneumatic connection
Outlet direction at the rear

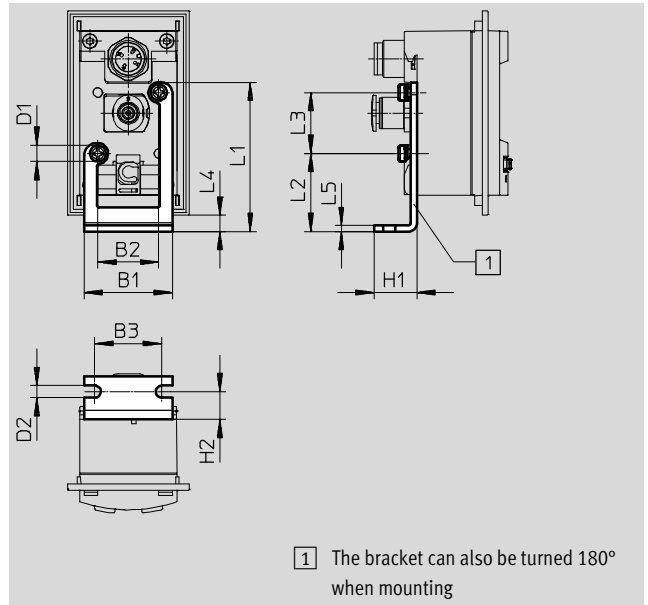

Ordering data

Type	B1	B2	B3	D1	D2	H1	H2	L1	L2	L3	L4	L5	CRC ¹⁾	Part No.	Type
SAMH-PU-A	29	20	22	M3x8	4	14	9	49	25.6	20	8.6	2	2	8003354	SAMH-PU-A

1) Corrosion resistance class CRC 2 to Festo standard FN 940070
Moderate corrosion stress. Indoor applications in which condensation may occur. External visible parts with primarily decorative requirements for the surface and which are in direct contact with the ambient atmosphere typical for industrial applications.

Wall mounting SAMH-PU-W

For H-rail mounting

Type of mounting: With through-hole

Material: High-alloy stainless steel

Note on materials: RoHS compliant

Only for variants with:
Pneumatic connection
Outlet direction underneath

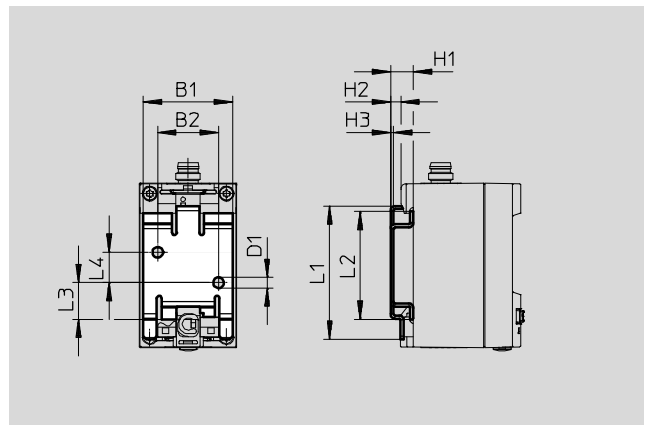

Dimensions and ordering data

Type	B1	B2	D1	H1	H2	H3	L1	L2	L3	L4	CRC ¹⁾	Part No.	Type
SAMH-PU-W	29.4	20	3.5	7.5	3.4	1	43.8	35.4	12	10	2	8003355	SAMH-PU-W

1) Corrosion resistance class CRC 2 to Festo standard FN 940070
Moderate corrosion stress. Indoor applications in which condensation may occur. External visible parts with primarily decorative requirements for the surface and which are in direct contact with the ambient atmosphere typical for industrial applications.

Pressure sensors SPAU

Accessories – Ordering data

Safety guard SACC-PU-G

to protect the display and control elements

Material: PA

Note on materials:
RoHS compliant

Only for variants with: Display

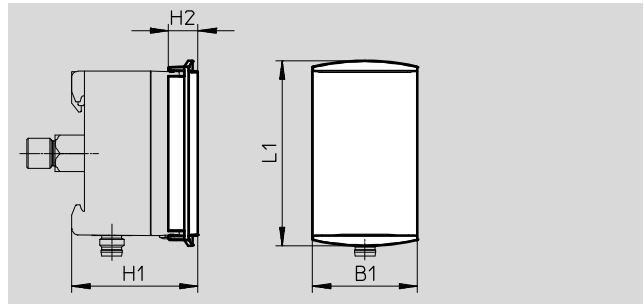

Dimensions and ordering data



Type		B1	H1	H2	L1	CRC ¹⁾	Part No.	Type
SACC-PU-G	SPAU- ... R-T- ...	34.5	41.6	9.6	60.8	2	8003353	SACC-PU-G
	SPAU- ... R-H- ... -D-L- ...		49.6					
	SPAU- ... R-H- ... -FD-L- ...		43.6					
	SPAU- ... R-F- ...		37.6					
	SPAU- ... R-W- ... -D-L- ...		43.6					
	SPAU- ... R-W- ... -FD-L- ...		49.6					

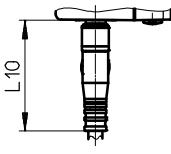
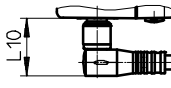
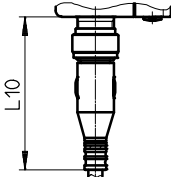
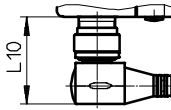

1) Corrosion resistance class CRC 2 to Festo standard FN 940070
Moderate corrosion stress. Indoor applications in which condensation may occur. External visible parts with primarily decorative requirements for the surface and which are in direct contact with the ambient atmosphere typical for industrial applications.

Pressure sensors SPAU

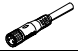
Accessories – Ordering data

Connecting cables			L10
 	M8	Straight socket	36.3
		Angled socket	18.7
 	M12	Straight socket	50
		Angled socket	28.5

Ordering data					Technical data → Internet: nebu
	Number of wires	Cable length [m]	Part No.	Type	
M8x1, straight socket					
	4	2.5	541342	NEBU-M8G4-K-2.5-LE4	
		5	541343	NEBU-M8G4-K-5-LE4	
M8x1, angled socket					
	4	2.5	541344	NEBU-M8W4-K-2.5-LE4	
		5	541345	NEBU-M8W4-K-5-LE4	

Ordering data					Technical data → Internet: nebu
	Number of wires	Cable length [m]	Part No.	Type	
M12x1, straight socket					
	4	2.5	550326	NEBU-M12G5-K-2.5-LE4	
		5	541328	NEBU-M12G5-K-5-LE4	
M12x1, angled socket					
	4	2.5	550325	NEBU-M12W5-K-2.5-LE4	
		5	541329	NEBU-M12W5-K-5-LE4	

Product Range and Company Overview

A Complete Suite and Company Overview

Our experienced engineers provide complete support at every stage of your development process, including: conceptualization, analysis, engineering, design, assembly, documentation, validation, and production.



Custom Automation Components
Complete custom engineered solutions



Custom Control Cabinets
Comprehensive engineering support and on-site services



Complete Systems
Shipment, stocking and storage services

The Broadest Range of Automation Components

With a comprehensive line of more than 30,000 automation components, Festo is capable of solving the most complex automation requirements.



Electromechanical
Electromechanical actuators, motors, controllers & drivers



Pneumatics
Pneumatic linear and rotary actuators, valves, and air supply



PLCs and I/O Devices
PLC's, operator interfaces, sensors and I/O devices

Supporting Advanced Automation... As No One Else Can!

Festo is a leading global manufacturer of pneumatic and electromechanical systems, components and controls for industrial automation, with more than 16,000 employees in 60 national headquarters serving more than 180 countries. For more than 80 years, Festo has continuously elevated the state of manufacturing with innovations and optimized motion control solutions that deliver higher performing, more profitable automated manufacturing and processing equipment. Our dedication to the advancement of automation extends beyond technology to the education and development of current and future automation and robotics designers with simulation tools, teaching programs, and on-site services.

Quality Assurance, ISO 9001 and ISO 14001 Certifications

Festo Corporation is committed to supply all Festo products and services that will meet or exceed our customers' requirements in product quality, delivery, customer service and satisfaction.

To meet this commitment, we strive to ensure a consistent, integrated, and systematic approach to management that will meet or exceed the requirements of the ISO 9001 standard for Quality Management and the ISO 14001 standard for Environmental Management.



© Copyright 2013, Festo Corporation. While every effort is made to ensure that all dimensions and specifications are correct, Festo cannot guarantee that publications are completely free of any error, in particular typing or printing errors. Accordingly, Festo cannot be held responsible for the same. For Liability and Warranty conditions, refer to our "Terms and Conditions of Sale", available from your local Festo office. All rights reserved. No part of this publication may be reproduced, distributed, or transmitted in any form or by any means, electronic, mechanical, photocopying or otherwise, without the prior written permission of Festo. All technical data subject to change according to technical update.



Printed on recycled paper at New Horizon Graphic, Inc., FSC certified as an environmental friendly printing plant.

Festo North America

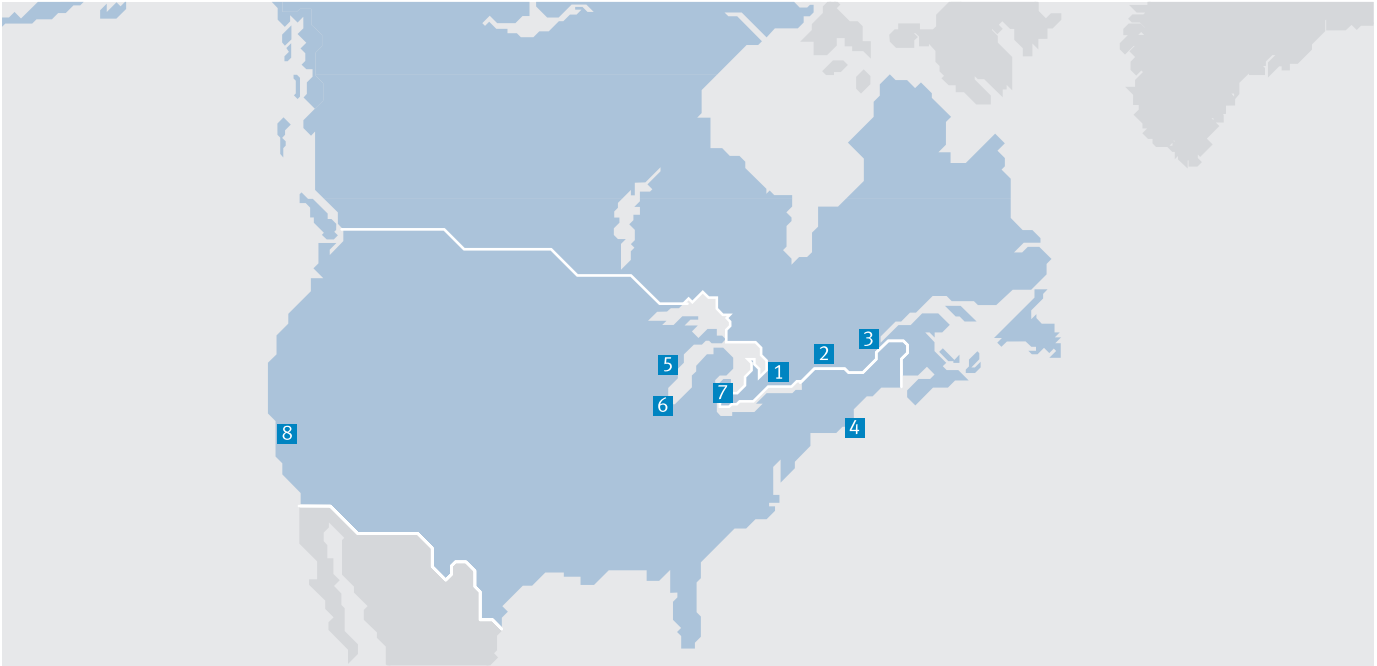

**1 Festo Canada
Headquarters
Festo Inc.**
5300 Explorer Drive
Mississauga, ON
L4W 5G4

2 Montréal
5600, Trans-Canada
Pointe-Claire, QC
H9R 1B6

3 Québec City
2930, rue Watt#117
Québec, QC
G1X 4G3



**4 Festo United States
Headquarters
Festo Corporation**
395 Moreland Road
Hauppauge, NY
11788

5 Appleton
North 922 Tower View Drive, Suite N
Greenville, WI
54942

7 Detroit
1441 West Long Lake Road
Troy, MI
48098

6 Chicago
85 W Algonquin - Suite 340
Arlington Heights, IL
60005

8 Silicon Valley
4935 Southfront Road, Suite F
Livermore, CA
94550

Festo Regional Contact Center

Canadian Customers

Commercial Support:
Tel: 1 877 GO FESTO (1 877 463 3786)
Fax: 1 877 FX FESTO (1 877 393 3786)
Email: festo.canada@ca.festo.com

Technical Support:

Tel: 1 866 GO FESTO (1 866 463 3786)
Fax: 1 877 FX FESTO (1 877 393 3786)
Email: technical.support@ca.festo.com

USA Customers

Commercial Support:
Tel: 1 800 99 FESTO (1 800 993 3786)
Fax: 1 800 96 FESTO (1 800 963 3786)
Email: customer.service@us.festo.com

Technical Support:

Tel: 1 866 GO FESTO (1 866 463 3786)
Fax: 1 800 96 FESTO (1 800 963 3786)
Email: product.support@us.festo.com