

Parallel grippers HGP, with protective dust cap



Parallel grippers HGP, with protective dust cap

Key features

At a glance

- Double-acting piston drive
- With protective dust cap for use in dusty environments (protection class IP54)
- Self-centring
- Variable gripping action:
 - External/internal gripping
- High gripping force and compact size
- Max. repetition accuracy
- Internal fixed flow control
- Versatility thanks to externally adaptable gripper fingers
- Wide range of options for mounting on drive units
- Sensor technology:
 - Adaptable proximity sensors for the small grippers
 - Integratable proximity sensors for the medium and large gripper sizes

 Note
Gripper selection sizing software
➔ www.festo.com

Mounting options for external gripper fingers (customer-specific)

- 1 Parallel gripper
- 2 External gripper finger
- 3 Mounting screws
- 4 Centring pins

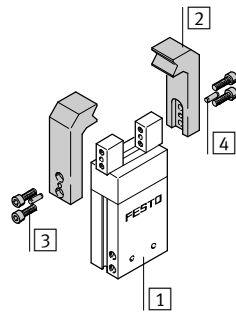

 Note
These grippers should always be used with exhaust air flow control. They are not suitable for the following or similar applications:

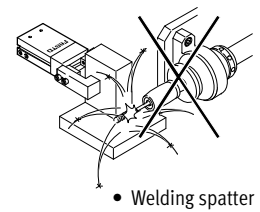
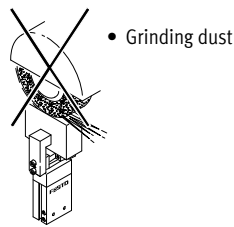
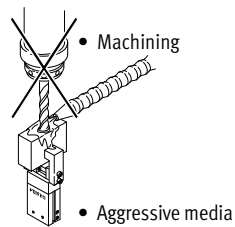

Parallel grippers HGP, with protective dust cap

Peripherals overview and type codes

Peripherals overview

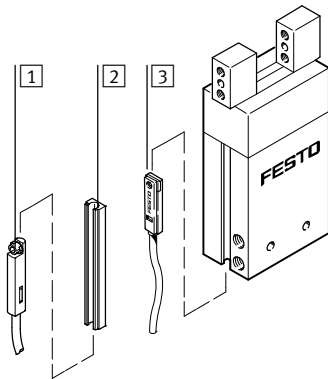

System product for handling and assembly technology

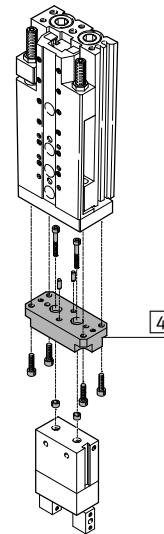

Accessories			
Type	Brief description		→ Page/Internet
1	Proximity sensor SME/SMT-10	For sensing the piston position	10
2	Bondable sensor rail HGP-SL	Enables the use of proximity sensors SME/SMT-10	9
3	Proximity sensor SME/SMT-8	For sensing the piston position	9
4	–	Drive/gripper connections	adapter kit

Type codes

HGP		–	16	–	A	–	B	–	SSK
Type									
HGP	Parallel gripper								
Size									
Position sensing									
A	Via proximity sensor								
Generation									
B	B series								
Protective dust cap									
SSK	Protective dust cap								

Parallel grippers HGP, with protective dust cap

FESTO

Technical data

Function
Double-acting

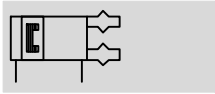

Size
16, 25 mm

Stroke
10, 14 mm

General technical data			
Size	16		25
Design	Lever		
Mode of operation	Double-acting		
Gripper function	Parallel		
Number of gripper jaws	2		
Max. load per external gripper finger ¹⁾	[g]	40	80
Stroke per gripper jaw	[mm]	5	7.5
Pneumatic connection	M3		G $\frac{1}{8}$
Repetition accuracy ²⁾	[mm]	≤ 0.04	
Max. interchangeability	[mm]	0.2	
Max. operating frequency	[Hz]	4	
Position sensing	Via proximity sensor		
Type of mounting	Via female thread and centring sleeve		
	Via through-hole and centring sleeve		
Mounting position	Any		
Product weight	[g]	197	737

1) Valid for unthrottled operation

2) End-position drift under constant conditions of use with 100 consecutive strokes in the direction of movement of the gripper jaws

Note: This product conforms to ISO 1179-1 and to ISO 228-1

Operating and environmental conditions			
Min. operating pressure	[bar]	2	
Max. operating pressure	[bar]	8	
Operating medium	Compressed air in accordance with ISO 8573-1:2010 [7:4:4]		
Note on operating/pilot medium	Operation with lubricated medium possible (in which case lubricated operation will always be required)		
Ambient temperature	[°C]	+5 ... +60	
Corrosion resistance class CRC ¹⁾		1	

1) Corrosion resistance class 1 according to Festo standard 940 070

Components subject to low corrosion stress. Transport and storage protection. Parts that do not have primarily decorative surface requirements, e.g. in internal areas that are not visible or behind covers.

Parallel grippers HGP, with protective dust cap

Technical data

Materials

Sectional view

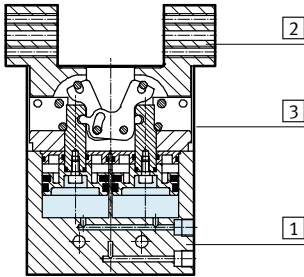

Parallel gripper		
1	Housing	Hard anodised aluminium
2	Gripper jaw	High-alloy steel
3	Cover cap	Polyamide
-	Protective dust cap	Vulcanised thermoplastic
-	Note on materials	Free of copper and PTFE RoHS-compliant

Gripping force [N] at 6 bar

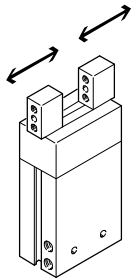

Size	16	25
Gripping force per gripper jaw		
Opening	70	185
Closing	80	170
Total gripping force		
Opening	140	370
Closing	160	340

Characteristic load values per gripper jaw

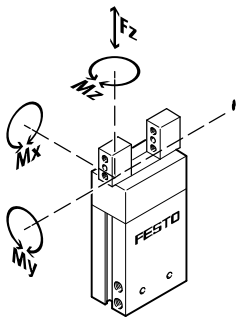

The indicated permissible forces and torques apply to a single gripper jaw. The indicated values include the lever arm, additional applied loads caused

by the workpiece or external gripper fingers, as well as forces which occur during movement.

The zero coordinate line (gripper jaw guide) must be taken into consideration for the calculation of torques.

Size	16	25	
Max. permissible force F_z	[N]	90	240
Max. permissible torque M_x	[Nm]	3.3	11
Max. permissible torque M_y	[Nm]	3.3	11
Max. permissible torque M_z	[Nm]	3.3	11

Parallel grippers HGP, with protective dust cap

Technical data

Mass moment of inertia [$\text{kgm}^2 \times 10^{-4}$]

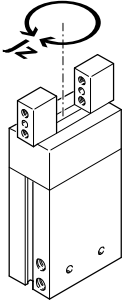

Mass moment of inertia [$\text{kgm}^2 \times 10^{-4}$] for parallel grippers in relation to the central axis, without external gripper fingers, without load.

Size	16	25
HGP-...	0.47	3.83

Opening and closing times [ms] at 6 bar

Without external gripper fingers

With external gripper fingers

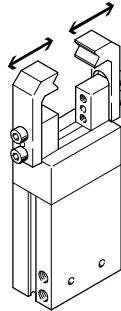
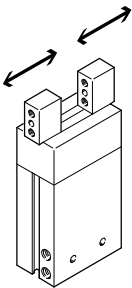

The indicated opening and closing times [ms] have been measured at room temperature and 6 bar operating pressure without external gripper fingers.

The grippers must be throttled for greater loads [g]. Opening and closing times must then be adjusted accordingly.

Size	16		25
Without external gripper fingers			
HGP-...	Opening	44	47
	Closing	60	50
With external gripper fingers (as a function of the load)			
HGP-...	100 g	100	-
	150 g	200	100
	200 g	300	200
	300 g	-	300

Parallel grippers HGP, with protective dust cap

Technical data

Gripping force F_H per gripper jaw as a function of operating pressure and lever arm x

External and internal gripping (closing and opening)

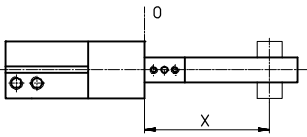

Gripping forces as a function of operating pressure and lever arm (distance from the zero co-ordinate line shown

opposite to the pressure point at which the fingers grip the workpiece)

can be determined for the various sizes from the following graphs.

HGP-16-...

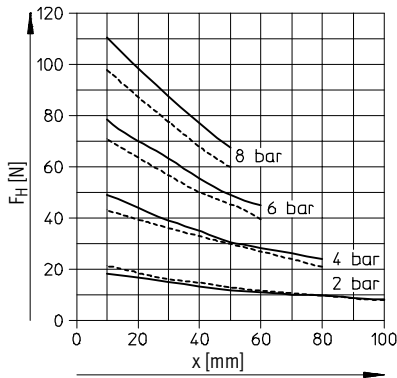

HGP-25-...

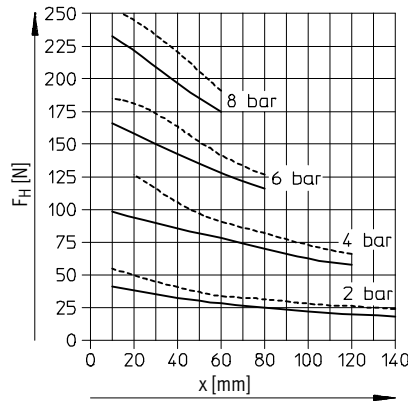

— Closing
- - - Opening

Gripping force F_H per gripper jaw at 6 bar as a function of lever arm x and eccentricity y

External and internal gripping (closing and opening)

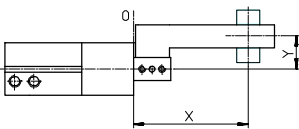

Gripping forces at 6 bar as a function of eccentric application of force (distance from the zero co-ordinate line

shown opposite to the pressure point at which the fingers grip the work-piece) and the maximum permissible

off-centre point at which force is applied can be determined for the various sizes from the following graphs.

Calculation example

Given:

HGP-16-A-B-SSK

Lever arm $x = 20$ mm

Eccentricity $y = 22$ mm

To be calculated:

Gripping force at 6 bar

Procedure:

- Determine the intersection xy between lever arm x and eccentricity y in the graph for HGP-16-...

- Draw an arc (with centre at origin) through intersection xy
 - Determine the intersection between the arc and X-axis
 - Read the gripping force
- Result:
Gripping force = approx. 66 N

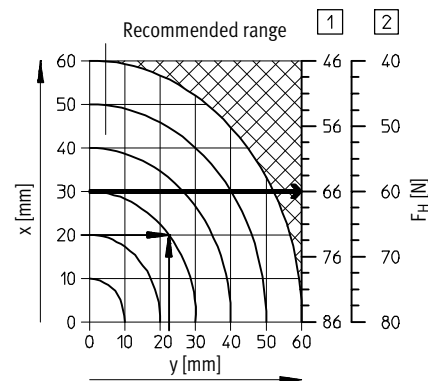

HGP-16-...

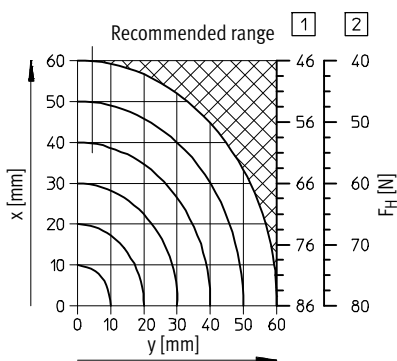

HGP-25-...

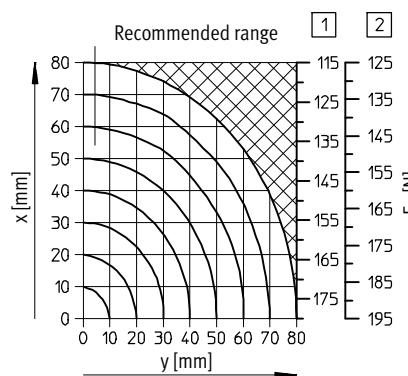

1 closing
2 opening

Parallel grippers HGP, with protective dust cap

Technical data

FESTO

Dimensions

Download CAD data → www.festo.com

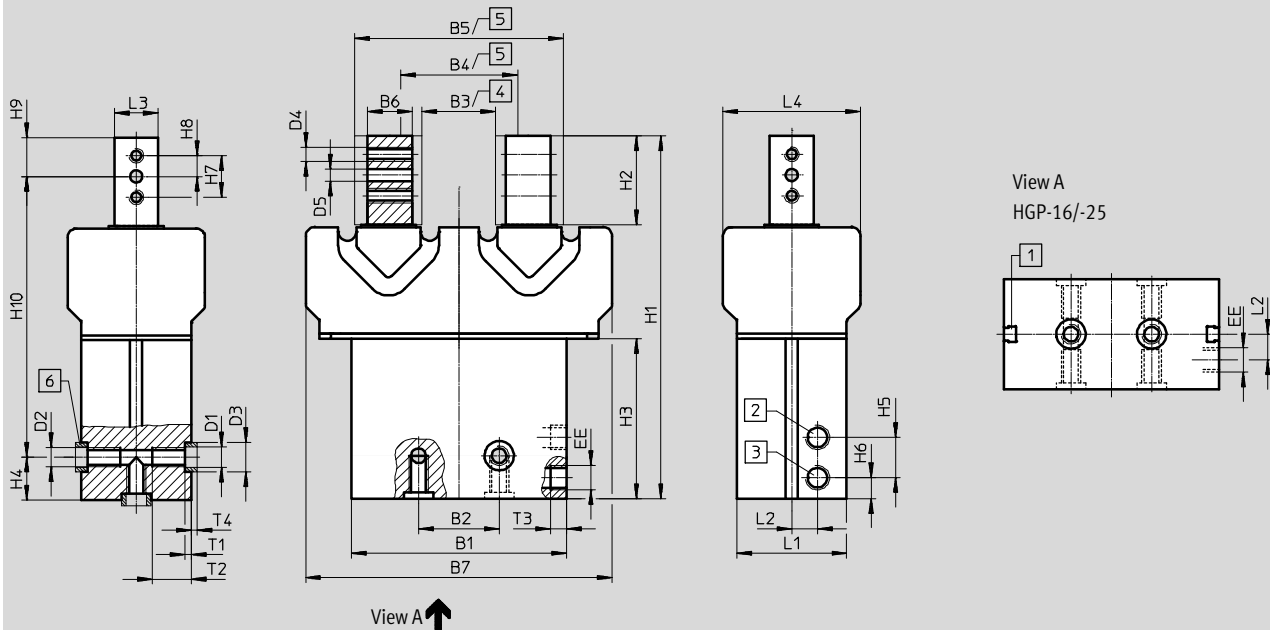

1 Slot for proximity sensor SME/SMT-8
Proximity sensors SME-/SMT-10 can also be used in combination with the bondable sensor rail.

2 Supply port, opening
3 Supply port, closing
4 Closed
5 Open
6 Centring sleeves ZBH (2 included in the scope of delivery)

The distance H5 = 7 mm between the two air connections on types HGP-16 means that only the following fittings can be used:

- QSM-M3-3
- QSML-M3-3
- QSMLL-M3-3
- CN-M3-PK-3
- LCN-M3-PK-3

Size	B1	B2 ¹⁾	B3	B4	B5	B6	B7	D1	D2	D3	D4	D5	EE	H1	H2	H3
[mm]		±0.1	±0.5	±0.5	±0.5	-0.03	±0.5	∅		∅		∅				
16	47	25	16.4	26.4	46.4	10	67	5.3	M4	7	M4	3	M3	83	20.5	38.1
25	68.2	29	21	36	66	15	101	6.4	M6	9	M5	4	G3/8	126.8	31.5	58.8

Size	H4 ²⁾	H5	H6	H7	H8	H9	H10	L1	L2	L3	L4	T1	T2	T3	T4
[mm]	±0.1						±0.2			-0.03		+0.1	+1	+0.5	-0.3
16	7.5	7	4	11	5.5	10	65.5	22	5.7	10	30	1.6	7.5	3.5	1.4
25	17.5	16.5	8.3	16	8	15	94.3	37	10.5	15	47	2.1	15	6.5	1.9

1) Tolerance for centring hole: ±0.02

2) Tolerance for centring hole: -0.05

• Note: This product conforms to ISO 1179-1 and to ISO 228-1

Ordering data

Size	Part No.	Type
16	539636	HGP-16-A-B-SSK
25	539635	HGP-25-A-B-SSK

Parallel grippers HGP, with protective dust cap

Accessories

Sensor rail HGP-SL

bondable

Material:

Wrought aluminium alloy

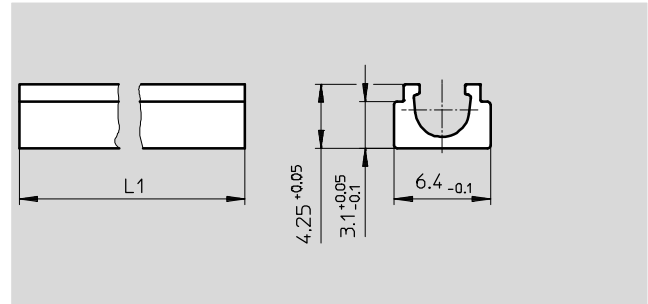



Dimensions and ordering data					
For size [mm]	L1	Weight [g]	Part No.	Type	
16	38	1.5	535583	HGP-SL-10-16	
25	58	2.3	535585	HGP-SL-10-25	

Ordering data						
Type	For size	Weight [g]	Part No.	Type	PU ¹⁾	
Centring sleeve ZBH			Technical data → Internet: zbh			
	16	1	186717	ZBH-7	10	
	25		150927	ZBH-9		

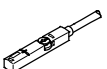
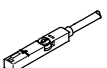
1) Packaging unit

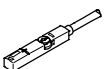
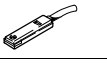
Ordering data – Proximity sensors for T-slot, magneto-resistive						
	Type of mounting	Switch output	Electrical connection	Cable length [m]	Part No.	Type
N/O contact						
	Insertable in the slot from above, flush with cylinder profile, short design	PNP	Cable, 3-wire	2.5	574335	SMT-8M-A-PS-24V-E-2,5-OE
			Plug M8x1, 3-pin	0.3	574334	SMT-8M-A-PS-24V-E-0,3-M8D
		NPN	Cable, 3-wire	2.5	574338	SMT-8M-A-NS-24V-E-2,5-OE
			Plug M8x1, 3-pin	0.3	574339	SMT-8M-A-NS-24V-E-0,3-M8D
N/C contact						
	Insertable in the slot from above, flush with cylinder profile, short design	PNP	Cable, 3-wire	7.5	574340	SMT-8M-A-PO-24V-E-7,5-OE

Ordering data – Proximity sensors for T-slot, magnetic reed						
	Type of mounting	Switching output	Electrical connection	Cable length [m]	Part No.	Type
N/O contact						
	Insertable in the slot from above, flush with the cylinder profile	Contacting	Cable, 3-wire	2.5	543862	SME-8M-DS-24V-K-2,5-OE
				5.0	543863	SME-8M-DS-24V-K-5,0-OE
			Cable, 2-wire	2.5	543872	SME-8M-ZS-24V-K-2,5-OE
			Plug M8x1, 3-pin	0.3	543861	SME-8M-DS-24V-K-0,3-M8D
	Insertable in the slot lengthwise, flush with the cylinder profile	Contacting	Cable, 3-wire	2.5	150855	SME-8-K-LED-24
			Plug M8x1, 3-pin	0.3	150857	SME-8-S-LED-24
N/C contact						
	Insertable in the slot lengthwise, flush with the cylinder profile	Contacting	Cable, 3-wire	7.5	160251	SME-8-0-K-LED-24



Parallel grippers HGP, with protective dust cap

FESTO

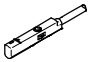
Accessories

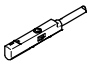
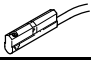
Ordering data – Proximity sensors for C-slot, magneto-resistive						Technical data → Internet: sm
	Type of mounting	Switching output	Electrical connection, connection direction	Cable length [m]	Part No.	Type
N/O contact						
	Insertable in the slot from above	PNP	Cable, 3-wire, in-line	2.5	551373	SMT-10M-PS-24V-E-2,5-L-OE
			Plug M8x1, 3-pin, in-line	0.3	551375	SMT-10M-PS-24V-E-0,3-L-M8D
			Plug M8x1, 3-pin, lateral	0.3	551376	SMT-10M-PS-24V-E-0,3-Q-M8D

Ordering data – Proximity sensors for C-slot, magnetic reed						Technical data → Internet: sm
	Type of mounting	Switching output	Electrical connection, connection direction	Cable length [m]	Part No.	Type
N/O contact						
	Insertable in the slot from above	Contacting	Plug M8x1, 3-pin, in-line	0.3	551367	SME-10M-DS-24V-E-0,3-L-M8D
			Cable, 3-wire, in-line	2.5	551365	SME-10M-DS-24V-E-2,5-L-OE
			Cable, 2-wire, in-line	2.5	551369	SME-10M-ZS-24V-E-2,5L-OE
	Insertable in the slot lengthwise	Contacting	Plug M8x1, 3-pin, in-line	0.3	173212	SME-10-SL-LED-24
			Cable, 3-wire, in-line	2.5	173210	SME-10-KL-LED-24

Ordering data – Connecting cables					Technical data → Internet: nebu
	Electrical connection, left	Electrical connection, right	Cable length [m]	Part No.	Type
	Straight socket, M8x1, 3-pin	Cable, open end, 3-wire	2.5	541333	NEBU-M8G3-K-2.5-LE3
			5	541334	NEBU-M8G3-K-5-LE3
	Straight socket, M12x1, 5-pin	Cable, open end, 3-wire	2.5	541363	NEBU-M12G5-K-2.5-LE3
			5	541364	NEBU-M12G5-K-5-LE3
	Angled socket, M8x1, 3-pin	Cable, open end, 3-wire	2.5	541338	NEBU-M8W3-K-2.5-LE3
			5	541341	NEBU-M8W3-K-5-LE3
	Angled socket, M12x1, 5-pin	Cable, open end, 3-wire	2.5	541367	NEBU-M12W5-K-2.5-LE3
			5	541370	NEBU-M12W5-K-5-LE3

Product Range and Company Overview

A Complete Suite and Company Overview

Our experienced engineers provide complete support at every stage of your development process, including: conceptualization, analysis, engineering, design, assembly, documentation, validation, and production.



Custom Automation Components
Complete custom engineered solutions

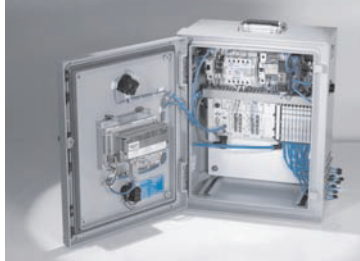

Custom Control Cabinets
Comprehensive engineering support and on-site services



Complete Systems
Shipment, stocking and storage services

The Broadest Range of Automation Components

With a comprehensive line of more than 30,000 automation components, Festo is capable of solving the most complex automation requirements.



Electromechanical
Electromechanical actuators, motors, controllers & drivers



Pneumatics
Pneumatic linear and rotary actuators, valves, and air supply



PLCs and I/O Devices
PLC's, operator interfaces, sensors and I/O devices

Supporting Advanced Automation... As No One Else Can!

Festo is a leading global manufacturer of pneumatic and electromechanical systems, components and controls for industrial automation, with more than 16,000 employees in 60 national headquarters serving more than 180 countries. For more than 80 years, Festo has continuously elevated the state of manufacturing with innovations and optimized motion control solutions that deliver higher performing, more profitable automated manufacturing and processing equipment. Our dedication to the advancement of automation extends beyond technology to the education and development of current and future automation and robotics designers with simulation tools, teaching programs, and on-site services.

Quality Assurance, ISO 9001 and ISO 14001 Certifications

Festo Corporation is committed to supply all Festo products and services that will meet or exceed our customers' requirements in product quality, delivery, customer service and satisfaction.

To meet this commitment, we strive to ensure a consistent, integrated, and systematic approach to management that will meet or exceed the requirements of the ISO 9001 standard for Quality Management and the ISO 14001 standard for Environmental Management.

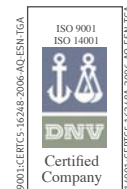

© Copyright 2013, Festo Corporation. While every effort is made to ensure that all dimensions and specifications are correct, Festo cannot guarantee that publications are completely free of any error, in particular typing or printing errors. Accordingly, Festo cannot be held responsible for the same. For Liability and Warranty conditions, refer to our "Terms and Conditions of Sale", available from your local Festo office. All rights reserved. No part of this publication may be reproduced, distributed, or transmitted in any form or by any means, electronic, mechanical, photocopying or otherwise, without the prior written permission of Festo. All technical data subject to change according to technical update.



Printed on recycled paper at New Horizon Graphic, Inc., FSC certified as an environmental friendly printing plant.

Festo North America

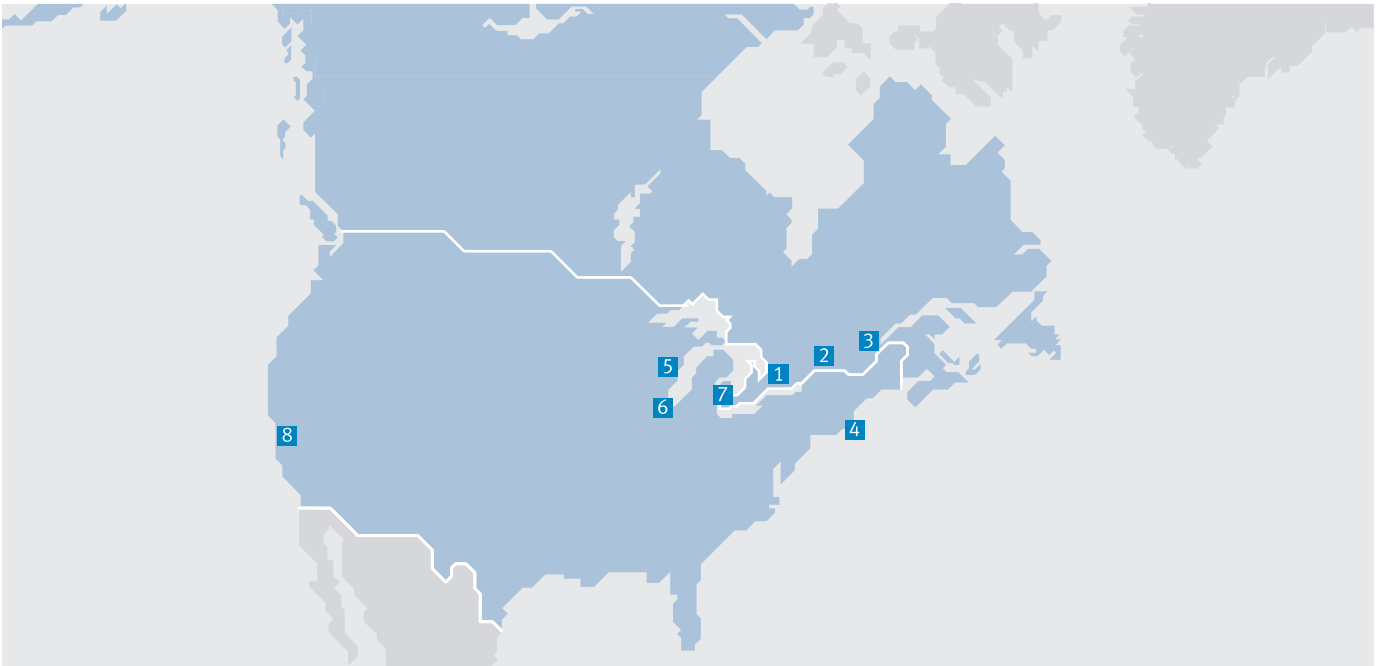

**1 Festo Canada
Headquarters
Festo Inc.**
5300 Explorer Drive
Mississauga, ON
L4W 5G4

2 Montréal
5600, Trans-Canada
Pointe-Claire, QC
H9R 1B6

3 Québec City
2930, rue Watt#117
Québec, QC
G1X 4G3



**4 Festo United States
Headquarters
Festo Corporation**
395 Moreland Road
Hauppauge, NY
11788

5 Appleton
North 922 Tower View Drive, Suite N
Greenville, WI
54942

7 Detroit
1441 West Long Lake Road
Troy, MI
48098

6 Chicago
85 W Algonquin - Suite 340
Arlington Heights, IL
60005

8 Silicon Valley
4935 Southfront Road, Suite F
Livermore, CA
94550

Festo Regional Contact Center

Canadian Customers

Commercial Support:
Tel: 1 877 GO FESTO (1 877 463 3786)
Fax: 1 877 FX FESTO (1 877 393 3786)
Email: festo.canada@ca.festo.com

Technical Support:
Tel: 1 866 GO FESTO (1 866 463 3786)
Fax: 1 877 FX FESTO (1 877 393 3786)
Email: technical.support@ca.festo.com

USA Customers

Commercial Support:
Tel: 1 800 99 FESTO (1 800 993 3786)
Fax: 1 800 96 FESTO (1 800 963 3786)
Email: customer.service@us.festo.com

Technical Support:
Tel: 1 866 GO FESTO (1 866 463 3786)
Fax: 1 800 96 FESTO (1 800 963 3786)
Email: product.support@us.festo.com