

Exhaust air flow control valves





Exhaust air flow control valves

Product range overview

Function

Exhaust air flow control valves are screwed into the exhaust controls of control valves or drives. They enable the piston speed of cylinders or rotary drives to be controlled by restricting

the air exhaust. This is done using the adjusting element. The air is exhausted via an integrated silencer which reduces the noise level.

Design	Valve function	Design	Type	Pneumatic connection 1	qn ¹⁾ [l/min]	Adjusting element	→ Page/ Internet
Exhaust air flow control valve	Sintered metal						
	Flow control/ silencer function		GRE	G1/8, G1/4, G3/8, G1/2	0 ... 3,600	Slotted head screw	3
Flow control/ silencer	Plastic						
	Flow control/ silencer function		VFFK	M5, M7, R1/8, R1/4	0 ... 420	Knurled screw	5
			GRU	G1/8, G1/4, G3/8, G1/2, G3/4	0 ... 8,000	Slotted head screw	8



1) Standard flow rate

Exhaust air flow control valves GRE

Technical data

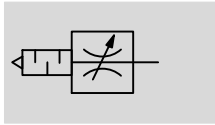
Function



-  - Flow rate
0 ... 3,600 l/min
-  - Temperature range
-10 ... +70 °C
-  - Operating pressure
0 ... 10 bar



General technical data					
Valve function		Flow control/silencer function			
Pneumatic connection 1		G1/8	G1/4	G3/8	G1/2
Adjustment component	Slotted head screw				
Type of mounting	Screw-in				
Mounting position	Any				
Max. tightening torque	[Nm]	-	-	15	-

Operating and environmental conditions					
Pneumatic connection 1		G1/8	G1/4	G3/8	G1/2
Operating pressure	[bar]	0 ... 10			
Operating medium		Compressed air in accordance with ISO 8573-1:2010 [7:-:-]	Compressed air in accordance with ISO 8573-1:2010 [7:-:-]	Compressed air in accordance with ISO 8573-1:2010 [7:4:4]	Compressed air in accordance with ISO 8573-1:2010 [7:-:-]
Note on operating/pilot medium	Operation with lubricated medium possible (in which case lubricated operation will always be required)				
Ambient temperature	[°C]	-10 ... +70			
Temperature of medium	[°C]	-10 ... +70			

Standard flow rate q_n at 6 bar \rightarrow 0 bar as a function of spindle rotations n

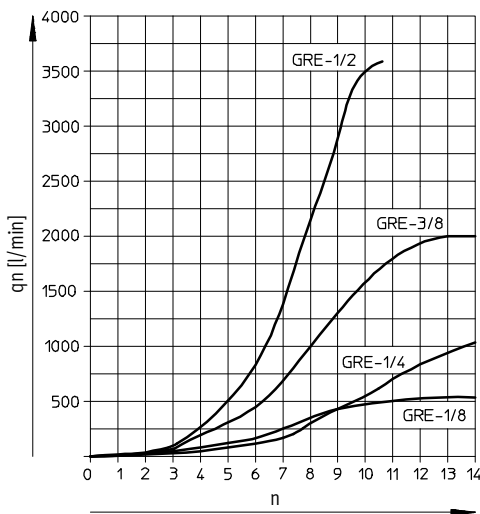

Exhaust air flow control valves GRE

Technical data

Materials

Sectional view

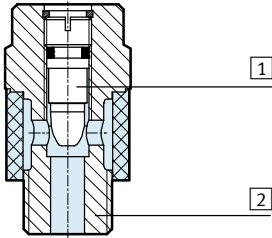

Exhaust air flow control valve

1	Adjusting screw	Brass
2	Threaded plug	Wrought aluminium alloy
-	Seals	NBR
Note on materials		RoHS-compliant

Dimensions

Download CAD data → www.festo.com

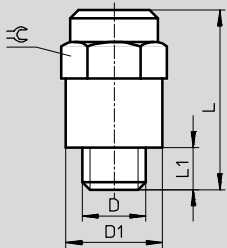

Type	Connection D	D1 ∅	L	L1	☞
GRE-1/8	G1/8	15	27.1	5.1	14
GRE-1/4	G1/4	18.2	32.1	6.1	17
GRE-3/8	G3/8	25	41.1	7.1	22
GRE-1/2	G1/2	27	44.6	8.6	24

Ordering data

	Pneumatic connection 1	Standard nominal flow rate qnN at 6 bar → 5 bar in direction of flow control [l/min]	Standard flow rate qn at 6 bar → 0 bar in direction of flow control [l/min]	Weight [g]	Part No.	Type
	G1/8	520	0 ... 520	15	10351	GRE-1/8
	G1/4	996	0 ... 996	25	10352	GRE-1/4
	G3/8	2,000	3 ... 2,000	50	35310	GRE-3/8
	G1/2	3,600	0 ... 3,600	75	10353	GRE-1/2

Flow control/silencers VFFK

Type codes

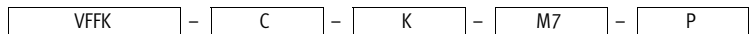

Type	
VFFK	Flow control/silencer

Design	
C	Inline

Adjusting element	
K	Knurled screw

Pneumatic connection 1	
M5	Thread M5
M7	Thread M7
R18	Thread R1/8
R14	Thread R1/4



Additional feature	
P	Polymer silencer

Flow control/silencers VFFK

Technical data

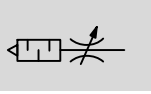
Function



-  Flow rate
0 ... 420 l/min
-  Temperature range
0 ... +60 °C
-  Operating pressure
0 ... 10 bar



General technical data				
Valve function	Flow control/silencer function			
Pneumatic connection 1	M5	M7	R1/8	R1/4
Adjusting element	Knurled screw			
Type of mounting	Screw-in			
Mounting position	Any			
Type of seal on threaded plug	Sealing ring			Coating
Nominal tightening torque [Nm]	1.4 ±20%	3.8 ±20%	-	

Operating and environmental conditions	
Operating pressure complete [bar]	0 ... 10
temperature range	
Operating medium	Compressed air according to ISO 8573-1:2010 [7:4:4]
Note about the operating/pilot medium	Lubricated operation possible
Ambient temperature [°C]	0 ... +60
Temperature of medium [°C]	0 ... +60
Storage temperature [°C]	0 ... +60

Materials		
Type	VFFK-C-K-M...-P	VFFK-C-K-R...-P
Silencer insert	PE	
Threaded plug	Nickel-plated brass	
Regulating screw	Nickel-plated brass	
Knurled nut	Aluminium	
Seals	NBR	-
Note on materials	RoHS-compliant	

Standard flow rate q_n [l/min] as a function of turns of the adjusting screw n
 VFFK-C-K-M5-P VFFK-C-K-M7-P

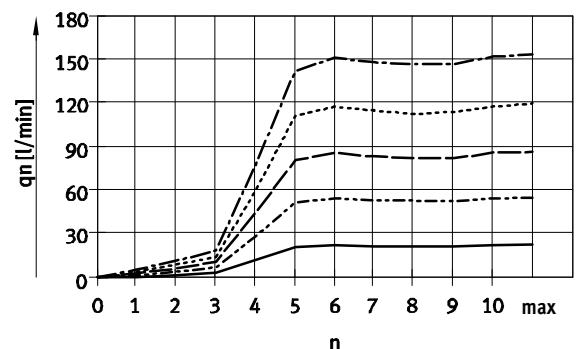
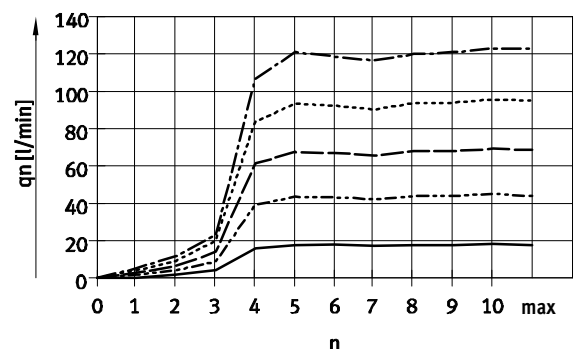

- P1 = 1 bar
- - - - - P1 = 3 bar
- · - · - P1 = 5 bar
- · · · · P1 = 7 bar
- - - - - P1 = 9 bar

Flow rate tolerance: ±20%

Flow control/silencers VFFK

Technical data

FESTO

Standard flow rate q_n [l/min] as a function of turns of the adjusting screw n

VFFK-C-K-R18-P

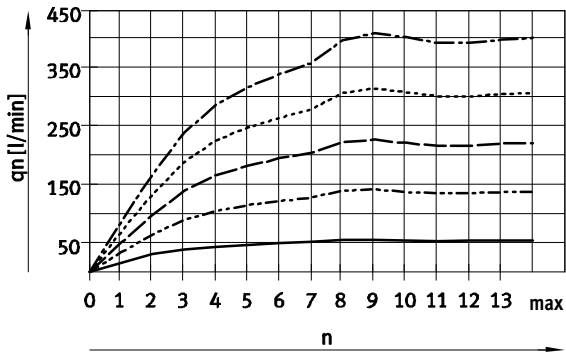

— P1 = 1 bar
 - - - P1 = 3 bar
 - · - P1 = 5 bar
 ····· P1 = 7 bar
 - · - P1 = 9 bar

VFFK-C-K-R14-P

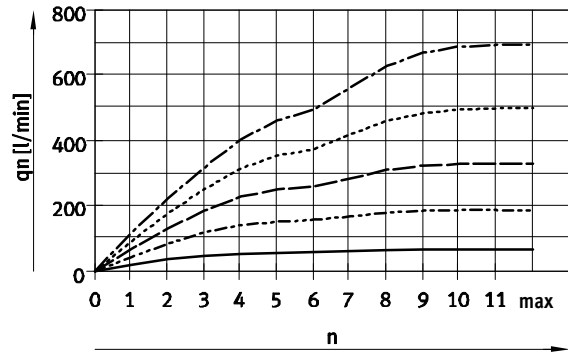

Flow rate tolerance: $\pm 20\%$

Dimensions

Download CAD data → www.festo.com

VFFK-C-K-M...-P

VFFK-C-K-R...-P

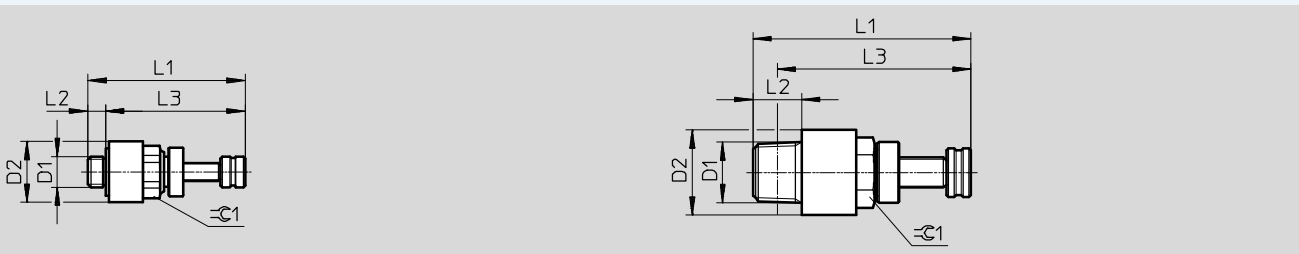

Type	Connection D1	D2 ∅	L1		L2	L3		=C 1
			min.	max.		min.	max.	
VFFK-C-K-M5-P	M5x0.8	10	22.2	25.8	2.9	19.3	22.9	8
VFFK-C-K-M7-P	M7x1	10	25	28.3	5.5	19.2	22.8	8
VFFK-C-K-R18-P	R1/8	14	29.1	35.8	8	25.1	31.8	10
VFFK-C-K-R14-P	R1/4	18	31.1	37	10.8	25.1	31	14

Ordering data

	Pneumatic connection 1	Standard flow rate q_n at 6 bar → 0 bar [l/min]	Weight [g]	Part No.	Type
	M5	0 ... 80	4.5	133140	VFFK-C-K-M5-P
	M7	0 ... 100	6.1	133141	VFFK-C-K-M7-P
	R1/8	0 ... 270	13.5	133142	VFFK-C-K-R18-P
	R1/4	0 ... 420	25	133143	VFFK-C-K-R14-P

Flow control/silencers GRU

Type codes

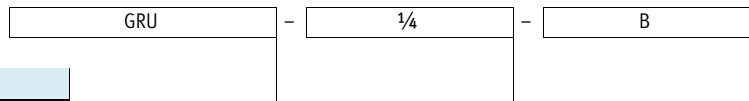

Type	
GRU	Flow control/silencer

Pneumatic connection 1	
1/8	Thread G1/8
1/4	Thread G1/4
3/8	Thread G3/8
1/2	Thread G1/2
3/4	Thread G3/4

Generation	
B	B series

Flow control/silencers GRU

Technical data

Function

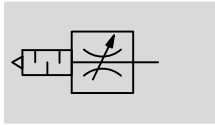

- - Flow rate
0 ... 8,000 l/min
- - Temperature range
-10 ... +70 °C
- - Operating pressure
0 ... 10 bar



General technical data					
Valve function	Flow control/silencer function				
Pneumatic connection 1	G ¹ / ₈	G ¹ / ₄	G ³ / ₈	G ¹ / ₂	G ³ / ₄
Adjustment component	Slotted head screw				
Type of mounting	Screw-in				
Mounting position	Any				

Operating and environmental conditions	
Operating pressure [bar]	0 ... 10
Operating medium	Compressed air in accordance with ISO 8573-1:2010 [7:-:-]
Note on operating/pilot medium	Operation with lubricated medium possible (in which case lubricated operation will always be required)
Ambient temperature [°C]	-10 ... +70
Temperature of medium [°C]	-10 ... +70

Standard flow rate qn at 6 bar → 0 bar as a function of spindle rotations n

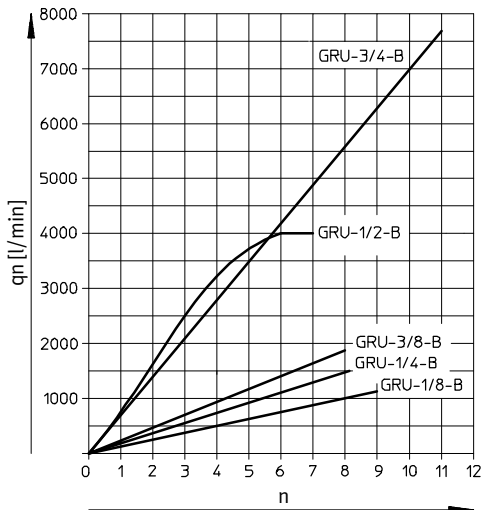

Materials

Sectional view

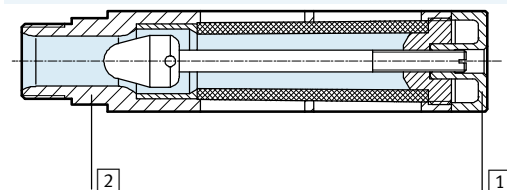

Flow control/silencer		
1	Adjusting screw	PA
2	Housing, threaded plug	Die-cast aluminium
Note on materials		RoHS-compliant (GRU- ³ / ₈ /GRU- ³ / ₄ only)

Flow control/silencers GRU

Technical data

Dimensions Download CAD data → www.festo.com

1 Adjusting screw

Type	Connection D	D1 Ø	L	L1	⌀
GRU-1/8	G1/8	16	46	5.4	14
GRU-1/4	G1/4	19.5	63.3	6.4	17
GRU-3/8	G3/8	25	95.3	7.5	19
GRU-1/2	G1/2	28	130	14	24
GRU-3/4	G3/4	38	157	16	32

Ordering data

	Pneumatic con- nection 1	Standard nominal flow rate qnN at 6 bar → 5 bar in direction of flow control [l/min]	Standard flow rate qn at 6 bar → 0 bar in direction of flow control [l/min]	Weight [g]	Part No.	Type
	G1/8	1,000	0 ... 1,000	10	9516	GRU-1/8-B
	G1/4	1,500	0 ... 1,500	25	9517	GRU-1/4-B
	G3/8	1,700	0 ... 1,700	55	9518	GRU-3/8-B
	G1/2	4,000	0 ... 4,000	100	9519	GRU-1/2-B
	G3/4	8,000	0 ... 8,000	170	9520	GRU-3/4-B

Product Range and Company Overview

A Complete Suite and Company Overview

Our experienced engineers provide complete support at every stage of your development process, including: conceptualization, analysis, engineering, design, assembly, documentation, validation, and production.

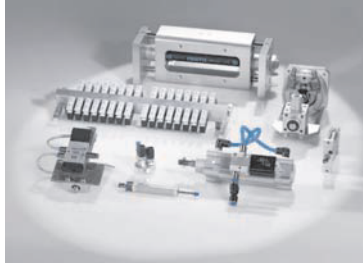

Custom Automation Components
Complete custom engineered solutions

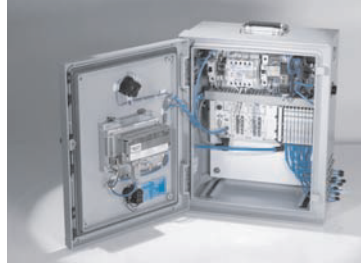

Custom Control Cabinets
Comprehensive engineering support and on-site services



Complete Systems
Shipment, stocking and storage services

The Broadest Range of Automation Components

With a comprehensive line of more than 30,000 automation components, Festo is capable of solving the most complex automation requirements.



Electromechanical
Electromechanical actuators, motors, controllers & drivers



Pneumatics
Pneumatic linear and rotary actuators, valves, and air supply



PLCs and I/O Devices
PLC's, operator interfaces, sensors and I/O devices

Supporting Advanced Automation... As No One Else Can!

Festo is a leading global manufacturer of pneumatic and electromechanical systems, components and controls for industrial automation, with more than 16,000 employees in 60 national headquarters serving more than 180 countries. For more than 80 years, Festo has continuously elevated the state of manufacturing with innovations and optimized motion control solutions that deliver higher performing, more profitable automated manufacturing and processing equipment. Our dedication to the advancement of automation extends beyond technology to the education and development of current and future automation and robotics designers with simulation tools, teaching programs, and on-site services.

Quality Assurance, ISO 9001 and ISO 14001 Certifications

Festo Corporation is committed to supply all Festo products and services that will meet or exceed our customers' requirements in product quality, delivery, customer service and satisfaction.

To meet this commitment, we strive to ensure a consistent, integrated, and systematic approach to management that will meet or exceed the requirements of the ISO 9001 standard for Quality Management and the ISO 14001 standard for Environmental Management.



© Copyright 2013, Festo Corporation. While every effort is made to ensure that all dimensions and specifications are correct, Festo cannot guarantee that publications are completely free of any error, in particular typing or printing errors. Accordingly, Festo cannot be held responsible for the same. For Liability and Warranty conditions, refer to our "Terms and Conditions of Sale", available from your local Festo office. All rights reserved. No part of this publication may be reproduced, distributed, or transmitted in any form or by any means, electronic, mechanical, photocopying or otherwise, without the prior written permission of Festo. All technical data subject to change according to technical update.



Printed on recycled paper at New Horizon Graphic, Inc., FSC certified as an environmental friendly printing plant.

Festo North America

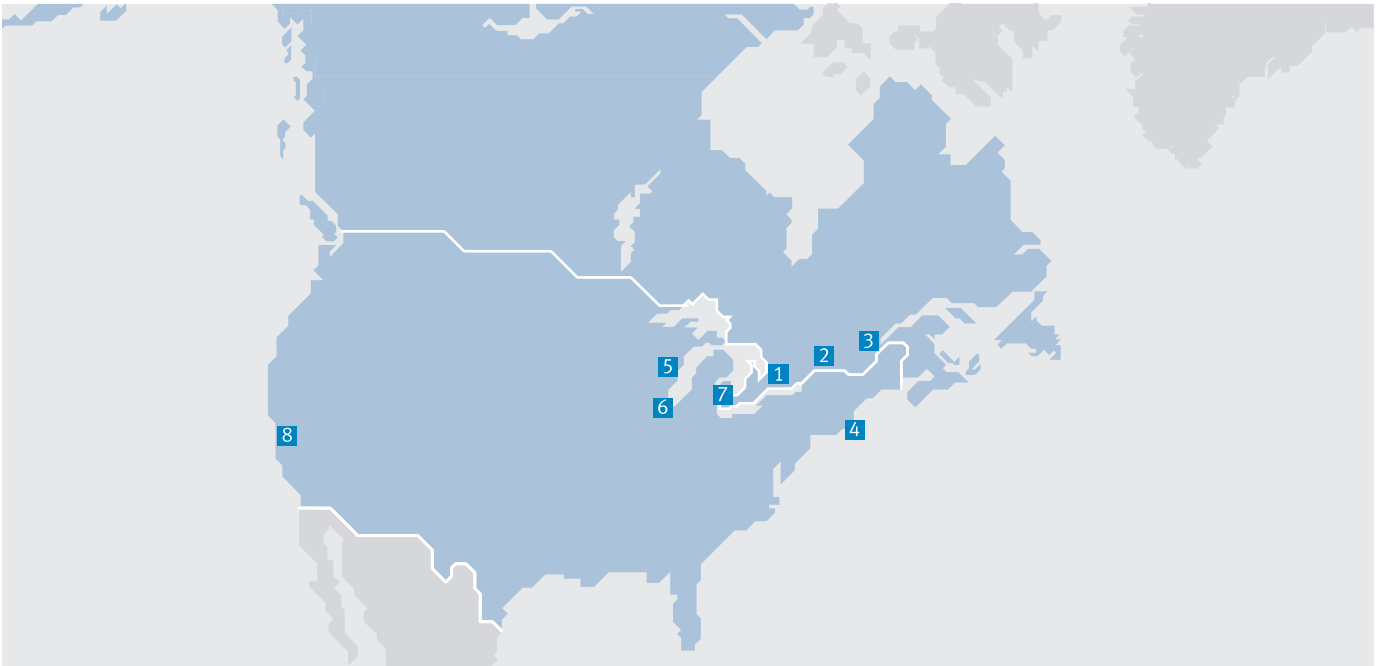

**1 Festo Canada
Headquarters
Festo Inc.**
5300 Explorer Drive
Mississauga, ON
L4W 5G4

2 Montréal
5600, Trans-Canada
Pointe-Claire, QC
H9R 1B6

3 Québec City
2930, rue Watt#117
Québec, QC
G1X 4G3



**4 Festo United States
Headquarters
Festo Corporation**
395 Moreland Road
Hauppauge, NY
11788

5 Appleton
North 922 Tower View Drive, Suite N
Greenville, WI
54942

7 Detroit
1441 West Long Lake Road
Troy, MI
48098

6 Chicago
85 W Algonquin - Suite 340
Arlington Heights, IL
60005

8 Silicon Valley
4935 Southfront Road, Suite F
Livermore, CA
94550

Festo Regional Contact Center

Canadian Customers

Commercial Support:
Tel: 1 877 GO FESTO (1 877 463 3786)
Fax: 1 877 FX FESTO (1 877 393 3786)
Email: festo.canada@ca.festo.com

Technical Support:
Tel: 1 866 GO FESTO (1 866 463 3786)
Fax: 1 877 FX FESTO (1 877 393 3786)
Email: technical.support@ca.festo.com

USA Customers

Commercial Support:
Tel: 1 800 99 FESTO (1 800 993 3786)
Fax: 1 800 96 FESTO (1 800 963 3786)
Email: customer.service@us.festo.com

Technical Support:
Tel: 1 866 GO FESTO (1 866 463 3786)
Fax: 1 800 96 FESTO (1 800 963 3786)
Email: product.support@us.festo.com