

Hinge cylinders DW

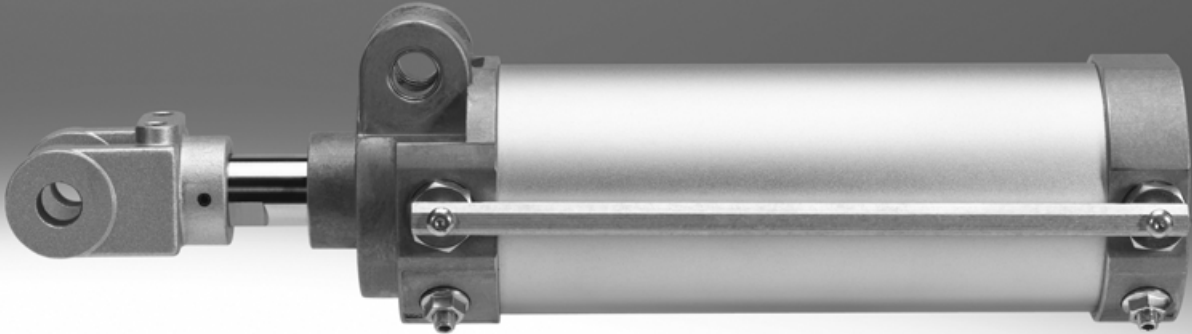

# Hinge cylinders DW

Key features

## At a glance

- Hinge cylinder for clamping components during the welding process
- Easy assembly thanks to swivel bearing on the bearing cap
- Integrated flow control
- Integrated end-position cushioning
- Rod wiper seal to protect against welding spatter
- Asian automotive standard for car body production

## The technology in detail

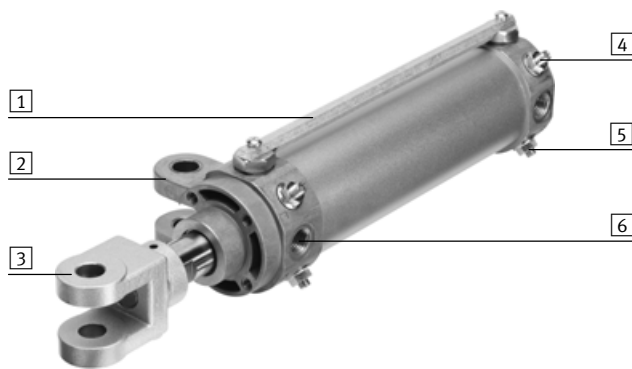

- 1 Different options for sensing the piston rod position:
  - Via sensor strip (→ Figure)
  - Via mounting kit SMBR with proximity sensor SME-/SMT-8M or SMTSO-8E
  - Via external proximity sensor using a switch lever
- 2 Swivel bearing on the cylinder. The fork gaps of the rod clevis and swivel bearing are identical
- 3 Different rod clevis gaps can be selected
- 4 Integrated flow control
- 5 Integrated end-position cushioning
- 6 Pneumatic connection, either:
  - Via Rc or G thread
  - Connection options on three sides (e.g. by modifying the sensor strip)

## Use as a clamping cylinder

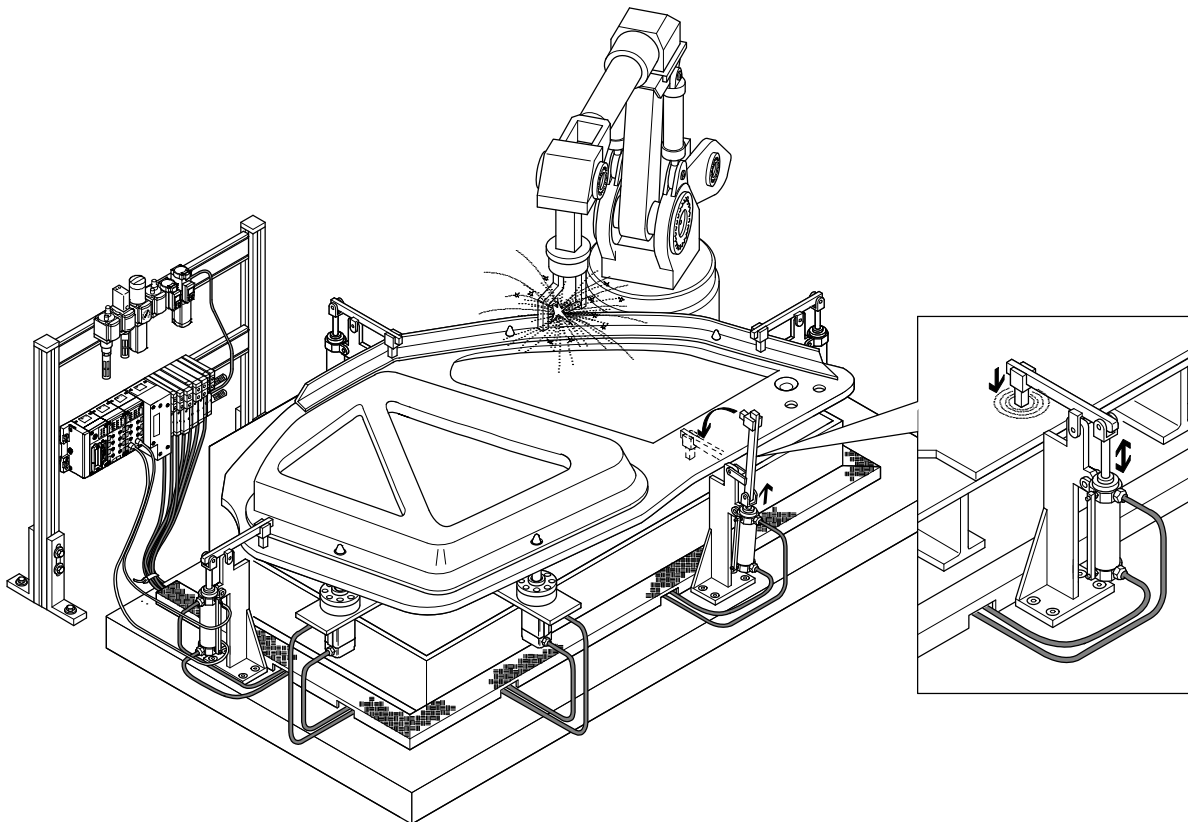

# Hinge cylinders DW

Peripherals overview

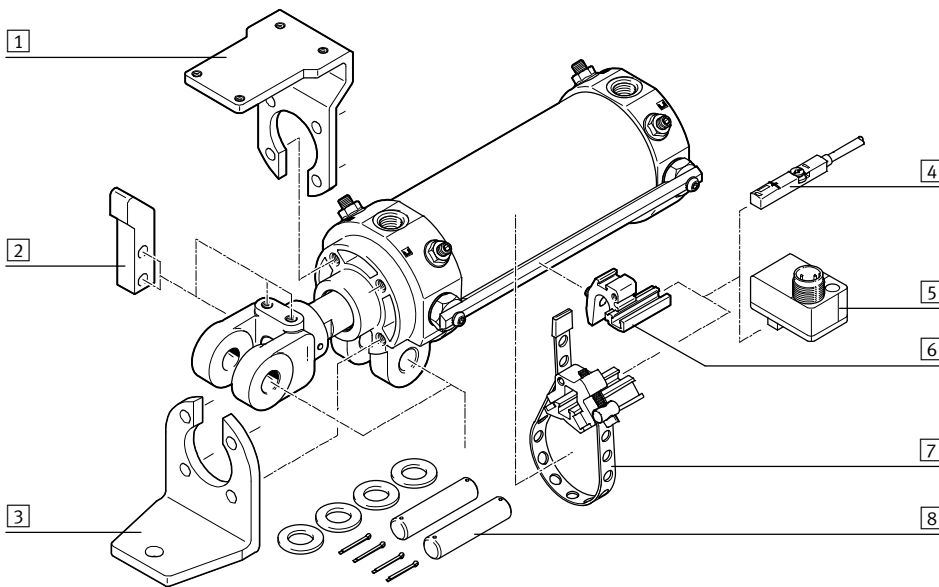

Included in the scope of delivery of the drive:  
 • Item 8

Accessories			
Type	Brief description	→ Page/Internet	
1	Mounting bracket TBH	For mounting external proximity sensors	12
2	Switch lever KTH	For sensing the piston rod position via external proximity sensors	12
3	Foot mounting HNH	For mounting the cylinder	12
4	Proximity sensor SME-/SMT-8	Flat proximity sensor for sensing the piston rod position	13
5	Proximity sensor SMTSO-8E	Welding field-resistant proximity sensor for sensing the piston rod position	13
6	Mounting SMBZ	For mounting the proximity sensor SME-/SMT-8 or SMTSO-8E on the sensor strip	14
7	Mounting kit SMBR	For mounting the proximity sensor SME-/SMT-8 or SMTSO-8E on the cylinder	14
8	Mounting kit DAMD	<ul style="list-style-type: none"> <li>For mounting the drive and attachments on the rod clevis</li> <li>The scope of delivery of the drive includes 2 bolts, 2 retaining pins and 4 washers</li> </ul>	13

# Hinge cylinders DW

Type codes

FESTO

DW – A – 50 – 50 – Y – A – G

Type	
DW	Hinge cylinder

Rod clevis gap [mm]	
	28
A	16
B	19.5
C	16.5

Piston Ø [mm]	

Stroke [mm]	

End of piston rod	
Y	With rod clevis

Position sensing	
	No magnet
A	Via magnet and sensor strip
AB	Via magnet

Pneumatic connection	
	Rc thread
G	G thread

# Hinge cylinders DW

Technical data

FESTO

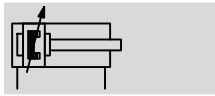
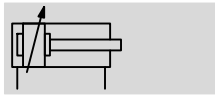

⌀ - Diameter  
50 ... 80 mm

— - Stroke length  
10 ... 200 mm

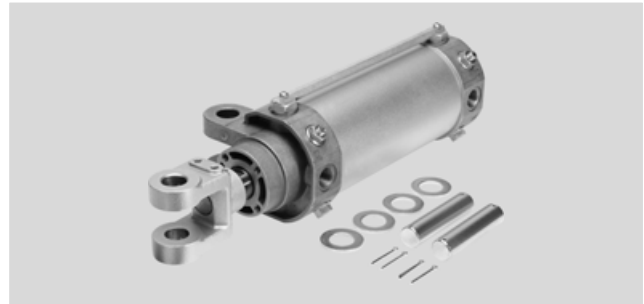

General technical data			
Piston Ø		50	63
Pneumatic connection		G1/4, Rc1/4	G3/8, Rc3/8
Piston rod thread		M16x1.5	M20x1.5
End of piston rod		Male thread with rod clevis	
Stroke	Standard	[mm]	50, 75, 100, 125, 150
	Variable	[mm]	10 ... 200
Rod clevis gap		[mm]	16, 16.5, 19.5
Design			Piston rod with rod clevis
			Swivel mounting on the bearing cap
			Cylinder barrel
			Piston
Mode of operation			Double-acting
			Pushing and pulling
Type of mounting			Via swivel mounting on the bearing cap
			Via accessories
Speed control			Integrated flow control at both ends
Mounting position			Any
Position sensing			Via proximity sensor
Cushioning			Pneumatic cushioning, adjustable at both ends
Cushioning length		[mm]	20
			30

Operating and environmental conditions	
Operating medium	Compressed air in accordance with ISO 8573-1:2010 [7:4:4]
Note on operating/pilot medium	Operation with lubricated medium possible (in which case lubricated operation will always be required)
Operating pressure	[bar] 1 ... 10
Ambient temperature	[°C] -10 ... +60

Weight [g]			
Piston Ø		50	63
Basic weight with 0 mm stroke		1,338	1,600
Additional weight per 10 mm stroke		37	42
Moving load with 0 mm stroke		664	741
Additional weight per 10 mm stroke		25	25
			39

# Hinge cylinders DW

Technical data

FESTO

Forces [N] and impact energy [J]			
Piston $\varnothing$	50	63	80
Theoretical force at 6 bar, advancing	1,178	1,870	3,016
Theoretical force at 6 bar, retracting	990	1,682	2,721
Impact energy in the end positions	0.7	1.3	1.8

## Materials

Sectional view

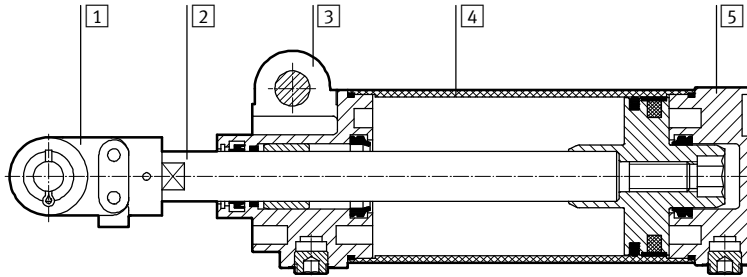

Hinge cylinder	
1	Rod clevis Cast steel
2	Piston rod Hard chromium-plated tempered steel
3	Bearing cap with mounting Die-cast aluminium
4	Cylinder barrel Anodised wrought aluminium alloy
5	Cover Anodised die-cast aluminium
-	Seals Nitrile rubber
	Note on materials RoHS-compliant

# Hinge cylinders DW

Technical data

FESTO

## Dimensions

Download CAD data → [www.festo.com](http://www.festo.com)

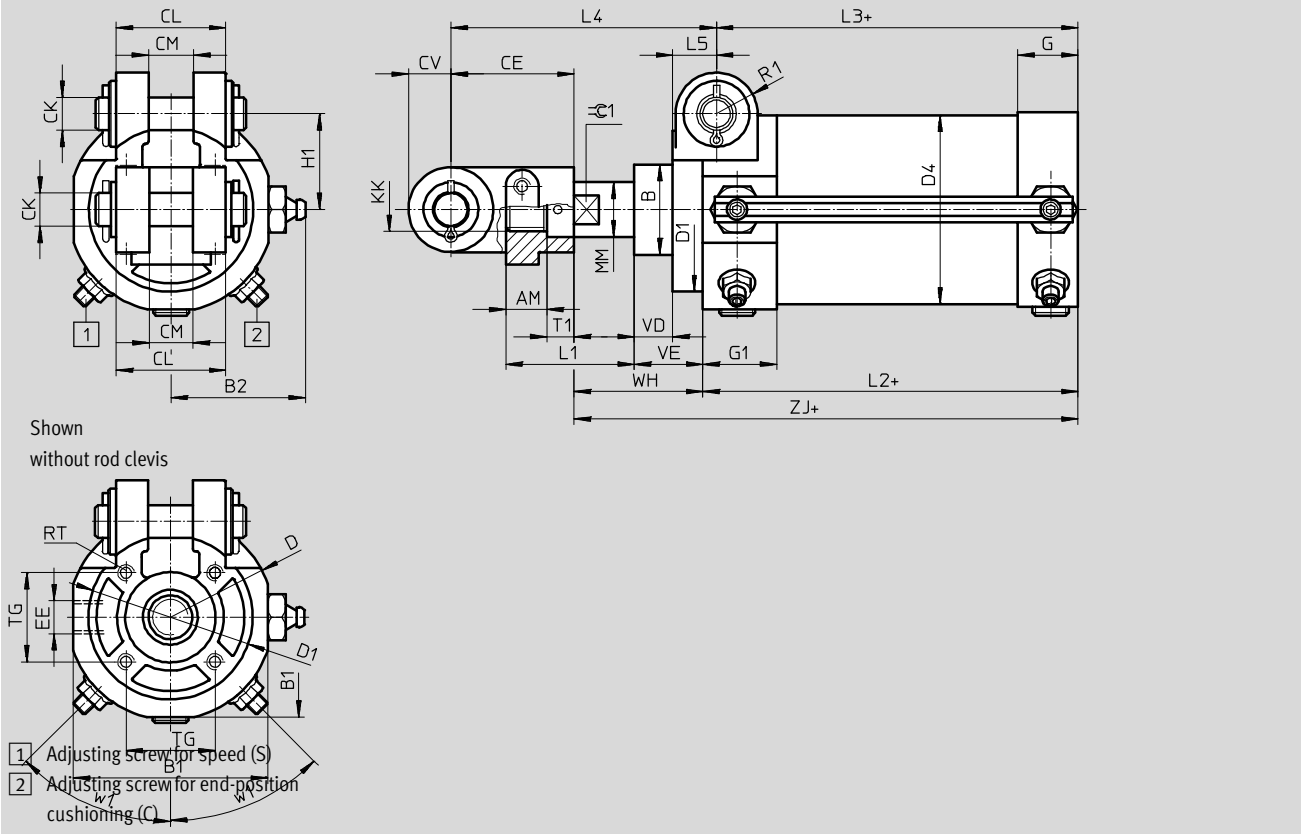

∅	AM	B ∅	B1	B2	CE	CK ∅	CL	CM		
								DWA +0.4/+0.1	DWB +0.4/+0.1	DWC +0.4/+0.1
50	15	33	58	42.5	45	12	40	16	19.5	16.5
63			71	49						
80	23	56	89	58.5	58	18	60	28	28	28

∅	CV	D ∅	D1 ∅	D4 ∅	EE		G	G1	H1
					Rc	G			
50	15.5	61	55	55	Rc1/4	G1/4	22	27	35
63		75	60	69					
80	19	93	70	87	Rc3/8	G3/8	34	34	50

∅	KK	L1	L2	L3	L4	L5	MM ∅	R1	RT
[mm]				+0.7/-0.4	+1.5/-2				
50	M16x1.5	47	87	82	97	16	20	15	M6
63									
80	M20x1	47	150	128	110	22	25	20	M6

∅	T1	TG	VD	VE	W1	WH	ZJ	⊖ 1
[mm]								
50	10	32.5	14	25	45°	47	134	17
63								
80	11	32.5	17	33	45°	46	180	19

# Hinge cylinders DW

Technical data

FESTO

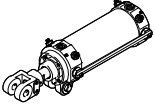
Ordering data – With Rc thread									
	Piston Ø [mm]	Stroke [mm]	Rod clevis gap 16 mm		Rod clevis gap 19.5 mm		Rod clevis gap 16.5 mm		
			Part No.	Type	Part No.	Type	Part No.	Type	
	50	Without magnet							
		50	549543	DWA-50-50-Y	549553	DWB-50-50-Y	558087	DWC-50-50-Y	
		75	549544	DWA-50-75-Y	549554	DWB-50-75-Y	558088	DWC-50-75-Y	
		100	549545	DWA-50-100-Y	549555	DWB-50-100-Y	558089	DWC-50-100-Y	
		125	549546	DWA-50-125-Y	549556	DWB-50-125-Y	558090	DWC-50-125-Y	
		150	549547	DWA-50-150-Y	549557	DWB-50-150-Y	558091	DWC-50-150-Y	
		10 ... 200	555710	DWA-50-...-Y	555713	DWB-50-...-Y	558137	DWC-50-...-Y	
		With magnet and sensor strip							
		50	549548	DWA-50-50-Y-A	549558	DWB-50-50-Y-A	558092	DWC-50-50-Y-A	
		75	549549	DWA-50-75-Y-A	549559	DWB-50-75-Y-A	558093	DWC-50-75-Y-A	
		100	549550	DWA-50-100-Y-A	549560	DWB-50-100-Y-A	558094	DWC-50-100-Y-A	
		125	549551	DWA-50-125-Y-A	549561	DWB-50-125-Y-A	558095	DWC-50-125-Y-A	
		150	549552	DWA-50-150-Y-A	549562	DWB-50-150-Y-A	558096	DWC-50-150-Y-A	
		10 ... 200	555711	DWA-50-...-Y-A	555714	DWB-50-...-Y-A	558138	DWC-50-...-Y-A	
		With magnet							
		50	549743	DWA-50-50-Y-AB	549707	DWB-50-50-Y-AB	558097	DWC-50-50-Y-AB	
		75	549744	DWA-50-75-Y-AB	549708	DWB-50-75-Y-AB	558098	DWC-50-75-Y-AB	
		100	549745	DWA-50-100-Y-AB	549709	DWB-50-100-Y-AB	558099	DWC-50-100-Y-AB	
	125	549746	DWA-50-125-Y-AB	549710	DWB-50-125-Y-AB	558100	DWC-50-125-Y-AB		
	150	549706	DWA-50-150-Y-AB	549711	DWB-50-150-Y-AB	558101	DWC-50-150-Y-AB		
	10 ... 200	555712	DWA-50-...-Y-AB	555715	DWB-50-...-Y-AB	558139	DWC-50-...-Y-AB		
	63	Without magnet							
		50	549563	DWA-63-50-Y	549573	DWB-63-50-Y	558102	DWC-63-50-Y	
		75	549564	DWA-63-75-Y	549574	DWB-63-75-Y	558103	DWC-63-75-Y	
		100	549565	DWA-63-100-Y	549575	DWB-63-100-Y	558104	DWC-63-100-Y	
		125	549566	DWA-63-125-Y	549576	DWB-63-125-Y	558105	DWC-63-125-Y	
		150	549567	DWA-63-150-Y	549577	DWB-63-150-Y	558106	DWC-63-150-Y	
10 ... 200		555716	DWA-63-...-Y	555719	DWB-63-...-Y	558140	DWC-63-...-Y		
With magnet and sensor strip									
50		549568	DWA-63-50-Y-A	549578	DWB-63-50-Y-A	558107	DWC-63-50-Y-A		
75		549569	DWA-63-75-Y-A	549579	DWB-63-75-Y-A	558108	DWC-63-75-Y-A		
100		549570	DWA-63-100-Y-A	549580	DWB-63-100-Y-A	558109	DWC-63-100-Y-A		
125		549571	DWA-63-125-Y-A	549581	DWB-63-125-Y-A	558110	DWC-63-125-Y-A		
150		549572	DWA-63-150-Y-A	549582	DWB-63-150-Y-A	558111	DWC-63-150-Y-A		
10 ... 200		555717	DWA-63-...-Y-A	555720	DWB-63-...-Y-A	558141	DWC-63-...-Y-A		
With magnet									
50		549712	DWA-63-50-Y-AB	549730	DWB-63-50-Y-AB	558112	DWC-63-50-Y-AB		
75		549713	DWA-63-75-Y-AB	549732	DWB-63-75-Y-AB	558113	DWC-63-75-Y-AB		
100		549714	DWA-63-100-Y-AB	549733	DWB-63-100-Y-AB	558114	DWC-63-100-Y-AB		
125	549715	DWA-63-125-Y-AB	549734	DWB-63-125-Y-AB	558115	DWC-63-125-Y-AB			
150	549716	DWA-63-150-Y-AB	549735	DWB-63-150-Y-AB	558116	DWC-63-150-Y-AB			
10 ... 200	555718	DWA-63-...-Y-AB	555721	DWB-63-...-Y-AB	558142	DWC-63-...-Y-AB			



# Hinge cylinders DW

Technical data

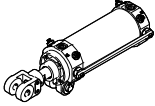
Ordering data – With Rc thread			
	Piston Ø [mm]	Stroke [mm]	Rod clevis gap 28 mm
			Part No. Type
	80	Without magnet	
		50	<b>557904 DW-80-50-Y</b>
		75	<b>557905 DW-80-75-Y</b>
		100	<b>557906 DW-80-100-Y</b>
		125	<b>557907 DW-80-125-Y</b>
		150	<b>557908 DW-80-150-Y</b>
		10 ... 200	<b>557929 DW-80-...-Y</b>
		With magnet and sensor strip	
		50	<b>557909 DW-80-50-Y-A</b>
		75	<b>557910 DW-80-75-Y-A</b>
		100	<b>557911 DW-80-100-Y-A</b>
		125	<b>557912 DW-80-125-Y-A</b>
		150	<b>557913 DW-80-150-Y-A</b>
		10 ... 200	<b>557930 DW-80-...-Y-A</b>
		With magnet	
		50	<b>557914 DW-80-50-Y-AB</b>
		75	<b>557915 DW-80-75-Y-AB</b>
		100	<b>557916 DW-80-100-Y-AB</b>
		125	<b>557917 DW-80-125-Y-AB</b>
		150	<b>557918 DW-80-150-Y-AB</b>
10 ... 200	<b>557931 DW-80-...-Y-AB</b>		

# Hinge cylinders DW

Technical data

FESTO

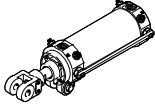
Ordering data – With G thread									
	Piston Ø [mm]	Stroke [mm]	Rod clevis gap 16 mm		Rod clevis gap 19.5 mm		Rod clevis gap 16.5 mm		
			Part No.	Type	Part No.	Type	Part No.	Type	
	50	Without magnet							
		50	565721	DWA-50-50-Y-G	565731	DWB-50-50-Y-G	572341	DWC-50-50-Y-G	
		75	565722	DWA-50-75-Y-G	565732	DWB-50-75-Y-G	572342	DWC-50-75-Y-G	
		100	565723	DWA-50-100-Y-G	565733	DWB-50-100-Y-G	572343	DWC-50-100-Y-G	
		125	565724	DWA-50-125-Y-G	565734	DWB-50-125-Y-G	572344	DWC-50-125-Y-G	
		150	565725	DWA-50-150-Y-G	565735	DWB-50-150-Y-G	572345	DWC-50-150-Y-G	
		10 ... 200	565781	DWA-50-...-Y-G	565784	DWB-50-...-Y-G	572371	DWC-50-...-Y-G	
		With magnet and sensor strip							
		50	565726	DWA-50-50-Y-A-G	565736	DWB-50-50-Y-A-G	572346	DWC-50-50-Y-A-G	
		75	565727	DWA-50-75-Y-A-G	565737	DWB-50-75-Y-A-G	572347	DWC-50-75-Y-A-G	
		100	565728	DWA-50-100-Y-A-G	565738	DWB-50-100-Y-A-G	572348	DWC-50-100-Y-A-G	
		125	565729	DWA-50-125-Y-A-G	565739	DWB-50-125-Y-A-G	572349	DWC-50-125-Y-A-G	
		150	565730	DWA-50-150-Y-A-G	565740	DWB-50-150-Y-A-G	572350	DWC-50-150-Y-A-G	
		10 ... 200	565782	DWA-50-...-Y-A-G	565785	DWB-50-...-Y-A-G	572372	DWC-50-...-Y-A-G	
		With magnet							
		50	565777	DWA-50-50-Y-AB-G	565762	DWB-50-50-Y-AB-G	572351	DWC-50-50-Y-AB-G	
		75	565778	DWA-50-75-Y-AB-G	565763	DWB-50-75-Y-AB-G	572352	DWC-50-75-Y-AB-G	
		100	565779	DWA-50-100-Y-AB-G	565764	DWB-50-100-Y-AB-G	572353	DWC-50-100-Y-AB-G	
	125	565780	DWA-50-125-Y-AB-G	565765	DWB-50-125-Y-AB-G	572354	DWC-50-125-Y-AB-G		
	150	565761	DWA-50-150-Y-AB-G	565766	DWB-50-150-Y-AB-G	572355	DWC-50-150-Y-AB-G		
	10 ... 200	565783	DWA-50-...-Y-AB-G	565786	DWB-50-...-Y-AB-G	572373	DWC-50-...-Y-AB-G		
	63	Without magnet							
		50	565741	DWA-63-50-Y-G	565751	DWB-63-50-Y-G	572356	DWC-63-50-Y-G	
		75	565742	DWA-63-75-Y-G	565752	DWB-63-75-Y-G	572357	DWC-63-75-Y-G	
		100	565743	DWA-63-100-Y-G	565753	DWB-63-100-Y-G	572358	DWC-63-100-Y-G	
		125	565744	DWA-63-125-Y-G	565754	DWB-63-125-Y-G	572359	DWC-63-125-Y-G	
		150	565745	DWA-63-150-Y-G	565755	DWB-63-150-Y-G	572360	DWC-63-150-Y-G	
10 ... 200		565787	DWA-63-...-Y-G	565790	DWB-63-...-Y-G	572374	DWC-63-...-Y-G		
With magnet and sensor strip									
50		565746	DWA-63-50-Y-A-G	565756	DWB-63-50-Y-A-G	572361	DWC-63-50-Y-A-G		
75		565747	DWA-63-75-Y-A-G	565757	DWB-63-75-Y-A-G	572362	DWC-63-75-Y-A-G		
100		565748	DWA-63-100-Y-A-G	565758	DWB-63-100-Y-A-G	572363	DWC-63-100-Y-A-G		
125		565749	DWA-63-125-Y-A-G	565759	DWB-63-125-Y-A-G	572364	DWC-63-125-Y-A-G		
150		565750	DWA-63-150-Y-A-G	565760	DWB-63-150-Y-A-G	572365	DWC-63-150-Y-A-G		
10 ... 200		565788	DWA-63-...-Y-A-G	565791	DWB-63-...-Y-A-G	572375	DWC-63-...-Y-A-G		
With magnet									
50		565767	DWA-63-50-Y-AB-G	565772	DWB-63-50-Y-AB-G	572366	DWC-63-50-Y-AB-G		
75		565768	DWA-63-75-Y-AB-G	565773	DWB-63-75-Y-AB-G	572367	DWC-63-75-Y-AB-G		
100		565769	DWA-63-100-Y-AB-G	565774	DWB-63-100-Y-AB-G	572368	DWC-63-100-Y-AB-G		
125	565770	DWA-63-125-Y-AB-G	565775	DWB-63-125-Y-AB-G	572369	DWC-63-125-Y-AB-G			
150	565771	DWA-63-150-Y-AB-G	565776	DWB-63-150-Y-AB-G	572370	DWC-63-150-Y-AB-G			
10 ... 200	565789	DWA-63-...-Y-AB-G	565792	DWB-63-...-Y-AB-G	572376	DWC-63-...-Y-AB-G			

# Hinge cylinders DW

Technical data

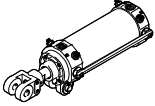
Ordering data – With G thread			
	Piston Ø [mm]	Stroke [mm]	Rod clevis gap 28 mm
			Part No.    Type
	80	Without magnet	
		50	<b>565793</b> <b>DW-80-50-Y-G</b>
		75	<b>565794</b> <b>DW-80-75-Y-G</b>
		100	<b>565795</b> <b>DW-80-100-Y-G</b>
		125	<b>565796</b> <b>DW-80-125-Y-G</b>
		150	<b>565797</b> <b>DW-80-150-Y-G</b>
		10 ... 200	<b>565808</b> <b>DW-80-...-Y-G</b>
		With magnet and sensor strip	
		50	<b>565798</b> <b>DW-80-50-Y-A-G</b>
		75	<b>565799</b> <b>DW-80-75-Y-A-G</b>
		100	<b>565800</b> <b>DW-80-100-Y-A-G</b>
		125	<b>565801</b> <b>DW-80-125-Y-A-G</b>
		150	<b>565802</b> <b>DW-80-150-Y-A-G</b>
		10 ... 200	<b>565809</b> <b>DW-80-...-Y-A-G</b>
		With magnet	
		50	<b>565803</b> <b>DW-80-50-Y-AB-G</b>
		75	<b>565804</b> <b>DW-80-75-Y-AB-G</b>
		100	<b>565805</b> <b>DW-80-100-Y-AB-G</b>
		125	<b>565806</b> <b>DW-80-125-Y-AB-G</b>
		150	<b>565807</b> <b>DW-80-150-Y-AB-G</b>
10 ... 200	<b>565810</b> <b>DW-80-...-Y-AB-G</b>		

# Hinge cylinders DW

Accessories

FESTO

## Foot mounting HNH

Material:  
Steel

Scope of delivery:  
4 screws

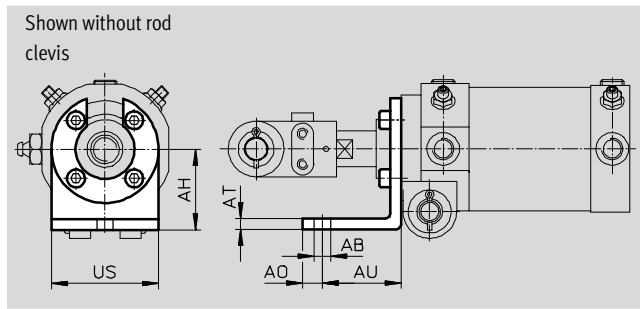

Dimensions and ordering data										Weight [g]	Part No.	Type
For Ø	AB Ø	AH	AO	AT	AU	US						
50, 63, 80	9	45	11	10	44	60	241	<b>549603</b>	<b>HNH-50/63/80</b>			

## Mounting bracket TBH

Material:  
Steel

Scope of delivery:  
4 screws, short  
4 screws, long

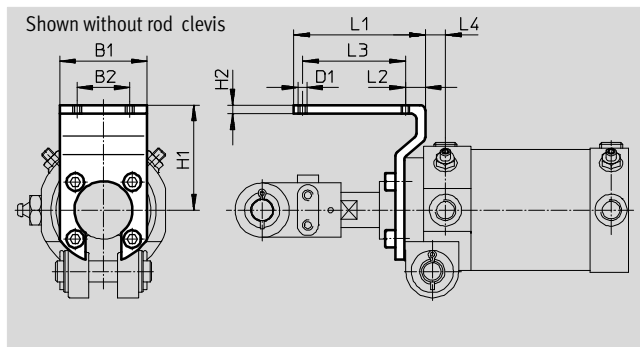

Dimensions and ordering data										Weight [g]	Part No.	Type
For Ø	B1	B2	D1	H1	H2	L1	L2	L3	L4			
50, 63, 80	50	30.2	M5	60	5	75	11.3	58.7	17	282	<b>549605</b>	<b>TBH-50/63/80</b>

## Switch lever KTH

Material:  
Steel

Scope of delivery:  
2 screws

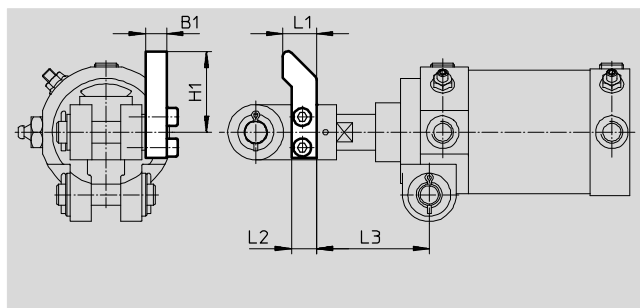

Dimensions and ordering data						Weight [g]	Part No.	Type
For Ø	B1	H1	L1	L2	L3			
50, 63	12	45.2	19	14	63	83	<b>549607</b>	<b>KTH-50/63/80</b>
80	12	45.2	19	14	68.5			



# Hinge cylinders DW

Accessories

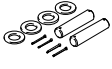
FESTO

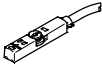
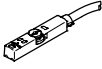
Ordering data – Mounting kit						
	Scope of delivery	For Ø	Weight [g]	Part No.	Type	
	2 bolts, 4 retaining pins and 4 washers	50, 63	117	<b>573323</b>	<b>DAMD-F5-S-50</b>	
		80	362	<b>573172</b>	<b>DAMD-F5-S-80</b>	

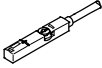
Ordering data – Proximity sensors for T-slot, magneto-resistive						Technical data → Internet: smt
	Type of mounting	Switch output	Electrical connection	Cable length [m]	Part No.	Type
N/O contact						
	Insertable in the slot from above, flush with cylinder profile, short design	PNP	Cable, 3-wire	2.5	<b>574335</b>	<b>SMT-8M-A-PS-24V-E-2,5-OE</b>
			Plug M8x1, 3-pin	0.3	<b>574334</b>	<b>SMT-8M-A-PS-24V-E-0,3-M8D</b>
		NPN	Cable, 3-wire	2.5	<b>574338</b>	<b>SMT-8M-A-NS-24V-E-2,5-OE</b>
			Plug M8x1, 3-pin	0.3	<b>574339</b>	<b>SMT-8M-A-NS-24V-E-0,3-M8D</b>
N/C contact						
	Insertable in the slot from above, flush with cylinder profile, short design	PNP	Cable, 3-wire	7.5	<b>574340</b>	<b>SMT-8M-A-PO-24V-E-7,5-OE</b>

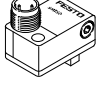

Ordering data – Proximity sensor for T-slot, magnetic reed						Technical data → Internet: sme
	Type of mounting	Switching output	Electrical connection	Cable length [m]	Part No.	Type
N/O contact						
	Insertable in slot from above, flush with cylinder profile	Contacting	Cable, 3-wire	2.5	<b>543862</b>	<b>SME-8M-DS-24V-K-2,5-OE</b>
			Cable, 3-wire	5.0	<b>543863</b>	<b>SME-8M-DS-24V-K-5,0-OE</b>
		Contacting	Cable, 2-wire	2.5	<b>543872</b>	<b>SME-8M-ZS-24V-K-2,5-OE</b>
			Plug M8x1, 3-pin	0.3	<b>543861</b>	<b>SME-8M-DS-24V-K-0,3-M8D</b>
	Insertable in slot lengthwise, flush with cylinder profile	Contacting	Cable, 3-wire	2.5	<b>150855</b>	<b>SME-8-K-LED-24</b>
			Plug M8x1, 3-pin	0.3	<b>150857</b>	<b>SME-8-S-LED-24</b>
N/C contact						
	Insertable in slot lengthwise, flush with cylinder profile	Contacting	Cable, 3-wire	7.5	<b>160251</b>	<b>SME-8-O-K-LED-24</b>

Ordering data – Proximity sensor for T-slot, welding field immune					Technical data → Internet: smtso
	Switching output	Electrical connection, right	Cable length [m]	Part No.	Type
	PNP	Plug M12x1, 3-pin	2.5	<b>191986</b>	<b>SMTSO-8E-PS-M12-LED-24</b>
	NPN	Plug M12x1, 3-pin	2.5	<b>175825</b>	<b>SMTSO-8E-NS-M12-LED-24</b>

# Hinge cylinders DW

Accessories

**FESTO**

Ordering data – Connecting cables				Technical data → Internet: nebu	
	Electrical connection, left	Electrical connection, right	Cable length [m]	Part No.	Type
	Straight socket, M8x1, 3-pin	Cable, open end, 3-wire	2.5	<b>541333</b>	<b>NEBU-M8G3-K-2.5-LE3</b>
			5	<b>541334</b>	<b>NEBU-M8G3-K-5-LE3</b>
	Angled socket, M8x1, 3-pin	Cable, open end, 3-wire	2.5	<b>541338</b>	<b>NEBU-M8W3-K-2.5-LE3</b>
			5	<b>541341</b>	<b>NEBU-M8W3-K-5-LE3</b>
	Angled socket, M12x1, 5-pin	Cable, open end, 3-wire	2.5	<b>541363</b>	<b>NEBU-M12G5-K-2.5-LE3</b>
			5	<b>541364</b>	<b>NEBU-M12G5-K-5-LE3</b>

Ordering data – Mounting kit			Technical data → Internet: smbr	
			Part No.	Type
	For mounting the proximity sensor SME-/SMT-8M or SMTSO-8E on the cylinder		<b>538937</b>	<b>SMBR-8-8/100-S6</b>

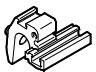
Ordering data – Mounting kit			Technical data → Internet: smbz	
			Part No.	Type
	For mounting the proximity sensor SME-/SMT-8 or SMTSO-8E on the sensor strip		<b>537806</b>	<b>SMBZ-8-32/100</b>

## Product Range and Company Overview

### A Complete Suite and Company Overview

Our experienced engineers provide complete support at every stage of your development process, including: conceptualization, analysis, engineering, design, assembly, documentation, validation, and production.



**Custom Automation Components**  
Complete custom engineered solutions

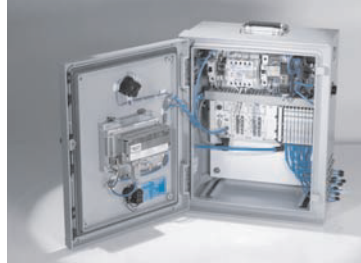

**Custom Control Cabinets**  
Comprehensive engineering support and on-site services



**Complete Systems**  
Shipment, stocking and storage services

### The Broadest Range of Automation Components

With a comprehensive line of more than 30,000 automation components, Festo is capable of solving the most complex automation requirements.



**Electromechanical**  
Electromechanical actuators, motors, controllers & drivers



**Pneumatics**  
Pneumatic linear and rotary actuators, valves, and air supply



**PLCs and I/O Devices**  
PLC's, operator interfaces, sensors and I/O devices

### Supporting Advanced Automation... As No One Else Can!

Festo is a leading global manufacturer of pneumatic and electromechanical systems, components and controls for industrial automation, with more than 16,000 employees in 60 national headquarters serving more than 180 countries. For more than 80 years, Festo has continuously elevated the state of manufacturing with innovations and optimized motion control solutions that deliver higher performing, more profitable automated manufacturing and processing equipment. Our dedication to the advancement of automation extends beyond technology to the education and development of current and future automation and robotics designers with simulation tools, teaching programs, and on-site services.

### Quality Assurance, ISO 9001 and ISO 14001 Certifications

Festo Corporation is committed to supply all Festo products and services that will meet or exceed our customers' requirements in product quality, delivery, customer service and satisfaction.

To meet this commitment, we strive to ensure a consistent, integrated, and systematic approach to management that will meet or exceed the requirements of the ISO 9001 standard for Quality Management and the ISO 14001 standard for Environmental Management.



© Copyright 2013, Festo Corporation. While every effort is made to ensure that all dimensions and specifications are correct, Festo cannot guarantee that publications are completely free of any error, in particular typing or printing errors. Accordingly, Festo cannot be held responsible for the same. For Liability and Warranty conditions, refer to our "Terms and Conditions of Sale", available from your local Festo office. All rights reserved. No part of this publication may be reproduced, distributed, or transmitted in any form or by any means, electronic, mechanical, photocopying or otherwise, without the prior written permission of Festo. All technical data subject to change according to technical update.



Printed on recycled paper at New Horizon Graphic, Inc., FSC certified as an environmental friendly printing plant.

# Festo North America

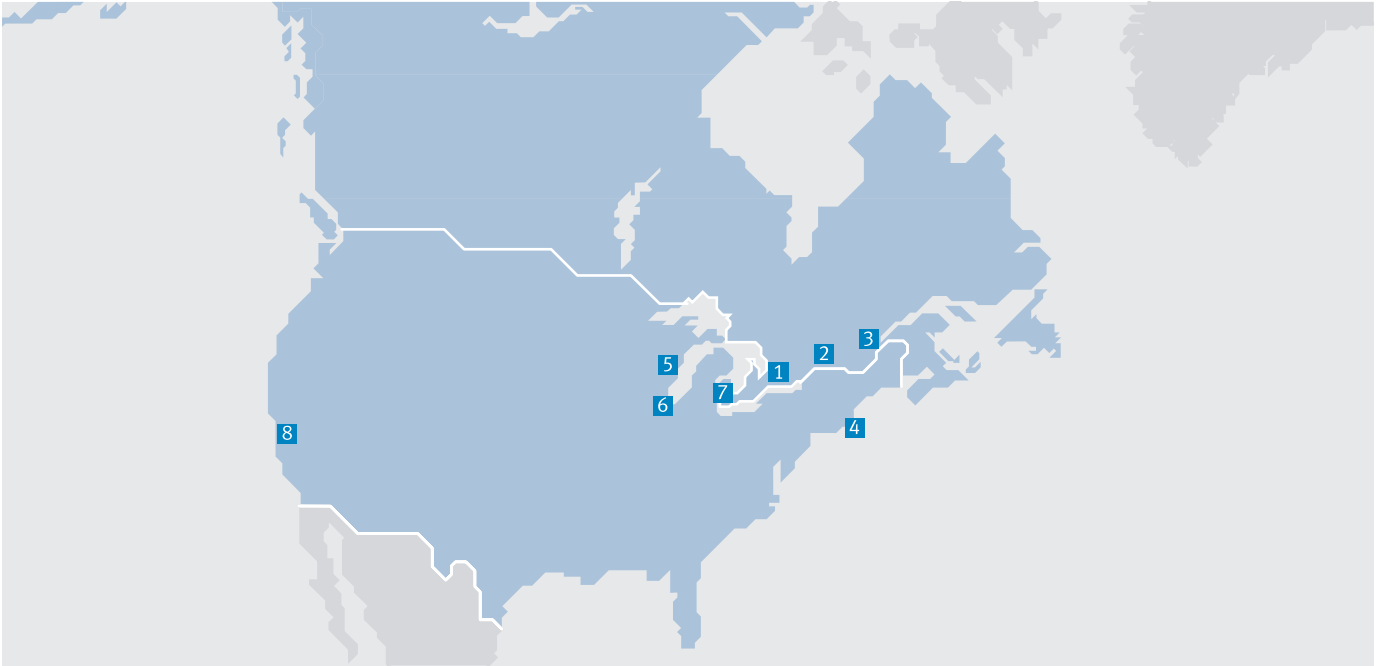

**1 Festo Canada  
Headquarters  
Festo Inc.**  
5300 Explorer Drive  
Mississauga, ON  
L4W 5G4

**2 Montréal**  
5600, Trans-Canada  
Pointe-Claire, QC  
H9R 1B6

**3 Québec City**  
2930, rue Watt#117  
Québec, QC  
G1X 4G3



**4 Festo United States  
Headquarters  
Festo Corporation**  
395 Moreland Road  
Hauppauge, NY  
11788

**5 Appleton**  
North 922 Tower View Drive, Suite N  
Greenville, WI  
54942

**7 Detroit**  
1441 West Long Lake Road  
Troy, MI  
48098

**6 Chicago**  
85 W Algonquin - Suite 340  
Arlington Heights, IL  
60005

**8 Silicon Valley**  
4935 Southfront Road, Suite F  
Livermore, CA  
94550

## Festo Regional Contact Center

### Canadian Customers

Commercial Support:  
Tel: 1 877 GO FESTO (1 877 463 3786)  
Fax: 1 877 FX FESTO (1 877 393 3786)  
Email: festo.canada@ca.festo.com

Technical Support:  
Tel: 1 866 GO FESTO (1 866 463 3786)  
Fax: 1 877 FX FESTO (1 877 393 3786)  
Email: technical.support@ca.festo.com

### USA Customers

Commercial Support:  
Tel: 1 800 99 FESTO (1 800 993 3786)  
Fax: 1 800 96 FESTO (1 800 963 3786)  
Email: customer.service@us.festo.com

Technical Support:  
Tel: 1 866 GO FESTO (1 866 463 3786)  
Fax: 1 800 96 FESTO (1 800 963 3786)  
Email: product.support@us.festo.com

Subject to change

Internet: [www.festo.com/us](http://www.festo.com/us)