

## Three-point grippers DHDS

**FESTO**



# Three-point grippers DHDS

Key features

FESTO

## At a glance

### General information

- Resilient and precise T-slot guide of the gripper jaws
- High gripping forces with compact dimensions
- Gripper jaw centring options
- Max. repetition accuracy
- Gripping force retention
- Internal fixed flow control
- Wide range of options for mounting on drive units

### Flexible range of applications

- Sensor technology:
  - Adaptable position sensor for the small gripper sizes
  - Integratable proximity sensors for the medium and large gripper sizes
- Can be used as a double-acting and single-acting gripper
- Compression spring for supplementary or retaining gripping forces
- Suitable for external and internal gripping

## The technology in detail

### Gripper closed

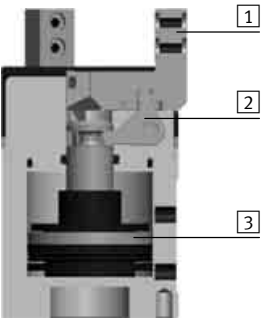

### Gripper open

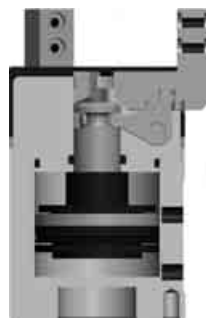

- 1 Gripper jaw
- 2 Reversing lever
- 3 Piston with magnet

-  - Note

Gripper selection  
sizing software  
→ [www.festo.com](http://www.festo.com)

## Position sensing/force control

### With position transmitter SMAT-8M



- Analogue positional feedback possible
- Analogue output 0 ... 10 V

### With proportional pressure regulator VPPM



- Infinite adjustment of the gripping force possible
- Setpoint input
    - 0 ... 10 V
    - 4 ... 20 mA

### With proximity sensor SMT-8G



- Multiple positions can be sensed:
- Open
  - Closed
  - Workpiece gripped

# Three-point grippers DHDS

Key features

## Supply ports

At the side

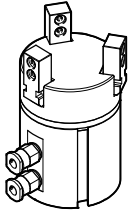

## Mounting options

Size 16

Size 32, 50

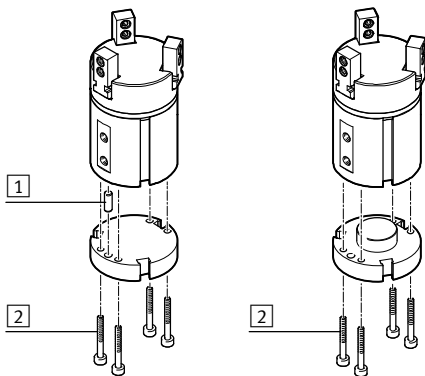

- 1 Centring pin
- 2 Mounting screws

## Mounting options for external gripper fingers

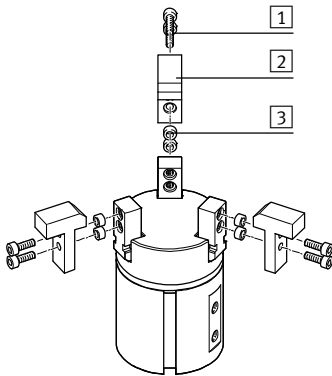

- 1 Mounting screws
- 2 Gripper fingers
- 3 Centring sleeves

-  - Note

These grippers are not designed for the following or similar sample applications:

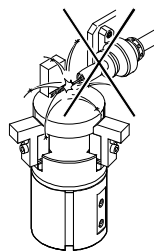

- Welding spatter

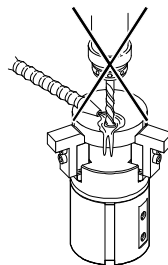

- Machining
- Aggressive media

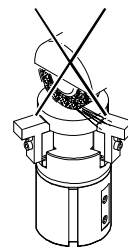

- Grinding dust

# Three-point grippers DHDS

Peripherals overview

FESTO

## Peripherals overview

DHDS-16

DHDS-32, 50

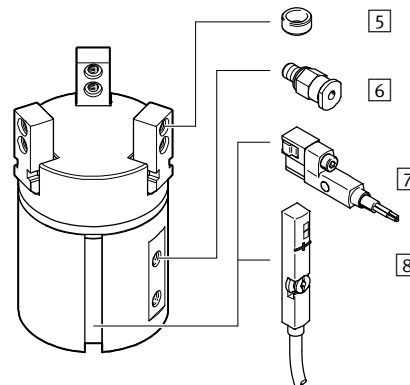
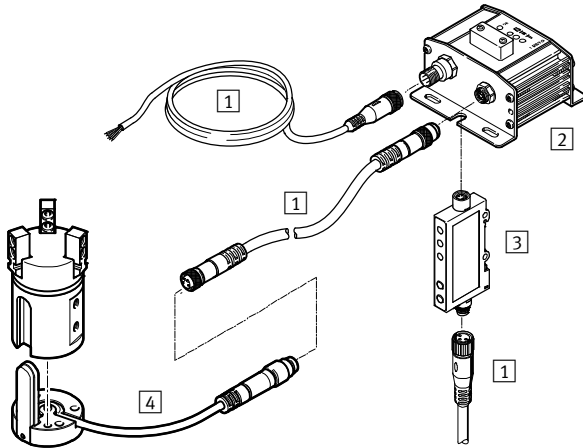

## System product for handling and assembly technology

## Proportional pressure regulator VPPM

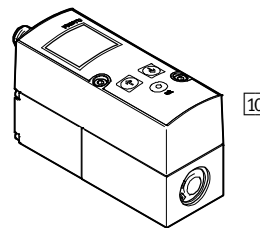
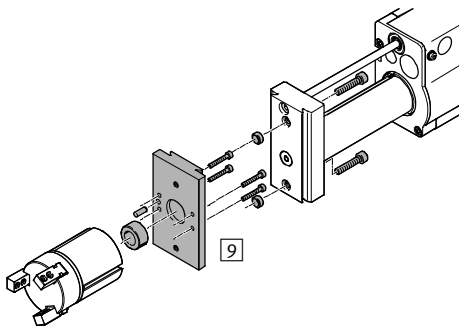

Accessories			
Type	Size	Description	→ Page/Internet
1 Connecting cable NEBU	16 ... 50	For connecting evaluation unit and signal converter	17
2 Evaluation unit SMH-AE1	16	<ul style="list-style-type: none"> <li>For evaluating signals for position sensor SMH-S1</li> </ul>	17
3 Signal converter SVE4	16	<ul style="list-style-type: none"> <li>For evaluating signals for position sensor SMH-S1</li> </ul>	17
4 Position sensor SMH-S1	16	<ul style="list-style-type: none"> <li>Adaptable and integratable sensor technology, for sensing the piston position</li> </ul>	17
5 Centring sleeve ZBH	16 ... 50	<ul style="list-style-type: none"> <li>For centring the gripper fingers on the gripper jaws</li> <li>The scope of delivery of the gripper includes 6 centring sleeves</li> </ul>	17
6 Push-in fitting QS	16 ... 50	For connecting compressed air tubing with standard O.D.	quick star
7 Proximity sensor SMT-8G	32, 50	<ul style="list-style-type: none"> <li>For sensing the piston position</li> <li>Proximity sensor does not project past the housing at the bottom</li> </ul>	18
8 Position transmitter SMAT-8M	32, 50	<ul style="list-style-type: none"> <li>Continuously senses the position of the piston. Has an analogue output with an output signal in proportion to the piston position.</li> </ul>	18
9 Adapter kit DHAA, HMSV, HAPG, HAPS, HMVA	16 ... 50	Connecting plate between drive and gripper	14
10 Proportional pressure regulator VPPM	16 ... 50	For infinite adjustment of the gripping force	vppm

# Three-point grippers DHDS

Type codes

DHDS – 32 – A – NC

**Type**

DHDS	Three-point gripper
------	---------------------

**Size**

**Position sensing**

A	Via proximity sensor
---	----------------------

**Gripping force retention**

NC	Closing
----	---------

# Three-point grippers DHDS

Technical data

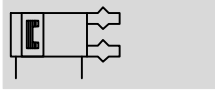

FESTO

Function  
Double-acting  
DHDS-...-A



Function – Variants  
Single-acting or  
with gripping force retention ...  
... closing DHDS-...-NC



-  Size  
16 ... 50 mm
-  Stroke  
2.5 ... 6 mm
-  [www.festo.com](http://www.festo.com)

General technical data			
Size	16	32	50
Design	Lever Forced motion sequence		
Mode of operation	Double-acting		
Gripper function	Three-point		
Gripping force retention	NC	NC	NC
Number of gripper jaws	3		
Max. load per external gripper finger <sup>1)</sup>	[g] 50	150	250
Stroke per gripper jaw	[mm] 2.5	3.9	6
Pneumatic connection	M3	M5	G1/8
Repetition accuracy <sup>2)</sup>	[mm] ≤ 0.04		
Max. interchangeability	[mm] ≤ ±0.2		
Max. operating frequency	[Hz] ≤ 4		
Rotational symmetry	[mm] < Ø 0.2		
Position sensing	Via position sensor	Via proximity sensor, position transmitter	
Type of mounting	Via female thread and dowel pin		
Mounting position	Any		

- 1) Valid for unthrottled operation
- 2) End-position drift under constant conditions of use with 100 consecutive strokes, concentric to the central shaft

Operating and environmental conditions		
Min. operating pressure		
DHDS-...-A	[bar]	2
DHDS-...-A-NC	[bar]	4
Max. operating pressure	[bar]	8
Operating medium	Compressed air in accordance with ISO 8573-1:2010 [7:4:4]	
Note on operating/pilot medium	Operation with lubricated medium possible (in which case lubricated operation will always be required)	
Ambient temperature <sup>1)</sup>	[°C]	+5 ... +60
Corrosion resistance class CRC <sup>2)</sup>	1	

- 1) Note operating range of proximity sensors
- 2) Corrosion resistance class CRC 1 to Festo standard FN 940070  
Low corrosion stress. For dry indoor applications or transport and storage protection. Also applies to parts behind covers, in the non-visible interior area, and parts which are covered in the application (e.g. drive trunnions).

Weight [g]			
Size	16	32	50
DHDS-...-A	96	276	920
DHDS-...-A-NC	99	281	932

# Three-point grippers DHDS

Technical data

## Materials

Sectional view

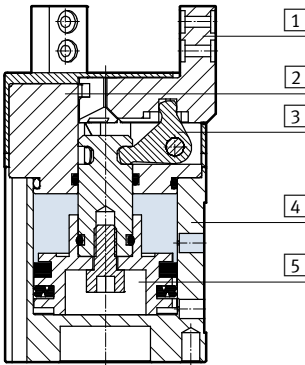

Three-point gripper		
1	Gripper jaw	High-alloy stainless steel
2	Cover cap	Polyamide
3	Reversing lever	Hardened sintered steel
4	Housing	Hard anodised wrought aluminium alloy
5	Piston	Polyacetal
-	Note on materials	Free of copper and PTFE RoHS-compliant

## Gripping force [N] at 6 bar

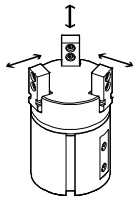

Size	16	32	50	
Gripping force per gripper jaw				
DHDS-...-A	Opening	40	135	280
	Closing	29	115	250
Total gripping force				
DHDS-...-A	Opening	120	405	840
	Closing	87	345	750

## Characteristic load values at the gripper jaws

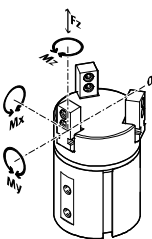

The indicated permissible forces and torques apply to a single gripper jaw. They include the lever arm, additional applied loads due to the workpiece or external gripper fingers and acceleration forces occurring during movement.

The zero coordinate line (gripper finger point of rotation) must be taken into consideration for the calculation of torques.

Size	16	32	50	
Max. permissible force $F_z$	[N]	50	150	250
Max. permissible torque $M_x$	[Nm]	2	9	24
Max. permissible torque $M_y$	[Nm]	2	9	24
Max. permissible torque $M_z$	[Nm]	2	9	24

# Three-point grippers DHDS

Technical data

## Mass moment of inertia [kgcm<sup>2</sup>]

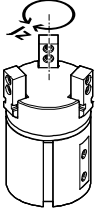

Mass moment of inertia of the three-point gripper in relation to the central axis, without external gripper fingers, without load.

Size	16	32	50
DHDS-...	0.14	0.79	6.10
DHDS-...-NC	0.14	0.82	6.18

## Gripper jaw backlash

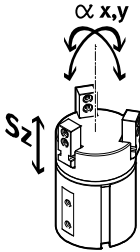

The plain-bearing guide used in the grippers means that there is backlash between the gripper jaws and the housing. The values entered in the table for the backlash were calculated in accordance with the traditional accumulative tolerance method.

Size	16	32	50
Max. gripper jaw backlash Sz [mm]	≤ 0.02		
Max. gripper jaw angular backlash ax, ay [°]	≤ 0.5		≤ 0.2

## Opening and closing times [ms] at 6 bar

Without external gripper fingers

With external gripper fingers

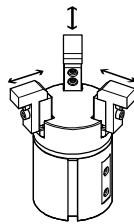
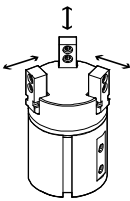

The indicated opening and closing times [ms] were measured at room temperature at an operating pressure of 6 bar with horizontally mounted grippers without additional gripper

fingers. The grippers must be throttled for greater loads [g]. Opening and closing times must then be adjusted accordingly.

Size	16	32	50	
Without external gripper fingers				
DHDS-...-A	Opening	26	44	62
	Closing	42	51	55
DHDS-...-A-NC	Opening	31	55	73
	Closing	34	47	50
With external gripper fingers per gripper finger (as a function of the load)				
DHDS-...	100 g	100	-	-
	200 g	-	100	-
	300 g	-	200	100
	400 g	-	-	200
	500 g	-	-	300



# Three-point grippers DHDS

Technical data

## Gripping force $F_H$ per gripper jaw as a function of operating pressure and lever arm $x$

The gripping forces as a function of operating pressure and lever arm can be determined from the following graphs.

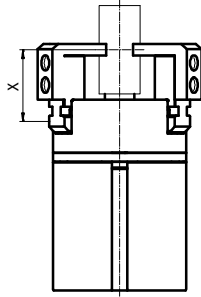

- 2 bar
- - - 4 bar
- · - 6 bar
- · · 8 bar

Note  
Gripper selection  
sizing software  
→ [www.festo.com](http://www.festo.com)

### External gripping (closing)

DHDS-16-A

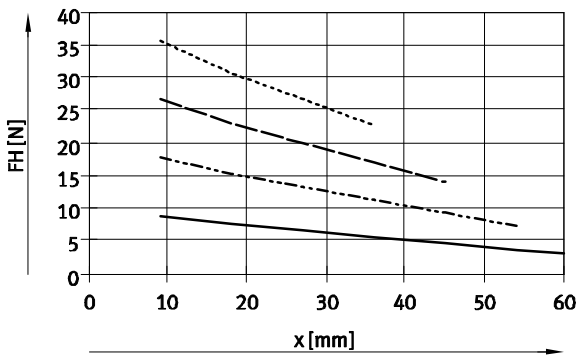

DHDS-32-A

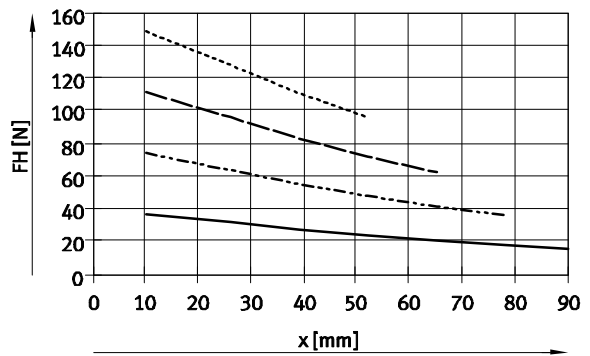

DHDS-50-A

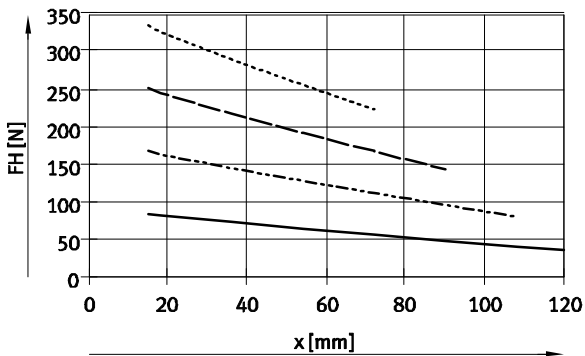

# Three-point grippers DHDS

Technical data

## Gripping force $F_H$ per gripper jaw as a function of operating pressure and lever arm $x$

The gripping forces as a function of operating pressure and lever arm can be determined from the following graphs.

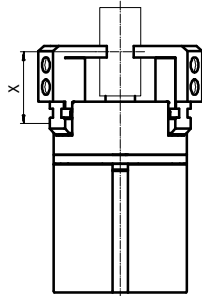

Note  
Gripper selection  
sizing software  
→ [www.festo.com](http://www.festo.com)

- 2 bar
- - - 4 bar
- · - 6 bar
- · · 8 bar

### Internal gripping (opening)

DHDS-16-A

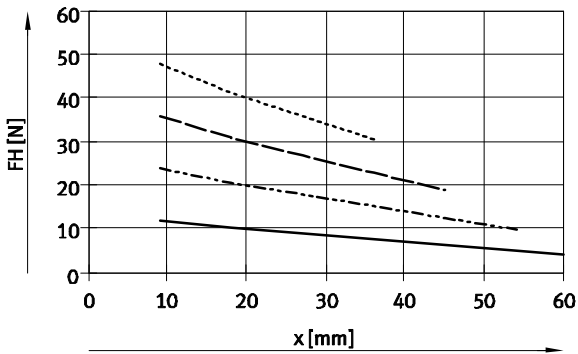

DHDS-32-A

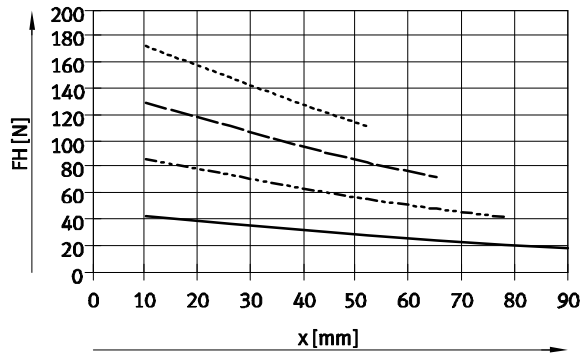

DHDS-50-A

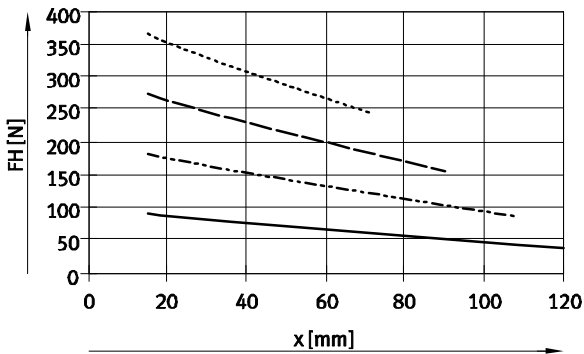

# Three-point grippers DHDS

Technical data

## Spring force $F_F$ as a function of size and gripper jaw stroke $l$

Gripping force retention for DHDS-...-NC

The spring forces  $F_F$  as a function of gripper jaw stroke can be determined from the following graph.

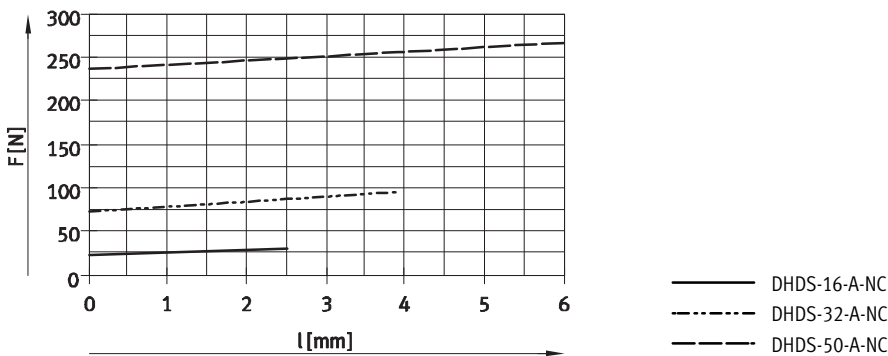
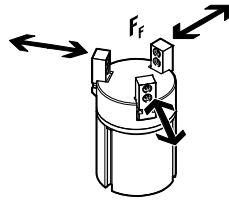

## Spring force $F_F$ as a function of size, gripper jaw stroke $l$ and lever arm $x$ per gripper finger

The lever arm  $x$  must be taken into consideration when determining the actual spring force  $F_{Ftotal}$ . The formulae for calculating the spring force are provided in the table below.

Gripping force retention	Size	$F_{Ftotal}$ per gripper finger
NC	16	$-0.1 \cdot x + 0.33 \cdot F_F$
	32	$-0.2 \cdot x + 0.33 \cdot F_F$
	50	$-0.3 \cdot x + 0.33 \cdot F_F$

## Determination of the actual gripping forces $F_{Gr}$ for DHDS-...-NC as a function of application per gripper finger

The three-point grippers with integrated spring type DHDS-...-NC (closing gripping force retention) can be used as:

- single-acting grippers

- grippers with supplementary gripping force and
- grippers with gripping force retention depending on requirements.

In order to calculate the available gripping forces  $F_{Gr}$  (per gripper finger), the gripping force ( $F_H$ ) and spring

force ( $F_{Ftotal}$ ) must be combined accordingly.

## Application forces per gripper finger

Single-acting	Supplementary gripping force	Gripping force retention
<ul style="list-style-type: none"> <li>Gripping with spring force: <math>F_{Gr} = F_{Ftotal}</math></li> <li>Gripping with pressure force: <math>F_{Gr} = F_H - F_{Ftotal}</math></li> </ul>	<ul style="list-style-type: none"> <li>Gripping with pressure and spring force: <math>F_{Gr} = F_H + F_{Ftotal}</math></li> </ul>	<ul style="list-style-type: none"> <li>Gripping with spring force: <math>F_{Gr} = F_{Ftotal}</math></li> </ul>

# Three-point grippers DHDS

Technical data

FESTO

Dimensions

Download CAD data → [www.festo.com](http://www.festo.com)

DHDS-16

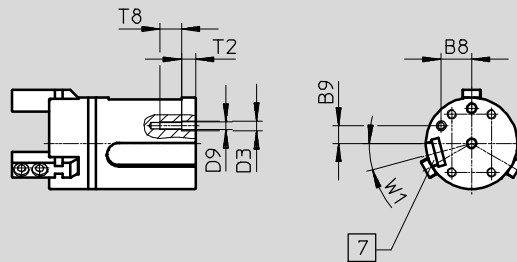

DHDS-32, 50

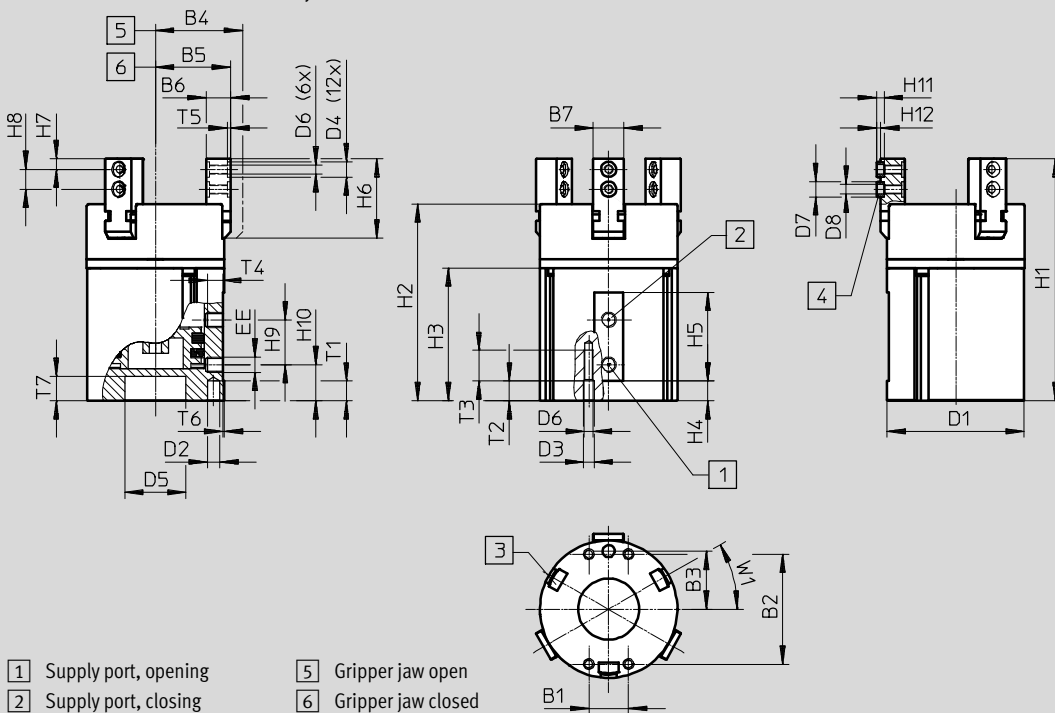

- |   |                            |
|---|----------------------------|
| 1 Supply port, opening  | 5 Gripper jaw open         |
| 2 Supply port, closing  | 6 Gripper jaw closed       |
| 3 Slot for proximity sensor                                       | 7 Slot for position sensor |
| 4 Centring sleeve ZBH<br>(6 included in the scope of<br>delivery) |                            |

# Three-point grippers DHDS

Technical data

Size	B1	B2	B3	B4	B5	B6	B7	B8	B9
[mm]			±0.02	±0.5	±0.5	-0.02/-0.05	-0.02	-0.1	-0.1
16	13	19	11.5	20	17.5	7	6	9.96	5.75
32	13	36	19	28.5	24.6	8	10	-	-
50	25	54	30	43	37	12	14	-	-

Size	D1	D2	D3	D4	D5	D6	D7	D8	D9
[mm]	∅	∅ H8	∅ H8	∅ H8	∅ +0.05/+0.02		∅ h7	∅	
16	30	3	3.2	5	-	M3	5	3.2	M2.5
32	45	4	3.5	5	20	M3	5	3.2	-
50	70	5	6	7	30	M5	7	5.3	-

Size	EE	H1	H2	H3	H4	H5	H6	H7	H8 <sup>1)</sup>	H9
[mm]										
16	M3	60	47.9	32.6	4.5	24	21.5	3	6	12
32	M5	78	63.2	42.2	5.2	29	26	3.5	6.5	14.7
50	G $\frac{1}{8}$	107.5	86.5	56	6.7	40	37	5	10	22

Size	H10	T1	T2	T3	T4	T5	T6	T7	T8	W1
[mm]		min.	min.	+1	-0.5	+0.1	±0.2		±1	
16	11	4.5	4.5	8	4	1.2	1	-	7	15°
32	10.5	6.5	6.5	10	4	1.1	0.5	8	-	30°
50	16	7	7	18	6	1.6	1	9	-	30°

1) Tolerance for centring hole ±0.02 mm  
Tolerance for thread ±0.1 mm

Ordering data					
Size	Double-acting without compression spring			Single-acting or with gripping force retention	
	Part No.	Type		Part No.	Type
16	1259491	DHDS-16-A		1259492	DHDS-16-A-NC
32	1259493	DHDS-32-A		1259494	DHDS-32-A-NC
50	1259495	DHDS-50-A		1259496	DHDS-50-A-NC

# Three-point grippers DHDS

Accessories

FESTO

**Adapter kit**  
DHAA, HAPG, HMSV, HMVA

Material:  
Wrought aluminium alloy  
Free of copper and PTFE  
RoHS-compliant

 Note  
The kit includes the individual mounting interface as well as the necessary mounting material.

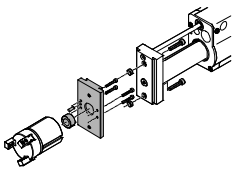
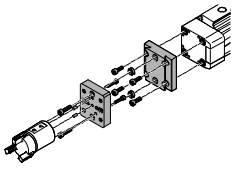
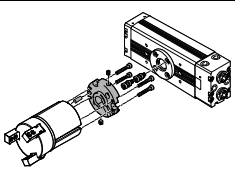
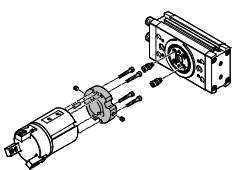
Permissible drive/gripper combinations with adapter kit						Download CAD data → <a href="http://www.festo.com">www.festo.com</a>
Combination	Drive	Gripper	Adapter kit			
	Size	Size	CRC <sup>1)</sup>	Part No.	Type	
	HMP	DHDS	HMSV			
	Direct mounting					
	16, 20, 25	32	2	177765	HMSV-25	
	25, 32	50		177766	HMSV-26	
	Dovetail mounting					
	16, 20, 25	32	2	178212	HMSV-32	
25, 32	50	178213		HMSV-33		
	DG...	DHDS	HMVA, HAPG, HMSV			
	Direct mounting					
	18 <sup>2)</sup> , 25	16	2	196788	HMVA-DLA18/25	
	40	16		193921	HAPG-36-S3	
				196790	HMVA-DLA40	
	Dovetail mounting					
40	32	2	196790	HMVA-DLA40		
40	50		178212	HMSV-32		
		196790	HMVA-DLA40			
178213	HMSV-33					
	DRQD	DHDS	HAPG			
	8, 12	16	2	187569	HAPG-35	
	16	16		187567	HAPG-SD2-13	
	20	32		184481	HAPG-SD2-5	
	25	50		184484	HAPG-SD2-8	
	32	50		184487	HAPG-SD2-11	
40, 50	50	526026		HAPG-SD2-20		
	DRRD	DHDS	DHAA			
	12	16	2	2823512	DHAA-G-Q11-12-B4-16	
	16	16		2136626	DHAA-G-Q11-16-B4-16	
	16	32		2151381	DHAA-G-Q11-16-B4-32	
	20	32		2136339	DHAA-G-Q11-20-B4-32	
	25	32		1471583	DHAA-G-Q11-25-B4-32	
	25	50		1731165	DHAA-G-Q11-25-B4-50	
	32	50		1907040	DHAA-G-Q11-32-B4-50	
	35	50		2135899	DHAA-G-Q11-35-B4-50	

1) Corrosion resistance class CRC 2 to Festo standard FN 940070  
Moderate corrosion stress. Indoor applications in which condensation may occur. External visible parts with primarily decorative requirements for the surface and which are in direct contact with the ambient atmosphere typical for industrial applications.

2) Only for DGEA...

# Three-point grippers DHDS

Accessories



**Adapter kit**  
**HAPG**

Material:  
Wrought aluminium alloy  
Free of copper and PTFE  
RoHS-compliant

 Note  
The kit includes the individual mounting interface as well as the necessary mounting material.

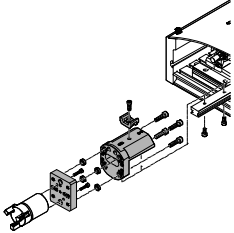
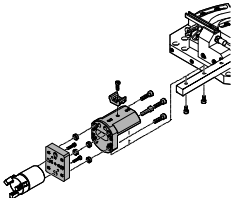
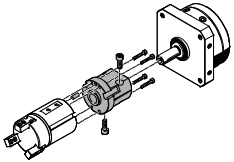
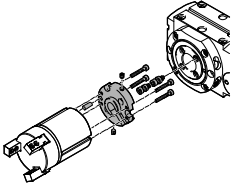
Permissible drive/gripper combinations with adapter kit				Download CAD data → <a href="http://www.festo.com">www.festo.com</a>	
Combination	Drive	Gripper	Adapter kit		
	Size	Size	CRC <sup>1)</sup>	Part No.	Type
	HSP	DHDS	HAPG		
	16	16	2	192705	HAPG-36-S1
				540882	HAPG-71-B
	25	16	192705	HAPG-36-S1	
		540883	HAPG-72-B		
	HSW	DHDS	HAPG		
	16	16	2	192705	HAPG-36-S1
				540882	HAPG-71-B
	DSM	DHDS	HAPG		
	8, 10	16	2	187569	HAPG-35
				163272	HAPG-23
	25	32			
	ERMB	DHDS	HAPG		
	20	32	2	184481	HAPG-SD2-5
	25	50		184484	HAPG-SD2-8
	32	50		184487	HAPG-SD2-11

1) Corrosion resistance class CRC 2 to Festo standard FN 940070  
Moderate corrosion stress. Indoor applications in which condensation may occur. External visible parts with primarily decorative requirements for the surface and which are in direct contact with the ambient atmosphere typical for industrial applications.

# Three-point grippers DHDS

Accessories



**Adapter kit  
HAPG**

Material:  
Wrought aluminium alloy  
Free of copper and PTFE  
RoHS-compliant

 Note  
The kit includes the individual mounting interface as well as the necessary mounting material.

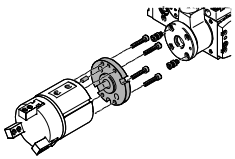
Permissible drive/gripper combinations with adapter kit			Download CAD data → <a href="http://www.festo.com">www.festo.com</a>		
Combination	Drive	Gripper	Adapter kit		
	Size	Size	CRC <sup>1)</sup>	Part No.	Type
	EHMB	DHDS	HAPG		
	20	50	2	<b>184487</b>	<b>HAPG-SD2-11</b>
	25, 32	50		<b>526026</b>	<b>HAPG-SD2-20</b>

1) Corrosion resistance class CRC 2 to Festo standard FN 940070  
Moderate corrosion stress. Indoor applications in which condensation may occur. External visible parts with primarily decorative requirements for the surface and which are in direct contact with the ambient atmosphere typical for industrial applications.



# Three-point grippers DHDS

Accessories

FESTO



Ordering data						
	For size [mm]	Comment	Weight [g]	Part No.	Type	PU <sup>1)</sup>
Centring sleeve ZBH <span style="float: right;">Technical data → Internet: zbh</span>						
	16, 32	For centring the gripper fingers on the gripper jaws	1	189652	ZBH-5	10
	50		1	186717	ZBH-7	

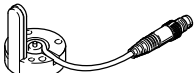



1) Packaging unit

Ordering data						
Type	For size	Weight [g]	Part No.	Type		
Position sensor SMH-S1 <span style="float: right;">Technical data → Internet: smh-s1</span>						
	16	30	175713	SMH-S1-HGD16		

Signal converter/evaluation unit for position sensor SMH-S1	
Signal converter SVE4	Evaluation unit SMH-AE1

- Converts analogue signals into switching points
- Switching function freely programmable with teach-in
- Threshold value, hysteresis or window comparator
- Converts analogue signals into switching points
- With 3 potentiometers for setting 3 switching points

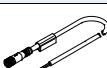
Ordering data						
Type	For size	Input connection	Output connection	Switching output	Weight [g]	Part No. Type
Signal converter SVE4 <span style="float: right;">Technical data → Internet: sve4</span>						
	16	Socket M8x1, 4-pin	Plug M8x1, 4-pin	2x PNP	19	544216 SVE4-HS-R-HM8-2P-M8
				2x NPN		544219 SVE4-HS-R-HM8-2N-M8
Evaluation unit SMH-AE1 <span style="float: right;">Technical data → Internet: smh-ae</span>						
	16	Socket M8x1, 4-pin	Plug M12x1, 5-pin	3x PNP	170	175708 SMH-AE1-PS3-M12
				3x NPN		175709 SMH-AE1-NS3-M12

Ordering data – Connecting cables						Technical data → Internet: nebu
	Electrical connection, left	Electrical connection, right	Cable length [m]	Part No.	Type	
Connection between position sensor and signal converter/evaluation unit						
	Straight socket, M8x1, 4-pin	Straight plug, M8x1, 4-pin	2.5	544035	NEBU-M8G4-K-2.5-M8G4	
Connection between evaluation unit and controller						
	Straight socket, M12x1, 5-pin	Cable, open end, 5-wire	2.5	541330	NEBU-M12G5-K-2.5-LE5	
			5	541331	NEBU-M12G5-K-5-LE5	
Connection between signal converter and controller						
	Straight socket, M8x1, 4-pin	Cable, open end, 4-wire	2.5	541342	NEBU-M8G4-K-2.5-LE4	
			5	541343	NEBU-M8G4-K-5-LE4	
	Angled socket, M8x1, 4-pin	Cable, open end, 4-wire	2.5	541344	NEBU-M8W4-K-2.5-LE4	
			5	541345	NEBU-M8W4-K-5-LE4	



# Three-point grippers DHDS

Accessories

FESTO

## Proximity sensor for size 32, 50

Ordering data – Proximity sensors for T-slot, magneto-resistive						Technical data → Internet: smt	
	Type of mounting	Electrical connection, connection direction	Switching output	Cable length [m]	Part No.	Type	
N/O contact							
	Insertable in the slot lengthwise	Cable, 3-wire, lateral	PNP	2.5	547859	SMT-8G-PS-24V-E-2,5Q-OE	
		Plug M8x1, 3-pin, lateral		0.3	547860	SMT-8G-PS-24V-E-0,3Q-M8D	



Ordering data – Connecting cables					Technical data → Internet: nebu	
	Electrical connection, left	Electrical connection, right	Cable length [m]	Part No.	Type	
	Straight socket, M8x1, 3-pin	Cable, open end, 3-wire	2.5	541333	NEBU-M8G3-K-2.5-LE3	
			5	541334	NEBU-M8G3-K-5-LE3	
	Angled socket, M8x1, 3-pin	Cable, open end, 3-wire	2.5	541338	NEBU-M8W3-K-2.5-LE3	
			5	541341	NEBU-M8W3-K-5-LE3	

## Position transmitter

The position transmitter continuously senses the position of the piston.

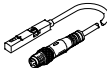
It has an analogue output with an output signal in proportion to the piston position.

Ordering data – Position transmitters for T-slot							Technical data → Internet: position transmitter		
	For size	Position measuring range	Analogue output		Type of mounting	Electrical connection	Cable length [m]	Part No.	Type
			[V]	[mA]					
	32, 50	0 ... 40	0 ... 10	–	Insertable in slot from above	Plug M8x1, 4-pin, in-line	0.3	553744	SMAT-8M-U-E-0,3-M8D

Ordering data – Connecting cables					Technical data → Internet: nebu	
	Electrical connection, left	Electrical connection, right	Cable length [m]	Part No.	Type	
	Straight socket, M8x1, 4-pin	Cable, open end, 4-wire	2.5	541342	NEBU-M8G4-K-2.5-LE4	
			5	541343	NEBU-M8G4-K-5-LE4	
	Angled socket, M8x1, 4-pin	Cable, open end, 4-wire	2.5	541344	NEBU-M8W4-K-2.5-LE4	
			5	541345	NEBU-M8W4-K-5-LE4	

## Product Range and Company Overview

### A Complete Suite and Company Overview

Our experienced engineers provide complete support at every stage of your development process, including: conceptualization, analysis, engineering, design, assembly, documentation, validation, and production.



**Custom Automation Components**  
Complete custom engineered solutions

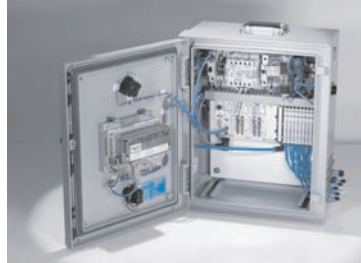

**Custom Control Cabinets**  
Comprehensive engineering support and on-site services



**Complete Systems**  
Shipment, stocking and storage services

### The Broadest Range of Automation Components

With a comprehensive line of more than 30,000 automation components, Festo is capable of solving the most complex automation requirements.



**Electromechanical**  
Electromechanical actuators, motors, controllers & drivers



**Pneumatics**  
Pneumatic linear and rotary actuators, valves, and air supply



**PLCs and I/O Devices**  
PLC's, operator interfaces, sensors and I/O devices

### Supporting Advanced Automation... As No One Else Can!

Festo is a leading global manufacturer of pneumatic and electromechanical systems, components and controls for industrial automation, with more than 16,000 employees in 60 national headquarters serving more than 180 countries. For more than 80 years, Festo has continuously elevated the state of manufacturing with innovations and optimized motion control solutions that deliver higher performing, more profitable automated manufacturing and processing equipment. Our dedication to the advancement of automation extends beyond technology to the education and development of current and future automation and robotics designers with simulation tools, teaching programs, and on-site services.

### Quality Assurance, ISO 9001 and ISO 14001 Certifications

Festo Corporation is committed to supply all Festo products and services that will meet or exceed our customers' requirements in product quality, delivery, customer service and satisfaction.

To meet this commitment, we strive to ensure a consistent, integrated, and systematic approach to management that will meet or exceed the requirements of the ISO 9001 standard for Quality Management and the ISO 14001 standard for Environmental Management.



© Copyright 2013, Festo Corporation. While every effort is made to ensure that all dimensions and specifications are correct, Festo cannot guarantee that publications are completely free of any error, in particular typing or printing errors. Accordingly, Festo cannot be held responsible for the same. For Liability and Warranty conditions, refer to our "Terms and Conditions of Sale", available from your local Festo office. All rights reserved. No part of this publication may be reproduced, distributed, or transmitted in any form or by any means, electronic, mechanical, photocopying or otherwise, without the prior written permission of Festo. All technical data subject to change according to technical update.



Printed on recycled paper at New Horizon Graphic, Inc., FSC certified as an environmental friendly printing plant.

# Festo North America

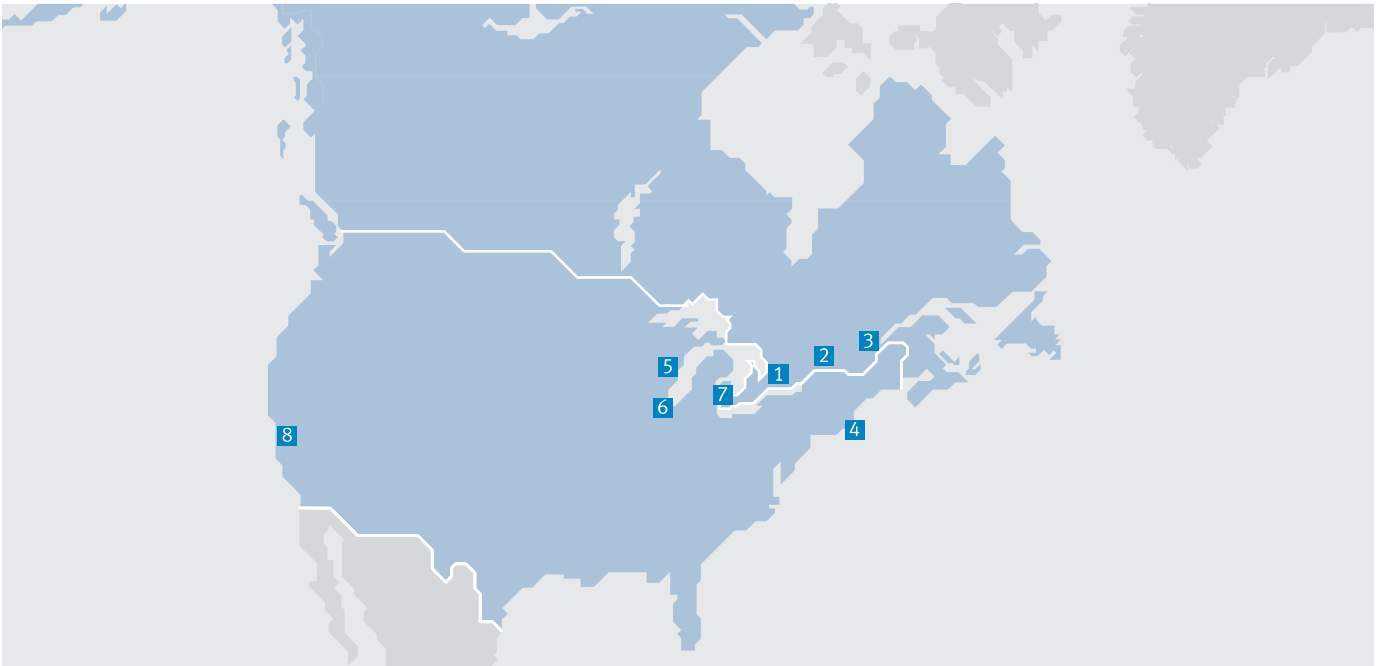

**1 Festo Canada  
Headquarters  
Festo Inc.**  
5300 Explorer Drive  
Mississauga, ON  
L4W 5G4

**2 Montréal**  
5600, Trans-Canada  
Pointe-Claire, QC  
H9R 1B6

**3 Québec City**  
2930, rue Watt#117  
Québec, QC  
G1X 4G3



**4 Festo United States  
Headquarters  
Festo Corporation**  
395 Moreland Road  
Hauppauge, NY  
11788

**5 Appleton**  
North 922 Tower View Drive, Suite N  
Greenville, WI  
54942

**7 Detroit**  
1441 West Long Lake Road  
Troy, MI  
48098

**6 Chicago**  
85 W Algonquin - Suite 340  
Arlington Heights, IL  
60005

**8 Silicon Valley**  
4935 Southfront Road, Suite F  
Livermore, CA  
94550

## Festo Regional Contact Center

### Canadian Customers

Commercial Support:  
Tel: 1 877 GO FESTO (1 877 463 3786)  
Fax: 1 877 FX FESTO (1 877 393 3786)  
Email: festo.canada@ca.festo.com

Technical Support:  
Tel: 1 866 GO FESTO (1 866 463 3786)  
Fax: 1 877 FX FESTO (1 877 393 3786)  
Email: technical.support@ca.festo.com

### USA Customers

Commercial Support:  
Tel: 1 800 99 FESTO (1 800 993 3786)  
Fax: 1 800 96 FESTO (1 800 963 3786)  
Email: customer.service@us.festo.com

Technical Support:  
Tel: 1 866 GO FESTO (1 866 463 3786)  
Fax: 1 800 96 FESTO (1 800 963 3786)  
Email: product.support@us.festo.com