

Push-in fittings CRQS, Quick Star, stainless steel, NPT



Push-in fittings CRQS, Quick Star, stainless steel, NPT

Technical data

General technical data	
Size	Standard
Design	Push-pull principle
Mounting position	Any
Max. tightening torque [ft-lbf]	8.851 at male thread NPTF1/8-27
	11.801 at male thread NPTF1/4-18
	13.276 at male thread NPTF3/8-18
	14.751 at male thread NPTF1/2-14
Usable lines	PFAN

Operating and environmental conditions	
Operating pressure complete temperature range [Psi]	-13.8 ... +203.1
Operating medium	Compressed air in accordance with ISO 8573-1:2010 [7:--:-]
Ambient temperature [°F]	-4 ... +302
Corrosion resistance class CRC ¹⁾	4
Food-industry approval	No

1) CRC4: Corrosion resistance class to Festo standard 940 070
Components with very heavy corrosion exposure. Components in contact with aggressive media, e.g. in food or chemical industries. These applications must, if necessary, be verified by special tests with the media concerned.

Materials



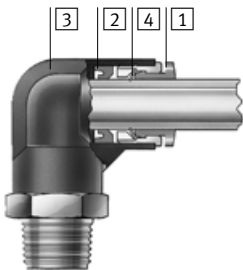

Sectional view

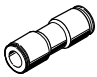
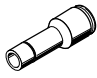
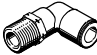

		CRQS, NPT
1	Releasing ring	High-alloy stainless steel
2	Tubing seal	FPM
3	Housing	High-alloy stainless steel
4	Tube retaining claw	High-alloy stainless steel
Note on materials		Contains PWIS (paint wetting impairment substances) RoHS-compliant

Push-in fittings CRQS, Quick Star, stainless steel, NPT

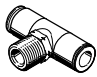
Product range overview

Design	Version	Type	Connection D1			Connection D2		→ Page/ Internet
			NPT thread	Tubing O.D.	Push-in sleeve ∅	Tubing O.D.		
Inline	Push-in fitting – Male thread with internal/external hex							
		CRQS	1/8	-	-	5/32, 1/4	4	
			1/4			1/4, 5/16, 3/8		
			3/8			3/8, 1/2		
			1/2			1/2		
	Push-in connector							
		CRQS...T	-	-	5/32	-	4	
			1/4					
			5/16					
			3/8					
1/2								
Push-in connector with push-in sleeve								
	CRQS...H	-	-	1/4	5/32	5		
		5/16		1/4				
		3/8		1/4, 5/16				
L-shape	Push-in L-fitting, orientable – Male thread with external hex							
		CRQSL	1/8	-	-	5/32, 1/4	6	
			1/4			1/4, 5/16, 3/8		
			3/8			3/8, 1/2		
			1/2			1/2		
	Push-in L-connector							
		CRQSL...T	-	-	5/32	-	6	
			1/4					
			5/16					
			3/8					
1/2								
T-shape	Push-in T-fitting, orientable – Male thread with external hex							
		CRQST	1/8	-	-	5/32, 1/4	7	
			1/4			1/4, 5/16, 3/8		
			3/8			3/8		
	Push-in T-connector							
		CRQST...T	-	-	5/32	-	7	
			1/4					
			5/16					
			3/8					
			1/2					

Push-in fittings CRQS, Quick Star, stainless steel, NPT

Technical data

Push-in fitting CRQS

Male thread with external hex

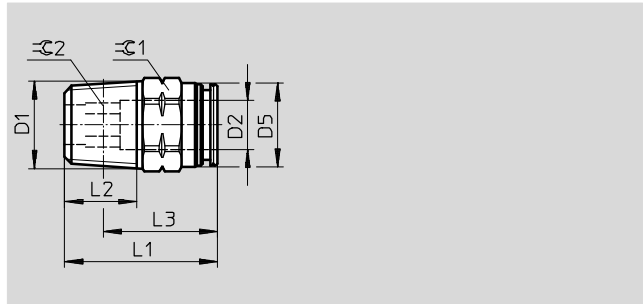

Pneumatic connection		Nominal size [inch]	D5 \varnothing	L1	L2	L3	$\varnothing 1$	$\varnothing 2$	Weight/ piece [oz]	Part No.	Type	PU ¹⁾
Male thread	For tubing O.D. D2 [inch]											
NPTF1/8-27	5/32	0.118	9.5	19.5	8.5	15.4	15/32	1/8	0.342	565318	CRQS-1/8-5/32-U	1
	1/4	0.157	12.0	22.0	8.5	17.9	1/2	5/32	0.388	565319	CRQS-1/8-1/4-U	1
NPTF1/4-18	1/4	0.157	12.0	24.5	13.0	18.7	35/64	5/32	0.628	565320	CRQS-1/4-1/4-U	1
	5/16	0.256	14.0	25.5	13.0	19.7	35/64	1/4	0.575	565321	CRQS-1/4-5/16-U	1
	3/8	0.256	16.0	32.0	13.0	26.2	21/32	1/4	0.896	565322	CRQS-1/4-3/8-U	1
NPTF3/8-18	3/8	0.315	16.0	25.5	13.0	19.4	45/64	5/16	0.917	565323	CRQS-3/8-3/8-U	1
	1/2	0.413	20.0	29.5	13.0	23.4	13/16	13/32	1.118	565324	CRQS-3/8-1/2-U	1
NPTF1/2-14	1/2	0.413	19.5	30.5	17.0	22.4	55/64	13/32	1.633	565325	CRQS-1/2-1/2-U	1

1) Packaging unit

Push-in connector CRQS-...T

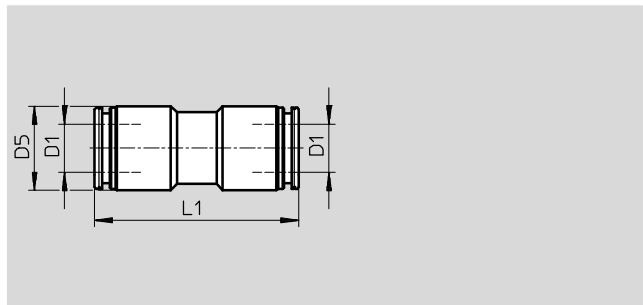

Pneumatic connection		Nominal size [inch]	D5 \varnothing	L1	Weight/ piece [oz]	Part No.	Type	PU ¹⁾
For tubing O.D. D1 [inch]								
5/32		0.118	9.5	28.0	0.307	565340	CRQS-5/32T-U	1
1/4		0.217	12.0	33.5	0.515	565341	CRQS-1/4T-U	1
5/16		0.256	14.0	34.0	0.695	565342	CRQS-5/16T-U	1
3/8		0.335	16.0	38.5	0.945	565343	CRQS-3/8T-U	1
1/2		0.433	20.0	41.0	1.552	565344	CRQS-1/2T-U	1

1) Packaging unit

Push-in fittings CRQS, Quick Star, stainless steel, NPT

Technical data

Push-in connector CRQS-...H
with push-in sleeve

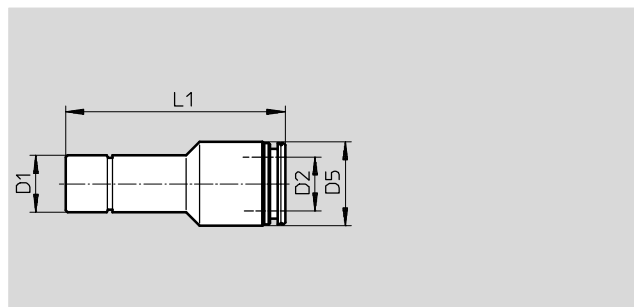

Pneumatic connection		Nominal size [inch]	D5 \varnothing	L1	Weight/ piece [oz]	Part No.	Type	PU ¹⁾
Push-in sleeve	For tubing O.D.							
D1 [inch]	D2 [inch]							
QS-1/4	5/32	0.118	9.5	31.5	–	565355	CRQS-1/4H-5/32-U	1
QS-5/16	1/4	0.197	12.0	34.5	0.406	565356	CRQS-5/16H-1/4-U	1
QS-3/8	1/4	0.217	12.0	34.5	0.483	565357	CRQS-3/8H-1/4-U	1
	5/16	0.256	14.0	36.5	0.547	565358	CRQS-3/8H-5/16-U	1

1) Packaging unit

Push-in fittings CRQS, Quick Star, stainless steel, NPT

Technical data

Push-in L-fitting CRQSL

Orientable

Male thread with external hex

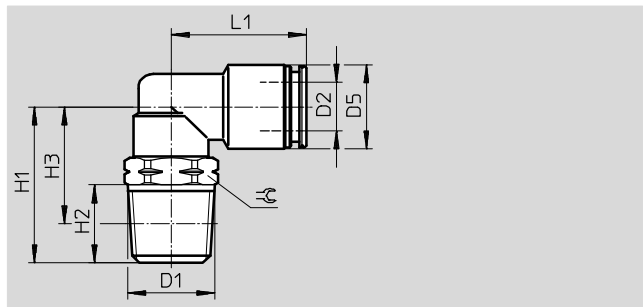

Dimensions and ordering data												
Pneumatic connection		Nominal size [inch]	D5 Ø	H1	H2	H3	L1	⌀	Weight/ piece [oz]	Part No.	Type	PU ¹⁾
Male thread	For tubing O.D.											
D1	D2 [inch]											
NPTF1/8-27	5/32	0.118	9.5	18.5	8.5	14.4	17.5	15/32	0.441	565326	CRQSL-1/8-5/32-U	1
	1/4	0.217	12.0	21.0	8.5	16.9	21.5	1/2	0.705	565327	CRQSL-1/8-1/4-U	1
NPTF1/4-18	1/4	0.217	12.0	26.0	13.0	20.2	21.5	35/64	0.97	565328	CRQSL-1/4-1/4-U	1
	5/16	0.236	14.0	26.0	13.0	20.2	22.5	35/64	0.967	565329	CRQSL-1/4-5/16-U	1
	3/8	0.335	16.0	29.0	13.0	23.2	26.0	21/32	1.376	565330	CRQSL-1/4-3/8-U	1
NPTF3/8-18	3/8	0.335	16.0	29.0	13.0	22.9	26.0	45/64	1.517	565331	CRQSL-3/8-3/8-U	1
	1/2	0.413	20.0	32.5	13.0	26.4	28.5	13/16	2.37	565332	CRQSL-3/8-1/2-U	1
NPTF1/2-14	1/2	0.413	20.0	37.0	17.0	28.9	28.5	55/64	2.723	565333	CRQSL-1/2-1/2-U	1

1) Packaging unit

Push-in L-connector CRQSL-...T

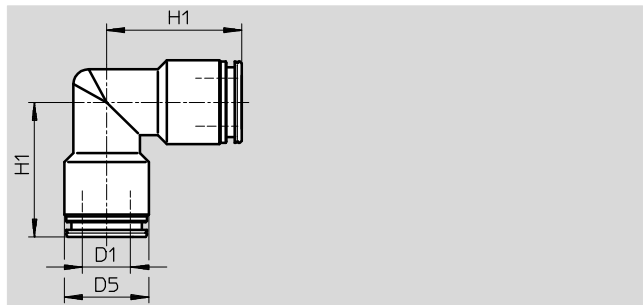

Dimensions and ordering data								
Pneumatic connection		Nominal size [inch]	D5 Ø	H1	Weight/ piece [oz]	Part No.	Type	PU ¹⁾
For tubing O.D.	D1 [inch]							
5/32		0.138	9.5	17.5	0.444	565345	CRQSL-5/32-T-U	1
1/4		0.217	12.0	21.0	0.515	565346	CRQSL-1/4-T-U	1
5/16		0.256	14.0	22.5	0.868	565347	CRQSL-5/16-T-U	1
3/8		0.335	16.0	25.5	1.517	565348	CRQSL-3/8-T-U	1
1/2		0.433	20.0	27.5	1.781	565349	CRQSL-1/2-T-U	1

1) Packaging unit

Push-in fittings CRQS, Quick Star, stainless steel, NPT

Technical data

Push-in T-fitting CRQST

Orientable

Male thread with external hex

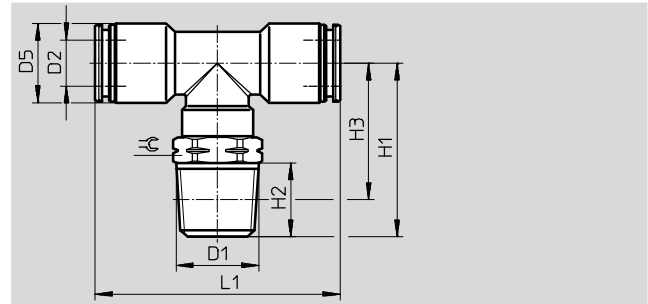

Dimensions and ordering data												
Pneumatic connection		Nominal size [inch]	D5 Ø	H1	H2	H3	L1	⌀	Weight/ piece [oz]	Part No.	Type	PU ¹⁾
Male thread	For tubing O.D.											
D1	D2 [inch]											
NPTF1/8-27	5/32	0.118	9.5	22.5	8.5	18.4	35.0	15/32	0.656	565334	CRQST-1/8-5/32-U	1
	1/4	0.217	12.0	25.5	8.5	21.4	42.0	1/2	0.97	565335	CRQST-1/8-1/4-U	1
NPTF1/4-18	1/4	0.217	12.0	30.5	13.0	24.7	42.0	35/64	1.185	565336	CRQST-1/4-1/4-U	1
	5/16	0.236	14.0	30.5	13.0	24.7	43.0	35/64	1.305	565337	CRQST-1/4-5/16-U	1
	3/8	0.335	16.0	32.0	13.0	26.2	51.0	21/32	2.258	565338	CRQST-1/4-3/8-U	1
NPTF3/8-18	3/8	0.335	16.0	32.0	13.0	25.9	51.0	45/64	2.346	565339	CRQST-3/8-3/8-U	1

1) Packaging unit

Push-in T-connector CRQST-...T

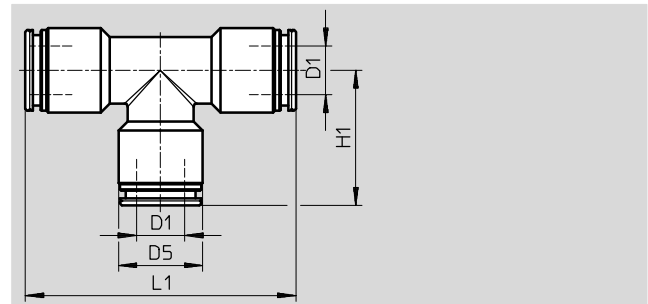

Dimensions and ordering data									
Pneumatic connection		Nominal size [inch]	D5 Ø	H1	L1	Weight/ piece [oz]	Part No.	Type	PU ¹⁾
For tubing O.D.	D1 [inch]								
	5/32	0.138	9.5	17.5	35.0	0.564	565350	CRQST-5/32T-U	1
	1/4	0.217	12.0	21.0	42.0	0.988	565351	CRQST-1/4T-U	1
	5/16	0.256	14.0	21.5	43.0	1.157	565352	CRQST-5/16T-U	1
	3/8	0.335	16.0	25.0	50.0	2.046	565353	CRQST-3/8T-U	1
	1/2	0.433	20.0	27.5	55.0	2.469	565354	CRQST-1/2T-U	1

1) Packaging unit

Product Range and Company Overview

A Complete Suite and Company Overview

Our experienced engineers provide complete support at every stage of your development process, including: conceptualization, analysis, engineering, design, assembly, documentation, validation, and production.



Custom Automation Components
Complete custom engineered solutions

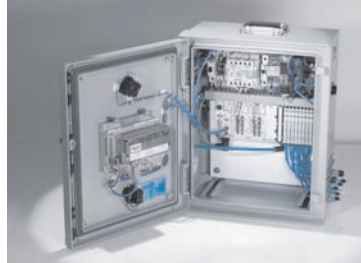

Custom Control Cabinets
Comprehensive engineering support and on-site services



Complete Systems
Shipment, stocking and storage services

The Broadest Range of Automation Components

With a comprehensive line of more than 30,000 automation components, Festo is capable of solving the most complex automation requirements.



Electromechanical
Electromechanical actuators, motors, controllers & drivers



Pneumatics
Pneumatic linear and rotary actuators, valves, and air supply



PLCs and I/O Devices
PLC's, operator interfaces, sensors and I/O devices

Supporting Advanced Automation... As No One Else Can!

Festo is a leading global manufacturer of pneumatic and electromechanical systems, components and controls for industrial automation, with more than 16,000 employees in 60 national headquarters serving more than 180 countries. For more than 80 years, Festo has continuously elevated the state of manufacturing with innovations and optimized motion control solutions that deliver higher performing, more profitable automated manufacturing and processing equipment. Our dedication to the advancement of automation extends beyond technology to the education and development of current and future automation and robotics designers with simulation tools, teaching programs, and on-site services.

Quality Assurance, ISO 9001 and ISO 14001 Certifications

Festo Corporation is committed to supply all Festo products and services that will meet or exceed our customers' requirements in product quality, delivery, customer service and satisfaction.

To meet this commitment, we strive to ensure a consistent, integrated, and systematic approach to management that will meet or exceed the requirements of the ISO 9001 standard for Quality Management and the ISO 14001 standard for Environmental Management.



© Copyright 2013, Festo Corporation. While every effort is made to ensure that all dimensions and specifications are correct, Festo cannot guarantee that publications are completely free of any error, in particular typing or printing errors. Accordingly, Festo cannot be held responsible for the same. For Liability and Warranty conditions, refer to our "Terms and Conditions of Sale", available from your local Festo office. All rights reserved. No part of this publication may be reproduced, distributed, or transmitted in any form or by any means, electronic, mechanical, photocopying or otherwise, without the prior written permission of Festo. All technical data subject to change according to technical update.



Printed on recycled paper at New Horizon Graphic, Inc., FSC certified as an environmental friendly printing plant.

Festo North America

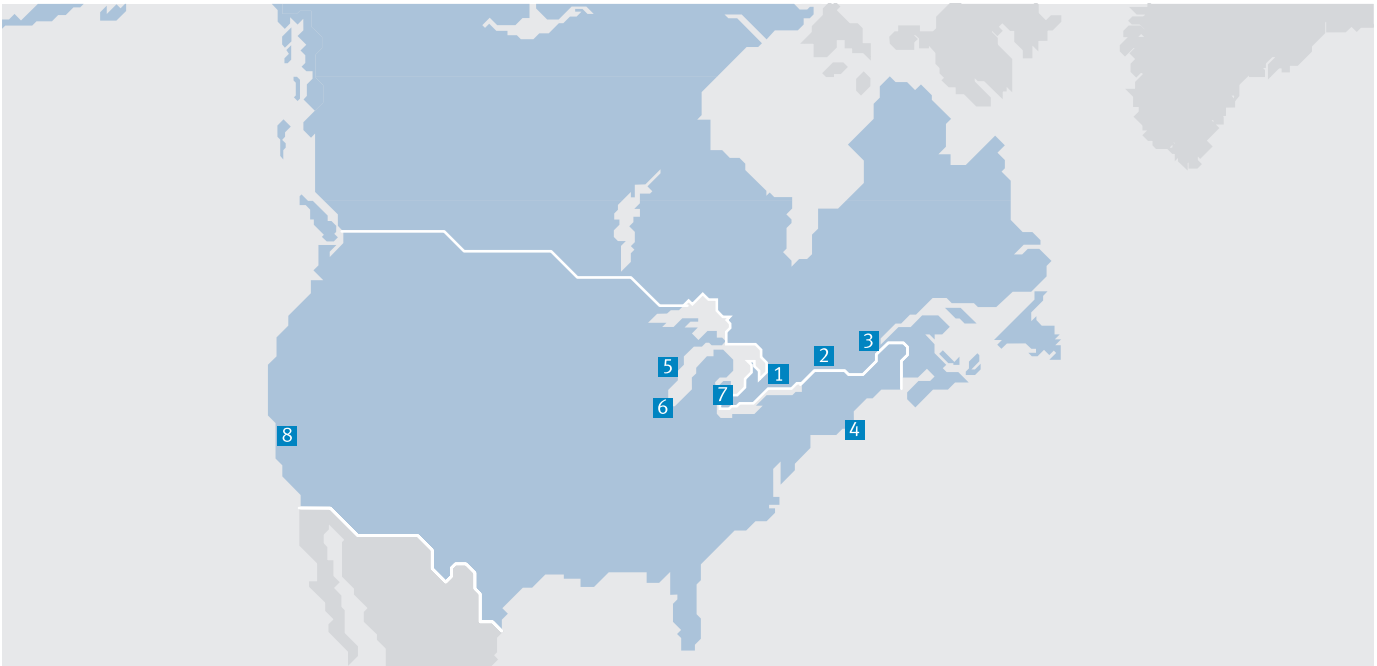

**1 Festo Canada
Headquarters
Festo Inc.**
5300 Explorer Drive
Mississauga, ON
L4W 5G4

2 Montréal
5600, Trans-Canada
Pointe-Claire, QC
H9R 1B6

3 Québec City
2930, rue Watt#117
Québec, QC
G1X 4G3



**4 Festo United States
Headquarters
Festo Corporation**
395 Moreland Road
Hauppauge, NY
11788

5 Appleton
North 922 Tower View Drive, Suite N
Greenville, WI
54942

7 Detroit
1441 West Long Lake Road
Troy, MI
48098

6 Chicago
85 W Algonquin - Suite 340
Arlington Heights, IL
60005

8 Silicon Valley
4935 Southfront Road, Suite F
Livermore, CA
94550

Festo Regional Contact Center

Canadian Customers

Commercial Support:
Tel: 1 877 GO FESTO (1 877 463 3786)
Fax: 1 877 FX FESTO (1 877 393 3786)
Email: festo.canada@ca.festo.com

Technical Support:
Tel: 1 866 GO FESTO (1 866 463 3786)
Fax: 1 877 FX FESTO (1 877 393 3786)
Email: technical.support@ca.festo.com

USA Customers

Commercial Support:
Tel: 1 800 99 FESTO (1 800 993 3786)
Fax: 1 800 96 FESTO (1 800 963 3786)
Email: customer.service@us.festo.com

Technical Support:
Tel: 1 866 GO FESTO (1 866 463 3786)
Fax: 1 800 96 FESTO (1 800 963 3786)
Email: product.support@us.festo.com

Subject to change

Internet: www.festo.com/us