

# Plugs, Sub-D, 9-pin

Technical data

FESTO

**Plug**  
**FBS-SUB-9**

- Fieldbus plug with 9-pin Sub-D connection
- Variants for different fieldbus systems
- Position of DIL switches can be read externally
- Easy assembly

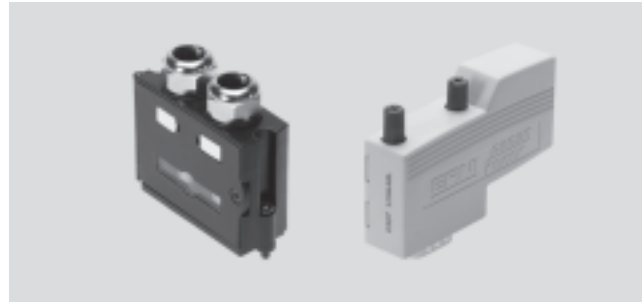

| General technical data           |  |                        |                                 |                       |
|----------------------------------|--|------------------------|---------------------------------|-----------------------|
| Type                             | FBS-SUB-9-GS-DB-B                          | FBS-SUB-9-GS-IB-B      | FBS-SUB-9-GS-2X4POL-B           | FBS-SUB-9-GS-1X9POL-B |
| Electrical connection            | Plug, 9-pin, Sub-D                         |                        |                                 |                       |
| Control elements                 | DIL switches                               | -                      | -                               | -                     |
| Note for fieldbus interface      | -  | -                      | BUS In - BUS Out looped through | -                     |
| Additional functions             | Switching off of outgoing fieldbus segment | Integrated RBST bridge | -                               | -                     |
| Permissible cable diameter [mm]  | 5 ... 10                                   |                        |                                 |                       |
| Degree of protection to EN 60529 | IP65, IP67 (assembled)                     |                        |                                 |                       |
| Height/length/width [mm]         | 62/61/20                                   |                        |                                 |                       |

| General technical data           |                    |
|----------------------------------|--------------------|
| Type                             | FBS-SUB-9-WS-...   |
| Electrical connection            | Plug, 9-pin, Sub-D |
| Permissible cable diameter [mm]  | 4.5 ... 8          |
| Degree of protection to EN 60529 | IP40               |

| Materials         |                  |                       |                  |
|-------------------|------------------|-----------------------|------------------|
| Type              | FBS-SUB-9-GS-... | FBS-SUB-9-GS-1X9POL-B | FBS-SUB-9-WS-... |
| Housing           | PA reinforced    | PA reinforced         | Thermoplastic    |
| Seals             | NBR              | NBR                   | -                |
| Screws            | Steel            | Steel                 | -                |
| Union nut         | Brass            | Brass                 | -                |
| Note on materials | RoHS-compliant   | -                     | -                |

| Operating and environmental conditions |                    |                                   |                  |
|--|--------------------|-----------------------------------|------------------|
| Type                                   | FBS-SUB-9-GS-...   | FBS-SUB-9-GS-1X9POL-B             | FBS-SUB-9-WS-... |
| Ambient temperature [°C]               | 0 ... +50          | 0 ... +50                         | -20 ... +70      |
| Storage temperature [°C]               | -20 ... +70        | -20 ... +70                       | -                |
| Relative air humidity [%]              | 95, non-condensing | 95, non-condensing                | -                |
| CE marking                             | -                  | To EU EMC Directive <sup>1)</sup> | -                |
| (see declaration of conformity)        | -                  | To EU Low Voltage Directive       | -                |

1) For information about the applicability of the component see the manufacturer's EC declaration of conformity at: [www.festo.com](http://www.festo.com) → Support → User documentation.  
If the component is subject to restrictions on usage in residential, office or commercial environments or small businesses, further measures to reduce the emitted interference may be necessary.

# Plugs, Sub-D, 9-pin

Technical data

FESTO

## Dimensions

Download CAD data → [www.festo.com](http://www.festo.com)

FBS-SUB-9-GS-...

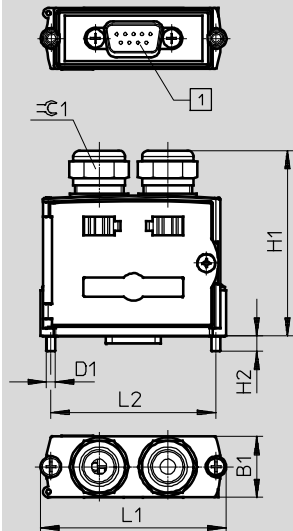

1 Sub-D plug, 9-pin

FBS-SUB-9-WS-...

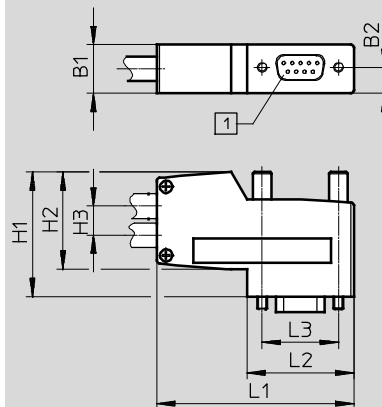

1 Sub-D plug, 9-pin

| Type             | B1 | B2  | D1    | H1   | H2   | H3  | L1   | L2   | L3 | ⌀1 |
|------------------|----|-----|-------|------|------|-----|------|------|----|----|
| FBS-SUB-9-GS-... | 20 | –   | M3x20 | 60.5 | 5    | –   | 60.9 | 54.1 | –  | 17 |
| FBS-SUB-9-WS-... | 16 | 8.5 | –     | 40.8 | 31.8 | 9.5 | 64.6 | 35   | 25 | –  |

## Ordering data

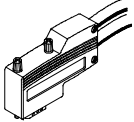
|   | Electrical connection | Protocol | Fieldbus interface           | Product weight [g] | Part No. | Type                  |
|---|-----------------------|----------|------------------------------|--------------------|----------|-----------------------|
|  | Straight plug         | PROFIBUS | 2x 2 spring-loaded terminals | 60                 | 532216   | FBS-SUB-9-GS-DP-B     |
|   |                       | INTERBUS | 1x 5 spring-loaded terminals | 60                 | 532217   | FBS-SUB-9-GS-IB-B     |
|   |                       | CC-Link  | 2x 4 spring-loaded terminals | 60                 | 532220   | FBS-SUB-9-GS-2x4POL-B |
|   |                       | RS232    | 1x 9 spring-loaded terminals | 60                 | 534497   | FBS-SUB-9-GS-1x9POL-B |
|  | Angled plug           | PROFIBUS | –                            | 43                 | 533780   | FBS-SUB-9-WS-PB-K     |
|   |                       | CANopen  | –                            | 45.9               | 533783   | FBS-SUB-9-WS-CO-K     |