

## Angle grippers DHWS

**FESTO**



# Angle grippers DHWS

Key features

FESTO

## At a glance

### General information

- Improved gripper jaw guide
- Slotted guide system
- Max. repetition accuracy
- Gripping force retention
- Internal fixed flow control
- Wide range of options for mounting on drive units

- Sensor technology:
  - Adaptable position sensor for the small gripper sizes
  - Integratable proximity sensors for the medium and large gripper sizes

### Flexible range of applications

- Can be used as a double-acting and single-acting gripper
- Compression spring for supplementary or retaining gripping forces
- Suitable for external and internal gripping

## The technology in detail

### Gripper closed

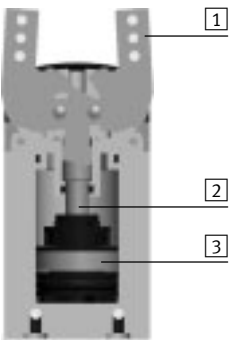

### Gripper open



- 1 Gripper jaw
- 2 Slotted guide plate
- 3 Piston with magnet

-  - Note

Gripper selection sizing software  
 → [www.festo.com](http://www.festo.com)

## Position sensing/force control

### With position transmitter SMAT-8M, SDAT



Analogue positional feedback possible

- Analogue output
  - 0 ... 10 V
  - 0 ... 20 mA

### With proportional pressure regulator VPPM



Infinite adjustment of the gripping force possible

- Setpoint input
  - 0 ... 10 V
  - 4 ... 20 mA

### With proximity sensor SMT-8G



Multiple positions can be sensed:

- Open
- Closed
- Workpiece gripped

# Angle grippers DHWS

Key features

## Supply ports

At the side

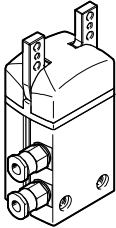

## Mounting options

At the side

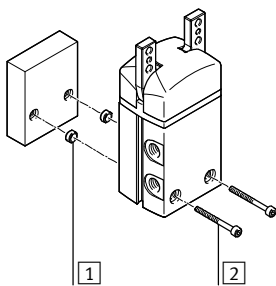

From underneath

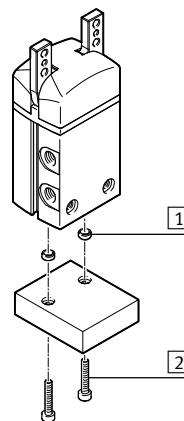
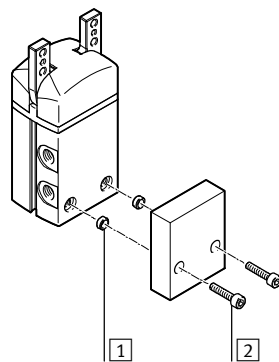

- 1 Centring sleeves
- 2 Mounting screws

## Mounting options for external gripper fingers

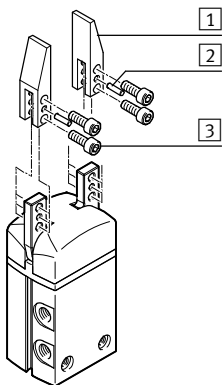

- 1 Gripper fingers
- 2 Centring pins
- 3 Mounting screws

Note

These grippers are not designed for the following or similar sample applications:

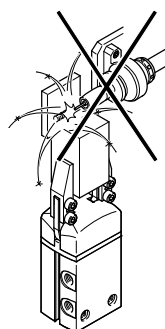

- Welding spatter

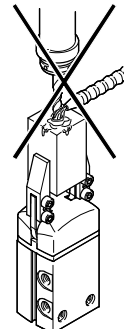

- Machining
- Aggressive media

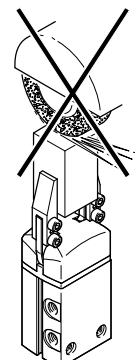

- Grinding dust

# Angle grippers DHWS

Peripherals overview

FESTO

## Peripherals overview

DHWS-10

DHWS-16 ... 40

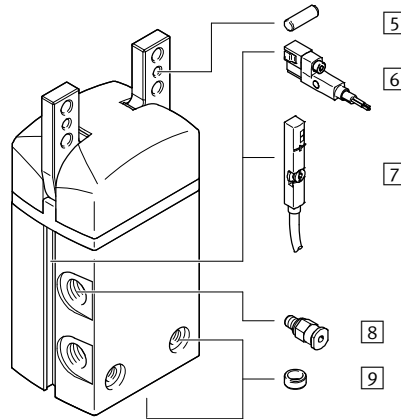
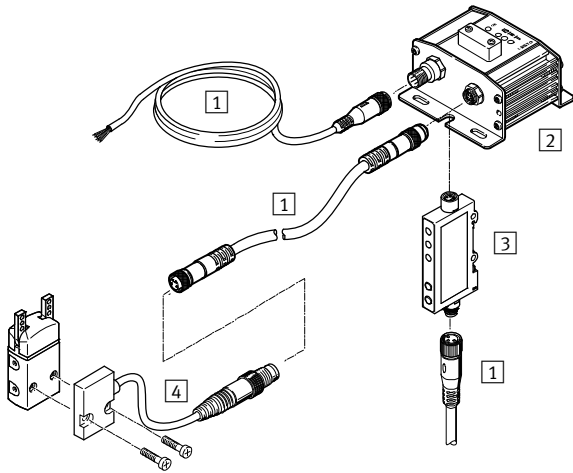

## System product for handling and assembly technology

## Proportional pressure regulator VPPM

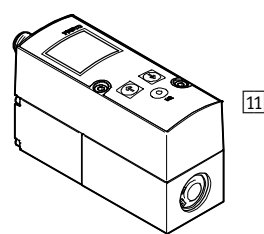
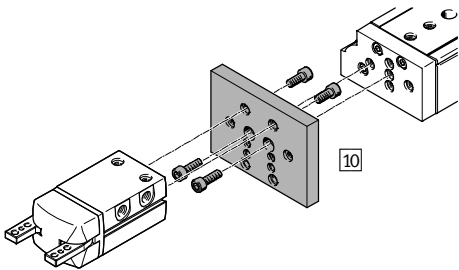

# Angle grippers DHWS

Peripherals overview

FESTO

Accessories				
	Type	Size	Description	→ Page/Internet
1	Connecting cable NEBU	10 ... 40	For connecting evaluation unit and signal converter	21
2	Evaluation unit SMH-AE1	10	<ul style="list-style-type: none"> <li>For evaluating signals for position sensor SMH-S1</li> </ul>	21
3	Signal converter SVE4	10	<ul style="list-style-type: none"> <li>For evaluating signals for position sensor SMH-S1</li> </ul>	21
4	Position sensor SMH-S1	10	<ul style="list-style-type: none"> <li>Adaptable and integratable sensor technology, for sensing the piston position</li> </ul>	21
5	Centring pin	10 ... 40	For centring the gripper fingers on the gripper jaws	–
6	Proximity sensor SMT-8G	16 ... 40	<ul style="list-style-type: none"> <li>For sensing the piston position</li> <li>Proximity sensor does not project past the housing at the bottom</li> </ul>	22
7	Position transmitter SMAT-8M	16 ... 40	<ul style="list-style-type: none"> <li>Continuously senses the position of the piston. Has an analogue output with an output signal in proportion to the piston position</li> </ul>	22
	Position transmitter SDAT			
8	Push-in fitting QS	10 ... 40	For connecting compressed air tubing with standard O.D.	quick star
9	Centring sleeve ZBH	10 ... 40	<ul style="list-style-type: none"> <li>For centring the gripper during mounting</li> <li>The scope of delivery of the gripper includes 2 centring sleeves</li> </ul>	21
10	Adapter kit DHAA, HMSV, HAPG, HAPS, HMVA	10 ... 40	Connecting plate between drive and gripper	16
11	Proportional pressure regulator VPPM	10 ... 40	For infinite adjustment of the gripping force	vppm

# Angle grippers DHWS

Type codes

		DHWS	-	16	-	A	-	
<b>Type</b>								
DHWS	Angle gripper							
<b>Size</b>								
<b>Position sensing</b>								
A	Via proximity sensor							
<b>Gripping force retention</b>								
NC	Closing							

# Angle grippers DHWS

Technical data

FESTO

Function  
Double-acting  
DHWS-...-A

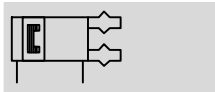

- - Size  
10 ... 40 mm
- - Opening angle  
40°

- - www.festo.com

Function – Variants  
Single-acting or  
with gripping force retention ...  
... closing DHWS-...-NC



General technical data					
Size	10	16	25	32	40
Design	Lever				
Mode of operation	Double-acting				
Gripper function	Angle				
Guide	Plain-bearing guide				
Gripping force retention	-	NC	NC	NC	NC
Number of gripper jaws	2				
Opening angle per gripper jaw	[°] 20				
Pneumatic connection	M3	M3	M5	G1/8	G1/8
Repetition accuracy <sup>1)</sup>	[mm] ≤ 0.04				
Max. interchangeability	[mm] ≤ 0.2				
Max. operating frequency	[Hz] 4		3		
Rotational symmetry	[mm] < Ø 0.2				
Position sensing	Via position sensor		Via proximity sensor, position transmitter		
Type of mounting	Via through-hole and centring sleeve				
	Via female thread and centring sleeve				
Mounting position	Any				

1) End-position drift under constant conditions of use with 100 consecutive strokes in the direction of movement of the gripper jaws

Operating and environmental conditions					
Size	10	16	25	32	40
Min. operating pressure					
DHWS-...-A	[bar] 2				
DHWS-...-A-NC	[bar] -	4			
Max. operating pressure	[bar] 8				
Operating medium	Compressed air in accordance with ISO 8573-1:2010 [7:4:4]				
Note on operating/pilot medium	Operation with lubricated medium possible (in which case lubricated operation will always be required)				
Ambient temperature <sup>1)</sup>	[°C] +5 ... +60				
Corrosion resistance class CRC <sup>2)</sup>	1				

1) Note operating range of proximity sensors

2) Corrosion resistance class CRC 1 to Festo standard FN 940070

Low corrosion stress. For dry indoor applications or transport and storage protection. Also applies to parts behind covers, in the non-visible interior area, and parts which are covered in the application (e.g. drive trunnions).

Weight [g]					
Size	10	16	25	32	40
DHWS-...-A	40	110	258	452	775
DHWS-...-A-NC	-	114	265	462	790

# Angle grippers DHWS

Technical data

FESTO

## Materials

Sectional view

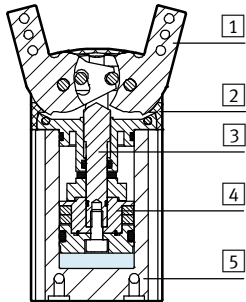

Angle gripper		
1	Gripper jaw	High-alloy stainless steel
2	Cover cap	Polyamide
3	Slotted guide plate	Tempered steel
4	Piston	Polyacetal
5	Housing	Hard anodised wrought aluminium alloy
-	Seals	Nitrile rubber
-	Note on materials	Free of copper and PTFE RoHS-compliant

## Total gripping torque [Ncm] at 6 bar

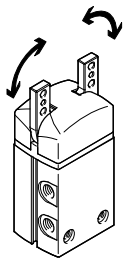

Size		10	16	25	32	40
DHWS-...-A	Opening	43	129	386	810	1497
	Closing	30	114	356	746	1362

## Static characteristic load values at the gripper jaws

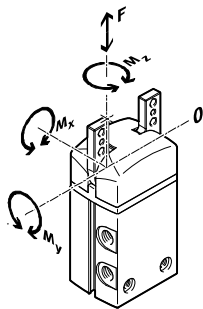

The indicated permissible forces and torques apply to a single gripper jaw. They include the lever arm, additional applied loads due to the workpiece or external gripper fingers and accelera-

tion forces occurring during movement.

The zero coordinate line (gripper jaw guide) must be taken into consideration for the calculation of torques.

Size		10	16	25	32	40
Max. permissible force $F_z$	[N]	25	50	90	120	200
Max. permissible torque $M_x$	[Nm]	0.6	1.6	3.6	6	13
Max. permissible torque $M_y$	[Nm]	0.6	1.6	3.6	6	13
Max. permissible torque $M_z$	[Nm]	0.6	1.6	3.6	6	13

## Mass moment of inertia [ $\text{kgm}^2 \times 10^{-4}$ ]

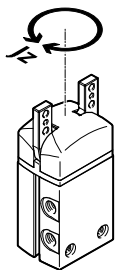

Mass moment of inertia of the angle gripper in relation to the central axis, without external gripper fingers, without load.

Size		10	16	25	32	40
DHWS-...-A		0.03	0.14	0.62	1.60	3.81
DHWS-...-A-NC		-	0.15	0.64	1.63	3.87



# Angle grippers DHWS

Technical data

## Opening and closing times [ms] at 6 bar

Without external gripper fingers

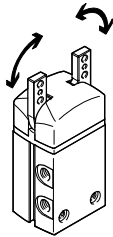

The indicated opening and closing times [ms] were measured at room temperature at an operating pressure of 6 bar with horizontally mounted grippers without additional gripper

fingers (average values). The grippers must be throttled for greater applied loads. Opening and closing times must then be adjusted accordingly.

Size		10	16	25	32	40
Without external gripper fingers						
DHWS-...-A	Opening	10	44	64	46	63
	Closing	22	52	80	77	96
DHWS-...-A-NC	Opening	-	62	106	88	99
	Closing	-	36	59	55	69

## Opening and closing times $t$ to be set at 6 bar as a function of mass moment of inertia of the gripper fingers

DHWS-10

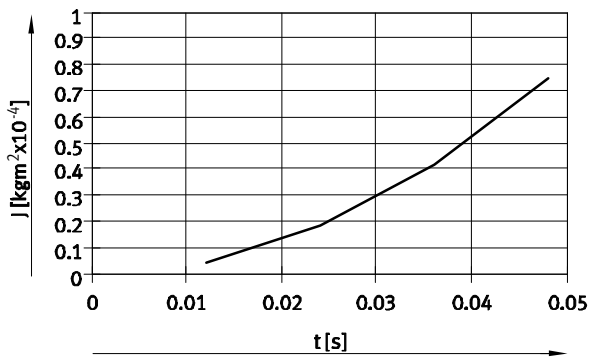

DHWS-16

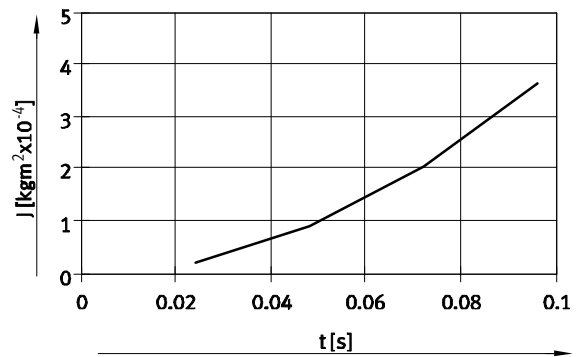

DHWS-25

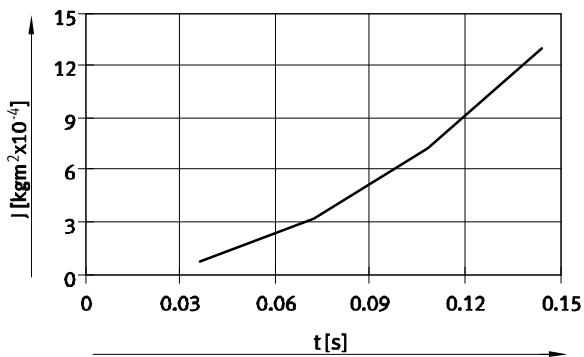

DHWS-32

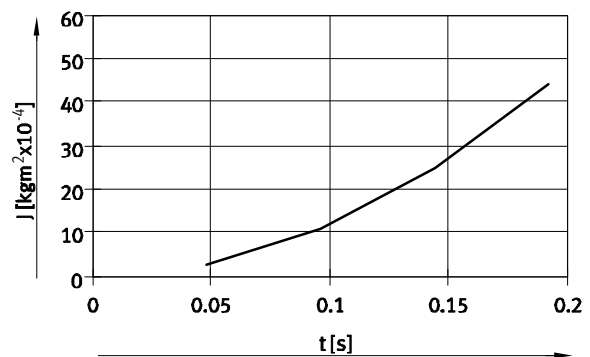

DHWS-40

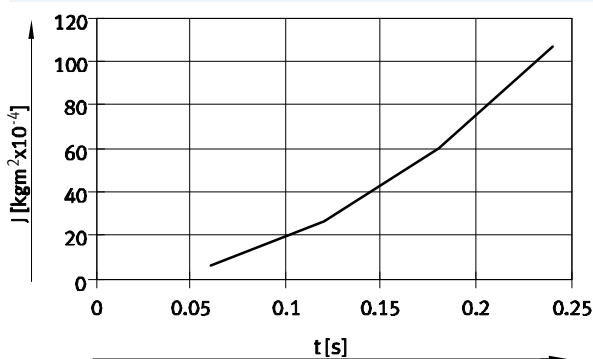

# Angle grippers DHWS

Technical data

## Gripping force $F_H$ per gripper jaw as a function of operating pressure and lever arm $x$

The gripping forces as a function of operating pressure and lever arm can be determined from the following graphs.

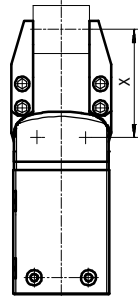

Note  
Gripper selection  
sizing software  
→ [www.festo.com](http://www.festo.com)

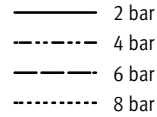

### External gripping (closing)

DHWS-10

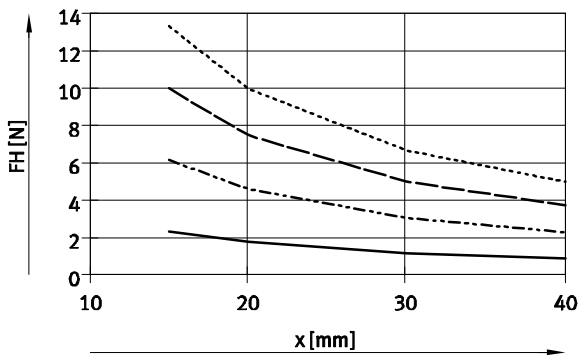

DHWS-16

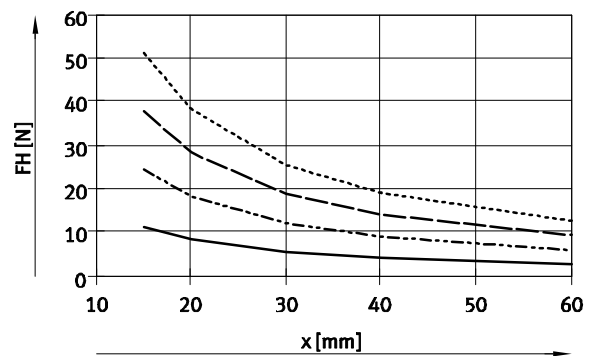

DHWS-25

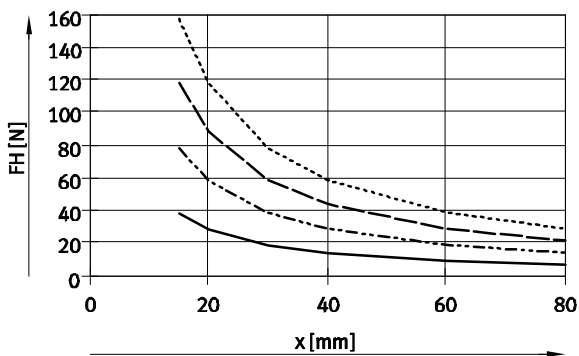

DHWS-32

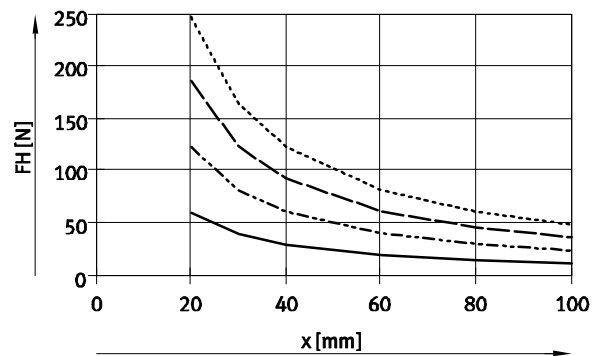

DHWS-40

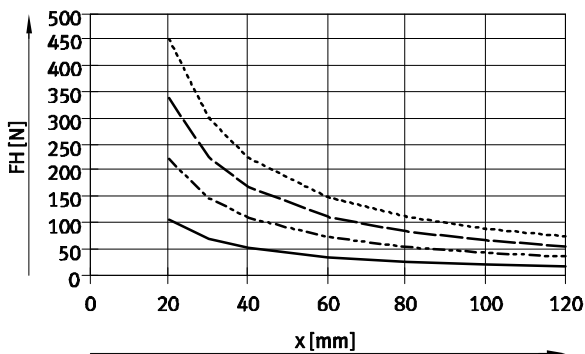

# Angle grippers DHWS

Technical data

## Gripping force $F_H$ per gripper jaw as a function of operating pressure and lever arm $x$

The gripping forces as a function of operating pressure and lever arm can be determined from the following graphs.

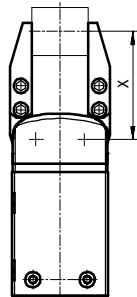

Note  
Gripper selection  
sizing software  
→ [www.festo.com](http://www.festo.com)

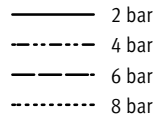

### Internal gripping (opening)

DHWS-10

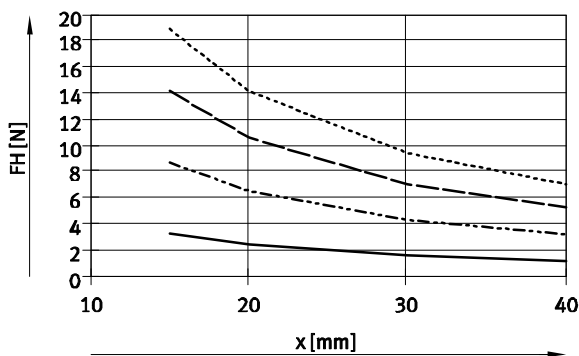

DHWS-16

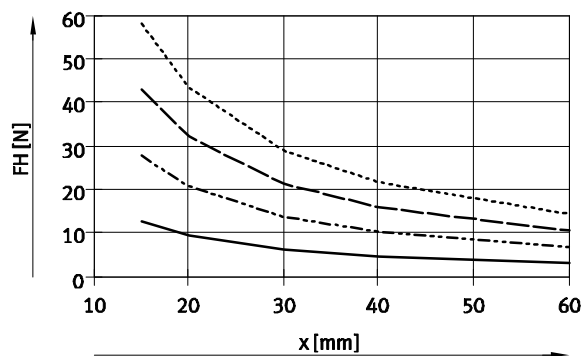

DHWS-25

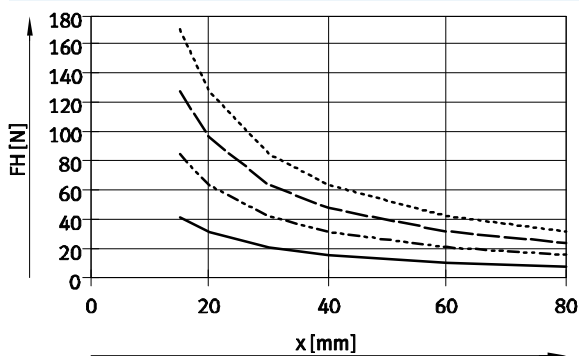

DHWS-32

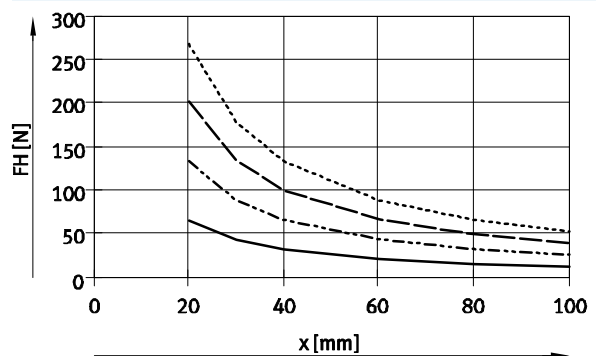

DHWS-40

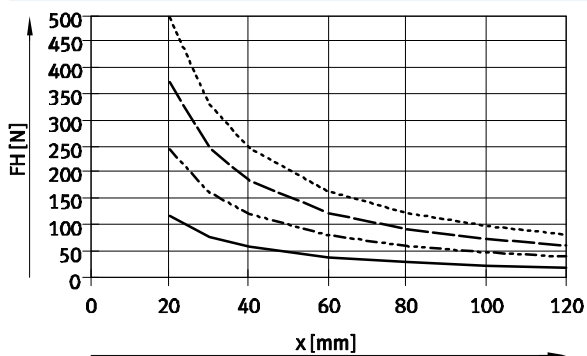

# Angle grippers DHWS

Technical data

## Gripping force $F_H$ per gripper jaw at 6 bar as a function of lever arm $x$ and eccentricity $a$ and $b$

The following formula must be used to calculate the lever arm  $x$  with eccentric gripping:

$$x = \sqrt{a^2 + b^2}$$

The gripping force  $F_H$  can be read from the graphs (→ 10/11) using the calculated value  $x$ .

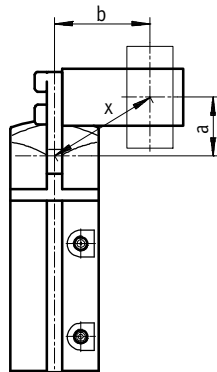

### Calculation example

Given:

Distance  $a = 20$  mm

Distance  $b = 25$  mm

To be calculated:

The gripping force at 6 bar, with a DHWS-16, used as an external gripper

Procedure:

Calculating the lever arm  $x$

$$x = \sqrt{20^2 + 25^2}$$

$$x = 32$$
 mm

The graph (→ 10) gives a value of  $F_H = 18$  N for the gripping force.

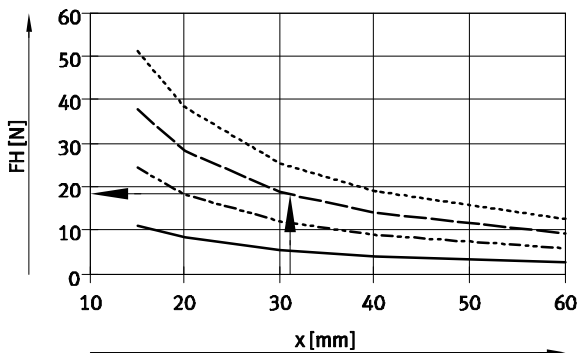

# Angle grippers DHWS

Technical data

## Spring torque $M_F$ as a function of opening angle $\alpha$

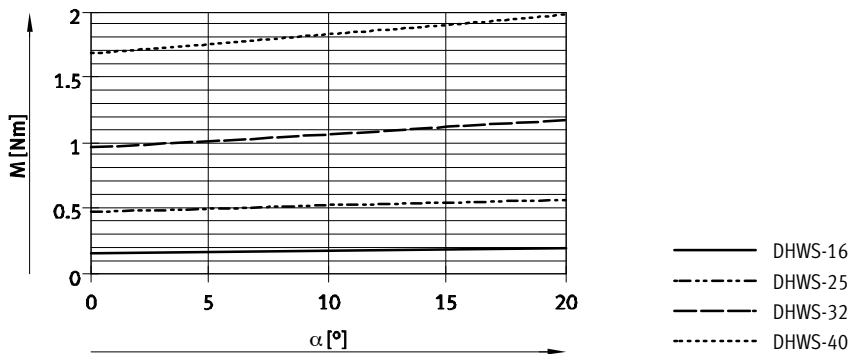

## Determination of the actual gripping torques $M_{Grtotal}$ for DHWS-...-NC as a function of application

The angle gripper with integrated spring type DHWS-...-NC (closing gripping force retention) can be used as:

- single-acting grippers
- grippers with supplementary gripping force and
- grippers with gripping force retention depending on requirements.

In order to calculate the available gripping torque  $M_{Grtotal}$  (per gripper jaw), the data from the graphs for the

gripping force  $F_H$  (→ 10/11) and the spring torque  $M_F$  (→ 13) must be combined accordingly.

$$M_{Gr} = F_H * x$$

$M_{Gr}$  Gripping torque  
 $F_H$  Gripping force  
 $x$  Lever arm

### Application

#### Single-acting

- Gripping with spring force:  
 $M_{Grtotal} = M_F$
- Gripping with pressure force:  
 $M_{Grtotal} = M_{Gr} - M_F$

#### Supplementary gripping force

- Gripping with pressure and spring force:  
 $M_{Grtotal} = M_{Gr} + M_F$

#### Gripping force retention

- Gripping with spring force:  
 $M_{Grtotal} = M_F$

# Angle grippers DHWS

Technical data

FESTO

## Dimensions

Download CAD data → [www.festo.com](http://www.festo.com)

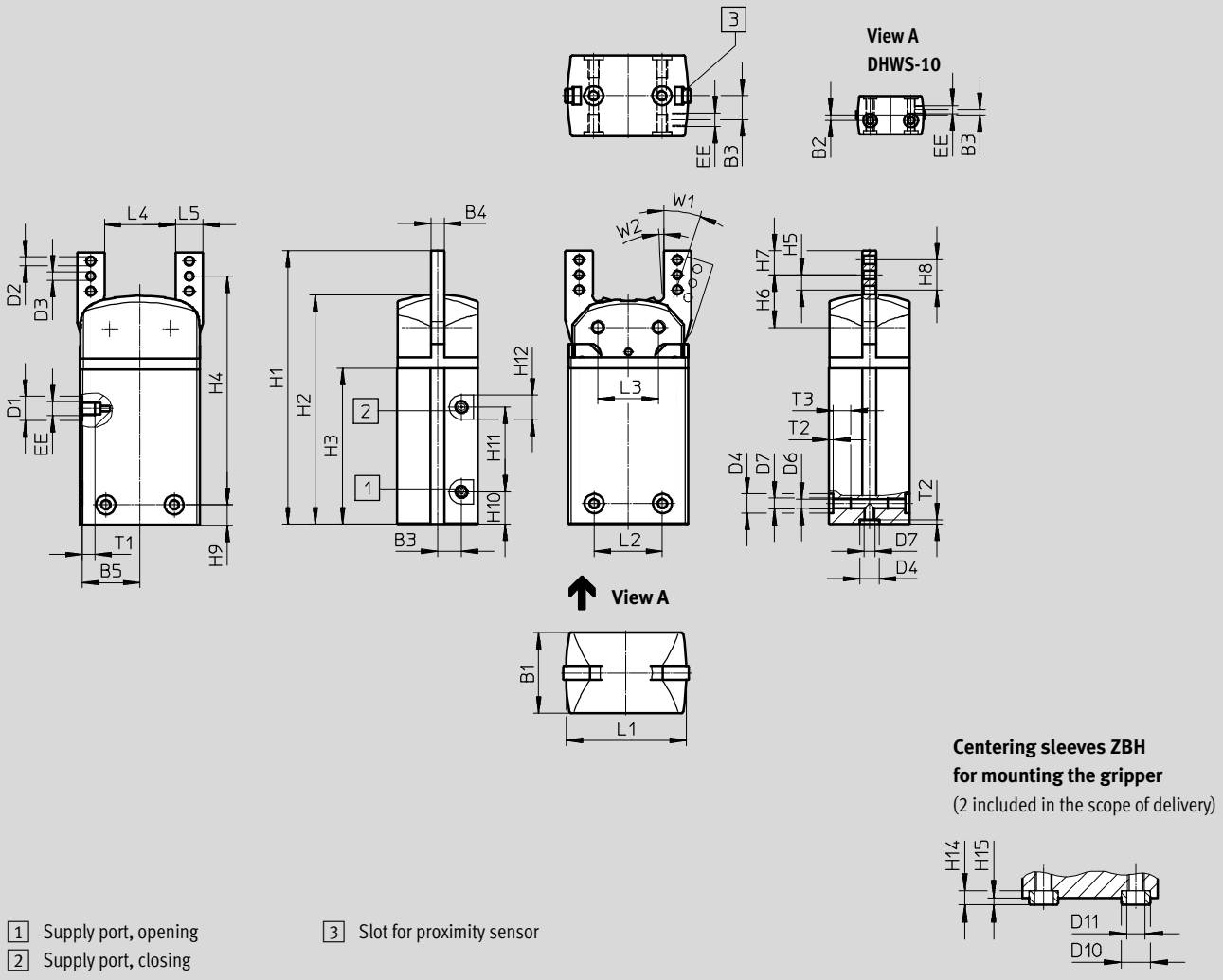

Size	B1	B2 <sup>1)</sup>	B3	B4	B5	D1	D2	D3	D4	D6	D7
[mm]	±0.05			-0.03/ -0.05		∅	∅ ±0.1	∅ H8	∅ H8/h7	+0.1	
10	14	2	2	3	11.6	7	2.2	2	5	2.4	M3
16	19	-	5.8	4	16	-	3.2	2.5	5	2.5	M3
25	29.5	-	8.75	5	21	9	3.2	3	7	3.3	M4
32	38	-	11	6	24	15	4.3	3	9	5.1	M6
40	49	-	11	8	28.4	15	5.3	4	12	6.4	M8

Size	D10	D11	EE	H1	H2	H3	H4	H5	H6	H7
[mm]	∅ h7	∅					±0.2		±0.05	
10	5	3.2	M3	56.3	46	30.8	38.25	3.5	10.95	5.75
16	5	3.2	M3	81	67	45.5	66	4.5	15.5	7.5
25	7	5.3	M5	100	84	57	83.7	5.5	19.2	8.8
32	9	6.4	G $\frac{1}{8}$	116	96.2	65	100.5	6.5	22.5	11
40	12	10.3	G $\frac{1}{8}$	129	108.4	71.5	99.5	7	24.5	12

1) Tolerance for centring hole ±0.02 mm; tolerance for thread ±0.1 mm

# Angle grippers DHWS

Technical data

**FESTO**

Size [mm]	H8	H9 <sup>2)</sup>	H10	H11	H12	H14	H15	L1	L2 <sup>1)</sup>
						-0.2	-0.3	±0.05	
10	7	12.3	8.8	16	7	2.4	1.2	24	15
16	9	7.5	12.25	23	7	2.4	1.2	34	16
25	11	7.5	11.8	31	9	3	1.4	44	25
32	13	11	20	25	15	4	1.9	53	29
40	14	17.5	9	46	15	5	2.4	59	33

Size [mm]	L3	L4	L5 -0.02/ -0.05	T1	T2	T3	W1	W2
	±0.02			+0.5	+0.1	+1	+3°/-1°	±1°
10	12.4	14	5.5	3.5	1.2	through	18	3
16	17	18	8	4.5	1.2	5.8	18	3
25	22.2	26	10	4.5	1.6	6.4	18	3
32	25.8	29	12	7.5	2.1	12.9	18	3
40	30	32	15	6	2.6	13.4	18	3

1) Tolerance for centring hole ±0.02 mm; tolerance for thread ±0.1 mm

2) Tolerance for centring hole -0.05 mm; tolerance for thread ±0.1 mm

## Ordering data

Size [mm]	Double-acting without compression spring		Single-acting or with gripping force retention	
	Part No.	Type	Closing Part No.	Type
10	<b>1310177</b>	<b>DHWS-10-A</b>	-	
16	<b>1310178</b>	<b>DHWS-16-A</b>	<b>1310179</b>	<b>DHWS-16-A-NC</b>
25	<b>1310180</b>	<b>DHWS-25-A</b>	<b>1310181</b>	<b>DHWS-25-A-NC</b>
32	<b>1310182</b>	<b>DHWS-32-A</b>	<b>1310183</b>	<b>DHWS-32-A-NC</b>
40	<b>1310184</b>	<b>DHWS-40-A</b>	<b>1310185</b>	<b>DHWS-40-A-NC</b>

# Angle grippers DHWS



Accessories

FESTO

**Adapter kit**  
HMSV, HAPG, HAPS, HMVA, DHAA

Material:  
Wrought aluminium alloy  
Free of copper and PTFE  
RoHS-compliant

 Note  
The kit includes the individual mounting interface as well as the necessary mounting material.

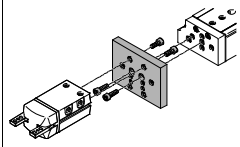
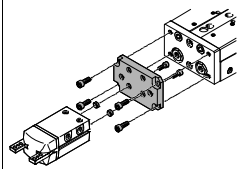
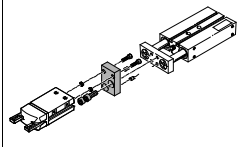
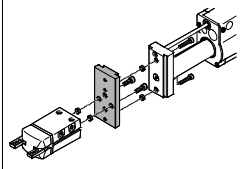
Permissible drive/gripper combinations with adapter kit						Download CAD data → <a href="http://www.festo.com">www.festo.com</a>		
Combination	Drive Size	Gripper Size	Mounting option		Adapter kit			
					CRC <sup>1)</sup>	Part No.	Type	
	DGSL	DHWS			HMSV			
	8, 10	10	■	■	2	548784	HMSV-54	
	12, 16	16	■	■		548785	HMSV-55	
	20, 25	25, 32	■	■		548786	HMSV-56	
	SLT	DHWS			HAPS			
	10	10	■	–	2	178448	HAPS-2	
	16	16	■	–		178449	HAPS-3	
	20	25	■	–		178450	HAPS-4	
	25	32	■	–		178451	HAPS-5	
	DPZ	DHWS			HAPG			
	10, 16	16	■	–	2	163250	HAPG-1	
	16	25	■	–		163251	HAPG-2	
	20	25	■	–		163252	HAPG-3	
	25, 32	32	■	–		163253	HAPG-4	
	HMP	DHWS			HMSV			
	Direct mounting					2		
	16, 20	16	■	■	177666		HMSV-20	
	16, 20, 25	25	■	■	177761		HMSV-21	
	16, 20, 25, 32	32	■	■	177762		HMSV-22	
	25	40	■	■	177763		HMSV-23	
	32	40	■	■	177764		HMSV-24	
	Dovetail mounting					2		
	16, 20	16	■	■	177767		HMSV-27	
	16, 20, 25	25	■	■	177768		HMSV-28	
	16, 20, 25, 32	32	■	■	177769		HMSV-29	
	25	40	■	■	177770		HMSV-30	
32	40	■	■	178211	HMSV-31			

1) Corrosion resistance class CRC 2 to Festo standard FN 940070  
Moderate corrosion stress. Indoor applications in which condensation may occur. External visible parts with primarily decorative requirements for the surface and which are in direct contact with the ambient atmosphere typical for industrial applications.



# Angle grippers DHWS

Accessories

FESTO

**Adapter kit**  
HMSV, HAPG, HAPS, HMVA, DHAA

Material:  
Wrought aluminium alloy  
Free of copper and PTFE  
RoHS-compliant

 Note  
The kit includes the individual mounting interface as well as the necessary mounting material.

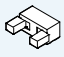
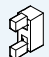
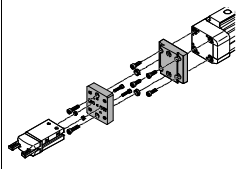
Permissible drive/gripper combinations with adapter kit					Download CAD data → <a href="http://www.festo.com">www.festo.com</a>		
Combination	Drive Size	Gripper Size	Mounting option		Adapter kit		
					CRC <sup>1)</sup>	Part No.	Type
DGP..., DGE-..., DGEA/DHWS	DG...	DHWS				HMVA, HAPG, HMSV	
	Direct mounting						
	18 <sup>2)</sup> , 25 <sup>3)</sup>	10	■	■	2	196788	HMVA-DIA18/25
						192706	HAPG-37-S1
	40 <sup>3)</sup>	10	■	■		196790	HMVA-DIA40
						192706	HAPG-37-S1
	18 <sup>2)</sup> , 25 <sup>3)</sup>	16	■	■		196788	HMVA-DIA18/25
						192705	HAPG-36-S1
	40 <sup>3)</sup>	16	■	■		196790	HMVA-DIA40
						192705	HAPG-36-S1
	18 <sup>2)</sup> , 25 <sup>3)</sup>	25	■	■		196788	HMVA-DIA18/25
						193922	HAPG-37-S4
	40 <sup>3)</sup>	25	■	■		196790	HMVA-DIA40
						193922	HAPG-37-S4
	Dovetail mounting						
18 <sup>2)</sup> , 25	16	■	■	2		196788	HMVA-DIA18/25
					177767	HMSV-27	
40	16	■	■		196790	HMVA-DIA40	
					177767	HMSV-27	
18 <sup>2)</sup> , 25	25	■	■		196788	HMVA-DIA18/25	
					177768	HMSV-28	
40	25	■	■		196790	HMVA-DIA40	
					177768	HMSV-28	
40	32	■	■		196790	HMVA-DIA40	
					177769	HMSV-29	
40	40	■	■		196790	HMVA-DIA40	
					177770	HMSV-30	

- 1) Corrosion resistance class CRC 2 to Festo standard FN 940070  
Moderate corrosion stress. Indoor applications in which condensation may occur. External visible parts with primarily decorative requirements for the surface and which are in direct contact with the ambient atmosphere typical for industrial applications.
- 2) Only for DGEA-...
- 3) Only for DGE.../DGP...

# Angle grippers DHWS



Accessories

FESTO

**Adapter kit**  
HMSV, HAPG, HAPS, HMVA, DHAA

Material:  
Wrought aluminium alloy  
Free of copper and PTFE  
RoHS-compliant

 Note  
The kit includes the individual mounting interface as well as the necessary mounting material.

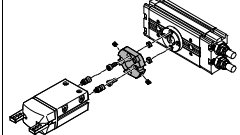
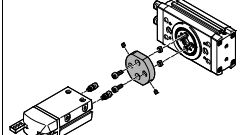
Permissible drive/gripper combinations with adapter kit					Download CAD data → <a href="http://www.festo.com">www.festo.com</a>				
Combination	Drive Size	Gripper Size	Mounting option		Adapter kit				
					CRC <sup>1)</sup>	Part No.	Type		
	DRQD-...-FW	DHWS			2	HAPG			
	6, 8, 12	10	■	■		187568	HAPG-34		
	16 <sup>2)</sup>	10	■	■		187566	HAPG-SD2-12		
	16 <sup>2)</sup>	16	■	■		184477	HAPG-SD2-1		
	16 <sup>2)</sup>	25	■	■		184478	HAPG-SD2-2		
	20 <sup>2)</sup>	25	■	■		184479	HAPG-SD2-3		
	20 <sup>2)</sup>	32	■	■		184480	HAPG-SD2-4		
	25 <sup>3)</sup>	25	■	■		184482	HAPG-SD2-6		
	25 <sup>3)</sup>	32	■	■		184483	HAPG-SD2-7		
	32 <sup>3)</sup>	32	■	■		184485	HAPG-SD2-9		
	32 <sup>3)</sup>	40	■	■		184486	HAPG-SD2-10		
	40, 50	40	■	■		526027	HAPG-SD2-21		
	DRQD-...ZW	DHWS				2	HAPG		
	16	16	■	■			163267	HAPG-18	
	16	25	■	■			163268	HAPG-19	
	20	25	■	■			163269	HAPG-20	
	20	32	■	■			163270	HAPG-21	
	25	32	■	■			163271	HAPG-22	
		DRRD	DHWS				2	DHAA	
		8	10	■		■		2816591	DHAA-G-Q11-8-B2/B3-10
10		10	■	■	2816068	DHAA-G-Q11-10-B2/B3-10			
12		10	■	■	2814790	DHAA-G-Q11-12-B2/B3-10			
12		16	■	■	2811183	DHAA-G-Q11-12-B2/B3-16			
16		16	■	■	1979085	DHAA-G-Q11-16-B2/B3-16			
16		25	■	■	1978889	DHAA-G-Q11-16-B2/B3-25			
20		25	■	■	1978443	DHAA-G-Q11-20-B2/B3-25			
20		32	■	■	1979912	DHAA-G-Q11-20-B2/B3-32			
25		25	■	■	1801802	DHAA-G-Q11-25-B2/B3-25			
25		32	■	■	1802969	DHAA-G-Q11-25-B2/B3-32			
32		32	■	■	1979992	DHAA-G-Q11-32-B2/B3-32			
32		40	■	■	1980014	DHAA-G-Q11-32-B2/B3-40			
35, 40		40	■	■	1980059	DHAA-G-Q11-35/40-B2/B3-40			

- 1) Corrosion resistance class CRC 2 to Festo standard FN 940070  
Moderate corrosion stress. Indoor applications in which condensation may occur. External visible parts with primarily decorative requirements for the surface and which are in direct contact with the ambient atmosphere typical for industrial applications.
- 2) Possible in combination with DRQD-...-E422 (flanged shaft with energy through-feed).
- 3) Possible in combination with DRQD-...-E444 (flanged shaft with energy through-feed).

# Angle grippers DHWS

Accessories

FESTO

**Adapter kit**  
HMSV, HAPG, HAPS, HMVA, DHAA

**Material:**  
Wrought aluminium alloy  
Free of copper and PTFE  
RoHS-compliant

 **Note**  
The kit includes the individual mounting interface as well as the necessary mounting material.

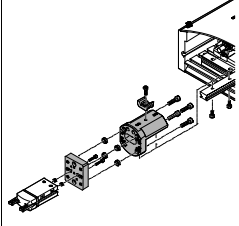
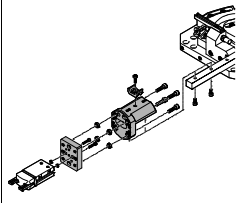
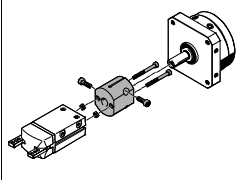
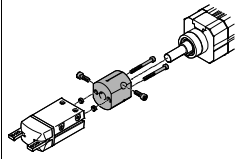
Permissible drive/gripper combinations with adapter kit						Download CAD data → <a href="http://www.festo.com">www.festo.com</a>	
Combination	Drive	Gripper	Mounting option		Adapter kit		
			Size	Size	CRC <sup>1)</sup>	Part No.	Type
	HSP	DHWS			2		
	12	10	■	–		192709	HAPG-60-S1
						540881	HAPG-70-B
	16	10	■	–		192706	HAPG-37-S1
						540882	HAPG-71-B
	16	16	■	–		192705	HAPG-36-S1
				540882	HAPG-71-B		
	25	16	■	–	192705	HAPG-36-S1	
					540883	HAPG-72-B	
	25	25	■	–	193922	HAPG-37-S4	
					540883	HAPG-72-B	
	HSW	DHWS			2		
	12, 16	10	■	–		192706	HAPG-37-S1
						540882	HAPG-71-B
	12, 16	16	■	–	192705	HAPG-36-S1	
					540882	HAPG-71-B	
	DSM:....FW	DHWS			2	187568	HAPG-34
	DSM:....	DHWS			2		
	12	16	■	■		163266	HAPG-17
	16	16	■	■		163267	HAPG-18
	16	25	■	■		163268	HAPG-19
	25	25	■	■		163269	HAPG-20
	25	32	■	■		163270	HAPG-21
	32	32	■	■		163271	HAPG-22
	DSL	DHWS			2		
	16	16	■	■		163266	HAPG-17
	20	16	■	■		163267	HAPG-18
	20	25	■	■		163268	HAPG-19
	25	25	■	■		163269	HAPG-20
	25	32	■	■		163270	HAPG-21
	32	32	■	■		163271	HAPG-22

1) Corrosion resistance class CRC 2 to Festo standard FN 940070  
Moderate corrosion stress. Indoor applications in which condensation may occur. External visible parts with primarily decorative requirements for the surface and which are in direct contact with the ambient atmosphere typical for industrial applications.

# Angle grippers DHWS



Accessories

FESTO

**Adapter kit**  
HMSV, HAPG, HAPS, HMVA, DHAA

Material:  
Wrought aluminium alloy  
Free of copper and PTFE  
RoHS-compliant

 Note  
The kit includes the individual mounting interface as well as the necessary mounting material.

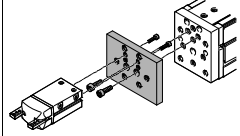
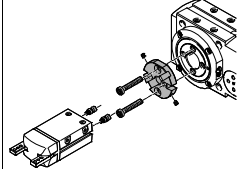
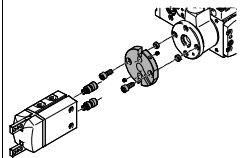
Permissible drive/gripper combinations with adapter kit							Download CAD data → <a href="http://www.festo.com">www.festo.com</a>	
Combination	Drive Size	Gripper Size	Mounting option		Adapter kit			
					CRC <sup>1)</sup>	Part No.	Type	
<b>EGSL/DHWS</b>	<b>EGSL</b>	<b>DHWS</b>			<b>HMSV</b>			
	35	10	■	■	2	548784	HMSV-54	
	45, 55	16	■	■		1088262	HMSV-70	
	75	25, 32	■	■		548785	HMSV-55	
			■	■		548786	HMSV-56	
<b>ERMB/DHWS</b>	<b>ERMB</b>	<b>DHWS</b>			<b>HAPG</b>			
	20	25	■	■	2	184479	HAPG-SD2-3	
	25	25	■	■		184482	HAPG-SD2-6	
	20	32	■	■		184480	HAPG-SD2-4	
	25	32	■	■		184483	HAPG-SD2-7	
	32	32	■	■		184485	HAPG-SD2-9	
	32	40	■	■		184486	HAPG-SD2-10	
			■	■				
<b>EHMB/DHWS</b>	<b>EHMB</b>	<b>DHWS</b>			<b>HAPG</b>			
	20	32	■	■	2	184485	HAPG-SD2-9	
	20	40	■	■		184486	HAPG-SD2-10	
	25, 32	40	■	■		526027	HAPG-SD2-21	
			■	■				

1) Corrosion resistance class CRC 2 to Festo standard FN 940070  
Moderate corrosion stress. Indoor applications in which condensation may occur. External visible parts with primarily decorative requirements for the surface and which are in direct contact with the ambient atmosphere typical for industrial applications.

# Angle grippers DHWS

Accessories

FESTO

Ordering data						
	For size [mm]	Description	Weight [g]	Part No.	Type	PU <sup>1)</sup>
Centring sleeve ZBH <span style="float: right;">Technical data → Internet: zbh</span>						
	10, 16	For centring the gripper during mounting	1	<b>189652</b>	<b>ZBH-5</b>	10
	25		1	<b>186717</b>	<b>ZBH-7</b>	
	32		1	<b>150927</b>	<b>ZBH-9</b>	
	40		1	<b>189653</b>	<b>ZBH-12</b>	

1) Packaging unit

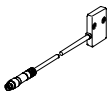
Ordering data						
Type	For size		Weight [g]	Part No.	Type	
Position sensor SMH-S1 <span style="float: right;">Technical data → Internet: smh-s1</span>						
	10		20	<b>175711</b>	<b>SMH-S1-HGW10</b>	



## Signal converter/evaluation unit for position sensor SMH-S1

Signal converter SVE4

Evaluation unit SMH-AE1

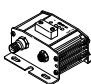
- Converts analogue signals into switching points
- Switching function freely programmable with teach-in
- Threshold value, hysteresis or window comparator
- Converts analogue signals into switching points
- With 3 potentiometers for setting 3 switching points

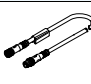

Ordering data						
Type	For size	Input connection	Output connection	Switching output	Weight [g]	Part No. Type
Signal converter SVE4 <span style="float: right;">Technical data → Internet: sve4</span>						
	10	Socket M8x1, 4-pin	Plug M8x1, 4-pin	2x PNP	19	<b>544216</b> <b>SVE4-HS-R-HM8-2P-M8</b>
				2x NPN		<b>544219</b> <b>SVE4-HS-R-HM8-2N-M8</b>
Evaluation unit SMH-AE1 <span style="float: right;">Technical data → Internet: smh-ae</span>						
	10	Socket M8x1, 4-pin	Plug M12x1, 5-pin	3x PNP	170	<b>175708</b> <b>SMH-AE1-PS3-M12</b>
				3x NPN		<b>175709</b> <b>SMH-AE1-NS3-M12</b>

Ordering data – Connecting cables						Technical data → Internet: nebu
	Electrical connection, left	Electrical connection, right	Cable length [m]	Part No.	Type	
Connection between position sensor and signal converter/evaluation unit						
	Straight socket, M8x1, 4-pin	Straight plug, M8x1, 4-pin	2.5	<b>554035</b>	<b>NEBU-M8G4-K-2.5-M8G4</b>	
Connection between evaluation unit and controller						
	Straight socket, M12x1, 5-pin	Cable, open end, 5-wire	2.5	<b>541330</b>	<b>NEBU-M12G5-K-2.5-LE5</b>	
			5	<b>541331</b>	<b>NEBU-M12G5-K-5-LE5</b>	

# Angle grippers DHWS



Accessories

FESTO

Ordering data – Connecting cables				Technical data → Internet: nebu	
	Electrical connection, left	Electrical connection, right	Cable length [m]	Part No.	Type
Connection between signal converter and controller					
	Straight socket, M8x1, 4-pin	Cable, open end, 4-wire	2.5	541342	NEBU-M8G4-K-2.5-LE4
			5	541343	NEBU-M8G4-K-5-LE4
	Angled socket, M8x1, 4-pin	Cable, open end, 4-wire	2.5	541344	NEBU-M8W4-K-2.5-LE4
			5	541345	NEBU-M8W4-K-5-LE4

## Proximity sensor for size 16 ... 40

Ordering data – Proximity sensors for T-slot, magneto-resistive				Technical data → Internet: smt	
	Type of mounting	Electrical connection, connection direction	Switching output	Cable length [m]	Part No. Type
N/O contact					
	Insertable in the slot lengthwise	Cable, 3-wire, lateral	PNP	2.5	547859 SMT-8G-PS-24V-E-2,5Q-OE
		Plug M8x1, 3-pin, lateral		0.3	547860 SMT-8G-PS-24V-E-0,3Q-M8D



Ordering data – Connecting cables				Technical data → Internet: nebu	
	Electrical connection, left	Electrical connection, right	Cable length [m]	Part No.	Type
	Straight socket, M8x1, 3-pin	Cable, open end, 3-wire	2.5	541333	NEBU-M8G3-K-2.5-LE3
			5	541334	NEBU-M8G3-K-5-LE3
	Angled socket, M8x1, 3-pin	Cable, open end, 3-wire	2.5	541338	NEBU-M8W3-K-2.5-LE3
			5	541341	NEBU-M8W3-K-5-LE3

## Position transmitter

The position transmitter continuously senses the position of the piston.

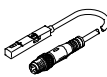
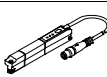
It has an analogue output with an output signal in proportion to the piston position.

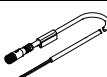
Ordering data – Position transmitters for T-slot						Technical data → Internet: position transmitter			
	Piston-∅	Position measuring range	Analogue output		Type of mounting	Electrical connection	Cable length [m]	Part No.	Type
			[V]	[mA]					
	16 ... 40	0 ... 40	0 ... 10	–	Insertable in slot from above	Plug M8x1, 4-pin, in-line	0.3	553744	SMAT-8M-U-E-0,3-M8D
	32, 40	0 ... 50	–	0 ... 20	Insertable in slot from above	Plug M8x1, 4-pin, in-line	0.3	1531265	SDAT-MHS-M50-1L-SA-E-0.3-M8

Ordering data – Connecting cables				Technical data → Internet: nebu	
	Electrical connection, left	Electrical connection, right	Cable length [m]	Part No.	Type
	Straight socket, M8x1, 4-pin	Cable, open end, 4-wire	2.5	541342	NEBU-M8G4-K-2.5-LE4
			5	541343	NEBU-M8G4-K-5-LE4
	Angled socket, M8x1, 4-pin	Cable, open end, 4-wire	2.5	541344	NEBU-M8W4-K-2.5-LE4
			5	541345	NEBU-M8W4-K-5-LE4