

Universal plug connectors, for self-assembly

FESTO



Universal plug connectors, for self-assembly

Product range overview

FESTO

| Function | Design | Type | Connection technology | Connection cross section [mm ²] | Protection class | Bus protocol/actuation | → Page/ Internet |
|----------|---------------------------------|---------------------|-----------------------------------|--|------------------|------------------------|---------------------|
| Plug | Round plug connector M8 | | | | | | |
| | 3-pin | NECU-S-M8G3-HX | Harax® quick connection | 0.1 ... 0.14 0.14 ... 0.34 | IP65, IP67 | – | 4 |
| | 4-pin | NECU-S-M8G4-HX | Harax® quick connection | 0.14 ... 0.34 | IP65, IP67 | – | 6 |
| | | NECU-S-M8G4-C2 | Screw terminal | 0.14 ... 0.5 | IP67 | – | 6 |
| | Round plug connector M12 | | | | | | |
| | 3-pin | NECU-S-M12G3-HX | Harax® quick connection | 0.14 ... 0.34 0.34 ... 0.75 | IP65, IP67 | – | 8 |
| | 4-pin | NECU-M-S-A12G4 | Spring-loaded terminal | 0.14 ... 0.5 | IP65, IP67 | – | 10 |
| | | NECU-S-M12G4-HX | Harax® quick connection | 0.14 ... 0.34 0.34 ... 0.75 | IP65, IP67 | – | 10 |
| | | NECU-S-M12G4-...-IS | Screw terminal | 0.14 ... 0.5 0.75 | IP65, IP67 | – | 10 |
| | | NECU-M-S-D12G4 | Screw terminal, can be screened | 0.14 ... 0.75 | IP67 | Ethernet | 10 |
| | 5-pin | NECU-M-S-B12G5 | Screw terminal | 0.14 ... 0.75 | IP67 | PROFIBUS | 14 |
| | Square plug connector | | | | | | |
| | 4-pin | NECU-S-ECG4 | Insulation displacement connector | 0.14 | IP40 | – | 16 |
| | 8-pin | NECU-L8G3-C1 | Spring-loaded terminal | 0.2 ... 2.5 | – | – | 18 |
| | | NECU-L8G3-C2 | Screw terminal | 0.2 ... 2.5 | – | – | 18 |
| | Sub-D plug connector | | | | | | |
| | 9-pin | NECU-S1W9-C2-APB | IDC terminal | 0.08 ... 0.5 | IP20 | PROFIBUS | 20 |

Harax® is a registered trademark of its respective trademark holder in certain countries.

Universal plug connectors, for self-assembly

Product range overview

FESTO

| Function | Design | Type | Connection technology | Connection cross section [mm ²] | Protection class | Bus protocol/actuation | ➔ Page/ Internet |
|----------|--------------------------------------|------------------|---------------------------------|--|------------------|------------------------|---------------------|
| Socket | Round plug connector M8 | | | | | | |
| | 4-pin | NECU-M8G4 | Screw terminal | 0.14 ... 0.5 | IP67 | – | 22 |
| | | | | | | | |
| | Round plug connector M12 | | | | | | |
| | 4-pin | SIE | Screw terminal | 0.25 ... 0.75 | IP67 | – | 24 |
| | 5-pin | NECU-M-B12G5 | Screw terminal | 0.14 ... 0.75 | IP67 | – | 26 |
| | | | | | | | |
| | Round plug connector 7/8" | | | | | | |
| | 4-pin | NECU-G78G4 | Screw terminal | Max. 1.5 | IP67 | – | 28 |
| | 5-pin | NECU-G78G5 | Screw terminal | Max. 1.5 | IP67 | – | 30 |
| | | | | | | | |
| | AIDA push-pull plug connector | | | | | | |
| | 5-pin | NECU-M-PPG5 | Spring-loaded terminal | 0.75 ... 2.5 | IP65, IP67 | – | 32 |
| | | | | | | | |
| | Sub-D plug connector | | | | | | |
| | 9-pin | NECU-S1W9-C2-ACO | Screw terminal, can be screened | 0.14 ... 0.5 | IP20 | CANopen | 34 |

Plug, M8, 3-pin

Technical data

FESTO

Plug
NECU-S-M8G3

- Plug
- 3-pin
- Can be assembled with any cable lengths



| General technical data | | | |
|--|--------------------|-----------------------------------|----------------|
| Type | | NECU-S-M8G3-HX-Q3 | NECU-S-M8G3-HX |
| Electrical connection | | Straight plug, M8x1 | |
| | | 3-pin | |
| | | Insulation displacement connector | |
| Operating voltage range | [V DC] | 0 ... 32 | |
| | [V AC] | 0 ... 32 | |
| Surge resistance | [kV] | 0.8 | |
| Acceptable current load at 40 °C | [A] | 2 | 4 |
| | | | |
| Based on standard | | EN 61076-2-104 | EN 61076-2-104 |
| | | EN 61984 | EN 61984 |
| Permissible cable Ø | [mm] | 2.1 ... 3.5 | 2.5 ... 5.1 |
| Permissible individual wire Ø | [mm] | ≥ 0.05 | ≥ 0.1 |
| Connection cross section | [mm ²] | 0.1 ... 0.14 | 0.14 ... 0.34 |
| Permissible wire Ø | [mm] | 0.6 ... 1 | 0.9 ... 1.6 |
| Permissible wire insulation | | PP | PP |
| | | PVC | PVC |
| | | – | TPE-E |
| Connection frequency | | 3 | 3 |
| Max. tightening torque of locking clip | [Nm] | 0.3 | 0.3 |
| Protection class | | IP65 | IP65 |
| | | IP67 | IP67 |

| Materials | |
|-------------------|-----------------------------|
| Housing | Polyamide |
| | Nickel-plated die-cast zinc |
| Seals | Fluoro elastomer |
| | Polyurethane |
| Pin contact | Gold-plated |
| Note on materials | Free of copper and PTFE |
| | RoHS-compliant |

| Operating and environmental conditions | |
|--|-----------------------|
| Ambient temperature | [°C] –25 ... +85 |
| Corrosion resistance class CRC ¹⁾ | 1 |
| Degree of contamination | 3 |
| Certification | cULus recognized (OL) |

1) Corrosion resistance class 1 according to Festo standard 940 070
Components subject to low corrosion stress. Transport and storage protection. Parts that do not have primarily decorative surface requirements, e.g. in internal areas that are not visible or behind covers.

Plug, M8, 3-pin

Technical data

FESTO

| Pin allocation | | |
|---|-----|-------------|
| M8x1 | | |
| 3-pin | Pin | Wire colour |
|  | 1 | Brown |
| | 3 | Blue |
| | 4 | Black |
| | | |

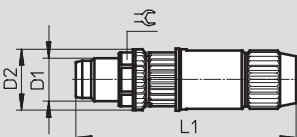
| Dimensions | Download CAD Data → www.festo.com/us/cad |
|---|--|
|  | |

| Type | D1 | D2 | L1 | ⌀ |
|------------|------|------|------|---|
| NECU-S-M8G | M8x1 | 11.5 | 40.8 | 9 |

| Ordering data | | | | |
|---|--------------------------------|------------|----------|-------------------|
| Electrical connection | Connection cross section [mm²] | Weight [g] | Part No. | Type |
| Plug M8x1, 3-pin, straight, insulation displacement connector | 0.1 ... 0.14 | 7.8 | 564945 | NECU-S-M8G3-HX-Q3 |
| | 0.14 ... 0.34 | 7.8 | 562024 | NECU-S-M8G3-HX |

Plug, M8, 4-pin

Technical data

FESTO

Plug
NECU-S-M8G4

- Plug
- 4-pin
- Can be assembled with any cable lengths



| General technical data | | | |
|--|--------------------|-----------------------------------|-------------------------------|
| Type | | NECU-S-M8G4-HX | NECU-S-M8G4-C2 |
| Electrical connection | | Straight plug, M8x1 | |
| | | 4-pin | |
| | | Insulation displacement connector | Screw terminal |
| Plug coding | | – | Coded via contact arrangement |
| Operating voltage range | [V DC] | 0 ... 32 | 0 ... 30 |
| | [V AC] | 0 ... 32 | 0 ... 30 |
| Surge resistance | [kV] | 0.8 | 0.8 |
| Acceptable current load at 40 °C | [A] | 4 | 4 |
| Based on standard | | EN 61076-2-104 | EN 61076-2-101 |
| | | EN 61984 | EN 61984 |
| Transmission characteristics | | – | DIN EN 50173/CAT 5 |
| Permissible cable Ø | [mm] | 2.5 ... 5.1 | 3.5 ... 5.0 |
| Permissible individual wire Ø | [mm] | ≥ 0.1 | – |
| Connection cross section | [mm ²] | 0.14 ... 0.34 | 0.14 ... 0.5 |
| Permissible wire Ø | [mm] | 0.9 ... 1.6 | – |
| Permissible wire insulation | | PP | – |
| | | PVC | – |
| | | TPE-E | – |
| Connection frequency | | 3 | – |
| Max. tightening torque of locking clip | [Nm] | 0.3 | – |
| Protection class | | IP65 | – |
| | | IP67 | IP67 |

| Materials | | |
|-------------------|-----------------------------|---------------------|
| Type | NECU-S-M8G4-HX | NECU-S-M8G4-C2 |
| Housing | Polyamide | – |
| | Nickel-plated die-cast zinc | – |
| Seals | Fluoro elastomer | – |
| | Polyurethane | – |
| Pin contact | Gold-plated | Gold-plated brass |
| Union nut | – | Nickel-plated brass |
| Note on materials | Free of copper and PTFE | – |
| | RoHS-compliant | RoHS-compliant |

Plug, M8, 4-pin

Technical data

FESTO

| Operating and environmental conditions | | |
|--|-----------------------|----------------|
| Type | NECU-S-M8G4-HX | NECU-S-M8G4-C2 |
| Ambient temperature [°C] | -25 ... +85 | -25 ... +85 |
| Corrosion resistance class CRC ¹⁾ | 1 | 1 |
| Degree of contamination | 3 | 3 |
| Certification | cULus recognized (OL) | – |

- 1) Corrosion resistance class 1 according to Festo standard 940 070
Components subject to low corrosion stress. Transport and storage protection. Parts that do not have primarily decorative surface requirements, e.g. in internal areas that are not visible or behind covers.

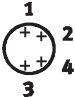
| Pin allocation | | |
|---|-----|-------------|
| M8x1 | | |
| 4-pin | Pin | Wire colour |
|  | 1 | Brown |
| | 2 | White |
| | 3 | Blue |
| | 4 | Black |

Dimensions Download CAD Data → www.festo.com/us/cad

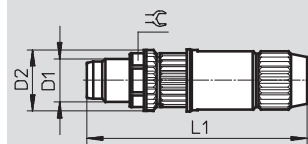

| Type | D1 | D2 | L1 | ⌀ |
|----------------|------|------|------|---|
| NECU-S-M8G4-HX | M8x1 | 11.5 | 40.8 | 9 |
| NECU-S-M8G4-C2 | M8x1 | 12 | 49.6 | 9 |

| Ordering data | | | | | |
|----------------------------|-----------------------------------|--------------------------------|------------|----------|----------------|
| Electrical connection | | Connection cross section [mm²] | Weight [g] | Part No. | Type |
| Plug M8x1, 4-pin, straight | Insulation displacement connector | 0.14 ... 0.34 | 7.8 | 562025 | NECU-S-M8G4-HX |
| | Screw terminal | 0.14 ... 0.5 | 10.9 | 1068198 | NECU-S-M8G4-C2 |

Plug, M12, 3-pin

Technical data

FESTO

Plug

NECU-S-M12G3

- Plug
- 3-pin
- Can be assembled with any cable lengths



| General technical data | | | |
|--|--------|-----------------------------------|--------------------|
| Type | | NECU-S-M12G3-HX | NECU-S-M12G3-HX-Q7 |
| Electrical connection | | Straight plug, M12x1 | |
| | | 3-pin | |
| | | Insulation displacement connector | |
| Plug coding | | A-coded | |
| Operating voltage range | [V DC] | 0 ... 32 | 0 ... 48 |
| | [V AC] | 0 ... 32 | 0 ... 48 |
| Surge resistance | [kV] | 0.8 | 0.8 |
| Acceptable current load at 40 °C | [A] | 4 | 6 |
| Based on standard | | EN 61076-2-101 | EN 61076-2-101 |
| | | EN 61984 | EN 61984 |
| Permissible cable Ø | [mm] | 2.9 ... 5.1 | 4.7 ... 6.0 |
| Permissible individual wire Ø | [mm] | ≥ 0.1 | ≥ 0.1 |
| Connection cross section | [mm²] | 0.14 ... 0.34 | 0.34 ... 0.75 |
| Permissible wire Ø | [mm] | 0.9 ... 1.6 | 1.6 ... 2.0 |
| Permissible wire insulation | | PP | – |
| | | PVC | PVC |
| | | TPE-E | – |
| Connection frequency | | 3 | 3 |
| Max. tightening torque of locking clip | [Nm] | 0.5 | 0.5 |
| Protection class | | IP65 | IP65 |
| | | IP67 | IP67 |

| Materials | |
|-------------------|-----------------------------|
| Housing | Polyamide |
| | Nickel-plated die-cast zinc |
| Seals | Fluoro elastomer |
| | Polyurethane |
| Pin contact | Gold-plated |
| Note on materials | Free of copper and PTFE |
| | RoHS-compliant |

Plug, M12, 3-pin

Technical data

FESTO

| Operating and environmental conditions | |
|--|-----------------------|
| Ambient temperature [°C] | −25 ... +85 |
| Corrosion resistance class CRC ¹⁾ | 1 |
| Degree of contamination | 3 |
| Certification | cULus recognized (OL) |

- 1) Corrosion resistance class 1 according to Festo standard 940 070
Components subject to low corrosion stress. Transport and storage protection. Parts that do not have primarily decorative surface requirements, e.g. in internal areas that are not visible or behind covers.

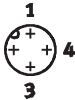
| Pin allocation | | |
|---|-----|-------------|
| M12x1 | | |
| 3-pin | Pin | Wire colour |
|  | 1 | Brown |
| | 3 | Blue |
| | 4 | Black |
| | | |

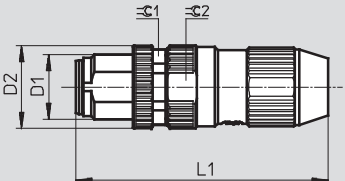
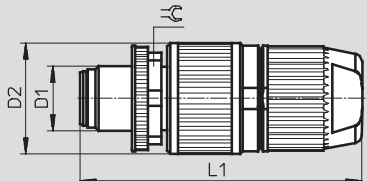
| Dimensions | Download CAD Data → www.festo.com/us/cad |
|--|---|
| NECU-S-M12G3-HX | NECU-S-M12G3-HX-Q7 |
|  |  |

| Type | D1 | D2 | L1 | ⌀G | ⌀G1 | ⌀G2 |
|--------------------|-------|------|-------|----|-----|-----|
| NECU-S-M12G3-HX | M12x1 | 15.3 | 46.75 | – | 13 | 14 |
| NECU-S-M12G3-HX-Q7 | M12x1 | 20.5 | 52.2 | 17 | – | – |

| Ordering data | | Connection cross section [mm²] | Weight [g] | Part No. | Type |
|-----------------------|-----------------------------|--------------------------------|------------|----------|--------------------|
| Electrical connection | Plug M12x1, 3-pin, straight | 0.14 ... 0.34 | 17.5 | 562027 | NECU-S-M12G3-HX |
| | | 0.34 ... 0.75 | 32.8 | 564946 | NECU-S-M12G3-HX-Q7 |

Plug, M12, 4-pin

Technical data

FESTO

Plug

NECU-M-S-A12G4

NECU-S-M12G4

NECU-M-S-D12G4

- Plug
- 4-pin
- Can be assembled with any cable lengths



| General technical data | | | | |
|--|----------------------|------------------------|-----------------------------------|--------------------|
| Type | | NECU-M-S-A12G4-IS | NECU-S-M12G4-HX | NECU-S-M12G4-HX-Q7 |
| Electrical connection | Straight plug, M12x1 | | | |
| | 4-pin | | | |
| | | Spring-loaded terminal | Insulation displacement connector | |
| Plug coding | | A-coded | A-coded | |
| Operating voltage range | [V DC] | 0 ... 30 | 0 ... 32 | 0 ... 48 |
| | [V AC] | – | 0 ... 32 | 0 ... 48 |
| Surge resistance | [kV] | – | 0.8 | 0.8 |
| Acceptable current load at 40 °C | [A] | 4 | 4 | 6 |
| | | EN 61076-2-101 | EN 61076-2-101 | EN 61076-2-101 |
| Based on standard | | – | EN 61984 | EN 61984 |
| | | | | |
| Permissible cable Ø | [mm] | 4.0 ... 8.0 | 2.9 ... 5.1 | 4.7 ... 6.0 |
| Permissible individual wire Ø | [mm] | – | ≥ 0.1 | ≥ 0.1 |
| Connection cross section | [mm ²] | 0.14 ... 0.5 | 0.14 ... 0.34 | 0.34 ... 0.75 |
| Permissible wire Ø | [mm] | – | 0.9 ... 1.6 | 1.6 ... 2.0 |
| Permissible wire insulation | | – | PP, PVC, TPE-E | PVC |
| Connection frequency | | 100 | 3 | 3 |
| Max. tightening torque of locking clip | [Nm] | 0.8 | 0.5 | 0.5 |
| Protection class | | IP65 | IP65 | IP65 |
| | | IP67 | IP67 | IP67 |

| Materials | | | | |
|-------------------|--|-----------------------------|--------------------------------|--------------------------------|
| Type | | NECU-M-S-A12G4-IS | NECU-S-M12G4-HX | NECU-S-M12G4-HX-Q7 |
| Housing | | – | Polyamide | Polyamide |
| | | Nickel-plated die-cast zinc | Nickel-plated die-cast zinc | Nickel-plated die-cast zinc |
| Seals | | – | Fluoro elastomer, polyurethane | Fluoro elastomer, polyurethane |
| Pin contact | | Gold-plated bronze | Gold-plated | Gold-plated |
| Note on materials | | – | Free of copper and PTFE | Free of copper and PTFE |
| | | RoHS-compliant | RoHS-compliant | RoHS-compliant |

| Operating and environmental conditions | | | | |
|--|------|-------------------|-----------------------|-----------------------|
| Type | | NECU-M-S-A12G4-IS | NECU-S-M12G4-HX | NECU-S-M12G4-HX-Q7 |
| Ambient temperature | [°C] | –40 ... +85 | –25 ... +85 | –25 ... +85 |
| Corrosion resistance class CRC ¹⁾ | | – | 1 | 1 |
| Degree of contamination | | 3 | 3 | 3 |
| Certification | | – | cULus recognized (OL) | cULus recognized (OL) |

1) Corrosion resistance class 1 according to Festo standard 940 070

Components subject to low corrosion stress. Transport and storage protection. Parts that do not have primarily decorative surface requirements, e.g. in internal areas that are not visible or behind covers.

Plug, M12, 4-pin

Technical data

FESTO

| General technical data | | | | | | |
|--|--------|-----------------------|-------------------|--------------------|--------------------|---------------------------------|
| Type | | NECU-S-M12G4-P1-Q6-IS | NECU-S-M12G4-D-IS | NECU-S-M12G4-P1-IS | NECU-S-M12G4-P2-IS | NECU-M-S-D12G4-C2-ET |
| Electrical connection | | Straight plug, M12x1 | | | | |
| | | 4-pin | | | | |
| | | Screw terminal | | | | Screw terminal, can be screened |
| Plug coding | | A-coded | | | | D-coded |
| Operating voltage range | [V DC] | 0 ... 30 | | | | 0 ... 250 |
| | [V AC] | – | | | | 0 ... 250 |
| Surge resistance | [kV] | 2.5 | | | | 2.5 |
| Acceptable current load at 40 °C | [A] | 4 | | | | – |
| Based on standard | | EN 61076-2-101 | | | | EN 61076-2-101 |
| | | EN 61984 | | | | EN 61984 |
| Transmission characteristics | | – | | | | DIN EN 50173/CAT 5 |
| Permissible cable Ø | [mm] | 2.5 ... 2.9 | 2x 3.0 or 2x 5.0 | 4.0 ... 6.0 | 6.0 ... 8.0 | 6.0 ... 8.0 |
| Connection cross section | [mm²] | 0.14 ... 0.5 | 0.75 | 0.75 | 0.75 | 0.14 ... 0.75 |
| Connection frequency | | 50 | | | | – |
| Max. tightening torque of locking clip | [Nm] | 0.5 | | | | – |
| Protection class | | IP65 | | | | – |
| | | IP67 | | | | IP67 |

| Materials | | |
|-------------------|---------------------|-----------------------------|
| Type | NECU-S-M12G4-...-IS | NECU-M-S-D12G4-C2-ET |
| Housing | Polyamide | Nickel-plated die-cast zinc |
| Pin contact | Brass | Gold-plated brass |
| | Coated white bronze | – |
| Note on materials | – | Free of copper and PTFE |
| | RoHS-compliant | RoHS-compliant |

| Operating and environmental conditions | | |
|--|---------------------|-----------------------------|
| Type | NECU-S-M12G4-...-IS | NECU-M-S-D12G4-C2-ET |
| Ambient temperature | [°C] | –25 ... +85 |
| Corrosion resistance class CRC ¹⁾ | – | 1 |
| Degree of contamination | 3 | 3 |
| CE marking (see declaration of conformity) | – | To EU Low Voltage Directive |

- 1) Corrosion resistance class 1 according to Festo standard 940 070
Components subject to low corrosion stress. Transport and storage protection. Parts that do not have primarily decorative surface requirements, e.g. in internal areas that are not visible or behind covers.

Plug, M12, 4-pin

Technical data

FESTO

| Pin allocation | | |
|----------------|-----|-------------|
| M12x1 | | |
| 4-pin | Pin | Wire colour |
| | 1 | Brown |
| | 2 | White |
| | 3 | Blue |
| | 4 | Black |

Dimensions Download CAD Data → www.festo.com/us/cad

| | |
|-----------------------------|------------------------|
| <p>NECU-M-S-A12G4-IS</p> | <p>NECU-S-M12G4-HX</p> |
| <p>NECU-S-M12G4-HX-Q7</p> | <p>NECU-S-M12G4-P1</p> |
| <p>NECU-S-M12G4-D</p> | <p>NECU-S-M12G4-P2</p> |
| <p>NECU-M-S-D12G4-C2-ET</p> | |

| Type | D1 | D2 | L1 | ⌀ | ⌀1 | ⌀2 |
|----------------------|-------|------|-------|----|----|----|
| NECU-M-S-A12G4-IS | M12x1 | 19.2 | 61.1 | – | – | – |
| NECU-S-M12G4-HX | M12x1 | 15.3 | 46.75 | – | 13 | 14 |
| NECU-S-M12G4-HX-Q7 | M12x1 | 20.5 | 52.2 | 17 | – | – |
| NECU-S-M12G4-P1 | M12x1 | 20 | 59.6 | – | – | – |
| NECU-S-M12G4-D | M12x1 | 20 | 62.6 | – | – | – |
| NECU-S-M12G4-P2 | M12x1 | 20 | 59.6 | – | – | – |
| NECU-M-S-D12G4-C2-ET | M12x1 | 20 | 62.5 | – | – | – |

Plug, M12, 4-pin

Technical data

FESTO

| Ordering data | | | | | |
|-----------------------------|-----------------------------------|--|---------------|---------------|------------------------------|
| Electrical connection | | Connection cross section [mm ²] | Weight [g] | Part No. | Type |
| Plug M12x1, 4-pin, straight | Spring-loaded terminal | 0.14 ... 0.5 | 38 | 575719 | NECU-M-S-A12G4-IS |
| | Insulation displacement connector | 0.14 ... 0.34 | 17.5 | 562028 | NECU-S-M12G4-HX |
| | | 0.34 ... 0.75 | 33.3 | 564947 | NECU-S-M12G4-HX-Q7 |
| | Screw terminal | 0.14 ... 0.5 | 18 | 570955 | NECU-S-M12G4-P1-Q6-IS |
| | | 0.75 | 24 | 570956 | NECU-S-M12G4-D-IS |
| | | 0.75 | 17 | 570953 | NECU-S-M12G4-P1-IS |
| | | 0.75 | 18 | 570954 | NECU-S-M12G4-P2-IS |
| | Screw terminal, can be screened | 0.14 ... 0.75 | 45.3 | 543109 | NECU-M-S-D12G4-C2-ET |

Plug, M12, 5-pin

Technical data

FESTO

Plug

NECU-M-S-B12G5

- Plug
- 5-pin
- B-coded for PROFIBUS
- Can be assembled with any cable lengths



| General technical data | | |
|----------------------------------|---------------------------------|---------------|
| Electrical connection | Straight plug, M12x1 | |
| | 5-pin | |
| | Screw terminal, can be screened | |
| Plug coding | B-coded | |
| Operating voltage range | [V DC] | 0 ... 60 |
| | [V AC] | 0 ... 60 |
| Surge resistance | [kV] | 1.5 |
| Acceptable current load at 40 °C | [A] | 4 |
| Based on standard | EN 61076-2-101 | |
| | EN 61984 | |
| Transmission characteristics | DIN EN 50173/CAT 5 | |
| Permissible cable Ø | [mm] | 6 ... 8 |
| Connection cross section | [mm ²] | 0.14 ... 0.75 |
| Protection class | IP67 | |

| Materials | |
|-------------------|-----------------------------|
| Housing | Nickel-plated die-cast zinc |
| Pin contact | Gold-plated brass |
| Note on materials | Free of copper and PTFE |
| | RoHS-compliant |

| Operating and environmental conditions | |
|---|-----------------------------|
| Ambient temperature | [°C] -25 ... +85 |
| Corrosion resistance class CRC ¹⁾ | 1 |
| Degree of contamination | 3 |
| CE marking (see declaration of conformity) | To EU Low Voltage Directive |

1) Corrosion resistance class 1 according to Festo standard 940 070
Components subject to low corrosion stress. Transport and storage protection. Parts that do not have primarily decorative surface requirements, e.g. in internal areas that are not visible or behind covers.

Plug, M12, 5-pin

Technical data

FESTO

Dimensions

NECU-M-S-B12G5

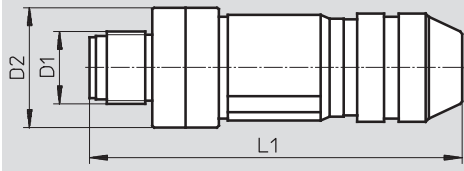

Pin allocation

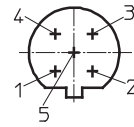

Download CAD Data → www.festo.com/us/cad

| Type | D1 | D2 | L1 |
|----------------|-----|----|------|
| NECU-M-S-B12G5 | M12 | 20 | 62.5 |

Ordering data

| Electrical connection | | Connection cross section [mm ²] | Weight [g] | Part No. | Type |
|-----------------------------|---------------------------------|--|---------------|----------------|-----------------------------|
| Plug M12x1, 5-pin, straight | Screw terminal, can be screened | 0.14 ... 0.75 | 46 | 1066354 | NECU-M-S-B12G5-C2-PB |

Plug, square, 4-pin

Technical data

FESTO

Plug
NECU-S-ECG4

- Plug
- 4-pin
- Insulation displacement connector
- Can be assembled with any cable lengths



| General technical data | | |
|----------------------------------|--------------------|-----------------------------------|
| Electrical connection | | Straight plug, square design |
| | | 4-pin |
| | | Insulation displacement connector |
| Operating voltage range | [V DC] | 0 ... 30 |
| Surge resistance | [kV] | 0.8 |
| Acceptable current load at 40 °C | [A] | 3 |
| Permissible individual wire Ø | [mm] | ≥ 0.07 |
| Connection cross section | [mm ²] | 0.14 |
| Permissible wire Ø | [mm] | 0.8 ... 1.0 |
| Permissible wire insulation | | PP |
| | | PVC |
| | | TPE-E |
| Connection frequency | | 1 |
| Type of mounting | | Engaging |
| Protection class | | IP40 |

| Materials | |
|-------------------|----------------------------|
| Housing | Polybutylene terephthalate |
| | Polycarbonate |
| Pin contact | Gold-plated |
| Note on materials | RoHS-compliant |

| Operating and environmental conditions | |
|--|-----------------------|
| Ambient temperature | [°C] -20 ... +60 |
| Corrosion resistance class CRC ¹⁾ | 1 |
| Degree of contamination | 2 |
| Certification | cULus recognized (OL) |

1) Corrosion resistance class 1 according to Festo standard 940 070
Components subject to low corrosion stress. Transport and storage protection. Parts that do not have primarily decorative surface requirements, e.g. in internal areas that are not visible or behind covers.

Plug, square, 4-pin

Technical data

FESTO

Dimensions

Download CAD Data → www.festo.com/us/cad

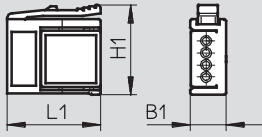

| Type | B1 | H1 | L1 |
|-------------|-----|------|------|
| NECU-S-ECG4 | 5.9 | 14.9 | 15.6 |

Ordering data

| Electrical connection | | Connection cross section [mm ²] | Weight [g] | Part No. | Type |
|-------------------------------------|-----------------------------------|--|---------------|----------|-------------------|
| Straight plug, square design, 4-pin | Insulation displacement connector | 0.14 | 3.6 | 570922 | NECU-S-ECG4-HX-Q3 |

Plug, terminal strip, 8-pin

Technical data

FESTO

Terminal strip

NECU-L8G3

- Plug
- 8-pin
- Can be assembled with any cable lengths
- The plugs meet the requirements of IEC 60079-11 with regard to air, leakage paths and separation distances for the maximum intrinsically safe operating voltage of 30 V DC

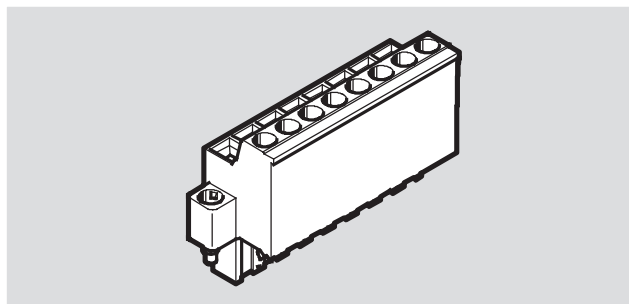

| General technical data | | | |
|--|------------------------|--------------|----------------|
| Type | | NECU-L8G3-C1 | NECU-L8G3-C2 |
| Electrical connection | Straight plug | | |
| | 8-pin | | |
| | Spring-loaded terminal | | Screw terminal |
| Operating voltage range | [V DC] | 0 ... 30 | 0 ... 30 |
| Surge resistance | [kV] | 4 | 0.8 |
| Acceptable current load at 40 °C | [A] | 12 | 12 |
| Connection cross section | [mm ²] | 0.2 ... 2.5 | 0.2 ... 2.5 |
| Connection frequency | | 100 | 100 |
| Max. tightening torque of locking clip | [Nm] | – | 0.6 |
| Product weight | [g] | 20 | 20 |

| Materials | |
|-------------------|-------------------------|
| Housing | Polyamide |
| Pin contact | Tin-plated copper alloy |
| Note on materials | RoHS-compliant |

| Operating and environmental conditions | |
|--|------------------|
| Ambient temperature | [°C] –40 ... +85 |
| Corrosion resistance class CRC ¹⁾ | 2 |
| Degree of contamination | 3 |

1) Corrosion resistance class 2 according to Festo standard 940 070

Components subject to moderate corrosion stress. Externally visible parts with primarily decorative surface requirements which are in direct contact with a normal industrial environment or media such as coolants or lubricating agents.

Plug, terminal strip, 8-pin

Technical data

Dimensions

Download CAD Data → www.festo.com/us/cad

NECU-L3G8-C1

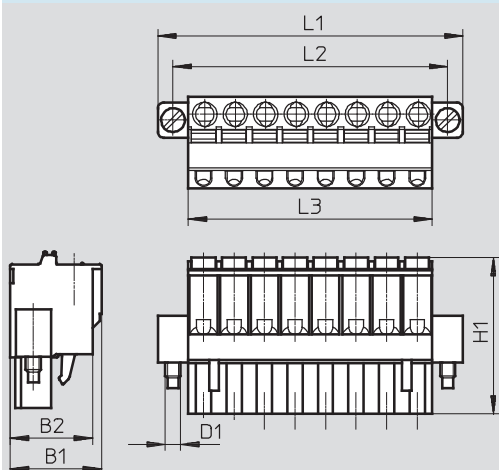

NECU-L3G8-C2

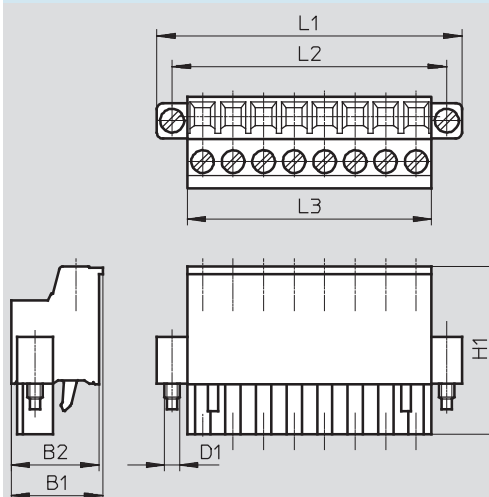

| Type | B1 | B2 | D1 | H1 | L1 | L2 | L3 |
|--------------|----|------|------|------|----|----|----|
| NECU-L3G8-C1 | 15 | 13.5 | M2.5 | 25.6 | 50 | 45 | 40 |
| NECU-L3G8-C2 | 15 | 14.4 | M2.5 | 27.5 | 50 | 45 | 40 |

Ordering data

| Electrical connection | | Housing colour | Part No. | Type |
|-----------------------|------------------------|----------------|---------------|------------------------|
| Plug, 8-pin, straight | Spring-loaded terminal | Black | 565712 | NECU-L3G8-C1 |
| | | Gentian blue | 565711 | NECU-L3G8-C1-IS |
| | Screw terminal | Black | 565710 | NECU-L3G8-C2 |
| | | Gentian blue | 565709 | NECU-L3G8-C2-IS |

Plug, Sub-D, 9-pin

Technical data

FESTO

Plug
NECU-S1W9

- Plug
- 9-pin
- Can be assembled with any cable lengths
- Plug for PROFIBUS with terminating resistor and programming interface

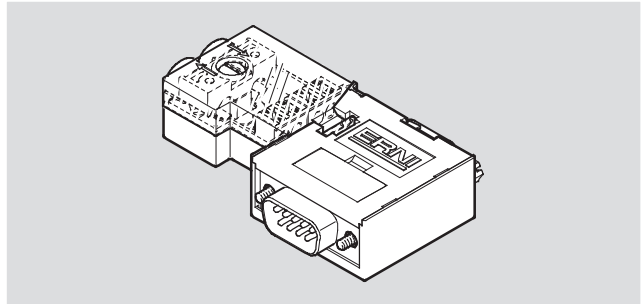

| General technical data | | |
|--------------------------|--------------------|--------------|
| Electrical connection | | Sub-D plug |
| | | 9-pin |
| | | IDC terminal |
| Programming interface | | Sub-D socket |
| | | 9-pin |
| Baud rate | [Mbps] | 12 |
| Permissible cable Ø | [mm] | 8 |
| Connection cross section | [mm ²] | 0.08 ... 0.5 |
| Type of mounting | | 4-40UNC |
| Protection class | | IP20 |

| Materials | |
|-------------------|--------------------------|
| Housing | Reinforced polycarbonate |
| Note on materials | RoHS-compliant |

| Operating and environmental conditions | | |
|--|------|-------------|
| Ambient temperature | [°C] | -20 ... +70 |
| Corrosion resistance class CRC ¹⁾ | | 1 |
| Relative air humidity | [%] | 75 at 25 °C |

1) Corrosion resistance class 1 according to Festo standard 940 070
Components subject to low corrosion stress. Transport and storage protection. Parts that do not have primarily decorative surface requirements, e.g. in internal areas that are not visible or behind covers.

Plug, Sub-D, 9-pin

Technical data

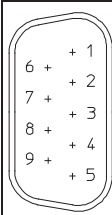
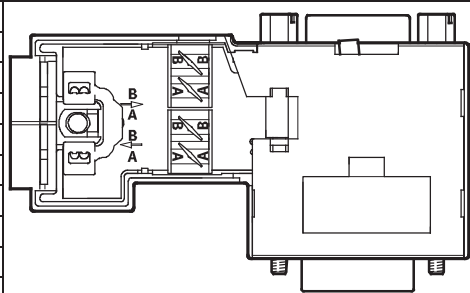
| Pin allocation | | | | |
|--|---------|-------------|---------------------|----------|
| Sub-D | | | | |
| 9-pin | Pin | Wire colour | Signal | Terminal |
| Sub-D plug | | | | |
|  | 1 | – | – | – |
| | 2 | – | – | – |
| | 3 | Red | RxD/TxD-P | B |
| | 4 | – | – | – |
| | 5 | – | CAN | – |
| | 6 | – | VP (supply voltage) | – |
| | 7 | – | – | – |
| | 8 | Green | RxD/TxD-N | A |
| | 9 | – | – | – |
| | Housing | – | – | – |
|  | | | | |

Dimensions

Download CAD Data ➔ www.festo.com/us/cad

Technical drawing of a Festo Sub-D plug, showing front and side views with dimensions and callouts.

Front View (Left):

- B1:** Width of the main body.
- D1:** Width of the base.
- H1:** Total height of the main body.
- 3:** Callout pointing to the internal contact pins.

Side View (Right):

- L1:** Total length of the main body.
- H2:** Total height of the main body.
- H3:** Height of the main body from the base.
- H4:** Height of the base.
- H5:** Height of the main body from the base (excluding the base).
- H6:** Height of the base.
- L2:** Total length of the base.
- L3:** Length of the base.
- L4:** Length of the main body.
- 1:** Callout pointing to the top of the main body.
- 2:** Callout pointing to the base.

| Type | B1 | D1 | H1 | H2 | H3 | H4 | H5 | H6 | L1 | L2 | L3 | L4 |
|------------------|------|---------|------|------|----|----|----|-----|------|------|------|----|
| NECU-S1W9-C2-APB | 16.2 | 4-40UNC | 40.7 | 44.2 | 28 | 12 | 10 | 5.2 | 72.8 | 53.1 | 35.1 | 25 |

| Ordering data | | | |
|-----------------------|--|-------------------------------|-------------------------|
| Electrical connection | | Connection cross section [mm] | Part No. Type |
| Sub-D plug, 9-pin | | IDC terminal | 574589 NECU-S1W9-C2-APB |

Socket, M8, 4-pin

Technical data

FESTO

Socket

NECU-M8G4

- Socket
- 4-pin
- Can be assembled with any cable lengths



| General technical data | | |
|--|--------------------|-----------------------|
| Electrical connection | | Straight socket, M8x1 |
| | | 4-pin |
| Operating voltage range | [V DC] | 0 ... 30 |
| | [V AC] | 0 ... 30 |
| Surge resistance | [kV] | 0.8 |
| Acceptable current load at 40 °C | [A] | 3 |
| Based on standard | | EN 61984 |
| Permissible cable Ø | [mm] | 3.5 ... 5.0 |
| Connection cross section | [mm ²] | 0.14 ... 0.5 |
| Connection frequency | | 500 |
| Max. tightening torque of locking clip | [Nm] | 0.3 |
| Protection class | | IP67 |

| Materials | |
|-------------------|----------------------------|
| Housing | Polybutylene terephthalate |
| | Nickel-plated brass |
| Housing colour | Black |
| Pin contact | Gold-plated brass |
| Union nut | Nickel-plated brass |
| Note on materials | RoHS-compliant |

| Operating and environmental conditions | | |
|--|------|-------------|
| Ambient temperature | [°C] | -40 ... +80 |
| Storage temperature | [°C] | -40 ... +80 |
| Corrosion resistance class CRC ¹⁾ | | 2 |
| Degree of contamination | | 3 |

1) Corrosion resistance class 2 according to Festo standard 940 070

Components subject to moderate corrosion stress. Externally visible parts with primarily decorative surface requirements which are in direct contact with a normal industrial environment or media such as coolants or lubricating agents.

Socket, M8, 4-pin

Technical data

FESTO

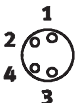
| Pin allocation | | |
|---|-----|-------------|
| M8x1 | | |
| 4-pin | Pin | Wire colour |
|  | 1 | Brown |
| | 2 | White |
| | 3 | Blue |
| | 4 | Black |

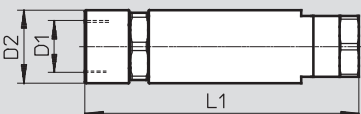
| Dimensions | Download CAD Data → www.festo.com/us/cad |
|---|--|
|  | |

| Type | D1 | D2 | L1 |
|----------|------|----|----|
| NECU-M8G | M8x1 | 12 | 45 |

| Ordering data | | | | | |
|------------------------------|----------------|--|---------------|---------------|------------------|
| Electrical connection | | Connection cross section [mm ²] | Weight [g] | Part No. | Type |
| Socket M8x1, 4-pin, straight | Screw terminal | 0.14 ... 0.5 | 9.5 | 544392 | NECU-M8G4 |

Socket, M12, 4-pin

Technical data

FESTO

Socket

SIE-GD

SIE-WD-TR

- Socket
- 4-pin
- Can be assembled with any cable lengths



| General technical data | | |
|--|------------------------|----------------------|
| Type | SIE-GD | SIE-WD-TR |
| Electrical connection | Straight socket, M12x1 | Angled socket, M12x1 |
| | 4-pin | 4-pin |
| Operating voltage range | [V DC] | 0 ... 250 |
| | [V AC] | 0 ... 250 |
| Surge resistance | [kV] | 2.5 |
| Acceptable current load at 40 °C | [A] | 4 |
| Based on standard | EN 61076-2-101 | EN 61076-2-101 |
| | EN 61984 | EN 61984 |
| Permissible cable Ø | [mm] | 4 ... 6 |
| Connection cross section | [mm ²] | 0.25 ... 0.75 |
| Max. tightening torque of locking clip | [Nm] | 0.5 |
| Protection class | IP67 | IP67 |

| Materials | |
|-------------------|----------------|
| Housing | Polyamide |
| Union nut | Polyamide |
| Note on materials | RoHS-compliant |

| Operating and environmental conditions | |
|--|-----------------------------|
| Ambient temperature | [°C] -25 ... +85 |
| Corrosion resistance class CRC ¹⁾ | 4 |
| Degree of contamination | 3 |
| CE marking (see declaration of conformity) | To EU Low Voltage Directive |

1) Corrosion resistance class 4 to Festo standard 940 070
Components subject to high corrosion stress. Parts used with aggressive media, e.g. in the food or chemical industry. These applications should be supported with special tests with the media if required.

Socket, M12, 4-pin

Technical data

FESTO

Dimensions

Download CAD Data → www.festo.com/us/cad

SIE-GD

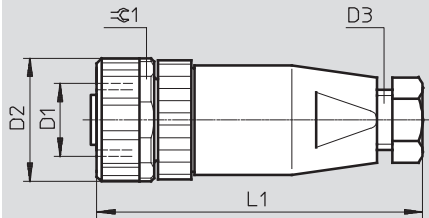

SIE-WD-TR

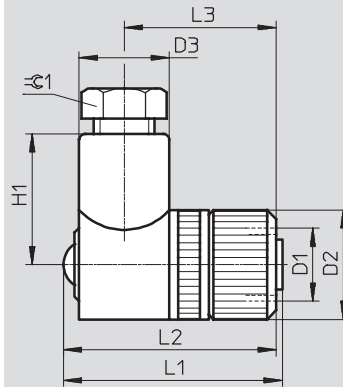

| Type | D1 | D2 | D3 | H1 | L1 | L2 | L3 | ≈C1 |
|-----------|-------|------|------|------|----|----|----|-----|
| SIE-GD | M12x1 | 20.2 | Pg7 | – | 54 | – | – | 18 |
| SIE-WD-TR | M12x1 | 18 | 14.8 | 20.5 | 36 | 35 | 25 | 13 |

Ordering data

| Electrical connection | | Connection cross section [mm ²] | Part No. | Type |
|-----------------------|----------|--|--------------|------------------|
| Socket M12x1, 4-pin | Straight | 0.25 ... 0.75 | 18494 | SIE-GD |
| | Angled | 0.25 ... 0.75 | 12956 | SIE-WD-TR |

Socket, M12, 5-pin

Technical data

FESTO

Socket

NECU-M-B12G5

- Socket
- 5-pin
- Can be assembled with any cable lengths



| General technical data | | |
|----------------------------------|---------------------------------|---------------|
| Electrical connection | Straight socket, M12x1 | |
| | 5-pin | |
| | Screw terminal, can be screened | |
| Plug coding | B-coded | |
| Operating voltage range | [V DC] | 0 ... 125 |
| | [V AC] | 0 ... 125 |
| Surge resistance | [kV] | 1.25 |
| Acceptable current load at 40 °C | [A] | 4 |
| Based on standard | EN 61076-2-101 | |
| | EN 61984 | |
| Transmission characteristics | DIN EN 50173/CAT 5 | |
| Permissible cable Ø | [mm] | 6 ... 8 |
| Connection cross section | [mm ²] | 0.14 ... 0.75 |
| Protection class | IP67 | |

| Materials | |
|-------------------|-----------------------------|
| Housing | Nickel-plated die-cast zinc |
| Pin contact | Gold-plated brass |
| Note on materials | RoHS-compliant |

| Operating and environmental conditions | |
|---|-----------------------------|
| Ambient temperature | [°C] -25 ... +85 |
| Corrosion resistance class CRC ¹⁾ | 1 |
| Degree of contamination | 3 |
| CE marking (see declaration of conformity) | To EU Low Voltage Directive |

1) Corrosion resistance class 1 according to Festo standard 940 070
Components subject to low corrosion stress. Transport and storage protection. Parts that do not have primarily decorative surface requirements, e.g. in internal areas that are not visible or behind covers.

Socket, M12, 5-pin

Technical data

FESTO

Dimensions

NECU-M-B12G5

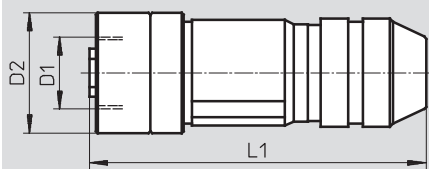

Pin allocation

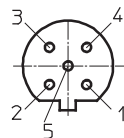

Download CAD Data → www.festo.com/us/cad

| Type | D1 | D2 | L1 |
|--------------|-----|----|----|
| NECU-M-B12G5 | M12 | 20 | 56 |

Ordering data

| Electrical connection | Connection cross section [mm ²] | Part No. | Type |
|-------------------------------|--|---------------|-----------------------------------|
| Socket M12x1, 5-pin, straight | Screw terminal | 0.14 ... 0.75 | 1067905 NECU-M-B12G5-C2-PB |

Socket, 7/8", 4-pin

Technical data

FESTO

Socket
NECU-G78G4

- Socket
- 4-pin
- Can be assembled with any cable lengths



| General technical data | | |
|----------------------------------|-----------------------|-----------|
| Electrical connection | Straight socket, 7/8" | |
| | 4-pin | |
| | Screw terminal | |
| Plug coding | ODVA AutoSIG | |
| Operating voltage range | [V DC] | 0 ... 250 |
| | [V AC] | 0 ... 250 |
| Surge resistance | [kV] | 2.5 |
| Acceptable current load at 40 °C | [A] | 10 |
| Based on standard | EN 61984 | |
| Permissible cable Ø | [mm] | 6 ... 12 |
| Connection cross section | [mm ²] | Max. 1.5 |
| Protection class | IP67 | |

| Materials | |
|-------------------|-----------------------------|
| Housing | Polyamide |
| Housing colour | Black |
| Seals | Fluoro elastomer |
| | Nitrile rubber |
| Pin contact | Gold-plated copper alloy |
| Union nut | Nickel-plated die-cast zinc |
| Note on materials | Free of copper and PTFE |
| | RoHS-compliant |

| Operating and environmental conditions | |
|---|-----------------------------|
| Ambient temperature | [°C] -25 ... +80 |
| Corrosion resistance class CRC ¹⁾ | 1 |
| Degree of contamination | 3 |
| CE marking (see declaration of conformity) | To EU Low Voltage Directive |
| Certification | c CSA us (OL) |

1) Corrosion resistance class 1 according to Festo standard 940 070
Components subject to low corrosion stress. Transport and storage protection. Parts that do not have primarily decorative surface requirements, e.g. in internal areas that are not visible or behind covers.

Socket, 7/8", 4-pin

Technical data

FESTO

Dimensions

Download CAD Data → www.festo.com/us/cad

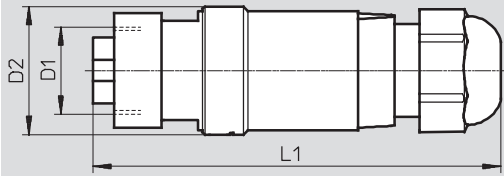

| Type | D1 | D2 | L1 |
|---------------|------|----|----|
| NECU-G78G4-C2 | 7/8" | 28 | 89 |

Ordering data

| Electrical connection | | Connection cross section [mm ²] | Part No. | Type |
|------------------------------|----------------|--|----------|---------------|
| Socket 7/8", 4-pin, straight | Screw terminal | Max. 1.5 | 543108 | NECU-G78G4-C2 |

Socket, 7/8", 5-pin

Technical data

FESTO

Socket
NECU-G78G5

- Socket
- 5-pin
- Can be assembled with any cable lengths



| General technical data | | |
|----------------------------------|-----------------------|-----------|
| Electrical connection | Straight socket, 7/8" | |
| | 5-pin | |
| | Screw terminal | |
| Plug coding | NFPA/T3.5.29 R1-2003 | |
| Operating voltage range | [V DC] | 0 ... 250 |
| | [V AC] | 0 ... 250 |
| Surge resistance | [kV] | 2.5 |
| Acceptable current load at 40 °C | [A] | 8 |
| Based on standard | EN 61984 | |
| Permissible cable Ø | [mm] | 6 ... 12 |
| Connection cross section | [mm ²] | Max. 1.5 |
| Protection class | IP67 | |

| Materials | |
|-------------------|-----------------------------|
| Housing | Polyamide |
| Housing colour | Black |
| Seals | Fluoro elastomer |
| | Nitrile rubber |
| Pin contact | Gold-plated copper alloy |
| Union nut | Nickel-plated die-cast zinc |
| Note on materials | Free of copper and PTFE |
| | RoHS-compliant |

| Operating and environmental conditions | |
|---|-----------------------------|
| Ambient temperature | [°C] -25 ... +80 |
| Corrosion resistance class CRC ¹⁾ | 1 |
| Degree of contamination | 3 |
| CE marking (see declaration of conformity) | To EU Low Voltage Directive |
| Certification | c CSA us (OL) |

1) Corrosion resistance class 1 according to Festo standard 940 070
Components subject to low corrosion stress. Transport and storage protection. Parts that do not have primarily decorative surface requirements, e.g. in internal areas that are not visible or behind covers.

Socket, 7/8", 5-pin

Technical data

FESTO

Dimensions

Download CAD Data → www.festo.com/us/cad

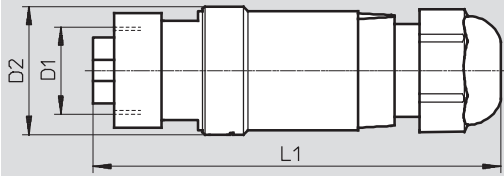

| Type | D1 | D2 | L1 |
|---------------|------|----|----|
| NECU-G78G5-C2 | 7/8" | 28 | 89 |

Ordering data

| Electrical connection | | Connection cross section [mm ²] | Weight [g] | Part No. | Type |
|------------------------------|----------------|--|---------------|----------|---------------|
| Socket 7/8", 5-pin, straight | Screw terminal | Max. 1.5 | 10.9 | 543107 | NECU-G78G5-C2 |

Socket, AIDA push-pull, 5-pin

Technical data

FESTO

Plug

NECU-M-PPG5

- Socket
- 5-pin
- Can be assembled with any cable lengths



| General technical data | | |
|----------------------------------|---------------------------------|--------------|
| Electrical connection | Straight socket, AIDA push-pull | |
| | 5-pin | |
| | Spring-loaded terminal | |
| Plug coding | Black insulator | |
| Operating voltage range | [V DC] | 0 ... 24 |
| Surge resistance | [kV] | 2.5 |
| Acceptable current load at 40 °C | [A] | 16 |
| Based on standard | EN 61984 | |
| Permissible cable Ø | [mm] | 9 ... 13 |
| Connection cross section | [mm ²] | 0.75 ... 2.5 |
| Protection class | IP65 | |
| | IP67 | |

| Materials | |
|-------------------|--|
| Housing | Nickel-plated die-cast zinc |
| Seals | Nitrile rubber |
| | Thermoplastic elastomer |
| Pin contact | Nickel-plated and gold-plated copper alloy |
| Note on materials | RoHS-compliant |

| Operating and environmental conditions | |
|--|-------------------|
| Ambient temperature | [°C] -40 ... +100 |
| Corrosion resistance class CRC ¹⁾ | 1 |
| Degree of contamination | 3 |
| Fire protection classification to UL 94 | V0 |

1) Corrosion resistance class 1 according to Festo standard 940 070
Components subject to low corrosion stress. Transport and storage protection. Parts that do not have primarily decorative surface requirements, e.g. in internal areas that are not visible or behind covers.

Socket, AIDA push-pull, 5-pin

Technical data

FESTO

Dimensions

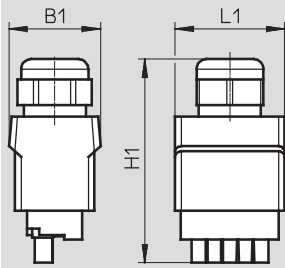

| Type | B1 | H1 | L1 |
|----------------|----|------|----|
| NECU-M-PPG5-C1 | 30 | 66.9 | 36 |

Ordering data

| Electrical connection | Connection cross section [mm ²] | Part No. | Type |
|--|--|----------|----------------|
| AIDA push-pull socket, 5-pin, straight | 0.75 ... 2.5 | 563059 | NECU-M-PPG5-C1 |

Socket, Sub-D, 9-pin

Technical data

FESTO

Socket
NECU-S1W9

- Socket
- 9-pin
- Can be assembled with any cable lengths
- Socket for CANopen with terminating resistor and programming interface

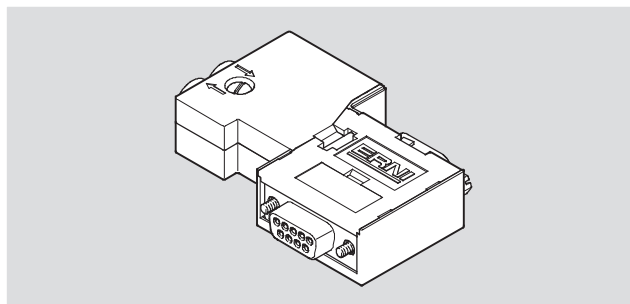

| General technical data | | |
|--------------------------|--------------------|---------------------------------|
| Electrical connection | | Sub-D socket |
| | | 9-pin |
| | | Screw terminal, can be screened |
| Programming interface | | Sub-D plug |
| | | 9-pin |
| Baud rate | [Mbps] | 1 |
| Permissible cable Ø | [mm] | 8 |
| Connection cross section | [mm ²] | 0.14 ... 0.5 |
| Type of mounting | | 4-40UNC |
| Protection class | | IP20 |

| Materials | |
|-------------------|--------------------------|
| Housing | Reinforced polycarbonate |
| Note on materials | RoHS-compliant |

| Operating and environmental conditions | | |
|--|------|-------------|
| Ambient temperature | [°C] | –20 ... +70 |
| Corrosion resistance class CRC ¹⁾ | | 1 |
| Relative air humidity | [%] | 75 at 25 °C |

1) Corrosion resistance class 1 according to Festo standard 940 070
Components subject to low corrosion stress. Transport and storage protection. Parts that do not have primarily decorative surface requirements, e.g. in internal areas that are not visible or behind covers.

Socket, Sub-D, 9-pin

Technical data

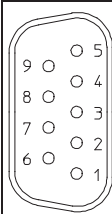
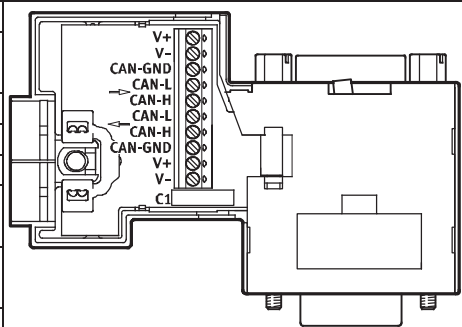
| Pin allocation | | | | |
|--|---------|-------------|--------------------------------|----------|
| Sub-D | | | | |
| 9-pin | Pin | Wire colour | Signal | Terminal |
| Sub-D plug | | | | |
|  | 1 | – | – | – |
| | 2 | White | Received/transmitted data low | C-L |
| | 3 | Screening | 0 V CAN interface | GND |
| | 4 | – | – | – |
| | 5 | – | – | – |
| | 6 | Optional | Optional screened connection | V– |
| | 7 | Brown | Received/transmitted data high | C-H |
| | 8 | – | – | – |
| | 9 | Optional | 24 V DC supply CAN interface | V+ |
| | Housing | – | – | – |
|  | | | | |

Dimensions

Download CAD Data → www.festo.com/us/cad

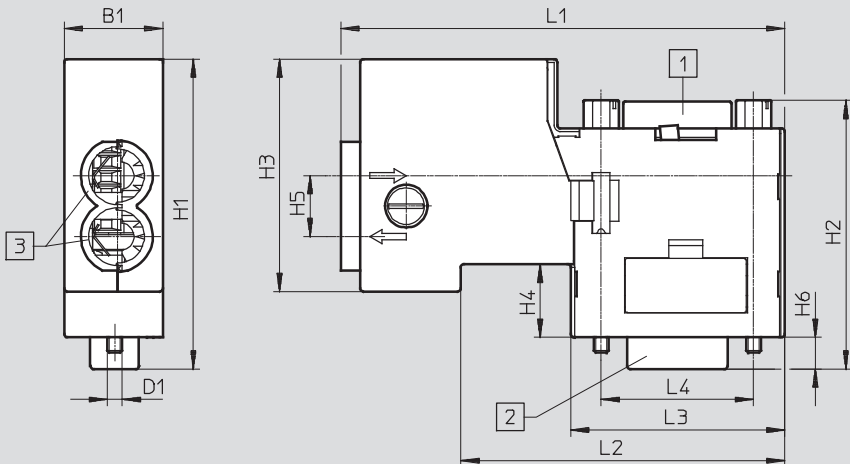

Technical drawing of a Festo Sub-D connector showing three views: front, side, and top.

Front View (Left): Shows the connector's profile with dimensions B1 (width), H1 (height), and D1 (bottom flange width). A label '3' points to the internal contact area.

Side View (Top): Shows the connector's side profile with dimensions L1 (total length), H3 (total height), H5 (height to top flange), H4 (height to bottom flange), L4 (width of bottom flange), L3 (width of main body), L2 (width of mounting base), and H2 (height of main body). A label '1' points to the top flange.

Top View (Bottom): Shows the connector's top profile with dimensions L1 (total length), L4 (width of bottom flange), L3 (width of main body), L2 (width of mounting base), and H2 (height of main body). A label '2' points to the mounting base.

| Type | B1 | D1 | H1 | H2 | H3 | H4 | H5 | H6 | L1 | L2 | L3 | L4 |
|------------------|------|---------|------|------|------|----|----|-----|------|------|------|----|
| NECU-S1W9-C2-ACO | 16.2 | 4-40UNC | 50.8 | 43.8 | 38.1 | 12 | 10 | 5.2 | 72.8 | 53.1 | 35.1 | 25 |

| Ordering data | | | |
|-----------------------|--|---------------------------------|---|
| Electrical connection | | Connection cross section [mm] | Part No. Type |
| Sub-D socket, 9-pin | | Screw terminal, can be screened | 0.14 ... 0.5 574588 NECU-S1W9-C2-ACO |

Universal plug connectors SIE, for self-assembly

Accessories

FESTO

Operational status indicator SIE-LP-LED-GR

Used to indicate the ready status of a proximity sensor SIE connected via the angled socket SIE-WD-TR. It does this by illuminating a green LED.



| Ordering data | | | |
|-----------------------------------|-----------------------------|----------|---------------|
| Operating voltage range [V DC] | Ambient temperature [°C] | Part No. | Type |
| 10 ... 30 | -25 ... +70 | 12957 | SIE-LP-LED-GR |

Product Range and Company Overview

A Complete Suite of Automation Services

Our experienced engineers provide complete support at every stage of your development process, including: conceptualization, analysis, engineering, design, assembly, documentation, validation, and production.



Custom Automation Components
Complete custom engineered solutions



Custom Control Cabinets
Comprehensive engineering support and on-site services



Complete Systems
Shipment, stocking and storage services

The Broadest Range of Automation Components

With a comprehensive line of more than 30,000 automation components, Festo is capable of solving the most complex automation requirements.



Electromechanical
Electromechanical actuators, motors, controllers & drives



Pneumatics
Pneumatic linear and rotary actuators, valves, and air supply



PLCs and I/O Devices
PLC's, operator interfaces, sensors and I/O devices

Supporting Advanced Automation... As No One Else Can!

Festo is a leading global manufacturer of pneumatic and electromechanical systems, components and controls for industrial automation, with more than 12,000 employees in 56 national headquarters serving more than 180 countries. For more than 80 years, Festo has continuously elevated the state of manufacturing with innovations and optimized motion control solutions that deliver higher performing, more profitable automated manufacturing and processing equipment. Our dedication to the advancement of automation extends beyond technology to the education and development of current and future automation and robotics designers with simulation tools, teaching programs, and on-site services.

Quality Assurance, ISO 9001 and ISO 14001 Certifications

Festo Corporation is committed to supply all Festo products and services that will meet or exceed our customers' requirements in product quality, delivery, customer service and satisfaction.

To meet this commitment, we strive to ensure a consistent, integrated, and systematic approach to management that will meet or exceed the requirements of the ISO 9001 standard for Quality Management and the ISO 14001 standard for Environmental Management.

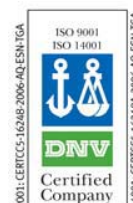

© Copyright 2008, Festo Corporation. While every effort is made to ensure that all dimensions and specifications are correct, Festo cannot guarantee that publications are completely free of any error, in particular typing or printing errors. Accordingly, Festo cannot be held responsible for the same. For Liability and Warranty conditions, refer to our "Terms and Conditions of Sale", available from your local Festo office. All rights reserved. No part of this publication may be reproduced, distributed, or transmitted in any form or by any means, electronic, mechanical, photocopying or otherwise, without the prior written permission of Festo. All technical data subject to change according to technical update.



Printed on recycled paper at New Horizon Graphic, Inc., FSC certified as an environmentally friendly printing plant.

Festo North America

Festo Regional Contact Center

5300 Explorer Drive
Mississauga, Ontario L4W 5G4
Canada

USA Customers:

For ordering assistance,

Call: 1.800.99.FESTO (1.800.993.3786)

Fax: 1.800.96.FESTO (1.800.963.3786)

Email: customer.service@us.festo.com

For technical support,

Call: 1.866.GO.FESTO (1.866.463.3786)

Fax: 1.800.96.FESTO (1.800.963.3786)

Email: product.support@us.festo.com

Canadian Customers:

Call: 1.877.GO.FESTO (1.877.463.3786)

Fax: 1.877.FX.FESTO (1.877.393.3786)

Email: festo.canada@ca.festo.com

USA Headquarters

Festo Corporation
395 Moreland Road
P.O. Box 18023
Hauppauge, NY 11788, USA
www.festo.com/us

USA Sales Offices

Appleton

North 922 Tower View Drive, Suite N
Greenville, WI 54942, USA

Boston

120 Presidential Way, Suite 330
Woburn, MA 01801, USA

Chicago

1441 East Business Center Drive
Mt. Prospect, IL 60056, USA

Dallas

1825 Lakeway Drive, Suite 600
Lewisville, TX 75057, USA

Detroit – Automotive Engineering Center

2601 Cambridge Court, Suite 320
Auburn Hills, MI 48326, USA

New York

395 Moreland Road
Hauppauge, NY 11788, USA

Silicon Valley

4935 Southfront Road, Suite F
Livermore, CA 94550, USA

United States



USA Headquarters, East: Festo Corp., 395 Moreland Road, Hauppauge, NY 11788

Phone: 1.631.435.0800; Fax: 1.631.435.8026;

Email: info@festo-usa.com

www.festo.com/us

Canada



Headquarters: Festo Inc., 5300 Explorer Drive, Mississauga, Ontario L4W 5G4

Phone: 1.905.624.9000; Fax: 1.905.624.9001;

Email: festo.canada@ca.festo.com

www.festo.ca

Mexico



Headquarters: Festo Pneumatic, S.A., Av. Ceylán 3, Col. Tequesquahuac,
54020 Tlalneapantla, Edo. de México

Phone: 011 52 [55] 53 21 66 00; Fax: 011 52 [55] 53 21 66 65;

Email: festo.mexico@mx.festo.com

www.festo.com/mx

Central USA

Festo Corporation
1441 East Business
Center Drive
Mt. Prospect, IL 60056, USA
Phone: 1.847.759.2600
Fax: 1.847.768.9480



Western USA

Festo Corporation
4935 Southfront Road,
Suite F
Livermore, CA 94550, USA
Phone: 1.925.371.1099
Fax: 1.925.245.1286



Festo Worldwide

Argentina Australia Austria Belarus Belgium Brazil Bulgaria Canada Chile China Colombia Croatia Czech Republic Denmark
Estonia Finland France Germany Great Britain Greece Hong Kong Hungary India Indonesia Iran Ireland Israel Italy Japan Latvia
Lithuania Malaysia Mexico Netherlands New Zealand Norway Peru Philippines Poland Romania Russia Serbia Singapore
Slovakia Slovenia South Africa South Korea Spain Sweden Switzerland Taiwan Thailand Turkey Ukraine United States Venezuela

www.festo.com