

Parallel grippers HGPL, heavy-duty with long stroke

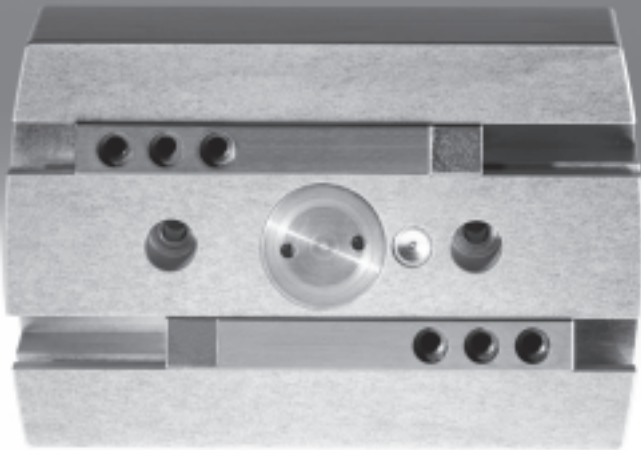

# Parallel grippers HGPL, heavy-duty with long stroke

Key features



## At a glance

- Space-saving and suitable for high forces
  - Two parallel and opposing pistons move the gripper jaws directly and without loss of force
- Reliable
  - A pinion that synchronises the movement of both gripper jaws ensures controlled, precise and centred gripping
  - The space-saving design of the parallel gripper jaws permits a long guide length for the gripper jaws
- Sturdy
  - The T-slot in combination with a long guide length allows the gripper jaws to withstand high forces and torques
- Flexible range of applications
  - Double-acting gripper suitable for external and internal gripping
  - Versatile mounting options and compressed air connections
  - Opening stroke can be adjusted to optimise time

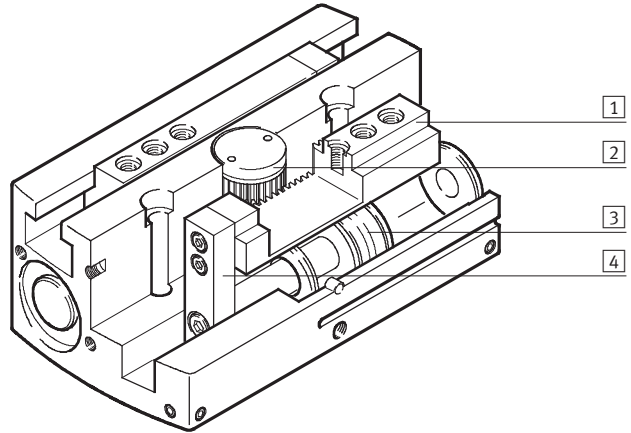

- 1 Gripper jaw
- 2 Synchronising element
- 3 Piston with magnet
- 4 Moment compensator

- - Note  
Sizing software for gripper selection  
→ [www.festo.com](http://www.festo.com)

## Wide range of supply ports

Direct from the front

Via adapter plate from underneath

## Mounting options

Direct mounting from above

from underneath

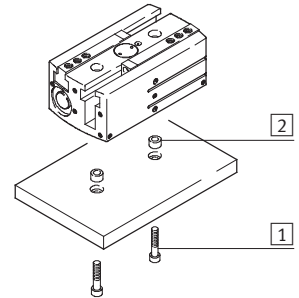
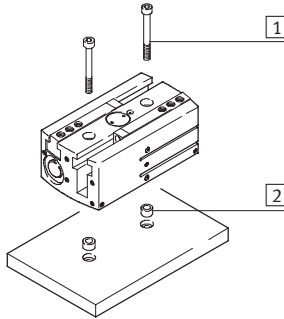
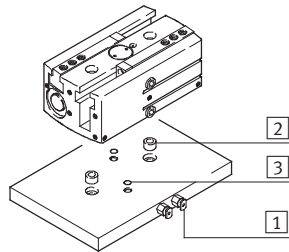
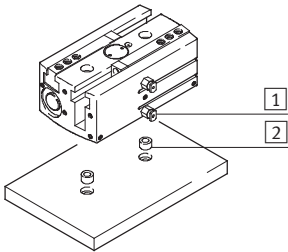

- 1 Supply ports
- 2 Centring sleeves
- 3 O-rings

- 1 Mounting screws
- 2 Centring sleeves

- - Note  
These grippers are not suitable for the following or similar application examples:

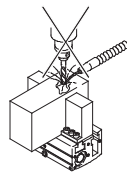

- Aggressive media
- Machining

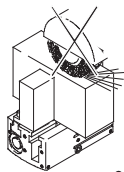

- Grinding dust

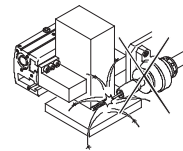

- Welding splashes

# Parallel grippers HGPL, heavy-duty with long stroke

Peripherals overview and type codes

Peripherals overview

System product for handling and assembly technology

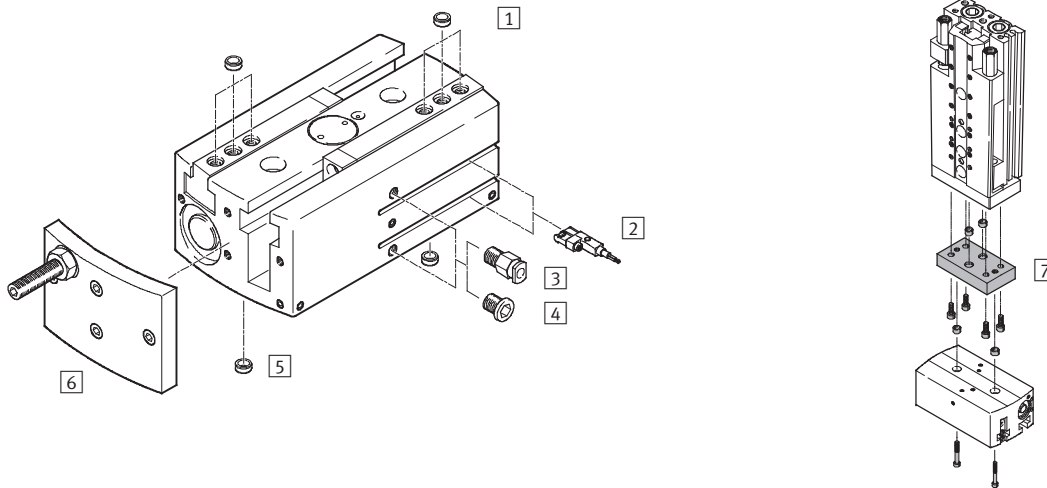

Accessories		
Type	Brief description	→ Page/Internet
1 Centring sleeve ZBH	<ul style="list-style-type: none"> <li>For centring gripper jaw blanks/gripper fingers on the gripper jaws</li> <li>4 included in the scope of delivery</li> </ul>	17
2 Proximity sensor SME/SMT-10	<ul style="list-style-type: none"> <li>For sensing the piston position</li> <li>For size 14 ... 40</li> </ul>	18
2 Proximity sensor SME/SMT-8	<ul style="list-style-type: none"> <li>For sensing the piston position</li> <li>For size 63</li> </ul>	18
3 Push-in fitting QS	For connecting compressed air tubing with standard O.D.	quick star
4 Blanking plug B	For sealing supply ports when using ports at the front	17
5 Centring sleeve ZBH	<ul style="list-style-type: none"> <li>For centring the gripper during mounting</li> <li>2 included in the scope of delivery</li> </ul>	17
6 Stroke reducing kit HGPL-HR-...	For reducing the opening stroke	16
7 Adapter kit HMSV, HAPG	Drive/gripper connections	13
- Gripper jaw blank BUB-HGPL	Blank specially matched to the gripper jaws for custom production of gripper fingers	17

Type codes

	HGPL	-	14	-	40	-	A
<b>Type</b>							
HGPL	Parallel gripper						
<b>Size</b>							
<b>Stroke [mm]</b>							
<b>Position sensing</b>							
A	Via proximity sensor						

# Parallel grippers HGPL, heavy-duty with long stroke

FESTO

Technical data

Function  
Double-acting  
HGPL...-A



www.festo.com  
Wearing parts kits  
→ 12

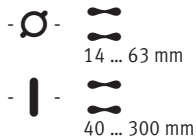
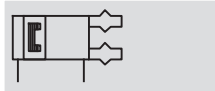

General technical data				
Size	14	25	40	63
Design	Synchronised pneumatic pistons Force-guided motion sequence			
Mode of operation	Double-acting T-shape			
Gripper function	Parallel			
Number of gripper jaws	2			
Stroke per gripper jaw [mm]	20, 40, 60, 80	20, 40, 60, 80	20, 40, 60, 80, 100	60, 100, 150
Pneumatic connection	M5			G1/8
Max. applied load per external gripper finger <sup>1)</sup> [N]	0.8	2.5	4.2	9.4
Repetition accuracy <sup>2)</sup> [mm]	< 0.03			
Max. interchangeability [mm]	< 0.2			
Max. operating frequency [Hz]	< 1			
Rotational symmetry [mm]	< $\varnothing$ 0.2			
Position sensing	Via proximity sensor			
Type of mounting	Via through-holes and centring sleeves Via female thread and centring sleeves			
Mounting position	Any			

- 1) Valid for unthrottled operation
- 2) End-position drift under constant conditions of use with 100 consecutive strokes in the direction of movement of the gripper jaws

Operating and environmental conditions	
Operating pressure [bar]	3 ... 8
Operating medium	Compressed air in accordance with ISO 8573-1:2010 [7:4:4]
Note on operating/pilot medium	Operation with lubricated medium possible (in which case lubricated operation will always be required)
Ambient temperature <sup>1)</sup> [°C]	+5 ... +60
Corrosion resistance class CRC <sup>2)</sup>	2

- 1) Note operating range of proximity sensors
- 2) Corrosion resistance class 2 according to Festo standard 940 070  
Components subject to moderate corrosion stress. Externally visible parts with primarily decorative surface requirements which are in direct contact with a normal industrial environment or media such as coolants or lubricating agents.

Weight [g]					
Size	14	25	40	63	
Stroke per gripper jaw	20 mm	305	1,015	2,560	–
	40 mm	440	1,400	3,300	–
	60 mm	595	1,780	4,165	10,460
	80 mm	720	2,200	4,800	–
	100 mm	–	–	5,340	13,800
	150 mm	–	–	–	18,100

# Parallel grippers HGPL, heavy-duty with long stroke

Technical data

## Materials

Sectional view

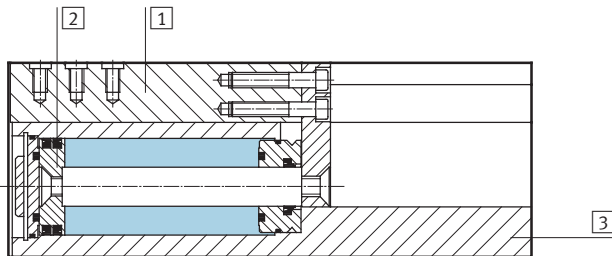

Parallel gripper		
1	Gripper jaw	Hardened steel, Citrocoated
2	Piston	High-alloy steel
3	Housing	Wrought aluminium alloy, coated with CompCote
-	Seals	Nitrile rubber, polyurethane
-	Note on materials	Free of copper, PTFE and silicone RoHS-compliant

Measured gripping force [N] at 6 bar (→ also see graphs starting on page 7)

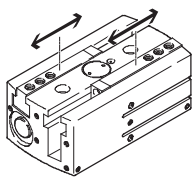

Size	14	25	40	63
Gripping force per gripper jaw				
Opening	63	206	519	1,233
Closing	79	256	608	1,371
Total gripping force				
Opening	126	412	1,038	2,466
Closing	158	512	1,216	2,742

## Characteristic load values at the gripper jaws

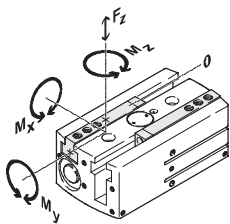

The indicated permissible forces and torques apply to a single gripper jaw. They include the lever arm, additional applied loads due to the workpiece or external gripper fingers and accelera-

tion forces occurring during movement. The zero coordinate line (guide groove of the gripper jaws) must be taken into consideration for the calculation of torques.

Size	14	25	40	63	
Max. permissible force $F_z$	[N]	500	1,500	2,500	9,000
Max. permissible torque $M_x$	[Nm]	35	100	125	300
Max. permissible torque $M_y$	[Nm]	35	60	80	200
Max. permissible torque $M_z$	[Nm]	35	70	100	250

# Parallel grippers HGPL, heavy-duty with long stroke

Technical data

FESTO

## Mass moment of inertia [kgm<sup>2</sup>x10<sup>-4</sup>]

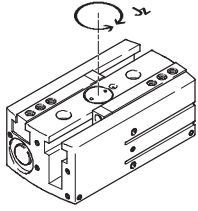

Mass moment of inertia of the parallel gripper in relation to the central axis, without external gripper fingers, without load.

Size		14	25	40	63
Stroke per gripper jaw	20 mm	1.40	11.98	27.60	–
	40 mm	6.69	18.88	66.83	–
	60 mm	11.43	39.95	118.30	470.07
	80 mm	21.93	78.70	198.87	–
	100 mm	–	–	318.25	1,018.17
	150 mm	–	–	–	2,247.54

## Opening and closing times [ms] at 6 bar

Without external gripper fingers

With external gripper fingers

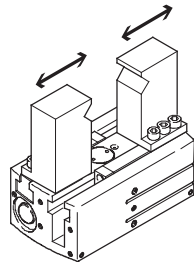
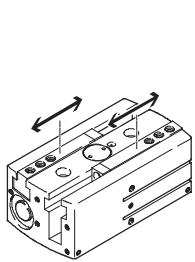

The indicated opening and closing times [ms] were measured at room temperature at an operating pressure of 6 bar with horizontally mounted grippers without additional gripper

fingers. The grippers must be throttled for greater applied loads. Opening and closing times must then be adjusted accordingly.

Size	14				25				40				63				
Stroke	mm	20	40	60	80	20	40	60	80	20	40	60	80	100	60	100	150
Without external gripper fingers																	
Opening times		120	171	270	286	170	225	370	423	190	238	430	414	620	410	650	1,020
Closing times		110	163	230	270	150	230	370	418	180	205	430	438	690	330	600	850
Max. permissible opening and closing times with external gripper fingers as a function of force due to weight																	
Force due to weight of the gripper fingers	1 N	123	108	257	243	–	–	–	–	–	–	–	–	–	–	–	–
	2 N	174	136	364	343	–	–	–	–	–	–	–	–	–	–	–	–
	3 N	213	167	445	420	164	210	405	401	–	–	–	–	–	–	–	–
	4 N	246	192	514	485	190	243	468	463	–	–	–	–	–	–	–	–
	5 N	–	–	–	–	212	272	523	518	196	260	469	478	676	–	–	–
	6 N	–	–	–	–	–	–	–	–	215	284	514	524	741	–	–	–
	7 N	–	–	–	–	–	–	–	–	232	307	555	565	800	–	–	–
	8 N	–	–	–	–	–	–	–	–	248	328	593	604	856	–	–	–
	9 N	–	–	–	–	–	–	–	–	–	–	–	–	–	323	587	832
	10 N	–	–	–	–	–	–	–	–	–	–	–	–	–	340	619	877
	11 N	–	–	–	–	–	–	–	–	–	–	–	–	–	357	649	919
	12 N	–	–	–	–	–	–	–	–	–	–	–	–	–	373	678	960

# Parallel grippers HGPL, heavy-duty with long stroke

Technical data

## Gripping force $F_h$ per gripper jaw as a function of operating pressure and lever arm $x$

The gripping forces as a function of operating pressure and lever arm can be determined from the following graphs.

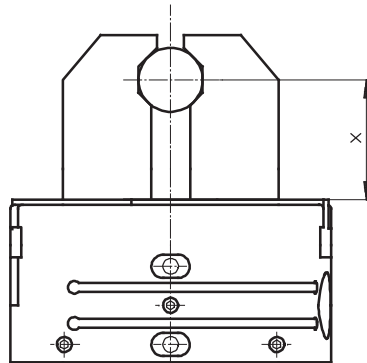

## Gripping force $F_h$ per gripper jaw as a function of operating pressure and lever arm $x$

### External gripping (closing)

HGPL-14

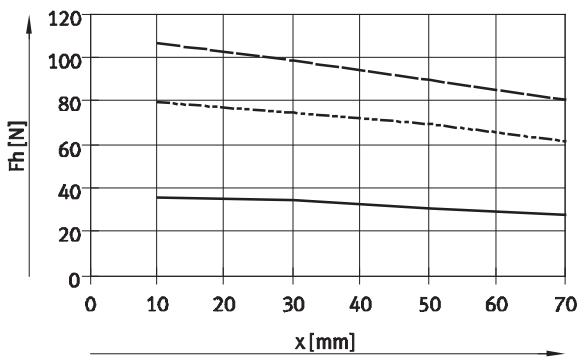

HGPL-25

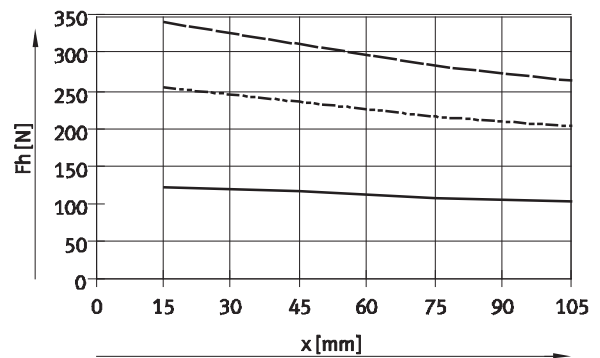

HGPL-40

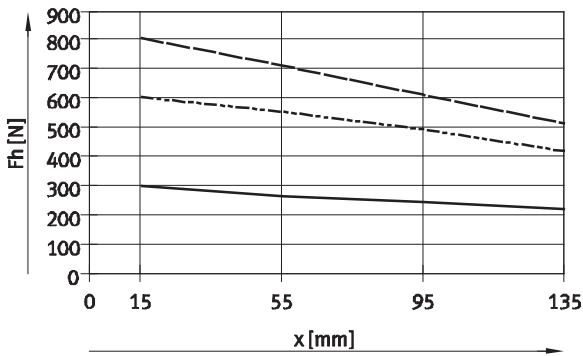

HGPL-63

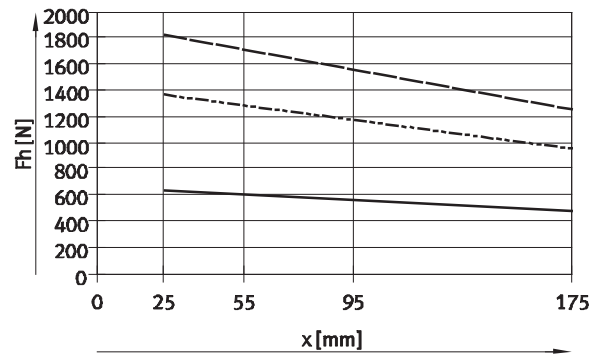

- 3 bar
- - - 6 bar
- 8 bar

# Parallel grippers HGPL, heavy-duty with long stroke

Technical data



Gripping force  $F_h$  per gripper jaw as a function of operating pressure and lever arm  $x$   
Internal gripping (opening)

HGPL-14

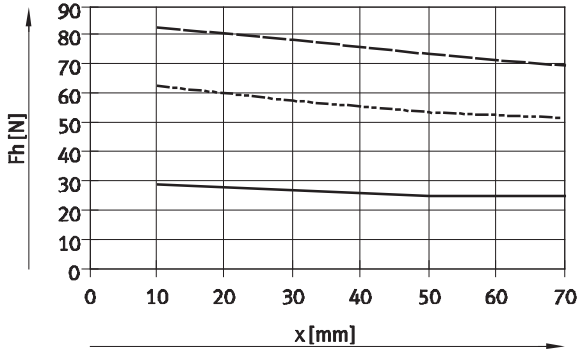

HGPL-25

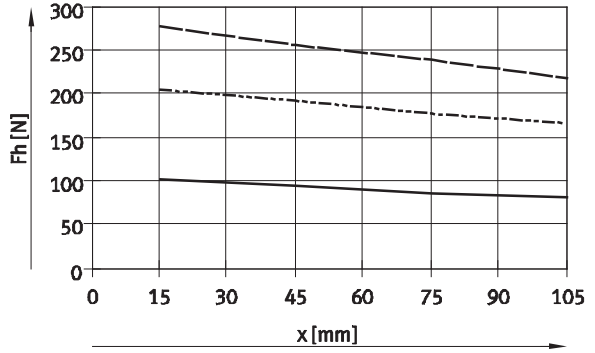

HGPL-40

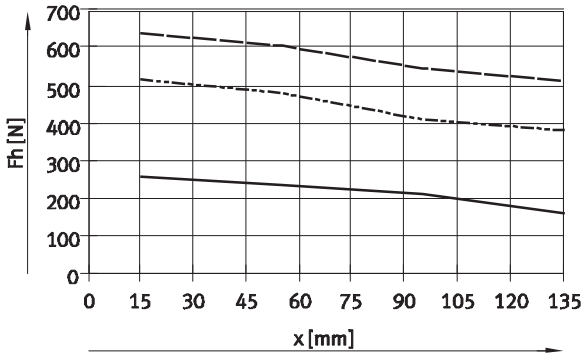

HGPL-63

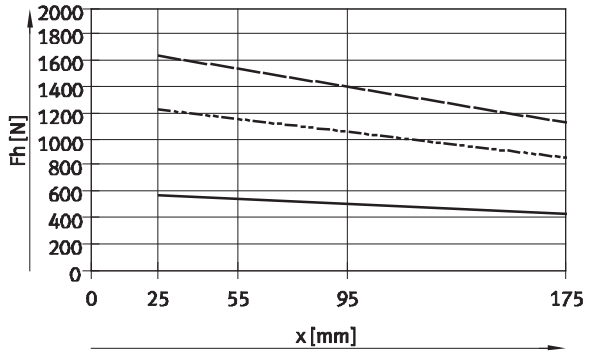

- 3 bar
- - - 6 bar
- · - 8 bar



# Parallel grippers HGPL, heavy-duty with long stroke

Technical data

## Gripping force $F_h$ per gripper jaw at 6 bar as a function of lever arm $x$ and eccentricity $a$ and $b$

The following formula must be used to calculate the lever arm  $x$  with eccentric gripping:

$$x = \sqrt{a^2 + b^2}$$

The gripping force  $F_h$  can be read from the graphs (→ 7) using the calculated value  $x$ .

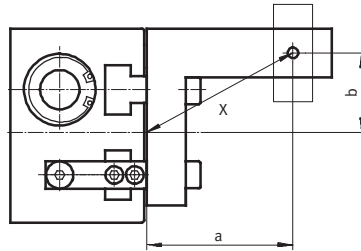

## Calculation example

Given:

Distance  $a = 45$  mm

Distance  $b = 40$  mm

To be calculated:

The gripping force at 6 bar, with an HGPL-25, used as an external gripper

Procedure:

Calculating the lever arm  $x$

$$x = \sqrt{45^2 + 40^2}$$

$x = 60$  mm

The graph (→ 7) shows a value of

$F_h = 225$  N for the gripping force.

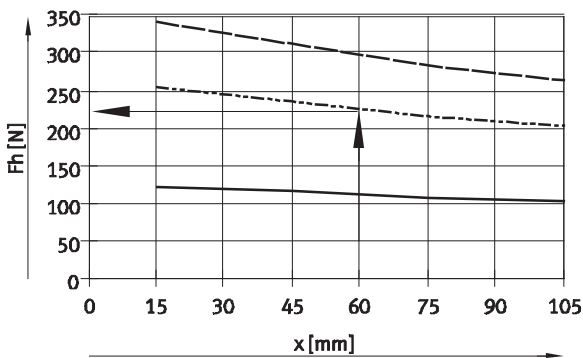

# Parallel grippers HGPL, heavy-duty with long stroke

Technical data

FESTO

Dimensions

Download CAD data → [www.festo.com](http://www.festo.com)

Size 40/63

Size 14/25

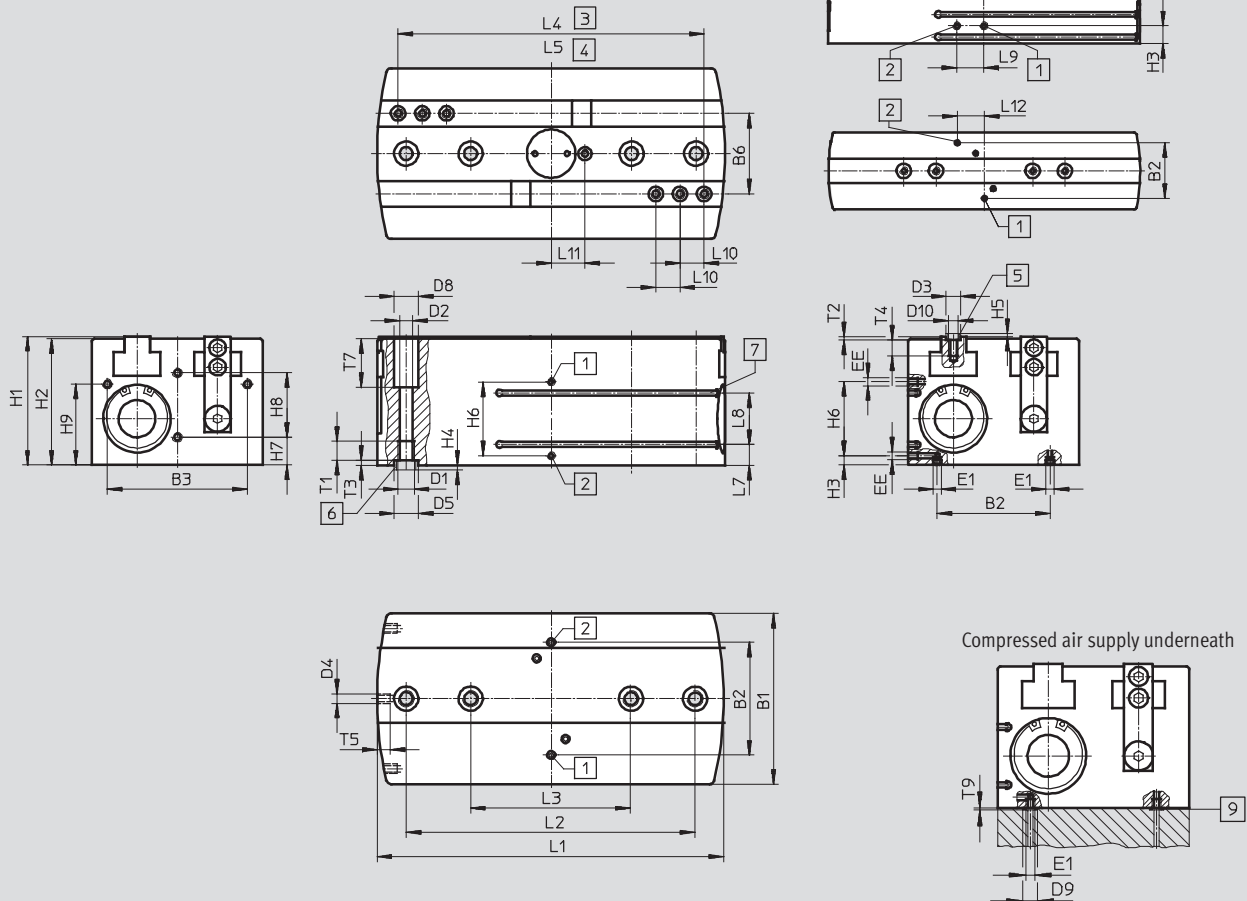

Compressed air supply underneath

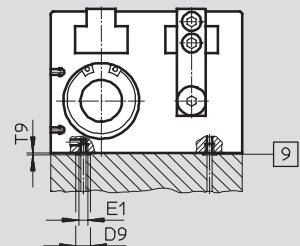

- |   |  |   |
|---|--|---|
| <p>1 Supply port, opening, either on the side or underneath (bottom connection sealed on delivery)</p> <p>2 Supply port, closing, either on the side or underneath (bottom connection sealed on delivery)</p> | <p>3 Gripper jaw open</p> <p>4 Gripper jaw closed</p> <p>5 Centring sleeves ZBH<br/>(4 included in the scope of delivery)</p> <p>6 Centring sleeves ZBH<br/>(2 included in the scope of delivery)</p> <p>7 Slot for proximity sensor</p> | <p>9 O-ring for parallel gripper<br/>HGPL-14: <math>\varnothing</math> 3x1.5<br/>HGPL-25: <math>\varnothing</math> 5x1.5<br/>HGPL-40: <math>\varnothing</math> 5x1.5<br/>HGPL-63: <math>\varnothing</math> 12x1.5</p> |
|---|--|---|

# Parallel grippers HGPL, heavy-duty with long stroke

Technical data

Type	B1 ±0.05	B2 ±0.1	B3 ±0.1	B6 ±0.01	D1	D2 ∅ +0.1	D3 ∅ H8/h7	D4	D5 ∅ H8/h7	D8 ∅ H13	D9	D10	EE	E1
HGPL-14	48	34.5	37	22	M5	4.2	5	M3	9	7.4	6	M3	M5	M3
HGPL-25	80	60	65	38	M6	5.1	7	M5	9	10	8	M5	M5	M5
HGPL-40	106	70	87	50	M10	8.5	9	M6	15	15	8	M6	M5	M5
HGPL-63	154	116	130	78	M12	10.4	15	M8	15	16.5	15	M10	G½	G½

Type	H1	H2 ±0.1	H3 ±0.1	H4 -0.3	H5 -0.3	H6 ±0.1	H7 ±0.1	H8 ±0.1	H9 ±0.1	L1 ±0.1	L2 ±0.02 <sup>1)</sup> ±0.1 <sup>2)</sup>	L3 ±0.02 <sup>1)</sup> ±0.1 <sup>2)</sup>	L4 ±0.5
HGPL-14-20	30	29	11	1.9	1.2	-	10	12	18	73.6	-	36	62
HGPL-14-40										113.6			
HGPL-14-60										153.6			
HGPL-14-80										193.6			
HGPL-25-20	50	49	18	1.9	1.4	-	18	20	30	86	-	60	64
HGPL-25-40										126			
HGPL-25-60										166			
HGPL-25-80										206			
HGPL-40-20	80	78.5	6	2.9	1.9	46	17.5	40	50.5	96	-	66	70
HGPL-40-40										136			
HGPL-40-60										176			
HGPL-40-80										216			
HGPL-40-100										256			
HGPL-63-60	121.5	120	14	2.9	2.9	60	30	58	74.8	190.8	-	100	160
HGPL-63-100										270.8			
HGPL-63-150										370.8			

Type	L5 ±0.5	L7 ±0.1	L8 ±0.1	L9 ±0.2	L10 ±0.02 <sup>1)</sup> ±0.1 <sup>2)</sup>	L11 ±0.5	L12 ±0.1	T1 min.	T2 +0.1	T3 +0.1	T4 min.	T5 min.	T7 +0.1	T9
HGPL-14-20	22	4	14	16.8	8	9	16.8	12.5	1.3	2.1	5.5	6.5	10	1
HGPL-14-40														
HGPL-14-60														
HGPL-14-80														
HGPL-25-20	24	11	14	20	10	17.5	20	12.5	1.6	2.1	8.5	7	17	1
HGPL-25-40														
HGPL-25-60														
HGPL-25-80														
HGPL-40-20	30	13	32	-	15	20.5	-	15.5	2.1	3.1	10.5	8	30	1
HGPL-40-40														
HGPL-40-60						21								
HGPL-40-80														
HGPL-40-100														
HGPL-63-60	40	28.5	30	-	22	29	-	18	3.1	3.1	17.5	8	45	1
HGPL-63-100														
HGPL-63-150														

1) For centring  
2) For through-hole

# Parallel grippers HGPL, heavy-duty with long stroke

FESTO

Technical data

Ordering data			
Size [mm]	Stroke [mm]	Double-acting without compression spring	
		Part No.	Type
<b>14</b>			
	20	567820	HGPL-14-20-A
	40	535852	HGPL-14-40-A
	60	567821	HGPL-14-60-A
	80	535853	HGPL-14-80-A
<b>25</b>			
	20	567822	HGPL-25-20-A
	40	535854	HGPL-25-40-A
	60	567823	HGPL-25-60-A
	80	535855	HGPL-25-80-A
<b>40</b>			
	20	567824	HGPL-40-20-A
	40	535856	HGPL-40-40-A
	60	567825	HGPL-40-60-A
	80	535857	HGPL-40-80-A
	100	567826	HGPL-40-100-A
<b>63</b>			
	60	567827	HGPL-63-60-A
	100	567828	HGPL-63-100-A
	150	567829	HGPL-63-150-A

Ordering data – Sets of wearing parts			
Size [mm]	Part No.	Type	
14	701585	HGPL-14-A	
25	701586	HGPL-25-A	
40	701587	HGPL-40-A	
63	752917	HGPL-63-A	

# Parallel grippers HGPL, heavy-duty with long stroke

Accessories

**Adapter kit**  
HAPG, HMSV, HMVA, DHAA

Material:  
Wrought aluminium alloy  
Free of copper and PTFE  
RoHS-compliant

 Note  
The kit includes the individual mounting interface as well as the necessary mounting material.

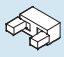
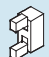
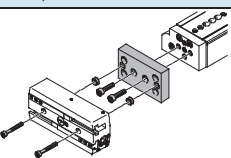
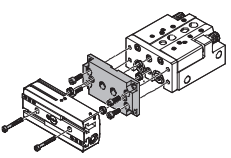
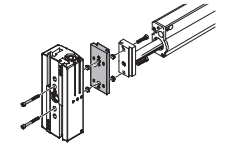
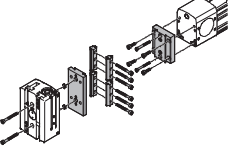
Permissible drive/gripper combinations with adapter kit						Download CAD data → <a href="http://www.festo.com">www.festo.com</a>	
Combination	Drive	Gripper	Mounting option		Adapter kit		
					CRC <sup>1)</sup>	Part No.	Type
<b>DGSL/HGPL</b>	DGSL	HGPL			HAPG		
	16	14-40, 14-60, 14-80	■	■	2	538055	HAPG-89
	20, 25	14-40, 14-60, 14-80	■	■		539274	HAPG-90
	25	25	■	■		539274	HAPG-90
<b>SLT/HGPL</b>	SLT	HGPL			HAPG		
	16	14-40, 14-60, 14-80	■	–	2	538055	HAPG-89
	20, 25	14-40, 14-60, 14-80	■	–		539274	HAPG-90
	25	25	■	–		539274	HAPG-90
<b>HMP/HGPL</b>	HMP	HGPL			HAPG		
	16, 20	14-40/14-60/14-80	–	■	2	–	2x M5x25 DIN 912
	20, 25	25	–	■		539887	HAPG-92
	25, 32	40-40, 40-60, 40-80, 40-100	–	■		537312	HAPG-SD2-30
<b>DGP..., DGE..., DGEA/HGPL</b>	DG...	HGPL			HAPG, HMSV, HMVA		
	40	25	■	■	2	196790	HMVA-DLA40
						177653	HMSV-7
						539887	HAPG-92

1) Corrosion resistance class 2 according to Festo standard 940 070  
Components subject to moderate corrosion stress. Externally visible parts with primarily decorative surface requirements which are in direct contact with a normal industrial environment or media such as coolants or lubricating agents.

# Parallel grippers HGPL, heavy-duty with long stroke

Accessories



**Adapter kit**  
HAPG, HMSV, HMVA, DHAA

Material:  
Wrought aluminium alloy  
Free of copper and PTFE  
RoHS-compliant

 Note  
The kit includes the individual mounting interface as well as the necessary mounting material.

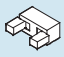
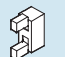
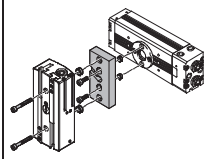
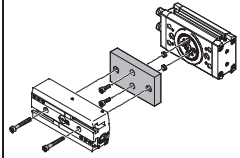
Permissible drive/gripper combinations with adapter kit						Download CAD data → <a href="http://www.festo.com">www.festo.com</a>	
Combination	Drive Size	Gripper Size	Mounting option		Adapter kit		
					CRC <sup>1)</sup>	Part No.	Type
<b>DRQD/HGPL</b>							
	DRQD-...	HGPL			HAPG		
	16, 20	14-40, 14-60, 14-80	■	■	2	537310	HAPG-SD2-31
	25, 32	25	■	■		537311	HAPG-SD2-29
	40, 50	40-40, 40-60, 40-80, 40-100	■	■		537312	HAPG-SD2-30
	DRQD-E422	HGPL			HAPG		
	16, 20	14-40, 14-60, 14-80	■	■	2	544644	HAPG-SD2-45
DRQD-E444	HGPL			HAPG			
25, 32	25	■	■	2	544645	HAPG-SD2-46	
<b>DRRD/HGPL</b>							
	DRRD	HGPL			DHAA		
	16	14-20	■	■	2	2019271	DHAA-G-Q11-16-B6-14-20
	16	14-40	■	■		2019618	DHAA-G-Q11-16-B6-14-40
	16	14-60, 14-80	■	■		2019640	DHAA-G-Q11-16-B6-14-60/80
	20	14-20	■	■		2018509	DHAA-G-Q11-20-B6-14-20
	20	14-40	■	■		2018553	DHAA-G-Q11-20-B6-14-40
	20	14-60, 14-80	■	■		2018986	DHAA-G-Q11-20-B6-14-60/80
	25	14-20	■	■		1813646	DHAA-G-Q11-25-B6-14-20
	25	14-40	■	■		1734087	DHAA-G-Q11-25-B6-14-40
	25	14-60, 14-80	■	■		2018453	DHAA-G-Q11-25-B6-14-60/80
	25	25-20, 25-40	■	■		1794882	DHAA-G-Q11-25-B6-25-20/40
	25	25-60, 25-80	■	■		2020149	DHAA-G-Q11-25-B6-25-60/80
	32	25-20, 25-40	■	■		2021733	DHAA-G-Q11-32-B6-25-20/40
	32	25-60, 25-80	■	■		2022377	DHAA-G-Q11-32-B6-25-60/80
	35	25-20, 25-40	■	■		2022892	DHAA-G-Q11-35-B6-25-20/40
	35	25-60, 25-80	■	■		2023095	DHAA-G-Q11-35-B6-25-60/80
	35, 40	40-20	■	■		2023665	DHAA-G-Q11-35/40-B6-40-20
	35, 40	40-40, 40-60	■	■		2024121	DHAA-G-Q11-35/40-B6-40-40/60
35, 40	40-80, 40-100	■	■	2024947		DHAA-G-Q11-35/40-B6-40-80/100	

1) Corrosion resistance class 2 according to Festo standard 940 070  
Components subject to moderate corrosion stress. Externally visible parts with primarily decorative surface requirements which are in direct contact with a normal industrial environment or media such as coolants or lubricating agents.



# Parallel grippers HGPL, heavy-duty with long stroke

Accessories

**Adapter kit**  
HAPG, HMSV, HMVA, DHAA

Material:  
Wrought aluminium alloy  
Free of copper and PTFE  
RoHS-compliant

 Note  
The kit includes the individual mounting interface as well as the necessary mounting material.

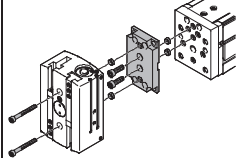
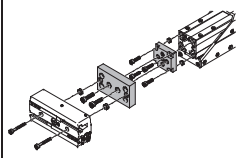
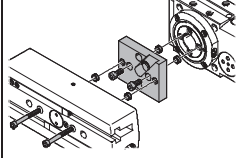
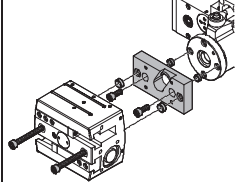
Permissible drive/gripper combinations with adapter kit						Download CAD data → <a href="http://www.festo.com">www.festo.com</a>	
Combination	Drive	Gripper	Mounting option		Adapter kit		
					CRC <sup>1)</sup>	Part No. Type	
	EGSL	HGPL			HAPG		
	45, 55	14-40, 14-60, 14-80	■	■	2	538055 HAPG-89	
	75	14-40, 14-60, 14-80	■	■		539274 HAPG-90	
	75	25	■	■		539274 HAPG-90	
	EGSA	HGPL			HAPG, HMSV		
	50	14-40, 14-60, 14-80	■	■	2	560017 HMSV-61	
	60	14-40, 14-60, 14-80	■	■		538055 HAPG-89	
						560018 HMSV-62	
				539274 HAPG-90			
	ERMB	HGPL			HAPG		
	20	14-40, 14-60, 14-80	■	■	2	537310 HAPG-SD2-31	
	25, 32	25	■	■		537311 HAPG-SD2-29	
	EHMB	HGPL			HAPG		
	20	25	■	■	2	537311 HAPG-SD2-29	
	25	40-40, 40-60, 40-80, 40-100	■	■		537312 HAPG-SD2-30	

1) Corrosion resistance class 2 according to Festo standard 940 070  
Components subject to moderate corrosion stress. Externally visible parts with primarily decorative surface requirements which are in direct contact with a normal industrial environment or media such as coolants or lubricating agents.

# Parallel grippers HGPL, heavy-duty with long stroke

Accessories

## Stroke reducing kit HGPL-HR

Material:  
Aluminium  
Free of copper, PTFE and silicone

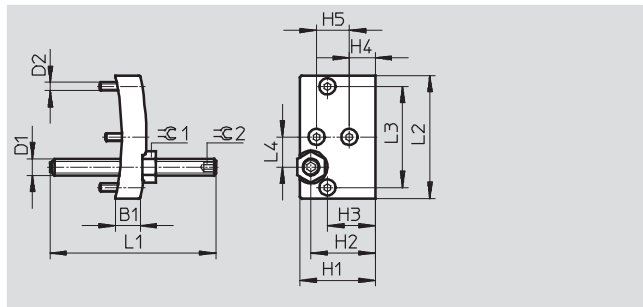

Dimensions and ordering data								
For size	B1	D1	D2	H1	H2	H3	H4	H5
[mm]	±0.1			±0.1	±0.1	±0.1	±0.1	±0.1
14	9	M6	M3	27.5	23.5	17.5	9.5	12
25	12	M8	M5	47.5	37.5	29.5	17.5	20
40	18	M12	M6	77	63	50	17	40
63	19	M14	M8	118.5	94.5	74.5	29.5	58

For size	L1	L2	L3	L4	≈C1	≈C2	Weight	Part No.	Type
[mm]	±1	±0.1	±0.1	±0.1			[g]		
14	61	45	37	11	10	3	45	539092	HGPL-HR-14
25	61	77	65	19	13	4	150	539093	HGPL-HR-25
40	61	103	87	25	19	6	455	539094	HGPL-HR-40
63	81	151	130	39	22	6	1,060	567831	HGPL-HR-63



# Parallel grippers HGPL, heavy-duty with long stroke



Accessories

**Gripper jaw blank BUB-HGPL**  
(scope of delivery: 2 pieces)

Material:  
Aluminium  
Free of copper, PTFE and silicone

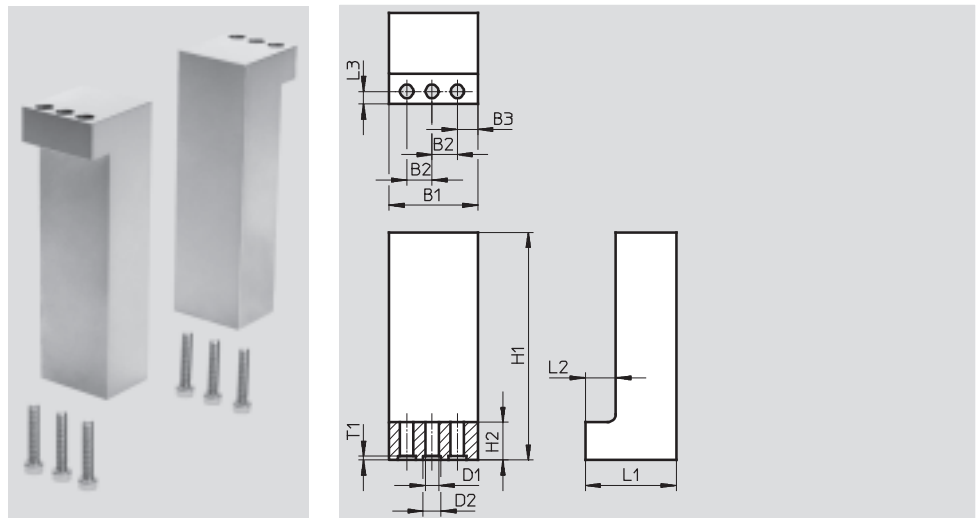

Dimensions and ordering data							
For size	B1	B2	B3	D1	D2	H1	H2
[mm]	±0.1	+0.02		∅ +0.1	∅ H8	±0.1	
14	25	8	4	3.2	5	80	11
25	35	10	8	5.3	7	120	15
40	50	15	10	6.4	9	150	18
63	68	22	12	10.5	15	200	20

For size	L1	L2	L3	T1	Weight per blank [g]	Part No.	Type
[mm]	±0.1	+0.1	+0.1	+0.1			
14	20.5	8	3.3	1.3	75	537316	BUB-HGPL-14
25	36	12	5	1.6	295	537317	BUB-HGPL-25
40	49.5	16.5	8	2.1	720	537318	BUB-HGPL-40
63	77	27	12	3.1	1,960	567830	BUB-HGPL-63

Ordering data				Technical data → <a href="http://www.festo.com">www.festo.com</a>		
	For size [mm]	Weight [g]	Part No.	Type	PU <sup>1)</sup>	
Centring sleeve for the gripper jaws ZBH				Technical data → <a href="http://Internet: zbh">Internet: zbh</a>		
	14	1	189652	ZBH-5	10	
	25	1	186717	ZBH-7		
	40	1	150927	ZBH-9		
	63	3	191409	ZBH-15		
Centring sleeve for the gripper ZBH				Technical data → <a href="http://Internet: zbh">Internet: zbh</a>		
	14, 25	1	150927	ZBH-9	10	
	40, 63	3	191409	ZBH-15		
Blanking plug B				Technical data → <a href="http://Internet: blanking plug">Internet: blanking plug</a>		
	14, 25, 40	2	174308	B-M5-B	10	
	63	5	3568	B-1/8		

1) Packaging unit

# Parallel grippers HGPL, heavy-duty with long stroke

Accessories

FESTO

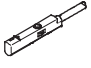
Proximity sensors for size 14 ... 40						
Ordering data – Proximity sensors for C-slot, magneto-resistive						Technical data → Internet: smt
	Type of mounting	Electrical connection, connection direction	Switching output	Cable length [m]	Part No.	Type
N/O contact						
	Insertable in the slot from above	Cable, 3-wire, in-line	PNP	2.5	551373	SMT-10M-PS-24V-E-2,5-L-OE
		Plug M8x1, 3-pin, in-line		0.3	551375	SMT-10M-PS-24V-E-0,3-L-M8D
		Cable, 3-wire, lateral	PNP	2.5	551374	SMT-10M-PS-24V-E-2,5-Q-OE
		Plug M8x1, 3-pin, lateral		0.3	551376	SMT-10M-PS-24V-E-0,3-Q-M8D

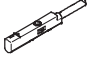
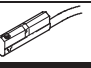
Ordering data – Proximity sensors for C-slot, magnetic reed						
Ordering data – Proximity sensors for C-slot, magnetic reed						Technical data → Internet: sme
	Type of mounting	Electrical connection, connection direction	Switching output	Cable length [m]	Part No.	Type
N/O contact						
	Insertable in the slot from above	Cable, 3-wire, in-line	Contacting	2.5	551365	SME-10M-DS-24V-E-2,5-L-OE
		Plug M8x1, 3-pin, in-line		0.3	551367	SME-10M-DS-24V-E-0,3-L-M8D
		Cable, 3-wire, lateral		2.5	551366	SME-10M-DS-24V-E-2,5-Q-OE
		Plug M8x1, 3-pin, lateral		0.3	551368	SME-10M-DS-24V-E-0,3-Q-M8D
	Insertable in the slot lengthwise	Cable, 3-wire, in-line	Contacting	2.5	173210	SME-10-KL-LED-24
		Plug M8x1, 3-pin, in-line		0.3	173212	SME-10-SL-LED-24

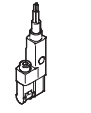

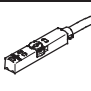
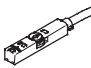
Ordering data – Proximity sensors for C-slot, magneto-resistive						
Ordering data – Proximity sensors for C-slot, magneto-resistive						Technical data → Internet: smt
	Type of mounting	Electrical connection, connection direction	Switching output	Cable length [m]	Part No.	Type
N/O contact						
	Insertable in the slot lengthwise	Cable, 3-wire, lateral	PNP	2.5	547862	SMT-10G-PS-24V-E-2,5Q-OE
		Plug M8x1, 3-pin, lateral		0.3	547863	SMT-10G-PS-24V-E-0,3Q-M8D

Proximity sensors for size 63						
Ordering data – Proximity sensors for T-slot, magneto-resistive						Technical data → Internet: smt
	Type of mounting	Electrical connection, connection direction	Switching output	Cable length [m]	Part No.	Type
N/O contact						
	Insertable in the slot from above, short design	Cable, 3-wire, in-line	PNP	2.5	574335	SMT-8M-A-PS-24V-E-2,5-OE
		Plug M8x1, 3-pin, in-line		0.3	574334	SMT-8M-A-PS-24V-E-0,3-M8D
		Plug M12x1, 3-pin, in-line		0.3	574337	SMT-8M-A-PS-24V-E-0,3-M12
		Cable, 3-wire, in-line	NPN	2.5	574338	SMT-8M-A-NS-24V-E-2,5-OE
		Plug M8x1, 3-pin, in-line		0.3	574339	SMT-8M-A-NS-24V-E-0,3-M8D
N/C contact						
	Insertable in the slot from above, short design	Cable, 3-wire, in-line	PNP	7.5	574340	SMT-8M-A-PO-24V-E-7,5-OE

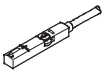
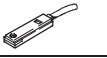

# Parallel grippers HGPL, heavy-duty with long stroke

Accessories

FESTO

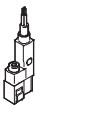
Proximity sensors for size 63						
Ordering data – Proximity sensors for T-slot, magnetic reed						Technical data → Internet: sme
	Type of mounting	Electrical connection, connection direction	Switching output	Cable length [m]	Part No.	Type
<b>N/O contact</b>						
	Insertable in the slot from above	Cable, 3-wire, in-line	Contacting	2.5	543862	SME-8M-DS-24V-K-2,5-OE
		Cable, 2-wire, in-line		5.0	543863	SME-8M-DS-24V-K-5,0-OE
	Plug M8x1, 3-pin, in-line	2.5		543872	SME-8M-ZS-24V-K-2,5-OE	
		0.3		543861	SME-8M-DS-24V-K-0,3-M8D	
	Insertable in the slot lengthwise	Cable, 3-wire, in-line	2.5	150855	SME-8-K-LED-24	
		Plug M8x1, 3-pin, in-line	0.3	150857	SME-8-S-LED-24	
<b>N/C contact</b>						
	Insertable in the slot lengthwise	Cable, 3-wire, in-line	Contacting	7.5	160251	SME-8-O-K-LED-24

Ordering data – Proximity sensors for T-slot, magneto-resistive						Technical data → Internet: smt
	Type of mounting	Electrical connection, connection direction	Switching output	Cable length [m]	Part No.	Type
<b>N/O contact</b>						
	Insertable in the slot lengthwise	Cable, 3-wire, lateral	PNP	2.5	547859	SMT-8G-PS-24V-E-2,5Q-OE
		Plug M8x1, 3-pin, lateral		0.3	547860	SMT-8G-PS-24V-E-0,3Q-M8D

Ordering data – Connecting cables					Technical data → Internet: nebu
	Electrical connection, left	Electrical connection, right	Cable length [m]	Part No.	Type
	Straight socket, M8x1, 3-pin	Cable, open end, 3-wire	2.5	541333	NEBU-M8G3-K-2.5-LE3
			5	541334	NEBU-M8G3-K-5-LE3
	Straight socket, M12x1, 5-pin	Cable, open end, 3-wire	2.5	541363	NEBU-M12G5-K-2.5-LE3
			5	541364	NEBU-M12G5-K-5-LE3
	Angled socket, M8x1, 3-pin	Cable, open end, 3-wire	2.5	541338	NEBU-M8W3-K-2.5-LE3
			5	541341	NEBU-M8W3-K-5-LE3
	Angled socket, M12x1, 5-pin	Cable, open end, 3-wire	2.5	541367	NEBU-M12W5-K-2.5-LE3
			5	541370	NEBU-M12W5-K-5-LE3

# Product Range and Company Overview

## A Complete Suite of Automation Services

Our experienced engineers provide complete support at every stage of your development process, including: conceptualization, analysis, engineering, design, assembly, documentation, validation, and production.



**Custom Automation Components**  
Complete custom engineered solutions



**Custom Control Cabinets**  
Comprehensive engineering support and on-site services



**Complete Systems**  
Shipment, stocking and storage services

## The Broadest Range of Automation Components

With a comprehensive line of more than 30,000 automation components, Festo is capable of solving the most complex automation requirements.



**Electromechanical**  
Electromechanical actuators, motors, controllers & drives



**Pneumatics**  
Pneumatic linear and rotary actuators, valves, and air supply



**PLCs and I/O Devices**  
PLC's, operator interfaces, sensors and I/O devices

## Supporting Advanced Automation... As No One Else Can!

Festo is a leading global manufacturer of pneumatic and electromechanical systems, components and controls for industrial automation, with more than 12,000 employees in 56 national headquarters serving more than 180 countries. For more than 80 years, Festo has continuously elevated the state of manufacturing with innovations and optimized motion control solutions that deliver higher performing, more profitable automated manufacturing and processing equipment. Our dedication to the advancement of automation extends beyond technology to the education and development of current and future automation and robotics designers with simulation tools, teaching programs, and on-site services.

## Quality Assurance, ISO 9001 and ISO 14001 Certifications

Festo Corporation is committed to supply all Festo products and services that will meet or exceed our customers' requirements in product quality, delivery, customer service and satisfaction.

To meet this commitment, we strive to ensure a consistent, integrated, and systematic approach to management that will meet or exceed the requirements of the ISO 9001 standard for Quality Management and the ISO 14001 standard for Environmental Management.



© Copyright 2008, Festo Corporation. While every effort is made to ensure that all dimensions and specifications are correct, Festo cannot guarantee that publications are completely free of any error, in particular typing or printing errors. Accordingly, Festo cannot be held responsible for the same. For Liability and Warranty conditions, refer to our "Terms and Conditions of Sale", available from your local Festo office. All rights reserved. No part of this publication may be reproduced, distributed, or transmitted in any form or by any means, electronic, mechanical, photocopying or otherwise, without the prior written permission of Festo. All technical data subject to change according to technical update.



Printed on recycled paper at New Horizon Graphic, Inc., FSC certified as an environmentally friendly printing plant.

# Festo North America

## Festo Regional Contact Center

5300 Explorer Drive  
Mississauga, Ontario L4W 5G4  
Canada

### USA Customers:

For ordering assistance,

**Call:** 1.800.99.FESTO (1.800.993.3786)

**Fax:** 1.800.96.FESTO (1.800.963.3786)

**Email:** [customer.service@us.festo.com](mailto:customer.service@us.festo.com)

For technical support,

**Call:** 1.866.GO.FESTO (1.866.463.3786)

**Fax:** 1.800.96.FESTO (1.800.963.3786)

**Email:** [product.support@us.festo.com](mailto:product.support@us.festo.com)

### Canadian Customers:

**Call:** 1.877.GO.FESTO (1.877.463.3786)

**Fax:** 1.877.FX.FESTO (1.877.393.3786)

**Email:** [festo.canada@ca.festo.com](mailto:festo.canada@ca.festo.com)

---

## USA Headquarters

Festo Corporation  
395 Moreland Road  
P.O. Box 18023  
Hauppauge, NY 11788, USA  
[www.festo.com/us](http://www.festo.com/us)

---

## USA Sales Offices

### Appleton

North 922 Tower View Drive, Suite N  
Greenville, WI 54942, USA

### Boston

120 Presidential Way, Suite 330  
Woburn, MA 01801, USA

### Chicago

1441 East Business Center Drive  
Mt. Prospect, IL 60056, USA

### Dallas

1825 Lakeway Drive, Suite 600  
Lewisville, TX 75057, USA

### Detroit – Automotive Engineering Center

2601 Cambridge Court, Suite 320  
Auburn Hills, MI 48326, USA

### New York

395 Moreland Road  
Hauppauge, NY 11788, USA

### Silicon Valley

4935 Southfront Road, Suite F  
Livermore, CA 94550, USA

## United States



**USA Headquarters, East:** Festo Corp., 395 Moreland Road, Hauppauge, NY 11788

Phone: 1.631.435.0800; Fax: 1.631.435.8026;

Email: [info@festo-usa.com](mailto:info@festo-usa.com)

[www.festo.com/us](http://www.festo.com/us)

## Canada



**Headquarters:** Festo Inc., 5300 Explorer Drive, Mississauga, Ontario L4W 5G4

Phone: 1.905.624.9000; Fax: 1.905.624.9001;

Email: [festo.canada@ca.festo.com](mailto:festo.canada@ca.festo.com)

[www.festo.ca](http://www.festo.ca)

## Mexico



**Headquarters:** Festo Pneumatic, S.A., Av. Ceylán 3, Col. Tequesquahuac,  
54020 Tlalneantla, Edo. de México

Phone: 011 52 [55] 53 21 66 00; Fax: 011 52 [55] 53 21 66 65;

Email: [festo.mexico@mx.festo.com](mailto:festo.mexico@mx.festo.com)

[www.festo.com/mx](http://www.festo.com/mx)

---

## Central USA

Festo Corporation  
1441 East Business  
Center Drive  
Mt. Prospect, IL 60056, USA  
Phone: 1.847.759.2600  
Fax: 1.847.768.9480



## Western USA

Festo Corporation  
4935 Southfront Road,  
Suite F  
Livermore, CA 94550, USA  
Phone: 1.925.371.1099  
Fax: 1.925.245.1286



---

## Festo Worldwide

Argentina Australia Austria Belarus Belgium Brazil Bulgaria Canada Chile China Colombia Croatia Czech Republic Denmark  
Estonia Finland France Germany Great Britain Greece Hong Kong Hungary India Indonesia Iran Ireland Israel Italy Japan Latvia  
Lithuania Malaysia Mexico Netherlands New Zealand Norway Peru Philippines Poland Romania Russia Serbia Singapore  
Slovakia Slovenia South Africa South Korea Spain Sweden Switzerland Taiwan Thailand Turkey Ukraine United States Venezuela

[www.festo.com](http://www.festo.com)