

Parallel grippers HGPC



Parallel grippers HGPC

Key features

At a glance

General

The compact and low-cost parallel gripper consists of a two-part symmetrical housing. The piston moves traverse to the half-shell casing in an optimum housing design that

guarantees reliable operation, long service life and convenient sensing. The gripper jaws move along the half shells in backlash-free, preloaded ball bearing guides.

- Double-acting gripper
- Compression spring for supplementary or retaining gripping forces
- Internal fixed flow control, does away with the need for external flow control in 80% of applications
- High force with minimal volume
- Suitable for external and internal gripping
- Wide range of options for attaching drive units
- Repetition accuracy of 0.05 mm
- Slot for proximity sensor SME/SMT-10

-  - Note

Sizing software
Gripper selection
→ www.festo.com

Details

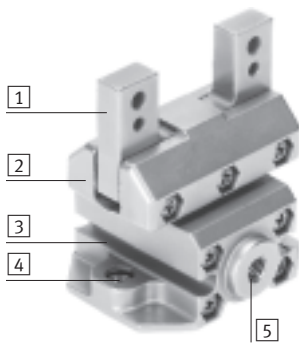

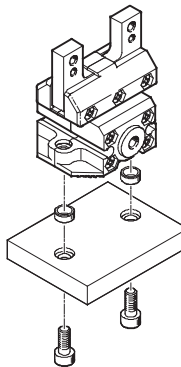

- 1 Gripper jaw with ball bearing guide
- 2 Housing based on half-shell principle
- 3 Slot for proximity sensor, for sensing the piston position
- 4 Mounting option
- 5 Supply port

Mounting option

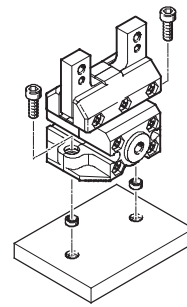

from above



-  - Note

Parallel grippers are not designed for the following applications:

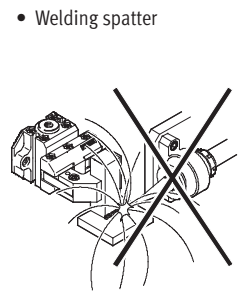
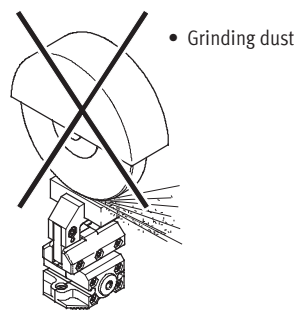
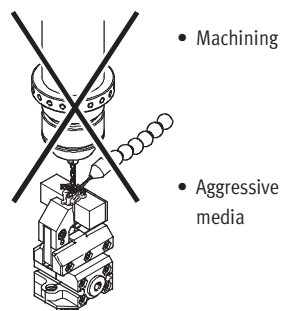

Parallel grippers HGPC

Peripherals overview and type codes

Peripherals overview

System product for handling and assembly technology

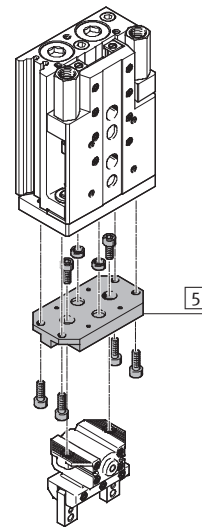
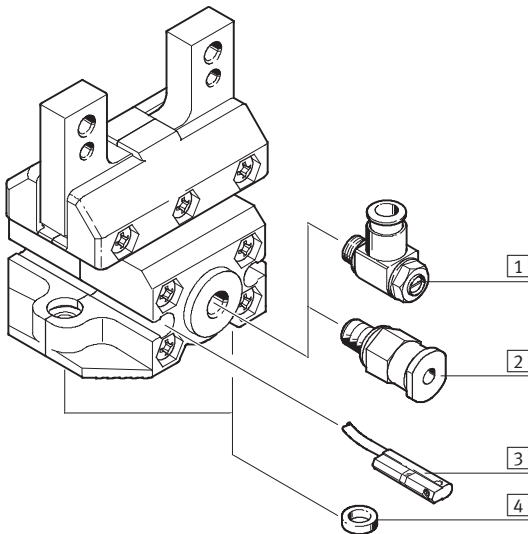

Accessories			
Type		Brief description	→ Page/Internet
1	One-way flow control valve GRLA	For regulating speed	gria
2	Push-in fitting QS	For connecting compressed air tubing with standard O.D.	quick star
3	Proximity sensor SME/SMT-10	For sensing the piston position	14
4	Centring sleeve ZBH	For centring when attaching to a drive (2 included in the scope of delivery)	14
5	Adapter kit HMSV, HAPG	Drive/gripper connections	12

Type codes

		HGPC	–	12	–	A	–	G2
Type								
HGPC	Parallel gripper							
Size								
Position sensing								
A	Via proximity sensor							
Gripping force backup								
G2	Closing							

Parallel grippers HGPC

Technical data

FESTO

Function -N- Size
 Double-acting 12, 16, 20 mm
 HGPC-...-A -T- Stroke
 6 ... 14 mm

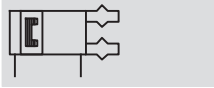

Single-acting or
 with gripping force retention
 closing HGPC-...-G2



General technical data				
Size	12	16	20	
Constructional design	Wedge-shaped drive Guided motion sequence			
Mode of operation	Double-acting			
Gripper function	Parallel			
Number of gripper jaws	2			
Max. weight force per external gripper finger ¹⁾	[N]	0.2	0.5	0.8
Stroke per gripper jaw	[mm]	3	5	7
Pneumatic connection	M5			
Repetition accuracy ²⁾	[mm]	≤ 0.05		
Max. interchangeability	[mm]	≤ 0.2		
Max. gripper jaw backlash ³⁾	[mm]	0		
Max. gripper jaw angular backlash ⁴⁾	[°]	0		
Max. operating frequency	[Hz]	4		
Rotational symmetry	[mm]	< Ø 0.2		
Position sensing	For proximity sensing			
Type of mounting	With female thread and centring sleeve			
Mounting position	Any			

- 1) Valid for unthrottled operation
- 2) End-position drift under constant conditions of use with 100 consecutive strokes in the direction of movement of the gripper jaws
- 3) Perpendicular to the direction of motion of the gripper jaws
- 4) Pretensioned, backlash-free ball bearing guide

Operating and environmental conditions			
Min. operating pressure	HGPC-...-A	[bar]	2
	HGPC-...-G2	[bar]	4
Max. operating pressure	[bar]	8	
Operating medium	Compressed air in accordance with ISO 8573-1:2010 [7:4:4]		
Note on operating/pilot medium	Operation with lubricated medium possible (in which case lubricated operation will always be required)		
Ambient temperature ¹⁾	[°C]	+5 ... +60	
Corrosion resistance class CRC ²⁾	2		

- 1) Note operating range of proximity sensors
- 2) Corrosion resistance class 2 according to Festo standard 940 070
 Components requiring moderate corrosion resistance. Externally visible parts with primarily decorative surface requirements which are in direct contact with a normal industrial environment or media such as coolants or lubricating agents

Weights [g]			
Size	12	16	20
HGPC-...-A	152	241	473
HGPC-...-G2	154	244	477

Parallel grippers HGPC

Technical data

Materials

Sectional view

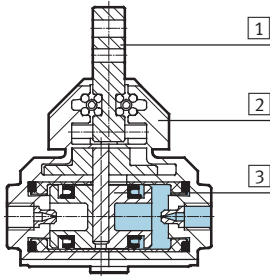

Parallel gripper		
1	Gripper jaw	High-alloy steel
2	Housing	Die-cast zinc
3	Piston	Polyamide
-	Seals	Polyurethane, nitrile rubber
-	Note on materials	Copper, PTFE and silicone-free Conforms to RoHS

Gripping force [N] at 6 bar

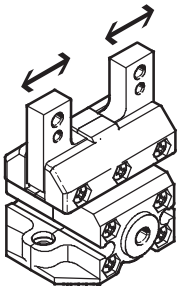

Size	12	16	20
Gripping force per gripper jaw			
Opening	22	41.5	63
Closing	22	41.5	63
Total gripping force			
Opening	44	83	126
Closing	44	83	126

Static characteristic load values at the gripper jaws

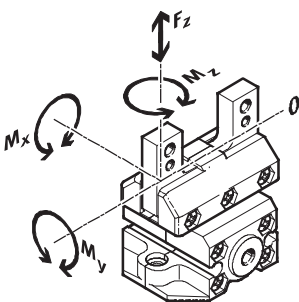

Indicated permissible forces and torques apply to a single gripper jaw. The indicated values include the lever arm, additional applied loads caused by the workpiece or external gripper fingers, as well as forces which occur

during movement. The zero coordinate line (gripper finger guide) must be taken into consideration for the calculation of torques.

Size	12	16	20	
Max. permissible force F_z	[N]	40	80	120
Max. permissible torque M_x	[Nm]	1	2,5	5
Max. permissible torque M_y	[Nm]	1	2,5	5
Max. permissible torque M_z	[Nm]	1	2,5	5

Parallel grippers HGPC

Technical data

Mass moment of inertia [kgm²x10⁻⁴]

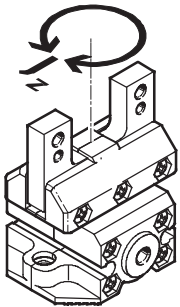

Mass moment of inertia [kgm²x10⁻⁴] of the parallel gripper in relation to the central axis with no load.

Size	12	16	20
HGPC-...-A	0.272	0.679	2.095
HGPC-...-G2	0.274	0.683	2.105

Opening and closing times [ms] at 6 bar

without external gripper fingers

with external gripper fingers

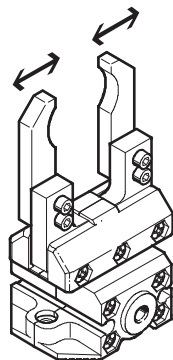
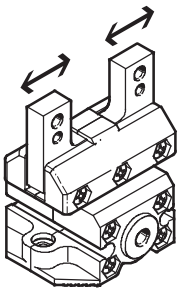

The indicated opening and closing times [ms] have been measured at room temperature and at 6 bar operating pressure with horizontally mounted gripper without additional

gripper fingers. The grippers must be throttled for greater applied loads. Opening and closing times must then be adjusted correspondingly.

Size		12	16	20
without external gripper fingers				
HGPC-...-A	Opening	30	60	90
	Closing	30	60	90
HGPC-...-G2	Opening	30	70	105
	Closing	30	50	75
with external gripper fingers as a function of weight force				
HGPC-...	0.4 N	40	-	-
	0.5 N	60	-	-
	0.6 N	80	-	-
	0.7 N	-	80	-
	1.0 N	-	100	-
	1.2 N	-	-	100

Parallel grippers HGPC

Technical data

Gripping force F_{Grip} per gripper jaw as a function of operating pressure and lever arm x

Gripping forces as a function of the operating pressure and the lever arm can be determined for the size using the following graph.

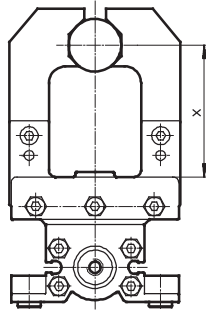

HGPC-12-A

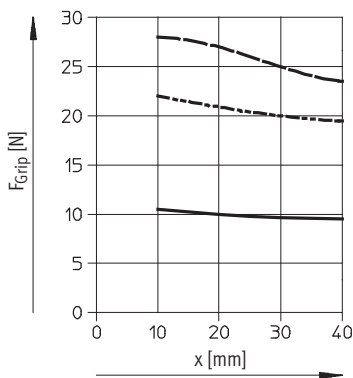

HGPC-16-A

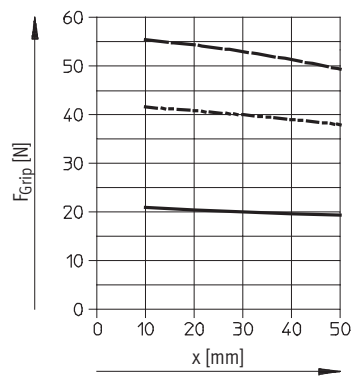

HGPC-20-A

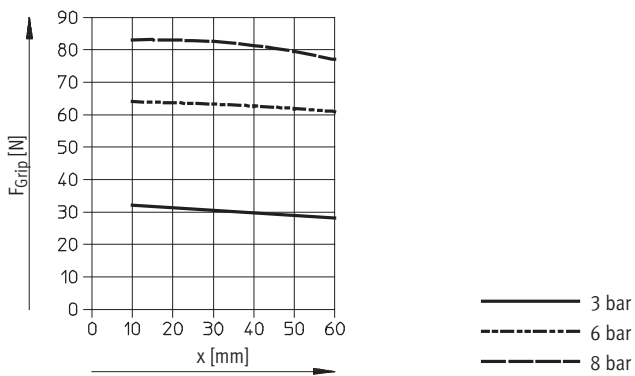

Parallel grippers HGPC

Technical data

Spring force F_S as a function of the gripper size and the overall stroke l

Gripping force retention for HGPC-...-G2

Spring forces F_S as a function of the gripper size and the overall stroke l for various gripper types (HGPC-...-G2) can be determined using the following graphs.

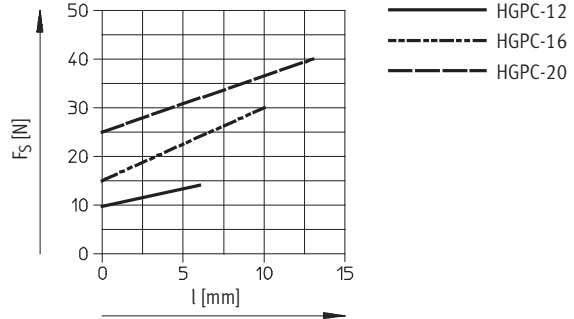
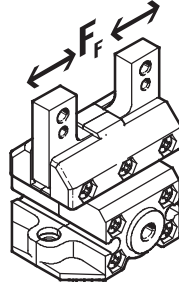

The lever arm x must be taken into consideration when determining the actual spring force F_{Stotal} . The formulae for calculating the spring force are provided in the table opposite.

Size	$F_{Stotal} =$
12	$-0.02 * x + 0.5 * F_S$
16	$-0.05 * x + 0.5 * F_S$
20	$-0.05 * x + 0.5 * F_S$

Determination of the actual gripping forces F_{Gr} for HGPC-...-G2 depending on the application

Parallel grippers with integrated spring type HGPC-...-G2 (closing gripping force retention) can be used as:
 – single-acting grippers

- grippers with supplementary gripping force
- grippers with gripping force retention

In order to calculate available gripping forces F_{Gr} (per gripper jaw), the gripping force (F_{Grip}) and spring

force (F_{Stotal}) must be combined accordingly.

Application

Single-acting

- Gripping with spring force:
 $F_{Gr} = F_{Stotal}$
- Gripping with pressure force:
 $F_{Gr} = F_{Grip} - F_{Stotal}$

Supplementary gripping force

- Gripping with pressure and spring force:
 $F_{Gr} = F_{Grip} + F_{Stotal}$

Gripping force retention

- Gripping with spring force:
 $F_{Gr} = F_{Stotal}$

Parallel grippers HGPC

Technical data

Gripping force F_{Grip} per gripper jaw at 6 bar as a function of lever arm x and eccentricity y

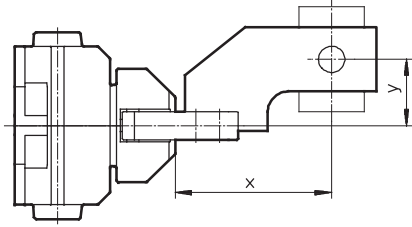

Gripping forces at 6 bar dependent upon eccentric application of force and the maximum permissible off-centre point of force application can be determined for the size using the following graph.

Calculation example

Given:

Lever arm $x = 20$ mm

Eccentricity $y = 22$ mm

To be found:

Gripping force at 6 bar

Procedure:

- Determine the intersection xy between lever arm x and eccentricity y in the graph for HGPC-12-A-...
- Draw an arc (with centre at origin) through intersection xy .
- Determine the intersection between the arc and the X axis.
- Read the gripping force.

Result:

Gripping force $F =$ approx. 20.5 N

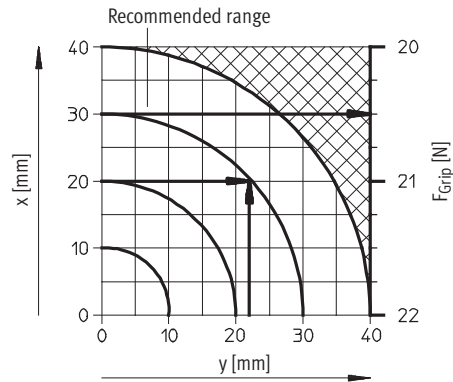

HGPC-12-A

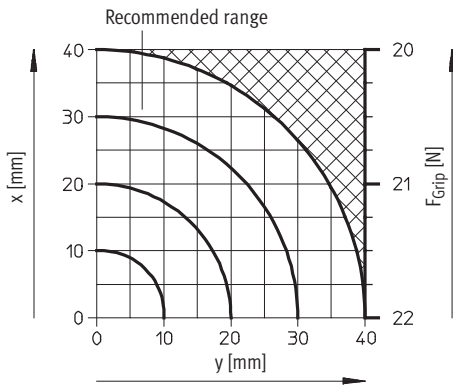

HGPC-16-A

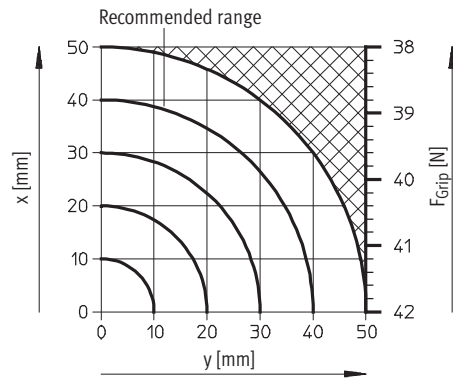

HGPC-20-A

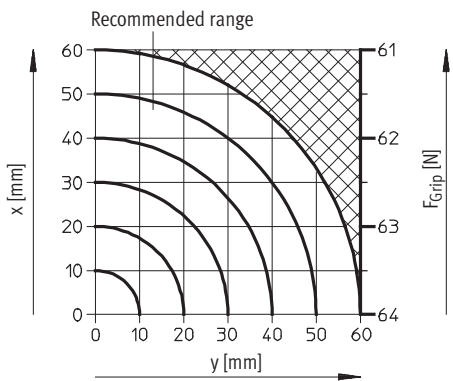

Parallel grippers HGPC

Technical data

FESTO

Dimensions

Download CAD Data → www.festo.com/us/cad

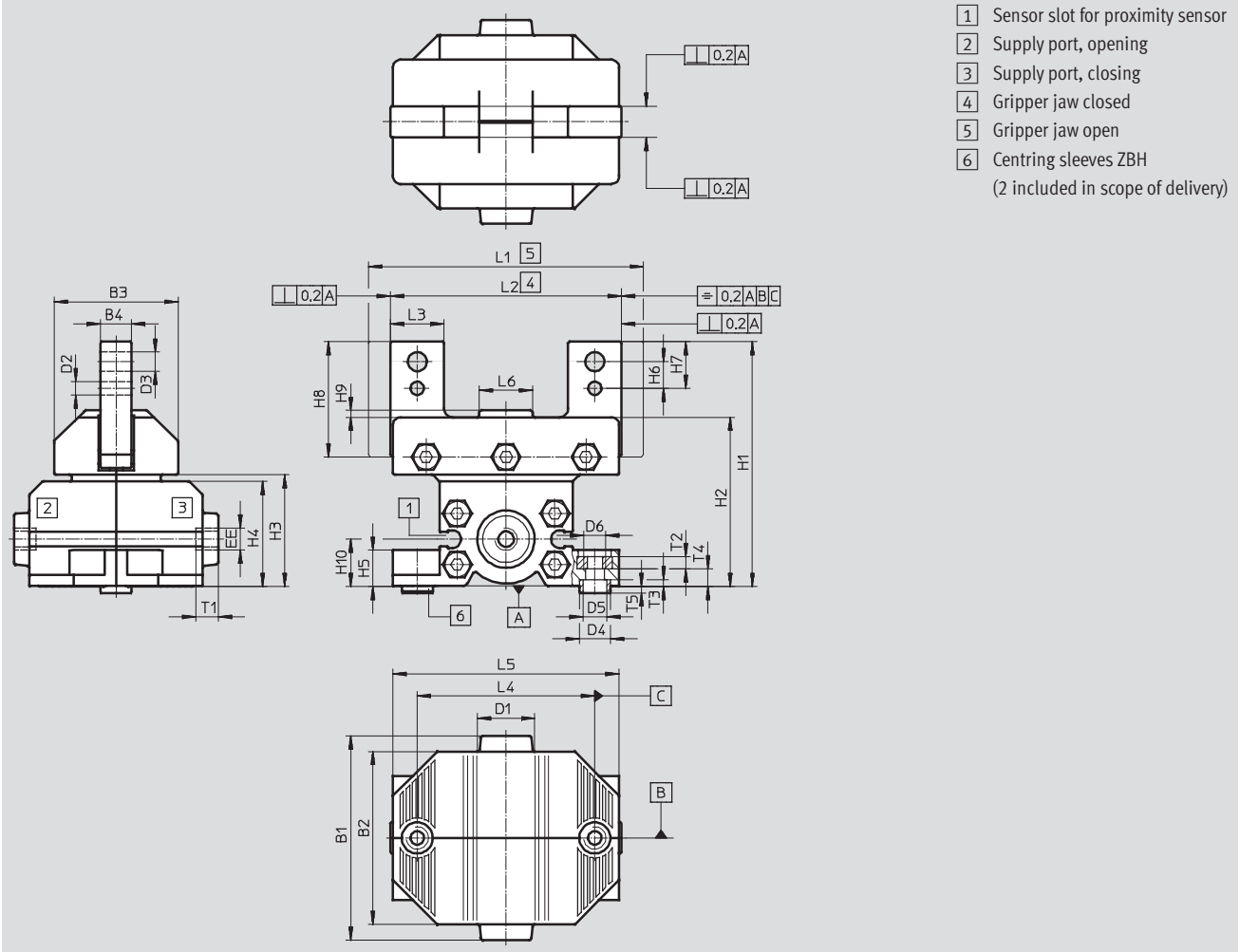

- 1 Sensor slot for proximity sensor
- 2 Supply port, opening
- 3 Supply port, closing
- 4 Gripper jaw closed
- 5 Gripper jaw open
- 6 Centring sleeves ZBH
(2 included in scope of delivery)

Size	B1	B2	B3	B4	D1	D2	D3	D4	D5	D6
[mm]				±0.1			±0.1	∅ F10/h7	∅	
12	38	33	22.4	6	12	2.5 ^{+0.04/+0.01}	3.3	7	5.3	M4
16	46	39	28	7	12	3 ^{H8}	4.3	7	5.3	M5
20	57	50	35	8	12	4 ^{H8}	5.3	9	6.4	M6

Size	EE	H1	H2	H3	H4	H5	H6	H7	H8	H9	H10
[mm]		±0.5							-0.2		
12	M5	48.2	33.6	21.7	20.2	6.9	5 ^{+0.05/-0.1}	9 ^{+0.05/-0.1}	25	1.2	9.2
16	M5	55.2	38.2	25.2	23.7	8.2	6±0.1	10.5±0.4	28.5	1.5	10.7
20	M5	68.7	48.2	32.5	30.5	10.2	7.5±0.1	13±0.4	34.5	1.5	13.7

Size	L1	L2	L3	L4 ¹⁾	L5	L6	T1	T2	T3	T4	T5
[mm]	±0.5	±0.5					min.		±0.1	+0.4 -0.3	+0.1 -0.3
12	45	39	10 ^{-0.02/-0.06}	33	42	10	4.5	2.2	1.7	3.1	1.3
16	62	52	12 ^{-0.05}	40	51	12	4.5	2.7	1.8	3.8	1.2
20	76	63	14 ^{-0.05}	50	65	16	4.5	3.2	2.3	5.2	1.7

1) Tolerance for centring hole ±0.03
Tolerance for thread ±0.1

Parallel grippers HGPC

Technical data

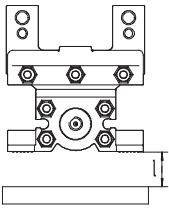

Minimum distance l between gripper and ferritic object			
		12	16
Distance	[mm]	10	

Ordering data					
	Size [mm]	Double-acting Without compression spring		Single-acting or with gripping force retention Closing	
		Part No.	Type	Part No.	Type
	12	539 267	HGPC-12-A	539 268	HGPC-12-A-G2
	16	539 269	HGPC-16-A	539 270	HGPC-16-A-G2
	20	539 271	HGPC-20-A	539 272	HGPC-20-A-G2

Parallel grippers HGPC

Accessories



FESTO

**Adapter kit
HAPG, HMSV**

Material:
Wrought aluminium alloy
Free of copper and PTFE
RoHS-compliant

Note

The kit includes the individual mounting interface as well as the necessary mounting material.

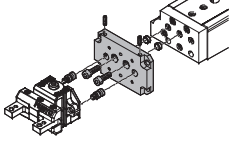
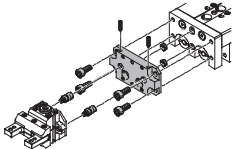
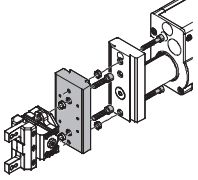
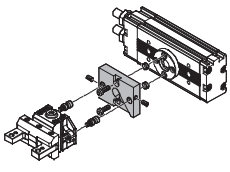
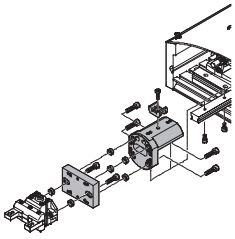
Permissible drive/gripper combinations with adapter kit					Download CAD Data → www.festo.com/us/cad	
Combination	Drive Size	Gripper Size	Mounting option		Adapter kit	
					CRC ¹⁾	Part No. Type
DGSL/HGPC	DGSL	HGPC			HAPG	
	12, 16	12	■	■	2	529018 HAPG-58
	20, 25	16	■	■		191267 HAPG-49
	20, 25	20	■	■		191269 HAPG-51
SLT/HGPC	SLT	HGPC			HAPG	
	10	12	■	–	2	542670 HAPG-100
	16	12	■	–		529018 HAPG-58
	16	16	■	–		542666 HAPG-101
	20	16	■	–		191267 HAPG-49
	20	20	■	–		542667 HAPG-102
	25	20	■	–		191269 HAPG-51
HMP/HGPC	HMP	HGPC			HAPG	
	16	16	–	■	2	191263 HAPG-45
	20, 25	20	–	■		191264 HAPG-46
DRQD/HGPC	DRQD-...-FW	HGPC			HAPG	
	12, 16	12	■	■	2	542671 HAPG-SD2-41
	16, 20	16	■	■		542668 HAPG-SD2-42
	20	20	■	■		542669 HAPG-SD2-43
	25	20	■	■		542758 HAPG-SD2-44
HSP/HGPC	HSP	HGPC			HAPG	
	16	16	■	–	2	191901 HAPG-55
	25	20	■	–		540882 HAPG-71-B
						191901 HAPG-55
				540883 HAPG-72-B		

1) Corrosion resistance class 2 according to Festo standard 940 070

Components subject to moderate corrosion stress. Externally visible parts with primarily decorative surface requirements which are in direct contact with a normal industrial environment or media such as coolants or lubricating agents.

Parallel grippers HGPC

Accessories

FESTO

Adapter kit
HAPG, HMSV

Material:
Wrought aluminium alloy
Free of copper and PTFE
RoHS-compliant

Note

The kit includes the individual mounting interface as well as the necessary mounting material.

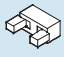
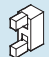
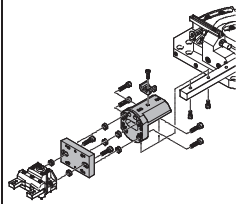
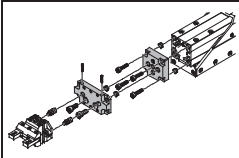
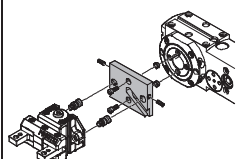
Permissible drive/gripper combinations with adapter kit					Download CAD Data → www.festo.com/us/cad		
Combination	Drive Size	Gripper		Adapter kit		Part No.	Type
		Size	Mounting option	CRC ¹⁾			
							
HSW/HGPC	HSW	HGPC		HAPG			
	12, 16	16	■	–	2	191901	HAPG-55
						540882	HAPG-71-B
EGSA/HGPC	EGSA	HGPC		HAPG, HMSV			
	50	12	■	■	2	529018	HAPG-58
	60	16	■	■		560017	HMSV-61
	60	20	■	■		191267	HAPG-49
						560018	HMSV-62
						191269	HAPG-51
						560018	HMSV-62
ERMB/HGPC	ERMB	HGPC		HAPG			
	20	16	■	■	2	542668	HAPG-SD2-42
	20	20	■	■		542669	HAPG-SD2-43
	25	20	■	■		542758	HAPG-SD2-44

1) Corrosion resistance class 2 according to Festo standard 940 070
Components subject to moderate corrosion stress. Externally visible parts with primarily decorative surface requirements which are in direct contact with a normal industrial environment or media such as coolants or lubricating agents.

Parallel grippers HGPC

Accessories



FESTO

Ordering data – Centring sleeves			Technical data → Internet: zbh		
	For size [mm]	Weight [g]	Part No.	Type	PU ¹⁾
	12, 16	1	186 717	ZBH-7	10
	20	1	150 927	ZBH-9	10

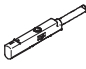
1) Packaging unit

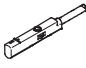
Ordering data – Proximity sensors for C-slot, in-line connecting cable						
	Assembly	Electrical connection		Cable length [m]	Part No.	Type
		Cable	Plug M8			
	N/O contact, magneto-resistive					Technical data → Internet: smt
	Insertable in the slot from above	3-wire	–	2.5	551 373	SMT-10M-PS-24V-E-2,5-L-OE
		–	3-pin	0.3	551 375	SMT-10M-PS-24V-E-0,3-L-M8D
	N/O contact, magnetic reed					Technical data → Internet: sme
Insertable in the slot lengthwise	3-wire	–	2.5	173 210	SME-10-KL-LED-24	
	–	3-pin	0.3	173 212	SME-10-SL-LED-24	

Ordering data – Proximity sensors for C-slot, lateral connecting cable						
	Assembly	Electrical connection		Cable length [m]	Part No.	Type
		Cable	Plug M8			
	N/O contact, magneto-resistive					Technical data → Internet: smt
	Insertable in the slot from above	3-wire	–	2.5	551 374	SMT-10M-PS-24V-E-2,5-Q-OE
		–	3-pin	0.3	551 376	SMT-10M-PS-24V-E-0,3-Q-M8D
	N/O contact, magnetic reed					Technical data → Internet: sme
Insertable in the slot lengthwise	3-wire	–	2.5	173 211	SME-10-KQ-LED-24	
	–	3-pin	0.3	173 213	SME-10-SQ-LED-24	

Ordering data – Connecting cables				Technical data → Internet: nebu	
	Electrical connection, left	Electrical connection, right	Cable length [m]	Part No.	Type
	Straight socket, M8x1, 3-pin	Cable, open end, 3-wire	2.5	541 333	NEBU-M8G3-K-2.5-LE3
			5	541 334	NEBU-M8G3-K-5-LE3
	Angled socket, M8x1, 3-pin	Cable, open end, 3-wire	2.5	541 338	NEBU-M8W3-K-2.5-LE3
			5	541 341	NEBU-M8W3-K-5-LE3

Product Range and Company Overview

A Complete Suite of Automation Services

Our experienced engineers provide complete support at every stage of your development process, including: conceptualization, analysis, engineering, design, assembly, documentation, validation, and production.



Custom Automation Components
Complete custom engineered solutions



Custom Control Cabinets
Comprehensive engineering support and on-site services



Complete Systems
Shipment, stocking and storage services

The Broadest Range of Automation Components

With a comprehensive line of more than 30,000 automation components, Festo is capable of solving the most complex automation requirements.



Electromechanical
Electromechanical actuators, motors, controllers & drives



Pneumatics
Pneumatic linear and rotary actuators, valves, and air supply



PLCs and I/O Devices
PLC's, operator interfaces, sensors and I/O devices

Supporting Advanced Automation... As No One Else Can!

Festo is a leading global manufacturer of pneumatic and electromechanical systems, components and controls for industrial automation, with more than 12,000 employees in 56 national headquarters serving more than 180 countries. For more than 80 years, Festo has continuously elevated the state of manufacturing with innovations and optimized motion control solutions that deliver higher performing, more profitable automated manufacturing and processing equipment. Our dedication to the advancement of automation extends beyond technology to the education and development of current and future automation and robotics designers with simulation tools, teaching programs, and on-site services.

Quality Assurance, ISO 9001 and ISO 14001 Certifications

Festo Corporation is committed to supply all Festo products and services that will meet or exceed our customers' requirements in product quality, delivery, customer service and satisfaction.

To meet this commitment, we strive to ensure a consistent, integrated, and systematic approach to management that will meet or exceed the requirements of the ISO 9001 standard for Quality Management and the ISO 14001 standard for Environmental Management.



© Copyright 2008, Festo Corporation. While every effort is made to ensure that all dimensions and specifications are correct, Festo cannot guarantee that publications are completely free of any error, in particular typing or printing errors. Accordingly, Festo cannot be held responsible for the same. For Liability and Warranty conditions, refer to our "Terms and Conditions of Sale", available from your local Festo office. All rights reserved. No part of this publication may be reproduced, distributed, or transmitted in any form or by any means, electronic, mechanical, photocopying or otherwise, without the prior written permission of Festo. All technical data subject to change according to technical update.



Printed on recycled paper at New Horizon Graphic, Inc., FSC certified as an environmentally friendly printing plant.

Festo North America

Festo Regional Contact Center

5300 Explorer Drive
Mississauga, Ontario L4W 5G4
Canada

USA Customers:

For ordering assistance,

Call: 1.800.99.FESTO (1.800.993.3786)

Fax: 1.800.96.FESTO (1.800.963.3786)

Email: customer.service@us.festo.com

For technical support,

Call: 1.866.GO.FESTO (1.866.463.3786)

Fax: 1.800.96.FESTO (1.800.963.3786)

Email: product.support@us.festo.com

Canadian Customers:

Call: 1.877.GO.FESTO (1.877.463.3786)

Fax: 1.877.FX.FESTO (1.877.393.3786)

Email: festo.canada@ca.festo.com

USA Headquarters

Festo Corporation
395 Moreland Road
P.O. Box 18023
Hauppauge, NY 11788, USA
www.festo.com/us

USA Sales Offices

Appleton

North 922 Tower View Drive, Suite N
Greenville, WI 54942, USA

Boston

120 Presidential Way, Suite 330
Woburn, MA 01801, USA

Chicago

1441 East Business Center Drive
Mt. Prospect, IL 60056, USA

Dallas

1825 Lakeway Drive, Suite 600
Lewisville, TX 75057, USA

Detroit – Automotive Engineering Center

2601 Cambridge Court, Suite 320
Auburn Hills, MI 48326, USA

New York

395 Moreland Road
Hauppauge, NY 11788, USA

Silicon Valley

4935 Southfront Road, Suite F
Livermore, CA 94550, USA

United States



USA Headquarters, East: Festo Corp., 395 Moreland Road, Hauppauge, NY 11788

Phone: 1.631.435.0800; Fax: 1.631.435.8026;

Email: info@festo-usa.com

www.festo.com/us

Canada



Headquarters: Festo Inc., 5300 Explorer Drive, Mississauga, Ontario L4W 5G4

Phone: 1.905.624.9000; Fax: 1.905.624.9001;

Email: festo.canada@ca.festo.com

www.festo.ca

Mexico



Headquarters: Festo Pneumatic, S.A., Av. Ceylán 3, Col. Tequesquahuac,
54020 Tlalneantla, Edo. de México

Phone: 011 52 [55] 53 21 66 00; Fax: 011 52 [55] 53 21 66 65;

Email: festo.mexico@mx.festo.com

www.festo.com/mx

Central USA

Festo Corporation
1441 East Business
Center Drive
Mt. Prospect, IL 60056, USA
Phone: 1.847.759.2600
Fax: 1.847.768.9480



Western USA

Festo Corporation
4935 Southfront Road,
Suite F
Livermore, CA 94550, USA
Phone: 1.925.371.1099
Fax: 1.925.245.1286



Festo Worldwide

Argentina Australia Austria Belarus Belgium Brazil Bulgaria Canada Chile China Colombia Croatia Czech Republic Denmark
Estonia Finland France Germany Great Britain Greece Hong Kong Hungary India Indonesia Iran Ireland Israel Italy Japan Latvia
Lithuania Malaysia Mexico Netherlands New Zealand Norway Peru Philippines Poland Romania Russia Serbia Singapore
Slovakia Slovenia South Africa South Korea Spain Sweden Switzerland Taiwan Thailand Turkey Ukraine United States Venezuela

www.festo.com