

Flow control valves

FESTO





Flow control valves

Key features

FESTO

Function			Note
Flow control or one-way flow control valves regulate the piston speed of pneumatic drives during advance and return strokes. This is done through suitable restriction of the flow rate of compressed air in exhaust air or supply air direction. With the one-way	flow control valve GRLA or GRLZ, the flow control function works in one direction only (exhaust air or supply air); the non-return function works in the opposite direction. With the flow control valve GRLO, the flow control function is active in both directions.	The flow control function creates an adjustable annular gap inside the valve. This gap can be increased or decreased by turning the knurled screw or slotted head screw. The required restriction can be set with the help of this adjustment component.	

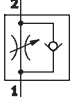
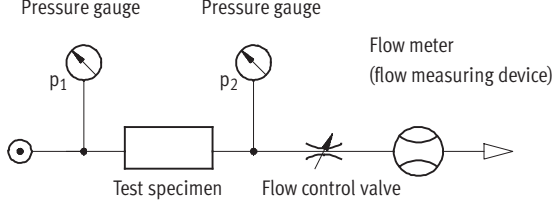
The documentation for the one-way flow control valves can be found at
www.festo.com/catalogue

General information		
Standard nominal flow rate q_{nN}	Exhaust air one-way flow control function	Flow measurement circuit
The standard nominal flow rate q_{nN} is the flow rate based on standard conditions at an operating pressure of $p_1 = 6$ bar and an output pressure of $p_2 = 5$ bar, measured at room temperature $t = 20$ °C.		
	Supply air one-way flow control function	<p>p_1 Operating pressure p_2 Output pressure</p>
	Flow control function in both directions	
		

Standard flow rate q_n

The standard flow rate is measured at an operating pressure of $p_1 = 6$ bar and an output pressure with respect to atmospheric pressure ($p_2 = 0$ bar).

Flow control valves

Key features

FESTO

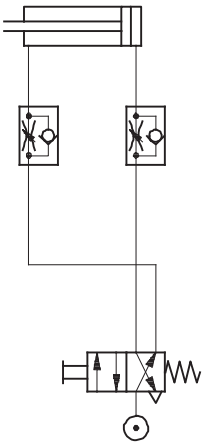
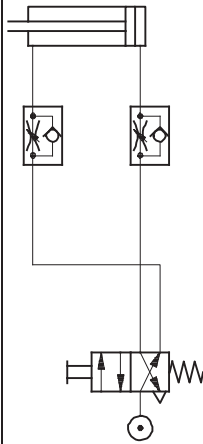
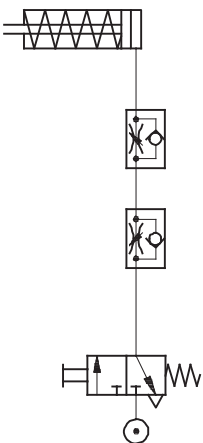
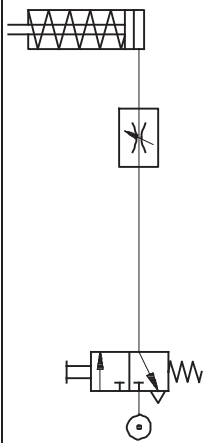
Flow control functions and range of applications			
Application	Description	Application	Description
Double-acting cylinder with one-way flow control valve			
Exhaust air one-way flow control function		Supply air one-way flow control function	
	Speed adjustment through exhaust air flow control. Uncontrolled supply air and controlled exhaust air move the piston between air cushions (improves motion, even with load changes).		Adjustable speed during advance and return strokes. The flow rate is identical in both directions.
Single-acting cylinder with one-way flow control valve		Single-acting cylinder with flow control valve	
Exhaust air and supply air one-way flow control function		Flow control function in both directions	
	Adjustable speed during advance and return strokes. The flow rate can be adjusted differently for both directions.		Speed adjustment through flow control on both sides is often applied in the case of single-acting or small cylinders. The benefit of this application lies in its simplicity.

Application examples

Mini slide SLT

Flat cylinder DZF



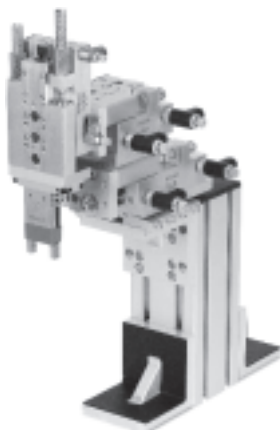



Multimount cylinder DMM



Flow control valves

Product range overview

FESTO

Version	Valve function	Version	Type	Connection direction	Pneumatic connection 1	Pneumatic connection 2	q _N ¹⁾ [l/min]	Adjustment component	➔ Page/ Internet
Standard	Metal Flow control function		GRLO	Elbow outlet	M5	M5	95	Slotted head screw	6
					M5	PK-3	83	Slotted head screw	6
Mini	Metal Flow control function		GRLO	Elbow outlet	M3, M5	QS-3, QS-4	40 ... 41	Slotted head screw	8
					M3	M3	18	Slotted head screw	11
			GRGO	Parallel outlet	M3	QS-3	41	Slotted head screw	8
In-line installation	Polymer Flow control function		GRO	Inline	QS-3, QS-4, QS-6	QS-3, QS-4, QS-6	25 ... 160	Knurled screw	gro

1) Standard nominal flow rate in direction of flow control.

Flow control valves

Type codes

FESTO

GRLO/GRGO

		GRLO	-	M5	-	PK-3	-		-	B
Type										
GRLO	Flow control valve, elbow outlet									
GRGO	Flow control valve, parallel outlet									
Pneumatic connection 1										
M3	Male thread M3									
M5	Male thread M5									
Pneumatic connection 2										
-	Female thread (connection size as for connection 2)									
QS-3	Push-in connector for tubing O.D. 3 mm									
QS-4	Push-in connector for O.D. tubing 4 mm									
PK-3	Push-in connector for tubing I.D. 3 mm									
Flow rate characteristic										
LF	Low flow									
MF	Medium flow									
Generation										
B	B series									
C	C series									

Flow control valves GRLO, standard

Technical data – Female thread/barbed connector, metal

FESTO

Function



Flow rate

83 ... 95 l/min

Temperature range

–10 ... +60 °C

Pressure

0 ... 10 bar

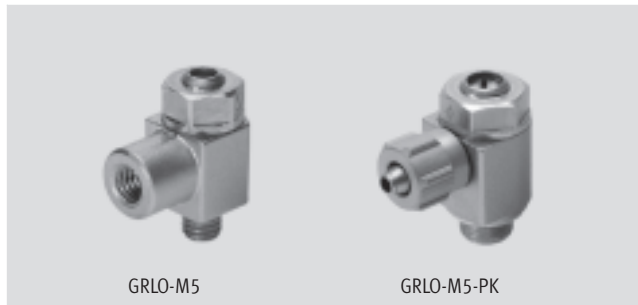

General technical data		
Valve function	Flow control function	
Pneumatic connection 1	M5	M5
Pneumatic connection 2	M5 ¹⁾	PK-3
Adjustment component	Slotted head screw	
Type of mounting	Screw-in	
Mounting position	Any	
Max. tightening torque [Nm]	1.5	1.5

1) Note: This product conforms to ISO 1179-1 and ISO 228-1.

Operating and environmental conditions		
Operating pressure [bar]	0 ... 10	
Operating medium	Compressed air in accordance with ISO 8573-1:2010 [7:4:4]	
Note on operating/pilot medium	Operation with lubricated medium possible (in which case lubricated operation will always be required)	
Ambient temperature [°C]	–10 ... +60	
Temperature of medium [°C]	–10 ... +60	
Storage temperature [°C]	–10 ... +40	

Standard nominal flow rate q_{nN} at 6 → 5 bar
as a function of turns of the adjusting screw n

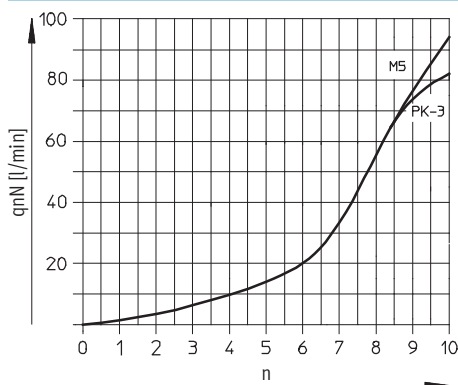

Standard flow rate q_n at 6 → 0 bar
as a function of turns of the adjusting screw n

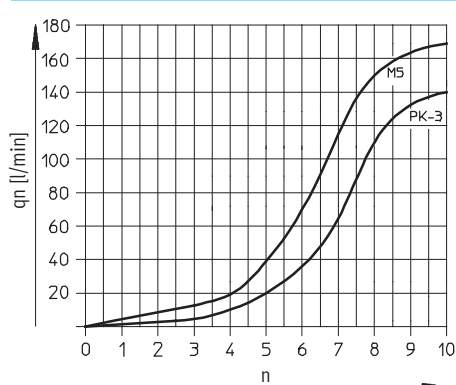

Flow control valves GRLO, standard

FESTO

Technical data – Female thread/barbed connector, metal

Materials

Sectional view

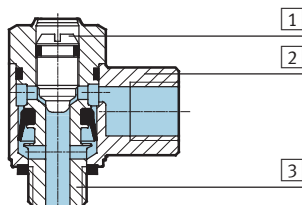

Flow control valve

1	Adjusting screw	Brass
2	Swivel connection	Die-cast zinc
3	Threaded plug	Nickel-plated brass
-	Seals	NBR
Note on materials		RoHS-compliant

Dimensions

Download CAD Data → www.festo.com/us/cad

Female thread

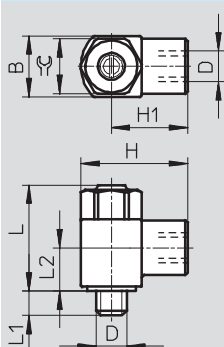

Push-in connector

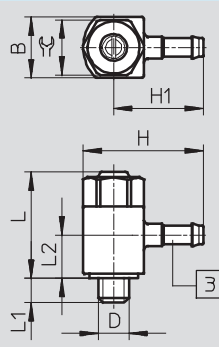

3 Barbed connector

Note: This product conforms to ISO 1179-1 and ISO 228-1

Type	Connection D	Nominal size [mm]	B	H	H1	L max.	L1	L2	⌀
Female thread									
GRLO-M5	M5	2	10 -0.15	17.5	12.5	17.6	4 ±0.3	7.1	9
Push-in connector									
GRLO-M5-PK-3	M5	2	10 -0.15	19.7	14.7	17.6	4 ±0.3	8.5	9

Ordering data

	Pneumatic connection		Standard nominal flow rate q _N at 6 → 5 bar in direction of flow control [l/min]	Standard flow rate q _n at 6 → 0 bar in direction of flow control [l/min]	Weight [g]	Part No.	Type
	1	2					
Slotted head screw							
	M5	M5	95	169	11	151181	GRLO-M5-B
	M5	PK-3	83	140	10	151182	GRLO-M5-PK-3-B

Flow control valves GRLO/GRGO, mini

Technical data – Push-in connector QS, metal

FESTO

Function

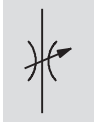

- Low flow: precision adjustment for low speed

Flow rate

40 ... 41 l/min

Temperature range

–10 ... +60 °C

Pressure

0 ... 10 bar

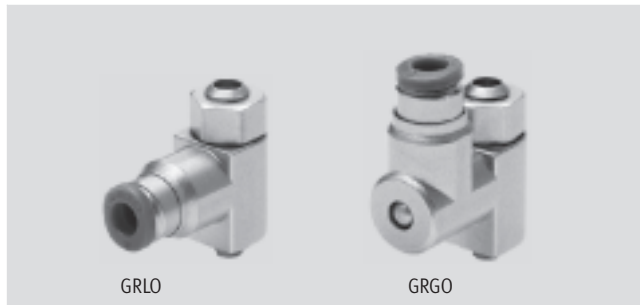

GRLO

GRGO

General technical data

Valve function	Flow control function	
Pneumatic connection 1	M3	M5
Pneumatic connection 2	QS-3	QS-3, QS-4
Adjustment component	Slotted head screw	
Type of mounting	Screw-in	
Mounting position	Any	
Max. tightening torque [Nm]	0.3	1.5

Operating and environmental conditions

Operating pressure [bar]	0 ... 10
Operating medium	Compressed air in accordance with ISO 8573-1:2010 [7:4:4]
Note on operating/pilot medium	Operation with lubricated medium possible (in which case lubricated operation will always be required)
Ambient temperature [°C]	–10 ... +60
Temperature of medium [°C]	–10 ... +60
Storage temperature [°C]	–10 ... +40

Standard nominal flow rate q_{nN} at 6 → 5 bar as a function of turns of the adjusting screw n

GRLO/GRGO-M3

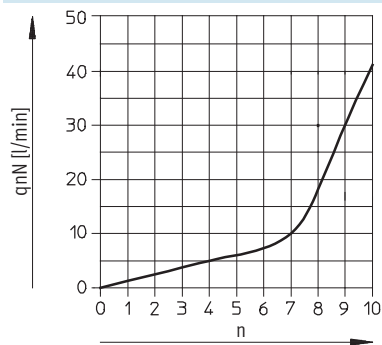

Standard flow rate q_n at 6 → 0 bar as a function of turns of the adjusting screw n

GRLO/GRGO-M3

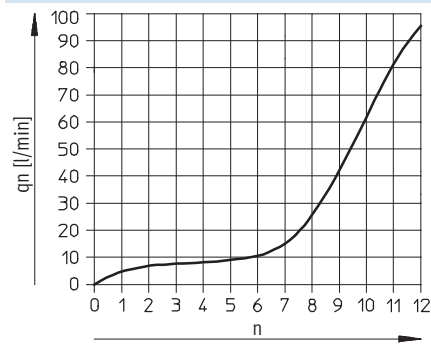

GRLO-M5

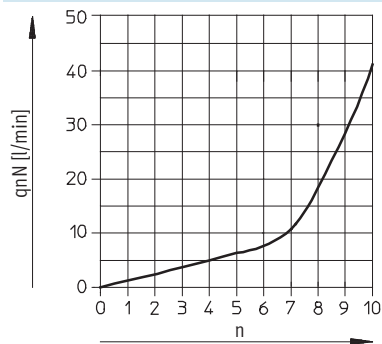

GRLO-M5

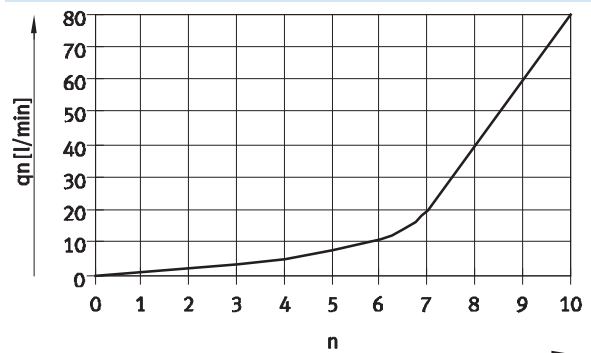

Flow control valves GRLO/GRGO, mini

FESTO

Technical data – Push-in connector QS, metal

Materials

Sectional view

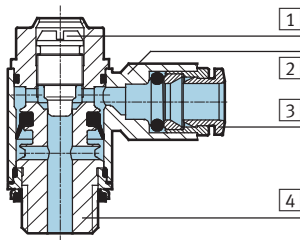

Flow control valve

1	Adjusting screw	Brass
2	Swivel connection	Die-cast zinc
3	Releasing ring	POM
4	Threaded plug	Brass
-	Seals	NBR
Note on materials		RoHS-compliant

Dimensions

Download CAD Data → www.festo.com/us/cad

GRLO, elbow outlet

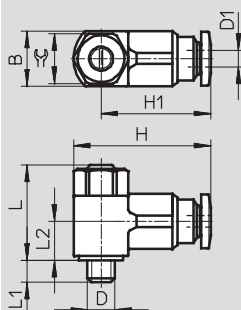

GRGO, parallel outlet

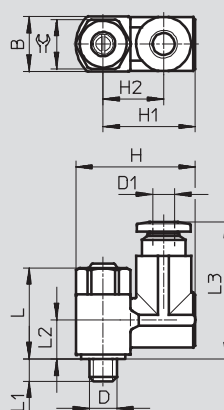

Type	Connection	Nominal size	Tubing O.D.	B	H	H1	H2	L max.	L1	L2	L3	☞
	D	[mm]	D1									
GRLO	M3	1.4	3	8 -0.15	20	15.8	-	16.6	2.3 +0.15/-0.3	7	-	7
	M5	1.4	3	9.8 -0.15	22.4	18.4		17.7	3.1 +0.15/-0.35	7.3		
		1.4	4	9.8 -0.15	22.2	18.2		17.7	3.1 +0.15/-0.35	7.3		
GRGO	M3	1.4	3	8 -0.15	18	14	9.25	16.6	2.3 +0.15/-0.3	7.5	22	7

Ordering data

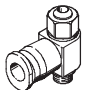
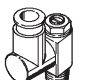
	Pneumatic connection		Standard nominal flow rate qnN at 6 → 5 bar in direction of flow control [l/min]	Standard flow rate qn at 6 → 0 bar in direction of flow control [l/min]	Weight [g]	Part No.	Type
	1	2					
Slotted head screw							
	M3	QS-3	41	95	7	175042	GRLO-M3-QS-3
	M5	QS-3	40	80	9	175054	GRLO-M5-QS-3-LF-C
		QS-4	40	80	9	175057	GRLO-M5-QS-4-LF-C
	M3	QS-3	41	95	14	175045	GRGO-M3-QS-3

Flow control valves GRLO, mini

Technical data – Female thread, metal

FESTO

Function



Flow rate

0 ... 18 l/min

Temperature range

-10 ... +60 °C

Pressure

0 ... 10 bar



General technical data	
Valve function	Flow control function
Pneumatic connection 1	M3
Pneumatic connection 2	M3
Adjustment component	Slotted head screw
Type of mounting	Screw-in
Mounting position	Any
Max. tightening torque [Nm]	0.3

Operating and environmental conditions	
Operating pressure [bar]	0 ... 10
Operating medium	Compressed air in accordance with ISO 8573-1:2010 [7:4:4]
Note on operating/pilot medium	Operation with lubricated medium possible (in which case lubricated operation will always be required)
Ambient temperature [°C]	-10 ... +60
Temperature of medium [°C]	-10 ... +60
Storage temperature [°C]	-10 ... +40

Standard nominal flow rate q_{nN} at 6 → 5 bar
as a function of turns of the adjusting screw n

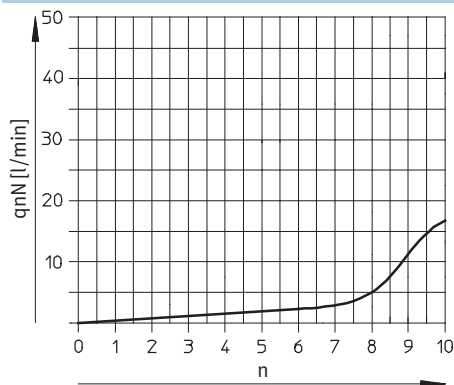

Standard flow rate q_n at 6 → 0 bar
as a function of turns of the adjusting screw n

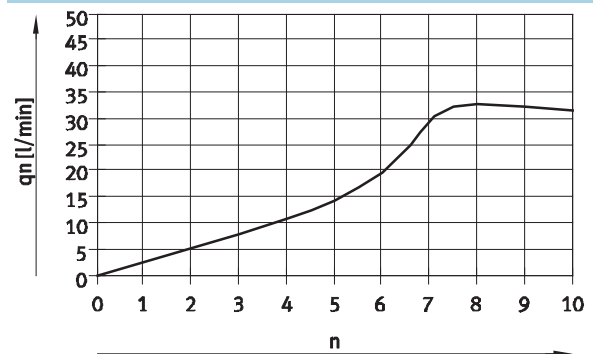

Materials

Sectional view

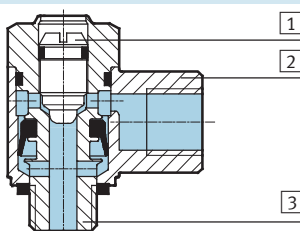

Flow control valve		
1	Adjusting screw	Brass
2	Swivel connection	Die-cast zinc
3	Threaded plug	Nickel-plated brass
—	Seals	NBR
Note on materials		RoHS-compliant

Flow control valves GRLO, mini

Technical data – Female thread, metal

FESTO

Dimensions

Download CAD Data → www.festo.com/us/cad

Slotted head screw

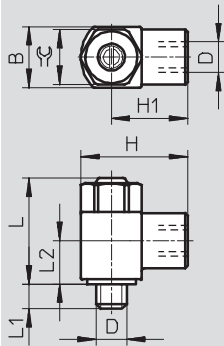

Type	Connection	Nominal size	B	H	H1	L max.	L1	L2	⌀
	D	[mm]							
GRLO	M3	0.8	5 -0.1	9	6.5	13.3	2.5 +0.15/-0.3	6.4	4.5

Ordering data

	Pneumatic connection		Standard nominal flow rate q _N at 6 → 5 bar in direction of flow control	Standard flow rate q _n at 6 → 0 bar in direction of flow control	Weight	Part No.	Type
	1	2	[l/min]	[l/min]	[g]		
Slotted head screw							
	M3	M3	18	33	2	175039	GRLO-M3

Product Range and Company Overview

A Complete Suite of Automation Services

Our experienced engineers provide complete support at every stage of your development process, including: conceptualization, analysis, engineering, design, assembly, documentation, validation, and production.



Custom Automation Components
Complete custom engineered solutions



Custom Control Cabinets
Comprehensive engineering support and on-site services



Complete Systems
Shipment, stocking and storage services

The Broadest Range of Automation Components

With a comprehensive line of more than 30,000 automation components, Festo is capable of solving the most complex automation requirements.



Electromechanical
Electromechanical actuators, motors, controllers & drives



Pneumatics
Pneumatic linear and rotary actuators, valves, and air supply



PLCs and I/O Devices
PLC's, operator interfaces, sensors and I/O devices

Supporting Advanced Automation... As No One Else Can!

Festo is a leading global manufacturer of pneumatic and electromechanical systems, components and controls for industrial automation, with more than 12,000 employees in 56 national headquarters serving more than 180 countries. For more than 80 years, Festo has continuously elevated the state of manufacturing with innovations and optimized motion control solutions that deliver higher performing, more profitable automated manufacturing and processing equipment. Our dedication to the advancement of automation extends beyond technology to the education and development of current and future automation and robotics designers with simulation tools, teaching programs, and on-site services.

Quality Assurance, ISO 9001 and ISO 14001 Certifications

Festo Corporation is committed to supply all Festo products and services that will meet or exceed our customers' requirements in product quality, delivery, customer service and satisfaction.

To meet this commitment, we strive to ensure a consistent, integrated, and systematic approach to management that will meet or exceed the requirements of the ISO 9001 standard for Quality Management and the ISO 14001 standard for Environmental Management.



© Copyright 2008, Festo Corporation. While every effort is made to ensure that all dimensions and specifications are correct, Festo cannot guarantee that publications are completely free of any error, in particular typing or printing errors. Accordingly, Festo cannot be held responsible for the same. For Liability and Warranty conditions, refer to our "Terms and Conditions of Sale", available from your local Festo office. All rights reserved. No part of this publication may be reproduced, distributed, or transmitted in any form or by any means, electronic, mechanical, photocopying or otherwise, without the prior written permission of Festo. All technical data subject to change according to technical update.



Printed on recycled paper at New Horizon Graphic, Inc., FSC certified as an environmentally friendly printing plant.

Festo North America

Festo Regional Contact Center

5300 Explorer Drive
Mississauga, Ontario L4W 5G4
Canada

USA Customers:

For ordering assistance,

Call: 1.800.99.FESTO (1.800.993.3786)

Fax: 1.800.96.FESTO (1.800.963.3786)

Email: customer.service@us.festo.com

For technical support,

Call: 1.866.GO.FESTO (1.866.463.3786)

Fax: 1.800.96.FESTO (1.800.963.3786)

Email: product.support@us.festo.com

Canadian Customers:

Call: 1.877.GO.FESTO (1.877.463.3786)

Fax: 1.877.FX.FESTO (1.877.393.3786)

Email: festo.canada@ca.festo.com

USA Headquarters

Festo Corporation
395 Moreland Road
P.O. Box 18023
Hauppauge, NY 11788, USA
www.festo.com/us

USA Sales Offices

Appleton

North 922 Tower View Drive, Suite N
Greenville, WI 54942, USA

Boston

120 Presidential Way, Suite 330
Woburn, MA 01801, USA

Chicago

1441 East Business Center Drive
Mt. Prospect, IL 60056, USA

Dallas

1825 Lakeway Drive, Suite 600
Lewisville, TX 75057, USA

Detroit – Automotive Engineering Center

2601 Cambridge Court, Suite 320
Auburn Hills, MI 48326, USA

New York

395 Moreland Road
Hauppauge, NY 11788, USA

Silicon Valley

4935 Southfront Road, Suite F
Livermore, CA 94550, USA

United States



USA Headquarters, East: Festo Corp., 395 Moreland Road, Hauppauge, NY 11788

Phone: 1.631.435.0800; Fax: 1.631.435.8026;

Email: info@festo-usa.com

www.festo.com/us

Canada



Headquarters: Festo Inc., 5300 Explorer Drive, Mississauga, Ontario L4W 5G4

Phone: 1.905.624.9000; Fax: 1.905.624.9001;

Email: festo.canada@ca.festo.com

www.festo.ca

Mexico



Headquarters: Festo Pneumatic, S.A., Av. Ceylán 3, Col. Tequesquahuac,
54020 Tlalneapantla, Edo. de México

Phone: 011 52 [55] 53 21 66 00; Fax: 011 52 [55] 53 21 66 65;

Email: festo.mexico@mx.festo.com

www.festo.com/mx

Central USA

Festo Corporation
1441 East Business
Center Drive
Mt. Prospect, IL 60056, USA
Phone: 1.847.759.2600
Fax: 1.847.768.9480



Western USA

Festo Corporation
4935 Southfront Road,
Suite F
Livermore, CA 94550, USA
Phone: 1.925.371.1099
Fax: 1.925.245.1286



Festo Worldwide

Argentina Australia Austria Belarus Belgium Brazil Bulgaria Canada Chile China Colombia Croatia Czech Republic Denmark
Estonia Finland France Germany Great Britain Greece Hong Kong Hungary India Indonesia Iran Ireland Israel Italy Japan Latvia
Lithuania Malaysia Mexico Netherlands New Zealand Norway Peru Philippines Poland Romania Russia Serbia Singapore
Slovakia Slovenia South Africa South Korea Spain Sweden Switzerland Taiwan Thailand Turkey Ukraine United States Venezuela

www.festo.com