

Electrical connection technology, for AS-interface

FESTO

Technical data

Cable distributor ASI-KVT-FK

- Flat cable distributor for branching the AS-interface network at any desired point
- For parallel or symmetrical cable installation
- Reverse polarity protected

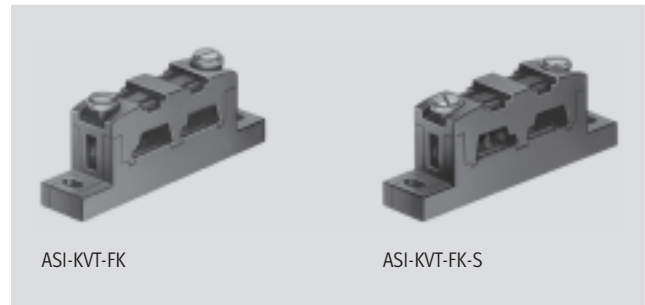

General technical data		
Mounting position		Any
Type of mounting		Via through-hole
Operating voltage range	[V AC]	0 ... 60
	[V DC]	0 ... 75
Acceptable current load	[A]	3
Connection type		Insulation displacement technology
Connection cross section	[mm ²]	1.5
Protection class		IP65 (fully assembled)
Product weight	[g]	7.2

Materials	
Housing	PA
Pin contacts	Bronze

Operating and environmental conditions		
Ambient temperature with flexible cable installation	[°C]	−5 ... +50
Storage temperature	[°C]	−30 ... +85

Electrical connection technology, for AS-interface

Technical data

FESTO

Dimensions

Download CAD Data → www.festo.com/us/cad

ASI-KVT-FK

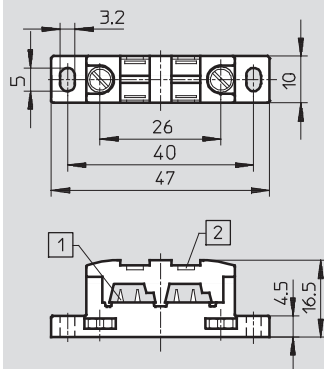

- 1 Contact pins for flat cable contacting
- 2 Mounting option for inscription labels IBS-6x10

ASI-KVT-FK-S

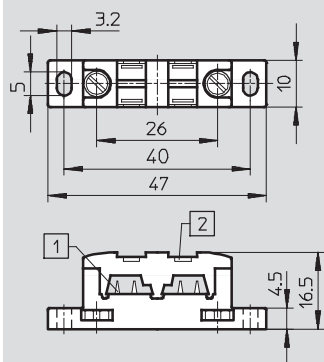

- 1 Contact pins for flat cable contacting
- 2 Mounting option for inscription labels IBS-6x10

Ordering data

	Part No.	Type
Parallel cable throughfeed	18786	ASI-KVT-FK
Symmetrical cable throughfeed	18797	ASI-KVT-FK-S

Ordering data – Accessories

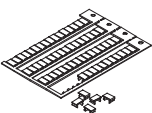
	Description	Part No.	Type
	Inscription labels 6x10 mm, 64 pieces, in frames	18576	IBS-6x10

Electrical connection technology, for AS-interface

FESTO

Technical data

Cable distributor ASI-KVT-FKx2

- Flat cable distributor for reconnecting from AS-interface flat cable to 4-pin M12 socket
- 2 connections: M12 socket with permanently attached cable (1 m long) and M12 socket integrated in housing
- Reverse polarity protected



General technical data		
Mounting position		Any
Type of mounting		Via through-hole
		Optionally via H-rail
AS-interface connection		AS-interface flat cable plug (must be ordered separately)
		M12x1 socket, 4-pin, A-coded
Nominal operating voltage for AS-interface	[V DC]	26.5
Operating voltage range for AS-interface	[V DC]	26.5 ... 31.6
Nominal operating voltage for load voltage	[V DC]	24
Operating voltage range for load voltage	[V DC]	20.4 ... 26.4
Protection class to EN 60529		IP65 (fully assembled)
Cable length	[mm]	1,000

Materials	
Housing	Reinforced PA
Cover	Reinforced PA
Seals	PUR
Note on materials	RoHS-compliant

Operating and environmental conditions		
Ambient temperature	[°C]	−5 ... +50
Storage temperature	[°C]	−20 ... +70
Relative air humidity	[%]	5 ... 90, non-condensing, in assembled state
CE marking (see declaration of conformity)		To EU EMC Directive

Electrical connection technology, for AS-interface

Technical data

FESTO

Dimensions

Download CAD Data → www.festo.com/us/cad

ASI-KVT-FKx2-M12

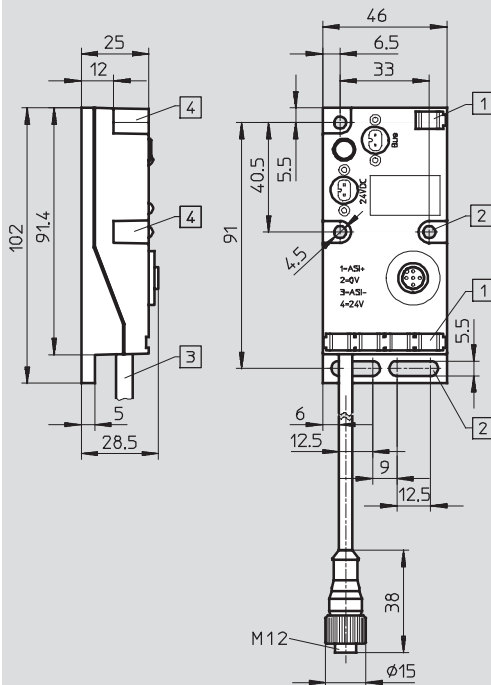

- 1 Mounting option for inscription labels IBS-6x10
- 2 Mounting holes for surface mounting
- 3 Cable PUR-OB, 1,000 mm long
- 4 Mounting holes for ITEM profile 40 mm or other mounting option

Pin allocation

AS-interface and auxiliary power supply		Pin	Signal	Pin	5-pin M12 socket and socket at the cable
	1	AS-interface bus	1 AS-interface +	1	
	2	AS-interface bus	2 AS-interface -	3	
	2	Additional power supply	1 0 V (additional supply)	2	
			2 +24 V (additional supply)	4	
			Unused	5	

Ordering data

		Product weight [g]	Part No.	Type
	Flat cable distributor for reconnecting from AS-interface flat cable to 4-pin M12 socket	190	527474	ASI-KVT-FKx2-M12

Ordering data – Accessories

	Description	Part No.	Type
	Inscription labels 6x10 mm, 64 pieces, in frames	18576	IBS-6x10
	10 plugs for (non-pressure-tight) sealing of openings with M12 female thread	165592	ISK-M12
	Mounted using 2x M2.5x6 screws For sealing unused flat cable connections	196090	ASI-SD-FK-BL

Product Range and Company Overview

A Complete Suite of Automation Services

Our experienced engineers provide complete support at every stage of your development process, including: conceptualization, analysis, engineering, design, assembly, documentation, validation, and production.



Custom Automation Components
Complete custom engineered solutions



Custom Control Cabinets
Comprehensive engineering support and on-site services



Complete Systems
Shipment, stocking and storage services

The Broadest Range of Automation Components

With a comprehensive line of more than 30,000 automation components, Festo is capable of solving the most complex automation requirements.



Electromechanical
Electromechanical actuators, motors, controllers & drives



Pneumatics
Pneumatic linear and rotary actuators, valves, and air supply



PLCs and I/O Devices
PLC's, operator interfaces, sensors and I/O devices

Supporting Advanced Automation... As No One Else Can!

Festo is a leading global manufacturer of pneumatic and electromechanical systems, components and controls for industrial automation, with more than 12,000 employees in 56 national headquarters serving more than 180 countries. For more than 80 years, Festo has continuously elevated the state of manufacturing with innovations and optimized motion control solutions that deliver higher performing, more profitable automated manufacturing and processing equipment. Our dedication to the advancement of automation extends beyond technology to the education and development of current and future automation and robotics designers with simulation tools, teaching programs, and on-site services.

Quality Assurance, ISO 9001 and ISO 14001 Certifications

Festo Corporation is committed to supply all Festo products and services that will meet or exceed our customers' requirements in product quality, delivery, customer service and satisfaction.

To meet this commitment, we strive to ensure a consistent, integrated, and systematic approach to management that will meet or exceed the requirements of the ISO 9001 standard for Quality Management and the ISO 14001 standard for Environmental Management.



© Copyright 2008, Festo Corporation. While every effort is made to ensure that all dimensions and specifications are correct, Festo cannot guarantee that publications are completely free of any error, in particular typing or printing errors. Accordingly, Festo cannot be held responsible for the same. For Liability and Warranty conditions, refer to our "Terms and Conditions of Sale", available from your local Festo office. All rights reserved. No part of this publication may be reproduced, distributed, or transmitted in any form or by any means, electronic, mechanical, photocopying or otherwise, without the prior written permission of Festo. All technical data subject to change according to technical update.



Printed on recycled paper at New Horizon Graphic, Inc., FSC certified as an environmentally friendly printing plant.

Festo North America

Festo Regional Contact Center

5300 Explorer Drive
Mississauga, Ontario L4W 5G4
Canada

USA Customers:

For ordering assistance,

Call: 1.800.99.FESTO (1.800.993.3786)

Fax: 1.800.96.FESTO (1.800.963.3786)

Email: customer.service@us.festo.com

For technical support,

Call: 1.866.GO.FESTO (1.866.463.3786)

Fax: 1.800.96.FESTO (1.800.963.3786)

Email: product.support@us.festo.com

Canadian Customers:

Call: 1.877.GO.FESTO (1.877.463.3786)

Fax: 1.877.FX.FESTO (1.877.393.3786)

Email: festo.canada@ca.festo.com

USA Headquarters

Festo Corporation
395 Moreland Road
P.O. Box 18023
Hauppauge, NY 11788, USA
www.festo.com/us

USA Sales Offices

Appleton

North 922 Tower View Drive, Suite N
Greenville, WI 54942, USA

Boston

120 Presidential Way, Suite 330
Woburn, MA 01801, USA

Chicago

1441 East Business Center Drive
Mt. Prospect, IL 60056, USA

Dallas

1825 Lakeway Drive, Suite 600
Lewisville, TX 75057, USA

Detroit – Automotive Engineering Center

2601 Cambridge Court, Suite 320
Auburn Hills, MI 48326, USA

New York

395 Moreland Road
Hauppauge, NY 11788, USA

Silicon Valley

4935 Southfront Road, Suite F
Livermore, CA 94550, USA

United States



USA Headquarters, East: Festo Corp., 395 Moreland Road, Hauppauge, NY 11788

Phone: 1.631.435.0800; Fax: 1.631.435.8026;

Email: info@festo-usa.com

www.festo.com/us

Canada



Headquarters: Festo Inc., 5300 Explorer Drive, Mississauga, Ontario L4W 5G4

Phone: 1.905.624.9000; Fax: 1.905.624.9001;

Email: festo.canada@ca.festo.com

www.festo.ca

Mexico



Headquarters: Festo Pneumatic, S.A., Av. Ceylán 3, Col. Tequesquahuac,
54020 Tlalneapantla, Edo. de México

Phone: 011 52 [55] 53 21 66 00; Fax: 011 52 [55] 53 21 66 65;

Email: festo.mexico@mx.festo.com

www.festo.com/mx

Central USA

Festo Corporation
1441 East Business
Center Drive
Mt. Prospect, IL 60056, USA
Phone: 1.847.759.2600
Fax: 1.847.768.9480



Western USA

Festo Corporation
4935 Southfront Road,
Suite F
Livermore, CA 94550, USA
Phone: 1.925.371.1099
Fax: 1.925.245.1286



Festo Worldwide

Argentina Australia Austria Belarus Belgium Brazil Bulgaria Canada Chile China Colombia Croatia Czech Republic Denmark
Estonia Finland France Germany Great Britain Greece Hong Kong Hungary India Indonesia Iran Ireland Israel Italy Japan Latvia
Lithuania Malaysia Mexico Netherlands New Zealand Norway Peru Philippines Poland Romania Russia Serbia Singapore
Slovakia Slovenia South Africa South Korea Spain Sweden Switzerland Taiwan Thailand Turkey Ukraine United States Venezuela

www.festo.com