

Short-stroke cylinders ADNE-LAS, with linear motor



Short-stroke cylinders ADNE-LAS, with linear motor

Key features



At a glance

| Properties | | Range of applications |
|---|---|---|
| <ul style="list-style-type: none"> • Electric short-stroke cylinder with integrated linear motor, specifically designed for dynamic movements between two end positions • A cycle of advancing and retracing motion over 15 mm can be achieved in 64 ms (movement frequency of up to 13.6 Hz) | <ul style="list-style-type: none"> • Festo plug & work: connect, switch on, teach-in end positions and then the system is ready to use. There is no need to set servo parameters • Mechanical interfaces are largely compatible with the pneumatic compact cylinder ADN | <ul style="list-style-type: none"> • Electronic end-position cushioning, i.e. constant force across the entire stroke with the force only reduced at the end positions as end-position cushioning • No external magnetic fields |
| | | <ul style="list-style-type: none"> • Dynamic movement with secondary accuracy requirements: <ul style="list-style-type: none"> – Switching deflectors – Rejecting good/bad parts from an ongoing production process – Blocking movements – Checking switches – Applying labels |

Everything from a single source

Short-stroke cylinder ADNE-LAS

→ 3



End-position controller CMFL

→ Internet: cmfl

- Short-stroke cylinder ADNE-LAS
- End-position controller CMFL
- Motor cable NEBM
- Power supply cable KPWR
- Pilot line KES

The short-stroke cylinder ADNE-LAS and the end-position controller CMFL form one unit. Only one cable is required between the short-stroke cylinder and end-position controller.

Movement pattern

Four movement patterns can be selected via inputs.

- | | |
|--|--|
| 1. Advancing | |
| 2. Retracting | |
| 3. Advancing and then retracting again | |
| 4. Retracting and then advancing again | |

Short-stroke cylinders ADNE-LAS, with linear motor

Type codes

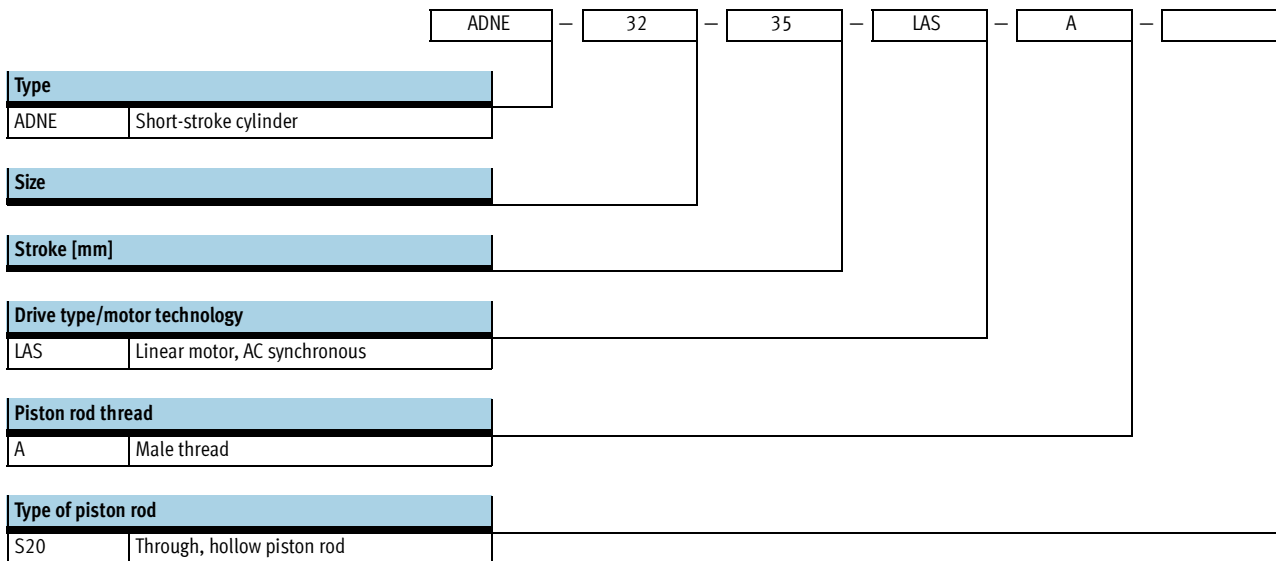

Short-stroke cylinders ADNE-LAS, with linear motor

Peripherals overview

FESTO

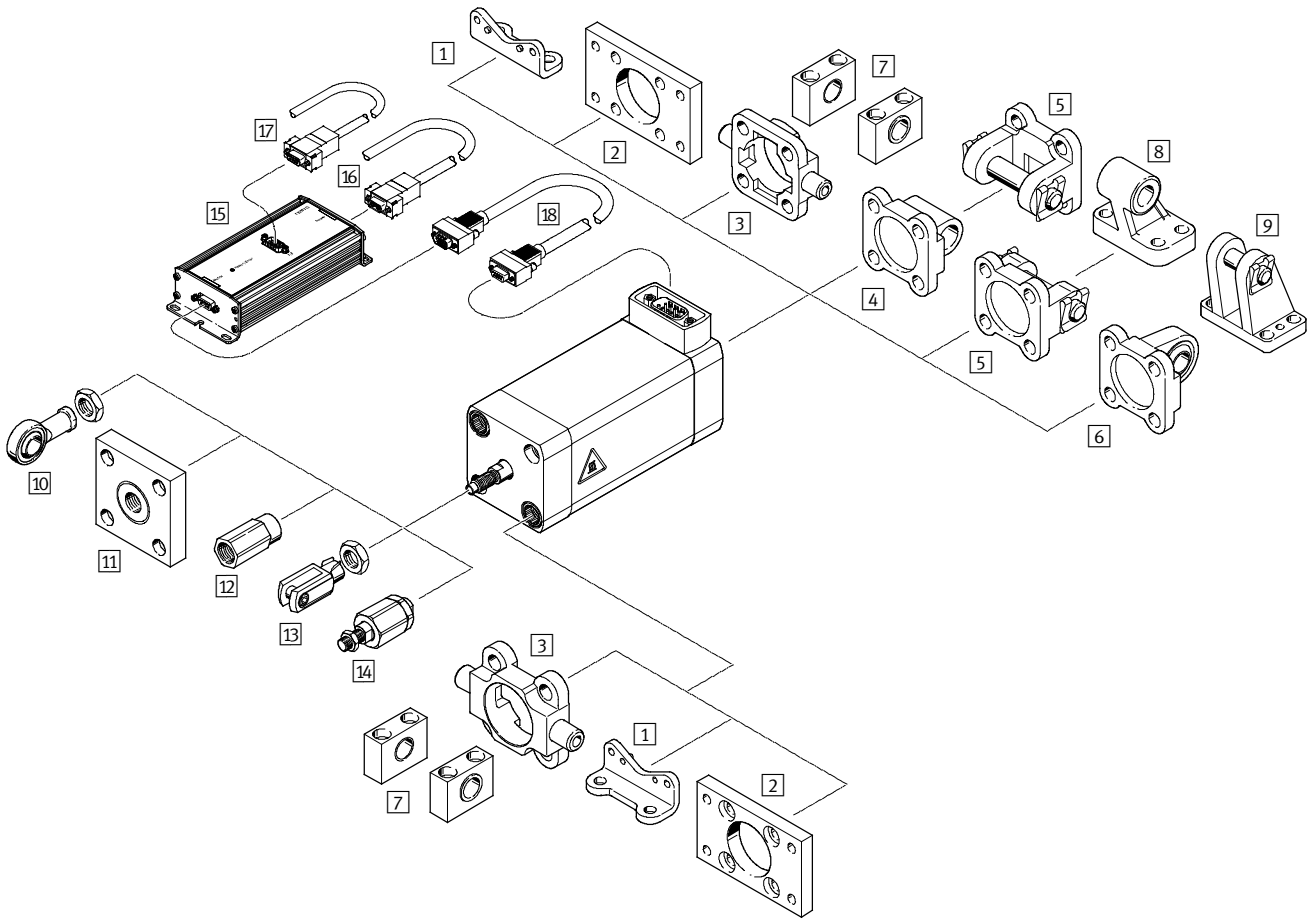

Short-stroke cylinders ADNE-LAS, with linear motor

Peripherals overview

| Mounting attachments and accessories | | | | | |
|--------------------------------------|---------------------------------|---|-----|-----------------|------|
| | Brief description | Variant | | → Page/Internet | |
| | | Basic version | S20 | | |
| 1 | Foot mounting HNA | For bearing or end caps | ■ | ■ | 15 |
| 2 | Flange mounting FNC | For bearing or end caps | ■ | ■ | 15 |
| 3 | Trunnion flange ZNCF | For bearing or end caps | ■ | ■ | 17 |
| 4 | Swivel flange SNCL | For end caps | ■ | – | 16 |
| 5 | Swivel flange SNCB | For end caps | ■ | – | 16 |
| 6 | Swivel flange SNCS | For end caps, with spherical bearing | ■ | – | 17 |
| 7 | Trunnion support LNZG | In combination with trunnion flange ZNCF | ■ | ■ | 18 |
| 8 | Clevis foot LNG | In combination with swivel flange SNCB | ■ | – | 18 |
| 9 | Clevis foot LBG | In combination with swivel flange SNCS | ■ | – | 18 |
| 10 | Rod eye SGS | With spherical bearing | ■ | ■ | 18 |
| 11 | Coupling piece KSZ | Compensates radial misalignments up to ±1 mm | ■ | ■ | 18 |
| 12 | Adapter AD | Specially for through, hollow piston rods, for example for connecting vacuum generators | ■ | ■ | 18 |
| 13 | Rod clevis SG | – | ■ | ■ | 18 |
| 14 | Self-aligning rod coupler FK | Compensates radial and angular misalignments | ■ | ■ | 18 |
| 15 | End-position controller CMFL | For parameterising and positioning the short-stroke cylinder | ■ | ■ | cmfl |
| 16 | Power supply cable KPWR | For connecting the load and logic supply | ■ | ■ | cmfl |
| 17 | Pilot line KES | For I/O interface to any controller | ■ | ■ | cmfl |
| 18 | Motor cable NEBM | For connecting the motor and end-position controller | ■ | ■ | cmfl |

Short-stroke cylinders ADNE-LAS, with linear motor

Technical data

Function

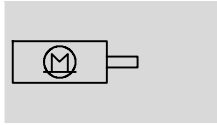

○ - Size
32, 40

┆ - Stroke length
15 ... 45 mm

⌀ - Note

All values are based on a standard temperature of 23 °C. Dynamic response and accuracy are dependent on the mounting (rigidity) and the derivation of the thermal energy (heat concentration).



| General technical data | | | | | |
|------------------------|-------|-----------------------------------|------|-----|------|
| Size | | 32 | | 40 | |
| Stroke | [mm] | 15 | 35 | 20 | 45 |
| Design | | Electric linear direct drive | | | |
| | | Electric cylinder with piston rod | | | |
| Based on standard | | ISO 21287 | | | |
| Type of mounting | | Via female thread | | | |
| | | Via accessories | | | |
| Mounting position | | Horizontal | | | |
| Minimum stroke | [mm] | 7.5 | 17.5 | 10 | 22.5 |
| Max. effective load | [g] | 500 | | | |
| Max. speed | [m/s] | 1.9 | 1.8 | 1.5 | 1.6 |
| Repetition accuracy | [mm] | ±0.1 | | | |

| Mechanical data | | | | | |
|--|-----------|------|------|------|------|
| Size | | 32 | | 40 | |
| Stroke | [mm] | 15 | 35 | 20 | 45 |
| Deflection of piston rod ¹⁾ | Retracted | [mm] | 0.14 | 0.14 | 0.15 |
| | Advanced | [mm] | 0.25 | 0.35 | 0.25 |
| At operating voltage of 48 V | | | | | |
| Continuous feed force ²⁾ | [N] | 10.5 | 5.9 | 14.2 | 11 |
| Peak feed force | [N] | 26 | 15 | 51 | 30 |
| Holding force in the end positions | [N] | 3 | 2 | 6 | 4.5 |
| At operating voltage of 24 V | | | | | |
| Continuous feed force ²⁾ | [N] | 10.5 | 5.9 | 14.2 | 11 |
| Peak feed force | [N] | 13 | 8 | 28 | 16 |
| Holding force in the end positions | [N] | 3 | 2 | 6 | 4.5 |

1) In new condition

2) Measured at a motor temperature of 70 °C

⌀ - Note

• Due to the maximum effective load of 500 g, the lateral force F_q of max. 5 N must not be exceeded.

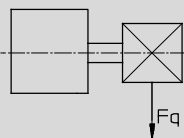

• No torques are permissible on the piston rod.

Short-stroke cylinders ADNE-LAS, with linear motor

Technical data

| Electrical data | |
|------------------------|-----------------------------|
| Motor type | Linear AC synchronous motor |
| End-position detection | Internal, non-contacting |
| Magnetic radiation | None |

| Operating and environmental conditions | |
|--|---|
| Ambient temperature | [°C] 0 ... +40 |
| Motor temperature during teach-in procedure | [°C] +15 ... +50 |
| Max. motor temperature | [°C] 70 (shuts down at 75 °C/in the event of a malfunction over 100 °C) |
| Standard temperature ¹⁾ | [°C] 23 |
| Temperature monitoring | Shuts down if motor overheats |
| Storage temperature | [°C] -20 ... +60 |
| Protection class (mechanical system) | IP40 |
| Protection class (electrical connection) | IP65 |
| Relative air humidity (non-condensing) | [%] 95 |
| CE marking (see declaration of conformity) | To EU EMC Directive |
| Certification | C-Tick |
| Corrosion resistance class CRC ²⁾ | 2 |

1) Unless otherwise stated, all values are based on standard temperature.

2) Corrosion resistance class 2 according to Festo standard 940 070

Components subject to moderate corrosion stress. Externally visible parts with primarily decorative surface requirements which are in direct contact with a normal industrial environment or media such as coolants or lubricating agents.

| Weight [g] | | | | | |
|----------------|------|-----|-----|-------|-------|
| Size | | 32 | | 40 | |
| Stroke | [mm] | 15 | 35 | 20 | 45 |
| Product weight | | 710 | 940 | 1,260 | 1,710 |
| | S20 | 725 | 960 | 1,290 | 1,750 |
| Moving load | | 105 | 130 | 275 | 350 |
| | S20 | 120 | 150 | 305 | 390 |

Short-stroke cylinders ADNE-LAS, with linear motor

Technical data

Materials

Sectional view

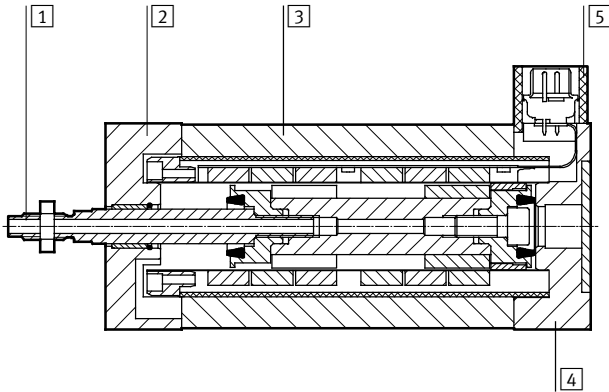

Short-stroke cylinder

| | | |
|---|-------------------|---|
| 1 | Piston rod | High-alloy stainless steel |
| 2 | Bearing cap | Anodised wrought aluminium alloy |
| 3 | Housing | Anodised wrought aluminium alloy |
| 4 | Connector cap | Anodised wrought aluminium alloy |
| 5 | Cover | Anodised wrought aluminium alloy |
| - | Plain bearing | Polyacetal |
| - | Screws, nuts | Steel |
| | Note on materials | Contains PWIS (paint-wetting impairment substances) RoHS-compliant |

Internal cushioning

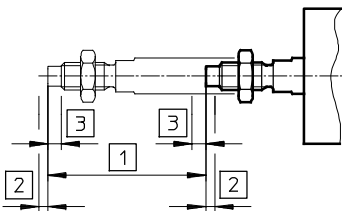

1 Working stroke:

The recommended, available operating range

2 Cushioning length:

The distance from the end positions of the working stroke to the mechanical end position

3 Rebound:

How far the drive rebounds depends on the load, the dynamics of the movement and the temperature of the cylinder

| Size | | 32 | 40 |
|-------------------------------|------|-----|-----|
| Stroke | [mm] | 15 | 20 |
| Working stroke | [mm] | 15 | 20 |
| Minimum stroke | [mm] | 7.5 | 10 |
| Cushioning length | [mm] | 0.7 | 0.8 |
| Rebound at 48 V ¹⁾ | [mm] | 0.8 | 0.5 |
| Rebound at 24 V ¹⁾ | [mm] | 0.3 | 0.5 |

1) Repeat the teach-in procedure if the rebound is too strong.

Short-stroke cylinders ADNE-LAS, with linear motor

Technical data

Max. frequency f as a function of effective load m and voltage U , briefly

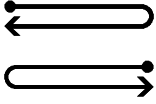

| Size | 32 | | 40 | | |
|------------------------------|-----------------------------|------|-----|------|-----|
| Stroke [mm] | 15 | 35 | 20 | 45 | |
| At operating voltage of 48 V | | | | | |
| Frequency | Effective load = 0 g [Hz] | 13.6 | 7.1 | 11.6 | 5.1 |
| | Effective load = 250 g [Hz] | 7.2 | 5.8 | 8.9 | 4.9 |
| | Effective load = 500 g [Hz] | 4.7 | 4.5 | 7 | 4.1 |
| At operating voltage of 24 V | | | | | |
| Frequency | Effective load = 0 g [Hz] | 11.1 | 5.5 | 8.8 | 4.2 |
| | Effective load = 250 g [Hz] | 9.1 | 4.7 | 7.2 | 3.9 |
| | Effective load = 500 g [Hz] | 6 | 3.2 | 5.4 | 3 |

Note
Applies to a motor temperature up to max. 74 °C.

Frequency f as a function of effective load m and voltage U , during continuous operation

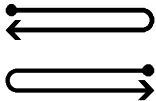

At $U = 48\text{ V}$
ADNE-32-15/35

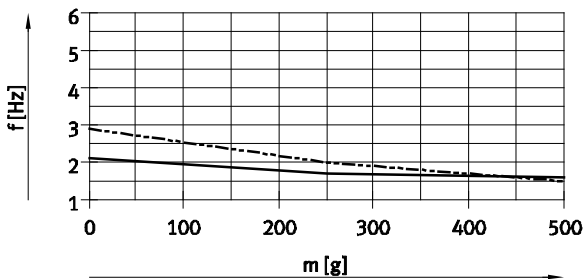

— ADNE-32-15
- - - ADNE-32-35

At $U = 24\text{ V}$
ADNE-32-15/35

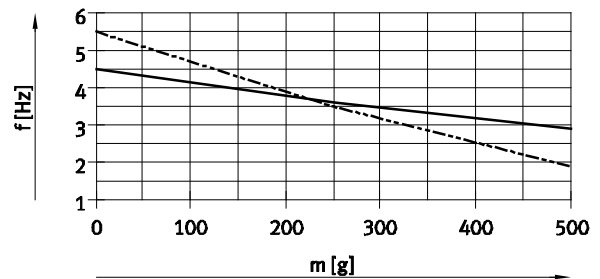

— ADNE-32-15
- - - ADNE-32-35

ADNE-40-20/45

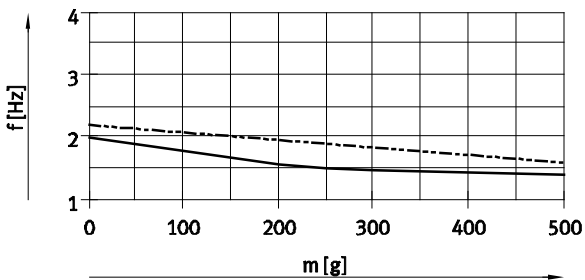

— ADNE-40-20
- - - ADNE-40-45

ADNE-40-20/45

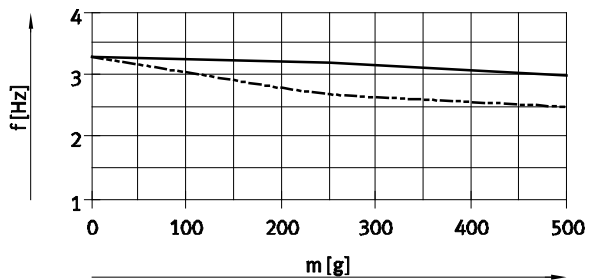

— ADNE-40-20
- - - ADNE-40-45

Short-stroke cylinders ADNE-LAS, with linear motor

Technical data

FESTO

Min. positioning time t as a function of voltage U , at an effective load of 0 g

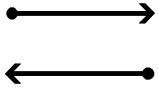

| | | | | | |
|------------------------------|------|----|----|----|-----|
| Size | | 32 | | 40 | |
| Stroke | [mm] | 15 | 35 | 20 | 45 |
| At operating voltage of 48 V | | | | | |
| Positioning time | [ms] | 30 | 48 | 36 | 75 |
| At operating voltage of 24 V | | | | | |
| Positioning time | [ms] | 30 | 62 | 44 | 100 |

Positioning time t as a function of effective load m and voltage U



At $U = 48\text{ V}$
ADNE-32-15/35

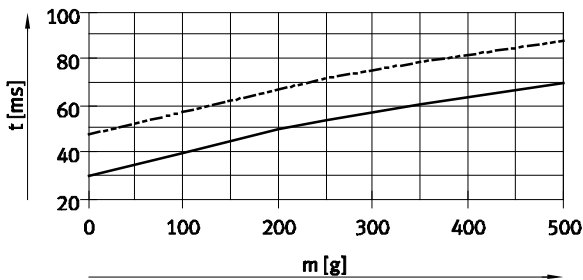

— ADNE-32-15
- - - ADNE-32-35

At $U = 24\text{ V}$
ADNE-32-15/35

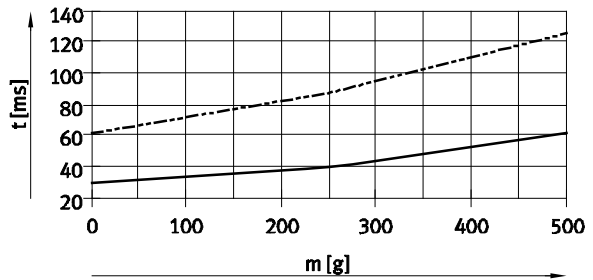

— ADNE-32-15
- - - ADNE-32-35

ADNE-40-20/45

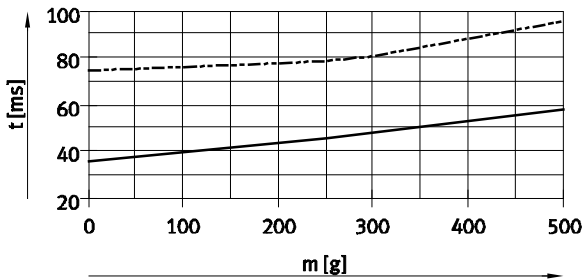

— ADNE-40-20
- - - ADNE-40-45

ADNE-40-20/45

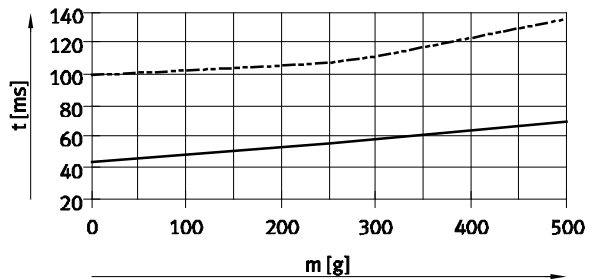

— ADNE-40-20
- - - ADNE-40-45

Short-stroke cylinders ADNE-LAS, with linear motor

Technical data

Min. positioning time t as a function of voltage U , at an effective load of 0 g

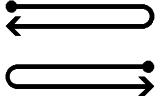

| Size | 32 | | 40 | |
|------------------------------|----|-----|----|-----|
| Stroke [mm] | 15 | 35 | 20 | 45 |
| At operating voltage of 48 V | | | | |
| Positioning time [ms] | 64 | 102 | 77 | 160 |
| At operating voltage of 24 V | | | | |
| Positioning time [ms] | 64 | 132 | 94 | 213 |

Positioning time t as a function of effective load m and voltage U

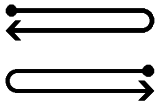

At $U = 48\text{ V}$
ADNE-32-15/35

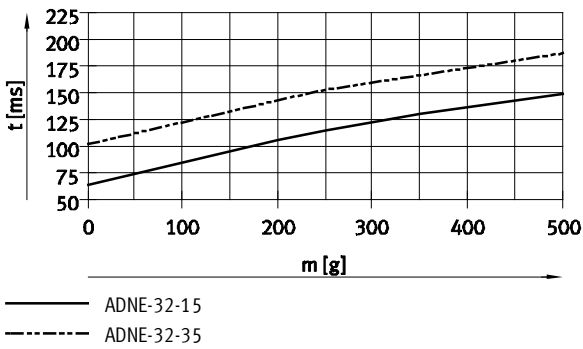

At $U = 24\text{ V}$
ADNE-32-15/35

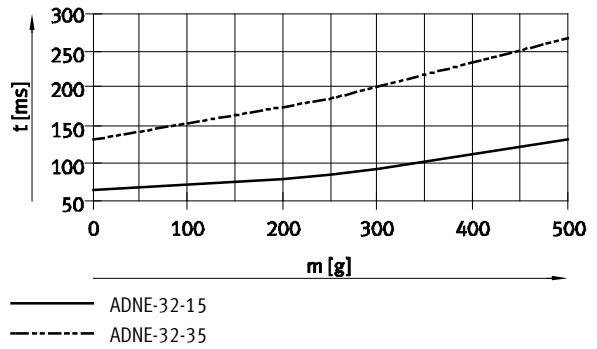

ADNE-40-20/45

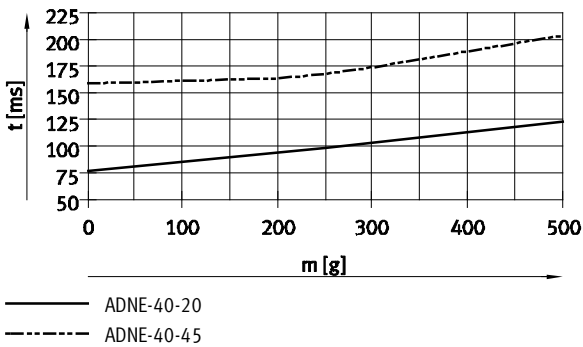

ADNE-40-20/45

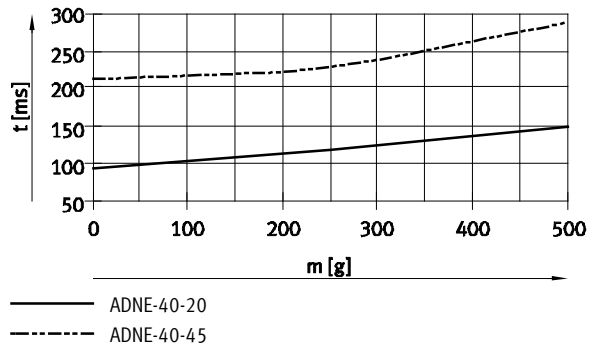

Short-stroke cylinders ADNE-LAS, with linear motor

Technical data

Dimensions – Basic version

Download CAD data → www.festo.com

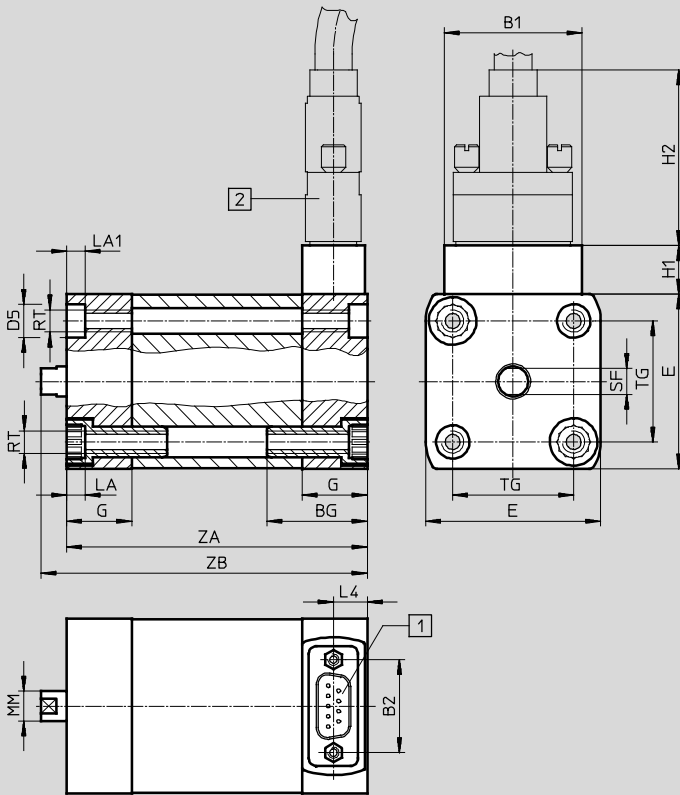

- 1 Electrical connection
- 2 Motor cable not included in the scope of delivery

| Size | Stroke [mm] | B1 | B2 | BG | D5 ∅ F9 | E +0.3 | G | H1 | H2 | LA +0.4 | | | | |
|------|----------------|----|----|----|---------------|-----------|------|----|----|------------|------|----|----|-----|
| 32 | 15 | 37 | 25 | 26 | 9 | 47 | 17.5 | 13 | 50 | 4.6 | | | | |
| | 35 | | | | | 54.5 | | | | | | | | |
| 40 | 20 | | | | | 54.5 | | | | | 17.5 | 13 | 50 | 4.6 |
| | 45 | | | | | 54.5 | | | | | 17.5 | 13 | 50 | 4.6 |

| Size | Stroke [mm] | LA1 | L4 | MM ∅ h9 | RT | SF h13 | TG ±0.2 | ZA +0.4/-0.2 | ZB +0.75/-0.35 | |
|------|----------------|-----|-----|---------------|----|-----------|------------|-----------------|-------------------|-------|
| 32 | 15 | 5 | 9.1 | 8 | M6 | 7 | 32.5 | 110.8 | 117.65 | |
| | 35 | | | 150.8 | | 157.65 | | | | |
| 40 | 20 | | | 10 | | 9 | | 38 | 136.5 | 143.4 |
| | 45 | | | 10 | | 9 | | 38 | 186.5 | 193.4 |

Short-stroke cylinders ADNE-LAS, with linear motor

Technical data

Dimensions – Variants Download CAD data → www.festo.com

A – Male thread

[1] Hex nut DIN 439-B included in the scope of delivery

| Size | Stroke [mm] | A -0.5 | D7 ∅ | D9 ∅ | KK | L5 | WH +0.75 -0.55 | ZB +0.75 -0.35 |
|------|----------------|-----------|---------|---------|----|----|----------------------|----------------------|
| 32 | 15 | 12 | 4.5 | 3.2 | M6 | 3 | 6.85 | 117.65 |
| | 35 | | | | | | | 157.65 |
| 40 | 20 | 16 | 6 | 3.8 | M8 | 2 | 6.9 | 143.4 |
| | 45 | | | | | | | 193.4 |

S20 – Through, hollow piston rod

[1] Hex nut DIN 439-B included in the scope of delivery
+ = plus stroke length

| Size | Stroke [mm] | A -0.5 | D7 ∅ | D9 ∅ | KK | L5 | WH +0.75 -0.55 | WH2 +0.55 -0.75 | ZM +0.6 -0.4 |
|------|----------------|-----------|---------|---------|----|----|----------------------|-----------------------|--------------------|
| 32 | 15 | 12 | 4.5 | 3.2 | M6 | 3 | 6.85 | 6.85 | 140 |
| | 35 | | | | | | | | 200 |
| 40 | 20 | 16 | 6 | 3.8 | M8 | 2 | 6.9 | 6.9 | 170.8 |
| | 45 | | | | | | | | 245.8 |

Short-stroke cylinders ADNE-LAS, with linear motor

Ordering data – Modular products

| Ordering table | | | | | |
|-----------------------------|--|---------------|-----------------|-------------|---------------|
| Size | 32 | 40 | Condi- tions | Code | Enter code |
| M Module No. | 566415 | 566416 | | | |
| Function | Electric short-stroke cylinder, based on ISO 21287 | | | ADNE | ADNE |
| Size | 32 | 40 | | -... | |
| Stroke [mm] | 15, 35 | 20, 45 | | -... | |
| Drive type | Linear motor | | | -L | -L |
| Motor technology | AC synchronous | | | AS | AS |
| Piston rod thread | Male thread | | | -A | A |
| O Type of piston rod | Through, hollow piston rod | | | -S20 | |

Transfer order code

| | | | | | | | | | | | | | |
|--|-------------|---|--|---|--|---|----------|--|-----------|---|----------|---|--|
| | ADNE | - | | - | | - | L | | AS | - | A | - | |
|--|-------------|---|--|---|--|---|----------|--|-----------|---|----------|---|--|

Short-stroke cylinders ADNE-LAS, with linear motor

Accessories

Foot mounting HNA

Material:
 HNA: Galvanised steel
 HNA-...-R3: Steel with protective coating
 Free of copper and PTFE
 RoHS-compliant

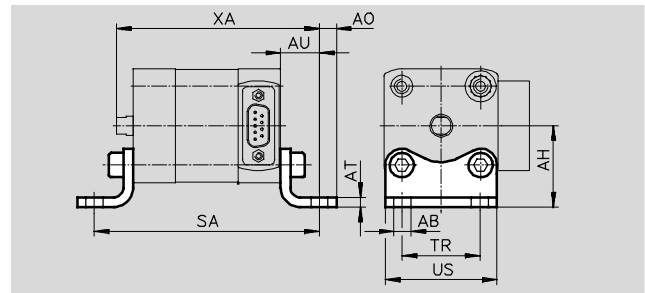

| Dimensions and ordering data | | | | | | | | | | |
|------------------------------|--------|----------|------|----|------|------|--------|------|------|--------|
| For size | Stroke | AB | AH | A0 | AT | AU | SA | TR | US | XA |
| | [mm] | ∅ H14 | JS14 | | ±0.5 | ±0.2 | | ±0.2 | -0.5 | |
| 32 | 15 | 7 | 33.5 | 7 | 4 | 16 | 142.8 | 32 | 46 | 133.65 |
| | 182.8 | | | | | | 173.65 | | | |
| 40 | 20 | 10 | 38 | 9 | 4 | 18 | 172.5 | 36 | 54 | 161.4 |
| | 222.5 | | | | | | 211.4 | | | |

| For size | Basic version | | | | High corrosion protection | | | |
|----------|-------------------|------------|----------|--------|---------------------------|------------|----------|-----------|
| | CRC ¹⁾ | Weight [g] | Part No. | Type | CRC ¹⁾ | Weight [g] | Part No. | Type |
| 32 | 1 | 123 | 537241 | HNA-32 | 3 | 123 | 537256 | HNA-32-R3 |
| 40 | 1 | 157 | 537242 | HNA-40 | 3 | 157 | 537257 | HNA-40-R3 |

Flange mounting FNC

Material:
 Galvanised steel
 Free of copper and PTFE
 RoHS-compliant

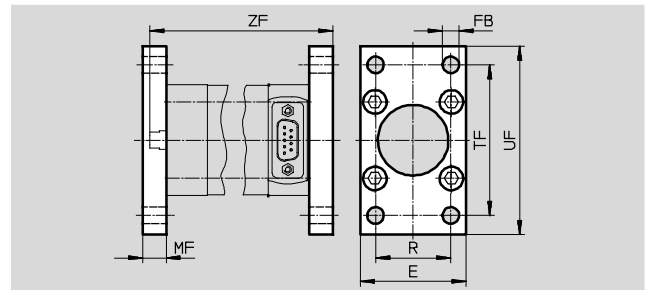

| Dimensions and ordering data | | | | | | | | |
|------------------------------|--------|----|----|----|----|----|----|--------|
| For size | Stroke | E | FB | MF | R | TF | UF | ZF |
| | [mm] | | ∅ | | | | ±1 | |
| 32 | 15 | 45 | 7 | 10 | 32 | 64 | 80 | 127.65 |
| | 35 | | | | | | | 167.65 |
| 40 | 20 | 54 | 9 | 10 | 36 | 72 | 90 | 153.4 |
| | 45 | | | | | | | 203.4 |

| For size | Basic version | | | | High corrosion protection | | | |
|----------|-------------------|------------|----------|--------|---------------------------|------------|----------|----------|
| | CRC ¹⁾ | Weight [g] | Part No. | Type | CRC ¹⁾ | Weight [g] | Part No. | Type |
| 32 | 1 | 221 | 174376 | FNC-32 | 4 | 225 | 161846 | CRFNG-32 |
| 40 | 1 | 291 | 174377 | FNC-40 | 4 | 300 | 161847 | CRFNG-40 |

1) Corrosion resistance class 1 according to Festo standard 940 070
 Components with light corrosion exposure. Protection for transport and storage. Components without significant decorative function or surface, e.g. installed out of sight internally or behind covers.
 Corrosion resistance class 2 according to Festo standard 940 070
 Components subject to moderate corrosion stress. Externally visible parts with primarily decorative surface requirements which are in direct contact with a normal industrial environment or media such as coolants or lubricating agents.

Corrosion resistance class 3 according to Festo standard 940 070
 Components subject to high corrosion stress. External visible parts in direct contact with industrial atmospheres or media such as solvents and cleaning agents, with a predominantly functional requirement for the surface.
 Corrosion resistance class 4 according to Festo standard 940 070
 Components subject to particularly high corrosion stress. Parts used with aggressive media, e.g. in the food or chemical industry. These applications should be supported with special tests with the media if required.

Short-stroke cylinders ADNE-LAS, with linear motor

Accessories



Swivel flange SNCL

Material:
 SNCL: Die-cast aluminium
 Free of copper and PTFE
 RoHS-compliant

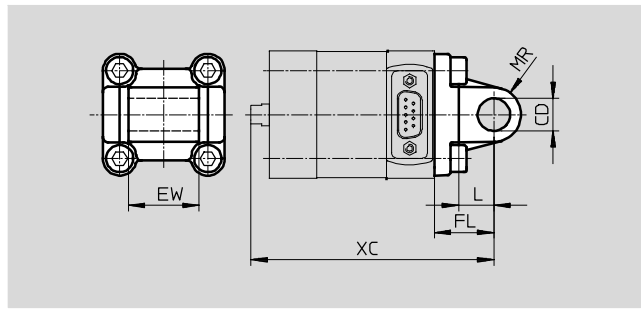

| Dimensions and ordering data | | | | | | | |
|------------------------------|--------|---------|-----|------|----|----|--------|
| For size | Stroke | CD | EW | FL | L | MR | XC |
| | [mm] | ∅ H9 | h12 | ±0.2 | | | |
| 32 | 15 | 10 | 26 | 22 | 13 | 10 | 139.65 |
| | 35 | | | | | | 179.65 |
| 40 | 20 | 12 | 28 | 25 | 16 | 12 | 168.4 |
| | 45 | | | | | | 218.4 |

| For size | Basic version | | Weight [g] | Part No. | Type |
|----------|-------------------|--|------------|----------|---------|
| | CRC ¹⁾ | | | | |
| 32 | 2 | | 85 | 174404 | SNCL-32 |
| 40 | 2 | | 115 | 174405 | SNCL-40 |

Swivel flange SNCB/SNCB-...-R3

Material:
 SNCB: Die-cast aluminium
 SNCB-...-R3: Die-cast aluminium with protective coating, high corrosion protection
 Free of copper and PTFE
 RoHS-compliant

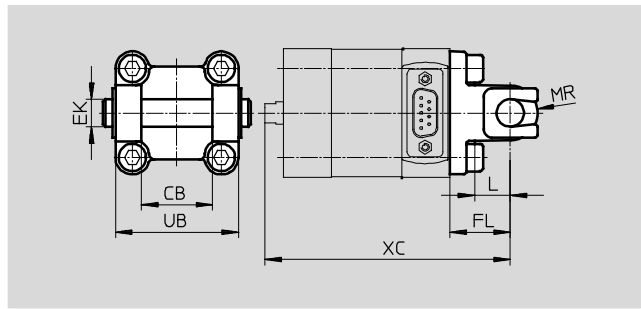

| Dimensions and ordering data | | | | | | | |
|------------------------------|--------|-----|---------|------|----|-----|--------|
| For size | Stroke | CB | EK | FL | L | MR | XC |
| | [mm] | H14 | ∅ e8 | ±0.2 | | | |
| 32 | 15 | 26 | 10 | 22 | 13 | 8.5 | 139.65 |
| | 35 | | | | | | 179.65 |
| 40 | 20 | 28 | 12 | 25 | 16 | 12 | 168.4 |
| | 45 | | | | | | 218.4 |

| For size | Basic version | | | High corrosion protection | | |
|----------|-------------------|------------|----------------|---------------------------|------------|-------------------|
| | CRC ¹⁾ | Weight [g] | Part No. Type | CRC ¹⁾ | Weight [g] | Part No. Type |
| 32 | 2 | 103 | 174390 SNCB-32 | 3 | 100 | 176944 SNCB-32-R3 |
| 40 | 2 | 155 | 174391 SNCB-40 | 3 | 151 | 176945 SNCB-40-R3 |

1) Corrosion resistance class 2 according to Festo standard 940 070
 Components subject to moderate corrosion stress. Externally visible parts with primarily decorative surface requirements which are in direct contact with a normal industrial environment or media such as coolants or lubricating agents.
 Corrosion resistance class 3 according to Festo standard 940 070
 Components subject to high corrosion stress. External visible parts in direct contact with industrial atmospheres or media such as solvents and cleaning agents, with a predominantly functional requirement for the surface.

Short-stroke cylinders ADNE-LAS, with linear motor

Accessories

Swivel flange SNCS

Material:
 SNCL: Die-cast aluminium
 Free of copper and PTFE
 RoHS-compliant

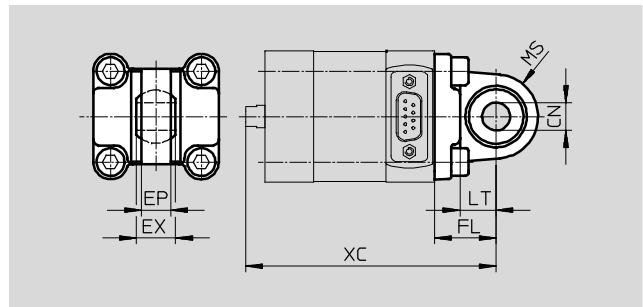

| Dimensions and ordering data | | | | | | | | |
|------------------------------|--------|---------------|------------|----|------------|----|----|--------|
| For size | Stroke | CN Ø H7 | EP ±0.2 | EX | FL ±0.2 | LT | MS | XC |
| 32 | 15 | 10 | 10.5 | 14 | 22 | 13 | 15 | 139.65 |
| | 35 | | | | | | | 179.65 |
| 40 | 20 | 12 | 12 | 16 | 25 | 16 | 17 | 168.4 |
| | 45 | | | | | | | 218.4 |

| For size | Basic version | | Weight [g] | Part No. | Type |
|----------|-------------------|--|---------------|----------|---------|
| | CRC ¹⁾ | | | | |
| 32 | 2 | | 85 | 174397 | SNCS-32 |
| 40 | 2 | | 125 | 174398 | SNCS-40 |

Trunnion flange ZNCF/CRZNG

Material:
 ZNCF: Stainless steel casting
 CRZNG: Electropolished stainless steel casting
 Free of copper and PTFE
 RoHS-compliant

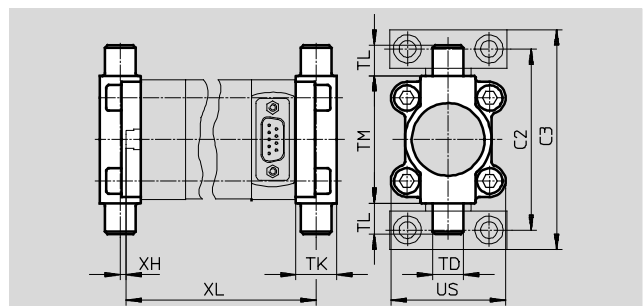

| Dimensions and ordering data | | | | | | | | | | |
|------------------------------|--------|----|-----|---------------|----|----|----|----|------|--------|
| For size | Stroke | C2 | C3 | TD Ø e9 | TK | TL | TM | US | XH | XL |
| 32 | 15 | 71 | 86 | 12 | 16 | 12 | 50 | 45 | 1.15 | 125.65 |
| | 35 | | | | | | | | | 165.65 |
| 40 | 20 | 87 | 105 | 16 | 20 | 16 | 63 | 54 | 3.1 | 153.4 |
| | 45 | | | | | | | | | 203.4 |





| For size | Basic version | | | High corrosion protection | | |
|----------|-------------------|---------------|----------------|---------------------------|---------------|-----------------|
| | CRC ¹⁾ | Weight [g] | Part No. Type | CRC ¹⁾ | Weight [g] | Part No. Type |
| 32 | 2 | 150 | 174411 ZNCF-32 | 4 | 150 | 161852 CRZNG-32 |
| 40 | 2 | 285 | 174412 ZNCF-40 | 4 | 285 | 161853 CRZNG-40 |

1) Corrosion resistance class 2 according to Festo standard 940 070
 Components subject to moderate corrosion stress. Externally visible parts with primarily decorative surface requirements which are in direct contact with a normal industrial environment or media such as coolants or lubricating agents.
 Corrosion resistance class 4 according to Festo standard 940 070
 Components subject to particularly high corrosion stress. Parts used with aggressive media, e.g. in the food or chemical industry. These applications should be supported with special tests with the media if required.

Short-stroke cylinders ADNE-LAS, with linear motor

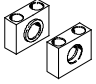
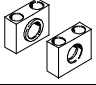
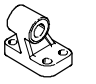
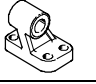
FESTO

Accessories

| Ordering data | | | |
|---|----------|----------|--------------|
| Designation | For size | Part No. | Type |
| Trunnion support LNZG | | | |
|  | 32 | 32959 | LNZG-32 |
| | 40 | 32960 | LNZG-40/50 |
| Trunnion support CRLNZG, corrosion-resistant | | | |
|  | 32 | 161874 | CRLNZG-32 |
| | 40 | 161875 | CRLNZG-40/50 |
| Clevis foot LNG | | | |
|  | 32 | 33890 | LNG-32 |
| | 40 | 33891 | LNG-40 |
| Clevis foot CRLNG, corrosion-resistant | | | |
|  | 32 | 161840 | CRLNG-32 |
| | 40 | 161841 | CRLNG-40 |
| Clevis foot LBG | | | |
|  | 32 | 31761 | LBG-32 |
| | 40 | 31762 | LBG-40 |
| Rod eye SGS | | | |
|  | 32 | 9254 | SGS-M6 |
| | 40 | 9255 | SGS-M8 |
| Rod eye CRSGS, corrosion-resistant | | | |
|  | 32 | 195580 | CRSGS-M6 |
| | 40 | 195581 | CRSGS-M8 |

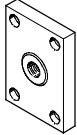
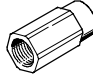
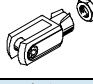
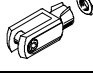
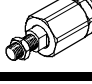
| Ordering data | | | |
|---|----------|----------|-----------|
| Designation | For size | Part No. | Type |
| Coupling piece KSZ | | | |
|  | 32 | 36123 | KSZ-M6 |
| | 40 | 36124 | KSZ-M8 |
| Adapter AD | | | |
|  | 32 | 157328 | AD-M6-M5 |
| | | 157329 | AD-M6-1/8 |
| | | 157330 | AD-M6-1/4 |
| | 40 | 157331 | AD-M8-1/8 |
| | | 157332 | AD-M8-1/4 |
| Rod clevis SG | | | |
|  | 32 | 3110 | SG-M6 |
| | 40 | 3111 | SG-M8 |
| Rod clevis CRSG, corrosion-resistant | | | |
|  | 32 | 13567 | CRSG-M6 |
| | 40 | 13568 | CRSG-M8 |
| Self-aligning rod coupler FK | | | |
|  | 32 | 2061 | FK-M6 |
| | 40 | 2062 | FK-M8 |