

Filters MS-LF/LFM/LFX, MS series, NPT

FESTO



Filters MS9-LF, MS series, NPT

Peripherals overview

FESTO

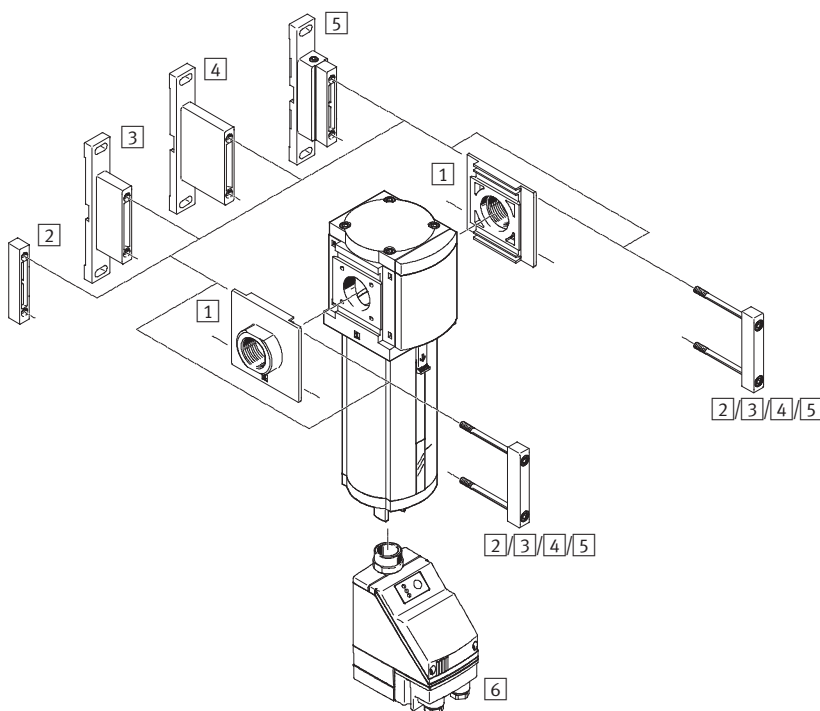

Note

Additional accessories:

- Module connector for combination with size MS6, MS9 or MS12 → Internet: rmv, armv

Mounting attachments and accessories					
		Individual device		Combination	➔ Page/ Internet
		With female thread N¾ or N1	With connecting plate AQ...	Module without connecting thread, without connecting plate G	
1	Connecting plate MS9-AQ...	–	■	■	ms9-aq
2	Module connector MS9-MV	–	–	■	ms9-mv
3	Mounting bracket MS9-WP	■	■	■	ms9-wp
4	Mounting bracket MS9-WPB	■	■	■	ms9-wp
5	Mounting bracket MS9-WPM	■	■	■	ms9-wp
6	Condensate drain, fully automatic, electrically actuated E2/E3/E4	■	■	■	8

Filters MS9-LF, MS series, NPT

Type codes

		MS	9	-	LF	-	G	-	E	U	M
Series											
MS	Standard service unit										
Size											
9	Grid dimension 90 mm										
Service function											
LF	Filter										
Connection size											
G	Module without connecting thread, without connecting plate										
Grade of filtration											
C	5 µm										
E	40 µm										
Bowl guard											
U	Integrated as metal bowl										
Condensate drain											
M	Manual rotary										
V	Fully automatic										

Additional variants can be ordered using the modular system → 8

- Connecting plates
- Condensate drain
- Type of mounting
- UL certification
- Alternative flow direction

Filters MS9-LF, MS series, NPT

FESTO

Technical data

Condensate drain,
manual rotary

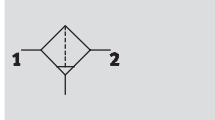

Condensate drain,
semi or fully automatic

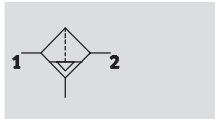

Flow rate
6,000 ... 16,000 l/min
Temperature range
-10 ... +60 °C
Pressure
0 ... 20 bar



- Good particle and condensate separation
- High flow rate with minimal pressure drop
- Available with manual, semi-automatic, fully automatic or fully automatic, electrically actuated condensate drain
- Choice of filter cartridges: 5 µm or 40 µm
- New filter cartridges → 29

General technical data				
Size	MS9			
Pneumatic connection 1, 2	NPT3/4-14	NPT1-11½	NPT1½-14 ... NPT1½-11½ (with connecting plate AQ...)	– (without connecting thread G)
Design	Sintered filter with centrifugal separator			
Type of mounting	Via accessories In-line installation			
Mounting position	Vertical ±5°			
Grade of filtration [µm]	5 40			
Air purity class at the output	Compressed air in accordance with ISO 8573-1:2010 [6:8:4] (grade of filtration 5 µm) Compressed air in accordance with ISO 8573-1:2010 [7:8:4] (grade of filtration 40 µm)			
Bowl guard	Integrated as metal bowl			
Condensate drain	Manual rotary Semi-automatic Fully automatic Fully automatic, electrically actuated			
Max. condensate volume [ml]	220			

Standard nominal flow rate qnN ¹⁾ [l/min]				
Pneumatic connection	Connecting plate AQR	Thread NPT3/4-14 or connecting plate AQS	Thread NPT1-11½ or connecting plate AQT/AQU/AQV	
Grade of filtration 5 µm	6,000	8,500	9,500	
Grade of filtration 40 µm	8,000	12,500	16,000	

1) Measured at p1 = 6 bar and Δp = 1 bar

Filters MS9-LF, MS series, NPT

Technical data

FESTO

Operating and environmental conditions				
Condensate drain	Manual rotary	Semi-automatic	Fully automatic	Fully automatic, electrically actuated
	M	H	V	E2/E3/E4
Operating pressure [bar]	0 ... 20	1.5 ... 12	2 ... 12	1 ... 16
Operating medium	Compressed air in accordance with ISO 8573-1:2010 [–:9:–]	Compressed air in accordance with ISO 8573-1:2010 [–:9:–]	Compressed air in accordance with ISO 8573-1:2010 [7:9:–]	Compressed air in accordance with ISO 8573-1:2010 [–:9:–]
Ambient temperature [°C]	–10 ... +60	+5 ... +60	+5 ... +60	+1 ... +60
Temperature of medium [°C]	–10 ... +60	+5 ... +60	+5 ... +60	+1 ... +60
Storage temperature [°C]	–10 ... +60	+5 ... +60	+5 ... +60	+1 ... +60
Corrosion resistance class CRC ¹⁾	2			
Certification (variant UL1)	cULus recognized (OL)			

1) Corrosion resistance class 2 according to Festo standard 940 070

Components subject to moderate corrosion stress. Externally visible parts with primarily decorative surface requirements which are in direct contact with a normal industrial environment or media such as coolants or lubricating agents.

Weight [g]	
Filter	2,000
Filter with condensate drain, fully automatic, electrically actuated E2/E3/E4	2,400

Materials

Sectional view

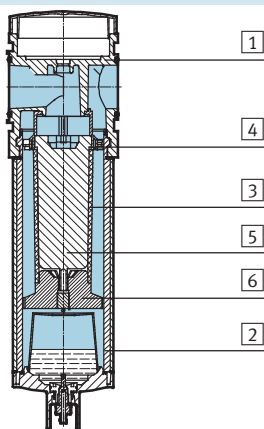

Filter		
1	Housing	Die-cast aluminium
2	Bowl	Wrought aluminium alloy
	Inspection window	PA
3	Filter	PE
4	Spin disc	POM
5	Filter holder	POM
6	Separating plate	POM
–	Cover	PA reinforced
–	Connecting plate, module connector, mounting bracket	Die-cast aluminium
–	Seals	NBR
Note on materials		RoHS-compliant (not with variant E2, E3 or E4)

Standard flow rate q_n as a function of differential pressure Δp_{1-2}

Grade of filtration 5 μm

MS9-LF-N1/AQT, pneumatic connection NPT1-11½

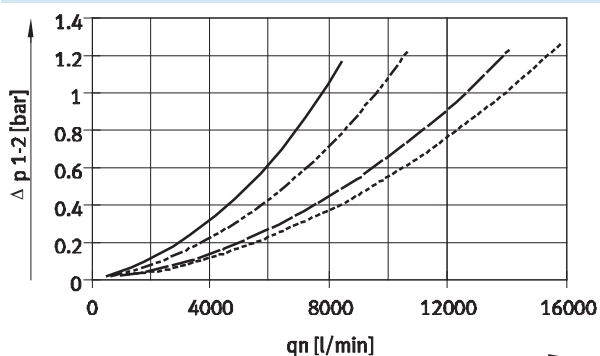

— 4 bar - · - 10 bar
- - - 6 bar · · · 12 bar

Grade of filtration 40 μm

MS9-LF-N1/AQT, pneumatic connection NPT1-11½

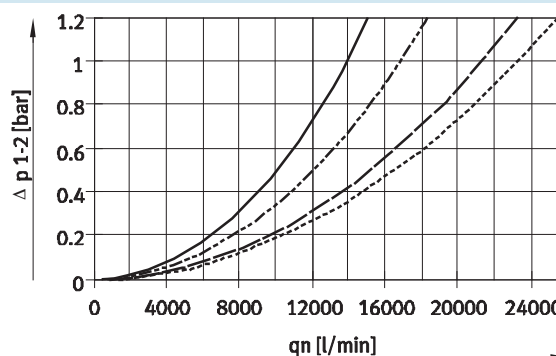

Filters MS9-LF, MS series, NPT

Technical data

FESTO

Dimensions – Basic version

Download CAD Data → www.festo.com/us/cad

Without connecting thread G

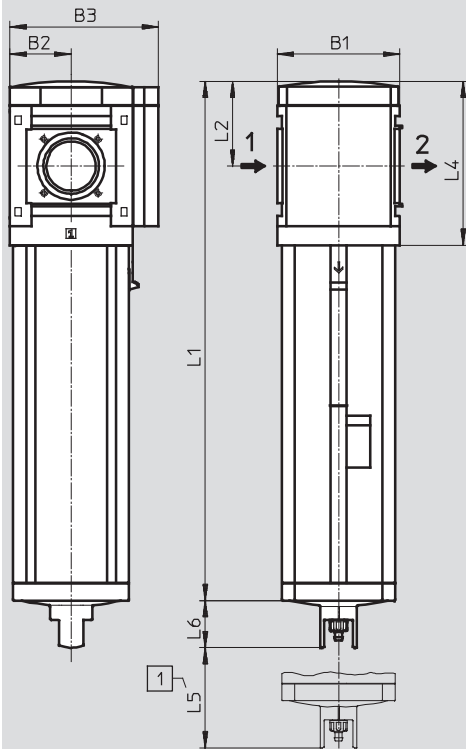

1 Installation dimensions

→ Flow direction

Type	B1	B2	B3	L1	L2	L4	L5	L6
MS9-LF-G	90	45	109	310.5	62	120	150	34.5

Dimensions – Connecting thread/connecting plate

Download CAD Data → www.festo.com/us/cad

With connecting thread N $\frac{3}{4}$ or N1

With connecting plate AQ...

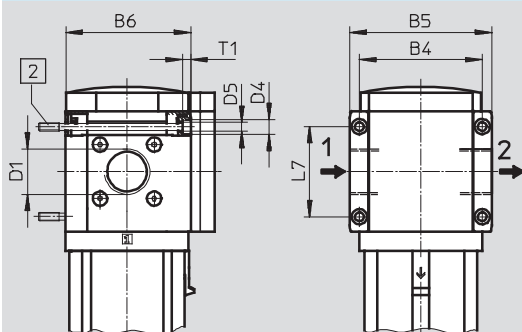

2 Mounting screw M6xmin.90 to DIN 912 (not included in the scope of delivery) for wall mounting without mounting bracket

→ Flow direction

Type	B4	B5	B6	B7	B8	D1	D4	D5	L7	T1	⌀C
MS9-LF-N $\frac{3}{4}$	90	104	91.5	–	–	NPT $\frac{3}{4}$ -14	11	6.5	66	6	–
MS9-LF-N1						NPT1-11 $\frac{1}{2}$					
MS9-LF-AQR	–	–	–	112	132	NPT $\frac{1}{2}$ -14	–	–	–	–	30
MS9-LF-AQS					132	NPT $\frac{3}{4}$ -14					36
MS9-LF-AQT					142	NPT1-11 $\frac{1}{2}$					41
MS9-LF-AQU					162	NPT1 $\frac{1}{4}$ -11 $\frac{1}{2}$					50
MS9-LF-AQV					176	NPT1 $\frac{1}{2}$ -11 $\frac{1}{2}$					55

Filters MS9-LF, MS series, NPT

Technical data

Dimensions – Condensate drain

Download CAD Data → www.festo.com/us/cad

Manual rotary M/fully automatic V

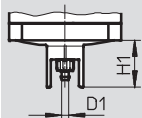

Barbed fitting for plastic tubing
PCN-4

Semi-automatic H

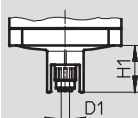

QS connector for plastic tubing
PUN-6/PAN-6

Fully automatic, electrically actuated E2/E3/E4

Technical data → Internet: [pwea](http://pwea.festo.com)

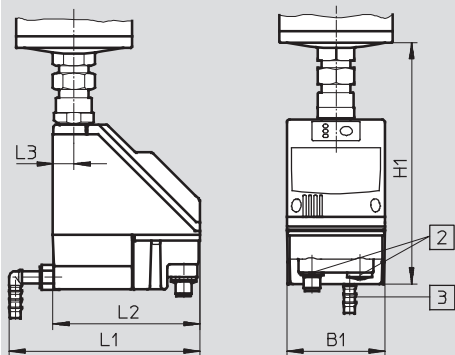

Condensate drain PWEA:

- 2 Electrical connection: Screw terminal PG9
- 3 Connection 360° rotatable for plastic tubing PUN-H-12x2

Type	B1	D1	H1	L1	L2	L3
MS9-LF-...-M/V	–	5	34.5	–	–	–
MS9-LF-...-H		6				
MS9-LF-...-E2/E3/E4	72	–	178	140	108	15

Ordering data

Size	Condensate drain	Connection	Grade of filtration 5 µm		Grade of filtration 40 µm	
			Part No.	Type	Part No.	Type
MS9	Manual rotary	–	564108	MS9-LF-G-CUM	564106	MS9-LF-G-EUM
	Fully automatic	–	564109	MS9-LF-G-CUV	564107	MS9-LF-G-EUV

Filters MS9-LF, MS series, NPT

Ordering data – Modular products

FESTO

M Mandatory data →						
Module No.	Series	Size	Function	Connection size	Grade of filtration	Bowl
562532	MS	9	LF	N $\frac{3}{4}$, N1, AQR, AQS, AQT, AQU, AQV, G	E, C	U
Ordering example						
562532	MS	9	- LF	- AQR	- E	- U

Ordering table					
Grid dimension [mm]		90	Condition s	Code	Enter code
M	Module No.	562532			
	Series	Standard		MS	MS
	Size	9		9	9
	Function	Filter		-LF	-LF
	Connection size	Thread NPT $\frac{3}{4}$		-N $\frac{3}{4}$	
		Thread NPT1		-N1	
		Connecting plate NPT $\frac{1}{2}$		-AQR	
		Connecting plate NPT $\frac{3}{4}$		-AQS	
		Connecting plate NPT1		-AQT	
		Connecting plate NPT1 $\frac{1}{4}$		-AQU	
		Connecting plate NPT1 $\frac{1}{2}$		-AQV	
		Module without connecting thread, without connecting plate		-G	
	Grade of filtration	40 µm		-E	
		5 µm		-C	
↓	Bowl	Metal bowl		-U	-U

Transfer order code

562532 MS 9 - LF - - - U

Filters MS9-LF, MS series, NPT

Ordering data – Modular products

→ M Mandatory data		O Options	
Condensate drain	Type of mounting	UL certification	Alternative flow direction
M, H, V, E2, E3, E4	WP, WPM, WPB	UL1	Z
- M	-	-	-

Ordering table					
Grid dimension	[mm]	90	Condition s	Code	Enter code
↓ M	Condensate drain	Manual		-M	
		Semi-automatic (P1 max. 12 bar)		-H	
		Fully automatic (P1 max. 12 bar)		-V	
	External, fully automatic, electric	110 V AC, terminals (P1 max. 16 bar)		-E2	
		230 V AC, terminals (P1 max. 16 bar)		-E3	
		24 V DC, terminals (P1 max. 16 bar)		-E4	
O	Type of mounting	Mounting bracket	1	-WP	
		Mounting bracket	1	-WPM	
		Mounting bracket for large wall gap	1	-WPB	
	UL certification	cULus, ordinary location for Canada and USA		-UL1	
	Alternative flow direction	Flow direction from right to left		-Z	

1 WP, WPM, WPB Not with module G

Transfer order code

- - - -

Fine and micro filters MS9-LFM, MS series, NPT

Peripherals overview

FESTO

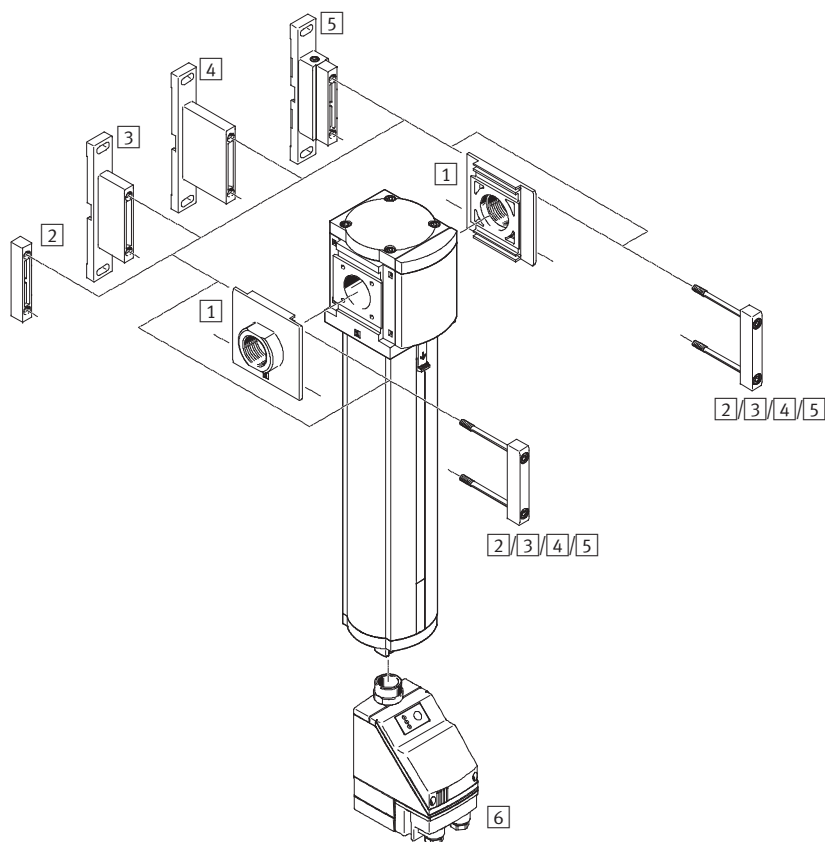

Note

Other accessories:

- Module connector for combination with size MS6, MS9 or MS12

→ Internet: rmv, armv

Mounting attachments and accessories					
		Individual device		Combination	➔ Page/ Internet
		With female thread N¾ or N1	With connecting plate AQ...	Module without connecting thread, without connecting plate G	
1	Connecting plate MS9-AQ...	–	■	■	ms9-aq
2	Module connector MS9-MV	–	–	■	ms9-mv
3	Mounting bracket MS9-WP	■	■	■	ms9-wp
4	Mounting bracket MS9-WPB	■	■	■	ms9-wp
5	Mounting bracket MS9-WPM	■	■	■	ms9-wp
6	Condensate drain, fully automatic, electrically actuated E2/E3/E4	■	■	■	20

Fine and micro filters MS9-LFM, MS series, NPT

Type codes

		MS	9	-	LFM	-	N1	-	A	U	M	-	HF	-	DA
Series															
MS	Standard service unit														
Size															
9	Grid dimension 90 mm														
Service function															
LFM	Fine and micro filter														
Pneumatic connection															
N3/4	Thread NPT3/4-14														
N1	Thread NPT1-11 1/2														
G	Module without connecting thread, without connecting plate														
Grade of filtration															
A	0.01 µm														
B	1 µm														
Bowl guard															
U	Integrated as metal bowl														
Condensate drain															
M	Manual rotary														
V	Fully automatic														
Flow rate															
	Standard														
HF	High flow rate														
Filter contamination sensor															
	Without differential pressure indicator														
DA	Differential pressure indicator														

Further variants can be ordered using the modular system → 20

- Connecting plates
- Condensate drain
- Type of mounting
- UL certification
- Alternative flow direction

Fine and micro filters MS9-LFM, MS series, NPT

Technical data

Condensate drain

Manual rotary

Without differential pressure indicator

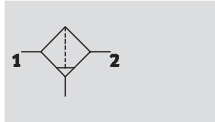

Flow rate

325 ... 10,000 l/min

Temperature range

-10 ... +60 °C

Pressure

0 ... 20 bar

With differential pressure indicator

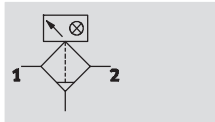

Condensate drain

Semi or fully automatic

Without differential pressure indicator

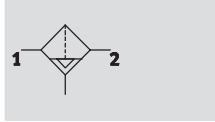

With differential pressure indicator

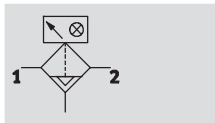

- High-performance filter for exceptionally clean compressed air
- Air quality to ISO 8573-1:2010
- Available with manual, semi-automatic, fully automatic or fully automatic, electrically actuated condensate drain
- Available with differential pressure indicator for indication of contamination
- Choice of filter cartridges: 0.01 µm or 1 µm
- New filter cartridges → 29

General technical data				
Size	MS9			
Pneumatic connection 1, 2	NPT3/4-14	NPT1-11½	NPT½-14 ... NPT1½-11½ (with connecting plate AQ...)	– (without connecting thread G)
Constructional design	Fibre filter			
Type of mounting	Via accessories			
	In-line installation			
Installation position	Vertical ±5°			
Grade of filtration [µm]	0.01 (micro filter MS9-LFM-A)			
	1 (fine filter MS9-LFM-B)			
Air purity class at the output	Compressed air in accordance with ISO 8573-1:2010 [1:7:2] (micro filter MS9-LFM-A)			
	Compressed air in accordance with ISO 8573-1:2010 [2:7:3] (fine filter MS9-LFM-B)			
Filter efficiency [%]	99.9999 (Grade of filtration 0.01 µm, micro filter MS9-LFM-A)			
	99.99 (Grade of filtration 1 µm, fine filter MS9-LFM-B)			
Bowl guard	Integrated as metal bowl			
Condensate drain	Manual rotary			
	Semi-automatic			
	Fully automatic			
	Fully automatic, electrically actuated			
Differential pressure indicator	Visual indicator			
Residual oil content [mg/m³]	≤0.01 (micro filter MS9-LFM-A)			
	≤0.5 (fine filter MS9-LFM-B)			
Max. condensate volume [cm³]	225			

Fine and micro filters MS9-LFM, MS series, NPT

Technical data

Standard flow rate $q_n^{1)}$ [l/min]		
Version	Standard	High flow rate HF
Micro filter MS9-LFM-A		
Max. standard flow rate for air purity class $q_{n \max}$	6,500	7,800
Min. standard flow rate for air purity class $q_{n \min}$	325	390
Fine filter MS9-LFM-B		
Max. standard flow rate for air purity class $q_{n \max}$	7,000	10,000
Min. standard flow rate for air purity class $q_{n \min}$	350	500

1) Measured at $p_1 = 6 \text{ bar}$

Operating and environmental conditions				
Condensate drain	Manual rotary	Semi-automatic	Fully automatic	Fully automatic, electrically actuated
	M	H	V	E2/E3/E4
Operating pressure [bar]	0 ... 20	1.5 ... 12	2 ... 12	0.8 ... 16
Operating medium	Compressed air in accordance with ISO 8573-1:2010 [6:8:4] ¹⁾			
Ambient temperature [°C]	-10 ... +60	+5 ... +60	+5 ... +60	+1 ... +60
Temperature of medium [°C]	-10 ... +60	+5 ... +60	+5 ... +60	+1 ... +60
Storage temperature [°C]	-10 ... +60	+5 ... +60	-10 ... +60	+1 ... +60
Corrosion resistance class CRC ²⁾	2			
Certification (variant UL1)	cULus recognized (OL)			

1) It is recommended to prefilter the compressed air for the micro filter MS-LFM-A using a fine filter MS-LFM-B (grade of filtration 1 μm).

2) Corrosion resistance class 2 according to Festo standard 940 070

Components subject to moderate corrosion stress. Externally visible parts with primarily decorative surface requirements which are in direct contact with a normal industrial environment or media such as coolants or lubricating agents.

Weights [g]		
Version	Standard	High flow rate HF
Fine and micro filter	2,000	2,500
Fine and micro filter with condensate drain fully automatic, electrically actuated E2/E3/E4	2,900	2,900

Materials

Sectional view

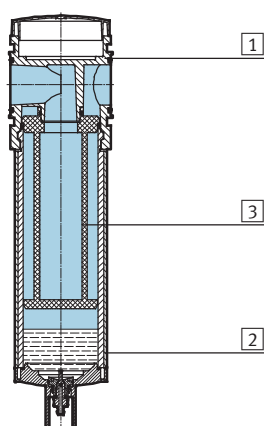

Fine and micro filters		
1	Housing	Die-cast aluminium
2	Bowl	Wrought aluminium alloy
	Inspection window	PA
3	Filter	Borosilicate fibre
-	Cover	PA reinforced
-	Connecting plate, module connector, mounting bracket	Die-cast aluminium
-	Seals	NBR
Note on materials		Free of copper and PTFE

Fine and micro filters MS9-LFM, MS series, NPT

Technical data

FESTO

Standard flow rate q_n as a function of the differential pressure p_{1-2}

Grade of filtration 0.01 μm

MS9-LFM-AQR, Pneumatic connection NPT $\frac{1}{2}$ -14

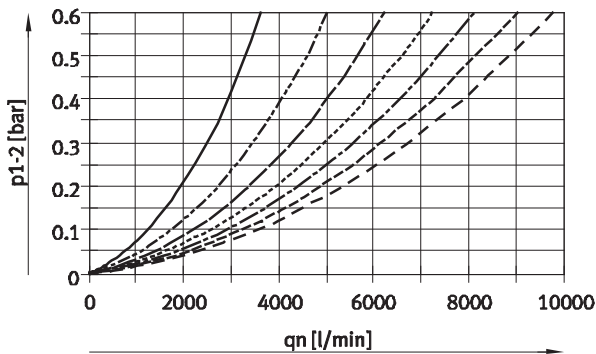

Grade of filtration 0.01 μm

MS9-LFM-N $\frac{3}{4}$ /AQS, Pneumatic connection NPT $\frac{3}{4}$ -14

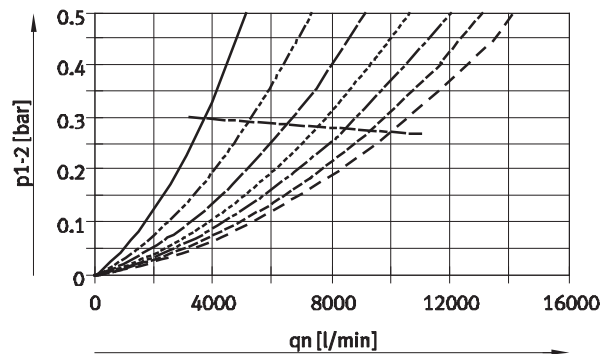

Grade of filtration 0.01 μm

MS9-LFM-N1/AQT, Pneumatic connection NPT1-11 $\frac{1}{2}$

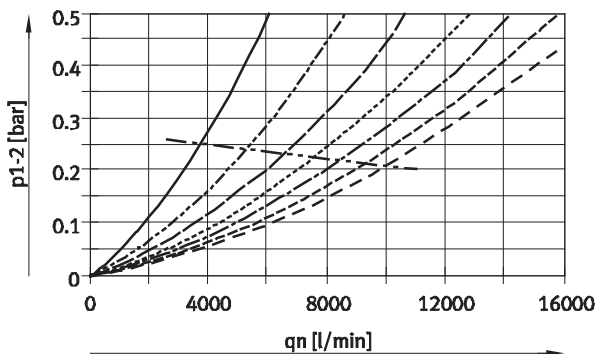

Grade of filtration 0.01 μm

MS9-LFM-AQU, Pneumatic connection NPT1 $\frac{1}{4}$ -11 $\frac{1}{2}$

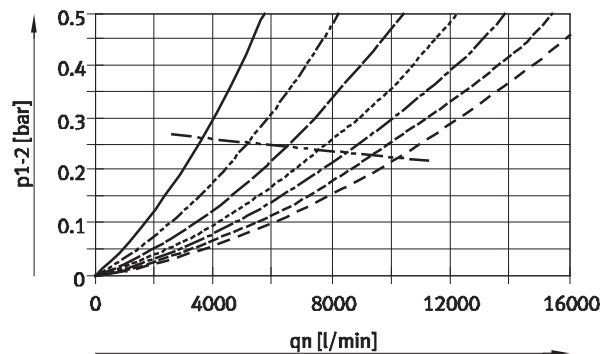

Grade of filtration 0.01 μm

MS9-LFM-AQV, Pneumatic connection NPT1 $\frac{1}{2}$ -11 $\frac{1}{2}$

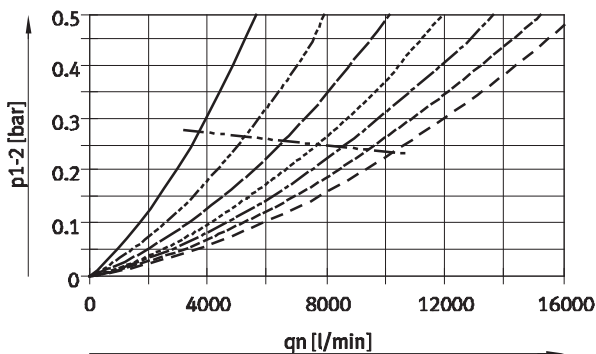

- 2 bar
- - - 4 bar ($q_{n \text{ min}}$: 268 l/min)
- · - 6 bar ($q_{n \text{ min}}$: 325 l/min)
- · · 8 bar
- - - 10 bar ($q_{n \text{ min}}$: 420 l/min)
- - - 12 bar
- - - 14 bar ($q_{n \text{ min}}$: 498 l/min)
- - - $q_{n \text{ max}}$
(with MS9-LFM-AQR: $q_{n \text{ max}}$ -values lie above the measured q_n -values)

Fine and micro filters MS9-LFM, MS series, NPT

Technical data

FESTO

Standard flow rate q_n as a function of the differential pressure p_{1-2}

Grade of filtration 1 μm

MS9-LFM-AQR, Pneumatic connection NPT $\frac{1}{2}$ -14

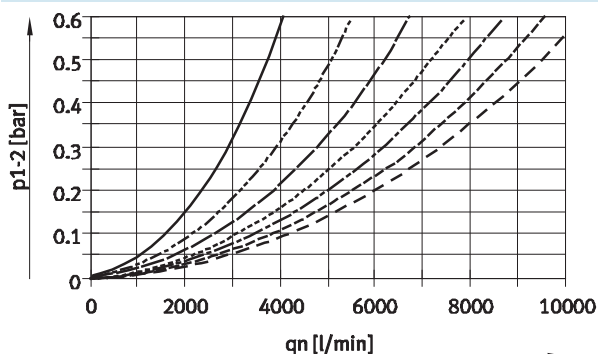

Grade of filtration 1 μm

MS9-LFM-N $\frac{3}{4}$ /AQS, Pneumatic connection NPT $\frac{3}{4}$ -14

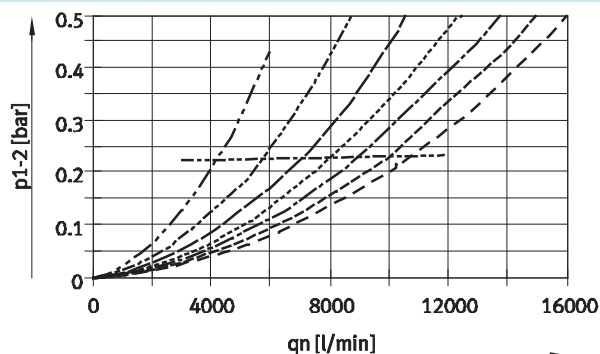

Grade of filtration 1 μm

MS9-LFM-N1/AQT, Pneumatic connection NPT1-11 $\frac{1}{2}$

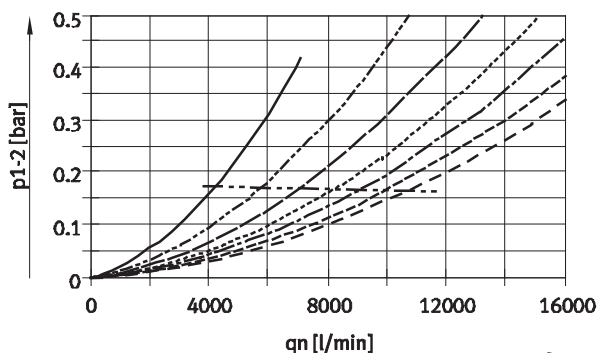

Grade of filtration 1 μm

MS9-LFM-AQU, Pneumatic connection NPT1 $\frac{1}{4}$ -11 $\frac{1}{2}$

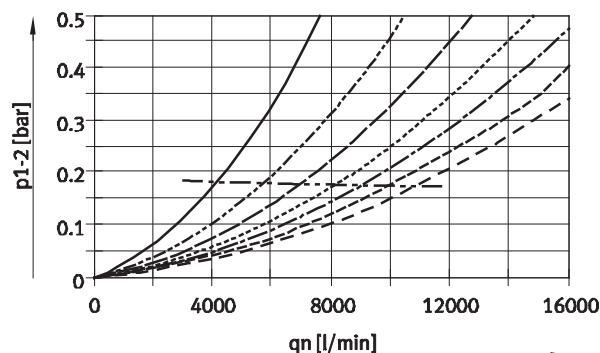

Grade of filtration 1 μm

MS9-LFM-AQV, Pneumatic connection NPT1 $\frac{1}{2}$ -11 $\frac{1}{2}$

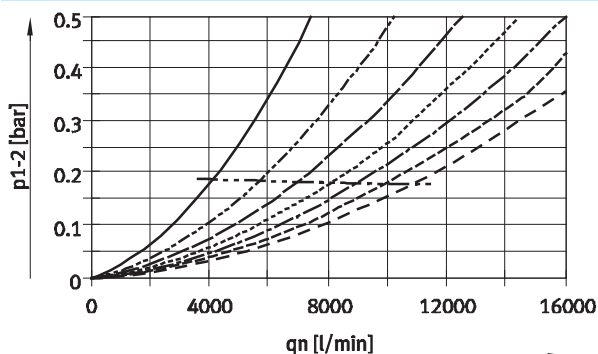

- 2 bar
- - - 4 bar ($q_{n \min}$: 289 l/min)
- · - 6 bar ($q_{n \min}$: 350 l/min)
- · · 8 bar
- - - 10 bar ($q_{n \min}$: 450 l/min)
- - - 12 bar
- - - 14 bar ($q_{n \min}$: 540 l/min)
- - - $q_{n \max}$
- (with MS9-LFM-AQR: $q_{n \max}$ -values lie above the measured q_n -values)

Fine and micro filters MS9-LFM, MS series, NPT

Technical data

FESTO

Standard flow rate q_n as a function of the differential pressure p_{1-2}

Grade of filtration 0.01 μm

MS9-LFM-N $\frac{3}{4}$ -...-HF, Pneumatic connection NPT $\frac{3}{4}$ -14

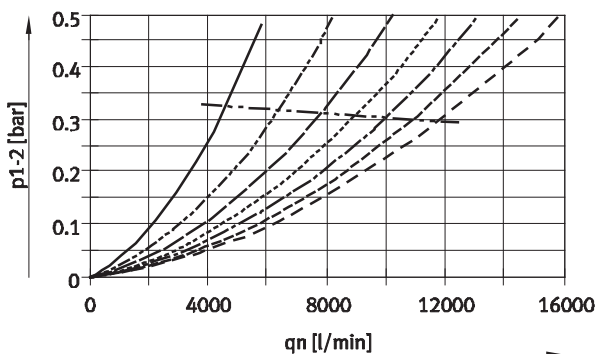

— 2 bar
- - - 4 bar
... 6 bar ($q_{n \min}$: 390 l/min)
- · - 8 bar
— · — 10 bar
- - - 12 bar
- · - 14 bar
... $q_{n \max}$

Grade of filtration 0.01 μm

MS9-LFM-N1-...-HF, Pneumatic connection NPT1-11 $\frac{1}{2}$

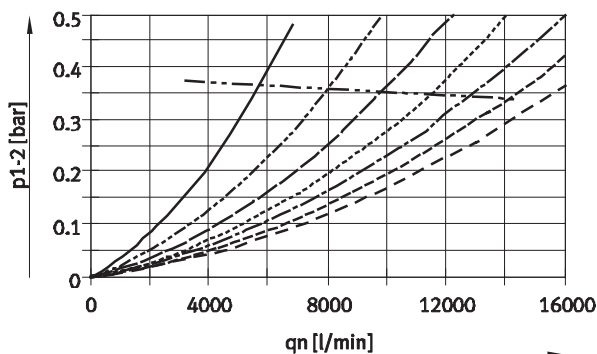

Grade of filtration 1 μm

MS9-LFM-N $\frac{3}{4}$ -...-HF, Pneumatic connection NPT $\frac{3}{4}$ -14

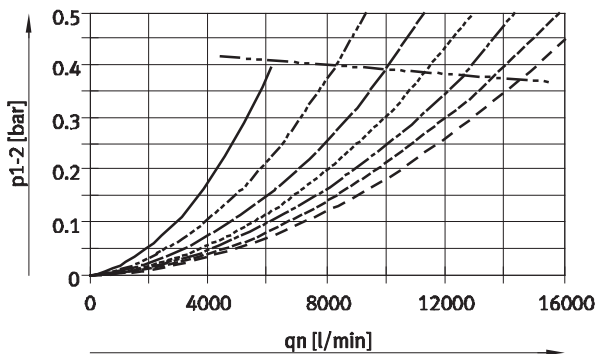

— 2 bar
- - - 4 bar
... 6 bar ($q_{n \min}$: 500 l/min)
- · - 8 bar
— · — 10 bar
- - - 12 bar
- · - 14 bar
... $q_{n \max}$

Grade of filtration 1 μm

MS9-LFM-N1-...-HF, Pneumatic connection NPT1-11 $\frac{1}{2}$

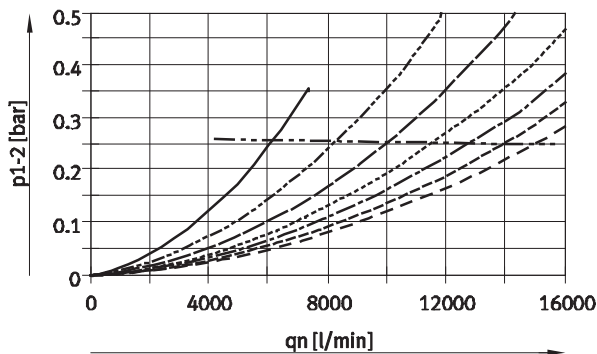

Fine and micro filters MS9-LFM, MS series, NPT

Technical data

Dimensions – Basic version

without connecting thread G

Download CAD Data → www.festo.com/us/cad

without connecting thread G, with differential pressure indicator DA

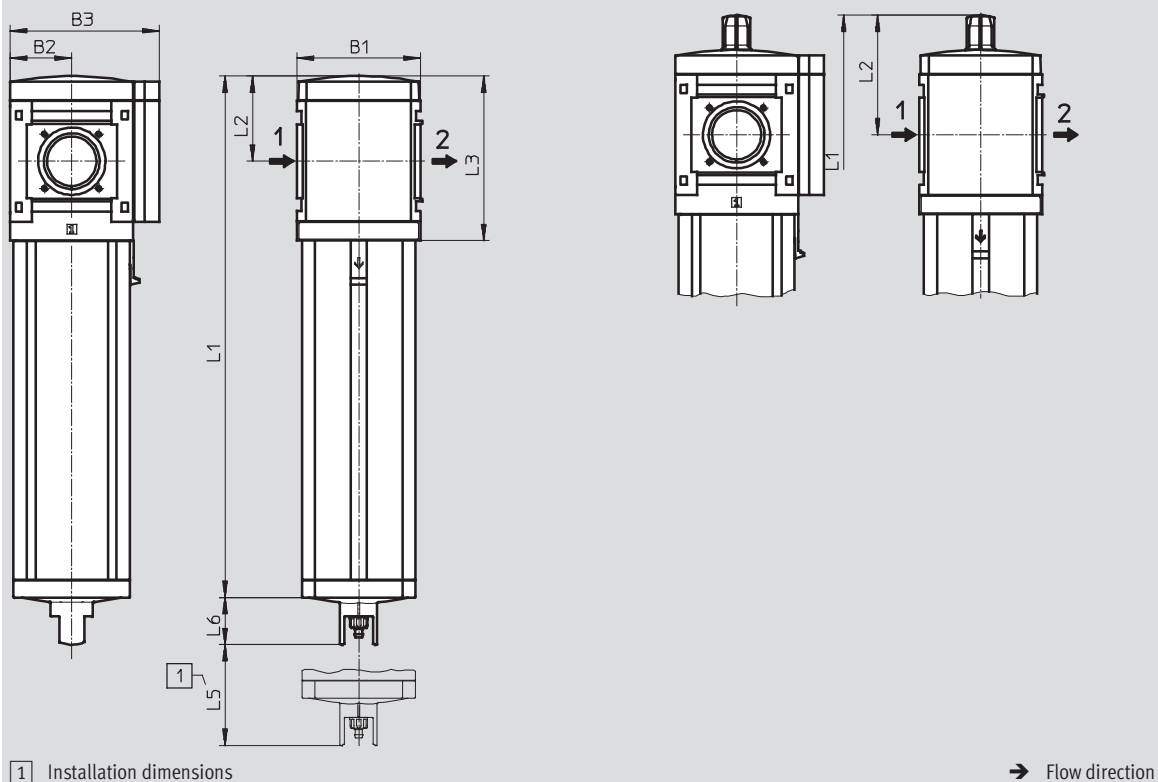

Type	B1	B2	B3	L1		L2	L3	L5	L6
				Standard	High flow rate HF				
MS9-LFM-G	90	45	109	380.5	480.5	62	120	50	34.5
MS9-LFM-G-...-DA				405.5	505.5	87			

Fine and micro filters MS9-LFM, MS series, NPT

Technical data

FESTO

Dimensions – Connecting thread/connecting plate

Download CAD Data → www.festo.com/us/cad

with connecting thread N $\frac{3}{4}$ or N1

with connecting plate AQ...

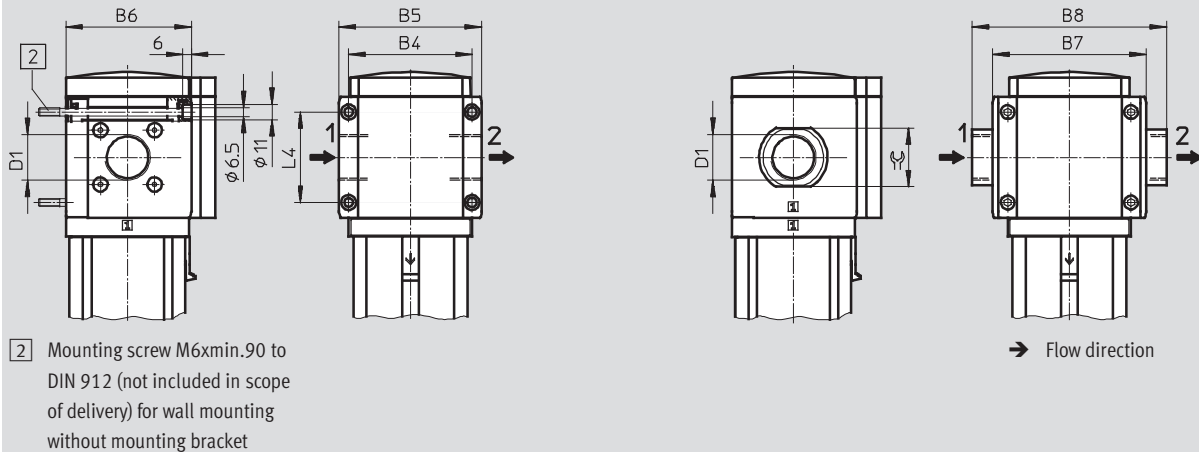

Type	B4	B5	B6	B7	B8	D1	L4	☞
MS9-LFM-N $\frac{3}{4}$	90	104	91.5	-	-	NPT $\frac{3}{4}$ -14	66	-
MS9-LFM-N1						NPT1-11 $\frac{1}{2}$		
MS9-LFM-AQR	-	-	-	112	132	NPT $\frac{1}{2}$ -14	-	30
MS9-LFM-AQS					132	NPT $\frac{3}{4}$ -14		36
MS9-LFM-AQT					142	NPT1-11 $\frac{1}{2}$		41
MS9-LFM-AQU					162	NPT1 $\frac{1}{4}$ -11 $\frac{1}{2}$		50
MS9-LFM-AQV					176	NPT1 $\frac{1}{2}$ -11 $\frac{1}{2}$		55

Dimensions – Condensate drain

Download CAD Data → www.festo.com/us/cad

Manual rotary M/fully automatic V

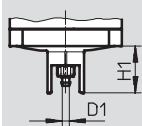

Barbed fitting for plastic tubing
PCN-4

Semi-automatic H

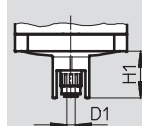

QS connector for plastic tubing
PUN-6/PAN-6

Fully automatic, electrically actuated E2/E3/E4

Technical data → Internet: pwea

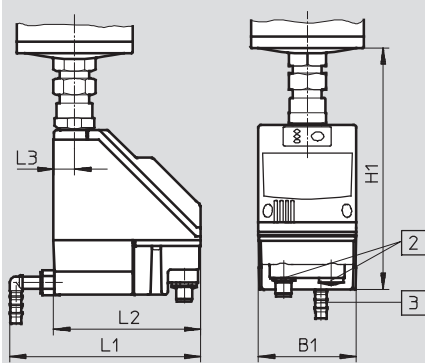

Condensate drain PWEA:

- 2 Electrical connection: Screw terminal PG9
- 3 Connection 360° rotatable for plastic tubing PUN-H-12x2

Type	B1	D1	H1	L1	L2	L3
MS9-LFM-...-M/V	-	5	34.5	-	-	-
MS9-LFM-...-H		6				
MS9-LFM-...-E2/E3/E4	72	-	178	140	108	15

Fine and micro filters MS9-LFM, MS series, NPT

Technical data

Ordering data						
Without differential pressure indicator						
Size	Condensate drain	Connection	Micro filter		Fine filter	
			Grade of filtration 0.01 μm		Grade of filtration 1 μm	
			Part No.	Type	Part No.	Type
Standard						
MS9	Manual rotary	NPT¾-14	553086	MS9-LFM-N¾-AUM	553090	MS9-LFM-N¾-BUM
		NPT1-11½	553016	MS9-LFM-N1-AUM	553020	MS9-LFM-N1-BUM
		–	564047	MS9-LFM-G-AUM	564039	MS9-LFM-G-BUM
	Fully automatic	NPT¾-14	553088	MS9-LFM-N¾-AUV	553092	MS9-LFM-N¾-BUV
		NPT1-11½	553018	MS9-LFM-N1-AUV	553022	MS9-LFM-N1-BUV
		–	564049	MS9-LFM-G-AUV	564041	MS9-LFM-G-BUV
High flow rate						
MS9	Manual rotary	NPT¾-14	552980	MS9-LFM-N¾-AUM-HF	552984	MS9-LFM-N¾-BUM-HF
		NPT1-11½	553054	MS9-LFM-N1-AUM-HF	553058	MS9-LFM-N1-BUM-HF
		–	564051	MS9-LFM-G-AUM-HF	564043	MS9-LFM-G-BUM-HF
	Fully automatic	NPT¾-14	552982	MS9-LFM-N¾-AUV-HF	552986	MS9-LFM-N¾-BUV-HF
		NPT1-11½	553056	MS9-LFM-N1-AUV-HF	553060	MS9-LFM-N1-BUV-HF
		–	564053	MS9-LFM-G-AUV-HF	564045	MS9-LFM-G-BUV-HF

Ordering data						
With differential pressure indicator						
Size	Condensate drain	Connection	Micro filter		Fine filter	
			Grade of filtration 0.01 μm		Grade of filtration 1 μm	
			Part No.	Type	Part No.	Type
Standard						
MS9	Manual rotary	NPT¾-14	553094	MS9-LFM-N¾-AUM-DA	553098	MS9-LFM-N¾-BUM-DA
		NPT1-11½	553024	MS9-LFM-N1-AUM-DA	553028	MS9-LFM-N1-BUM-DA
		–	564048	MS9-LFM-G-AUM-DA	564040	MS9-LFM-G-BUM-DA
	Fully automatic	NPT¾-14	553096	MS9-LFM-N¾-AUV-DA	553100	MS9-LFM-N¾-BUV-DA
		NPT1-11½	553026	MS9-LFM-N1-AUV-DA	553030	MS9-LFM-N1-BUV-DA
		–	564050	MS9-LFM-G-AUV-DA	564042	MS9-LFM-G-BUV-DA
High flow rate						
MS9	Manual rotary	NPT¾-14	552988	MS9-LFM-N¾-AUM-HF-DA	552992	MS9-LFM-N¾-BUM-HF-DA
		NPT1-11½	553062	MS9-LFM-N1-AUM-HF-DA	553066	MS9-LFM-N1-BUM-HF-DA
		–	564052	MS9-LFM-G-AUM-HF-DA	564044	MS9-LFM-G-BUM-HF-DA
	Fully automatic	NPT¾-14	552990	MS9-LFM-N¾-AUV-HF-DA	552994	MS9-LFM-N¾-BUV-HF-DA
		NPT1-11½	553064	MS9-LFM-N1-AUV-HF-DA	553068	MS9-LFM-N1-BUV-HF-DA
		–	564054	MS9-LFM-G-AUV-HF-DA	564046	MS9-LFM-G-BUV-HF-DA

Fine and micro filters MS9-LFM, MS series, NPT

Ordering data – Modular products

FESTO

M **Mandatory data** →

Module No.	Series	Size	Function	Connection size	Grade of filtration	Bowl
552940	MS	9	LFM	N $\frac{3}{4}$, N1, AQR, AQS, AQT, AQU, AQV, G	B, A	U
Order example						
552940	MS	9	- LFM	- AQR	- B	- U

Ordering table					
Grid dimension	[mm]	90	Condition s	Code	Enter code
M Module No.	552940				
Series	Standard service unit			MS	MS
Size	9			9	9
Function	Fine and micro filter			-LFM	-LFM
Connection size	Thread NPT $\frac{3}{4}$			-N$\frac{3}{4}$	
	Thread NPT1			-N1	
	Connecting plate NPT $\frac{1}{2}$			-AQR	
	Connecting plate NPT $\frac{3}{4}$			-AQS	
	Connecting plate NPT1			-AQT	
	Connecting plate NPT1 $\frac{1}{4}$			-AQU	
	Connecting plate NPT1 $\frac{1}{2}$			-AQV	
	Module without connecting thread, without connecting plate			-G	
Grade of filtration	μ m	1		-B	
		0.01		-A	
↓ Bowl	Metal bowl			-U	-U

Transfer order code

552940	MS	9	- LFM	-		-		- U
--------	----	---	-------	---	--	---	--	-----

Fine and micro filters MS9-LFM, MS series, NPT

Ordering data – Modular products

→ M Mandatory data		O Options			
Condensate drain	Flow rate	Filter contamination sensor	Type of mounting	UL certification	Alternative flow direction
M, H, V, E2, E3, E4	HF	DA	WP, WPM, WPB	UL1	Z
- M	-	-	-	-	-

Ordering table					
Grid dimension	[mm]	90	Condition s	Code	Enter code
↓ M	Condensate drain	Manual		-M	
		Semi-automatic (P1 max. 12 bar)		-H	
		Fully automatic (P1 max. 12 bar)		-V	
		External fully automatic condensate drain, electrical, 110 V AC, terminal strip		-E2	
		External fully automatic condensate drain, electrical, 230 V AC, terminal strip		-E3	
		External fully automatic condensate drain, electrical, 24 V DC, terminal strip		-E4	
O	Flow rate	High flow rate		-HF	
	Filter contamination sensor	Differential pressure indicator, visual		-DA	
	Type of mounting	Mounting bracket	1	-WP	
		Mounting bracket	1	-WPM	
		Wall mounting bracket for large wall gap	1	-WPB	
	UL certification	cULus, ordinary location for Canada and USA		-UL1	
	Alternative flow direction	Flow direction from right to left		-Z	

1 WP, WPM, WPB Not with module G

Transfer order code

- - - - - -

Activated carbon filters MS9-LFX, MS series, NPT

Peripherals overview

FESTO

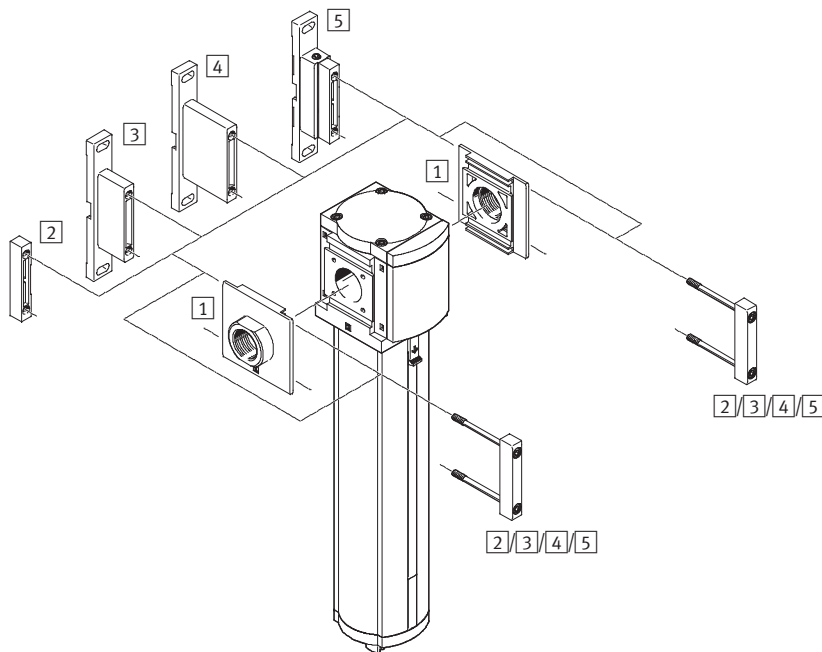

Note

Other accessories:

- Module connector for combination with size MS6, MS9 or MS12

➔ Internet: rmv, armv

Mounting attachments and accessories					
		Individual device		Combination	➔ Page/ Internet
		With female thread N¾ or N1	With connecting plate AQ...	Module without connecting thread, without connecting plate G	
1	Connecting plate MS9-AQ...	–	■	■	ms9-aq
2	Module connector MS9-MV	–	–	■	ms9-mv
3	Mounting bracket MS9-WP	■	■	■	ms9-wp
4	Mounting bracket MS9-WPB	■	■	■	ms9-wp
5	Mounting bracket MS9-WPM	■	■	■	ms9-wp

Activated carbon filters MS9-LFX, MS series, NPT

Type codes

		MS	9	–	LFX	–	N $\frac{3}{4}$	–	U
Series									
MS	Standard service unit								
Size									
9	Grid dimension 90 mm								
Service function									
LFX	Activated carbon filter								
Pneumatic connection									
N $\frac{3}{4}$	Thread NPT $\frac{3}{4}$ -14								
N1	Thread NPT1-1 $\frac{1}{2}$								
G	Module without connecting thread, without connecting plate								
Bowl guard									
U	Integrated as metal bowl								

Further variants can be ordered using the modular system → 28

- Connecting plates
- Type of mounting
- UL certification
- Alternative flow direction

Activated carbon filters MS9-LFX, MS series, NPT

FESTO

Technical data

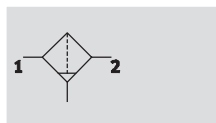

Flow rate
max. 6,500 l/min
Temperature range
-10 ... +60 °C
Pressure
0 ... 20 bar



- Removal of liquid and gaseous oil particles from compressed air using activated carbon
- Eliminates odours and vapours
- Prefiltration with micro filter MS9-LFM-A, grade of filtration 0.01 µm, recommended
- New filter cartridges → 29

General technical data				
Size	MS9			
Pneumatic connection 1, 2	NPT3/4-14	NPT1-11½	NPT½-14 ... NPT1½-11½ (with connecting plate AQ...)	– (without connecting thread G)
Constructional design	Activated carbon filter			
Type of mounting	Via accessories			
	In-line installation			
Installation position	Vertical ±5°			
Air purity class at the output ¹⁾	Compressed air in accordance with ISO 8573-1:2010 [1:4:1]			
Bowl guard	Integrated as metal bowl			
Residual oil content [mg/m³]	≤0.003			

1) It is recommended to replace filter cartridges after 1,000 operating hours (applies to an ambient temperature of 21 °C). The service life of a filter cartridge is reduced at higher temperatures.

Standard flow rate $q_n^{1)}$ [l/min]	
Max. standard flow rate for air purity class $q_{n \max}$	6,500

1) Measured at $p_1 = 6 \text{ bar}$

Operating and environmental conditions	
Operating pressure [bar]	0 ... 20
Operating medium	Compressed air in accordance with ISO 8573-1:2010 [1:4:2]
Ambient temperature [°C]	-10 ... +60
Temperature of medium [°C]	+5 ... +30
Storage temperature [°C]	-10 ... +60
Corrosion resistance class CRC ²⁾	2
Certification (variant UL1)	cULus recognized (OL)

1) Corrosion resistance class 2 according to Festo standard 940 070
Components subject to moderate corrosion stress. Externally visible parts with primarily decorative surface requirements which are in direct contact with a normal industrial environment or media such as coolants or lubricating agents.

Weights [g]	
Activated carbon filter	2,000

Activated carbon filters MS9-LFX, MS series, NPT

Technical data

Materials

Sectional view

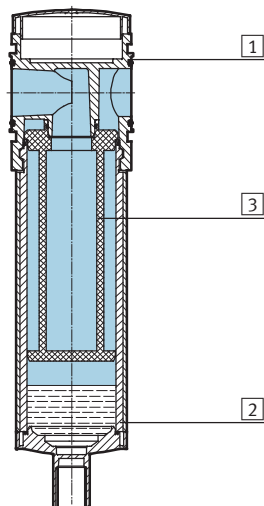

Activated carbon filter

1	Housing	Die-cast aluminium
2	Bowl	Wrought aluminium alloy
	Inspection window	PA
3	Filter	Activated carbon
-	Cover	PA reinforced
-	Connecting plate, module connector, mounting bracket	Die-cast aluminium
-	Seals	NBR
Note on materials		Free of copper and PTFE

Standard flow rate q_n as a function of the differential pressure p_{1-2}

MS9-LFX-AQR, Pneumatic connection NPT $\frac{1}{2}$ -14

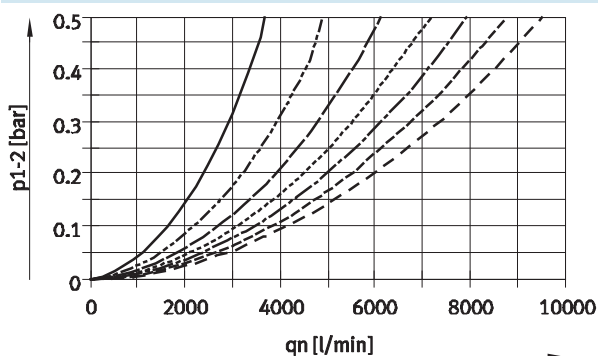

MS9-LFX-N $\frac{3}{4}$ /AQS, Pneumatic connection NPT $\frac{3}{4}$ -14

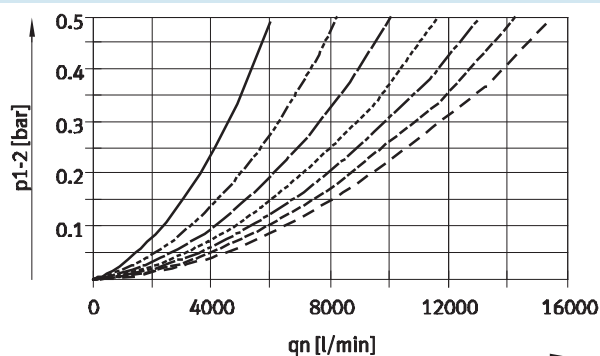

MS9-LFX-N1/AQT, Pneumatic connection NPT1-11 $\frac{1}{2}$

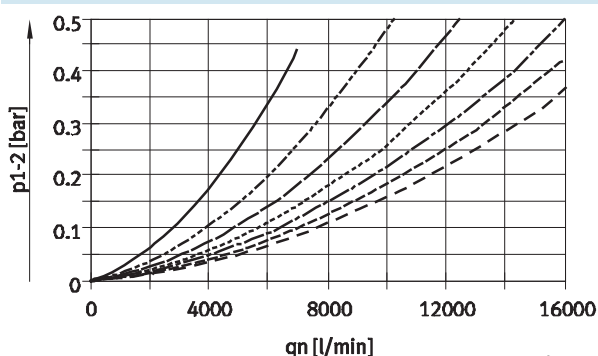

MS9-LFX-AQV, Pneumatic connection NPT1 $\frac{1}{2}$ -11 $\frac{1}{2}$

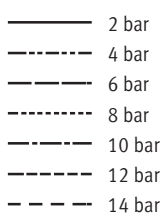
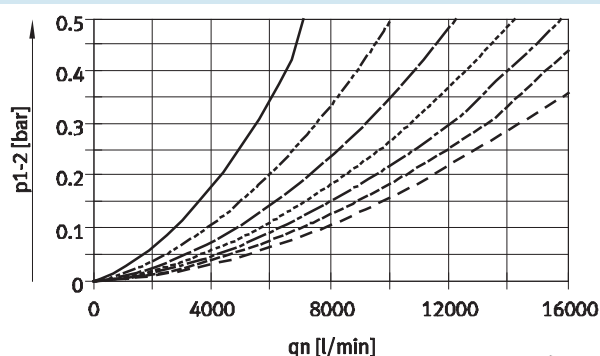

Activated carbon filters MS9-LFX, MS series, NPT

FESTO

Technical data

Dimensions – Basic version

Download CAD Data → www.festo.com/us/cad

without connecting thread G

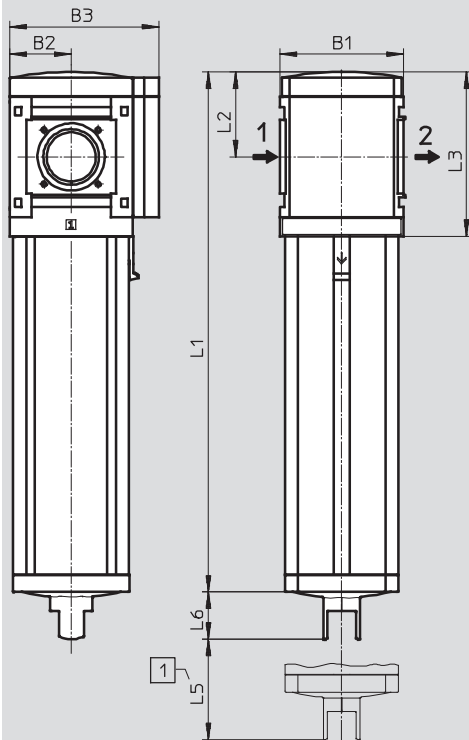

1 Installation dimensions

→ Flow direction

Type	B1	B2	B3	L1	L2	L3	L5	L6
MS9-LFX-G	90	45	109	380.5	62	120	50	34.5

Activated carbon filters MS9-LFX, MS series, NPT

Technical data

FESTO

Dimensions – Connecting thread/connecting plate

Download CAD Data → www.festo.com/us/cad

with connecting thread N $\frac{3}{4}$ or N1

with connecting plate AQ...

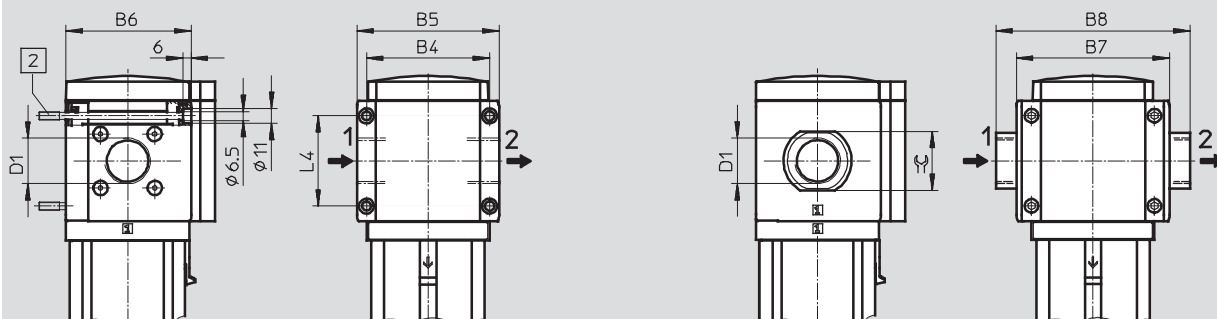

2 Mounting screw M6xmin.90 to DIN 912 (not included in scope of delivery) for wall mounting without mounting bracket

→ Flow direction

Type	B4	B5	B6	B7	B8	D1	L4	≡C
MS9-LFX-N $\frac{3}{4}$	90	104	91.5	–	–	NPT $\frac{3}{4}$ -14	66	–
MS9-LFX-N1						NPT1-11 $\frac{1}{2}$		
MS9-LFX-AQR	–	–	–	112	132	NPT $\frac{1}{2}$ -14	–	30
MS9-LFX-AQS					132	NPT $\frac{3}{4}$ -14		36
MS9-LFX-AQT					142	NPT1-11 $\frac{1}{2}$		41
MS9-LFX-AQU					162	NPT1 $\frac{1}{4}$ -11 $\frac{1}{2}$		50
MS9-LFX-AQV					176	NPT1 $\frac{1}{2}$ -11 $\frac{1}{2}$		55

Ordering data

Size	Connection	Part No.	Type
MS9	NPT $\frac{3}{4}$ -14	552998	MS9-LFX-N $\frac{3}{4}$ -U
	NPT1-11 $\frac{1}{2}$	553034	MS9-LFX-N1-U
	–	564038	MS9-LFX-G-U

Activated carbon filters MS9-LFX, MS series, NPT

FESTO

Ordering data – Modular products

M Mandatory data						O Options		
Module No.	Series	Size	Function	Connection size	Bowl	Type of mounting	UL certification	Alternative flow direction
552942	MS	9	LFX	N $\frac{3}{4}$, N1, AQR, AQS, AQT, AQU, AQV, G	U	WP, WPM, WPB	UL1	Z
Order example								
552942	MS	9	- LFX	- AQR	- U	-	-	-

Ordering table					
Grid dimension	[mm]	90	Condition s	Code	Enter code
M Module No.	552942				
Series	Standard service unit			MS	MS
Size	9			9	9
Function	Activated carbon filter			-LFX	-LFX
Connection size	Thread NPT $\frac{3}{4}$			-N $\frac{3}{4}$	
	Thread NPT1			-N1	
	Connecting plate NPT $\frac{1}{2}$			-AQR	
	Connecting plate NPT $\frac{3}{4}$			-AQS	
	Connecting plate NPT1			-AQT	
	Connecting plate NPT1 $\frac{1}{4}$			-AQU	
	Connecting plate NPT1 $\frac{1}{2}$			-AQV	
	Module without connecting thread, without connecting plate			-G	
Bowl	Metal bowl			-U	-U
O Type of mounting	Mounting bracket			1 -WP	
	Mounting bracket			1 -WPM	
	Wall mounting bracket for large wall gap			1 -WPB	
UL certification	cULus, ordinary location for Canada and USA			-UL1	
Alternative flow direction	Flow direction from right to left			-Z	

1 WP, WPM, WPB

Not with module G

Transfer order code

552942	MS	9	- LFX	-	U	-	-	-
--------	----	---	-------	---	---	---	---	---

Filters MS-LF/LFM/LFX, MS series, NPT

Accessories

FESTO

Filter cartridges, MS9 series



Ordering data				
Size	Filter cartridge	Grade of filtration [μm]	Part No.	Type
MS9	Micro-filter cartridge	0.01	553036	MS9-LFM-A
	Fine-filter cartridge	1	553037	MS9-LFM-B
	Filter cartridge	5	570309	MS9-LFP-C
	Filter cartridge	40	570310	MS9-LFP-E
	Activated carbon filter cartridge	–	552946	MS9-LFX
High flow rate HF				
MS9	Micro-filter cartridge	0.01	552944	MS9-LFM-A-HF
	Fine-filter cartridge	1	552945	MS9-LFM-B-HF

Product Range and Company Overview

A Complete Suite of Automation Services

Our experienced engineers provide complete support at every stage of your development process, including: conceptualization, analysis, engineering, design, assembly, documentation, validation, and production.



Custom Automation Components
Complete custom engineered solutions



Custom Control Cabinets
Comprehensive engineering support and on-site services



Complete Systems
Shipment, stocking and storage services

The Broadest Range of Automation Components

With a comprehensive line of more than 30,000 automation components, Festo is capable of solving the most complex automation requirements.



Electromechanical
Electromechanical actuators, motors, controllers & drives



Pneumatics
Pneumatic linear and rotary actuators, valves, and air supply



PLCs and I/O Devices
PLC's, operator interfaces, sensors and I/O devices

Supporting Advanced Automation... As No One Else Can!

Festo is a leading global manufacturer of pneumatic and electromechanical systems, components and controls for industrial automation, with more than 12,000 employees in 56 national headquarters serving more than 180 countries. For more than 80 years, Festo has continuously elevated the state of manufacturing with innovations and optimized motion control solutions that deliver higher performing, more profitable automated manufacturing and processing equipment. Our dedication to the advancement of automation extends beyond technology to the education and development of current and future automation and robotics designers with simulation tools, teaching programs, and on-site services.

Quality Assurance, ISO 9001 and ISO 14001 Certifications

Festo Corporation is committed to supply all Festo products and services that will meet or exceed our customers' requirements in product quality, delivery, customer service and satisfaction.

To meet this commitment, we strive to ensure a consistent, integrated, and systematic approach to management that will meet or exceed the requirements of the ISO 9001 standard for Quality Management and the ISO 14001 standard for Environmental Management.



© Copyright 2008, Festo Corporation. While every effort is made to ensure that all dimensions and specifications are correct, Festo cannot guarantee that publications are completely free of any error, in particular typing or printing errors. Accordingly, Festo cannot be held responsible for the same. For Liability and Warranty conditions, refer to our "Terms and Conditions of Sale", available from your local Festo office. All rights reserved. No part of this publication may be reproduced, distributed, or transmitted in any form or by any means, electronic, mechanical, photocopying or otherwise, without the prior written permission of Festo. All technical data subject to change according to technical update.



Printed on recycled paper at New Horizon Graphic, Inc., FSC certified as an environmentally friendly printing plant.

Festo North America

Festo Regional Contact Center

5300 Explorer Drive
Mississauga, Ontario L4W 5G4
Canada

USA Customers:

For ordering assistance,

Call: 1.800.99.FESTO (1.800.993.3786)

Fax: 1.800.96.FESTO (1.800.963.3786)

Email: customer.service@us.festo.com

For technical support,

Call: 1.866.GO.FESTO (1.866.463.3786)

Fax: 1.800.96.FESTO (1.800.963.3786)

Email: product.support@us.festo.com

Canadian Customers:

Call: 1.877.GO.FESTO (1.877.463.3786)

Fax: 1.877.FX.FESTO (1.877.393.3786)

Email: festo.canada@ca.festo.com

USA Headquarters

Festo Corporation
395 Moreland Road
P.O. Box 18023
Hauppauge, NY 11788, USA
www.festo.com/us

USA Sales Offices

Appleton

North 922 Tower View Drive, Suite N
Greenville, WI 54942, USA

Boston

120 Presidential Way, Suite 330
Woburn, MA 01801, USA

Chicago

1441 East Business Center Drive
Mt. Prospect, IL 60056, USA

Dallas

1825 Lakeway Drive, Suite 600
Lewisville, TX 75057, USA

Detroit – Automotive Engineering Center

2601 Cambridge Court, Suite 320
Auburn Hills, MI 48326, USA

New York

395 Moreland Road
Hauppauge, NY 11788, USA

Silicon Valley

4935 Southfront Road, Suite F
Livermore, CA 94550, USA

United States



USA Headquarters, East: Festo Corp., 395 Moreland Road, Hauppauge, NY 11788

Phone: 1.631.435.0800; Fax: 1.631.435.8026;

Email: info@festo-usa.com

www.festo.com/us

Canada



Headquarters: Festo Inc., 5300 Explorer Drive, Mississauga, Ontario L4W 5G4

Phone: 1.905.624.9000; Fax: 1.905.624.9001;

Email: festo.canada@ca.festo.com

www.festo.ca

Mexico



Headquarters: Festo Pneumatic, S.A., Av. Ceylán 3, Col. Tequesquahuac,
54020 Tlalneapantla, Edo. de México

Phone: 011 52 [55] 53 21 66 00; Fax: 011 52 [55] 53 21 66 65;

Email: festo.mexico@mx.festo.com

www.festo.com/mx

Central USA

Festo Corporation
1441 East Business
Center Drive
Mt. Prospect, IL 60056, USA
Phone: 1.847.759.2600
Fax: 1.847.768.9480



Western USA

Festo Corporation
4935 Southfront Road,
Suite F
Livermore, CA 94550, USA
Phone: 1.925.371.1099
Fax: 1.925.245.1286



Festo Worldwide

Argentina Australia Austria Belarus Belgium Brazil Bulgaria Canada Chile China Colombia Croatia Czech Republic Denmark
Estonia Finland France Germany Great Britain Greece Hong Kong Hungary India Indonesia Iran Ireland Israel Italy Japan Latvia
Lithuania Malaysia Mexico Netherlands New Zealand Norway Peru Philippines Poland Romania Russia Serbia Singapore
Slovakia Slovenia South Africa South Korea Spain Sweden Switzerland Taiwan Thailand Turkey Ukraine United States Venezuela

www.festo.com