

Electrical connection technology, for multi-pin plug connection

Technical data – KMP1-...



- Plug socket with cable for multi-pin connection (to valve terminal type 02)
- Pre-assembled
- Cable lengths of 5 m, 10 m or by customer request
- 25-pin, 40-pin or 72-pin socket
- Not suitable for chain link trunking



General technical data		KMP1-...
Type		KMP1-...
Type of mounting		Clamping strap
Mounting position		Any
Operating voltage range	[V]	300 AC
	[V]	250 DC
Current-carrying capacity	[A]	4
Protection class to EN 60 529		IP65 (assembled)
Material of housing		Die-cast light metal alloy
Material of contacts		Silver-plated copper base alloy
Material of cable sheath		Polyethylene
Ambient temperature	[°C]	-30 ... +70
Ambient temperature of flexible cable installation	[°C]	+5 ... +70

Electrical connection technology, for multi-pin plug connection

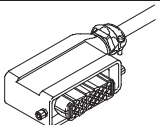
Technical data – KMP1-...

Ordering data								
	Electrical connection	Cable composition [mm ²]	Cable diameter [mm]	Product weight		Cable length [m]	Type	Part No.
				Cable [g/m]	Total [g]			
	25-pin plug socket	25x0.75	13		1,933	5	KMP1-02-II-4-5	175 654
	25-pin plug socket	25x0.75	13		3,676	10	KMP1-02-II-4-10	175 655
	25-pin plug socket	25x0.75	13	Approx. 370	Acc. to length	Any	KMP1-02-II-4-X	158 988
	40-pin plug socket	39x0.75	17		2,995	5	KMP1-02-II-8-5	175 656
	40-pin plug socket	39x0.75	17		5,672	10	KMP1-02-II-8-10	175 657
	40-pin plug socket	39x0.75	17	Approx. 570	Acc. to length	Any	KMP1-02-II-8-X	158 989
	72-pin plug socket	50x0.75	19		3,908	5	KMP1-02-II-10-5	175 658
	72-pin plug socket	50x0.75	19		7,300	10	KMP1-02-II-10-10	175 659
	72-pin plug socket	50x0.75	19	Approx. 700	Acc. to length	Any	KMP1-02-II-10-X	158 990
	72-pin plug socket	65x0.75	22		6,000	5	KMP1-02-II-14-5	175 660
	72-pin plug socket	65x0.75	22		11,300	10	KMP1-02-II-14-10	175 661
	72-pin plug socket	65x0.75	22	Approx. 930	Acc. to length	Any	KMP1-02-II-14-X	158 991
	72-pin plug socket	80x0.75	24		5,326	5	KMP1-02-II-16-5	175 662
	72-pin plug socket	80x0.75	24		10,650	10	KMP1-02-II-16-10	175 663
	72-pin plug socket	80x0.75	24	Approx. 1160	Acc. to length	Any	KMP1-02-II-16-X	158 992
	25-pin plug socket	13x0.75	10		1,200	5	KMP1-02-VI-6-5	175 585
	25-pin plug socket	13x0.75	10		2,188	10	KMP1-02-VI-6-10	175 586
	25-pin plug socket	13x0.75	10	Approx. 180	Acc. to length	Any	KMP1-02-VI-6-X	158 984
	25-pin plug socket	25x0.75	13		1,967	5	KMP1-02-VI-12-5	175 587
	25-pin plug socket	25x0.75	13		3,667	10	KMP1-02-VI-12-10	175 588
	40-pin plug socket	39x0.75	17		3,016	5	KMP1-02-VI-16-5	175 589
	40-pin plug socket	39x0.75	17		5,800	10	KMP1-02-VI-16-10	175 590
	40-pin plug socket	39x0.75	17	Approx. 570	Acc. to length	Any	KMP1-02-VI-16-X	158 987

Electrical connection technology, for multi-pin plug connection

Technical data – KMP1-...

Download CAD Data → www.festo.com/us/cad

Dimensions

KMP1-...

Cable assembled

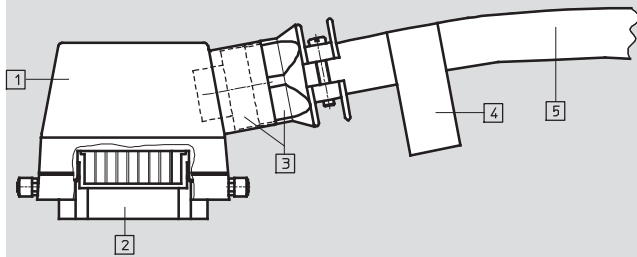

- 1 Housing
- 2 Socket insert with protective earth connection
- 3 Cable gland fitting with sealing set
- 4 Label with part number, type and cable length
- 5 Cable

Housing

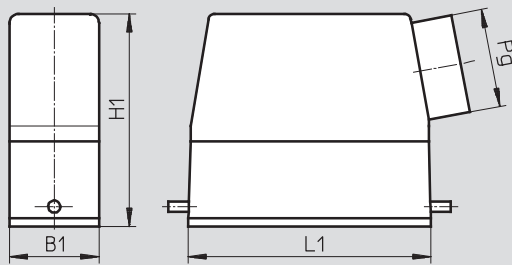

	25-pin	40-pin	72-pin
L1	79.5 mm	93.5 mm	93.5 mm
B1	29.5 mm	43 mm	43 mm
H1	54.5 mm	60 mm	76 mm
Pg	16	21	29

Socket insert, 72-pin

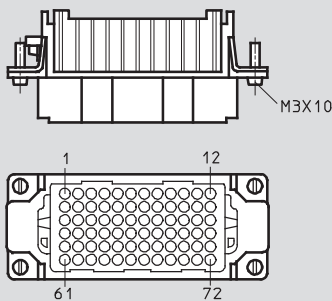

Socket insert, 40-pin

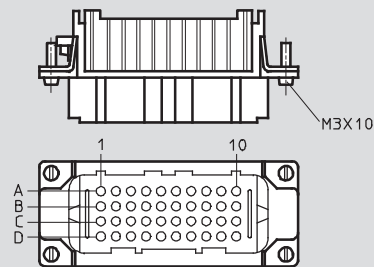

Socket insert, 25-pin

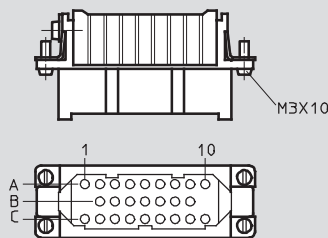

Electrical connection technology, for multi-pin plug connection

Technical data – KMP1-...

Wiring allocation (socket view)						
KMP1-02-II-4-...						
	Pin Row A	Wire number	Pin Row B	Wire number	Pin Row C	Wire number
	1	4			1	20
	2	5	2	13	2	21
	3	6	3	14	3	22
	4	7	4	15	4	23
	5	8	5	16	5	24
	6	9	6	17	6	25
	7	10	7	18	7	1
	8	11	8	19	8	2
	9	12			9	3
KMP1-02-VI-6-...						
	Pin Row A	Wire number	Pin Row B	Wire number	Pin Row C	Wire number
	1	2			1	-
	2	3	2	11	2	-
	3	4	3	12	3	-
	4	5	4	13	4	-
	5	6	5	-	5	-
	6	7	6	-	6	-
	7	8	7	-	7	-
	8	9	8	-	8	-
	9	10			9	1
KMP1-02-VI-12-...						
	Pin Row A	Wire number	Pin Row B	Wire number	Pin Row C	Wire number
	1	2			1	18
	2	3	2	11	2	19
	3	4	3	12	3	20
	4	5	4	13	4	21
	5	6	5	14	5	22
	6	7	6	15	6	23
	7	8	7	16	7	24
	8	9	8	17	8	25
	9	10			9	1

Electrical connection technology, for multi-pin plug connection

Technical data – KMP1-...

Wiring allocation (socket view)								
KMP1-02-II-8-...								
	Pin Row A	Wire number	Pin Row B	Wire number	Pin Row C	Wire number	Pin Row D	Wire number
	1	4	1	14	1	22	1	32
	2	5	2	15	2	23	2	33
	3	6	3	16	3	24	3	34
	4	7	4	17	4	25	4	35
	5	8	5	18	5	26	5	36
	6	9	6	19	6	27	6	37
	7	10	7	2	7	28	7	38
	8	11	8	21	8	29	8	39
	9	12	9	–	9	30	9	2
	10	13	10	1	10	31	10	3
KMP1-02-VI-16-...								
	Pin Row A	Wire number	Pin Row B	Wire number	Pin Row C	Wire number	Pin Row D	Wire number
	1	3	1	13	1	23	1	33
	2	4	2	14	2	24	2	34
	3	5	3	15	3	25	3	35
	4	6	4	16	4	26	4	36
	5	7	5	17	5	27	5	37
	6	8	6	18	6	28	6	38
	7	9	7	19	7	29	7	39
	8	10	8	20	8	30	8	–
	9	11	9	21	9	31	9	1
	10	12	10	22	10	32	10	2

Electrical connection technology, for multi-pin plug connection

Technical data – KMP1-...

Wiring allocation (socket view)												
KMP1-02-II-10-...												
	Pin	Wire number	Pin	Wire number	Pin	Wire number	Pin	Wire number	Pin	Wire number	Pin	Wire number
	1	4	13	16	25	–	37	26	49	38	61	50
	2	5	14	17	26	–	38	27	50	39	62	–
	3	6	15	18	27	–	39	28	51	40	63	–
	4	7	16	19	28	–	40	29	52	41	64	–
	5	8	17	20	29	–	41	30	53	42	65	–
	6	9	18	21	30	–	42	31	54	43	66	–
	7	10	19	22	31	–	43	32	55	44	67	–
	8	11	20	23	32	–	44	33	56	45	68	–
	9	12	21	24	33	–	45	34	57	46	69	–
	10	13	22	25	34	–	46	35	58	47	70	–
	11	14	23	–	35	–	47	36	59	48	71	2
	12	15	24	–	36	1	48	37	60	49	72	3
KMP1-02-II-14-...												
	Pin	Wire number	Pin	Wire number	Pin	Wire number	Pin	Wire number	Pin	Wire number	Pin	Wire number
	1	4	13	16	25	28	37	34	49	46	61	58
	2	5	14	17	26	29	38	35	50	47	62	59
	3	6	15	18	27	30	39	36	51	48	63	60
	4	7	16	19	28	31	40	37	52	49	64	61
	5	8	17	20	29	32	41	38	53	50	65	62
	6	9	18	21	30	33	42	39	54	51	66	63
	7	10	19	22	31	–	43	40	55	52	67	64
	8	11	20	23	32	–	44	41	56	53	68	65
	9	12	21	24	33	–	45	42	57	54	69	–
	10	13	22	25	34	–	46	43	58	55	70	–
	11	14	23	26	35	–	47	44	59	56	71	2
	12	15	24	27	36	1	48	45	60	57	72	3
KMP1-02-II-16-...												
	Pin	Wire number	Pin	Wire number	Pin	Wire number	Pin	Wire number	Pin	Wire number	Pin	Wire number
	1	4	13	16	25	28	37	38	49	50	61	62
	2	5	14	17	26	29	38	39	50	51	62	63
	3	6	15	18	27	30	39	40	51	52	63	64
	4	7	16	19	28	31	40	41	52	53	64	65
	5	8	17	20	29	32	41	42	53	54	65	66
	6	9	18	21	30	33	42	43	54	55	66	67
	7	10	19	22	31	34	43	44	55	56	67	68
	8	11	20	23	32	35	44	45	56	57	68	69
	9	12	21	24	33	36	45	46	57	58	69	70
	10	13	22	25	34	37	46	47	58	59	70	71
	11	14	23	26	35	72	47	48	59	60	71	2
	12	15	24	27	36	1	48	49	60	61	72	3

Product Range and Company Overview

A Complete Suite of Automation Services

Our experienced engineers provide complete support at every stage of your development process, including: conceptualization, analysis, engineering, design, assembly, documentation, validation, and production.



Custom Automation Components
Complete custom engineered solutions



Custom Control Cabinets
Comprehensive engineering support and on-site services



Complete Systems
Shipment, stocking and storage services

The Broadest Range of Automation Components

With a comprehensive line of more than 30,000 automation components, Festo is capable of solving the most complex automation requirements.



Electromechanical
Electromechanical actuators, motors, controllers & drives



Pneumatics
Pneumatic linear and rotary actuators, valves, and air supply



PLCs and I/O Devices
PLC's, operator interfaces, sensors and I/O devices

Supporting Advanced Automation... As No One Else Can!

Festo is a leading global manufacturer of pneumatic and electromechanical systems, components and controls for industrial automation, with more than 12,000 employees in 56 national headquarters serving more than 180 countries. For more than 80 years, Festo has continuously elevated the state of manufacturing with innovations and optimized motion control solutions that deliver higher performing, more profitable automated manufacturing and processing equipment. Our dedication to the advancement of automation extends beyond technology to the education and development of current and future automation and robotics designers with simulation tools, teaching programs, and on-site services.

Quality Assurance, ISO 9001 and ISO 14001 Certifications

Festo Corporation is committed to supply all Festo products and services that will meet or exceed our customers' requirements in product quality, delivery, customer service and satisfaction.

To meet this commitment, we strive to ensure a consistent, integrated, and systematic approach to management that will meet or exceed the requirements of the ISO 9001 standard for Quality Management and the ISO 14001 standard for Environmental Management.



© Copyright 2008, Festo Corporation. While every effort is made to ensure that all dimensions and specifications are correct, Festo cannot guarantee that publications are completely free of any error, in particular typing or printing errors. Accordingly, Festo cannot be held responsible for the same. For Liability and Warranty conditions, refer to our "Terms and Conditions of Sale", available from your local Festo office. All rights reserved. No part of this publication may be reproduced, distributed, or transmitted in any form or by any means, electronic, mechanical, photocopying or otherwise, without the prior written permission of Festo. All technical data subject to change according to technical update.



Printed on recycled paper at New Horizon Graphic, Inc., FSC certified as an environmentally friendly printing plant.

Festo North America

Festo Regional Contact Center

5300 Explorer Drive
Mississauga, Ontario L4W 5G4
Canada

USA Customers:

For ordering assistance,

Call: 1.800.99.FESTO (1.800.993.3786)

Fax: 1.800.96.FESTO (1.800.963.3786)

Email: customer.service@us.festo.com

For technical support,

Call: 1.866.GO.FESTO (1.866.463.3786)

Fax: 1.800.96.FESTO (1.800.963.3786)

Email: product.support@us.festo.com

Canadian Customers:

Call: 1.877.GO.FESTO (1.877.463.3786)

Fax: 1.877.FX.FESTO (1.877.393.3786)

Email: festo.canada@ca.festo.com

USA Headquarters

Festo Corporation
395 Moreland Road
P.O. Box 18023
Hauppauge, NY 11788, USA
www.festo.com/us

USA Sales Offices

Appleton

North 922 Tower View Drive, Suite N
Greenville, WI 54942, USA

Boston

120 Presidential Way, Suite 330
Woburn, MA 01801, USA

Chicago

1441 East Business Center Drive
Mt. Prospect, IL 60056, USA

Dallas

1825 Lakeway Drive, Suite 600
Lewisville, TX 75057, USA

Detroit – Automotive Engineering Center

2601 Cambridge Court, Suite 320
Auburn Hills, MI 48326, USA

New York

395 Moreland Road
Hauppauge, NY 11788, USA

Silicon Valley

4935 Southfront Road, Suite F
Livermore, CA 94550, USA

United States



USA Headquarters, East: Festo Corp., 395 Moreland Road, Hauppauge, NY 11788

Phone: 1.631.435.0800; Fax: 1.631.435.8026;

Email: info@festo-usa.com

www.festo.com/us

Canada



Headquarters: Festo Inc., 5300 Explorer Drive, Mississauga, Ontario L4W 5G4

Phone: 1.905.624.9000; Fax: 1.905.624.9001;

Email: festo.canada@ca.festo.com

www.festo.ca

Mexico



Headquarters: Festo Pneumatic, S.A., Av. Ceylán 3, Col. Tequesquahuac,
54020 Tlalneantla, Edo. de México

Phone: 011 52 [55] 53 21 66 00; Fax: 011 52 [55] 53 21 66 65;

Email: festo.mexico@mx.festo.com

www.festo.com/mx

Central USA

Festo Corporation
1441 East Business
Center Drive
Mt. Prospect, IL 60056, USA
Phone: 1.847.759.2600
Fax: 1.847.768.9480



Western USA

Festo Corporation
4935 Southfront Road,
Suite F
Livermore, CA 94550, USA
Phone: 1.925.371.1099
Fax: 1.925.245.1286



Festo Worldwide

Argentina Australia Austria Belarus Belgium Brazil Bulgaria Canada Chile China Colombia Croatia Czech Republic Denmark
Estonia Finland France Germany Great Britain Greece Hong Kong Hungary India Indonesia Iran Ireland Israel Italy Japan Latvia
Lithuania Malaysia Mexico Netherlands New Zealand Norway Peru Philippines Poland Romania Russia Serbia Singapore
Slovakia Slovenia South Africa South Korea Spain Sweden Switzerland Taiwan Thailand Turkey Ukraine United States Venezuela

www.festo.com