

## Sensor boxes SRBP, binary

**FESTO**

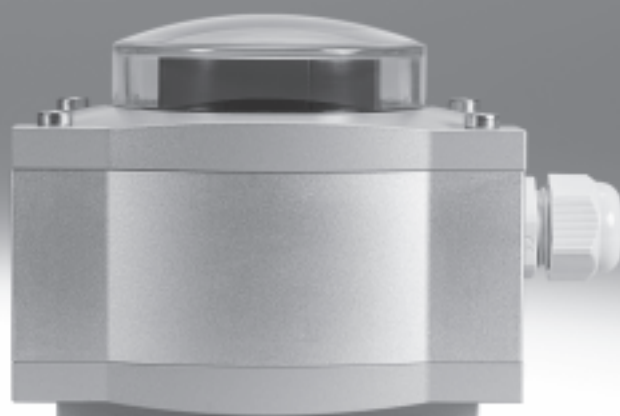

# Sensor boxes SRBP, binary

Key features

FESTO

## General information

- Whether for transporting, metering or bottling gaseous, paste and liquid media or bulk materials, sensor boxes are used in the process industry as position indicators for the end positions of the semi-rotary actuator
- The binary sensor boxes SRBP not only convert the mechanical open and closed position of the actuator or process valve into electrical output signals, but also permit the optional sensing of a mid-position

## Advantages

- Sturdy aluminium housing to IP65 and CRC 3 also enables use in harsh environments
- Mounting on DFPB without additional adapter kit as well as mounting on other actuators via adapter kits as per VDI/VDE 3845
- Clearly visible 3D position indicator offers the option of fast recognition of the current position of the semi-rotary actuator, including from a distance
- Correct indication of the flow direction (I, L, T) of the medium, even with 3-way valves
- Captive screws and name plates offer trouble-free assembly and ordering
- Version available for the ATEX zone 2/22
- Just one product for multiple applications thanks to the wide, adjustable swivel range of up to 270°
- Integrated reed contacts in N/O or changeover contact versions
- The innovative design makes setting the two end positions as well as the mid-position within the wide swivel range of up to 270° quick and easy
- Internal LEDs as setting aid during commissioning
- Optional sensing of the mid-position
- You can find information on the media resistance of the product at → [www.festo.com](http://www.festo.com)

## 1 cable connector

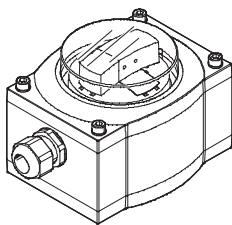

- Power supply for sensor box only

## 2 cable connectors

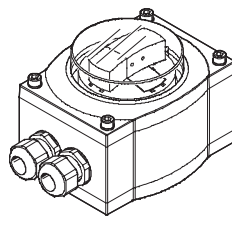

- Common power supply for sensor box and solenoid valve

## Sensor boxes SRBP, binary

Peripherals overview

FESTO

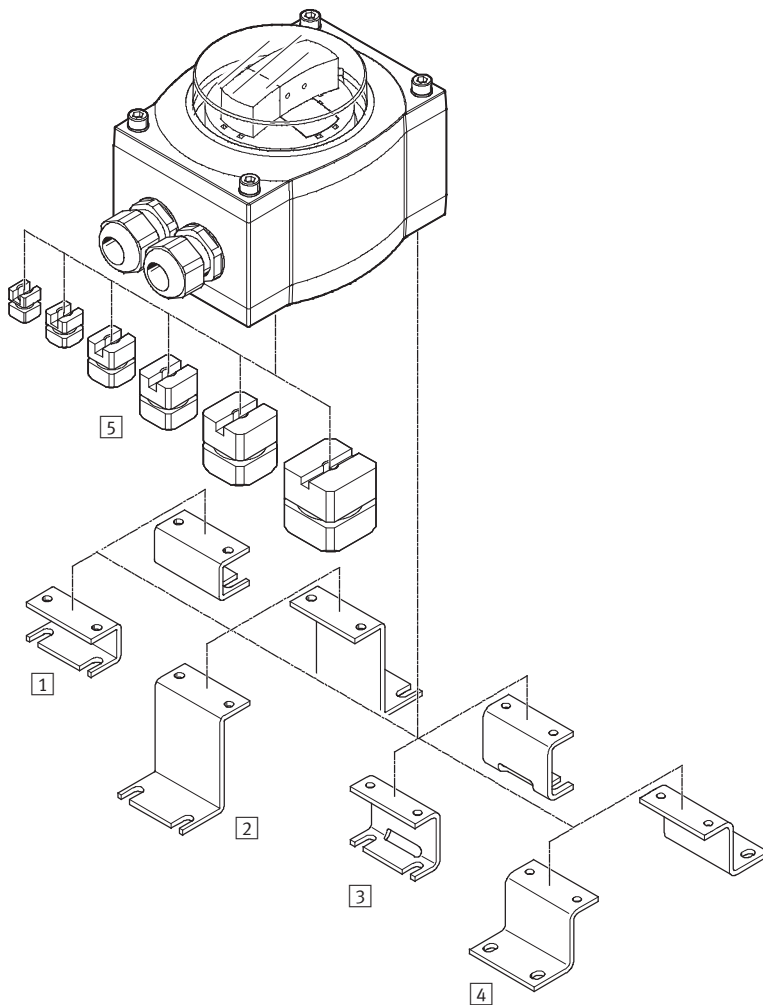

Mounting attachments and accessories		
	Brief description	→ Page/Internet
1	Adapter kit DASB-P1-HA-SB <sup>1)</sup>	Hole pattern 30x80 mm, height 20 mm dasb
2	Adapter kit DASB-P1-HL-SB	Hole pattern 30x130 mm, height 50 mm dasb
3	Adapter kit DASB-P1-HB-SB	Hole pattern 30x80 mm, height 30 mm dasb
4	Adapter kit DASB-P1-HC-SB	Hole pattern 30x130 mm, height 30 mm dasb
5	Coupling DARQ-C-S9	For direct mounting on semi-rotary actuators DFPB darq
	Coupling DARQ-C-S11	For direct mounting on semi-rotary actuators DFPB darq
	Coupling DARQ-C-S14	For direct mounting on semi-rotary actuators DFPB darq
	Coupling DARQ-C-S17	For direct mounting on semi-rotary actuators DFPB darq
	Coupling DARQ-C-S22	For direct mounting on semi-rotary actuators DFPB darq
	Coupling DARQ-C-S27	For direct mounting on semi-rotary actuators DFPB darq

1) The adapter kit DASB-P1-HA-SB can optionally be used for all DFPB actuators.

# Sensor boxes SRBP, binary

Type codes

FESTO

		SRBP	-	M	-	CA1	-	BB270	-	MSA	-	1U	-	T2P20	-		-	EX2
<b>Function</b>																		
SRBP	Binary sensor box																	
<b>Product version</b>																		
M	Primarily metal																	
<b>Design</b>																		
C	Sensor box																	
<b>Mechanical interface</b>																		
A1	Direct mounting, hole pattern 30x80 mm																	
<b>Indicator type</b>																		
BB	Blue/black position indicator																	
GR	Green/red position indicator																	
YB	Yellow/black position indicator																	
<b>Measuring range</b>																		
270	0 ... 270°																	
<b>Sensor principle</b>																		
MS	Floating contact, N/O contact																	
FW	Floating contact, changeover contact																	
<b>Mid-position sensing</b>																		
	None																	
A	With sensing																	
<b>Nominal operating voltage</b>																		
20N	8.2 V DC																	
1U	24 V AC/DC																	
<b>Electrical connection</b>																		
T	Terminal box																	
<b>Valve connection</b>																		
	None																	
2	With valve connection																	
<b>Cable connector</b>																		
P20	M20x1.5, polymer																	
<b>Temperature range</b>																		
	Standard -20 ... +80 °C																	
<b>EU certification</b>																		
	None																	
EX2	II 3GD																	

## Sensor boxes SRBP, binary

Technical data

FESTO

- The binary sensor box is a so-called position sensor for semi-rotary actuators and reports the open and closed position of the actuator
- Sensors are based on reed technology



General technical data				... -20N	... -1U
Adjustment range for angle detection		[°]		0 ... 270	
Based on standard				VDI/VDE 3845 (NAMUR)	
Design				Angular	
Mounting position				Any	
Measured variable				Swivel angle	
Measuring principle				Magnetic reed	
Switching element function				→ Page 7	
Mid-position				→ Page 7	
Switching status display				→ Page 7	
Max. output current		[mA]		→ Page 7	
Idle current		[mA]		→ Page 7	
Position indicator				→ Page 7	
Reproducibility of switching point				+/- 1 deg	
Max. switching capacity	Direct voltage DC	[W]		–	10
	Alternating voltage AC	[VA]		–	10
Operating voltage range	Direct voltage DC	[V]		7.8 ... 8.6	19.2 ... 28.8
	Alternating voltage AC	[V]		–	19.2 ... 28.8
Insulation voltage		[V]		50	
Surge capacity		[kV]		0.8	
Voltage drop		[V]		–	0 ... 0.2
Protection against short circuit				No	
Protection against overloading				No	
Output signal				Digital	
Reverse polarity protection				For operating voltage	
Electrical connection				9-pin	
				Screw terminal	
				Plug-in	
Cable connector				M20x1.5	
Max. cable length		[m]		30	
Permissible cable diameter		[mm]		5 ... 13	
Connectable nominal conductor cross section		[mm <sup>2</sup> ]		2.5	
Product weight		[g]		1,000	
Housing material				Wrought aluminium alloy	
Note on materials				RoHS-compliant	

# Sensor boxes SRBP, binary

Technical data

FESTO

Operating and environmental conditions	... -20N	... -1U
Certification	C-Tick	
Ambient temperature [°C]	-20 ... +80 °C	
Protection class	IP65	
CE mark (see declaration of conformity)	To EU EMC Directive	
Electrical protection class	III	
Degree of contamination	3	
Corrosion resistance class CRC <sup>1)</sup>	3	

- 1) Corrosion resistance class 3 according to Festo standard 940 070  
Components subject to high corrosion stress. External visible parts in direct contact with industrial atmospheres or media such as solvents and cleaning agents, with a predominantly functional requirement for the surface.

Operating and environmental conditions with explosion protection	... -20N	... -1U
Certification	C-Tick	
Ambient temperature [°C]	-20 ... +80 °C	
Protection class	IP65	
CE mark (see declaration of conformity)	To EU EMC Directive To EU Explosion Protection Directive (ATEX)	
ATEX category for gas	II 3G	
Explosion ignition protection type for gas	Ex nA II T5 X	
ATEX category for dust	II 3D	
Explosion ignition protection type for dust	Ex tD A22 IP65 T90°C X	
Explosion-proof ambient temperature	-20 °C ≤ Ta ≤ +80 °C	
Electrical protection class	III	
Degree of contamination	3	
Corrosion resistance class CRC <sup>1)</sup>	3	

- 1) Corrosion resistance class 3 according to Festo standard 940 070  
Components subject to high corrosion stress. External visible parts in direct contact with industrial atmospheres or media such as solvents and cleaning agents, with a predominantly functional requirement for the surface.

## Dimensions – Sensor boxes SRBP, binary

Download CAD Data → [www.festo.com/us/cad](http://www.festo.com/us/cad)

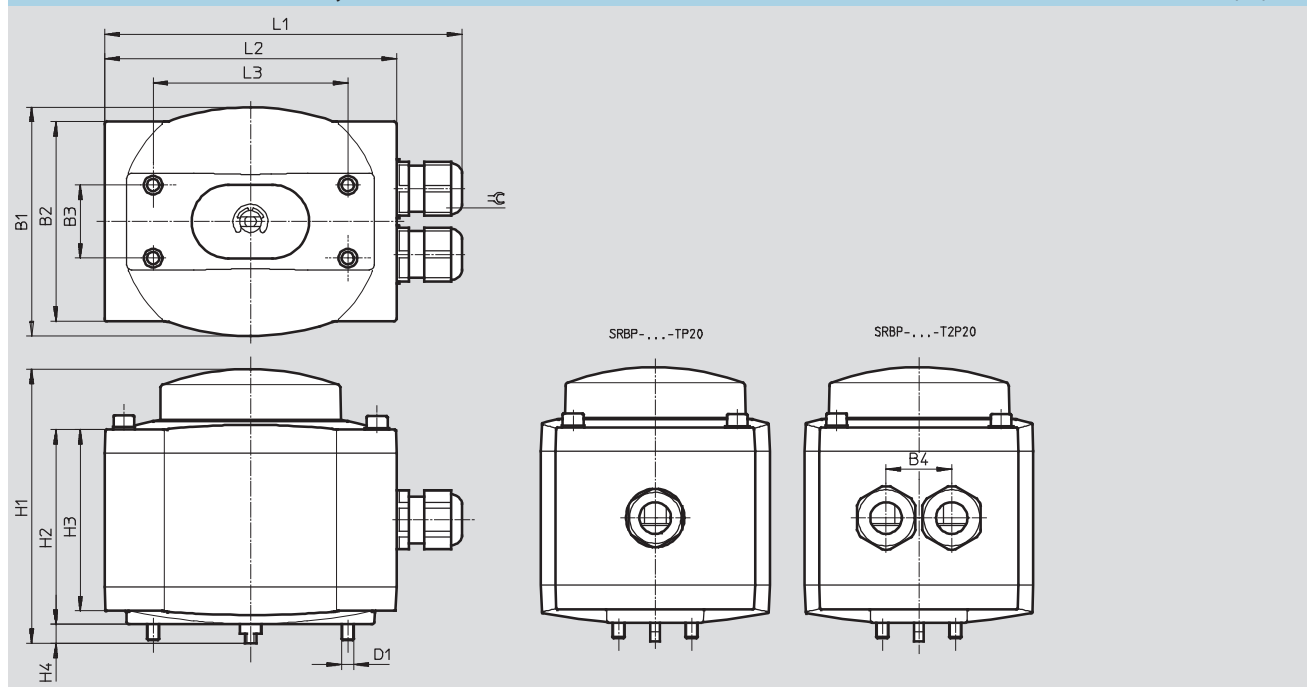

Type	B1	B2	B3 ±1	B4	D1	H1	H2	H3	H4	L1	L2 ±1	L3	⌀
SRBP- ...	94	82	30	–	M5	112.7	80	74.5	7.8	148	120	80	24
SRBP- ... -T2P20	94	82	30	27	M5	112.7	80	74.5	7.8	148	120	80	24

# Sensor boxes SRBP, binary

FESTO

Technical data

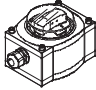
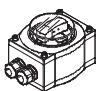

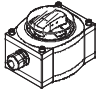
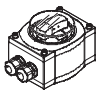

Ordering data – Sensor boxes SRBP, binary without explosion protection								
	Switching element function	Mid-position	Switching status	Max. output current [mA]	Idle current [mA]	Position indicator	Part No.	Type
	N/O contact	–	LED	500	0 ... 10	Green/red	570 402	SRBP-M-CA1-GR270-MS-1U-TP20
	N/O contact	Yes	LED	500	0 ... 10	Green/red	570 403	SRBP-M-CA1-GR270-MSA-1U-TP20
	N/O contact	–	LED	500	0 ... 10	Yellow/black	570 404	SRBP-M-CA1-YB270-MS-1U-TP20
	N/O contact	Yes	LED	500	0 ... 10	Yellow/black	570 405	SRBP-M-CA1-YB270-MSA-1U-TP20
	Changeover switch	–	LED	500	0 ... 10	Green/red	570 406	SRBP-M-CA1-GR270-MW-1U-TP20
	Changeover switch	Yes	LED	500	0 ... 10	Green/red	570 407	SRBP-M-CA1-GR270-MWA-1U-TP20
	Changeover switch	–	LED	500	0 ... 10	Yellow/black	570 408	SRBP-M-CA1-YB270-MW-1U-TP20
	Changeover switch	Yes	LED	500	0 ... 10	Yellow/black	570 409	SRBP-M-CA1-YB270-MWA-1U-TP20
	N/O contact	–	LED	500	0 ... 10	Green/red	570 410	SRBP-M-CA1-GR270-MS-1U-T2P20
	N/O contact	–	LED	500	0 ... 10	Yellow/black	570 411	SRBP-M-CA1-YB270-MS-1U-T2P20

Ordering data – Sensor boxes SRBP, binary with explosion protection								
	Switching element function	Mid-position	Switching status	Max. output current [mA]	Idle current [mA]	Position indicator	Part No.	Type
	N/O contact	–	LED	500	0 ... 10	Blue/black	568 249	SRBP-M-CA1-BB270-MS-1U-TP20-Ex2
	N/O contact	–	–	–	–	Green/red	568 250	SRBP-M-CA1-GR270-MS-20N-TP20-Ex2
	N/O contact	Yes	–	–	–	Green/red	568 251	SRBP-M-CA1-GR270-MSA-20N-TP20-Ex2
	N/O contact	Yes	LED	500	0 ... 10	Green/red	568 254	SRBP-M-CA1-GR270-MSA-1U-TP20-Ex2
	N/O contact	–	LED	500	0 ... 10	Green/red	568 255	SRBP-M-CA1-GR270-MS-1U-TP20-Ex2
	N/O contact	–	–	–	–	Yellow/black	568 256	SRBP-M-CA1-YB270-MS-20N-TP20-Ex2
	N/O contact	Yes	–	–	–	Yellow/black	568 257	SRBP-M-CA1-YB270-MSA-20N-TP20-Ex2
	N/O contact	–	LED	500	0 ... 10	Yellow/black	568 261	SRBP-M-CA1-YB270-MS-1U-TP20-Ex2
	N/O contact	Yes	LED	500	0 ... 10	Yellow/black	568 262	SRBP-M-CA1-YB270-MSA-1U-TP20-Ex2
	Changeover switch	Yes	LED	500	0 ... 10	Green/red	568 266	SRBP-M-CA1-GR270-MWA-1U-TP20-Ex2
	Changeover switch	–	LED	500	0 ... 10	Green/red	568 267	SRBP-M-CA1-GR270-MW-1U-TP20-Ex2
	Changeover switch	–	LED	500	0 ... 10	Yellow/black	568 271	SRBP-M-CA1-YB270-MW-1U-TP20-Ex2
	Changeover switch	Yes	LED	500	0 ... 10	Yellow/black	568 272	SRBP-M-CA1-YB270-MWA-1U-TP20-Ex2
	N/O contact	–	LED	500	0 ... 10	Green/red	568 274	SRBP-M-CA1-GR270-MS-1U-T2P20-Ex2

## Sensor boxes SRBP, binary

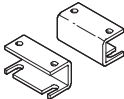
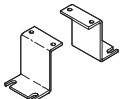
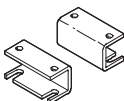
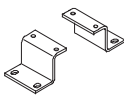
Accessories

**FESTO**

Dimensions and ordering data			
	Brief description	Part No.	Type
Adapter kit			
	Adapter kit for DRD/DRE, DAPS and DFPB, shaft height 20 mm, hole patterns 80x30 mm	568 275	DASB-P1-HA-SB
	Adapter kit for third-party drives, shaft height 50 mm, hole patterns 130x30 mm	568 276	DASB-P1-HL-SB
	Adapter kit for DRD/DRE and DAPS, shaft height 30 mm, hole patterns 80x30 mm	572 418	DASB-P1-HB-SB
	Adapter kit for DRD/DRE and DAPS, shaft height 30 mm, hole patterns 130x30 mm	572 419	DASB-P1-HC-SB
Couplings			
	Couplings for direct mounting of sensor boxes SRBP/SRAP on quarter turn actuators DFPB. Technical data ➔ Internet: dfpb	568 674	DARQ-C-S9
		568 675	DARQ-C-S11
		568 676	DARQ-C-S14
		568 677	DARQ-C-S17
		568 678	DARQ-C-S22
		568 679	DARQ-C-S27
Cable connector			
	Polymer cable connector M20x1.5	568 278	NETC-P-M20-P4
	Metal cable connector M20x1.5	568 279	NETC-M-M20-P4



## Product Range and Company Overview

### A Complete Suite of Automation Services

Our experienced engineers provide complete support at every stage of your development process, including: conceptualization, analysis, engineering, design, assembly, documentation, validation, and production.



**Custom Automation Components**  
Complete custom engineered solutions



**Custom Control Cabinets**  
Comprehensive engineering support and on-site services



**Complete Systems**  
Shipment, stocking and storage services

### The Broadest Range of Automation Components

With a comprehensive line of more than 30,000 automation components, Festo is capable of solving the most complex automation requirements.



**Electromechanical**  
Electromechanical actuators, motors, controllers & drives



**Pneumatics**  
Pneumatic linear and rotary actuators, valves, and air supply



**PLCs and I/O Devices**  
PLC's, operator interfaces, sensors and I/O devices

### Supporting Advanced Automation... As No One Else Can!

Festo is a leading global manufacturer of pneumatic and electromechanical systems, components and controls for industrial automation, with more than 12,000 employees in 56 national headquarters serving more than 180 countries. For more than 80 years, Festo has continuously elevated the state of manufacturing with innovations and optimized motion control solutions that deliver higher performing, more profitable automated manufacturing and processing equipment. Our dedication to the advancement of automation extends beyond technology to the education and development of current and future automation and robotics designers with simulation tools, teaching programs, and on-site services.

### Quality Assurance, ISO 9001 and ISO 14001 Certifications

Festo Corporation is committed to supply all Festo products and services that will meet or exceed our customers' requirements in product quality, delivery, customer service and satisfaction.

To meet this commitment, we strive to ensure a consistent, integrated, and systematic approach to management that will meet or exceed the requirements of the ISO 9001 standard for Quality Management and the ISO 14001 standard for Environmental Management.



© Copyright 2008, Festo Corporation. While every effort is made to ensure that all dimensions and specifications are correct, Festo cannot guarantee that publications are completely free of any error, in particular typing or printing errors. Accordingly, Festo cannot be held responsible for the same. For Liability and Warranty conditions, refer to our "Terms and Conditions of Sale", available from your local Festo office. All rights reserved. No part of this publication may be reproduced, distributed, or transmitted in any form or by any means, electronic, mechanical, photocopying or otherwise, without the prior written permission of Festo. All technical data subject to change according to technical update.



Printed on recycled paper at New Horizon Graphic, Inc., FSC certified as an environmentally friendly printing plant.

# Festo North America

## Festo Regional Contact Center

5300 Explorer Drive  
Mississauga, Ontario L4W 5G4  
Canada

### USA Customers:

For ordering assistance,

**Call:** 1.800.99.FESTO (1.800.993.3786)

**Fax:** 1.800.96.FESTO (1.800.963.3786)

**Email:** [customer.service@us.festo.com](mailto:customer.service@us.festo.com)

For technical support,

**Call:** 1.866.GO.FESTO (1.866.463.3786)

**Fax:** 1.800.96.FESTO (1.800.963.3786)

**Email:** [product.support@us.festo.com](mailto:product.support@us.festo.com)

### Canadian Customers:

**Call:** 1.877.GO.FESTO (1.877.463.3786)

**Fax:** 1.877.FX.FESTO (1.877.393.3786)

**Email:** [festo.canada@ca.festo.com](mailto:festo.canada@ca.festo.com)

## USA Headquarters

Festo Corporation  
395 Moreland Road  
P.O. Box 18023  
Hauppauge, NY 11788, USA  
[www.festo.com/us](http://www.festo.com/us)

## USA Sales Offices

### Appleton

North 922 Tower View Drive, Suite N  
Greenville, WI 54942, USA

### Boston

120 Presidential Way, Suite 330  
Woburn, MA 01801, USA

### Chicago

1441 East Business Center Drive  
Mt. Prospect, IL 60056, USA

### Dallas

1825 Lakeway Drive, Suite 600  
Lewisville, TX 75057, USA

### Detroit – Automotive Engineering Center

2601 Cambridge Court, Suite 320  
Auburn Hills, MI 48326, USA

### New York

395 Moreland Road  
Hauppauge, NY 11788, USA

### Silicon Valley

4935 Southfront Road, Suite F  
Livermore, CA 94550, USA

## United States



**USA Headquarters, East:** Festo Corp., 395 Moreland Road, Hauppauge, NY 11788

Phone: 1.631.435.0800; Fax: 1.631.435.8026;

Email: [info@festo-usa.com](mailto:info@festo-usa.com)

[www.festo.com/us](http://www.festo.com/us)

## Canada



**Headquarters:** Festo Inc., 5300 Explorer Drive, Mississauga, Ontario L4W 5G4

Phone: 1.905.624.9000; Fax: 1.905.624.9001;

Email: [festo.canada@ca.festo.com](mailto:festo.canada@ca.festo.com)

[www.festo.ca](http://www.festo.ca)

## Mexico



**Headquarters:** Festo Pneumatic, S.A., Av. Ceylán 3, Col. Tequesquahuac,  
54020 Tlalneapantla, Edo. de México

Phone: 011 52 [55] 53 21 66 00; Fax: 011 52 [55] 53 21 66 65;

Email: [festo.mexico@mx.festo.com](mailto:festo.mexico@mx.festo.com)

[www.festo.com/mx](http://www.festo.com/mx)

## Central USA

Festo Corporation  
1441 East Business  
Center Drive  
Mt. Prospect, IL 60056, USA  
Phone: 1.847.759.2600  
Fax: 1.847.768.9480



## Western USA

Festo Corporation  
4935 Southfront Road,  
Suite F  
Livermore, CA 94550, USA  
Phone: 1.925.371.1099  
Fax: 1.925.245.1286



## Festo Worldwide

Argentina Australia Austria Belarus Belgium Brazil Bulgaria Canada Chile China Colombia Croatia Czech Republic Denmark  
Estonia Finland France Germany Great Britain Greece Hong Kong Hungary India Indonesia Iran Ireland Israel Italy Japan Latvia  
Lithuania Malaysia Mexico Netherlands New Zealand Norway Peru Philippines Poland Romania Russia Serbia Singapore  
Slovakia Slovenia South Africa South Korea Spain Sweden Switzerland Taiwan Thailand Turkey Ukraine United States Venezuela

[www.festo.com](http://www.festo.com)