

Air gap sensors SOPA

Product range overview



- Sensing range 20 ... 200 µm
- Switch outputs PNP or NPN
- Integrated air jet function
- Two-colour LCD display

Detailed product information

➔ www.festo.com/catalog/sopa

Key features			
General	Precise	Easy to use	Reliable and flexible
Lightweight, compact and highly precise, this pneumatic solution offers impressive scope for integration: SOPA features a control module, compressed air regulation, measurement air switch-off and air jet function as well as up to four measuring modules. All in all, an attractively priced solution for low tolerances.	The air gap sensor SOPA senses exactly in the µm range whether the workpiece is lying flat or resting against other workpieces before clamping and whether the machining tool is exactly aligned on the spindle.	Lightweight, compact and simple into the bargain: thanks to parameterisation via teach-in or numerical setting using three buttons. Simple assembly and commissioning thanks to the inclusion of virtually unregulated compressed air and an integrated air jet function that needs no additional peripheral devices.	The multi-coloured LCD display with clear operating status indication ensures maximum reliability, while selectable monitoring points (1 to 4) and further functions make the application extremely flexible.

Air gap sensors SOPA

Type codes

FESTO

		SOPA	-	CM1	H	-	R1	-	H	Q6	-	2P	-	M12	-	E1
Function																
SOPA	Air gap sensor for contact and distance monitoring via LCD display															
Modules																
CM1	Control module with one sensor module															
CM2	Control module with two sensor modules, pneumatically interlinked															
CM3	Control module with three sensor modules, pneumatically interlinked															
CM4	Control module with four sensor modules, pneumatically interlinked															
M1	Sensor module															
Manual override for control module																
H	With manual override															
Distance sensing range																
R1	20 ... 200 µm															
Type of mounting																
H	H-rail mounting/through-hole															
W	Additional wall mounting															
Pneumatic connection																
Q6	Push-in connector QS-6															
Electrical output																
2P	2 switch outputs PNP															
2N	2 switch outputs NPN															
Electrical connection																
M12	Plug M12x1, A-coded															
Electrical accessories																
E1	Straight socket, cable 2.5 m															
E2	Straight socket, cable 5 m															
E3	Angled socket, cable 2.5 m															
E4	Angled socket, cable 5 m															

Air gap sensors SOPA

Technical data

Technical data			
Type	SOPA-M1-...	SOPA-CM...-...-H...	SOPA-CM...-...-W...
Sensing range	[µm]	20 ... 200	
Repetition accuracy of switching point ¹⁾		± 2.5 µm: sensing range 30 µm to 150 µm ± 5µm: sensing range 20 µm to 200 µm	
Setting options		Teach-in via display and buttons	
Protection against manipulation		Electronic lock	
Type of display		Multi-coloured illuminated LCD	
Type of mounting		Alternatively: Via H-rail Via through-holes Via wall/surface bracket ²⁾	Alternatively: Via H-rail Via through-holes Via wall/surface bracket ³⁾
Sensing principle		Pneumatic	
Pneumatic connection		QS-6	
Operating voltage range	[V DC]	15 ... 30	–
Operating voltage	[V DC]	–	24
Max. output current	[mA]	100	
Electrical connection		Plug M12x1, 5-pin, round design to EN 60947-5-2	
Protection against short circuit		Pulsed	
Protection against polarity reversal		For all electrical connections	
Protection class		IP65 to IEC 60529	

1) Under constant operating conditions (temperature and supply pressure) and nominal measuring nozzle diameter (2 mm).

2) Adapter plate SXE3 must be ordered separately as an accessory → 6.

3) 2 adapter plates SXE3-W included in scope of delivery.

Operating and environmental conditions		
Type	SOPA-M1-...	SOPA-CM...-...
Operating pressure [bar]	–	4 ... 7
Supply pressure [bar]	0.8 ... 1.6	–
Operating medium	Filtered compressed air, grade of filtration 40µm, lubricated or unlubricated	
Ambient temperature [°C]	0 ... 50	
CE mark (see declaration of conformity)	In accordance with EU EMC directive	
Certification	C tick	

Materials	
Housing	Reinforced polyamide
Note on materials	Free of copper and PTFE Conforms to RoHS

Air gap sensors SOPA

Technical data

FESTO

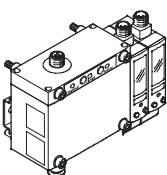
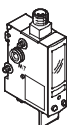
Ordering data						
Version	Type of mounting	Number of sensor modules	Switch output PNP		Switch output NPN	
			Part No.	Type	Part No.	Type
Control module with sensor modules						
	Via H-rail	1	552 130	SOPA-CM1H-R1-HQ6-2P-M12	552 134	SOPA-CM1H-R1-HQ6-2N-M12
		2	552 131	SOPA-CM2H-R1-HQ6-2P-M12	552 135	SOPA-CM2H-R1-HQ6-2N-M12
		3	552 132	SOPA-CM3H-R1-HQ6-2P-M12	552 136	SOPA-CM3H-R1-HQ6-2N-M12
		4	552 133	SOPA-CM4H-R1-HQ6-2P-M12	552 137	SOPA-CM4H-R1-HQ6-2N-M12
	Via wall/surface bracket ¹⁾	1	552 138	SOPA-CM1H-R1-WQ6-2P-M12	552 142	SOPA-CM1H-R1-WQ6-2N-M12
		2	552 139	SOPA-CM2H-R1-WQ6-2P-M12	552 143	SOPA-CM2H-R1-WQ6-2N-M12
		3	552 140	SOPA-CM3H-R1-WQ6-2P-M12	552 144	SOPA-CM3H-R1-WQ6-2N-M12
		4	552 141	SOPA-CM4H-R1-WQ6-2P-M12	552 145	SOPA-CM4H-R1-WQ6-2N-M12
Individual sensor module						
	Via H-rail	1	552 146	SOPA-M1-R1-HQ6-2P-M12	552 147	SOPA-M1-R1-HQ6-2N-M12

1) 2 adapter plates SXE3-W included in scope of delivery.

Air gap sensors SOPA

Ordering data – Modular products

[M] Mandatory data			[O] Options			[M] Mandatory data						[O] Options	
Module No.	Function		Control module override	Distance sensing range		Pneumatic connection		Electrical connection		Electrical accessories			
549 902	Modules		H	Type of mounting		Electrical output		M12					
	SOPA	CM1 CM2 CM3 CM4 M1		R1	H W	Q6	2P 2N						
Ordering example													
549 902	SOPA	- M1	-	R1	- H	Q6	- 2P	-	M12	+	E3		

Ordering table				Condition s	Code	Enter code
[M]	Module No.	549 902				
	Function	Air gap sensor for contact and distance monitoring with LCD display			SOPA	SOPA
	Modules	Control module with one sensor module			-CM1	
		Control module with two sensor modules, pneumatically interlinked			-CM2	
		Control module with three sensor modules, pneumatically interlinked			-CM3	
		Control module with four sensor modules, pneumatically interlinked			-CM4	
		Sensor module			-M1	
[O]	Control module override	With manual override for control module	[1]		H	
[M]	Distance sensing range [µm]	20 ... 200			-R1	-R1
	Type of mounting	H-rail mounting/through-hole			-H	
		Additional wall mounting			-W	
	Pneumatic connection	Push-in connector 6 mm			Q6	Q6
	Electrical output	2 switch outputs PNP			-2P	
		2 switch outputs NPN			-2N	
	Electrical connection	Plug M12, A-coded			-M12	-M12
[O]	Electrical accessories	Straight socket, cable 2.5 m			+E1	
		Straight socket, cable 5 m			+E2	
		Angled socket, cable 2.5 m			+E3	
		Angled socket, cable 5 m			+E4	

[1] H Not with module M1 (sensor module)

Transfer order code

549 902	SOPA	-		-	R1	-		-	Q6	-		-	M12	+	
---------	------	---	--	---	----	---	--	---	----	---	--	---	-----	---	--

Air gap sensors SOPA

Peripherals overview, sample applications

FESTO

Peripherals overview

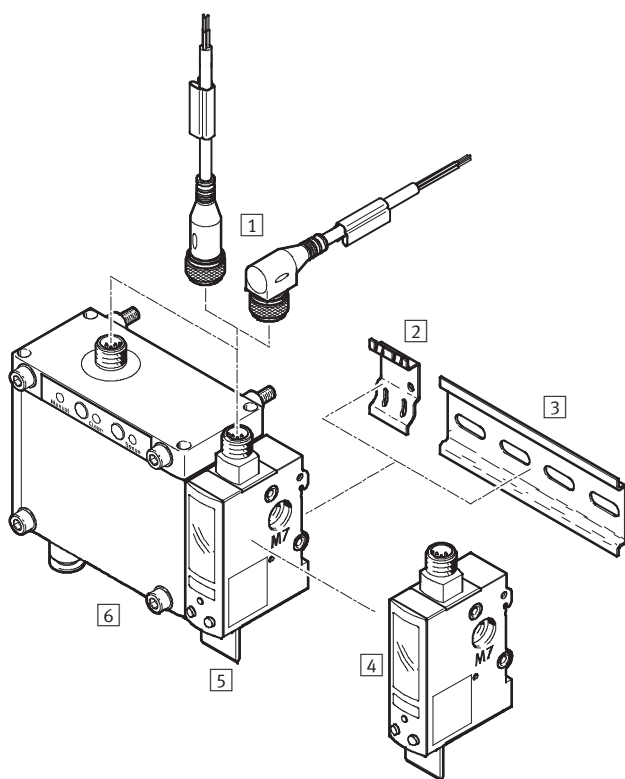

Accessories

1	Connecting cable for switch output
2	Adapter plate SXE3-W (2 included in scope of delivery with SOPA-...-W-...)
3	Mounting rail to DIN EN 60715
4	Sensor module SOPA-M1-...
5	Inscription label holder SXE3 (included in scope of delivery)
6	Control module with one sensor module SOPA-CM1-...

Ordering data – Connecting cables M12x1

Technical data → Internet: nebu

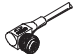
	Number of wires	Cable length [m]	Part No.	Type
Straight socket				
	4	2.5	550 326	NEBU-M12G5-K-2.5-LE4
		5	541 328	NEBU-M12G5-K-5-LE4
Angled socket				
	4	2.5	550 325	NEBU-M12W5-K-2.5-LE4
		5	541 329	NEBU-M12W5-K-5-LE4

Ordering data – Adapter plate

	Part No.	Type
	540 214	SXE3-W

Product Range and Company Overview

A Complete Suite of Automation Services

Our experienced engineers provide complete support at every stage of your development process, including: conceptualization, analysis, engineering, design, assembly, documentation, validation, and production.



Custom Automation Components
Complete custom engineered solutions



Custom Control Cabinets
Comprehensive engineering support and on-site services



Complete Systems
Shipment, stocking and storage services

The Broadest Range of Automation Components

With a comprehensive line of more than 30,000 automation components, Festo is capable of solving the most complex automation requirements.



Electromechanical
Electromechanical actuators, motors, controllers & drives



Pneumatics
Pneumatic linear and rotary actuators, valves, and air supply



PLCs and I/O Devices
PLC's, operator interfaces, sensors and I/O devices

Supporting Advanced Automation... As No One Else Can!

Festo is a leading global manufacturer of pneumatic and electromechanical systems, components and controls for industrial automation, with more than 12,000 employees in 56 national headquarters serving more than 180 countries. For more than 80 years, Festo has continuously elevated the state of manufacturing with innovations and optimized motion control solutions that deliver higher performing, more profitable automated manufacturing and processing equipment. Our dedication to the advancement of automation extends beyond technology to the education and development of current and future automation and robotics designers with simulation tools, teaching programs, and on-site services.

Quality Assurance, ISO 9001 and ISO 14001 Certifications

Festo Corporation is committed to supply all Festo products and services that will meet or exceed our customers' requirements in product quality, delivery, customer service and satisfaction.

To meet this commitment, we strive to ensure a consistent, integrated, and systematic approach to management that will meet or exceed the requirements of the ISO 9001 standard for Quality Management and the ISO 14001 standard for Environmental Management.



© Copyright 2008, Festo Corporation. While every effort is made to ensure that all dimensions and specifications are correct, Festo cannot guarantee that publications are completely free of any error, in particular typing or printing errors. Accordingly, Festo cannot be held responsible for the same. For Liability and Warranty conditions, refer to our "Terms and Conditions of Sale", available from your local Festo office. All rights reserved. No part of this publication may be reproduced, distributed, or transmitted in any form or by any means, electronic, mechanical, photocopying or otherwise, without the prior written permission of Festo. All technical data subject to change according to technical update.



Printed on recycled paper at New Horizon Graphic, Inc., FSC certified as an environmentally friendly printing plant.

Festo North America

Festo Regional Contact Center

5300 Explorer Drive
Mississauga, Ontario L4W 5G4
Canada

USA Customers:

For ordering assistance,

Call: 1.800.99.FESTO (1.800.993.3786)

Fax: 1.800.96.FESTO (1.800.963.3786)

Email: customer.service@us.festo.com

For technical support,

Call: 1.866.GO.FESTO (1.866.463.3786)

Fax: 1.800.96.FESTO (1.800.963.3786)

Email: product.support@us.festo.com

Canadian Customers:

Call: 1.877.GO.FESTO (1.877.463.3786)

Fax: 1.877.FX.FESTO (1.877.393.3786)

Email: festo.canada@ca.festo.com

USA Headquarters

Festo Corporation
395 Moreland Road
P.O. Box 18023
Hauppauge, NY 11788, USA
www.festo.com/us

USA Sales Offices

Appleton

North 922 Tower View Drive, Suite N
Greenville, WI 54942, USA

Boston

120 Presidential Way, Suite 330
Woburn, MA 01801, USA

Chicago

1441 East Business Center Drive
Mt. Prospect, IL 60056, USA

Dallas

1825 Lakeway Drive, Suite 600
Lewisville, TX 75057, USA

Detroit – Automotive Engineering Center

2601 Cambridge Court, Suite 320
Auburn Hills, MI 48326, USA

New York

395 Moreland Road
Hauppauge, NY 11788, USA

Silicon Valley

4935 Southfront Road, Suite F
Livermore, CA 94550, USA

United States



USA Headquarters, East: Festo Corp., 395 Moreland Road, Hauppauge, NY 11788

Phone: 1.631.435.0800; Fax: 1.631.435.8026;

Email: info@festo-usa.com

www.festo.com/us

Canada



Headquarters: Festo Inc., 5300 Explorer Drive, Mississauga, Ontario L4W 5G4

Phone: 1.905.624.9000; Fax: 1.905.624.9001;

Email: festo.canada@ca.festo.com

www.festo.ca

Mexico



Headquarters: Festo Pneumatic, S.A., Av. Ceylán 3, Col. Tequesquahuac,
54020 Tlalneapantla, Edo. de México

Phone: 011 52 [55] 53 21 66 00; Fax: 011 52 [55] 53 21 66 65;

Email: festo.mexico@mx.festo.com

www.festo.com/mx

Central USA

Festo Corporation
1441 East Business
Center Drive
Mt. Prospect, IL 60056, USA
Phone: 1.847.759.2600
Fax: 1.847.768.9480



Western USA

Festo Corporation
4935 Southfront Road,
Suite F
Livermore, CA 94550, USA
Phone: 1.925.371.1099
Fax: 1.925.245.1286



Festo Worldwide

Argentina Australia Austria Belarus Belgium Brazil Bulgaria Canada Chile China Colombia Croatia Czech Republic Denmark
Estonia Finland France Germany Great Britain Greece Hong Kong Hungary India Indonesia Iran Ireland Israel Italy Japan Latvia
Lithuania Malaysia Mexico Netherlands New Zealand Norway Peru Philippines Poland Romania Russia Serbia Singapore
Slovakia Slovenia South Africa South Korea Spain Sweden Switzerland Taiwan Thailand Turkey Ukraine United States Venezuela

www.festo.com