

## Pressure sensors SPAB, with display

**FESTO**



## Pressure sensors SPAB

Key features

**FESTO**

### At a glance

SPAB

- Plug-in version, plug M8x1
- Cable version

Multi-coloured, two-part display

Alphanumeric pressure display

Displayable units:

- bar
- inchH<sub>2</sub>O
- inchHG
- kgf/cm<sup>2</sup>
- kPa
- mmHg
- psi

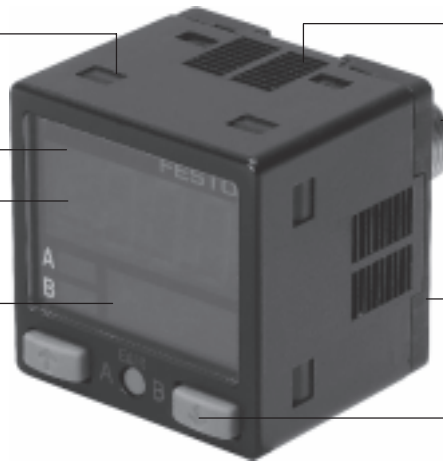

Compact design  
30 x 30 mm

Country-specific pressure  
supply ports:

- G $\frac{1}{8}$
- R $\frac{1}{8}$
- NPT $\frac{1}{8}$ -27

Wall or front panel mounting

High ease of use thanks to  
intuitive operator prompting

### Product description

The pressure sensor SPAB can be used in all industries thanks to its wide range of connection and configuration options and its compact size. Switching point settings are emphasised via switching status indication and switching of the display value colour. Once programmed, the settings can be transferred to other pressure sensors SPAB.

### Main applications

- Pressure/vacuum sensing
- Light assembly
- Wherever there is a need for space-saving pressure measurement with visualisation and limited robustness
- Easy identification of the system status by means of clear, colour-based switching status detection

### Key features

- Pressure measuring range –1 ... +1 or 0 ... 10 bar
- Relative pressure measurement
- Pressure supply port G $\frac{1}{8}$ , R $\frac{1}{8}$  or NPT $\frac{1}{8}$ -27
- Switching output PNP, NPN and analogue output
- Two-part, multi-coloured display
- Copy function (settings can be transferred from one device to another)
- Simple commissioning thanks to intuitive operation
- Compact design 30x30 mm

## Pressure sensors SPAB, with display

Product range overview

| Product range overview                      |                      |                                |                     |  |               |                   |           |
|---|----------------------|--------------------------------|---------------------|--|---------------|-------------------|-----------|
| Measurement method                          | Measured variable    | Pressure measuring range [bar] | Switching function  | Pneumatic connection                                       |               | Electrical output |           |
|   |                      |                                |                     | Male thread  | Female thread | Digital           | Analogue  |
| Piezoresistive pressure sensor with display | 1x relative pressure | -1 ... +1 or 0 ... 10          | Freely programmable | G $\frac{1}{8}$ , R $\frac{1}{8}$ or NPT $\frac{1}{8}$ -27 | M5            | 1x PNP            | 1 ... 5 V |
|   |                      |                                |                     |  |               | 2x PNP            | –         |
|   |                      |                                |                     |  |               | 1x NPN            | 1 ... 5 V |
|   |                      |                                |                     |  |               | 2x NPN            | –         |

## Pressure sensors SPAB, with display

Peripherals overview

**FESTO**

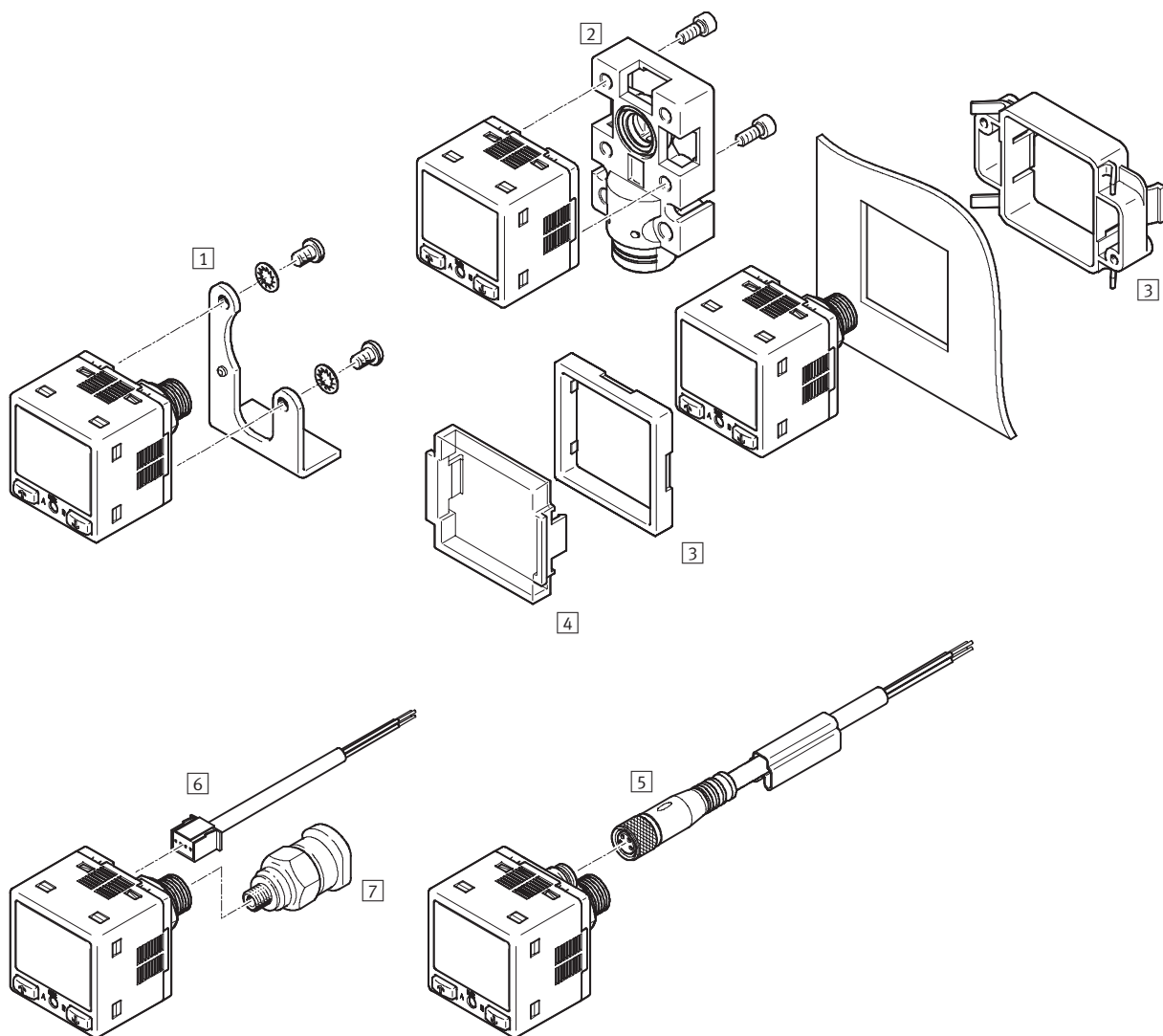

| Accessories   | → Page/<br>Internet |
|---|---------------------|
| 1 Mounting bracket SAMH-...-A                       | 10                  |
| 2 Adapter plate SASF for pressure sensor SPAB-...-F | 11                  |
| 3 Front panel installation kit SAMH-...-F           | 10                  |
| 4 Protective cover SACC                             | 10                  |

| Accessories   | → Page/<br>Internet |
|---|---------------------|
| 5 Connecting cable NEBU-M8                                | 12                  |
| 6 Connecting cable NEBU-L1G4 with square, straight socket | 12                  |
| 7 Push-in fitting QSM-M5                                  | 12                  |

## Pressure sensors SPAB, with display

Type codes

**FESTO**

|                                       |  |      |   |     |   |   |     |   |    |   |    |
|---------------------------------------|--|------|---|-----|---|---|-----|---|----|---|----|
|                                       |  | SPAB | - | P10 | R | - | G18 | - | PB | - | K1 |
| <b>Type</b>                           |  |      |   |     |   |   |     |   |    |   |    |
| SPAB                                  | Piezoresistive pressure sensor with multi-coloured display |      |   |     |   |   |     |   |    |   |    |
| <b>Pressure measuring range [bar]</b> |  |      |   |     |   |   |     |   |    |   |    |
| B2                                    | -1 ... +1  |      |   |     |   |   |     |   |    |   |    |
| P10                                   | 0 ... 10   |      |   |     |   |   |     |   |    |   |    |
| <b>Pressure input</b>                 |  |      |   |     |   |   |     |   |    |   |    |
| R                                     | Relative pressure  |      |   |     |   |   |     |   |    |   |    |
| <b>Pneumatic connection</b>           |  |      |   |     |   |   |     |   |    |   |    |
| G18                                   | Male thread G $\frac{1}{8}$ and female thread M5           |      |   |     |   |   |     |   |    |   |    |
| R18                                   | Male thread R $\frac{1}{8}$ and female thread M5           |      |   |     |   |   |     |   |    |   |    |
| N18                                   | Male thread NPT $\frac{1}{8}$ -27 and female thread M5     |      |   |     |   |   |     |   |    |   |    |
| F                                     | Female thread M5   |      |   |     |   |   |     |   |    |   |    |
| <b>Electrical output</b>              |  |      |   |     |   |   |     |   |    |   |    |
| 2P                                    | 2 switching outputs PNP                                    |      |   |     |   |   |     |   |    |   |    |
| 2N                                    | 2 switching outputs NPN                                    |      |   |     |   |   |     |   |    |   |    |
| PB                                    | 1 switching output PNP, 1 analogue output 1 ... 5 V        |      |   |     |   |   |     |   |    |   |    |
| NB                                    | 1 switching output NPN, 1 analogue output 1 ... 5 V        |      |   |     |   |   |     |   |    |   |    |
| <b>Electrical connection</b>          |  |      |   |     |   |   |     |   |    |   |    |
| K1                                    | Cable, 2.5 m (included in the scope of delivery)           |      |   |     |   |   |     |   |    |   |    |
| M8                                    | Plug M8x1  |      |   |     |   |   |     |   |    |   |    |

## Pressure sensors SPAB, with display

Technical data

Function

E.g. switching output 2x PNP

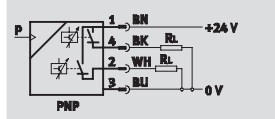

Voltage

12 ... 24 V DC



Pressure

-1 ... +10 bar

E.g. switching output NPN, analogue output

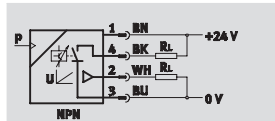

Temperature range

-10 ... +50 °C



| General technical data                  |       |  |          |
|---|-------|--|----------|
| Type SPAB                               |       | -B2  | -P10     |
| General information                     |       |  |          |
| Certification                           |       | cULus listed (OL)  |          |
|   |       | C-Tick   |          |
| CE mark (see declaration of conformity) |       | To EU EMC Directive <sup>1)</sup>                                |          |
| Note on materials                       |       | Contains PWIS (paint wetting impairment substances)              |          |
|   |       | RoHS-compliant   |          |
| Input signal/measuring element          |       |  |          |
| Measured variable                       |       | Relative pressure  |          |
| Measurement method                      |       | Piezoresistive pressure sensor with display                      |          |
| Pressure measuring range                | [bar] | -1 ... +1  | 0 ... 10 |
| Overload capacity                       | [bar] | 5  | 15       |
| Operating medium                        |       | Filtered, unlubricated compressed air, grade of filtration 40 µm |          |
| Ambient temperature                     | [°C]  | -10 ... +50  |          |

1) For information about the applicability of the component see the manufacturer's EC declaration of conformity at: [www.festo.com](http://www.festo.com) → Support → User documentation.  
If the component is subject to restrictions on usage in residential, office or commercial environments or small businesses, further measures to reduce the emitted interference may be necessary.

| Electrical data                                |                     |        |         |     |        |        |         |     |
|--|---------------------|--------|---------|-----|--------|--------|---------|-----|
| Type SPAB                                      | -B2                 |        |         |     | -P10   |        |         |     |
| Electrical output                              | 2P                  | 2N     | PB      | NB  | 2P     | 2N     | PB      | NB  |
| Switching output <sup>1)</sup>                 |                     |        |         |     |        |        |         |     |
| Switching output                               | 2x PNP              | 2x NPN | PNP     | NPN | 2x PNP | 2x NPN | PNP     | NPN |
| Switching function                             | Freely programmable |        |         |     |        |        |         |     |
| Switching element function                     | Switchable          |        |         |     |        |        |         |     |
| Accuracy of FS display [%]                     | 1                   |        |         |     | 2      |        |         |     |
| Reproducibility of switching value [%]         | 0.1                 |        |         |     |        |        |         |     |
| Max. output current [mA]                       | 100                 |        |         |     |        |        |         |     |
|  |                     |        |         |     |        |        |         |     |
| Analogue output <sup>1)</sup>                  |                     |        |         |     |        |        |         |     |
| Analogue output                                | –                   |        | 1 ... 5 |     | –      |        | 1 ... 5 |     |
| Accuracy of analogue output zero point ±FS [%] | –                   |        | 5       |     | –      |        | 5       |     |
| Accuracy of analogue output margin ±FS [%]     | –                   |        | 5       |     | –      |        | 5       |     |
| Reproducibility of analogue value [%]          | –                   |        | 0.2     |     | –      |        | 0.2     |     |
|  |                     |        |         |     |        |        |         |     |
| Output, additional data                        |                     |        |         |     |        |        |         |     |
| Protection against short circuit               | Yes                 |        |         |     |        |        |         |     |

1) % FS = % of the measuring range final value (full scale)

## Pressure sensors SPAB, with display

Technical data

| Electrical data              |   |           |    |    |      |    |    |    |
|------------------------------|---|-----------|----|----|------|----|----|----|
| Type SPAB                    | -B2   |           |    |    | -P10 |    |    |    |
| Electrical output            | 2P  | 2N        | PB | NB | 2P   | 2N | PB | NB |
| Electronic components        |   |           |    |    |      |    |    |    |
| Operating voltage range DC   | [V]   | 12 ... 24 |    |    |      |    |    |    |
| Reverse polarity protection  | For operating voltage                           |           |    |    |      |    |    |    |
|                              |   |           |    |    |      |    |    |    |
| Electromechanical components |   |           |    |    |      |    |    |    |
| Electrical connection        | Plug M8x1, 4-pin, round design to EN 60 947-5-2 |           |    |    |      |    |    |    |
|                              | Cable, 4-wire, 2.5 m                            |           |    |    |      |    |    |    |

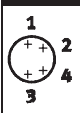
| Pin allocation to EN 60947-5-2  |     |             |  |
|---|-----|-------------|--|
| Plug, 4-pin   |     |             |  |
| M8x1  | Pin | Wire colour | Allocation                               |
|  | 1   | Brown       | Operating voltage +24 V DC               |
|   | 3   | Blue        | 0 V                                      |
|   | 4   | Black       | Switching output (Out A)                 |
|   | 2   | White       | Switching output (Out B)/analogue output |
|   |     |             |  |

| Mechanical components |                  |                  |                       |             |
|-----------------------|------------------|------------------|-----------------------|-------------|
| Type SPAB             | -G18             | -R18             | -N18                  | -F          |
| Type of mounting      | Screw-in         |                  |                       | On sub-base |
|                       | Via accessories  |                  |                       | –           |
| Pneumatic connection  | Female thread M5 |                  |                       |             |
|                       | Male thread G1/8 | Male thread R1/8 | Male thread NPT1/8-27 | –           |
| Product weight        | [g]              | 45               |                       | 30          |
| Housing materials     | ABS, reinforced  |                  |                       |             |
|                       | PBT, reinforced  |                  |                       |             |

| Display/operation             |                                 |
|-------------------------------|---------------------------------|
| Display type                  | Illuminated LCD, multi-coloured |
| Displayable units             | bar                             |
|                               | kgf/cm <sup>2</sup>             |
|                               | inchHg                          |
|                               | mmHg                            |
|                               | kPa                             |
|                               | inchH <sub>2</sub> O            |
|                               | psi                             |
| Switching status display      | Yellow LCD                      |
| Setting options               | Teach-in                        |
|                               | Via display and keys            |
| Tamper protection             | PIN code                        |
| Threshold value setting range | [%]                             |
|                               | 0 ... 100                       |
| Hysteresis setting range      | [%]                             |
|                               | 0 ... 90                        |

| Immissions/emissions                         |      |
|--|------|
| Protection class                             | IP40 |
| Corrosion resistance class CRC <sup>1)</sup> | 2    |

1) Corrosion resistance class 2 according to Festo standard 940 070

Components subject to moderate corrosion stress. Externally visible parts with primarily decorative surface requirements which are in direct contact with a normal industrial environment or media such as coolants or lubricating agents.

## Pressure sensors SPAB, with display

Technical data

**FESTO**

### Dimensions

Download CAD Data → [www.festo.com/us/cad](http://www.festo.com/us/cad)

SPAB-...-K1

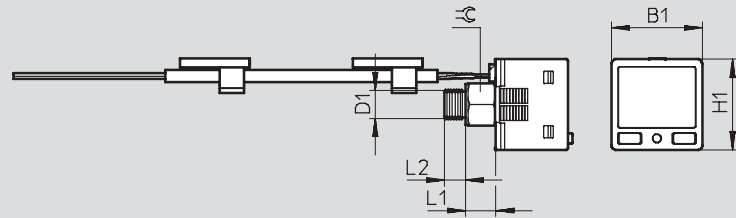

SPAB-...-F-...-K1

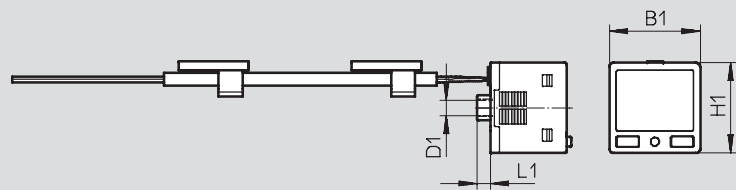

| Type         | B1 | D1                | H1 | L1  | L2  | ☺  |
|--------------|----|-------------------|----|-----|-----|----|
| SPAB-...-G18 | 30 | G $\frac{1}{8}$   | 30 | 10  | 7   | 14 |
| SPAB-...-R18 | 30 | R $\frac{1}{8}$   | 30 | 9.5 | 7.5 | 12 |
| SPAB-...-N18 | 30 | NPT $\frac{1}{8}$ | 30 | 9.5 | 7.5 | 12 |
| SPAB-...-F   | 30 | M5                | 30 | 4.5 | –   | –  |

### Dimensions

Download CAD Data → [www.festo.com/us/cad](http://www.festo.com/us/cad)

SPAB-...-M8

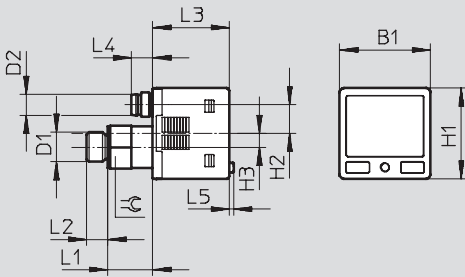







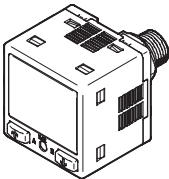

| Type         | B1 | D1                | D2   | H1 | H2  | H3  | L1 | L2  | L3  | L4 | L5 | ☺  |
|--------------|----|-------------------|------|----|-----|-----|----|-----|-----|----|----|----|
| SPAB-...-G18 | 30 | G $\frac{1}{8}$   | M8x1 | 30 | 9.2 | 4.5 | 15 | 7   | ~25 | 7  | 1  | 14 |
| SPAB-...-R18 | 30 | R $\frac{1}{8}$   | M8x1 | 30 | 9.2 | 4.5 | 14 | 9.5 | ~25 | 7  | 1  | 11 |
| SPAB-...-N18 | 30 | NPT $\frac{1}{8}$ | M8x1 | 30 | 9.2 | 4.5 | 14 | 9.5 | ~25 | 7  | 1  | 12 |



# Pressure sensors SPAB, with display

Technical data

| Ordering data   |                          |                   |           |                       |                     |   |                     |
|---|--------------------------|-------------------|-----------|-----------------------|---------------------|---|---------------------|
| Version   | Pressure measuring range | Electrical output |           | Electrical connection |                     |   |                     |
|   |                          |                   |           | Cable <sup>1)</sup>   |                     | Plug  |                     |
|   | [bar]                    | Digital           | Analogue  | Part No.              | Type                | Part No.  | Type                |
|  | Male thread G1/8         |                   |           |                       |                     |   |                     |
|   | -1 ... +1                | 1x PNP            | 1 ... 5 V | 552356                | SPAB-B2R-G18-PB-K1  | 553152  | SPAB-B2R-G18-PB-M8  |
|   |                          | 2x PNP            | –         | 552350                | SPAB-B2R-G18-2P-K1  | 553146  | SPAB-B2R-G18-2P-M8  |
|   |                          | 1x NPN            | 1 ... 5 V | 552359                | SPAB-B2R-G18-NB-K1  | 553155  | SPAB-B2R-G18-NB-M8  |
|   |                          | 2x NPN            | –         | 552353                | SPAB-B2R-G18-2N-K1  | 553149  | SPAB-B2R-G18-2N-M8  |
|   | 0 ... 10                 | 1x PNP            | 1 ... 5 V | 552368                | SPAB-P10R-G18-PB-K1 | 553164  | SPAB-P10R-G18-PB-M8 |
|   |                          | 2x PNP            | –         | 552362                | SPAB-P10R-G18-2P-K1 | 553158  | SPAB-P10R-G18-2P-M8 |
|   |                          | 1x NPN            | 1 ... 5 V | 552371                | SPAB-P10R-G18-NB-K1 | 553167  | SPAB-P10R-G18-NB-M8 |
|   |                          | 2x NPN            | –         | 552365                | SPAB-P10R-G18-2N-K1 | 553161  | SPAB-P10R-G18-2N-M8 |
|   | Male thread R1/8         |                   |           |                       |                     |   |                     |
|   | -1 ... +1                | 1x PNP            | 1 ... 5 V | 552357                | SPAB-B2R-R18-PB-K1  | 553153  | SPAB-B2R-R18-PB-M8  |
|   |                          | 2x PNP            | –         | 552351                | SPAB-B2R-R18-2P-K1  | 553147  | SPAB-B2R-R18-2P-M8  |
|   |                          | 1x NPN            | 1 ... 5 V | 552360                | SPAB-B2R-R18-NB-K1  | 553156  | SPAB-B2R-R18-NB-M8  |
|   |                          | 2x NPN            | –         | 552354                | SPAB-B2R-R18-2N-K1  | 553150  | SPAB-B2R-R18-2N-M8  |
|   | 0 ... 10                 | 1x PNP            | 1 ... 5 V | 552369                | SPAB-P10R-R18-PB-K1 | 553165  | SPAB-P10R-R18-PB-M8 |
|   |                          | 2x PNP            | –         | 552363                | SPAB-P10R-R18-2P-K1 | 553159  | SPAB-P10R-R18-2P-M8 |
|   |                          | 1x NPN            | 1 ... 5 V | 552372                | SPAB-P10R-R18-NB-K1 | 553168  | SPAB-P10R-R18-NB-M8 |
|   |                          | 2x NPN            | –         | 552366                | SPAB-P10R-R18-2N-K1 | 553162  | SPAB-P10R-R18-2N-M8 |
|   | Male thread NPT1/8-27    |                   |           |                       |                     |   |                     |
|   | -1 ... +1                | 1x PNP            | 1 ... 5 V | 552358                | SPAB-B2R-N18-PB-K1  | 553154  | SPAB-B2R-N18-PB-M8  |
|   |                          | 2x PNP            | –         | 552352                | SPAB-B2R-N18-2P-K1  | 553148  | SPAB-B2R-N18-2P-M8  |
|   |                          | 1x NPN            | 1 ... 5 V | 552361                | SPAB-B2R-N18-NB-K1  | 553157  | SPAB-B2R-N18-NB-M8  |
|   |                          | 2x NPN            | –         | 552355                | SPAB-B2R-N18-2N-K1  | 553151  | SPAB-B2R-N18-2N-M8  |
|   | 0 ... 10                 | 1x PNP            | 1 ... 5 V | 552370                | SPAB-P10R-N18-PB-K1 | 553166  | SPAB-P10R-N18-PB-M8 |
|   |                          | 2x PNP            | –         | 552364                | SPAB-P10R-N18-2P-K1 | 553160  | SPAB-P10R-N18-2P-M8 |
|   |                          | 1x NPN            | 1 ... 5 V | 552373                | SPAB-P10R-N18-NB-K1 | 553169  | SPAB-P10R-N18-NB-M8 |
|   |                          | 2x NPN            | –         | 552367                | SPAB-P10R-N18-2N-K1 | 553163  | SPAB-P10R-N18-2N-M8 |
|   | Female thread M5         |                   |           |                       |                     |   |                     |
|   | -1 ... +1                | 1x PNP            | 1 ... 5 V | 570795                | SPAB-B2R-F-PB-K1    |  | –                   |
|   |                          | 2x PNP            | –         | 570793                | SPAB-B2R-F-2P-K1    |  | –                   |
|   |                          | 1x NPN            | 1 ... 5 V | 570769                | SPAB-B2R-F-NB-K1    |  | –                   |
|   |                          | 2x NPN            | –         | 570794                | SPAB-B2R-F-2N-K1    |  | –                   |
|   | 0 ... 10                 | 1x PNP            | 1 ... 5 V | 570799                | SPAB-P10R-F-PB-K1   |  | –                   |
|   |                          | 2x PNP            | –         | 570797                | SPAB-P10R-F-2P-K1   |  | –                   |
|   |                          | 1x NPN            | 1 ... 5 V | 570800                | SPAB-P10R-F-NB-K1   |  | –                   |
|   |                          | 2x NPN            | –         | 570798                | SPAB-P10R-F-2NP-K1  |  | –                   |

1) Connecting cable NEBU-L1... (2.5 m long) included in the scope of delivery.

## Pressure sensors SPAB, with display

Accessories

**FESTO**

### Mounting bracket SAMH

Material:  
Galvanised chromated steel

Note on materials:  
RoHS-compliant

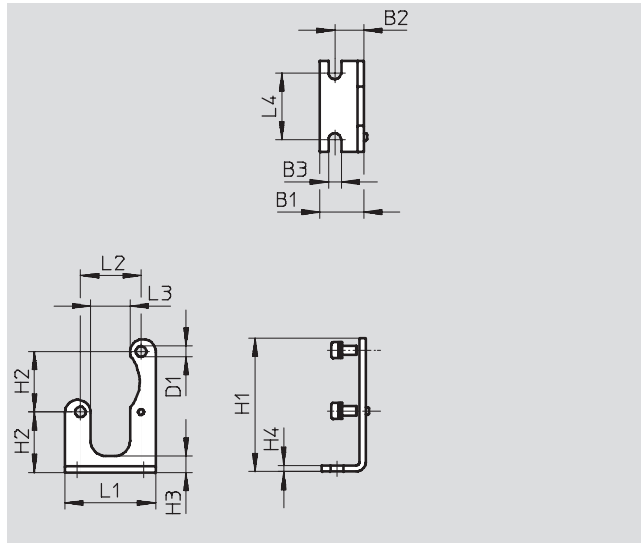

#### Dimensions and ordering data

| B1   | B2  | B3  | D1<br>Ø | H1  | H2 | H3  | H4 | L1 | L2 | L3 | L4 | Part No. | Type      |
|------|-----|-----|---------|-----|----|-----|----|----|----|----|----|----------|-----------|
| 14.5 | 9.5 | 4.2 | 3.5     | ~44 | 20 | 5.5 | 2  | 30 | 20 | 13 | 22 | 552376   | SAMH-P4-A |

### Front panel installation kit SAMH

Materials:  
PC, POM

Note on materials:  
RoHS-compliant

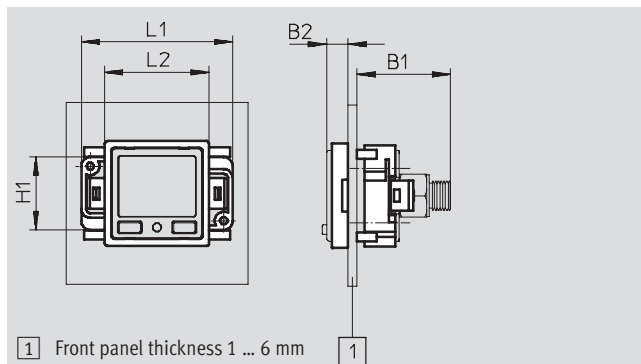

#### Ordering data

| B1  | B2 | H1 | L1 | L2   | Part No. | Type      |
|-----|----|----|----|------|----------|-----------|
| ~31 | 7  | 24 | 50 | 34.5 | 552377   | SAMH-P4-F |

### Protective cover SACC

Material:  
PC

Note on materials:  
RoHS-compliant

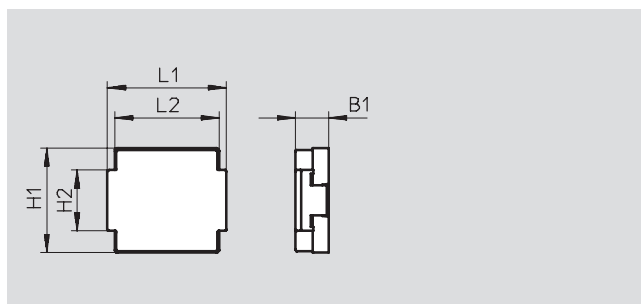

#### Dimensions and ordering data

| B1  | H1   | H2 | L1   | L2   | Part No. | Type      |
|-----|------|----|------|------|----------|-----------|
| ~28 | 34.5 | 20 | 39.3 | 34.5 | 552378   | SACC-P4-G |

## Pressure sensors SPAB, with display

Accessories

### Adapter plate SASF

for pressure sensor SPAB-...-F

Materials:

PBT-reinforced

High-alloy stainless steel

HNBR

Note on materials:

Contains PWIS (paint wetting  
impairment substances)

RoHS-compliant

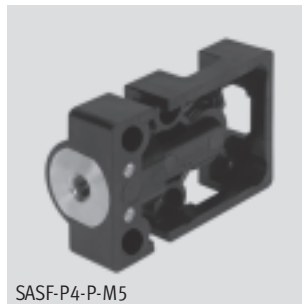
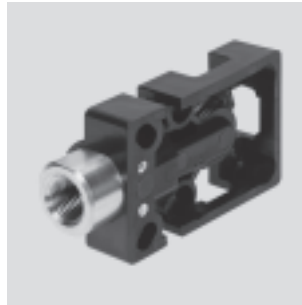

SASF-P4-P-M5

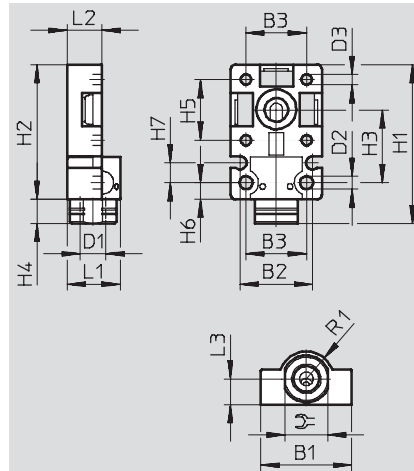

### Note

To differentiate the adapter plates  
R $\frac{1}{8}$ , G $\frac{1}{8}$  and NPT $\frac{1}{8}$ , they are  
identified as follows at the  
pneumatic connection:

- R $\frac{1}{8}$  No line
- NPT $\frac{1}{8}$  One line
- G $\frac{1}{8}$  Two lines

| Dimensions and ordering data |    |    |                   |     |     |      |      |    |    |    |     |     |      |      |     |    |    | Part No. | Type          |
|------------------------------|----|----|-------------------|-----|-----|------|------|----|----|----|-----|-----|------|------|-----|----|----|----------|---------------|
| B1                           | B2 | B3 | D1                | D2  | D3  | H1   | H2   | H3 | H4 | H5 | H6  | H7  | L1   | L2   | L3  | R1 | ☞  |          |               |
| 30                           | 24 | 20 | R $\frac{1}{8}$   | 4.3 | 3.4 | 52.5 | 44.5 | 24 | 8  | 20 | 5.5 | 6.5 | 17.5 | 11.5 | 8.5 | 9  | 14 | 570801   | SASF-P4-P-R18 |
|                              |    |    | G $\frac{1}{8}$   |     |     |      |      |    |    |    |     |     |      |      |     |    |    | 570802   | SASF-P4-P-G18 |
|                              |    |    | NPT $\frac{1}{8}$ |     |     |      |      |    |    |    |     |     |      |      |     |    |    | 570803   | SASF-P4-P-N18 |
| 30                           | 24 | 20 | M5                | 4.3 | 3.4 | –    | 44.5 | 24 | –  | 20 | 5.5 | 6.5 | 17.5 | 11.5 | 8.5 | 9  | –  | 570804   | SASF-P4-P-M5  |



1) Corrosion resistance class 2 according to Festo standard 940 070

Components subject to moderate corrosion stress. Externally visible parts with primarily decorative surface requirements which are in direct contact with a normal industrial environment or media such as coolants or lubricating agents.

## Pressure sensors SPAB, with display

Accessories

**FESTO**

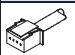
| Ordering data – Connecting cables   |                                   |                 |                  |          | Technical data ➔ Internet: nebu   |  |
|---|-----------------------------------|-----------------|------------------|----------|-----------------------------------|--|
|   | Designation                       | Number of wires | Cable length [m] | Part No. | Type                              |  |
| M8x1  |                                   |                 |                  |          |                                   |  |
|  | Straight socket                   | 4               | 2.5              | 541342   | NEBU-M8G4-K-2.5-LE4               |  |
|   |                                   |                 | 5                | 541343   | NEBU-M8G4-K-5-LE4                 |  |
|  | Angled socket                     | 4               | 2.5              | 541344   | NEBU-M8W4-K-2.5-LE4               |  |
|   |                                   |                 | 5                | 541345   | NEBU-M8W4-K-5-LE4                 |  |
|   |                                   |                 |                  |          |                                   |  |
| Circuit board plug connector  |                                   |                 |                  |          |                                   |  |
|  | Straight socket,<br>square design | 4               | 2.5              | 552374   | NEBU-L1G4-K-2.5-LE4 <sup>1)</sup> |  |
|   |                                   |                 | 5                | 552375   | NEBU-L1G4-K-5-LE4                 |  |

1) Included in the scope of delivery with SPAB-...-K1.

| Ordering data – Push-in fittings   |                      |                      |          | Technical data → Internet: quick star |  |
|--|----------------------|----------------------|----------|---------------------------------------|--|
|  | Pneumatic connection | For tubing O.D. [mm] | Part No. | Type                                  |  |
|  | M5                   | 4                    | 153304   | QSM-M5-4                              |  |
|  |                      | 6                    | 153306   | QSM-M5-6                              |  |

## Product Range and Company Overview

### A Complete Suite of Automation Services

Our experienced engineers provide complete support at every stage of your development process, including: conceptualization, analysis, engineering, design, assembly, documentation, validation, and production.



**Custom Automation Components**  
Complete custom engineered solutions



**Custom Control Cabinets**  
Comprehensive engineering support and on-site services



**Complete Systems**  
Shipment, stocking and storage services

### The Broadest Range of Automation Components

With a comprehensive line of more than 30,000 automation components, Festo is capable of solving the most complex automation requirements.



**Electromechanical**  
Electromechanical actuators, motors, controllers & drives



**Pneumatics**  
Pneumatic linear and rotary actuators, valves, and air supply



**PLCs and I/O Devices**  
PLC's, operator interfaces, sensors and I/O devices

### Supporting Advanced Automation... As No One Else Can!

Festo is a leading global manufacturer of pneumatic and electromechanical systems, components and controls for industrial automation, with more than 12,000 employees in 56 national headquarters serving more than 180 countries. For more than 80 years, Festo has continuously elevated the state of manufacturing with innovations and optimized motion control solutions that deliver higher performing, more profitable automated manufacturing and processing equipment. Our dedication to the advancement of automation extends beyond technology to the education and development of current and future automation and robotics designers with simulation tools, teaching programs, and on-site services.

### Quality Assurance, ISO 9001 and ISO 14001 Certifications

Festo Corporation is committed to supply all Festo products and services that will meet or exceed our customers' requirements in product quality, delivery, customer service and satisfaction.

To meet this commitment, we strive to ensure a consistent, integrated, and systematic approach to management that will meet or exceed the requirements of the ISO 9001 standard for Quality Management and the ISO 14001 standard for Environmental Management.



© Copyright 2008, Festo Corporation. While every effort is made to ensure that all dimensions and specifications are correct, Festo cannot guarantee that publications are completely free of any error, in particular typing or printing errors. Accordingly, Festo cannot be held responsible for the same. For Liability and Warranty conditions, refer to our "Terms and Conditions of Sale", available from your local Festo office. All rights reserved. No part of this publication may be reproduced, distributed, or transmitted in any form or by any means, electronic, mechanical, photocopying or otherwise, without the prior written permission of Festo. All technical data subject to change according to technical update.



Printed on recycled paper at New Horizon Graphic, Inc., FSC certified as an environmentally friendly printing plant.

# Festo North America

## Festo Regional Contact Center

5300 Explorer Drive  
Mississauga, Ontario L4W 5G4  
Canada

### USA Customers:

For ordering assistance,

**Call:** 1.800.99.FESTO (1.800.993.3786)

**Fax:** 1.800.96.FESTO (1.800.963.3786)

**Email:** [customer.service@us.festo.com](mailto:customer.service@us.festo.com)

For technical support,

**Call:** 1.866.GO.FESTO (1.866.463.3786)

**Fax:** 1.800.96.FESTO (1.800.963.3786)

**Email:** [product.support@us.festo.com](mailto:product.support@us.festo.com)

### Canadian Customers:

**Call:** 1.877.GO.FESTO (1.877.463.3786)

**Fax:** 1.877.FX.FESTO (1.877.393.3786)

**Email:** [festo.canada@ca.festo.com](mailto:festo.canada@ca.festo.com)

## USA Headquarters

Festo Corporation  
395 Moreland Road  
P.O. Box 18023  
Hauppauge, NY 11788, USA  
[www.festo.com/us](http://www.festo.com/us)

## USA Sales Offices

### Appleton

North 922 Tower View Drive, Suite N  
Greenville, WI 54942, USA

### Boston

120 Presidential Way, Suite 330  
Woburn, MA 01801, USA

### Chicago

1441 East Business Center Drive  
Mt. Prospect, IL 60056, USA

### Dallas

1825 Lakeway Drive, Suite 600  
Lewisville, TX 75057, USA

### Detroit – Automotive Engineering Center

2601 Cambridge Court, Suite 320  
Auburn Hills, MI 48326, USA

### New York

395 Moreland Road  
Hauppauge, NY 11788, USA

### Silicon Valley

4935 Southfront Road, Suite F  
Livermore, CA 94550, USA

## United States



**USA Headquarters, East:** Festo Corp., 395 Moreland Road, Hauppauge, NY 11788

Phone: 1.631.435.0800; Fax: 1.631.435.8026;

Email: [info@festo-usa.com](mailto:info@festo-usa.com)

[www.festo.com/us](http://www.festo.com/us)

## Canada



**Headquarters:** Festo Inc., 5300 Explorer Drive, Mississauga, Ontario L4W 5G4

Phone: 1.905.624.9000; Fax: 1.905.624.9001;

Email: [festo.canada@ca.festo.com](mailto:festo.canada@ca.festo.com)

[www.festo.ca](http://www.festo.ca)

## Mexico



**Headquarters:** Festo Pneumatic, S.A., Av. Ceylán 3, Col. Tequesquahuac,  
54020 Tlalneapantla, Edo. de México

Phone: 011 52 [55] 53 21 66 00; Fax: 011 52 [55] 53 21 66 65;

Email: [festo.mexico@mx.festo.com](mailto:festo.mexico@mx.festo.com)

[www.festo.com/mx](http://www.festo.com/mx)

## Central USA

Festo Corporation  
1441 East Business  
Center Drive  
Mt. Prospect, IL 60056, USA  
Phone: 1.847.759.2600  
Fax: 1.847.768.9480



## Western USA

Festo Corporation  
4935 Southfront Road,  
Suite F  
Livermore, CA 94550, USA  
Phone: 1.925.371.1099  
Fax: 1.925.245.1286



## Festo Worldwide

Argentina Australia Austria Belarus Belgium Brazil Bulgaria Canada Chile China Colombia Croatia Czech Republic Denmark  
Estonia Finland France Germany Great Britain Greece Hong Kong Hungary India Indonesia Iran Ireland Israel Italy Japan Latvia  
Lithuania Malaysia Mexico Netherlands New Zealand Norway Peru Philippines Poland Romania Russia Serbia Singapore  
Slovakia Slovenia South Africa South Korea Spain Sweden Switzerland Taiwan Thailand Turkey Ukraine United States Venezuela

[www.festo.com](http://www.festo.com)