

## Accessories, MS series

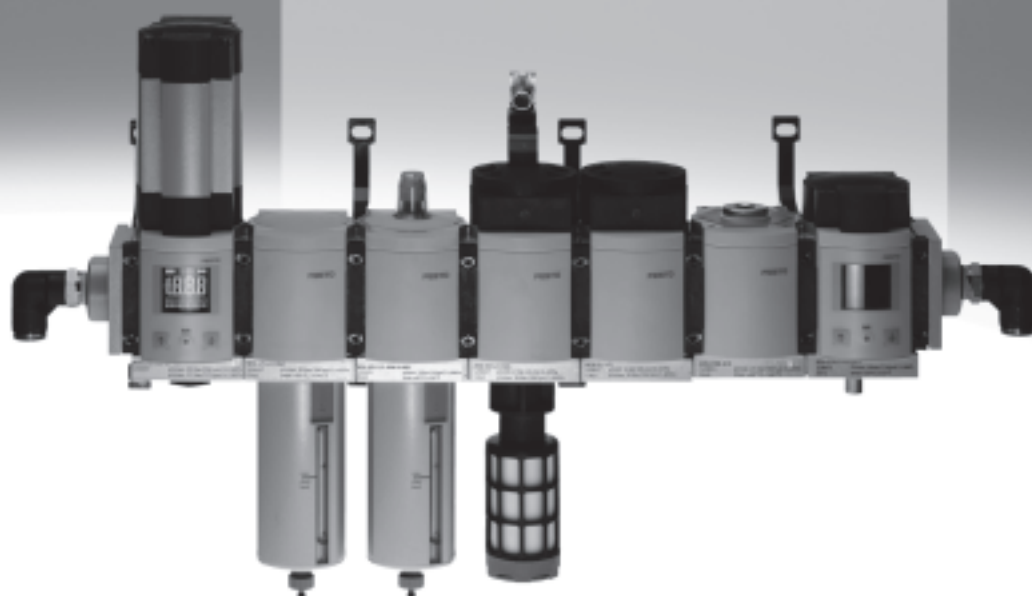











**FESTO**

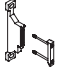

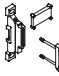
## Accessories, MS series

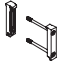
Product range overview









FESTO

| Type  |   | Accessories for size |           |               |           |
|---|---|----------------------|-----------|---------------|-----------|
|   |   | MS4                  | MS6       | MS9           | MS12      |
| <b>Mounting attachments for individual devices</b>              |   |                      |           |               |           |
| Mounting bracket<br>MS-WB                                       |    | ■<br>→ 4             | ■<br>→ 4  | –             | –         |
| Mounting bracket<br>MS-WBM                                      |    | ■<br>→ 4             | –         | –             | –         |
| Mounting bracket<br>MS-WR                                       |    | ■<br>→ 5             | ■<br>→ 5  | –             | –         |
| Hex nut<br>MS-WRS   |    | ■<br>→ 5             | ■<br>→ 5  | –             | –         |
| <b>Mounting attachments for individual devices/combinations</b> |   |                      |           |               |           |
| Mounting bracket<br>MS-WP                                       |    | ■<br>→ 7             | ■<br>→ 7  | ■<br>→ 13     | ■<br>→ 15 |
| Mounting bracket<br>MS-WPB                                      |   | ■<br>→ 8             | ■<br>→ 8  | ■<br>→ 13     | –         |
| Mounting bracket<br>MS-WPM                                      |  | ■<br>→ 9             | ■<br>→ 9  | ■<br>→ 14     | –         |
| Mounting bracket<br>MS-WPE                                      |  | ■<br>→ 10            | ■<br>→ 10 | –             | –         |
| <b>Connectors</b>   |   |                      |           |               |           |
| Module connector<br>MS-MV                                       |  | ■<br>→ 10            | ■<br>→ 10 | ■<br>→ 14     | ■<br>→ 15 |
| Module connector<br>MS-MVM                                      |  | ■<br>→ 10            | ■<br>→ 10 | –             | –         |
| Module connector<br>MS-RMV                                      |  | ■<br>→ 16            | ■<br>→ 16 | ■<br>→ 19     | –         |
| Module connector<br>MS-AMV                                      |  | ■<br>→ 16            | ■<br>→ 16 | –             | –         |
| Module connector<br>MS-ARMV                                     |  | –                    | ■<br>→ 19 | ■<br>→ 19, 21 | ■<br>→ 21 |

## Accessories, MS series

Product range overview

**FESTO**

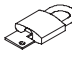
| Type                                     |   | Accessories for size |           |           |           |
|--|---|----------------------|-----------|-----------|-----------|
|  |   | MS4                  | MS6       | MS9       | MS12      |
| <b>Adapters for mounting on profiles</b> |   |                      |           |           |           |
| Power supply modules<br>MS-E-IPM-40-80   |    | ■<br>→ 24            | ■<br>→ 24 | –         | –         |
| Power supply modules<br>MS-E-IPM-80-80   |    | ■<br>→ 24            | ■<br>→ 24 | –         | –         |
| Branching modules<br>MS-A-IPM-80         |    | ■<br>→ 24            | ■<br>→ 24 | –         | –         |
| Branching modules<br>MS-A-RMV-IPM-80     |    | ■<br>→ 24            | ■<br>→ 24 | –         | –         |
| Sealing rings<br>MS-NNR                  |    | ■<br>→ 24            | ■<br>→ 24 | –         | –         |
| <b>Cover plates</b>                      |   |                      |           |           |           |
| Connecting plate<br>MS-AG...             |   | ■<br>→ 30            | ■<br>→ 30 | ■<br>→ 32 | ■<br>→ 33 |
| Cover plate<br>MS-END                    |  | ■<br>→ 31            | ■<br>→ 31 | –         | –         |
| Mounting plate<br>MS-AEND                |  | ■<br>→ 31            | ■<br>→ 31 | –         | –         |
| <b>Security components</b>               |   |                      |           |           |           |
| Padlock<br>LRVS-D                        |  | ■<br>→ 34            | ■<br>→ 34 | ■<br>→ 34 | ■<br>→ 34 |

## Accessories, MS series

Mounting attachments MS4/MS6

FESTO

### Mounting bracket MS4/6-WB

(order code: WB)

- For wall mounting

Material:

Steel

Note on materials:

RoHS-compliant (MS6-WB only)

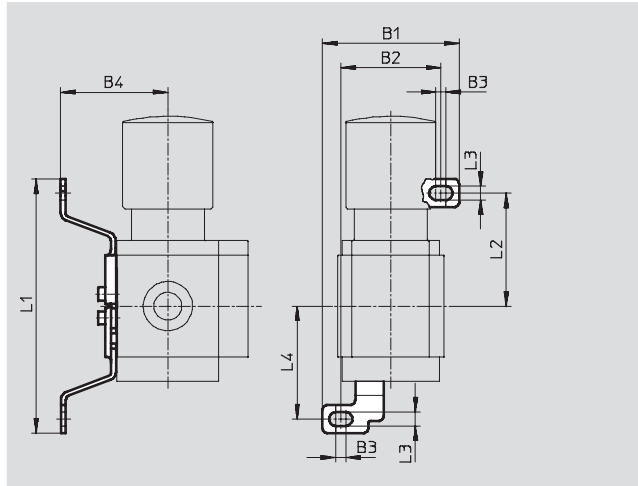

| Dimensions and ordering data |      |      |     |      |       |      |     |      |            |          |        |
|------------------------------|------|------|-----|------|-------|------|-----|------|------------|----------|--------|
| Size                         | B1   | B2   | B3  | B4   | L1    | L2   | L3  | L4   | Weight [g] | Part No. | Type   |
| MS4                          | 56.2 | 41.2 | 4   | 44.2 | 104.6 | 46.6 | 5.6 | 46.5 | 46         | 532185   | MS4-WB |
| MS6                          | 79.4 | 61.9 | 4.5 | 55   | 157.6 | 71   | 6.6 | 71   | 121        | 532196   | MS6-WB |

### Mounting bracket MS4-WBM

(order code: WBM)

- For wall mounting

Material:

Steel

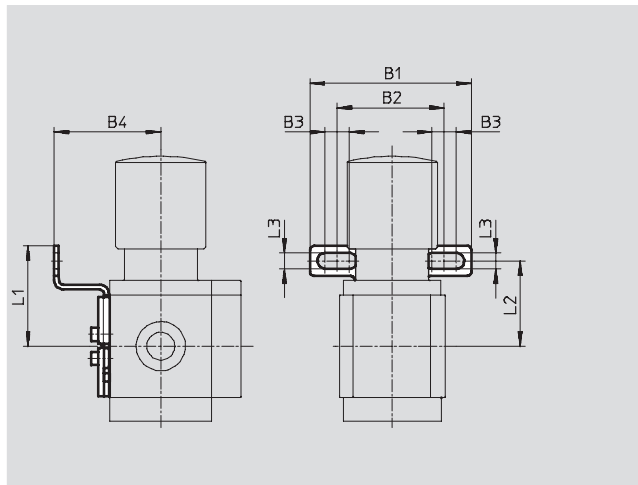

| Dimensions and ordering data |      |    |    |    |      |    |     |               |          |         |
|------------------------------|------|----|----|----|------|----|-----|---------------|----------|---------|
| Size                         | B1   | B2 | B3 | B4 | L1   | L2 | L3  | Weight<br>[g] | Part No. | Type    |
| MS4                          | 66.5 | 44 | 10 | 44 | 41.3 | 35 | 6.5 | 48            | 526062   | MS4-WBM |

## Accessories, MS series

Mounting attachments MS4/MS6

FESTO

### Mounting bracket MS4/6-WR

(order code: WR)

- For wall mounting
- For filter regulator, pressure regulator

Material:

Steel

Note on materials:

RoHS-compliant (MS6-WR only)

#### Note

The hex nut for attaching components to this bracket must be ordered separately.

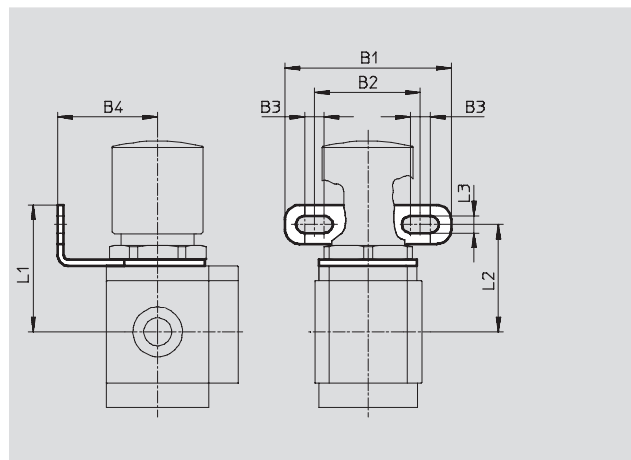

| Dimensions and ordering data |    |    |     |    |    |    |     |            |          |        |
|------------------------------|----|----|-----|----|----|----|-----|------------|----------|--------|
| Size                         | B1 | B2 | B3  | B4 | L1 | L2 | L3  | Weight [g] | Part No. | Type   |
| MS4                          | 68 | 44 | 8   | 41 | 52 | 44 | 7   | 49         | 526064   | MS4-WR |
| MS6                          | 70 | 42 | 8.2 | 40 | 67 | 57 | 7.1 | 90         | 526075   | MS6-WR |

### Hex nut MS4/6-WRS

- For front panel mounting
- For attaching the mounting bracket MS...-WR

Material:

Aluminium

Note on materials:

RoHS-compliant (MS6-WRS only)

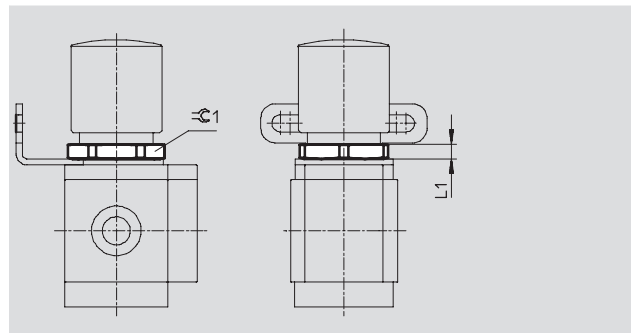

| Dimensions and ordering data |    |    |            |          |         |
|------------------------------|----|----|------------|----------|---------|
| Size                         | L1 | 1  | Weight [g] | Part No. | Type    |
| MS4                          | 6  | 36 | 6.9        | 532187   | MS4-WRS |
| MS6                          | 7  | 55 | 20.9       | 532188   | MS6-WRS |

## Accessories, MS series

Mounting attachments MS4/MS6

FESTO

### Mounting bracket MS4/6-WP...

Clearances for mounting service unit combinations

#### Size MS4

- 1 service unit with MS4-WP... :  
40.2 mm (20.1 mm)<sup>1)</sup>
- 2 service units with MS4-WP... :  
80.4 mm (40.2 mm)<sup>1)</sup>

#### Size MS6

- 1 service unit with
  - MS6-WP/WPB/WPE: 62 mm  
(31 mm)<sup>1)</sup>
  - MS6-WPM-D: 69 mm (38 mm)<sup>1)</sup>
- 2 service units with
  - MS6-WP/WPB/WPE: 124 mm  
(62 mm)<sup>1)</sup>
  - MS6-WPM-2D: 138 mm  
(76 mm)<sup>1)</sup>

#### Number of units

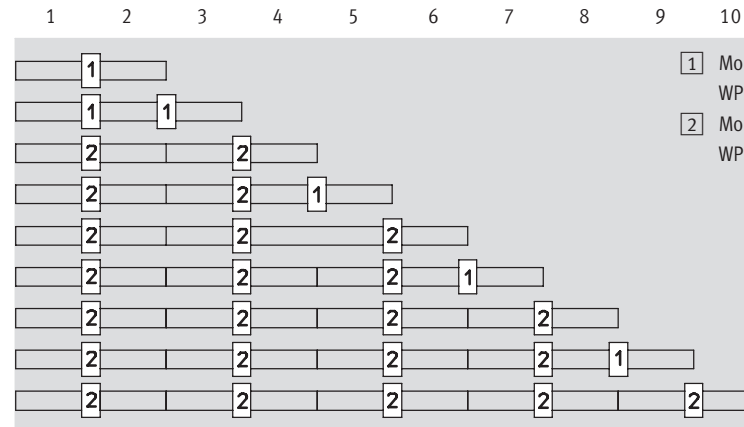

1) With distributor block MS-FRM-FRZ

### Mounting dimensions

#### Note

The distributor block MS4/6-FRM-FRZ has a dimension of half grid width.

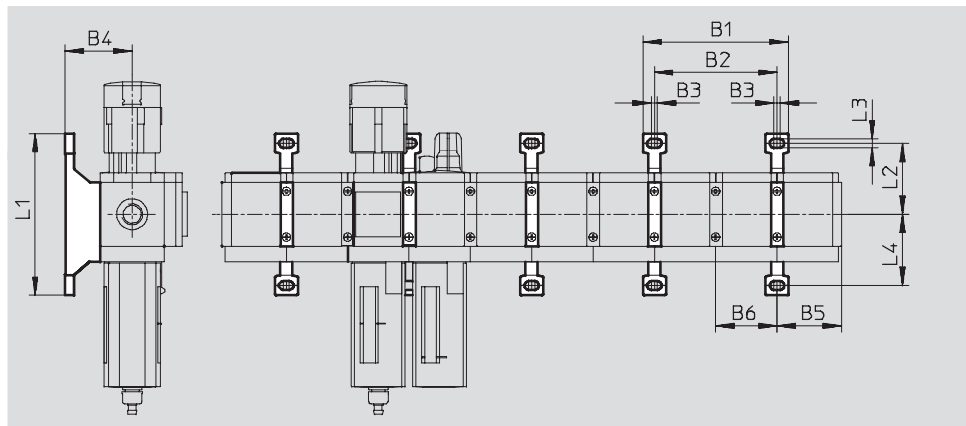

| Type         | 2 service units with grid dimension |      | 1 service unit with grid dimension and 1 distributor block MS-FRM-FRZ |      | 2 distributor blocks MS-FRM-FRZ |      | B3  | B4   | Service unit with grid dimension |      | Distributor block MS-FRM-FRZ |      | L1   | L2   | L3  | L4   |
|--------------|-------------------------------------|------|---|------|---------------------------------|------|-----|------|----------------------------------|------|------------------------------|------|------|------|-----|------|
|              | B1                                  | B2   | B1  | B2   | B1                              | B2   |     |      | B5 <sup>1)</sup>                 | B6   | B5 <sup>1)</sup>             | B6   |      |      |     |      |
| MS4-WP       | 95.4                                | 80.4 | 75.3  | 60.3 | 55.2                            | 40.2 | 4   | 44   | 41.9                             | 40.2 | 21.8                         | 20.1 | 106  | 46.5 | 5.6 | 46.7 |
| MS4-WPB/WPE  |                                     |      |   |      |                                 |      |     | 66   |                                  |      |                              |      | 92.8 | 34.8 |     | 45.2 |
| MS4-WPM-...D |                                     |      |   |      |                                 |      |     | 44   |                                  |      |                              |      |      |      |     |      |
| MS6-WP       | 141                                 | 124  | 110   | 93   | 79                              | 62   | 4.5 | 54.1 | 64.5                             | 62   | 33.5                         | 31   | 158  | 71   | 6.6 | 71   |
| MS6-WPB/WPE  |                                     |      |   |      |                                 |      |     | 90.5 |                                  |      |                              |      |      |      |     |      |
| MS6-WPM-...D |                                     |      |   |      |                                 |      |     | 54.1 |                                  |      |                              |      | 98.6 | 41.3 |     | 41.3 |

1) With accessory cover plate MS-END

## Accessories, MS series

Mounting attachments MS4/MS6

**FESTO**

### Mounting bracket MS4/6-WP

(order code: WP)

- For connecting modules via wall mounting
- In combination with a connecting plate MS4/6-AG... for individual wall mounting
- In combination with mounting plate MS4/6-AEND for individual wall mounting via direct thread
- For pressure regulator LRB with angled outlet block B... at rear

Material:

Die-cast aluminium

Note on materials:

RoHS-compliant (MS6-WP only)

Free of copper and PTFE

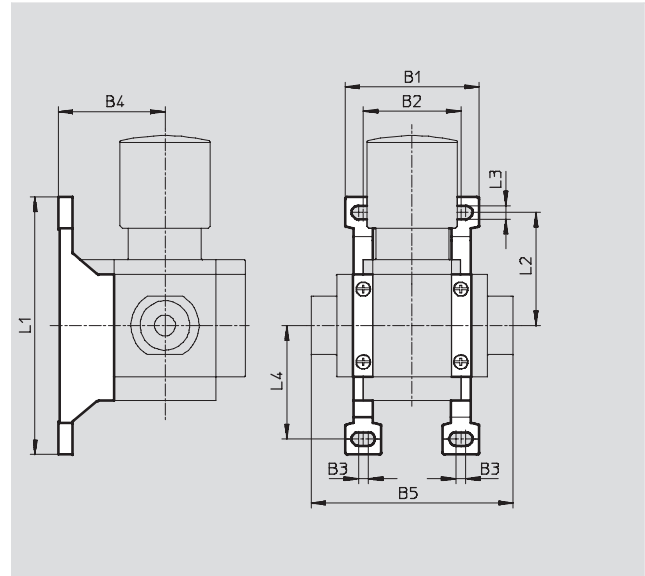

| Dimensions and ordering data                 |      |      |     |      |      |     |      |     |      |                   |            |          |           |
|--|------|------|-----|------|------|-----|------|-----|------|-------------------|------------|----------|-----------|
| Size   | B1   | B2   | B3  | B4   | B5   | L1  | L2   | L3  | L4   | CRC <sup>1)</sup> | Weight [g] | Part No. | Type      |
| MS4  | 55.2 | 40.2 | 4   | 44   | 83.4 | 106 | 46.5 | 5.6 | 46.7 | 2                 | 39         | 532184   | MS4-WP    |
| MS6  | 79   | 62   | 4.5 | 54.1 | 115  | 158 | 71   | 6.6 | 71   | 2                 | 76         | 532195   | MS6-WP    |
| For use in explosive areas in zones 2 and 22 |      |      |     |      |      |     |      |     |      |                   |            |          |           |
| MS4  | 55.2 | 40.2 | 4   | 44   | 83.4 | 106 | 46.5 | 5.6 | 46.7 | 2                 | 39         | 541554   | MS4-WP-EX |
| MS6  | 79   | 62   | 4.5 | 54.1 | 115  | 158 | 71   | 6.6 | 71   | 2                 | 76         | 541544   | MS6-WP-EX |

1) Corrosion resistance class 2 as per Festo standard 940 070

Components subject to moderate corrosion stress. Externally visible parts with primarily decorative surface requirements which are in direct contact with a normal industrial environment or media such as coolants or lubricating agents.

## Accessories, MS series

Mounting attachments MS4/MS6

FESTO

### Mounting bracket MS4/6-WPB

(order code: WPB)

- For connecting modules via wall mounting
- In combination with a connecting plate MS4/6-AG... for individual wall mounting
- In combination with mounting plate MS4/6-AEND for individual wall mounting via direct thread
- Provides large wall gap for pressure regulator

Material:

Die-cast aluminium

Note on materials:

RoHS-compliant (MS6-WPB only)

Free of copper and PTFE

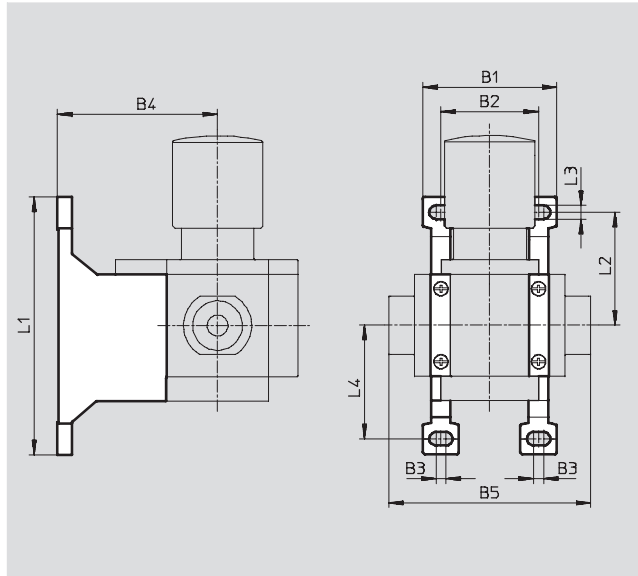

| Dimensions and ordering data                 |      |      |     |      |      |     |      |     |      |                   |            |                   |
|--|------|------|-----|------|------|-----|------|-----|------|-------------------|------------|-------------------|
| Size   | B1   | B2   | B3  | B4   | B5   | L1  | L2   | L3  | L4   | CRC <sup>1)</sup> | Weight [g] | Part No. Type     |
| MS4  | 55.2 | 40.2 | 4   | 66   | 83.4 | 106 | 46.5 | 5.6 | 46.7 | 2                 | 55         | 526063 MS4-WPB    |
| MS6  | 79   | 62   | 4.5 | 90.5 | 115  | 158 | 71   | 6.6 | 71   | 2                 | 115        | 526074 MS6-WPB    |
| For use in explosive areas in zones 2 and 22 |      |      |     |      |      |     |      |     |      |                   |            |                   |
| MS4  | 55.2 | 40.2 | 4   | 66   | 83.4 | 106 | 46.5 | 5.6 | 46.7 | 2                 | 55         | 541552 MS4-WPB-EX |
| MS6  | 79   | 62   | 4.5 | 90.5 | 115  | 158 | 71   | 6.6 | 71   | 2                 | 115        | 541542 MS6-WPB-EX |

1) Corrosion resistance class 2 as per Festo standard 940 070

Components subject to moderate corrosion stress. Externally visible parts with primarily decorative surface requirements which are in direct contact with a normal industrial environment or media such as coolants or lubricating agents.



## Accessories, MS series

Mounting attachments MS4/MS6

### Mounting bracket MS4/6-WPM

(order code: WPM)

- For connecting modules via wall mounting
- In combination with a connecting plate MS4/6-AG... for individual wall mounting
- Speedy attachment and detachment
- For installation of modules with regulating knob pointing downwards

The distance piece D or 2D (designated in the type code) is included in the scope of delivery and ensures the correct clearance

Material:

Die-cast aluminium

Note on materials:

RoHS-compliant (MS6-WPM only)

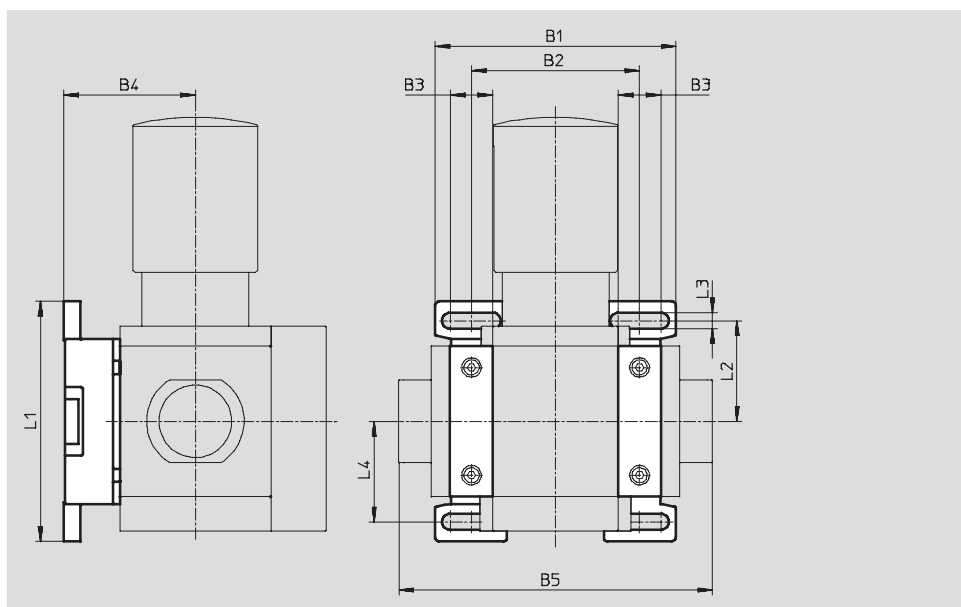
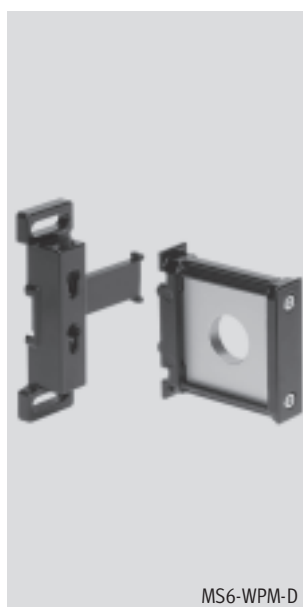
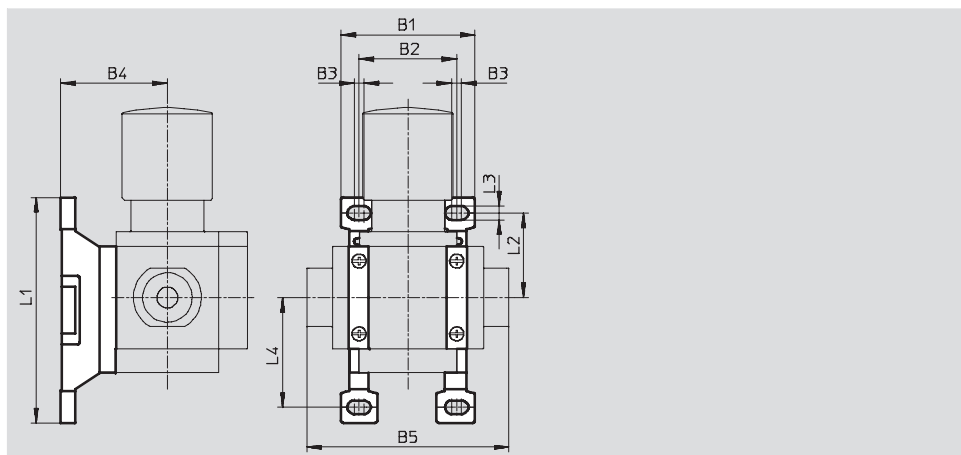

| Dimensions and ordering data |      |      |      |      |       |      |      |     |      |           |            |          |            |
|------------------------------|------|------|------|------|-------|------|------|-----|------|-----------|------------|----------|------------|
| Size                         | B1   | B2   | B3   | B4   | B5    | L1   | L2   | L3  | L4   | Clearance | Weight [g] | Part No. | Type       |
| MS4                          | 55.2 | 40.2 | 4    | 44   | 83.4  | 92.8 | 34.8 | 5.6 | 45.2 | 40.2      | 45         | 526060   | MS4-WPM-D  |
|                              | 95.4 | 80.4 |      |      | 123.4 |      |      |     |      | 80.4      | 55         | 526061   | MS4-WPM-2D |
| MS6                          | 99   | 69   | 17.5 | 54.1 | 129   | 98.6 | 41.3 | 6.6 | 41.3 | 69        | 144        | 526073   | MS6-WPM-D  |
|                              | 168  | 138  |      |      | 198   |      |      |     |      | 138       | 154        | 532186   | MS6-WPM-2D |

## Accessories, MS series

Mounting attachments MS4/MS6

FESTO

### Mounting bracket MS4/6-WPE

- Inexpensive alternative to mounting bracket MS4/6-WPB

Note on materials:

RoHS-compliant

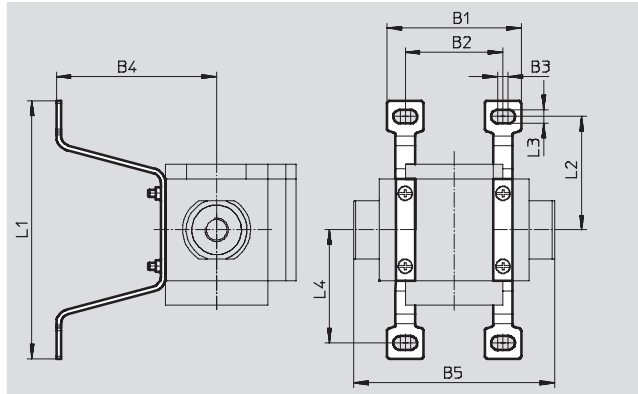

| Dimensions and ordering data |      |      |     |      |      |     |      |     |      |                   |          |         |
|------------------------------|------|------|-----|------|------|-----|------|-----|------|-------------------|----------|---------|
| Size                         | B1   | B2   | B3  | B4   | B5   | L1  | L2   | L3  | L4   | CRC <sup>1)</sup> | Part No. | Type    |
| MS4                          | 55.2 | 40.2 | 4.2 | 66   | 83.4 | 106 | 46.6 | 5.7 | 46.6 | 2                 | 558869   | MS4-WPE |
| MS6                          | 79   | 62   | 4.3 | 90.5 | 115  | 158 | 71   | 6.5 | 71   | 2                 | 1025936  | MS6-WPE |

1) Corrosion resistance class 2 as per Festo standard 940 070

Components subject to moderate corrosion stress. Externally visible parts with primarily decorative surface requirements which are in direct contact with a normal industrial environment or media such as coolants or lubricating agents.

### Module connector MS4/6-MV

- For connecting modules

Material:

Stainless steel/polyacetal

Note on materials:

RoHS-compliant (MS6-MV only)

Free of copper and PTFE



| Ordering data                                |                   |            |          |           |
|--|-------------------|------------|----------|-----------|
| Size   | CRC <sup>1)</sup> | Weight [g] | Part No. | Type      |
| MS4  | 2                 | 36         | 532798   | MS4-MV    |
| MS6  | 2                 | 54         | 532799   | MS6-MV    |
| For use in explosive areas in zones 2 and 22 |                   |            |          |           |
| MS4  | 2                 | 36         | 541553   | MS4-MV-EX |
| MS6  | 2                 | 54         | 541543   | MS6-MV-EX |

1) Corrosion resistance class 2 as per Festo standard 940 070

Components subject to moderate corrosion stress. Externally visible parts with primarily decorative surface requirements which are in direct contact with a normal industrial environment or media such as coolants or lubricating agents.

# Accessories, MS series

Mounting attachments MS4/MS6



## Module connector MS4/6-MVM

- For installation of modules with regulating knob pointing downwards

Material:  
Die-cast aluminium

Note on materials:  
RoHS-compliant (MS6-MVM only)

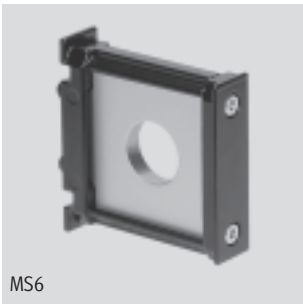

| Ordering data |          |         |
|---------------|----------|---------|
| Size          | Part No. | Type    |
| MS4           | 532800   | MS4-MVM |
| MS6           | 532801   | MS6-MVM |

## Accessories, MS series

Mounting attachments MS9

**FESTO**

### Mounting bracket MS9-WP...

Clearances for mounting service unit combinations

1 service unit: 90 mm

2 service units: 180 mm

Number of units

1 2 3 4 5 6 7 8 9 10

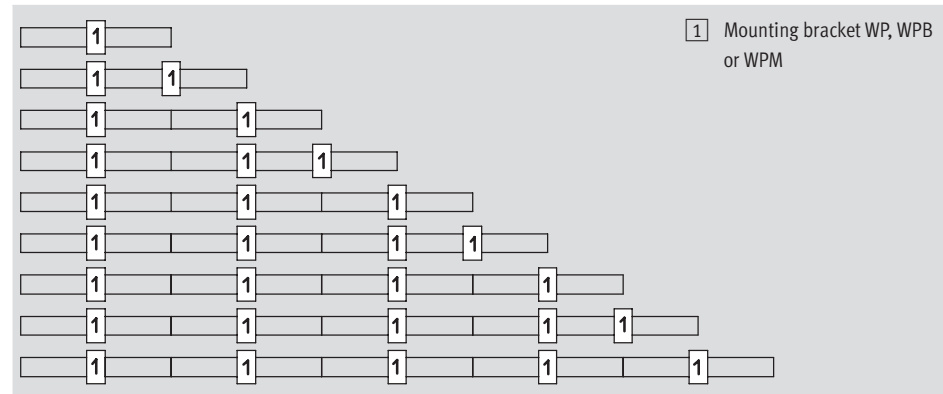

### Mounting dimensions

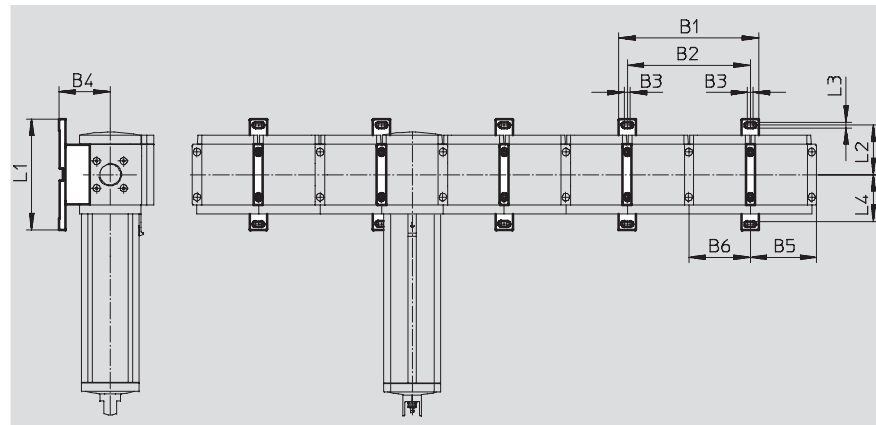

| Type    | B1  | B2  | B3  | B4   | B5 | B6 | L1  | L2    | L3  | L4    |
|---------|-----|-----|-----|------|----|----|-----|-------|-----|-------|
| MS9-WP  | 205 | 180 | 8.5 | 75   | 97 | 90 | 162 | 72.75 | 8.3 | 72.25 |
| MS9-WPB |     |     |     | 99   |    |    |     |       |     |       |
| MS9-WPM |     |     |     | 90.5 |    |    |     |       |     |       |

## Accessories, MS series

Mounting attachments MS9

### Mounting bracket MS9-WP

(order code: WP)

- For connecting modules via wall mounting
- In combination with a connecting plate MS9-AG... for individual wall mounting

Material:

Module connector, bracket,  
hollow bolt: Die-cast aluminium

Screws: Steel

Seals: Nitrile rubber

RoHS-compliant

Free of copper and PTFE

Temperature of medium:

-10 ... +60 °C

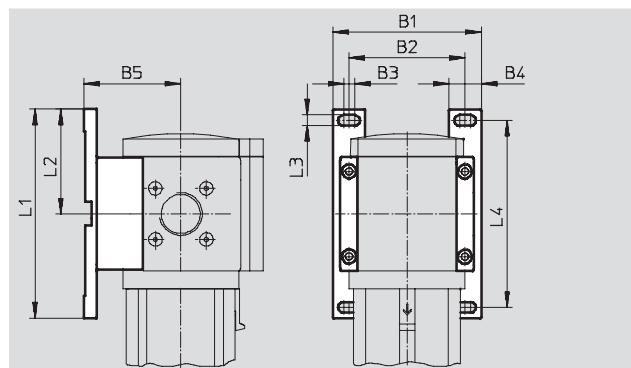

| Dimensions and ordering data |     |    |     |    |    |     |       |     |     |                   |            |               |
|------------------------------|-----|----|-----|----|----|-----|-------|-----|-----|-------------------|------------|---------------|
| Size                         | B1  | B2 | B3  | B4 | B5 | L1  | L2    | L3  | L4  | CRC <sup>1)</sup> | Weight [g] | Part No. Type |
| MS9                          | 115 | 90 | 8.5 | 25 | 75 | 162 | 81.25 | 8.3 | 145 | 2                 | 180        | 552947 MS9-WP |

1) Corrosion resistance class 2 as per Festo standard 940 070

Components subject to moderate corrosion stress. Externally visible parts with primarily decorative surface requirements which are in direct contact with a normal industrial environment or media such as coolants or lubricating agents.

### Mounting bracket MS9-WPB

(order code: WPB)

- For connecting modules via wall mounting
- In combination with a connecting plate MS9-AG... for individual wall mounting
- Same wall gap for combination with MS12 series using the mounting bracket MS12-WP

Material:

Module connector, bracket,  
hollow bolt: Die-cast aluminium

Screws: Steel

Seals: Nitrile rubber

RoHS-compliant

Free of copper and PTFE

Temperature of medium:

-10 ... +60 °C

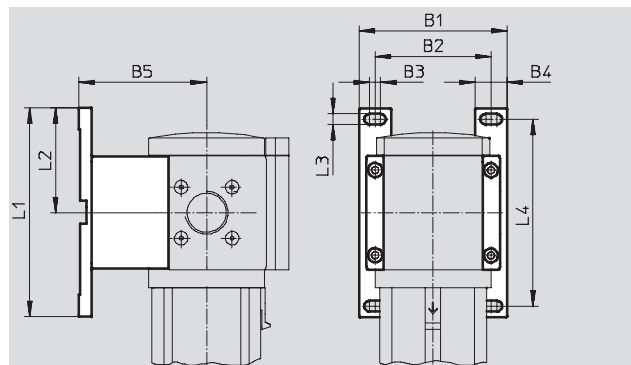

| Dimensions and ordering data |     |    |     |    |    |     |       |     |     |                   |            |                |
|------------------------------|-----|----|-----|----|----|-----|-------|-----|-----|-------------------|------------|----------------|
| Size                         | B1  | B2 | B3  | B4 | B5 | L1  | L2    | L3  | L4  | CRC <sup>1)</sup> | Weight [g] | Part No. Type  |
| MS9                          | 115 | 90 | 8.5 | 25 | 99 | 162 | 81.25 | 8.3 | 145 | 2                 | 210        | 552949 MS9-WPB |

1) Corrosion resistance class 2 as per Festo standard 940 070

Components subject to moderate corrosion stress. Externally visible parts with primarily decorative surface requirements which are in direct contact with a normal industrial environment or media such as coolants or lubricating agents.

## Accessories, MS series

Mounting attachments MS9

**FESTO**

### Mounting bracket MS9-WPM

(order code: WPM)

- For connecting modules via wall mounting
- In combination with a connecting plate MS9-AG... for individual wall mounting

- Speedy attachment and detachment
- Same wall gap for combination with MS6 series using the mounting bracket MS6-WPB

The distance pieces included in the scope of delivery ensure the correct clearance.

Material:

Module connector, bracket, hollow

bolt: Die-cast aluminium

Screws: Steel

Seals: Nitrile rubber

RoHS-compliant

Free of copper and PTFE

Temperature of medium:

-10 ... +60 °C

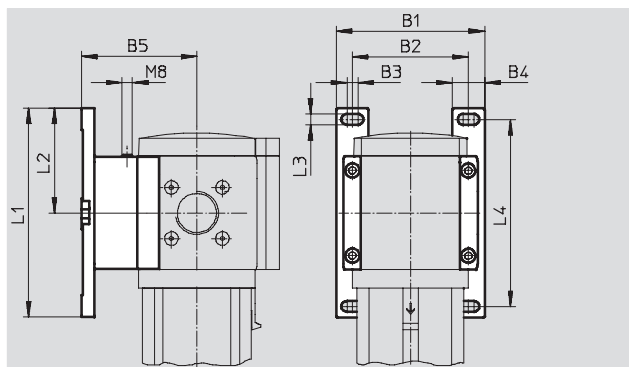

| Dimensions and ordering data |     |    |     |    |      |     |       |     |     |                   |            |                |
|------------------------------|-----|----|-----|----|------|-----|-------|-----|-----|-------------------|------------|----------------|
| Size                         | B1  | B2 | B3  | B4 | B5   | L1  | L2    | L3  | L4  | CRC <sup>1)</sup> | Weight [g] | Part No. Type  |
| MS9                          | 115 | 90 | 8.5 | 25 | 90.5 | 162 | 81.25 | 8.3 | 145 | 2                 | 220        | 552948 MS9-WPM |

1) Corrosion resistance class 2 as per Festo standard 940 070

Components subject to moderate corrosion stress. Externally visible parts with primarily decorative surface requirements which are in direct contact with a normal industrial environment or media such as coolants or lubricating agents.

### Module connector MS9-MV

- For connecting modules

Material:

Module connector, hollow bolt:

Die-cast aluminium

Screws: Steel

Seals: Nitrile rubber

RoHS-compliant

Free of copper and PTFE

Temperature of medium:

-10 ... +60 °C

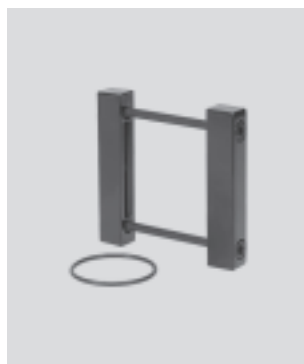

| Ordering data |                   |            |               |
|---------------|-------------------|------------|---------------|
| Size          | CRC <sup>1)</sup> | Weight [g] | Part No. Type |
| MS9           | 2                 | 110        | 552950 MS9-MV |

1) Corrosion resistance class 2 as per Festo standard 940 070

Components subject to moderate corrosion stress. Externally visible parts with primarily decorative surface requirements which are in direct contact with a normal industrial environment or media such as coolants or lubricating agents.

# Accessories, MS series

Mounting attachments MS12

## Mounting bracket MS12-WP (order code: WP)

- For connecting modules via wall mounting
- In combination with a connecting plate for individual wall mounting

Material:  
Die-cast aluminium  
Free of copper and PTFE

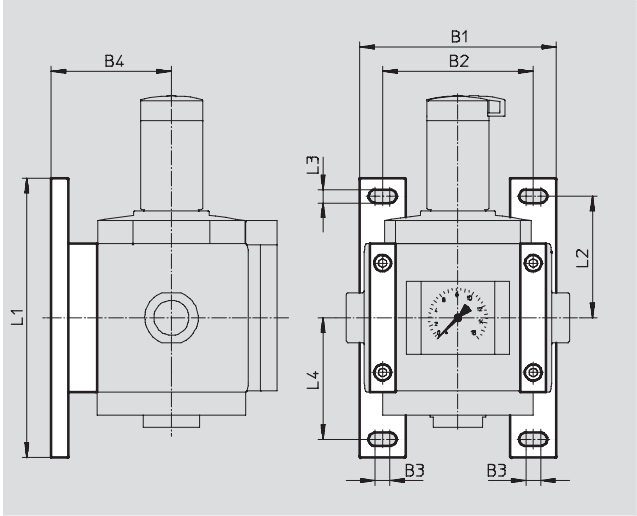

| Dimensions and ordering data |     |     |    |    |     |     |    |     |            |          |         |
|------------------------------|-----|-----|----|----|-----|-----|----|-----|------------|----------|---------|
| Size                         | B1  | B2  | B3 | B4 | L1  | L2  | L3 | L4  | Weight [g] | Part No. | Type    |
| MS12                         | 162 | 124 | 12 | 99 | 230 | 100 | 11 | 100 | 700        | 537133   | MS12-WP |

## Module connector MS12-MV

- For connecting modules

Material:  
Die-cast aluminium  
Free of copper and PTFE



| Ordering data |            |          |         |
|---------------|------------|----------|---------|
| Size          | Weight [g] | Part No. | Type    |
| MS12          | 500        | 537134   | MS12-MV |

# Accessories, MS series

Mounting attachments MS4/MS6

FESTO

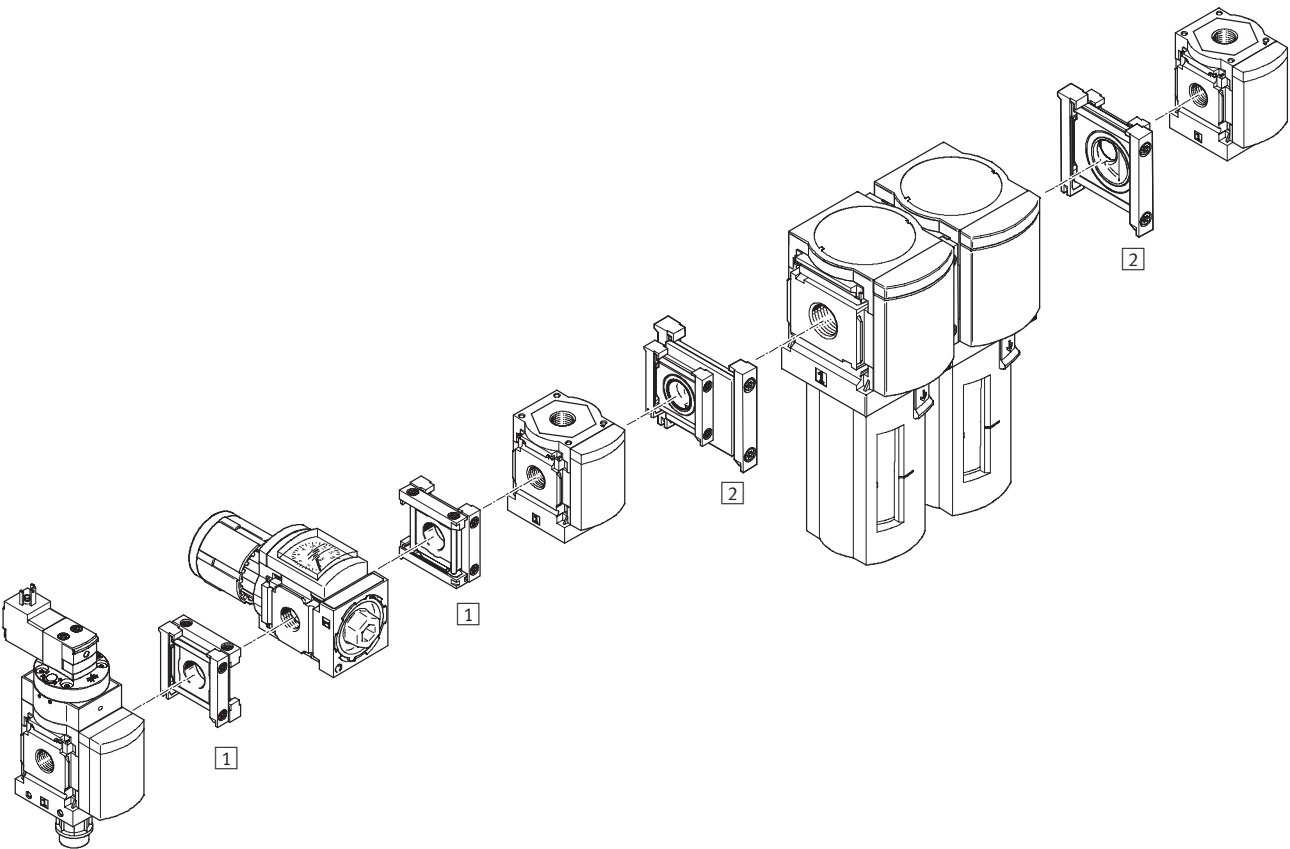

| Mounting attachments |                               | → Page/Internet |
|----------------------|-------------------------------|-----------------|
| 1                    | Module connector<br>MS4/6-RMV | 17              |
| 2                    | Module connector<br>MS4-6-AMV | 18              |

**Note**  
Mounting attachments for wall  
mounting → 6



## Accessories, MS series

Mounting attachments MS4/MS6

**FESTO**

### Module connector MS4/6-RMV

- For connecting service units at right angles to the axis of connection

Material:

Connecting plate, module connector:

Die-cast aluminium

Sealing ring: Nitrile rubber

RoHS-compliant

Temperature of medium:

–10 ... +60 °C

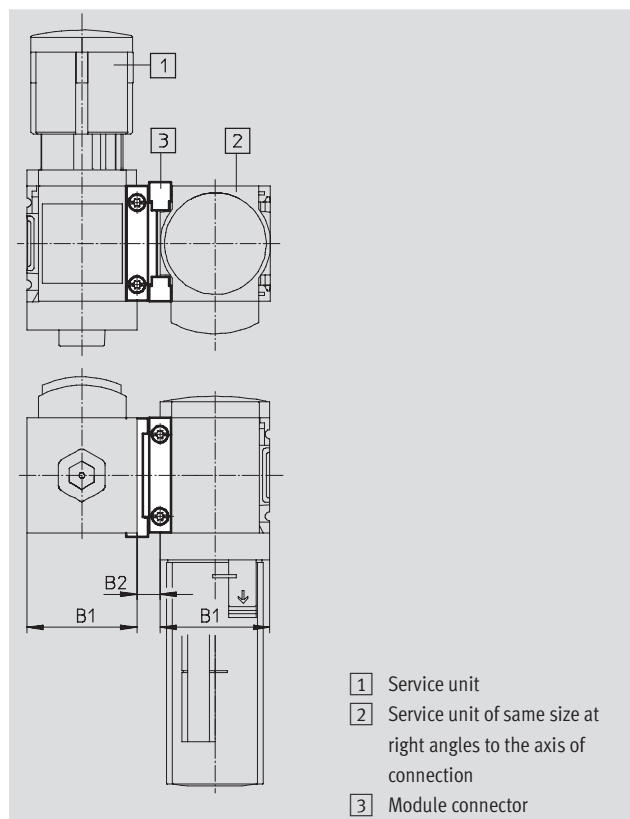

| Dimensions and ordering data                 |      |     |                   |            |          |            |
|--|------|-----|-------------------|------------|----------|------------|
| Size   | B1   | B2  | CRC <sup>1)</sup> | Weight [g] | Part No. | Type       |
| MS4  | 40.2 | 8.5 | 2                 | 42         | 543490   | MS4-RMV    |
| MS6  | 62   | 11  | 2                 | 112        | 543491   | MS6-RMV    |
| For use in explosive areas in zones 2 and 22 |      |     |                   |            |          |            |
| MS4  | 40.2 | 8.5 | 2                 | 42         | 563393   | MS4-RMV-EX |
| MS6  | 62   | 11  | 2                 | 112        | 563394   | MS6-RMV-EX |

1) Corrosion resistance class 2 as per Festo standard 940 070

Components subject to moderate corrosion stress. Externally visible parts with primarily decorative surface requirements which are in direct contact with a normal industrial environment or media such as coolants or lubricating agents.

## Accessories, MS series

Mounting attachments MS4/MS6

FESTO

### Module connector MS4-6-AMV

- For connecting MS4 and MS6 service units into one unit

Material:

Connecting plate, module connector:

Die-cast aluminium

Sealing ring: Nitrile rubber

RoHS-compliant

Temperature of medium:

-10 ... +60 °C

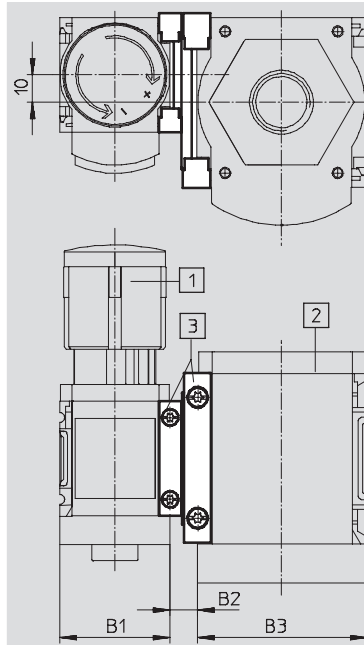

- 1 Service unit size MS4
- 2 Service unit size MS6
- 3 Module connector

| Dimensions and ordering data                 |      |    |    |                   |            |          |              |
|--|------|----|----|-------------------|------------|----------|--------------|
| Size   | B1   | B2 | B3 | CRC <sup>1)</sup> | Weight [g] | Part No. | Type         |
| MS4/6  | 40.2 | 10 | 62 | 2                 | 77         | 543489   | MS4-6-AMV    |
| For use in explosive areas in zones 2 and 22 |      |    |    |                   |            |          |              |
| MS4/6  | 40.2 | 10 | 62 | 2                 | 77         | 563392   | MS4-6-AMV-EX |

1) Corrosion resistance class 2 as per Festo standard 940 070

Components subject to moderate corrosion stress. Externally visible parts with primarily decorative surface requirements which are in direct contact with a normal industrial environment or media such as coolants or lubricating agents.

## Accessories, MS series

Mounting attachments MS6/MS9

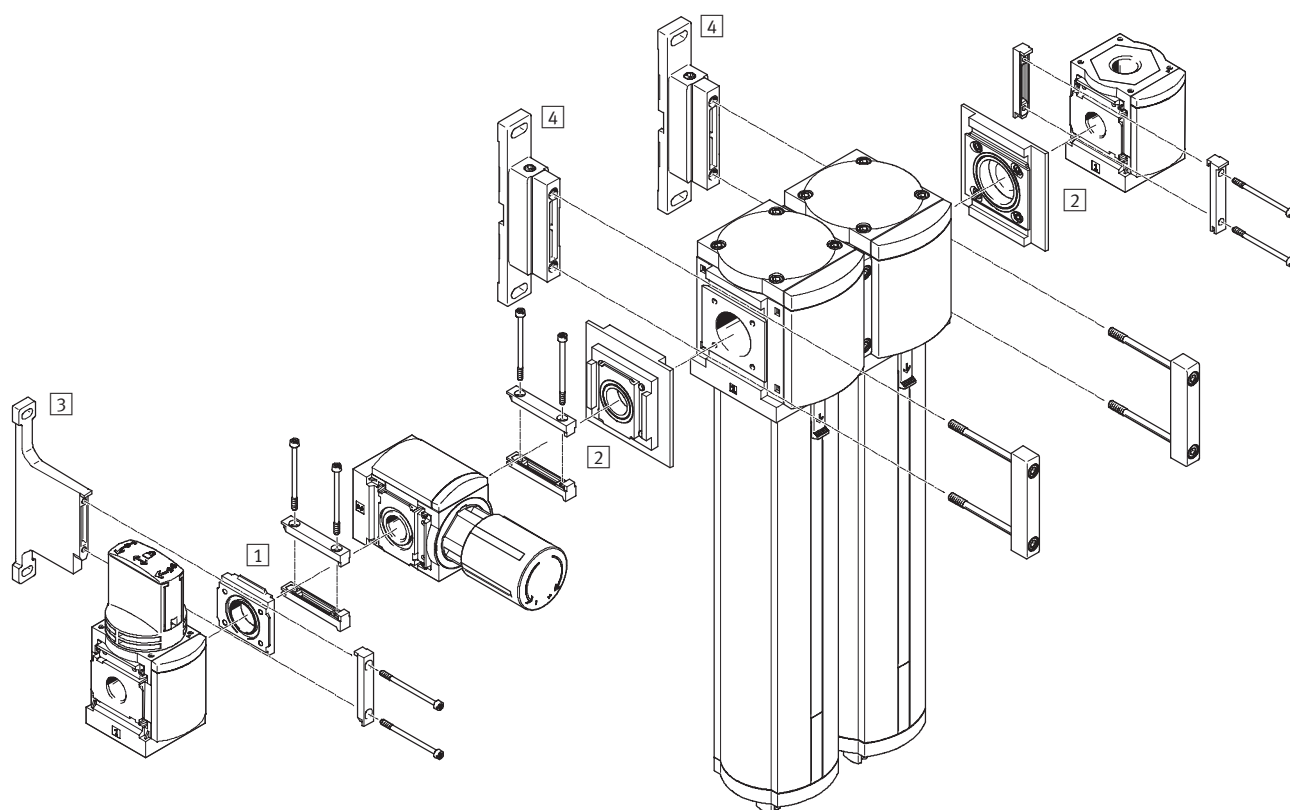

| Mounting attachments |                                | → Page/Internet |
|----------------------|--------------------------------|-----------------|
| 1                    | Module connector<br>MS6-RMV    | 17              |
| 2                    | Module connector<br>MS6-9-ARMV | 20              |
| 3                    | Mounting bracket<br>MS6-WPB    | 8               |
| 4                    | Mounting bracket<br>MS9-WPM    | 14              |

## Accessories, MS series

Module connector MS6/MS9

**FESTO**

### Module connector MS6-9-ARMV

- For connecting MS6 and MS9 service units into one unit
- Rotation of service unit at right angles to the axis of connection possible

Material:

Connecting plate, module connector:

Die-cast aluminium

Screws: Steel

Seals: Nitrile rubber

RoHS-compliant

Free of copper and PTFE

Temperature of medium:

-10 ... +60 °C

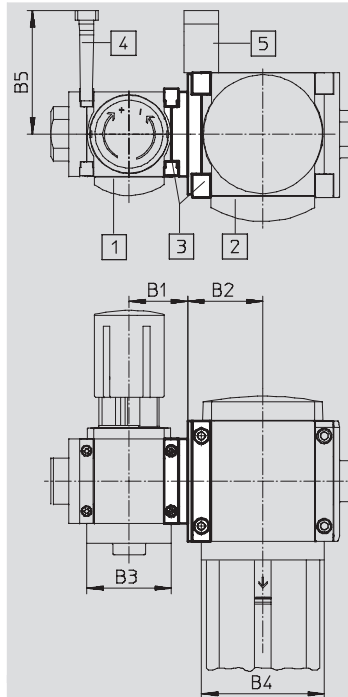

- 1 Service unit size MS6
- 2 Service unit size MS9
- 3 Module connector
- 4 Mounting bracket MS6-WPB
- 5 Mounting bracket MS9-WPM

### Note

The larger mounting bracket must always be used on the module connector. The mounting bracket must be ordered separately.

| Dimensions and ordering data |    |    |    |    |      |                   |            |          |            |
|------------------------------|----|----|----|----|------|-------------------|------------|----------|------------|
| Size                         | B1 | B2 | B3 | B4 | B5   | CRC <sup>1)</sup> | Weight [g] | Part No. | Type       |
| MS6/9                        | 43 | 55 | 62 | 90 | 90.5 | 2                 | 350        | 552951   | MS6-9-ARMV |

1) Corrosion resistance class 2 as per Festo standard 940 070

Components subject to moderate corrosion stress. Externally visible parts with primarily decorative surface requirements which are in direct contact with a normal industrial environment or media such as coolants or lubricating agents.

## Accessories, MS series

Mounting attachments MS9/MS12

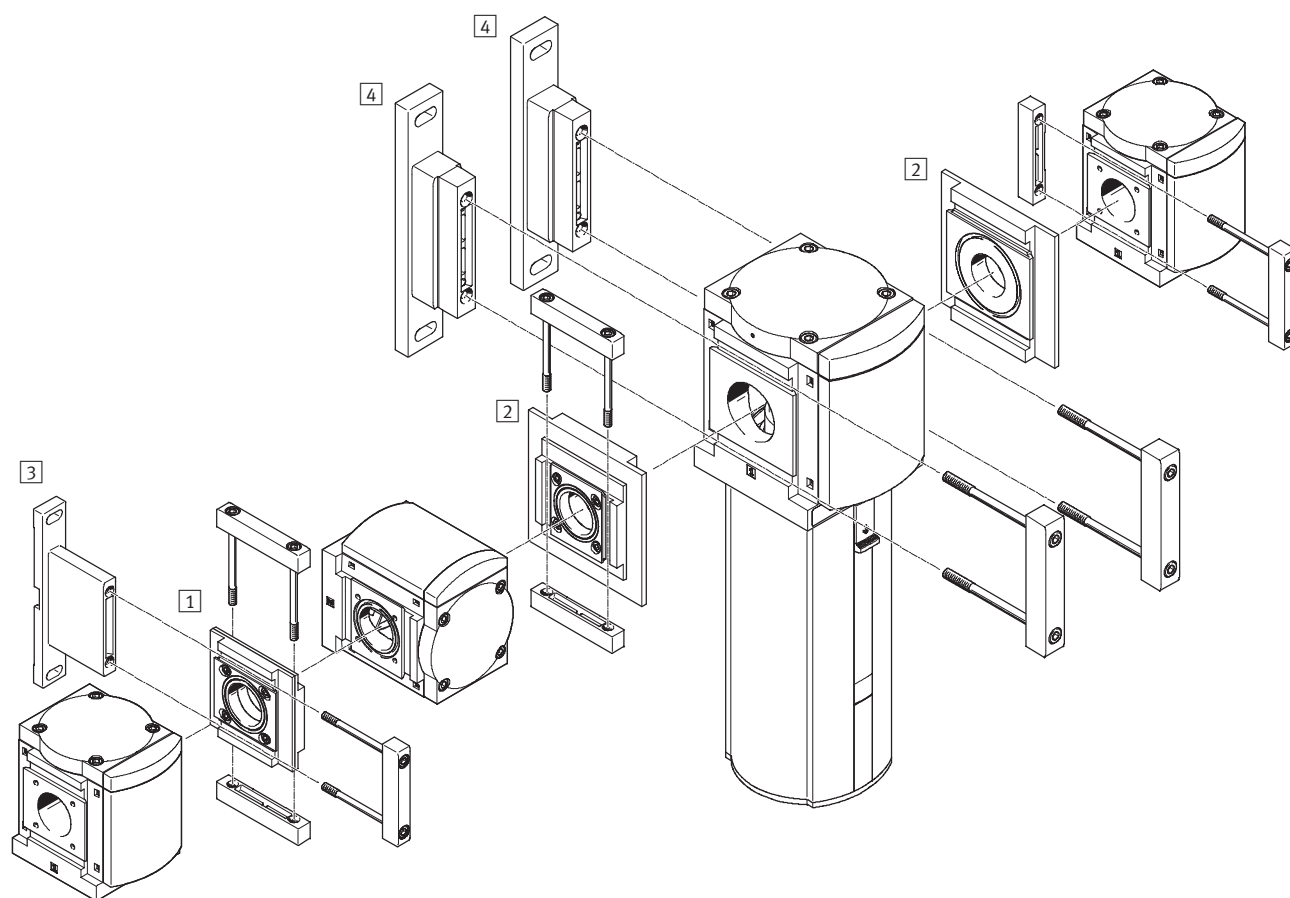

| Mounting attachments |                                 | → Page/Internet |
|----------------------|---------------------------------|-----------------|
| 1                    | Module connector<br>MS9-RMV     | 22              |
| 2                    | Module connector<br>MS9-12-ARMV | 23              |
| 3                    | Mounting bracket<br>MS9-WPB     | 13              |
| 4                    | Mounting bracket<br>MS12-WP     | 15              |

## Accessories, MS series

Mounting attachments MS9/MS12

**FESTO**

### Module connector MS9-RMV

- For connecting service units at right angles to the axis of connection

Material:

Connecting plate, module connector:

Die-cast aluminium

Screws: Steel

Seals: Nitrile rubber

RoHS-compliant

Free of copper and PTFE

Temperature of medium:

-10 ... +60 °C

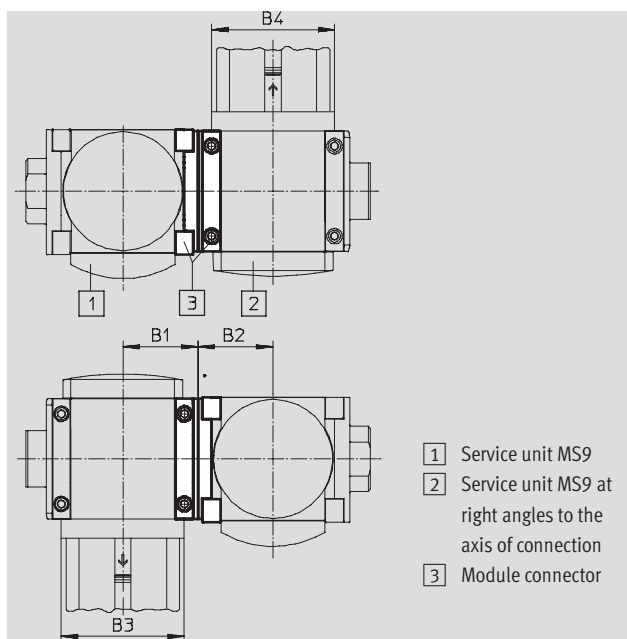

### Dimensions and ordering data

| Size | B1 | B2 | B3 | B4 | CRC <sup>1)</sup> | Weight [g] | Part No. | Type    |
|------|----|----|----|----|-------------------|------------|----------|---------|
| MS9  | 55 | 55 | 90 | 90 | 2                 | 920        | 552952   | MS9-RMV |

1) Corrosion resistance class 2 as per Festo standard 940 070

Components subject to moderate corrosion stress. Externally visible parts with primarily decorative surface requirements which are in direct contact with a normal industrial environment or media such as coolants or lubricating agents.

## Accessories, MS series

Mounting attachments MS9/MS12

### Module connector MS9-12-ARMV

- For connecting MS9 and MS12 service units into one unit
- Rotation of service unit at right angles to the axis of connection possible

Material:

Connecting plate, module connector:

Die-cast aluminium

Screws: Steel

Seals: Nitrile rubber

RoHS-compliant

Free of copper and PTFE

Temperature of medium:

-10 ... +60 °C

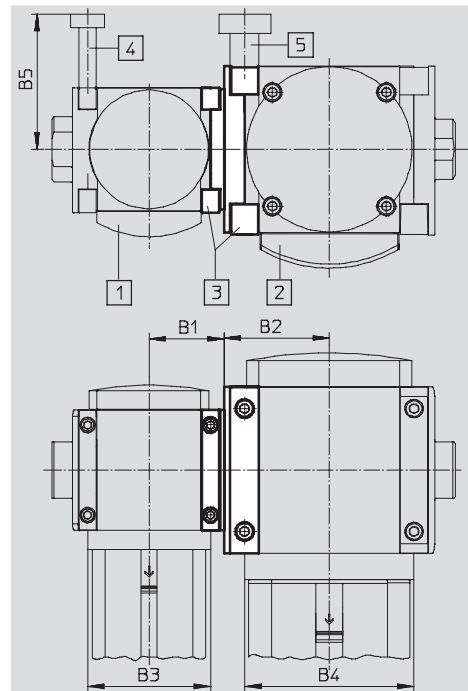

- 1 Service unit size MS9
- 2 Service unit size MS12
- 3 Module connector
- 4 Mounting bracket MS9-WPB
- 5 Mounting bracket MS12-WP

### Note

The larger mounting bracket must always be used on the module connector. The mounting bracket must be ordered separately.

### Dimensions and ordering data

| Size   | B1 | B2 | B3 | B4  | B5 | CRC <sup>1)</sup> | Weight [g] | Part No. | Type        |
|--------|----|----|----|-----|----|-------------------|------------|----------|-------------|
| MS9/12 | 55 | 77 | 90 | 124 | 99 | 2                 | 990        | 552953   | MS9-12-ARMV |

1) Corrosion resistance class 2 as per Festo standard 940 070

Components subject to moderate corrosion stress. Externally visible parts with primarily decorative surface requirements which are in direct contact with a normal industrial environment or media such as coolants or lubricating agents.

## Accessories, MS series

Mounting attachments MS4/MS6

FESTO

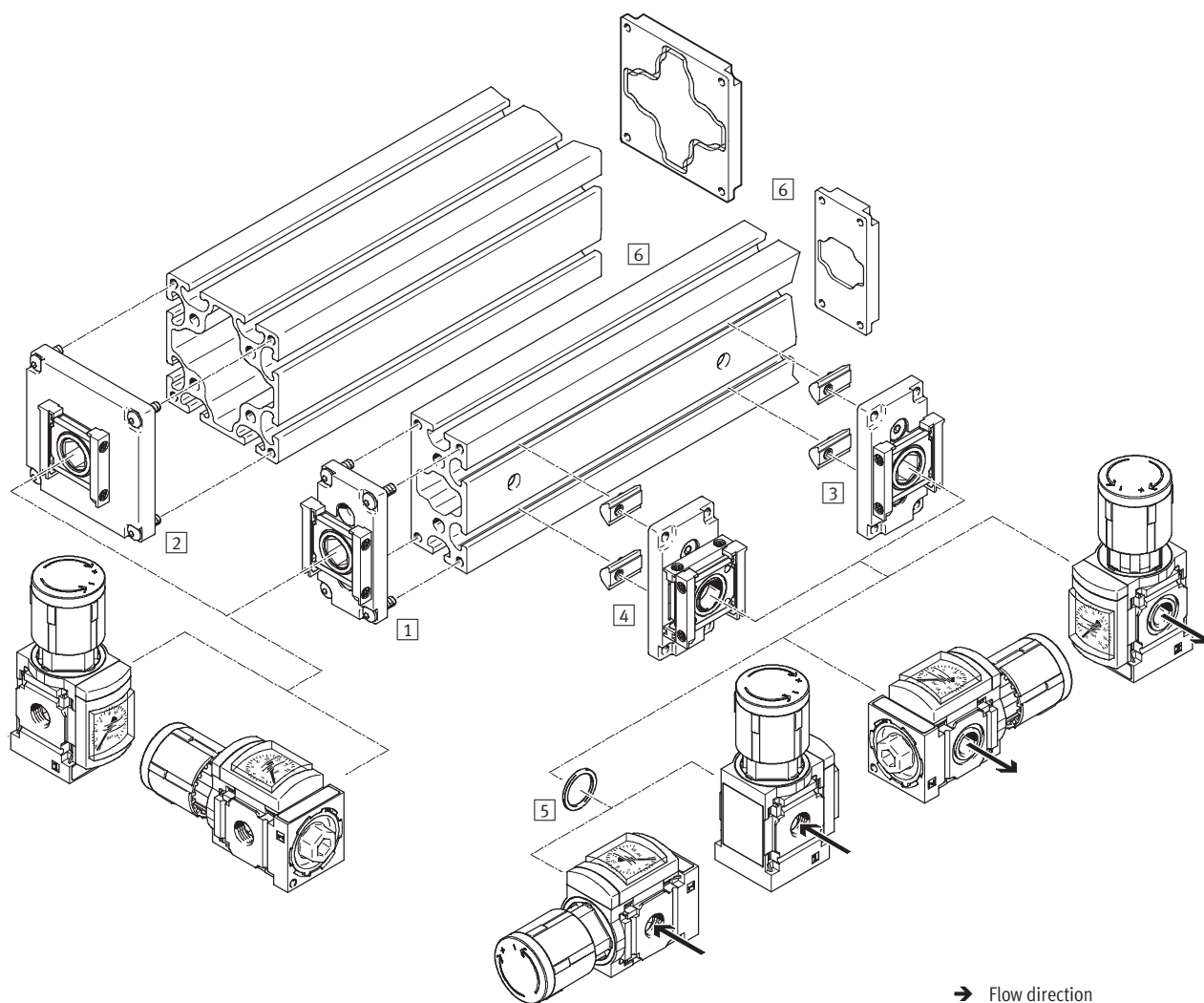

| Mounting attachments |  | → Page/Internet |
|----------------------|--|-----------------|
| 1                    | Power supply module<br>MS4/6-E-IPM-40-80                     | 25              |
| 2                    | Power supply module<br>MS4/6-E-IPM-80-80                     | 26              |
| 3                    | Branching module<br>MS4/6-A-IPM-80                           | 27              |
| 4                    | Branching module<br>MS4/6-A-RMV-IPM-80                       | 28              |
| 5                    | Sealing ring<br>MS4/6-NNR                                    | 29              |
| 6                    | Profile 40x80/80x80, cover plate, supply plate, drilling jig | On request      |

### Note

Further mounting attachments are required for mounting a service unit combination → 6



## Accessories, MS series

Mounting attachments MS4/MS6

**FESTO**

### Power supply module

#### MS4/6-E-IPM-40-80

- For mounting a service unit to the front of a profile of size 40x80
- Module connector can be repositioned by 90° for horizontal mounting of a service unit

Material:

Connecting plate, hollow bolt, module connector: Die-cast aluminium

Screws: Steel

Seals: Nitrile rubber

RoHS-compliant

Temperature of medium:

-10 ... +60 °C

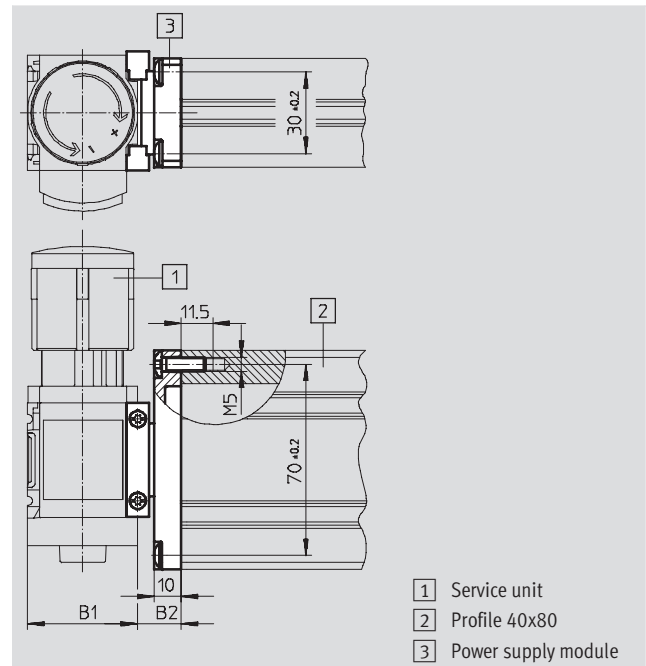

- 1 Service unit
- 2 Profile 40x80
- 3 Power supply module

| Dimensions and ordering data |      |    |                   |            |          |                 |
|------------------------------|------|----|-------------------|------------|----------|-----------------|
| Size                         | B1   | B2 | CRC <sup>1)</sup> | Weight [g] | Part No. | Type            |
| MS4                          | 40.2 | 16 | 2                 | 109        | 543494   | MS4-E-IPM-40-80 |
| MS6                          | 62   | 16 | 2                 | 141        | 543496   | MS6-E-IPM-40-80 |

1) Corrosion resistance class 2 as per Festo standard 940 070

Components subject to moderate corrosion stress. Externally visible parts with primarily decorative surface requirements which are in direct contact with a normal industrial environment or media such as coolants or lubricating agents.

## Accessories, MS series

Mounting attachments MS4/MS6

FESTO

### Power supply module

#### MS4/6-E-IPM-80-80

- For mounting a service unit to the front of a profile of size 80x80
- Module connector can be repositioned by 90° for horizontal mounting of a service unit

Material:

Connecting plate, hollow bolt, module

connector: Die-cast aluminium

Screws: Steel

Seals: Nitrile rubber

RoHS-compliant

Temperature of medium:

-10 ... +60 °C

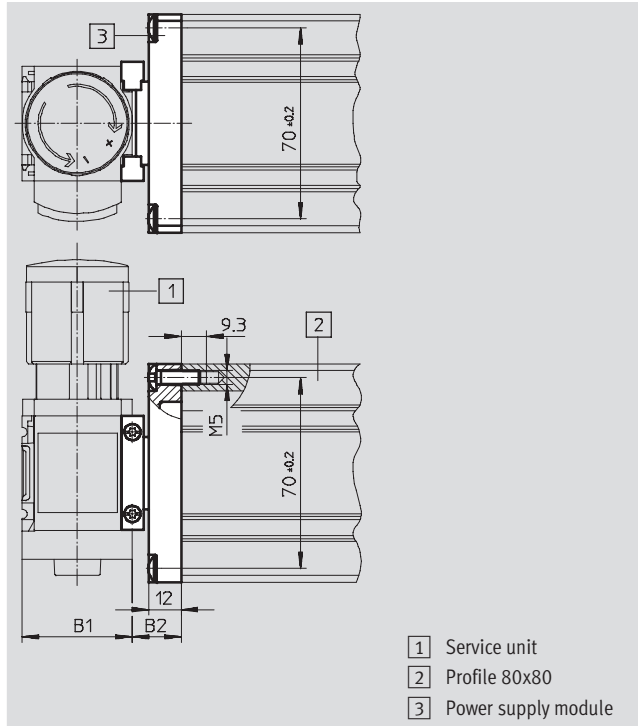

| Dimensions and ordering data |      |    |                   |            |          |                 |
|------------------------------|------|----|-------------------|------------|----------|-----------------|
| Size                         | B1   | B2 | CRC <sup>1)</sup> | Weight [g] | Part No. | Type            |
| MS4                          | 40.2 | 18 | 2                 | 186        | 543495   | MS4-E-IPM-80-80 |
| MS6                          | 62   | 18 | 2                 | 218        | 543497   | MS6-E-IPM-80-80 |

1) Corrosion resistance class 2 as per Festo standard 940 070

Components subject to moderate corrosion stress. Externally visible parts with primarily decorative surface requirements which are in direct contact with a normal industrial environment or media such as coolants or lubricating agents.

## Accessories, MS series

Mounting attachments MS4/MS6

FESTO

### Branching module MS4/6-A-IPM-80

- For mounting a service unit on the long side of a profile
- Module connector can be repositioned by 90° for horizontal mounting of a service unit

Material:

Connecting plate, hollow bolt, module connector: Die-cast aluminium

Screws: Steel

Seals: Nitrile rubber

RoHS-compliant

Temperature of medium:

-10 ... +60 °C

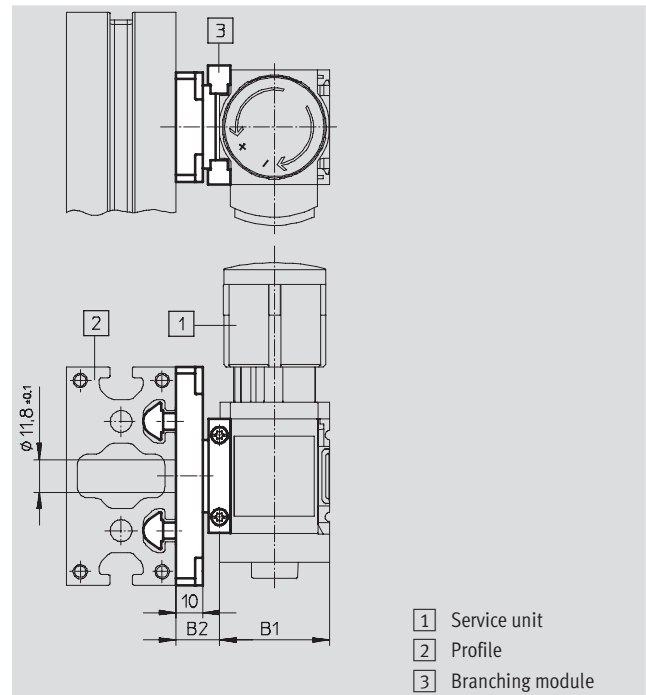
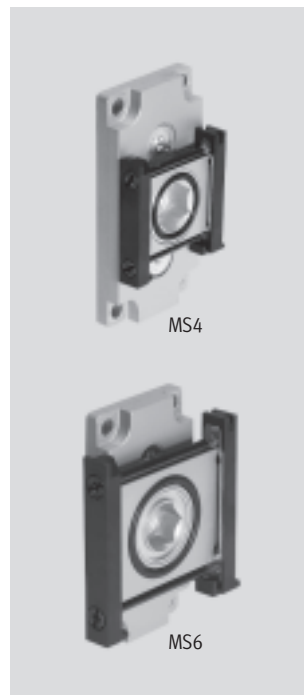

| Dimensions and ordering data |      |    |                   |            |          |              |
|------------------------------|------|----|-------------------|------------|----------|--------------|
| Size                         | B1   | B2 | CRC <sup>1)</sup> | Weight [g] | Part No. | Type         |
| MS4                          | 40.2 | 16 | 2                 | 124        | 543498   | MS4-A-IPM-80 |
| MS6                          | 62   | 16 | 2                 | 156        | 543499   | MS6-A-IPM-80 |

1) Corrosion resistance class 2 as per Festo standard 940 070  
Components subject to moderate corrosion stress. Externally visible parts with primarily decorative surface requirements which are in direct contact with a normal industrial environment or media such as coolants or lubricating agents.

## Accessories, MS series

Mounting attachments MS4/MS6

FESTO

### Branching module

#### MS4/6-A-RMV-IPM-80

- For mounting a service unit on the long side of a profile
- Suitable for manifold mounting (the fittings on the module connector can be accessed from above for fast replacement of an individual component)
- Module connector can be repositioned by 90° for horizontal mounting of a service unit

Material:

Connecting plate, hollow bolt,

module connector:

Die-cast aluminium

Screws: Steel

Seals: Nitrile rubber

RoHS-compliant

Temperature of medium:

-10 ... +60 °C

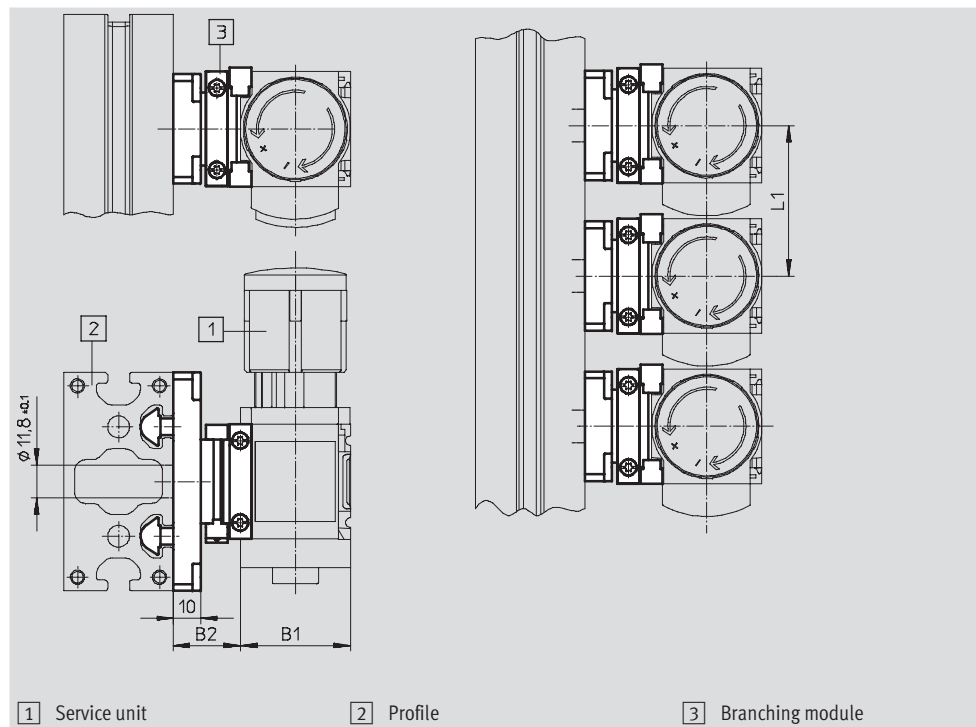
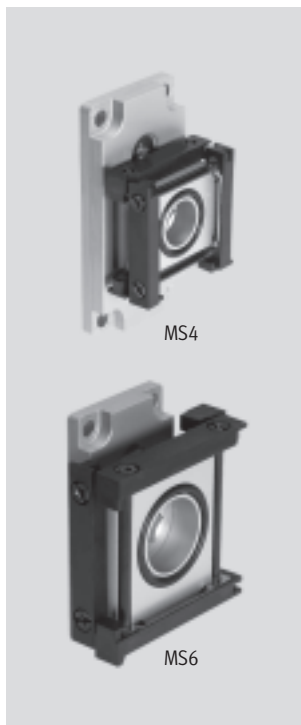

| Dimensions and ordering data |      |      |    |                   |            |          |                  |
|------------------------------|------|------|----|-------------------|------------|----------|------------------|
| Size                         | B1   | B2   | L1 | CRC <sup>1)</sup> | Weight [g] | Part No. | Type             |
| MS4                          | 40.2 | 24.5 | 55 | 2                 | 150        | 543500   | MS4-A-RMV-IPM-80 |
| MS6                          | 62   | 27   | 77 | 2                 | 236        | 543501   | MS6-A-RMV-IPM-80 |

1) Corrosion resistance class 2 as per Festo standard 940 070

Components subject to moderate corrosion stress. Externally visible parts with primarily decorative surface requirements which are in direct contact with a normal industrial environment or media such as coolants or lubricating agents.

## Accessories, MS series

Mounting attachments MS4/MS6

### Sealing ring MS4/6-NNR

- For sealing a branching module  
MS-A-IPM when used as a power  
supply module

Material:

Nitrile rubber

RoHS-compliant

Temperature of medium:

-10 ... +60 °C

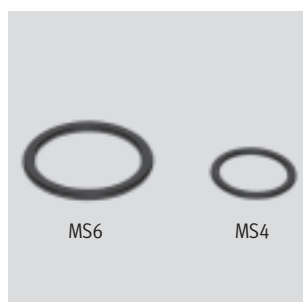

| Dimensions and ordering data |                   |          |         |
|------------------------------|-------------------|----------|---------|
| Size                         | CRC <sup>1)</sup> | Part No. | Type    |
| MS4                          | 2                 | 543492   | MS4-NNR |
| MS6                          | 2                 | 543493   | MS6-NNR |

1) Corrosion resistance class 2 as per Festo standard 940 070

Components subject to moderate corrosion stress. Externally visible parts with primarily decorative surface requirements which are in direct contact with a normal industrial environment or media such as coolants or lubricating agents.

## Accessories, MS series

Connecting plates MS4/MS6

**FESTO**

### Connecting plate MS4/6-AG...

(order code: AG...)

- Adapter for pneumatic connection
- MS6-AGE for implementing threaded connection G $\frac{3}{4}$

Material:  
Aluminium

Note on materials:  
RoHS-compliant (MS6-AG... only)  
Free of copper and PTFE

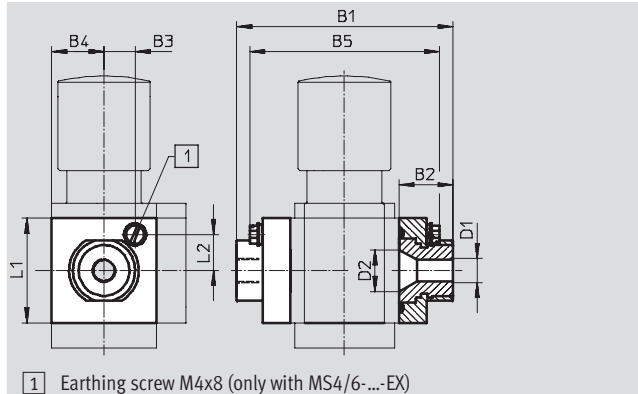

| Dimensions and ordering data                 |      |      |      |    |      |                               |      |    |      |                   |               |          |            |
|--|------|------|------|----|------|-------------------------------|------|----|------|-------------------|---------------|----------|------------|
| Size   | B1   | B2   | B3   | B4 | B5   | D1                            | D2   | L1 | L2   | CRC <sup>1)</sup> | Weight<br>[g] | Part No. | Type       |
| MS4  | 83.5 | 21.5 | –    | 21 | –    | G <sup>1</sup> / <sub>8</sub> | 16.8 | 42 | –    | 2                 | 128           | 526068   | MS4-AGA    |
|  |      |      |      |    |      | G <sup>1</sup> / <sub>4</sub> |      |    |      | 2                 | 128           | 526069   | MS4-AGB    |
|  |      |      |      |    |      | G <sup>3</sup> / <sub>8</sub> |      |    |      | 2                 | 128           | 526070   | MS4-AGC    |
| MS6  | 115  | 26.5 | –    | 31 | –    | G <sup>1</sup> / <sub>4</sub> | 24   | 62 | –    | 2                 | 300           | 526080   | MS6-AGB    |
|  |      |      |      |    |      | G <sup>3</sup> / <sub>8</sub> |      |    |      | 2                 | 300           | 526081   | MS6-AGC    |
|  |      |      |      |    |      | G <sup>1</sup> / <sub>2</sub> |      |    |      | 2                 | 300           | 526082   | MS6-AGD    |
|  |      |      |      |    |      | G <sup>3</sup> / <sub>4</sub> |      |    |      | 2                 | 300           | 526083   | MS6-AGE    |
|  |      |      |      |    |      |                               |      |    |      |                   |               |          |            |
| For use in explosive areas in zones 2 and 22 |      |      |      |    |      |                               |      |    |      |                   |               |          |            |
| MS4  | 83.5 | 21.5 | 12.5 | 21 | 72.5 | G <sup>1</sup> / <sub>8</sub> | 16.8 | 42 | 14.5 | 2                 | 128           | 541549   | MS4-AGA-EX |
|  |      |      |      |    |      | G <sup>1</sup> / <sub>4</sub> |      |    |      | 2                 | 128           | 541550   | MS4-AGB-EX |
|  |      |      |      |    |      | G <sup>3</sup> / <sub>8</sub> |      |    |      | 2                 | 128           | 541551   | MS4-AGC-EX |
| MS6  | 115  | 26.5 | 20.5 | 31 | 98.3 | G <sup>1</sup> / <sub>4</sub> | 24   | 62 | 15.5 | 2                 | 300           | 541538   | MS6-AGB-EX |
|  |      |      |      |    |      | G <sup>3</sup> / <sub>8</sub> |      |    |      | 2                 | 300           | 541539   | MS6-AGC-EX |
|  |      |      |      |    |      | G <sup>1</sup> / <sub>2</sub> |      |    |      | 2                 | 300           | 541540   | MS6-AGD-EX |
|  |      |      |      |    |      | G <sup>3</sup> / <sub>4</sub> |      |    |      | 2                 | 300           | 541541   | MS6-AGE-EX |

1) Corrosion resistance class 2 as per Festo standard 940 070

Components subject to moderate corrosion stress. Externally visible parts with primarily decorative surface requirements which are in direct contact with a normal industrial environment or media such as coolants or lubricating agents.

Note: This product conforms to ISO 1179-1 and to ISO 228-1

## Accessories, MS series

Connecting plates MS4/MS6

FESTO

### Cover plate MS4/6-END

- Can be used to cover the body sides of the first and last module if connecting plates are not used

Material:  
Reinforced polyamide  
Free of copper and PTFE

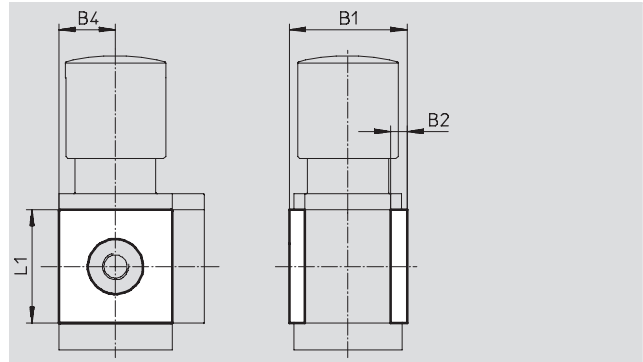

| Dimensions and ordering data |      |    |    |    |          |         |
|------------------------------|------|----|----|----|----------|---------|
| Size                         | B1   | B2 | B4 | L1 | Part No. | Type    |
| MS4                          | 43.6 | 6  | 21 | 42 | 538779   | MS4-END |
| MS6                          | 67   | 8  | 31 | 62 | 538780   | MS6-END |

### Mounting plate MS4/6-AEND

(order code: WBE; scope of delivery includes wall mounting plate MS6-WPB)

- In combination with mounting bracket MS-WP or MS-WPB for individual wall mounting via direct thread

Material:  
Reinforced polyamide  
RoHS-compliant  
Free of copper and PTFE

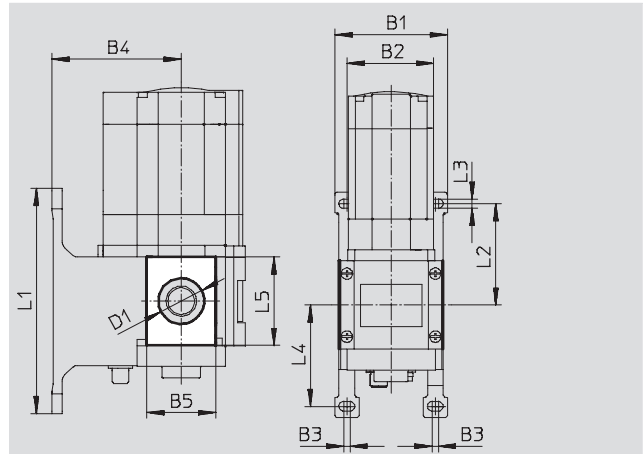

| Dimensions and ordering data |      |      |     |    |      |      |      |     |      |     |      |    |                   |               |          |          |
|------------------------------|------|------|-----|----|------|------|------|-----|------|-----|------|----|-------------------|---------------|----------|----------|
| Size                         | B1   | B2   | B3  | B4 |      | B5   | D1   | L1  | L2   | L3  | L4   | L5 | CRC <sup>1)</sup> | Weight<br>[g] | Part No. | Type     |
|                              |      |      |     | WP | WPB  |      |      |     |      |     |      |    |                   |               |          |          |
| MS4                          | 55.2 | 40.2 | 4   | 44 | 66   | 30.4 | 20.3 | 106 | 46.5 | 5.6 | 46.7 | 42 | 2                 | 4             | 542966   | MS4-AEND |
| MS6                          | 79   | 62   | 4.5 | 54 | 90.5 | 48.4 | 32   | 158 | 71   | 6.6 | 71   | 62 | 2                 | 17            | 535408   | MS6-AEND |

1) Corrosion resistance class 2 as per Festo standard 940 070  
Components subject to moderate corrosion stress. Externally visible parts with primarily decorative surface requirements which are in direct contact with a normal industrial environment or media such as coolants or lubricating agents.

## Accessories, MS series

Connecting plates MS9

**FESTO**

### Connecting plate MS9-AG...

(order code: AG...)

- Adapter for pneumatic connection

Material:

Connecting plate, hollow bolt:

Die-cast aluminium

Seals: Nitrile rubber

RoHS-compliant

Free of copper and PTFE

Temperature of medium:

-10 ... +60 °C

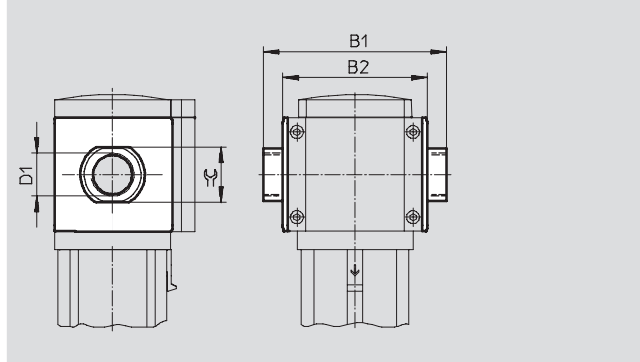

| Dimensions and ordering data |     |     |        |    |       |               |          |         |
|------------------------------|-----|-----|--------|----|-------|---------------|----------|---------|
| Size                         | B1  | B2  | D1     | ≅  | KBK1) | Weight<br>[g] | Part No. | Type    |
| MS9                          | 132 | 112 | G1/2   | 30 | 2     | 300           | 552954   | MS9-AGD |
|                              | 132 | 112 | G3/4   | 36 | 2     | 300           | 552955   | MS9-AGE |
|                              | 142 | 112 | G1     | 41 | 2     | 300           | 552956   | MS9-AGF |
|                              | 162 | 112 | G1 1/4 | 50 | 2     | 400           | 552957   | MS9-AGG |
|                              | 176 | 112 | G1 1/2 | 55 | 2     | 400           | 552958   | MS9-AGH |

1) Corrosion resistance class 2 as per Festo standard 940 070

Components subject to moderate corrosion stress. Externally visible parts with primarily decorative surface requirements which are in direct contact with a normal industrial environment or media such as coolants or lubricating agents.

Note: This product conforms to ISO 1179-1 and to ISO 228-1



# Accessories, MS series



Connecting plates MS12

Connecting plate MS12-AG...  
(order code: AG...)

- Adapter for pneumatic connection

Material:  
Die-cast aluminium  
Free of copper and PTFE

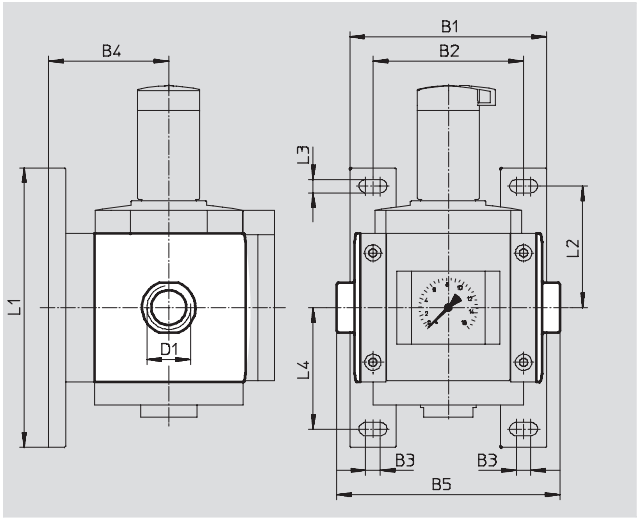

| Dimensions and ordering data |     |     |    |    |     |     |     |     |    |     |            |          |          |
|------------------------------|-----|-----|----|----|-----|-----|-----|-----|----|-----|------------|----------|----------|
| Size                         | B1  | B2  | B3 | B4 | B5  | D1  | L1  | L2  | L3 | L4  | Weight [g] | Part No. | Type     |
| MS12                         | 162 | 124 | 12 | 99 | 184 | G1  | 230 | 100 | 11 | 100 | 1,300      | 537135   | MS12-AGF |
|                              |     |     |    |    | 184 | G1¼ |     |     |    |     |            | 537136   | MS12-AGG |
|                              |     |     |    |    | 184 | G1½ |     |     |    |     |            | 537137   | MS12-AGH |
|                              |     |     |    |    | 196 | G2  |     |     |    |     |            | 537138   | MS12-AGI |

Note: This product conforms to ISO 1179-1 and to ISO 228-1

## Accessories, MS series

Security components MS4/MS6/MS9/MS12

**FESTO**

### Padlock LRVS-D

Material:

Housing: Brass

Ambient temperature:

-20 ... +60 °C



| Ordering data        |               |          |        |
|----------------------|---------------|----------|--------|
| Size                 | Weight<br>[g] | Part No. | Type   |
| MS4/MS6/<br>MS9/MS12 | 120           | 193786   | LRVS-D |

## Product Range and Company Overview

### A Complete Suite of Automation Services

Our experienced engineers provide complete support at every stage of your development process, including: conceptualization, analysis, engineering, design, assembly, documentation, validation, and production.



**Custom Automation Components**  
Complete custom engineered solutions



**Custom Control Cabinets**  
Comprehensive engineering support and on-site services



**Complete Systems**  
Shipment, stocking and storage services

### The Broadest Range of Automation Components

With a comprehensive line of more than 30,000 automation components, Festo is capable of solving the most complex automation requirements.



**Electromechanical**  
Electromechanical actuators, motors, controllers & drives



**Pneumatics**  
Pneumatic linear and rotary actuators, valves, and air supply



**PLCs and I/O Devices**  
PLC's, operator interfaces, sensors and I/O devices

### Supporting Advanced Automation... As No One Else Can!

Festo is a leading global manufacturer of pneumatic and electromechanical systems, components and controls for industrial automation, with more than 12,000 employees in 56 national headquarters serving more than 180 countries. For more than 80 years, Festo has continuously elevated the state of manufacturing with innovations and optimized motion control solutions that deliver higher performing, more profitable automated manufacturing and processing equipment. Our dedication to the advancement of automation extends beyond technology to the education and development of current and future automation and robotics designers with simulation tools, teaching programs, and on-site services.

### Quality Assurance, ISO 9001 and ISO 14001 Certifications

Festo Corporation is committed to supply all Festo products and services that will meet or exceed our customers' requirements in product quality, delivery, customer service and satisfaction.

To meet this commitment, we strive to ensure a consistent, integrated, and systematic approach to management that will meet or exceed the requirements of the ISO 9001 standard for Quality Management and the ISO 14001 standard for Environmental Management.



© Copyright 2008, Festo Corporation. While every effort is made to ensure that all dimensions and specifications are correct, Festo cannot guarantee that publications are completely free of any error, in particular typing or printing errors. Accordingly, Festo cannot be held responsible for the same. For Liability and Warranty conditions, refer to our "Terms and Conditions of Sale", available from your local Festo office. All rights reserved. No part of this publication may be reproduced, distributed, or transmitted in any form or by any means, electronic, mechanical, photocopying or otherwise, without the prior written permission of Festo. All technical data subject to change according to technical update.



Printed on recycled paper at New Horizon Graphic, Inc., FSC certified as an environmentally friendly printing plant.

# Festo North America

## Festo Regional Contact Center

5300 Explorer Drive  
Mississauga, Ontario L4W 5G4  
Canada

### USA Customers:

For ordering assistance,

**Call:** 1.800.99.FESTO (1.800.993.3786)

**Fax:** 1.800.96.FESTO (1.800.963.3786)

**Email:** [customer.service@us.festo.com](mailto:customer.service@us.festo.com)

For technical support,

**Call:** 1.866.GO.FESTO (1.866.463.3786)

**Fax:** 1.800.96.FESTO (1.800.963.3786)

**Email:** [product.support@us.festo.com](mailto:product.support@us.festo.com)

### Canadian Customers:

**Call:** 1.877.GO.FESTO (1.877.463.3786)

**Fax:** 1.877.FX.FESTO (1.877.393.3786)

**Email:** [festo.canada@ca.festo.com](mailto:festo.canada@ca.festo.com)

## USA Headquarters

Festo Corporation  
395 Moreland Road  
P.O. Box 18023  
Hauppauge, NY 11788, USA  
[www.festo.com/us](http://www.festo.com/us)

## USA Sales Offices

### Appleton

North 922 Tower View Drive, Suite N  
Greenville, WI 54942, USA

### Boston

120 Presidential Way, Suite 330  
Woburn, MA 01801, USA

### Chicago

1441 East Business Center Drive  
Mt. Prospect, IL 60056, USA

### Dallas

1825 Lakeway Drive, Suite 600  
Lewisville, TX 75057, USA

### Detroit – Automotive Engineering Center

2601 Cambridge Court, Suite 320  
Auburn Hills, MI 48326, USA

### New York

395 Moreland Road  
Hauppauge, NY 11788, USA

### Silicon Valley

4935 Southfront Road, Suite F  
Livermore, CA 94550, USA

## United States



**USA Headquarters, East:** Festo Corp., 395 Moreland Road, Hauppauge, NY 11788

Phone: 1.631.435.0800; Fax: 1.631.435.8026;

Email: [info@festo-usa.com](mailto:info@festo-usa.com)

[www.festo.com/us](http://www.festo.com/us)

## Canada



**Headquarters:** Festo Inc., 5300 Explorer Drive, Mississauga, Ontario L4W 5G4

Phone: 1.905.624.9000; Fax: 1.905.624.9001;

Email: [festo.canada@ca.festo.com](mailto:festo.canada@ca.festo.com)

[www.festo.ca](http://www.festo.ca)

## Mexico



**Headquarters:** Festo Pneumatic, S.A., Av. Ceylán 3, Col. Tequesquahuac,  
54020 Tlalneapantla, Edo. de México

Phone: 011 52 [55] 53 21 66 00; Fax: 011 52 [55] 53 21 66 65;

Email: [festo.mexico@mx.festo.com](mailto:festo.mexico@mx.festo.com)

[www.festo.com/mx](http://www.festo.com/mx)

## Central USA

Festo Corporation  
1441 East Business  
Center Drive  
Mt. Prospect, IL 60056, USA  
Phone: 1.847.759.2600  
Fax: 1.847.768.9480



## Western USA

Festo Corporation  
4935 Southfront Road,  
Suite F  
Livermore, CA 94550, USA  
Phone: 1.925.371.1099  
Fax: 1.925.245.1286



## Festo Worldwide

Argentina Australia Austria Belarus Belgium Brazil Bulgaria Canada Chile China Colombia Croatia Czech Republic Denmark  
Estonia Finland France Germany Great Britain Greece Hong Kong Hungary India Indonesia Iran Ireland Israel Italy Japan Latvia  
Lithuania Malaysia Mexico Netherlands New Zealand Norway Peru Philippines Poland Romania Russia Serbia Singapore  
Slovakia Slovenia South Africa South Korea Spain Sweden Switzerland Taiwan Thailand Turkey Ukraine United States Venezuela

[www.festo.com](http://www.festo.com)