

## Angle grippers HGWC

**FESTO**

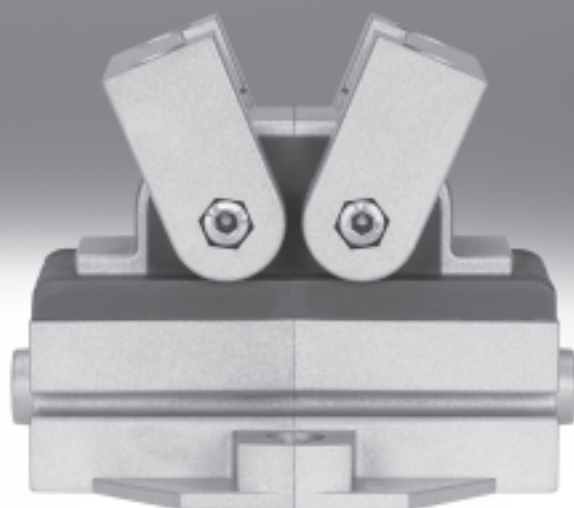

# Angle grippers HGWC

Key features

**FESTO**

## At a glance

### General information

The compact and cost-optimised angle gripper consists of a two-part mirror-symmetrical housing made of die-cast zinc. The force generated by the linear motion of the piston is translated into the gripper jaw movement via a pneumatic piston, which acts directly on the gripper jaws installed in the

housing by means of a moment compensator in accordance with the rack and pinion principle. To ensure a low-backlash plain-bearing guide for the gripper jaws, appropriate guide elements are fitted in the housing and pretensioned by means of socket head screws.

- Double-acting gripper
- Internal fixed flow control, does away with the need for external flow control in 90% of applications
- High force with minimal volume
- Suitable for external and internal gripping

- Opening angle of 30°, 80°
- Wide range of options for mounting on drives
- Repetition accuracy of 0.05 mm
- Slot for proximity sensor SME/SMT-10

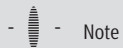

Note

Sizing software for gripper selection

➔ [www.festo.com](http://www.festo.com)

## Details

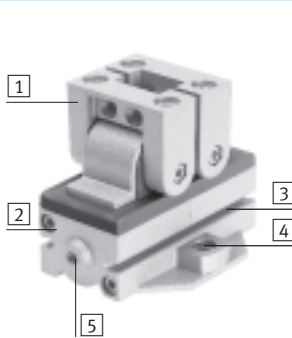

- 1 Gripper jaw
- 2 Housing based on half-shell principle
- 3 Slot for proximity sensor, for sensing the piston position
- 4 Mounting option
- 5 Supply port

## Mounting option from underneath

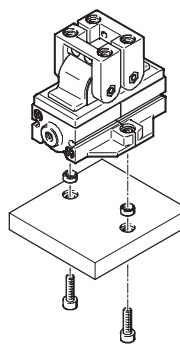

## from above

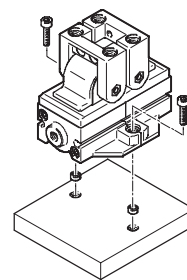

Note

Angle grippers are not designed for the following sample applications:

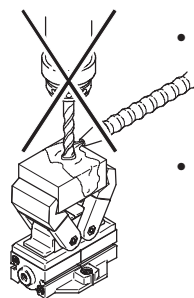

• Machining

• Aggressive media



• Grinding dust

• Welding spatter

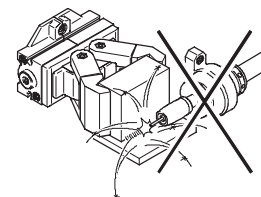

# Angle grippers HGWC

Peripherals overview and type codes

## Peripherals overview

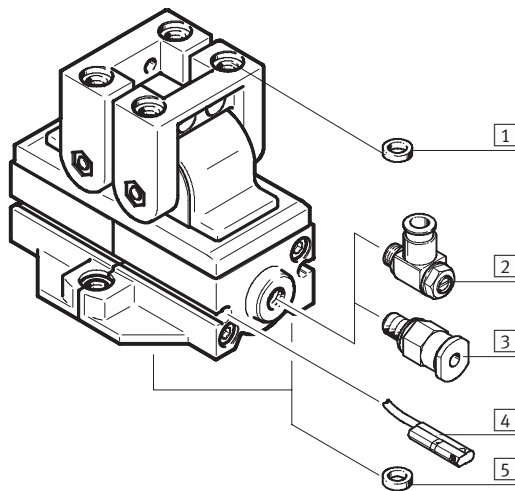

## System product for handling and assembly technology

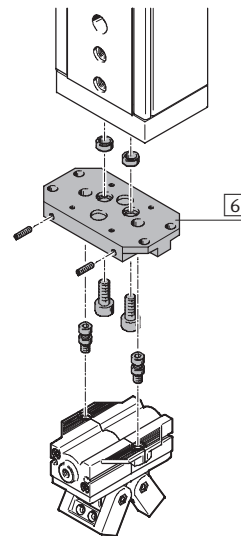

Accessories			
Type	Brief description		→ Page/Internet
1 Centring sleeve ZBH	<ul style="list-style-type: none"> <li>For centring when attaching gripper fingers</li> <li>4 included in the scope of delivery of the gripper</li> </ul>		10
2 One-way flow control valve GRLA	For regulating speed		gria
3 Push-in fitting QS	For connecting compressed air tubing with standard O.D.		quick star
4 Proximity sensor SME/SMT-10	For sensing the piston position		10
5 Centring sleeve ZBH	<ul style="list-style-type: none"> <li>For centring when attaching to a drive or plate</li> <li>2 included in the scope of delivery of the gripper</li> </ul>		10
6 –	Drive/gripper connections		adapter kit

## Type codes

		HGWC	–	12	–	40	–	A
<b>Type</b>								
HGWC	Angle gripper							
<b>Size</b>								
<b>Opening angle per gripper jaw</b>								
15	15°							
40	40°							
<b>Position sensing</b>								
A	Via proximity sensor							

## Angle grippers HGWC

Technical data

**FESTO**

Function  
Double-acting  
HGWC-...-A

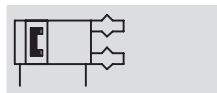

-  - Size  
12, 16, 20 mm
-  - Opening angle  
30° and 80°



General technical data			
Size	12	16	20
Design	Rack and pinion Force-guided motion sequence		
Mode of operation	Double-acting		
Gripper function	Angle		
Number of gripper jaws	2		
Max. opening angle [°]	30, 80		
Pneumatic connection	M5		
Repetition accuracy <sup>1)</sup> [mm]	≤ 0.05		
Max. interchangeability [mm]	≤ 0.2		
Max. gripper jaw backlash <sup>2)</sup> [mm]	≤ 0.1		
Max. gripper jaw angular backlash <sup>3)</sup> [°]	≤ 0.5		
Max. operating frequency [Hz]	≤ 4		
Rotational symmetry [mm]	≤ Ø 0.2		
Position sensing	Via proximity sensor		
Type of mounting	Via female thread and centring sleeve		
Mounting position	Any		
Product weight [g]	200	350	700

1) End-position drift under constant operating conditions with 100 consecutive strokes in the direction of movement of the gripper jaws

2) Perpendicular to the direction of motion of the gripper jaws

3) Pretensioned, backlash-free ball bearing guide

Operating and environmental conditions	
Operating pressure [bar]	2 ... 8
Operating medium	Filtered compressed air, lubricated or unlubricated
Ambient temperature <sup>1)</sup> [°C]	+5 ... +60
Corrosion resistance class CRC <sup>2)</sup>	2

1) Note operating range of proximity sensors

2) Corrosion resistance class 2 according to Festo standard 940 070

Components subject to moderate corrosion stress. Externally visible parts with primarily decorative surface requirements which are in direct contact with a normal industrial environment or media such as coolants or lubricating agents

# Angle grippers HGWC

Technical data

## Materials

Sectional view

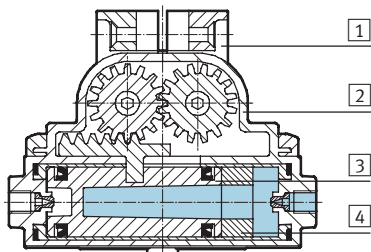

## Angle gripper

1	Gripper jaw	Die-cast zinc, painted
2	Housing	Die-cast zinc, painted
3	Piston	Polyamide
4	Distance sleeve	Polyurethane
–	Seals	Polyurethane, nitrile rubber
–	Note on materials	Free of copper, PTFE and silicone
		RoHS-compliant

## Total gripping torque at 6 bar

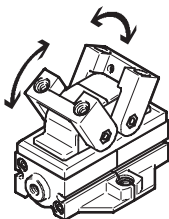

Size		12	16	20
Opening	[Ncm]	22	72	144
Closing	[Ncm]	22	72	144

## Static characteristic load values at the gripper jaws

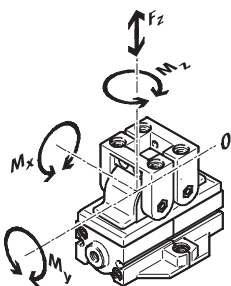

The indicated permissible forces and torques apply to a single gripper jaw. The indicated values include the lever arm, additional applied loads caused by the workpiece or external gripper

fingers, as well as forces which occur during movement.

The zero co-ordinate line (gripper jaw guide) must be taken into consideration for the calculation of torques.

Size		12	16	20
Max. permissible force $F_z$	[N]	40	60	80
Max. permissible torque $M_x$	[Nm]	2.5	4	8
Max. permissible torque $M_y$	[Nm]	0.6	1	1.9
Max. permissible torque $M_z$	[Nm]	2	3.2	6.7

## Angle grippers HGWC

Technical data

**FESTO**

### Mass moment of inertia

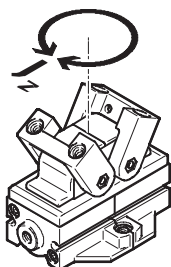

Mass moment of inertia [ $\text{kgm}^2 \times 10^{-4}$ ] of the angle gripper in relation to the central axis with no load.

Size	12	16	20
HGWC-...-A [ $\text{kgm}^2 \times 10^{-4}$ ]	0.52	1.35	4.31

### Opening and closing times [ms] at 6 bar

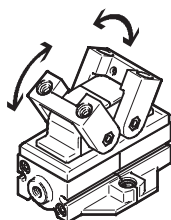

The indicated opening and closing times [ms] have been measured at room temperature and an operating pressure of 6 bar with vertically mounted gripper and without additional gripper fingers.

The grippers must be throttled for greater applied loads. Opening and closing times must then be adjusted accordingly.

Size		12-15	12-40	16-15	16-40	20-15	20-40
Without external gripper fingers							
HGWC-...-A	Opening	50	70	50	85	50	90
	Closing	35	50	35	70	35	75

# Angle grippers HGWC

Technical data

## Gripping force $F_{\text{Grip}}$ per gripper jaw as a function of operating pressure and lever arm $x$

Gripping forces as a function of the operating pressure and the lever arm can be determined for the size using the following graph.

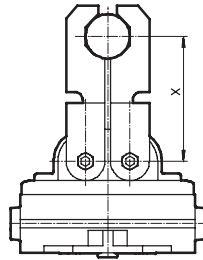

HGWC-12-A

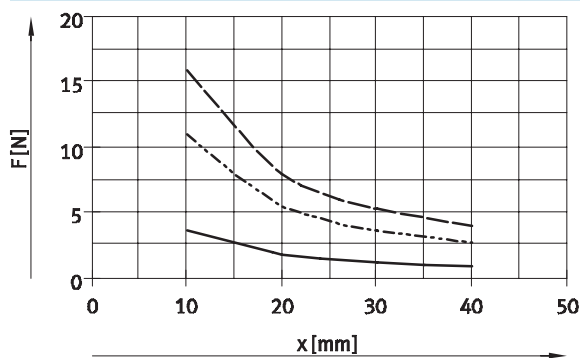

HGWC-16-A

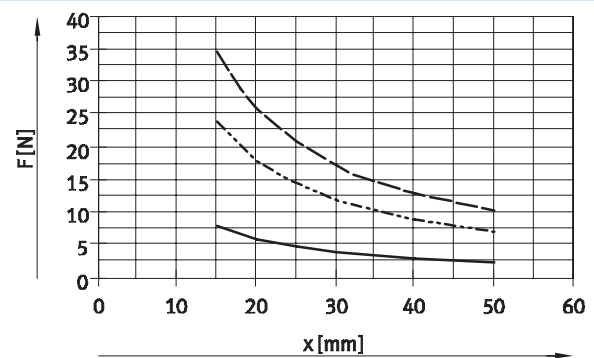

HGWC-20-A

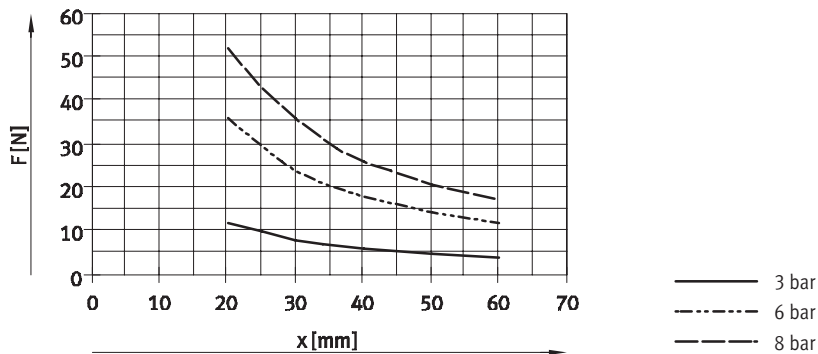

# Angle grippers HGWC

Technical data

**FESTO**

## Dimensions

Download CAD data → [www.festo.com](http://www.festo.com)

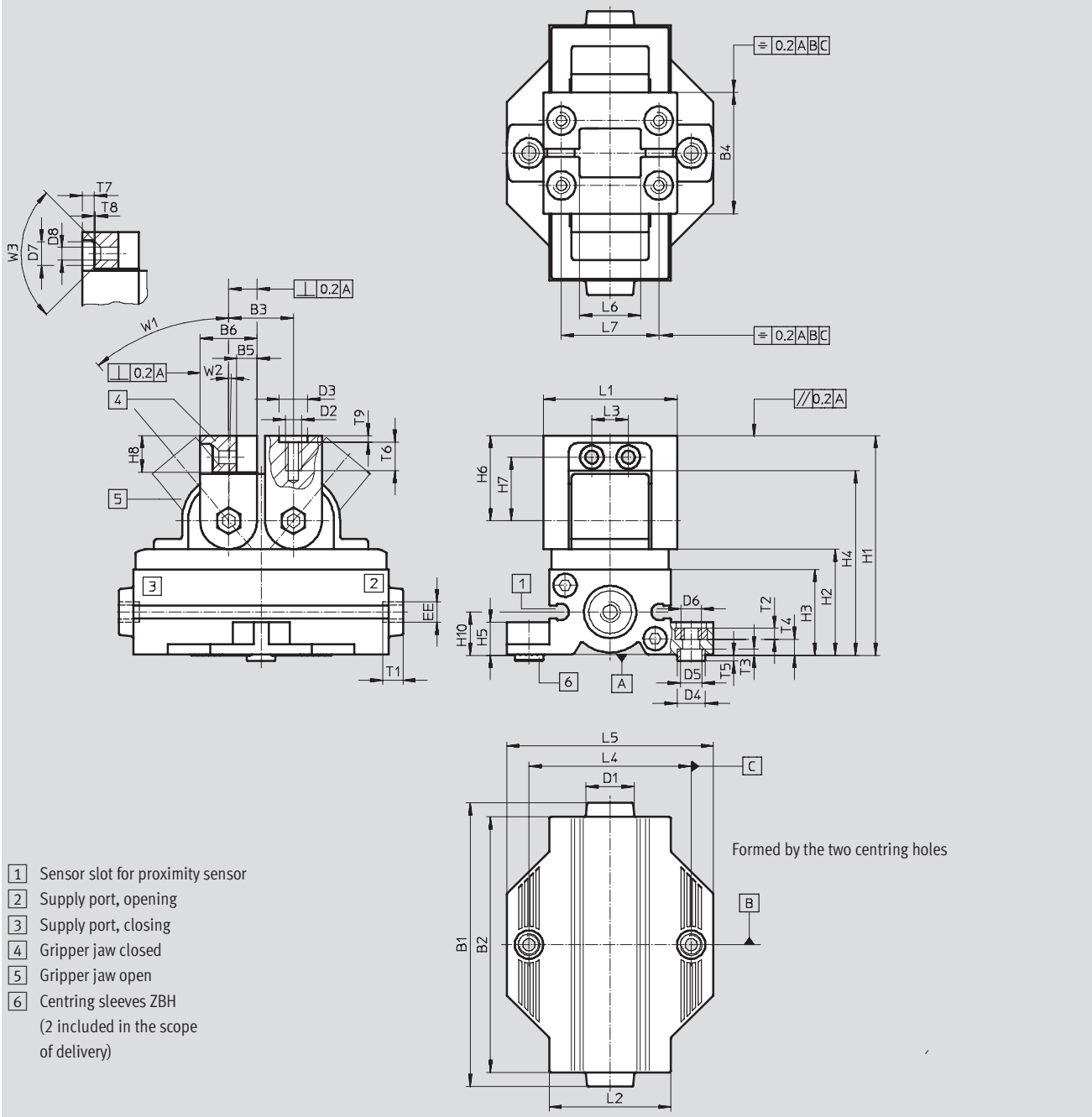

# Angle grippers HGWC

Technical data

Type	B1	B2	B3 ±0.05	B4 +0.25 -0.05	B5 +0.5	B6 +0.1	D1	D2	D3 +0.05 -0.02	D4 F10/h7	D5
HGWC-12	57	52	12	23	4	11	12	M3	5	7	5.3
HGWC-16	70	63	16	30	5.5	14	12	M4	7	7	5.3
HGWC-20	86	79	20	38	6	18	12	M5	9	9	6.4

Type	D6	D7	D8	EE	H1 ±0.5	H2	H3	H4	H5	H6 ±0.2	H7
HGWC-12	M4	4.8	2.6	M5	43.2	20.7	18.2	35.2	6.9	17	12.5
HGWC-16	M5	5.8	3.2	M5	54.2	26.2	21.2	44.7	8.2	21	15.7
HGWC-20	M6	8.1	4.4	M5	68.2	32.7	27	55.7	10.2	26.5	19.5

Type	H8	H10	L1 ±0.2	L2	L3 ±0.1	L4 <sup>1)</sup>	L5	L6 +0.25 -0.05	L7 <sup>1)</sup>	T1 min.
HGWC-12	7.5	9.2	27.5	25.5	6	33	42	12	20	4.5
HGWC-16	9	10.7	33	30	9	40	51	15	24	5
HGWC-20	12	13.7	45	38	12	50	65	21	33	5

Type	T2	T3 ±0.1	T4 +0.4 -0.3	T5 +0.1 -0.3	T6 min.	T7 +0.2	T8	T9 +0.1	W1 ±2	W2 ±3	W3
HGWC-12-15	2.2	1.7	3.1	1.3	6	1.7	0.5	1.3	15°	1°	90°
HGWC-12-40									40°		
HGWC-16-15	2.7	1.8	3.8	1.2	7	3	0.3	1.6	15°	1°	90°
HGWC-16-40									40°		
HGWC-20-15	3.2	2.3	5.2	1.7	9	3.5	0.5	2.1	15°	1°	90°
HGWC-20-40									40°		

1) Tolerance for centring hole ±0.03  
Tolerance for thread ±0.2

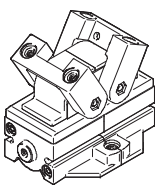
Ordering data			
	Size	Opening angle [°]	Double-acting Part No.    Type
	12	30	565135 HGWC-12-15-A
		80	565141 HGWC-12-40-A
	16	30	565137 HGWC-16-15-A
		80	565143 HGWC-16-40-A
	20	30	565139 HGWC-20-15-A
		80	565145 HGWC-20-40-A

## Angle grippers HGWC

Accessories

**FESTO**



Ordering data – Centring sleeves			Technical data → Internet: zbh	
	For size [mm]	Part No.	Type	PU <sup>1)</sup>
	For attaching to a drive or plate			
	12, 16	186717	ZBH-7	10
	20	150927	ZBH-9	10
	For attaching gripper fingers			
	12	189652	ZBH-5	10
	16	186717	ZBH-7	10
	20	150927	ZBH-9	10

1) Packaging unit quantity

Ordering data – Proximity sensors for C-slot, in-line connecting cable						
	Assembly	Electrical connection		Cable length [m]	Part No.	Type
		Cable	Plug M8			
	N/O contact, magneto-resistive					Technical data ➔ Internet: <a href="#">smt</a>
	Insertable from end	3-wire	–	2.5	173218	SMT-10-PS-KL-LED-24
		–	3-pin	0.3	173220	SMT-10-PS-SL-LED-24
	N/O contact, magnetic reed					Technical data ➔ Internet: <a href="#">sme</a>
	Insertable from end	3-wire	–	2.5	173210	SME-10-KL-LED-24
		–	3-pin	0.3	173212	SME-10-SL-LED-24

Ordering data – Proximity sensors for C-slot, lateral connecting cable						
	Assembly	Electrical connection		Cable length [m]	Part No.	Type
		Cable	Plug M8			
	N/O contact, magneto-resistive				Technical data ➔ Internet: <a href="#">smt</a>	
	Insertable from end	3-wire	–	2.5	173219	SMT-10-PS-KQ-LED-24
		–	3-pin	0.3	173221	SMT-10-PS-SQ-LED-24
	N/O contact, magnetic reed				Technical data ➔ Internet: <a href="#">sme</a>	
	Insertable from end	3-wire	–	2.5	173211	SME-10-KQ-LED-24
		–	3-pin	0.3	173213	SME-10-SQ-LED-24

Ordering data – Proximity sensors for C-slot, short design						
	Assembly	Electrical connection		Cable length [m]	Part No.	Type
		Cable	Plug M8			
	N/O contact, magneto-resistive					Technical data ➔ Internet: smt
	Insertable from end	3-wire	–	2.5	547862	SMT-10G-PS-24V-E-2,5Q-OE
		–	3-pin	0.3	547863	SMT-10G-PS-24V-E-0,3Q-M8D

Ordering data – Connecting cables					Technical data → Internet: nebu
	Electrical connection, left	Electrical connection, right	Cable length [m]	Part No.	Type
	Straight socket, M8x1, 3-pin	Cable, open end, 3-wire	2.5	541333	NEBU-M8G3-K-2.5-LE3
			5	541334	NEBU-M8G3-K-5-LE3
	Angled socket, M8x1, 3-pin	Cable, open end, 3-wire	2.5	541338	NEBU-M8W3-K-2.5-LE3
			5	541341	NEBU-M8W3-K-5-LE3

## Product Range and Company Overview

### A Complete Suite of Automation Services

Our experienced engineers provide complete support at every stage of your development process, including: conceptualization, analysis, engineering, design, assembly, documentation, validation, and production.



**Custom Automation Components**  
Complete custom engineered solutions



**Custom Control Cabinets**  
Comprehensive engineering support and on-site services

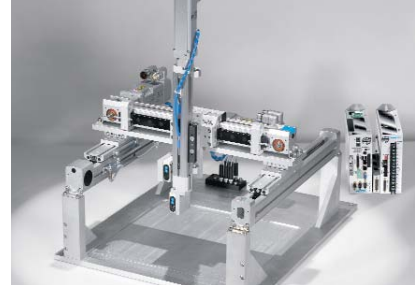

**Complete Systems**  
Shipment, stocking and storage services

### The Broadest Range of Automation Components

With a comprehensive line of more than 30,000 automation components, Festo is capable of solving the most complex automation requirements.



**Electromechanical**  
Electromechanical actuators, motors, controllers & drives



**Pneumatics**  
Pneumatic linear and rotary actuators, valves, and air supply



**PLCs and I/O Devices**  
PLC's, operator interfaces, sensors and I/O devices

### Supporting Advanced Automation... As No One Else Can!

Festo is a leading global manufacturer of pneumatic and electromechanical systems, components and controls for industrial automation, with more than 12,000 employees in 56 national headquarters serving more than 180 countries. For more than 80 years, Festo has continuously elevated the state of manufacturing with innovations and optimized motion control solutions that deliver higher performing, more profitable automated manufacturing and processing equipment. Our dedication to the advancement of automation extends beyond technology to the education and development of current and future automation and robotics designers with simulation tools, teaching programs, and on-site services.

### Quality Assurance, ISO 9001 and ISO 14001 Certifications

Festo Corporation is committed to supply all Festo products and services that will meet or exceed our customers' requirements in product quality, delivery, customer service and satisfaction.

To meet this commitment, we strive to ensure a consistent, integrated, and systematic approach to management that will meet or exceed the requirements of the ISO 9001 standard for Quality Management and the ISO 14001 standard for Environmental Management.



© Copyright 2008, Festo Corporation. While every effort is made to ensure that all dimensions and specifications are correct, Festo cannot guarantee that publications are completely free of any error, in particular typing or printing errors. Accordingly, Festo cannot be held responsible for the same. For Liability and Warranty conditions, refer to our "Terms and Conditions of Sale", available from your local Festo office. All rights reserved. No part of this publication may be reproduced, distributed, or transmitted in any form or by any means, electronic, mechanical, photocopying or otherwise, without the prior written permission of Festo. All technical data subject to change according to technical update.



Printed on recycled paper at New Horizon Graphic, Inc., FSC certified as an environmentally friendly printing plant.

# Festo North America

## Festo Regional Contact Center

5300 Explorer Drive  
Mississauga, Ontario L4W 5G4  
Canada

### USA Customers:

For ordering assistance,

**Call:** 1.800.99.FESTO (1.800.993.3786)

**Fax:** 1.800.96.FESTO (1.800.963.3786)

**Email:** [customer.service@us.festo.com](mailto:customer.service@us.festo.com)

For technical support,

**Call:** 1.866.GO.FESTO (1.866.463.3786)

**Fax:** 1.800.96.FESTO (1.800.963.3786)

**Email:** [product.support@us.festo.com](mailto:product.support@us.festo.com)

### Canadian Customers:

**Call:** 1.877.GO.FESTO (1.877.463.3786)

**Fax:** 1.877.FX.FESTO (1.877.393.3786)

**Email:** [festo.canada@ca.festo.com](mailto:festo.canada@ca.festo.com)

## USA Headquarters

Festo Corporation  
395 Moreland Road  
P.O. Box 18023  
Hauppauge, NY 11788, USA  
[www.festo.com/us](http://www.festo.com/us)

## USA Sales Offices

### Appleton

North 922 Tower View Drive, Suite N  
Greenville, WI 54942, USA

### Boston

120 Presidential Way, Suite 330  
Woburn, MA 01801, USA

### Chicago

1441 East Business Center Drive  
Mt. Prospect, IL 60056, USA

### Dallas

1825 Lakeway Drive, Suite 600  
Lewisville, TX 75057, USA

### Detroit – Automotive Engineering Center

2601 Cambridge Court, Suite 320  
Auburn Hills, MI 48326, USA

### New York

395 Moreland Road  
Hauppauge, NY 11788, USA

### Silicon Valley

4935 Southfront Road, Suite F  
Livermore, CA 94550, USA

## United States



**USA Headquarters, East:** Festo Corp., 395 Moreland Road, Hauppauge, NY 11788

Phone: 1.631.435.0800; Fax: 1.631.435.8026;

Email: [info@festo-usa.com](mailto:info@festo-usa.com)

[www.festo.com/us](http://www.festo.com/us)

## Canada



**Headquarters:** Festo Inc., 5300 Explorer Drive, Mississauga, Ontario L4W 5G4

Phone: 1.905.624.9000; Fax: 1.905.624.9001;

Email: [festo.canada@ca.festo.com](mailto:festo.canada@ca.festo.com)

[www.festo.ca](http://www.festo.ca)

## Mexico



**Headquarters:** Festo Pneumatic, S.A., Av. Ceylán 3, Col. Tequesquahuac,  
54020 Tlalneapantla, Edo. de México

Phone: 011 52 [55] 53 21 66 00; Fax: 011 52 [55] 53 21 66 65;

Email: [festo.mexico@mx.festo.com](mailto:festo.mexico@mx.festo.com)

[www.festo.com/mx](http://www.festo.com/mx)

## Central USA

Festo Corporation  
1441 East Business  
Center Drive  
Mt. Prospect, IL 60056, USA  
Phone: 1.847.759.2600  
Fax: 1.847.768.9480



## Western USA

Festo Corporation  
4935 Southfront Road,  
Suite F  
Livermore, CA 94550, USA  
Phone: 1.925.371.1099  
Fax: 1.925.245.1286



## Festo Worldwide

Argentina Australia Austria Belarus Belgium Brazil Bulgaria Canada Chile China Colombia Croatia Czech Republic Denmark  
Estonia Finland France Germany Great Britain Greece Hong Kong Hungary India Indonesia Iran Ireland Israel Italy Japan Latvia  
Lithuania Malaysia Mexico Netherlands New Zealand Norway Peru Philippines Poland Romania Russia Serbia Singapore  
Slovakia Slovenia South Africa South Korea Spain Sweden Switzerland Taiwan Thailand Turkey Ukraine United States Venezuela

[www.festo.com](http://www.festo.com)