

# Suction cup holders ESH

Technical data

FESTO

- With or without height compensation
- 6 holder sizes
- 8 holder types
- 3 tubing connectors

 Temperature range  
 -10 ... +60





| General technical data                        |             |                               |                           |                 |                        |                             |            |
|---|-------------|-------------------------------|---------------------------|-----------------|------------------------|-----------------------------|------------|
| ESH-HA-... without height compensation        |             |                               |                           |                 |                        |                             |            |
|   | Holder size | Vacuum connection             | Volume [cm <sup>3</sup> ] | Mounting thread | Suction cup connection | Max. tightening torque [Nm] | Weight [g] |
| Male thread, 2 nuts, vacuum connection on top |             |                               |                           |                 |                        |                             |            |
| QS  | 1           | QS4                           | 0.239                     | M6x0.75         | ∅ 3 mm                 | 3                           | 6          |
|   |             | PK-3                          | 0.090                     | M5x0.5          |                        | 2                           | 3          |
|   | 2           | QS4                           | 0.501                     | M10x1           | ∅ 4 mm                 | 7                           | 12         |
|   |             | PK-4                          | 0.169                     | M8x0.75         |                        | 3.5                         | 7          |
| PK  | 3           | QS6                           | 0.520                     | M12x1           | M4x0.7                 | 14                          | 20         |
|   |             | PK-4                          | 0.274                     | M8x0.75         |                        | 3.5                         | 10         |
|   | 4           | QS6                           | 0.719                     | M14x1           | M6x1                   | 21                          | 30         |
|   |             | PK-4                          | 0.668                     | M12x1           |                        | 14                          | 23         |
| G   | 5           | G <sup>1</sup> / <sub>8</sub> | 1.862                     | M20x1           | M10x1.5                | 21                          | 84         |
|   |             | G <sup>1</sup> / <sub>4</sub> | 7.234                     | M24x2           |                        | 50                          | 200        |



| General technical data                   |             |                               |                           |                               |                        |            |
|--|-------------|-------------------------------|---------------------------|-------------------------------|------------------------|------------|
| ESH-HB-... without height compensation   |             |                               |                           |                               |                        |            |
|  | Holder size | Vacuum connection             | Volume [cm <sup>3</sup> ] | Mounting thread Female thread | Suction cup connection | Weight [g] |
| Female thread, vacuum connection on side |             |                               |                           |                               |                        |            |
| QS                                       | 1           | QS4                           | 0.228                     | M3x0.5                        | ∅ 3 mm                 | 5          |
|  |             | PK-3                          | 0.108                     |                               |                        | 4          |
|  | 2           | QS6                           | 0.418                     | M4x0.75                       | ∅ 4 mm                 | 13         |
|  |             | PK-4                          | 0.188                     |                               |                        | 11         |
| PK                                       | 3           | QS6                           | 0.539                     | M6x1                          | M4x0.7                 | 29         |
|  |             | PK-4                          | 0.313                     |                               |                        | 27         |
|  | 4           | QS6                           | 0.646                     | M6x1                          | M6x1                   | 27         |
|  |             | PK-4                          | 0.416                     |                               |                        | 25         |
| G  | 5           | G <sup>1</sup> / <sub>8</sub> | 1.921                     | M8x1.25                       | M10x1.5                | 91         |
|  |             | G <sup>1</sup> / <sub>4</sub> | 7.250                     |                               |                        | M16x2      |

# Suction cup holders ESH

Technical data

FESTO



| General technical data  |             |                               |                              |                 |                        |                             |              |             |                                |               |
|---|-------------|-------------------------------|------------------------------|-----------------|------------------------|-----------------------------|--------------|-------------|--------------------------------|---------------|
| ESH-HC-... with height compensation   |             |                               |                              |                 |                        |                             |              |             |                                |               |
|   | Holder size | Vacuum connection             | Volume<br>[cm <sup>3</sup> ] | Mounting thread | Suction cup connection | Height compensation<br>[mm] | Spring force |             | Max. tightening torque<br>[Nm] | Weight<br>[g] |
|   |             |                               |                              |                 |                        |                             | min.<br>[N]  | max.<br>[N] |                                |               |
| Male thread, 2 nuts, vacuum connection on top   |             |                               |                              |                 |                        |                             |              |             |                                |               |
| QS<br> | 1           | QS4                           | 0.385                        | M12x1           | ∅ 3 mm                 | 3                           | 0            | 0.1         | 14                             | 17            |
|   |             | PK-3                          | 0.117                        | M8x0.75         |                        |                             |              |             | 3.5                            | 8             |
|   | 2           | QS6                           | 0.551                        | M12x1           | ∅ 4 mm                 | 3                           | 0            | 0.1         | 14                             | 18            |
|   |             | PK-4                          | 0.192                        | M8x0.75         |                        |                             |              |             | 3.5                            | 8             |
| PK<br> | 3           | QS6                           | 1.041                        | M14x1           | M4x0.7                 | 6                           | 2            | 5           | 21                             | 34            |
|   |             | PK-4                          | 0.789                        |                 |                        |                             |              |             |                                | 32            |
|   | 4           | QS6                           | 1.153                        | M14x1           | M6x1                   | 6                           | 5            | 10          | 21                             | 33            |
|   |             | PK-4                          | 0.911                        |                 |                        |                             |              |             |                                | 31            |
| G<br>  | 5           | G <sup>1</sup> / <sub>8</sub> | 3.327                        | M22x1           | M10x1.5                | 10                          | 8            | 18          | 50                             | 112           |
|   | 6           | G <sup>3</sup> / <sub>4</sub> | 11.537                       | M30x2           | M20x2                  | 20                          | 12           | 22          |                                | 472           |



| General technical data  |             |                               |                              |                 |                        |                             |              |             |                                |               |
|---|-------------|-------------------------------|------------------------------|-----------------|------------------------|-----------------------------|--------------|-------------|--------------------------------|---------------|
| ESH-HCL-... with height compensation, long  |             |                               |                              |                 |                        |                             |              |             |                                |               |
|   | Holder size | Vacuum connection             | Volume<br>[cm <sup>3</sup> ] | Mounting thread | Suction cup connection | Height compensation<br>[mm] | Spring force |             | Max. tightening torque<br>[Nm] | Weight<br>[g] |
|   |             |                               |                              |                 |                        |                             | min.<br>[N]  | max.<br>[N] |                                |               |
| Male thread, 2 nuts, vacuum connection on top   |             |                               |                              |                 |                        |                             |              |             |                                |               |
| QS<br> | 1           | QS4                           | 0.489                        | M12x1           | ∅ 3 mm                 | 10                          | 0            | 0.1         | 14                             | 20            |
|   |             | PK-3                          | 0.360                        |                 |                        |                             |              |             |                                |               |
|   | 2           | QS6                           | 0.519                        | M12x1           | ∅ 4 mm                 | 10                          | 0            | 0.1         | 14                             | 20            |
|   |             | PK-4                          | 0.398                        |                 |                        |                             |              |             |                                |               |
| PK<br> | 3           | QS6                           | 1.616                        | M14x1           | M4x0.7                 | 20                          | 1            | 3           | 21                             | 48            |
|   |             | PK-4                          | 1.383                        |                 |                        |                             |              |             |                                |               |
|   | 4           | QS6                           | 1.780                        | M14x1           | M6x1                   | 20                          | 1            | 9           | 21                             | 47            |
|   |             | PK-4                          | 1.535                        |                 |                        |                             |              |             |                                |               |
| G<br>  | 5           | G <sup>1</sup> / <sub>8</sub> | 6.060                        | M22x1           | M10x1.5                | 30                          | 10           | 16          | 50                             | 169           |
|   | 6           | G <sup>3</sup> / <sub>4</sub> | 16.325                       | M30x2           | M20x2                  | 40                          | 15           | 32          |                                | 560           |

# Suction cup holders ESH

Technical data

FESTO

| General technical data  |             |                               |                              |                 |                        |                             |              |             |                                |               |
|---|-------------|-------------------------------|------------------------------|-----------------|------------------------|-----------------------------|--------------|-------------|--------------------------------|---------------|
| ESH-HD-... with height compensation   |             |                               |                              |                 |                        |                             |              |             |                                |               |
|   | Holder size | Vacuum connection             | Volume<br>[cm <sup>3</sup> ] | Mounting thread | Suction cup connection | Height compensation<br>[mm] | Spring force |             | Max. tightening torque<br>[Nm] | Weight<br>[g] |
|   |             |                               |                              |                 |                        |                             | min.<br>[N]  | max.<br>[N] |                                |               |
| Male thread, 2 nuts, vacuum connection on side  |             |                               |                              |                 |                        |                             |              |             |                                |               |
| QS<br> | 1           | QS4                           | 0.241                        | M8x0.75         | ∅ 3 mm                 | 3                           | 0            | 0.1         | 3.5                            | 13            |
|   |             | PK-3                          | 0.120                        |                 |                        |                             |              |             |                                | 11            |
|   | 2           | QS6                           | 0.417                        | M8x0.75         | ∅ 4 mm                 | 3                           | 0            | 0.1         | 3.5                            | 15            |
|   |             | PK-4                          | 0.183                        |                 |                        |                             |              |             |                                | 12            |
| PK<br> | 3           | QS6                           | 0.573                        | M14x1           | M4x0.7                 | 6                           | 2            | 5           | 21                             | 46            |
|   |             | PK-4                          | 0.343                        |                 |                        |                             |              |             |                                | 44            |
|   | 4           | QS6                           | 0.678                        | M14x1           | M6x1                   | 6                           | 5            | 10          | 21                             | 45            |
|   |             | PK-4                          | 0.449                        |                 |                        |                             |              |             |                                | 43            |
| G<br>  | 5           | G <sup>1</sup> / <sub>8</sub> | 2.072                        | M22x1           | M10x1.5                | 10                          | 8            | 18          | 50                             | 195           |
|   |             | G <sup>1</sup> / <sub>4</sub> | 13.171                       |                 |                        |                             |              |             |                                | M30x2         |

| General technical data  |             |                               |                              |                 |                        |                             |              |             |                                |               |
|---|-------------|-------------------------------|------------------------------|-----------------|------------------------|-----------------------------|--------------|-------------|--------------------------------|---------------|
| ESH-HDL-... with height compensation, long  |             |                               |                              |                 |                        |                             |              |             |                                |               |
|   | Holder size | Vacuum connection             | Volume<br>[cm <sup>3</sup> ] | Mounting thread | Suction cup connection | Height compensation<br>[mm] | Spring force |             | Max. tightening torque<br>[Nm] | Weight<br>[g] |
|   |             |                               |                              |                 |                        |                             | min.<br>[N]  | max.<br>[N] |                                |               |
| Male thread, 2 nuts, vacuum connection on side  |             |                               |                              |                 |                        |                             |              |             |                                |               |
| QS<br> | 1           | QS4                           | 0.272                        | M12x1           | ∅ 3 mm                 | 10                          | 0            | 0.1         | 14                             | 29            |
|   |             | PK-3                          | 0.150                        |                 |                        |                             |              |             |                                | 28            |
|   | 2           | QS6                           | 0.260                        | M12x1           | ∅ 4 mm                 | 10                          | 0            | 0.1         | 14                             | 33            |
|   |             | PK-4                          | 0.138                        |                 |                        |                             |              |             |                                | 32            |
| PK<br> | 3           | QS6                           | 0.474                        | M14x1           | M4x0.7                 | 20                          | 1            | 3           | 21                             | 65            |
|   |             | PK-4                          | 0.252                        |                 |                        |                             |              |             |                                | 63            |
|   | 4           | QS6                           | 0.370                        | M14x1           | M6x1                   | 20                          | 1            | 9           | 21                             | 65            |
|   |             | PK-4                          | 0.448                        |                 |                        |                             |              |             |                                | 63            |
| G<br>  | 5           | G <sup>1</sup> / <sub>8</sub> | 1.667                        | M22x1           | M10x1.5                | 30                          | 10           | 16          | 50                             | 273           |
|   |             | G <sup>1</sup> / <sub>4</sub> | 16.968                       |                 |                        |                             |              |             |                                | M30x2         |

# Suction cup holders ESH

Technical data

FESTO

| General technical data  |             |                                  |                        |                                |               |
|---|-------------|----------------------------------|------------------------|--------------------------------|---------------|
| ESH-HE-... without height compensation  |             |                                  |                        |                                |               |
|   | Holder size | Vacuum connection<br>Male thread | Suction cup connection | Max. tightening torque<br>[Nm] | Weight<br>[g] |
| With threaded connection for direct attachment                                    |             |                                  |                        |                                |               |
|  | 1           | M3x0.5                           | ∅ 3 mm                 | 0.7                            | 1             |
|   | 2           | M5x0.8                           | ∅ 4 mm                 | 1.9                            | 3             |
|   | 3           | G <sup>1</sup> / <sub>8</sub>    | M4x0.7                 | 9                              | 11            |
|   | 4           | G <sup>1</sup> / <sub>8</sub>    | M6x1                   | 9                              | 11            |
|   | 5           | G <sup>1</sup> / <sub>4</sub>    | M10x1.5                | 14                             | 24            |

| General technical data   |             |                                  |                        |                            |              |             |                                |               |
|--|-------------|----------------------------------|------------------------|----------------------------|--------------|-------------|--------------------------------|---------------|
| ESH-HF-... with height compensation  |             |                                  |                        |                            |              |             |                                |               |
|  | Holder size | Vacuum connection<br>Male thread | Suction cup connection | Height compensator<br>[mm] | Spring force |             | Max. tightening torque<br>[Nm] | Weight<br>[g] |
|  |             |                                  |                        |                            | min.<br>[N]  | max.<br>[N] |                                |               |
| With threaded connection for direct attachment                                     |             |                                  |                        |                            |              |             |                                |               |
|  | 1           | M10x1                            | ∅ 3 mm                 | 2.6                        | 2            | 4           | 7                              | 14            |
|  | 2           | M10x1                            | ∅ 4 mm                 | 2.6                        | 2            | 4           | 7                              | 14            |
|  | 3           | M14x1                            | M4x0.7                 | 6                          | 6            | 12          | 21                             | 54            |
|  | 4           | M14x1                            | M6x1                   | 6                          | 6            | 12          | 21                             | 52            |

# Suction cup holders ESH

Technical data

| Materials         |                                    |        |        |        |         |        |         |        |        |
|-------------------|------------------------------------|--------|--------|--------|---------|--------|---------|--------|--------|
|                   | ESH-...-                           | HA-... | HB-... | HC-... | HCL-... | HD-... | HDL-... | HE-... | HF-... |
| Threaded plug     | Steel                              |        |        |        |         |        |         |        |        |
| QS connection     | Steel, polyacetate, nitrile rubber |        |        |        |         |        |         | -      |        |
| Note on materials | RoHS-compliant                     |        |        |        |         |        |         |        |        |

| Ambient conditions         |                   |             |
|----------------------------|-------------------|-------------|
|                            | ESH-...-...       |             |
| Ambient temperature        | [°C]              | -10 ... +60 |
| Corrosion resistance class | CRC <sup>1)</sup> | 1           |

1) Corrosion resistance class 1 according to Festo standard 940 070  
 Components requiring low corrosion resistance. Transport and storage protection. Parts that do not have primarily decorative surface requirements, e.g. in internal areas that are not visible or behind covers.

# Suction cup holders ESH

Technical data

FESTO

## Dimensions – ESH-HA

Push-in connector QS

Holder size 1

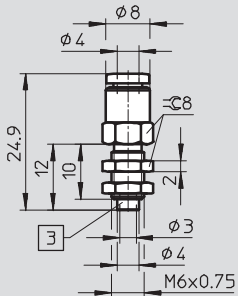

Holder size 2

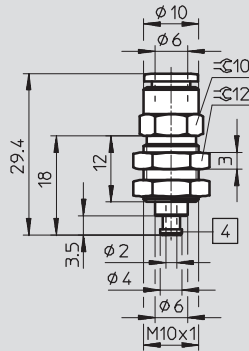

Holder size 3

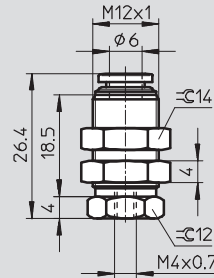

Holder size 4

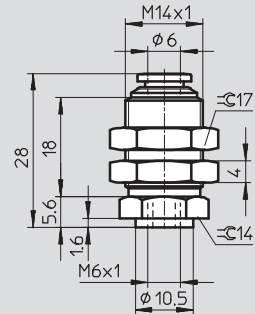

## Barbed fitting connector PK

Holder size 1

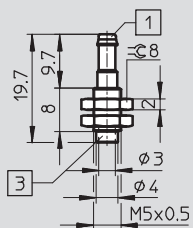

Holder size 2

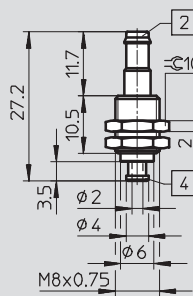

Holder size 3

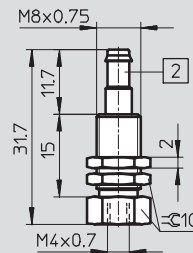

Holder size 4

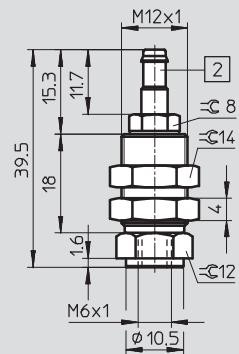

## Threaded connection G

Holder size 5/Holder size 6\*

M20x1 (M24x2)

G1/8 (G1/4)

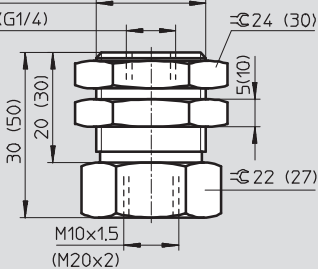

1 Barbed fitting for 3 mm plastic tubing

2 Barbed fitting for 4 mm plastic tubing

3 Hole for vacuum generator

4 Barbed fitting for vacuum generator

\* Dimensions in brackets

# Suction cup holders ESH

Technical data

FESTO

## Dimensions – ESH-HB

Push-in connector QS

Holder size 1

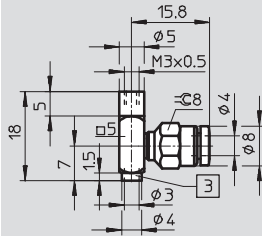

Holder size 2

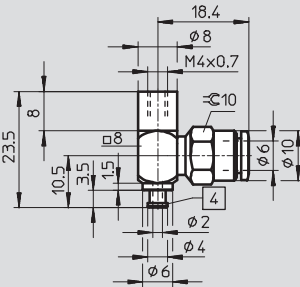

Holder size 3

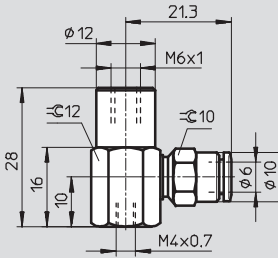

Holder size 4

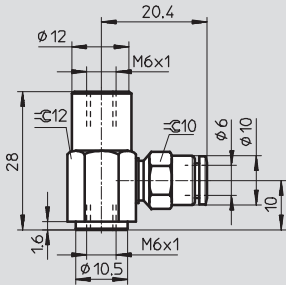

Barbed fitting connector PK

Holder size 1

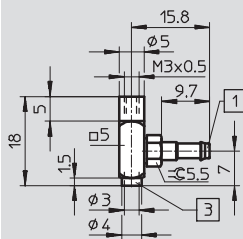

Holder size 2

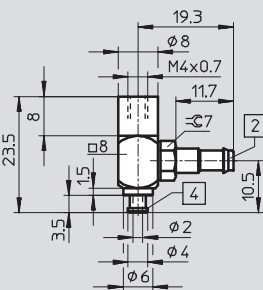

Holder size 3

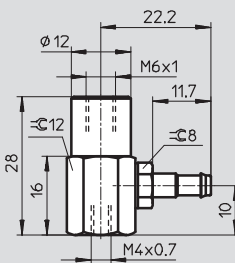

Holder size 4

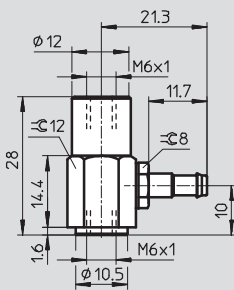

Threaded connection G

Holder size 5/Holder size 6\*

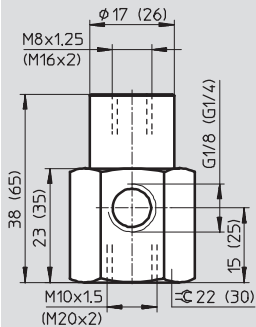

1 Barbed fitting for 3 mm plastic tubing

2 Barbed fitting for 4 mm plastic tubing

3 Hole for vacuum generator tubing

4 Barbed fitting for vacuum generator

\* Dimensions in brackets

# Suction cup holders ESH

Technical data

## Dimensions – ESH-HC

### Push-in connector QS

#### Holder size 1

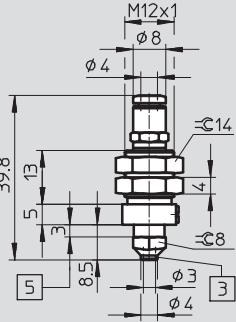

#### Holder size 2

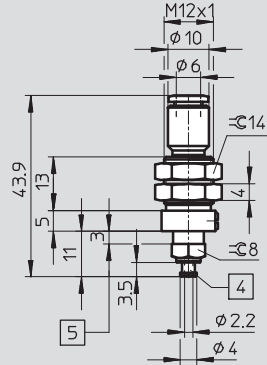

#### Holder size 3/Holder size 4\*

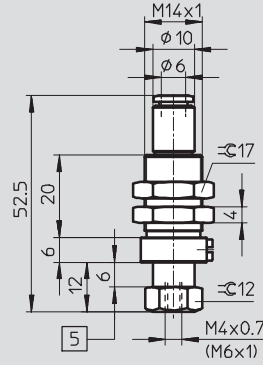

### Barbed fitting connector PK

#### Holder size 1

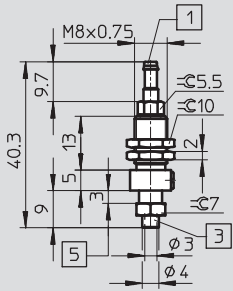

#### Holder size 2

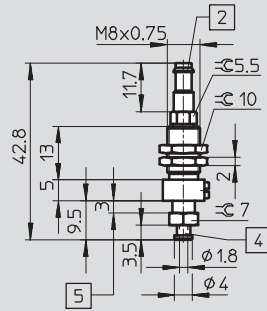

#### Holder size 3/Holder size 4\*

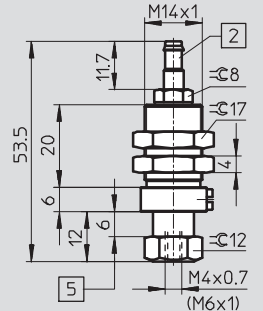

### Threaded connection G

#### Holder size 5

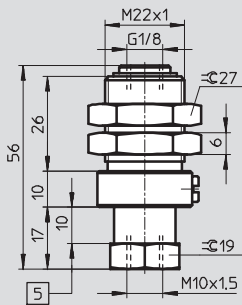

#### Holder size 6

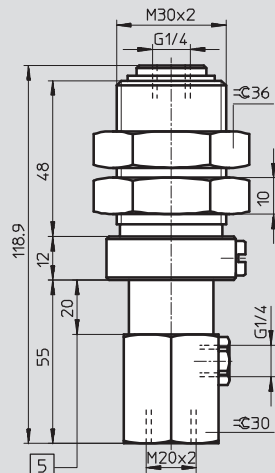

1 Barbed fitting for 3 mm plastic tubing

2 Barbed fitting for 4 mm plastic tubing

3 Hole for vacuum generator

4 Barbed fitting for vacuum generator

5 Stroke

\* Dimensions in brackets



# Suction cup holders ESH

Technical data

## Dimensions – ESH-HCL

### Push-in connector QS

#### Holder size 1

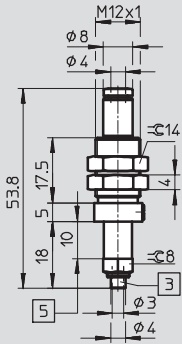

#### Holder size 2

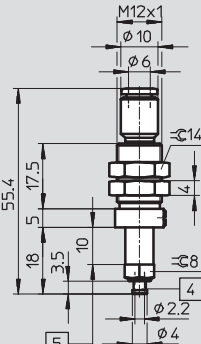

#### Holder size 3/Holder size 4\*

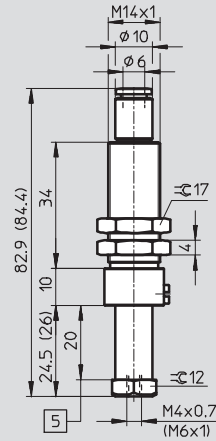

### Barbed fitting connector PK

#### Holder size 1

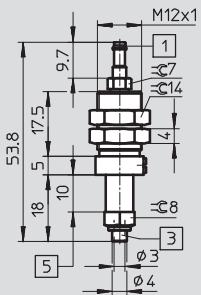

#### Holder size 2

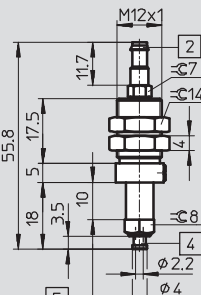

#### Holder size 3/Holder size 4\*

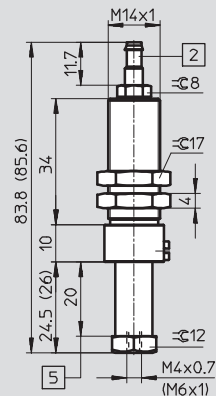

### Threaded connection G

#### Holder size 5

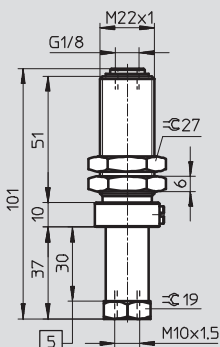

#### Holder size 6

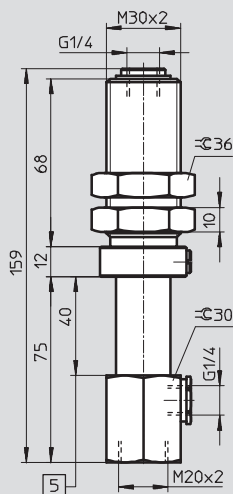

- 1 Barbed fitting for 3 mm plastic tubing
- 2 Barbed fitting for 4 mm plastic tubing
- 3 Hole for vacuum generator
- 4 Barbed fitting for vacuum generator
- 5 Stroke

\* Dimensions in brackets

# Suction cup holders ESH

Technical data

## Dimensions – ESH-HD

Push-in connector QS

Holder size 1

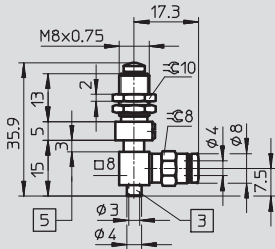

Holder size 2

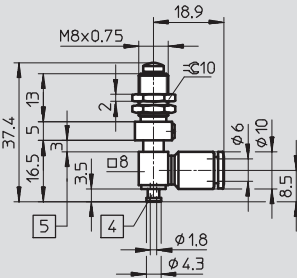

Holder size 3/Holder size 4\*

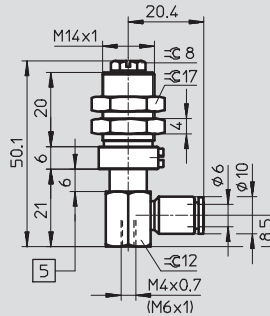

Barbed fitting connector PK

Holder size 1

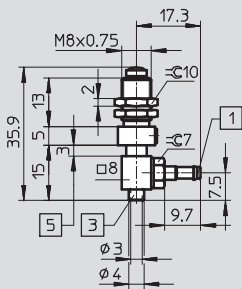

Holder size 2

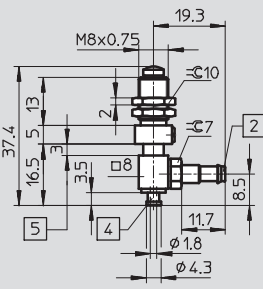

Holder size 3/Holder size 4\*

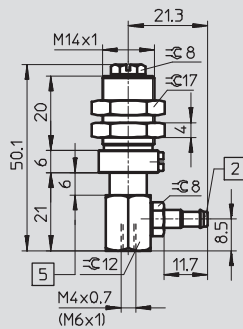

Threaded connection G

Holder size 5

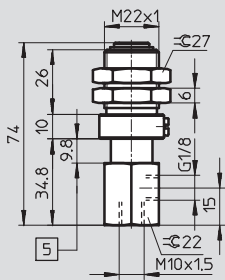

Holder size 6

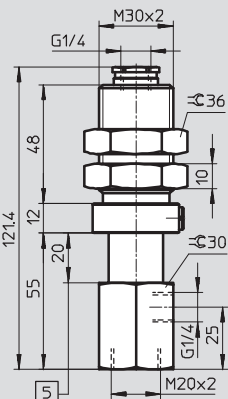

1 Barbed fitting for 3 mm plastic tubing

2 Barbed fitting for 4 mm plastic tubing

3 Hole for vacuum generator  
4 Barbed fitting for vacuum generator

5 Stroke

\* Dimensions in brackets



# Suction cup holders ESH

Technical data

FESTO

## Dimensions – ESH-HE

G and M thread

Holder size 1

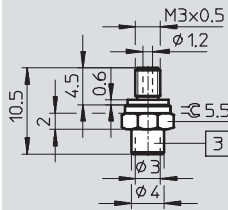

Holder size 2

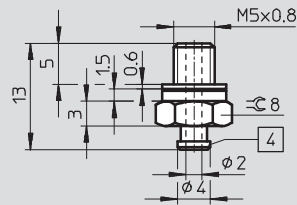

Holder size 3

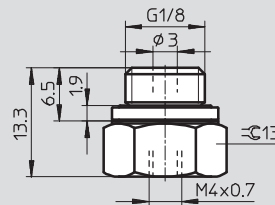

Holder size 4

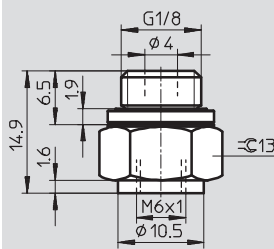

Holder size 5

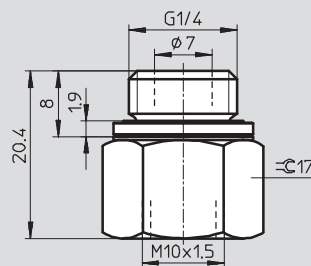

3 Hole for vacuum generator

4 Barbed fitting for vacuum generator

## Dimensions – ESH-HF

M thread

Holder size 1

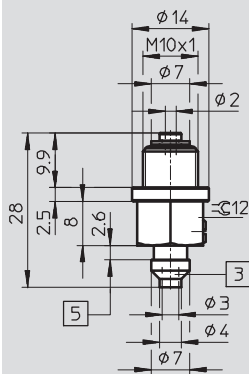

Holder size 2

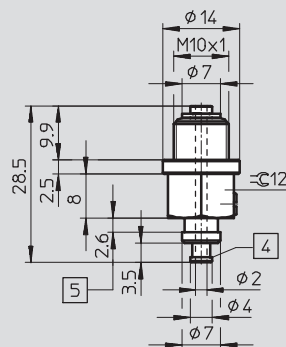

Holder size 3

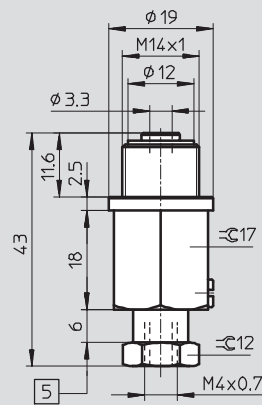

Holder size 4

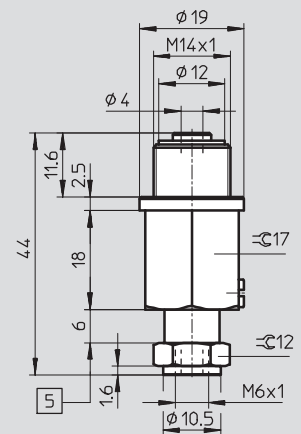

3 Hole for vacuum generator

4 Barbed fitting for vacuum generator

5 Stroke

# Suction cup holders ESH

Technical data

**FESTO**

| Ordering data                                 |            |                   |             |                          |             |                     |            |
|---|------------|-------------------|-------------|--------------------------|-------------|---------------------|------------|
| ESH-HA  |            |                   |             |                          |             |                     |            |
| Holder size                                   | Connection | Push-in connector |             | Barbed fitting connector |             | Threaded connection |            |
|   |            | Part No.          | Type        | Part No.                 | Type        | Part No.            | Type       |
| Male thread, 2 nuts, vacuum connection on top |            |                   |             |                          |             |                     |            |
| 1   | QS4        | 189193            | ESH-HA-1-QS | –                        | –           | –                   | –          |
|   | PK-3       | –                 | –           | 189194                   | ESH-HA-1-PK | –                   | –          |
| 2   | QS4        | 189195            | ESH-HA-2-QS | –                        | –           | –                   | –          |
|   | PK-4       | –                 | –           | 189196                   | ESH-HA-2-PK | –                   | –          |
| 3   | QS6        | 189197            | ESH-HA-3-QS | –                        | –           | –                   | –          |
|   | PK-4       | –                 | –           | 189198                   | ESH-HA-3-PK | –                   | –          |
| 4   | QS6        | 189199            | ESH-HA-4-QS | –                        | –           | –                   | –          |
|   | PK-4       | –                 | –           | 189200                   | ESH-HA-4-PK | –                   | –          |
| 5   | G1/8       | –                 | –           | –                        | –           | 189201              | ESH-HA-5-G |
| 6   | G1/4       | –                 | –           | –                        | –           | 189202              | ESH-HA-6-G |

| Ordering data                            |            |                   |             |                          |             |                     |            |
|--|------------|-------------------|-------------|--------------------------|-------------|---------------------|------------|
| ESH-HB                                   |            |                   |             |                          |             |                     |            |
| Holder size                              | Connection | Push-in connector |             | Barbed fitting connector |             | Threaded connection |            |
|  |            | Part No.          | Type        | Part No.                 | Type        | Part No.            | Type       |
| Female thread, vacuum connection on side |            |                   |             |                          |             |                     |            |
| 1  | QS4        | 189203            | ESH-HB-1-QS | –                        | –           | –                   | –          |
|  | PK-3       | –                 | –           | 189204                   | ESH-HB-1-PK | –                   | –          |
| 2  | QS6        | 189205            | ESH-HB-2-QS | –                        | –           | –                   | –          |
|  | PK-4       | –                 | –           | 189206                   | ESH-HB-2-PK | –                   | –          |
| 3  | QS6        | 189207            | ESH-HB-3-QS | –                        | –           | –                   | –          |
|  | PK-4       | –                 | –           | 189208                   | ESH-HB-3-PK | –                   | –          |
| 4  | QS6        | 189209            | ESH-HB-4-QS | –                        | –           | –                   | –          |
|  | PK-4       | –                 | –           | 189210                   | ESH-HB-4-PK | –                   | –          |
| 5  | G1/8       | –                 | –           | –                        | –           | 189211              | ESH-HB-5-G |
| 6  | G1/4       | –                 | –           | –                        | –           | 189212              | ESH-HB-6-G |

| Ordering data   |            |                   |             |                          |             |                     |            |
|---|------------|-------------------|-------------|--------------------------|-------------|---------------------|------------|
| ESH-HC  |            |                   |             |                          |             |                     |            |
| Holder size   | Connection | Push-in connector |             | Barbed fitting connector |             | Threaded connection |            |
|   |            | Part No.          | Type        | Part No.                 | Type        | Part No.            | Type       |
| Male thread, 2 nuts, vacuum connection on top, height compensator |            |                   |             |                          |             |                     |            |
| 1   | QS4        | 189213            | ESH-HC-1-QS | –                        | –           | –                   | –          |
|   | PK-3       | –                 | –           | 189214                   | ESH-HC-1-PK | –                   | –          |
| 2   | QS6        | 189215            | ESH-HC-2-QS | –                        | –           | –                   | –          |
|   | PK-4       | –                 | –           | 189216                   | ESH-HC-2-PK | –                   | –          |
| 3   | QS6        | 189217            | ESH-HC-3-QS | –                        | –           | –                   | –          |
|   | PK-4       | –                 | –           | 189218                   | ESH-HC-3-PK | –                   | –          |
| 4   | QS6        | 189219            | ESH-HC-4-QS | –                        | –           | –                   | –          |
|   | PK-4       | –                 | –           | 189220                   | ESH-HC-4-PK | –                   | –          |
| 5   | G1/8       | –                 | –           | –                        | –           | 189221              | ESH-HC-5-G |
| 6   | G1/4       | –                 | –           | –                        | –           | 189222              | ESH-HC-6-G |

# Suction cup holders ESH

Technical data

**FESTO**

| Ordering data   |            |                   |                     |                          |                     |                     |                    |
|---|------------|-------------------|---------------------|--------------------------|---------------------|---------------------|--------------------|
| ESH-HCL   |            |                   |                     |                          |                     |                     |                    |
| Holder size   | Connection | Push-in connector |                     | Barbed fitting connector |                     | Threaded connection |                    |
|   |            | Part No.          | Type                | Part No.                 | Type                | Part No.            | Type               |
| Male thread, 2 nuts, vacuum connection on top, height compensator, long |            |                   |                     |                          |                     |                     |                    |
| 1   | QS4        | <b>189223</b>     | <b>ESH-HCL-1-QS</b> | –                        | –                   | –                   | –                  |
|   | PK-3       | –                 | –                   | <b>189224</b>            | <b>ESH-HCL-1-PK</b> | –                   | –                  |
| 2   | QS6        | <b>189225</b>     | <b>ESH-HCL-2-QS</b> | –                        | –                   | –                   | –                  |
|   | PK-4       | –                 | –                   | <b>189226</b>            | <b>ESH-HCL-2-PK</b> | –                   | –                  |
| 3   | QS6        | <b>189227</b>     | <b>ESH-HCL-3-QS</b> | –                        | –                   | –                   | –                  |
|   | PK-4       | –                 | –                   | <b>189228</b>            | <b>ESH-HCL-3-PK</b> | –                   | –                  |
| 4   | QS6        | <b>189229</b>     | <b>ESH-HCL-4-QS</b> | –                        | –                   | –                   | –                  |
|   | PK-4       | –                 | –                   | <b>189230</b>            | <b>ESH-HCL-4-PK</b> | –                   | –                  |
| 5   | G1/8       | –                 | –                   | –                        | –                   | <b>189231</b>       | <b>ESH-HCL-5-G</b> |
| 6   | G1/4       | –                 | –                   | –                        | –                   | <b>189232</b>       | <b>ESH-HCL-6-G</b> |

| Ordering data  |            |                   |                    |                          |                    |                     |                   |
|--|------------|-------------------|--------------------|--------------------------|--------------------|---------------------|-------------------|
| ESH-HD   |            |                   |                    |                          |                    |                     |                   |
| Holder size  | Connection | Push-in connector |                    | Barbed fitting connector |                    | Threaded connection |                   |
|  |            | Part No.          | Type               | Part No.                 | Type               | Part No.            | Type              |
| Male thread, 2 nuts, vacuum connection on side, height compensator |            |                   |                    |                          |                    |                     |                   |
| 1  | QS4        | <b>189233</b>     | <b>ESH-HD-1-QS</b> | –                        | –                  | –                   | –                 |
|  | PK-3       | –                 | –                  | <b>189234</b>            | <b>ESH-HD-1-PK</b> | –                   | –                 |
| 2  | QS6        | <b>189235</b>     | <b>ESH-HD-2-QS</b> | –                        | –                  | –                   | –                 |
|  | PK-4       | –                 | –                  | <b>189236</b>            | <b>ESH-HD-2-PK</b> | –                   | –                 |
| 3  | QS6        | <b>189237</b>     | <b>ESH-HD-3-QS</b> | –                        | –                  | –                   | –                 |
|  | PK-4       | –                 | –                  | <b>189238</b>            | <b>ESH-HD-3-PK</b> | –                   | –                 |
| 4  | QS6        | <b>189239</b>     | <b>ESH-HD-4-QS</b> | –                        | –                  | –                   | –                 |
|  | PK-4       | –                 | –                  | <b>189240</b>            | <b>ESH-HD-4-PK</b> | –                   | –                 |
| 5  | G1/8       | –                 | –                  | –                        | –                  | <b>189241</b>       | <b>ESH-HD-5-G</b> |
| 6  | G1/4       | –                 | –                  | –                        | –                  | <b>189242</b>       | <b>ESH-HD-6-G</b> |

| Ordering data  |            |                   |                     |                          |                     |                     |                    |
|--|------------|-------------------|---------------------|--------------------------|---------------------|---------------------|--------------------|
| ESH-HDL  |            |                   |                     |                          |                     |                     |                    |
| Holder size  | Connection | Push-in connector |                     | Barbed fitting connector |                     | Threaded connection |                    |
|  |            | Part No.          | Type                | Part No.                 | Type                | Part No.            | Type               |
| Male thread, 2 nuts, vacuum connection on side, height compensator, long |            |                   |                     |                          |                     |                     |                    |
| 1  | QS4        | <b>189243</b>     | <b>ESH-HDL-1-QS</b> | –                        | –                   | –                   | –                  |
|  | PK-3       | –                 | –                   | <b>189244</b>            | <b>ESH-HDL-1-PK</b> | –                   | –                  |
| 2  | QS6        | <b>189245</b>     | <b>ESH-HDL-2-QS</b> | –                        | –                   | –                   | –                  |
|  | PK-4       | –                 | –                   | <b>189246</b>            | <b>ESH-HDL-2-PK</b> | –                   | –                  |
| 3  | QS6        | <b>189247</b>     | <b>ESH-HDL-3-QS</b> | –                        | –                   | –                   | –                  |
|  | PK-4       | –                 | –                   | <b>189248</b>            | <b>ESH-HDL-3-PK</b> | –                   | –                  |
| 4  | QS6        | <b>189249</b>     | <b>ESH-HDL-4-QS</b> | –                        | –                   | –                   | –                  |
|  | PK-4       | –                 | –                   | <b>189250</b>            | <b>ESH-HDL-4-PK</b> | –                   | –                  |
| 5  | G1/8       | –                 | –                   | –                        | –                   | <b>189251</b>       | <b>ESH-HDL-5-G</b> |
| 6  | G1/4       | –                 | –                   | –                        | –                   | <b>189252</b>       | <b>ESH-HDL-6-G</b> |

# Suction cup holders ESH

Technical data

| Ordering data                             |            |          |               |
|---|------------|----------|---------------|
| ESH-HE                                    |            |          |               |
| Holder size                               | Connection | Part No. | Type          |
| Threaded connection for direct attachment |            |          |               |
| 1   | M3         | 189253   | ESH-HE-1-M3   |
| 2   | M5         | 189254   | ESH-HE-2-M5   |
| 3   | G1/8       | 189255   | ESH-HE-3-G1/8 |
| 4   | G1/8       | 189256   | ESH-HE-4-G1/8 |
| 5   | G1/4       | 189257   | ESH-HE-5-G1/4 |

| Ordering data   |            |          |                |
|---|------------|----------|----------------|
| ESH-HF  |            |          |                |
| Holder size   | Connection | Part No. | Type           |
| Threaded connection for direct attachment, height compensator |            |          |                |
| 1   | M10        | 189260   | ESH-HF-1-M10x1 |
| 2   | M10        | 189261   | ESH-HF-2-M10x1 |
| 3   | M14        | 189262   | ESH-HF-3-M14x1 |
| 4   | M14        | 189263   | ESH-HF-4-M14x1 |