

# Electrical connection technology, for multi-pin plug connection

Technical data – IMP1

- Plug socket for multi-pin cable connection (to valve terminal type 02)
- Can be fabricated with any cable lengths
- 25-pin, 40-pin or 72-pin socket
- Wire cross section 0.75 and 1.5 mm<sup>2</sup> can be used

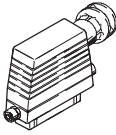

General technical data		
Type	IMP1-SD-...	
Type of mounting	Clamping strap	
Mounting position	Any	
Operating voltage range	[V]	300 AC
	[V]	250 DC
Current-carrying capacity	[A]	10
Protection class to EN 60 529		IP65 (assembled)
Material of housing		Die-cast light metal alloy
Material of contacts		Silver-plated copper base alloy
Material of plug		Fibreglass reinforced thermoplastic moulded material
Ambient temperature	[°C]	-40 ... +125

Ordering data							
	Electrical connection	Cable gland connection	Perm. cable diameter [mm]	Max. wire cross section [mm <sup>2</sup> ]	Product weight [g]	Type	Part No.
	25-pin plug socket	Pg21	11 ... 21	1.5	315	IMP1-SD-25	18 317
	25-pin plug socket	Pg16	7.5 ... 15	0.75	210	IMP1-SD-25-0,75	18 321
	40-pin plug socket	Pg29	18 ... 27	1.5	395	IMP1-SD-40	18 318
	40-pin plug socket	Pg21	10 ... 19	0.75	325	IMP1-SD-40-0,75	18 322
	72-pin plug socket	Pg29	18 ... 27	1.5	401	IMP1-SD-72	18 319
	72-pin plug socket	Pg29	18 ... 27	0.75	417	IMP1-SD-72-0,75	18 323
	72-pin plug socket	Sg50	22 ... 32	1.75	550	IMP1-SD-72-36	18 320

# Electrical connection technology, for multi-pin plug connection

Technical data – IMP1

## Dimensions

Download CAD data → [www.festo.com](http://www.festo.com)

IMP1-...

Cable assembled

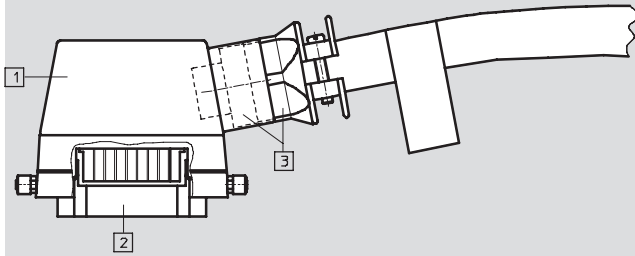

- 1 Housing
- 2 Socket insert with protective earth connection
- 3 Cable gland fitting with sealing set

## Housing

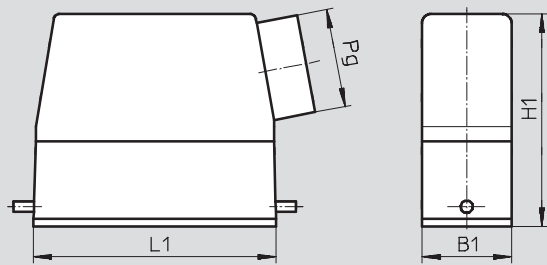

	25-pin	25-pin	40-pin	72-pin
L1	79.5 mm	79.5 mm	93.5 mm	93.5 mm
B1	29.5 mm	36 mm	43 mm	43 mm
H1	54.5 mm	70.5 mm	60 mm	76 mm
Pg	16	21	21	29

## Socket insert, 72-pin

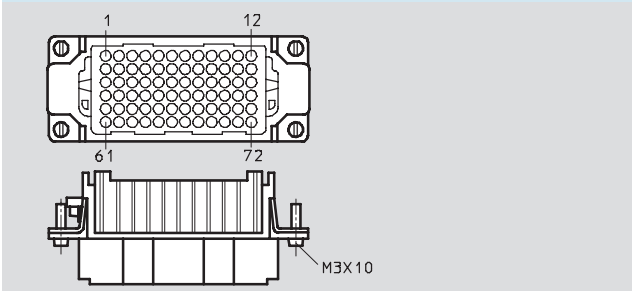

## Socket insert, 40-pin

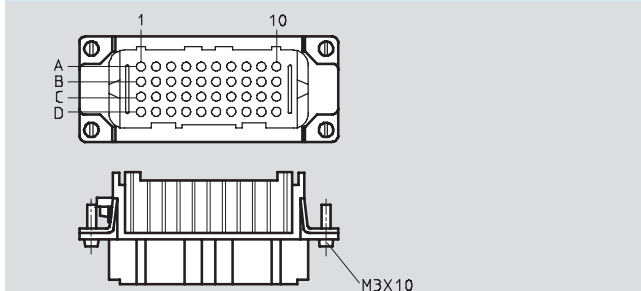

## Socket insert, 25-pin

