









Branching modules/Distributor blocks MS-FRM, MS series

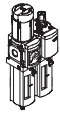
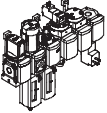

Branching modules/Distributor blocks MS-FRM, MS series



Product range overview – MS series service units

Type	Size	Pneumatic connection in housing	Connecting plate	Pressure regulation range [bar]						Grade of filtration [µm]				
				0.05	0.05	0.1	0.3	0.1	0.5					
				... 0.7	... 2.5	... 4	... 7	... 12	... 16	0.01	1	5	40	
Code		AG...		D2	D4	D5	D6	D7	D8	A	B	C	E	
Service units														
MSB-FRC 	4	G1/8, G1/4	G1/8, G1/4, G3/8	-	-	-	■	■	-	-	-	-	■	■
	6	G1/4, G3/8, G1/2	G1/4, G3/8, G1/2, G3/4	-	-	-	■	■	-	-	-	-	■	■
	9	-												
	12	-												
Service unit combinations (further variants can be ordered using the configurator → Internet: msb4, msb6 or msb9)														
MSB 	4	G1/4	G1/8, G1/4, G3/8	-	-	-	■	■	-	-	-	-	■	■
	6	G1/2	G1/4, G3/8, G1/2, G3/4	-	-	-	■	■	-	-	-	-	■	■
	9	-												
	12	-												
Individual devices														
Filter regulators MS-LFR 	4	G1/8, G1/4	G1/8, G1/4, G3/8	-	-	■	■	■	-	-	-	-	■	■
	6	G1/4, G3/8, G1/2	G1/4, G3/8, G1/2, G3/4	-	-	■	■	■	■	-	-	-	■	■
	9	-												
	12	-	G1, G1 1/4, G1 1/2, G2	-	-	-	■	■	■	-	-	-	■	■
Filter MS-LF 	4	G1/8, G1/4	G1/8, G1/4, G3/8	-	-	-	-	-	-	-	-	-	■	■
	6	G1/4, G3/8, G1/2	G1/4, G3/8, G1/2, G3/4	-	-	-	-	-	-	-	-	-	■	■
	9	-												
	12	-	G1, G1 1/4, G1 1/2, G2	-	-	-	-	-	-	-	-	-	■	■
Fine and micro filters MS-LFM 	4	G1/8, G1/4	G1/8, G1/4, G3/8	-	-	-	-	-	-	■	■	-	-	-
	6	G1/4, G3/8, G1/2	G1/4, G3/8, G1/2, G3/4	-	-	-	-	-	-	■	■	-	-	-
	9	G3/4, G1	G1/2, G3/4, G1, G1 1/4, G1 1/2	-	-	-	-	-	-	■	■	-	-	-
	12	-	G1, G1 1/4, G1 1/2, G2	-	-	-	-	-	-	■	■	-	-	-
Activated carbon filters MS-LFX 	4	G1/8, G1/4	G1/8, G1/4, G3/8	-	-	-	-	-	-	-	-	-	-	-
	6	G1/4, G3/8, G1/2	G1/4, G3/8, G1/2, G3/4	-	-	-	-	-	-	-	-	-	-	-
	9	G3/4, G1	G1/2, G3/4, G1, G1 1/4, G1 1/2	-	-	-	-	-	-	-	-	-	-	-
	12	-	G1, G1 1/4, G1 1/2, G2	-	-	-	-	-	-	-	-	-	-	-
Pressure regulators MS-LR 	4	G1/8, G1/4	G1/8, G1/4, G3/8	-	-	■	■	■	-	-	-	-	-	-
	6	G1/4, G3/8, G1/2	G1/4, G3/8, G1/2, G3/4	-	-	■	■	■	■	-	-	-	-	-
	9	-												
	12	-	G1, G1 1/4, G1 1/2, G2	-	-	-	■	■	■	-	-	-	-	-
Pressure regulators MS-LRB 	4	G1/4	G1/8, G1/4, G3/8	-	-	■	■	■	-	-	-	-	-	-
	6	G1/2	G1/4, G3/8, G1/2, G3/4	-	-	■	■	■	■	-	-	-	-	-
	9	-												
	12	-												
Precision pressure regulators MS-LRP 	4	-												
	6	G1/4, G3/8, G1/2	G1/4, G3/8, G1/2, G3/4	■	■	■	-	■	-	-	-	-	-	-
	9	-												
	12	-												
Precision pressure regulators MS-LRPB 	4	-												
	6	G1/2	G1/4, G3/8, G1/2, G3/4	■	■	■	-	■	-	-	-	-	-	-
	9	-												
	12	-												

Branching modules/Distributor blocks MS-FRM, MS series

Product range overview – MS series service units

Type	Size	Bowl guard		Condensate drains				Pressure indicator					Actuator lock		Options		→ Page/ Internet
		Plastic bowl with plastic bowl guard	Metal bowl	Manual rotary	Semi-automatic	Fully automatic	External, fully automatic, electrical	Cover plate (without pressure gauge)	Integrated MS pressure gauge	Adapter plate for EN pressure gauge G1/8	Adapter plate for EN pressure gauge G1/4	Pressure sensor with display	Rotary knob, lockable	Rotary knob, long	Silencer	Flow direction from right to left	
Code		R	U	M	H	V	E ...	VS	AG	A8	A4	AD...	AS	LD	S	Z	
Service units																	
MSB-FRC	4	■	-	■	-	■	-	-	■	-	-	-	■	-	-	■	msb4
	6	■	■	■	-	■	-	-	■	-	-	-	■	-	-	■	msb6
	9	-	-	-	-	-	-	-	-	-	-	-	-	-	-	-	-
	12	-	-	-	-	-	-	-	-	-	-	-	-	-	-	-	-
Service unit combinations																	
MSB	4	■	■	■	-	■	-	-	■	-	-	-	■	-	-	■	msb4
	6	■	■	■	-	■	-	-	■	-	-	-	■	-	-	■	msb6
	9	-	-	-	-	-	-	-	-	-	-	-	-	-	-	-	-
	12	-	-	-	-	-	-	-	-	-	-	-	-	-	-	-	-
Individual devices																	
Filter regulators MS-LFR	4	■	■	■	■	■	-	■	■	■	■	■	■	■	-	■	ms4-lfr
	6	■	■	■	■	■	■	■	■	-	■	■	■	■	-	■	ms6-lfr
	9	-	-	-	-	-	-	-	-	-	-	-	-	-	-	-	-
	12	-	■	■	-	■	■	■	■	-	■	-	■	■	-	■	ms12-lfr
Filters MS-LF	4	■	■	■	■	■	-	-	-	-	-	-	-	-	-	■	ms4-lf
	6	■	■	■	■	■	■	-	-	-	-	-	-	-	-	■	ms6-lf
	9	-	-	-	-	-	-	-	-	-	-	-	-	-	-	-	-
	12	-	■	■	-	■	■	-	-	-	-	-	-	-	-	■	ms12-lf
Fine and micro filters MS-LFM	4	■	■	■	■	■	-	-	-	-	-	-	-	-	-	■	ms4-lfm
	6	■	■	■	■	■	■	-	-	-	-	-	-	-	-	■	ms6-lfm
	9	-	■	■	-	■	■	-	-	-	-	-	-	-	-	■	ms9-lfm
	12	-	■	■	-	■	■	-	-	-	-	-	-	-	-	■	ms12-lfm
Activated carbon filters MS-LFX	4	■	■	-	-	-	-	-	-	-	-	-	-	-	-	■	ms4-lfx
	6	■	■	-	-	-	-	-	-	-	-	-	-	-	-	■	ms6-lfx
	9	-	■	-	-	-	-	-	-	-	-	-	-	-	-	■	ms9-lfx
	12	-	■	-	-	-	-	-	-	-	-	-	-	-	-	■	ms12-lfx
Pressure regulators MS-LR	4	-	-	-	-	-	-	■	■	■	■	■	■	■	-	■	ms4-lr
	6	-	-	-	-	-	-	■	■	-	■	■	■	■	-	■	ms6-lr
	9	-	-	-	-	-	-	-	-	-	-	-	-	-	-	-	-
	12	-	-	-	-	-	-	■	■	-	■	-	■	■	-	■	ms12-lr
Pressure regulators MS-LRB	4	-	-	-	-	-	-	■	■	■	■	■	■	■	-	■	ms4-lrb
	6	-	-	-	-	-	-	■	■	-	■	■	■	■	-	■	ms6-lrb
	9	-	-	-	-	-	-	-	-	-	-	-	-	-	-	-	-
	12	-	-	-	-	-	-	-	-	-	-	-	-	-	-	-	-
Precision pressure regulators MS-LRP	4	-	-	-	-	-	-	■	-	■	■	■	■	■	-	■	ms6-lrp
	6	-	-	-	-	-	-	■	-	■	■	■	■	■	-	■	ms6-lrp
	9	-	-	-	-	-	-	-	-	-	-	-	-	-	-	-	-
	12	-	-	-	-	-	-	-	-	-	-	-	-	-	-	-	-
Precision pressure regulators MS-LRPB	4	-	-	-	-	-	-	■	-	■	■	■	■	■	-	■	ms6-lrpb
	6	-	-	-	-	-	-	■	-	■	■	■	■	■	-	■	ms6-lrpb
	9	-	-	-	-	-	-	-	-	-	-	-	-	-	-	-	-
	12	-	-	-	-	-	-	-	-	-	-	-	-	-	-	-	-

Branching modules/Distributor blocks MS-FRM, MS series



Product range overview – MS series service units

Type	Size	Pneumatic connection in housing	Connecting plate	Pressure regulation range [bar]				Supply voltage				
				0.3	0.3	0.5	0.5	24 V DC, connection pattern to EN 175301	24 V DC, connection pattern M12 to DESINA	110 V AC, connection pattern to EN 175301	230 V AC, connection pattern to EN 175301	
Code			AG...	D5	D6	D7	D8	V24	V24P	V110	V230	
Individual devices												
Electrical pressure regulators MS-LRE		4	–									
		6	G $\frac{1}{4}$, G $\frac{3}{8}$, G $\frac{1}{2}$	G $\frac{1}{4}$, G $\frac{3}{8}$, G $\frac{1}{2}$, G $\frac{3}{4}$	■	■	■	■	–	–	–	–
		9	–									
		12	–									
Lubricators MS-LOE		4	G $\frac{1}{8}$, G $\frac{1}{4}$	G $\frac{1}{8}$, G $\frac{1}{4}$, G $\frac{3}{8}$	–	–	–	–	–	–	–	
		6	G $\frac{1}{4}$, G $\frac{3}{8}$, G $\frac{1}{2}$	G $\frac{1}{4}$, G $\frac{3}{8}$, G $\frac{1}{2}$, G $\frac{3}{4}$	–	–	–	–	–	–	–	
		9	–									
		12	–	G1, G1 $\frac{1}{4}$, G1 $\frac{1}{2}$, G2	–	–	–	–	–	–	–	–
Electrical on-off valves MS-EM(1)		4	G $\frac{1}{8}$, G $\frac{1}{4}$	G $\frac{1}{8}$, G $\frac{1}{4}$, G $\frac{3}{8}$	–	–	–	–	–	–	–	
		6	G $\frac{1}{4}$, G $\frac{3}{8}$, G $\frac{1}{2}$	G $\frac{1}{4}$, G $\frac{3}{8}$, G $\frac{1}{2}$, G $\frac{3}{4}$	–	–	–	–	–	–	–	
		9	–									
		12	–	G1, G1 $\frac{1}{4}$, G1 $\frac{1}{2}$, G2	–	–	–	–	–	–	–	–
Electrical on-off valves MS-EE		4	G $\frac{1}{8}$, G $\frac{1}{4}$	G $\frac{1}{8}$, G $\frac{1}{4}$, G $\frac{3}{8}$	–	–	–	–	■	–	■	■
		6	G $\frac{1}{4}$, G $\frac{3}{8}$, G $\frac{1}{2}$	G $\frac{1}{4}$, G $\frac{3}{8}$, G $\frac{1}{2}$, G $\frac{3}{4}$	–	–	–	–	■	–	■	■
		9	–									
		12	–	G1, G1 $\frac{1}{4}$, G1 $\frac{1}{2}$, G2	–	–	–	–	■	■	■	■
Electrical soft-start valves MS-DL		4	G $\frac{1}{8}$, G $\frac{1}{4}$	G $\frac{1}{8}$, G $\frac{1}{4}$, G $\frac{3}{8}$	–	–	–	–	–	–	–	
		6	G $\frac{1}{4}$, G $\frac{3}{8}$, G $\frac{1}{2}$	G $\frac{1}{4}$, G $\frac{3}{8}$, G $\frac{1}{2}$, G $\frac{3}{4}$	–	–	–	–	–	–	–	
		9	–									
		12	–	G1, G1 $\frac{1}{4}$, G1 $\frac{1}{2}$, G2	–	–	–	–	–	–	–	–
Electrical soft-start valves MS-DE		4	G $\frac{1}{8}$, G $\frac{1}{4}$	G $\frac{1}{8}$, G $\frac{1}{4}$, G $\frac{3}{8}$	–	–	–	–	■	–	■	■
		6	G $\frac{1}{4}$, G $\frac{3}{8}$, G $\frac{1}{2}$	G $\frac{1}{4}$, G $\frac{3}{8}$, G $\frac{1}{2}$, G $\frac{3}{4}$	–	–	–	–	■	–	■	■
		9	–									
		12	–	G1, G1 $\frac{1}{4}$, G1 $\frac{1}{2}$, G2	–	–	–	–	■	■	■	■
Soft start and exhaust valves MS-SV		4	–									
		6	G $\frac{1}{2}$	G $\frac{1}{4}$, G $\frac{3}{8}$, G $\frac{1}{2}$, G $\frac{3}{4}$	–	–	–	–	■	–	–	–
		9	–									
		12	–									
Membrane air dryers MS-LDM1		4	G $\frac{1}{8}$, G $\frac{1}{4}$	G $\frac{1}{8}$, G $\frac{1}{4}$, G $\frac{3}{8}$	–	–	–	–	–	–	–	
		6	G $\frac{1}{4}$, G $\frac{3}{8}$, G $\frac{1}{2}$	G $\frac{1}{4}$, G $\frac{3}{8}$, G $\frac{1}{2}$, G $\frac{3}{4}$	–	–	–	–	–	–	–	
		9	–									
		12	–									

Branching modules/Distributor blocks MS-FRM, MS series

Product range overview – MS series service units

Type	Size	Bowl guard		Pressure indicator				Options			→ Page/ Internet
		Plastic bowl with plastic bowl guard	Metal bowl	Cover plate (without pressure gauge)	Integrated MS pressure gauge	Adapter plate for EN pressure gauge G1/8	Adapter plate for EN pressure gauge G1/4	Pressure sensor with display	Silencer	Flow direction from right to left	
Individual devices											
Electrical pressure regulators MS-LRE	4	-	-	-	-	-	-	-	-	-	-
	6	-	-	■	■	-	■	-	-	■	ms6-lre
	9	-	-	-	-	-	-	-	-	-	-
	12	-	-	-	-	-	-	-	-	-	-
Lubricators MS-LOE	4	■	■	-	-	-	-	-	-	■	ms4-loe
	6	■	■	-	-	-	-	-	-	■	ms6-loe
	9	-	-	-	-	-	-	-	-	-	-
	12	-	■	-	-	-	-	-	-	■	ms12-loe
Electrical on-off valves MS-EM(1)	4	-	-	■	■	■	■	■	■	■	ms4-em1
	6	-	-	■	■	-	■	■	■	■	ms6-em1
	9	-	-	-	-	-	-	-	-	-	-
	12	-	-	■	■	-	■	-	■	■	ms12-em
Electrical on-off valves MS-EE	4	-	-	■	■	■	■	■	■	■	ms4-ee
	6	-	-	■	■	-	■	■	■	■	ms6-ee
	9	-	-	-	-	-	-	-	-	-	-
	12	-	-	■	■	-	■	-	■	■	ms12-ee
Electrical soft-start valves MS-DL	4	-	-	■	■	■	■	■	-	■	ms4-dl
	6	-	-	■	■	-	■	■	-	■	ms6-dl
	9	-	-	-	-	-	-	-	-	-	-
	12	-	-	■	■	-	■	-	-	■	ms12-dl
Electrical soft-start valves MS-DE	4	-	-	■	■	■	■	■	-	■	ms4-de
	6	-	-	■	■	-	■	■	-	■	ms6-de
	9	-	-	-	-	-	-	-	-	-	-
	12	-	-	■	■	-	■	-	-	■	ms12-de
Soft start and exhaust valves MS-SV	4	-	-	-	-	-	-	-	-	-	-
	6	-	-	■	■	-	■	■	■	■	ms6-sv
	9	-	-	-	-	-	-	-	-	-	-
	12	-	-	-	-	-	-	-	-	-	-
Membrane air dryers MS-LDM1	4	-	■	-	-	-	-	-	-	■	ms4-ldm1
	6	-	■	-	-	-	-	-	-	■	ms6-ldm1
	9	-	-	-	-	-	-	-	-	-	-
	12	-	-	-	-	-	-	-	-	-	-

Branching modules/Distributor blocks MS-FRM, MS series

Product range overview – MS series service units

Type	Size	Pneumatic connection in housing	Connecting plate	Pressure regulation range [bar]				Supply voltage			
				0.3	0.3	0.5	0.5	24 V DC, connection pattern to EN 175301	24 V DC, connection pattern M12 to DESINA	110 V AC, connection pattern to EN 175301	230 V AC, connection pattern to EN 175301
Code			AG...	D5	D6	D7	D8	V24	V24P	V110	V230
Individual devices											
Branching modules MS-FRM		4	G1/8, G1/4	G1/8, G1/4, G3/8	-	-	-	-	-	-	-
		6	G1/4, G3/8, G1/2	G1/4, G3/8, G1/2, G3/4	-	-	-	-	-	-	-
		9	-	-	-	-	-	-	-	-	-
		12	-	G1, G1 1/4, G1 1/2, G2	-	-	-	-	-	-	-
Distributor blocks MS-FRM-FRZ		4	G1/4	-	-	-	-	-	-	-	-
		6	G1/2	-	-	-	-	-	-	-	-
		9	-	-	-	-	-	-	-	-	-
		12	-	-	-	-	-	-	-	-	-
Flow sensors MS-SFE		4	-	-	-	-	-	-	-	-	-
		6	G1/2	G1/2	-	-	-	-	-	-	-
		9	-	-	-	-	-	-	-	-	-
		12	-	-	-	-	-	-	-	-	-

Branching modules/Distributor blocks MS-FRM, MS series

Product range overview – MS series service units

Type	Size	Pressure indicator					Switch output		Options		→ Page/ Internet
		Cover plate (without pressure gauge)	Integrated MS pressure gauge	Adapter plate for EN pressure gauge G1/8	Adapter plate for EN pressure gauge G1/4	Pressure sensor with display	2x PNP	2x NPN	Silencer	Flow direction from right to left	
Individual devices											
Branching modules MS-FRM	4	■	■	■	■	■	-	-	-	■	8
	6	■	■	-	■	■	-	-	-	■	8
	9	-	-	-	-	-	-	-	-	-	-
	12	■	-	-	-	-	-	-	-	-	20
Distributor blocks MS-FRM-FRZ	4	-	-	-	-	-	-	-	-	-	18
	6	-	-	-	-	-	-	-	-	-	18
	9	-	-	-	-	-	-	-	-	-	-
	12	-	-	-	-	-	-	-	-	-	-
Flow sensors MS-SFE	4	-	-	-	-	-	-	-	-	-	-
	6	-	-	-	-	-	■	■	-	■ ¹⁾	ms6-sfe
	9	-	-	-	-	-	-	-	-	-	-
	12	-	-	-	-	-	-	-	-	-	-

1) Can only be ordered using the configurator → Internet: ms6-sfe

Branching modules MS4/MS6-FRM, MS series

Peripherals overview

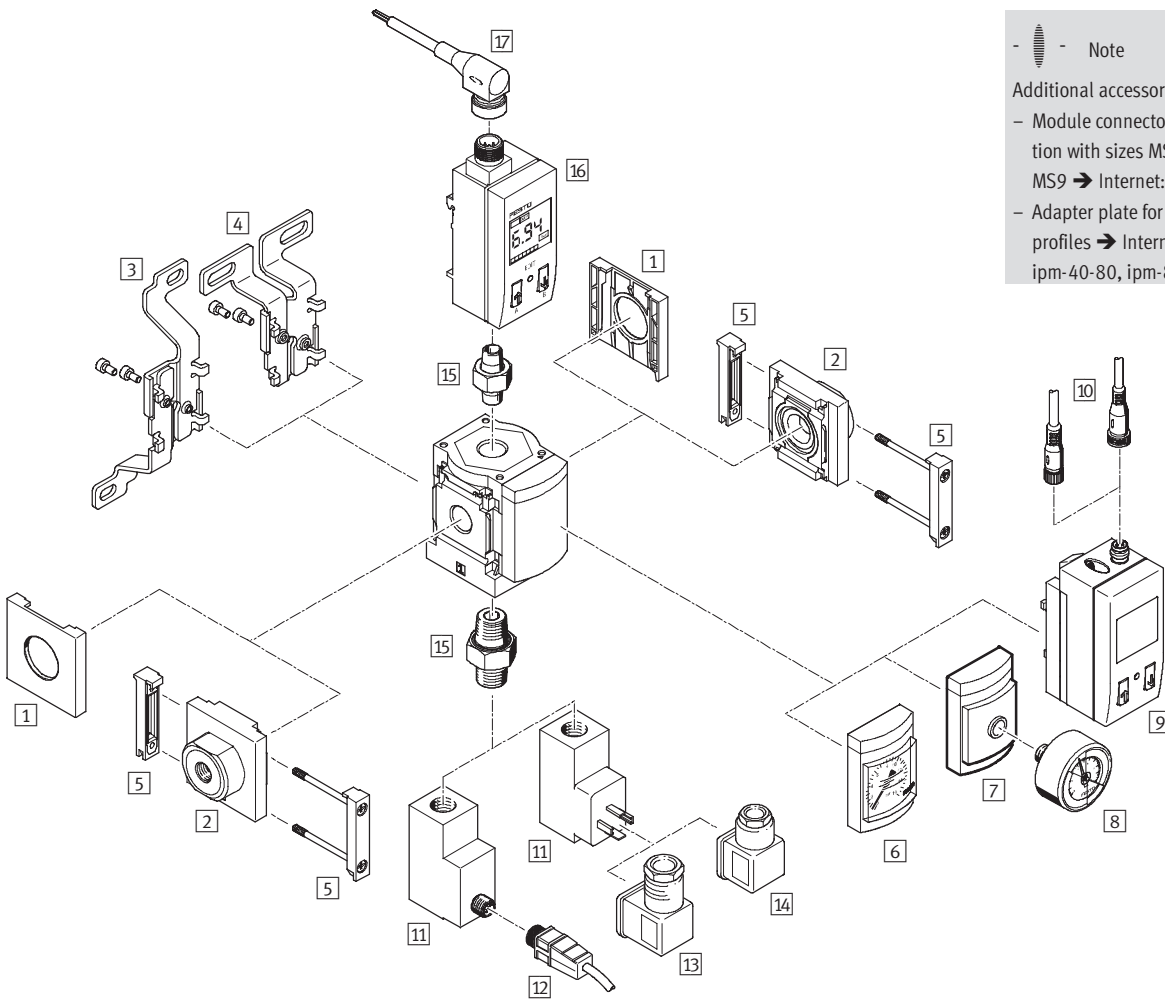

-  - Note

Additional accessories:

- Module connector for combination with sizes MS4/MS6 or size MS9 → Internet: amv, rmv, armv
- Adapter plate for mounting on profiles → Internet: ipm-80, ipm-40-80, ipm-80-80

Branching modules MS4/MS6-FRM, MS series

Peripherals overview

Mounting attachments and accessories						
		Individual unit		Combination		→ Page/Internet
		without connect- ing plate	with connecting plate	without connect- ing plate	with connecting plate	
1	Cover cap MS4/6-END	■	-	■	-	ms4-end, ms6-end
2	Connecting plate MS4/6-AG...	-	■	-	■	ms4-ag, ms6-ag
3	Mounting bracket MS4/6-WB	■	■	-	-	ms4-wb, ms6-wb
4	Mounting bracket MS4-WBM	■	■	-	-	ms4-wbm
5	Module connector MS4/6-MV	-	■	■	■	ms4-mv, ms6-mv
6	MS pressure gauge AG	■	■	■	■	16
7	Adapter for EN pressure gauge 1/8/1/4 A8/A4	■	■	■	■	16
8	Pressure gauge MA	■	■	■	■	25
9	Pressure sensor SDE1-...-MS AD1 ... AD4	■	■	■	■	16
10	Plug socket with cable SIM-M8-3.../SIM-M12-4...	■	■	■	■	sim
11	Pressure switch PEV X/Y/M12	■	■	■	■	16
12	Plug socket with cable SIM-M12-4...	■	■	■	■	sim
13	Angled socket PEV-1/4-WD-LED-...	■	■	■	■	25
14	Plug socket MSSD-C-4P	■	■	■	■	25
15	Double nipple ESK	■	■	■	■	25
16	Pressure sensor SDE1-...-H18/W18 AD5/AD6	■	■	■	■	16
17	Plug socket with cable SIM-M8-3.../SIM-M12-5...	■	■	■	■	sim
-	Mounting bracket MS4/6-WP/WPB/WPM	-	■	■	■	ms4-wp, ms6-wp

Branching modules MS4/MS6-FRM, MS series

FESTO

Type codes

Series		MS	4	-	FRM	-	1/8	-	Y
MS	Standard service unit								
Size									
4	Grid dimension 40 mm								
6	Grid dimension 62 mm								
Service function									
FRM	Branching module								
Connection size									
1/8	Thread G1/8								
1/4	Thread G1/4								
3/8	Thread G3/8								
1/2	Thread G1/2								
Non-return function/pressure switch									
	Standard								
I	With integrated non-return function								
Y	With pressure switch								

Further variants can be ordered using the modular system

Branching modules FRM

→ 16

- Connecting plates
- Pressure gauge alternatives
- Alternative pressure gauge scale
- Pressure switch
- Type of mounting
- Alternative flow direction

Branching modules MS4/MS6-FRM, MS series

Technical data

Function
Standard



With integrated non-return function

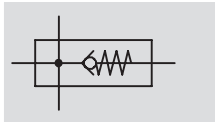

-  - Flow rate
1,200 ... 14,700 l/min

-  - Temperature range
-10 ... +60 °C

-  - Operating pressure
0 ... 20 bar



- Pneumatic manifold with 4 connections
- Can be used as an intermediate distributor for varying air qualities
- Attachment facility for auxiliary modules
- Outlet top and bottom
- An integrated non-return valve prevents the return flow e.g. of lubricated compressed air
- Optional pressure sensor with display

General technical data					
Size	MS4		MS6		
Pneumatic connection 1, 2	G $\frac{1}{8}$	G $\frac{1}{4}$	G $\frac{1}{4}$	G $\frac{3}{8}$	G $\frac{1}{2}$
Pneumatic connection 3, 4	G $\frac{1}{4}$		G $\frac{1}{2}$		
Design	Branching module				
	Branching module with non-return function				
Type of mounting	Via accessories				
	In-line installation				
Assembly position	Any ¹⁾				
Pressure display	With pressure sensor for the output pressure display and with electric output				
	With pressure gauge for the output pressure display				

1) The branching module must be mounted vertically when combined with a pressure sensor as condensate must not collect in the pressure sensor.
-  Note: This product conforms with the ISO 1179-1 standard and the ISO 228-1 standard.

Standard nominal flow rate $q_n N^{1)}$ [l/min]					
Size	MS4		MS6		
Pneumatic connection	G $\frac{1}{8}$	G $\frac{1}{4}$	G $\frac{1}{4}$	G $\frac{3}{8}$	G $\frac{1}{2}$
Standard					
In main flow direction 1 \rightarrow 2	1,800	4,600	4,200	9,200	14,700
Outlet at top	1,600	1,500	6,000	4,700	4,400
Outlet at bottom	1,700	1,500	6,400	4,800	4,600
With non-return function					
In main flow direction 1 \rightarrow 2	1,200	1,750	3,200	5,500	6,000
Outlet at top	500	500	2,700	2,900	3,100
Outlet at bottom	500	500	2,800	3,200	3,300

1) Measured at $p_1 = 6$ bar and $p_2 = 5$ bar, $\Delta p = 1$ bar

Branching modules MS4/MS6-FRM, MS series

Technical data

Operating and environmental conditions								
Variant	Standard		Non-return function I		Pressure switch X/Y/M12		Pressure sensor with display AD...	
Size	MS4	MS6	MS4	MS6	MS4	MS6	MS4	MS6
Operating pressure [bar]	0 ... 14	0 ... 20	0 ... 10	0 ... 20	0 ... 12	0 ... 12	0 ... 10	0 ... 10
Operating medium	Compressed air		Compressed air		Compressed air		Filtered compressed air, lubricated or unlubricated, grade of filtration 40 µm	
Ambient temperature [°C]	-10 ... +60		-10 ... +60		-10 ... +60		0 ... +50	
Temperature of medium [°C]	-10 ... +60		-10 ... +60		-10 ... +60		0 ... +50	
Storage temperature [°C]	-10 ... +60		-10 ... +60		-10 ... +60		-10 ... +60	
Corrosion resistance class CRC ¹⁾	2							

1) Corrosion resistance class 2 according to Festo standard 940 070

Components requiring moderate corrosion resistance. Externally visible parts with primarily decorative surface requirements which are in direct contact with a normal industrial environment or media such as coolants or lubricating agents.

Weight [g]		
Size	MS4	MS6
Branching module	165	458
Branching module with non-return function I	160	400
Branching module with pressure switch AD...	255	528
Branching module with pressure sensor X/Y/M12	405	736

Materials

Sectional view

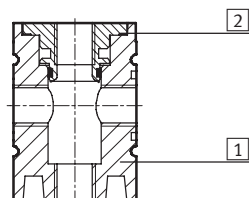

Branching module	
1	Housing Die-cast aluminium
2	Threaded insert Aluminium
Note on materials Free of copper and PTFE (not with variants AG or AD...)	

Branching modules MS4/MS6-FRM, MS series

Technical data

FESTO

Dimensions – Standard

Download CAD data → www.festo.com

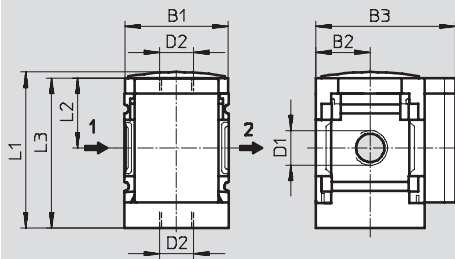

→ Flow direction

Type	B1	B2	B3	D1	D2	L1	L2	L3
MS4-FRM-1/8	40	21	54	G1/8	G1/4	60.4	27	58
MS4-FRM-1/4				G1/4				
MS6-FRM-1/4	62	31	76	G1/4	G1/2	87.2	39	84.5
MS6-FRM-3/8				G3/8				
MS6-FRM-1/2				G1/2				

• | • Note: This product conforms with the ISO 1179-1 standard and the ISO 228-1 standard.

Dimensions – Pressure gauge alternatives

Download CAD data → www.festo.com

Integrated MS pressure gauge with standard scale AG or red-green scale RG, display unit [bar]

Adapter plate A8/A4 for EN pressure gauge 1/8/1/4, without pressure gauge

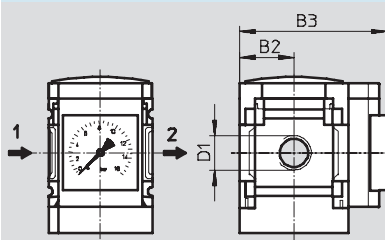

→ Flow direction

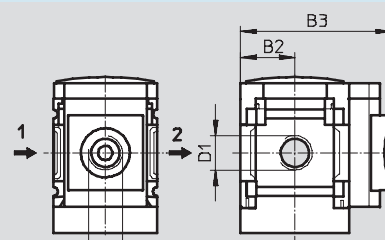

→ Flow direction

Type	B2	B3	D1	D4
MS4-FRM-1/8-...-AG	21	57	G1/8	-
MS4-FRM-1/4-...-AG			G1/4	
MS4-FRM-1/8-...-RG	21	58.5	G1/8	-
MS4-FRM-1/4-...-RG			G1/4	
MS4-FRM-1/8-...-A8	21	58.5	G1/8	G1/8
MS4-FRM-1/4-...-A8			G1/4	
MS4-FRM-1/8-...-A4	21	58.5	G1/8	G1/4
MS4-FRM-1/4-...-A4			G1/4	
MS6-FRM-1/4-...-AG	31	77	G1/4	-
MS6-FRM-3/8-...-AG			G3/8	
MS6-FRM-1/2-...-AG			G1/2	
MS6-FRM-1/4-...-RG	31	78.5	G1/4	-
MS6-FRM-3/8-...-RG			G3/8	
MS6-FRM-1/2-...-RG			G1/2	
MS6-FRM-1/4-...-A4	31	78.5	G1/4	G1/4
MS6-FRM-3/8-...-A4			G3/8	
MS6-FRM-1/2-...-A4			G1/2	

• | • Note: This product conforms with the ISO 1179-1 standard and the ISO 228-1 standard.

Branching modules MS4/MS6-FRM, MS series

Technical data

Dimensions – Pressure gauge alternatives

Pressure sensor with display AD1 ... AD4

Download CAD data → www.festo.com

Technical data → Internet: sde1

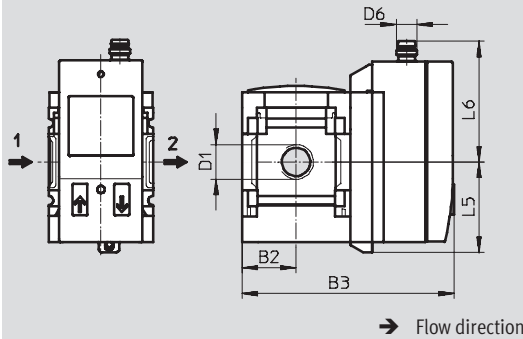

Variant AD1:
SDE1-D10-G2-MS-L-P1-M8 with
3-pin plug M8x1, 1 switch output
PNP

Variant AD3:
SDE1-D10-G2-MS-L-PI-M12 with
4-pin plug M12x1, 1 switch output
PNP and 4 ... 20 mA analogue

Variant AD2:
SDE1-D10-G2-MS-L-N1-M8 with
3-pin plug M8x1, 1 switch output
NPN

Variant AD4:
SDE1-D10-G2-MS-L-NI-M12 with
4-pin plug M12x1, 1 switch output
NPN and 4 ... 20 mA analogue

Type	B2	B3	D1	D6	L5	L6
MS4-FRM-1/8-...-AD1/AD2	21	82.6	G1/8	M8x1	35.1	46.7
MS4-FRM-1/4-...-AD1/AD2			G1/4			
MS4-FRM-1/8-...-AD3/AD4	21	82.6	G1/8	M12x1	35.1	55.8
MS4-FRM-1/4-...-AD3/AD4			G1/4			
MS6-FRM-1/4-...-AD1/AD2	31	103	G1/4	M8x1	35.1	46.7
MS6-FRM-3/8-...-AD1/AD2			G3/8			
MS6-FRM-1/2-...-AD1/AD2			G1/2			
MS6-FRM-1/4-...-AD3/AD4	31	103	G1/4	M12x1	35.1	55.8
MS6-FRM-3/8-...-AD3/AD4			G3/8			
MS6-FRM-1/2-...-AD3/AD4			G1/2			

– † – Note: This product conforms with the ISO 1179-1 standard and the ISO 228-1 standard.

Dimensions – Pressure gauge alternatives

Pressure sensor with display AD5/AD6

Download CAD data → www.festo.com

Technical data → Internet: sde1

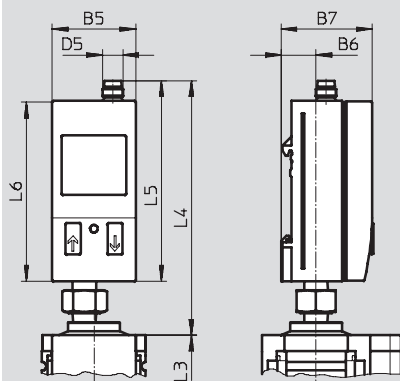

Variant AD5:
SDE1-D10-G2-H18-C-P1-M8 with
3-pin plug M8x1, 1 switch output
PNP

Variant AD6:
SDE1-D10-G2-W18-L-2I-M12 with
5-pin plug M12x1, 2 switch outputs
PNP and 4 ... 20 mA analogue

Type	B5	B6	B7	D5	L3	L4	L5	L6
MS4-FRM-...-AD5	32.3	13.5	35.2	M8	58	99	78	70
MS4-FRM-...-AD6				M12		108	87	
MS6-FRM-...-AD5	32.3	13.5	35.2	M8	84.5	94	78	70
MS6-FRM-...-AD6				M12		103	87	

Branching modules MS4/MS6-FRM, MS series

Technical data

FESTO

Dimensions – Pressure switch

Pressure switch with adjustable pressure switching point X/Y/M12



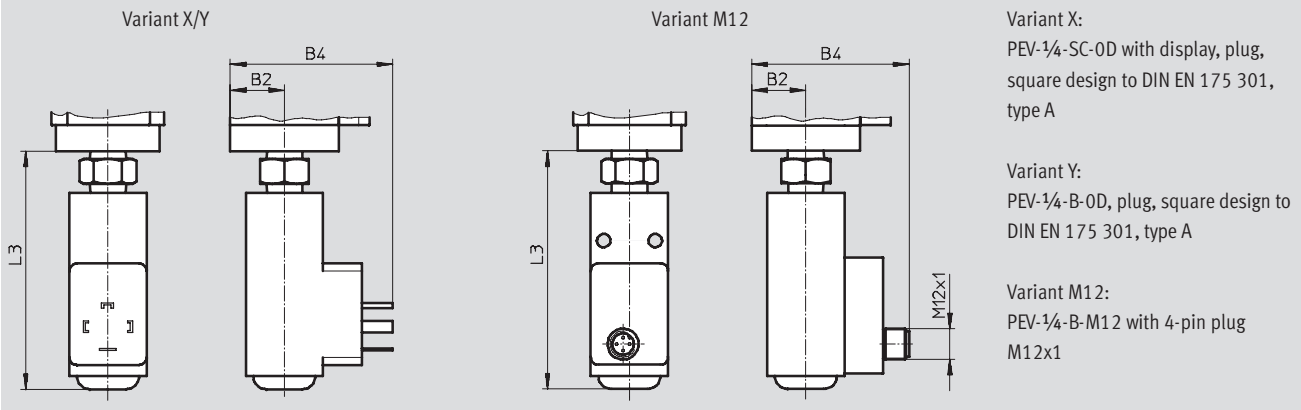

Download CAD data → www.festo.com

Technical data → Internet: pev-1/4



Type	B2	B4	L3
MS4-FRM-...-X/Y	21	63	92.3
MS4-FRM-...-M12	21	61	92.3
MS6-FRM-...-X/Y	31	73	99.5
MS6-FRM-...-M12	31	71	99.5

Ordering data

Size	Connection	Part No.	Type
Standard			
MS4	G1/8	529 559	MS4-FRM-1/8-1)
	G1/4	529 555	MS4-FRM-1/4-1)
MS6	G1/4	529 857	MS6-FRM-1/4-1)
	G3/8	529 861	MS6-FRM-3/8-1)
	G1/2	529 853	MS6-FRM-1/2-1)
With integrated non-return function			
MS4	G1/8	536 965	MS4-FRM-1/8-1 ¹)  New
	G1/4	536 966	MS4-FRM-1/4-1 ¹)  New
MS6	G1/4	536 967	MS6-FRM-1/4-1 ¹)  New
	G3/8	536 968	MS6-FRM-3/8-1 ¹)  New
	G1/2	536 969	MS6-FRM-1/2-1 ¹)  New
With pressure switch PEV-1/4-B-0D (variant Y)			
MS4	G1/8	529 560	MS4-FRM-1/8-Y ¹)
	G1/4	529 556	MS4-FRM-1/4-Y ¹)
MS6	G1/4	529 858	MS6-FRM-1/4-Y ¹)
	G3/8	529 862	MS6-FRM-3/8-Y ¹)
	G1/2	529 854	MS6-FRM-1/2-Y ¹)

1) Free of copper and PTFE

Branching modules MS4/MS6-FRM, MS series

Ordering data – Modular products

M **Mandatory data** →

Module No.	Series	Size	Function	Connection sizes
527 703 527 676	MS	4 6	FRM	1/8, 1/4, 3/8 > 1/2, AGA, AGB, AGC, AGD, AGE
Order example 527 676	MS	6	- FRM	- 3/8

Ordering table		Grid dimension	[mm]	40	62	Condi- tions	Code	Enter code
M	Module No.	527 703	527 676					
	Series	Standard					MS	MS
	Size	4	6				...	
	Function	Branching module					-FRM	-FRM
	Connection sizes	Thread G1/8	-				-1/8	
		Thread G1/4	Thread G1/4				-1/4	
		-	Thread G3/8				-3/8	
		-	Thread G1/2				-1/2	
		Connecting plate G1/8	-				-AGA	
		Connecting plate G1/4	Connecting plate G1/4				-AGB	
		Connecting plate G3/8	Connecting plate G3/8				-AGC	
		-	Connecting plate G1/2				-AGD	
	-	Connecting plate G3/4				-AGE		

Transfer order code

	MS		- FRM	
--	-----------	--	--------------	--

Branching modules MS4/MS6-FRM, MS series

Ordering data – Modular products

FESTO

Options					
Additional function	Pressure gauge alternatives	Alternative pressure gauge scale	Pressure switch	Type of mounting	Alternative flow direction
I	AG, A8, A4, RG, AD1, AD2, AD3, AD4, AD5, AD6	PSI MPA	X Y M12	WP WPM WB WBM	Z
-	- AG	- PSI	- M12	- WB	- Z

Ordering table						
Grid dimension	[mm]	40	62	Condi- tions	Code	Enter code
0	Additional function	With integrated non-return function		1	-I	
	Pressure gauge alternatives	MS pressure gauge, bar (with adapter)			-AG	
		Adapter plate for EN pressure gauge 1/8, without pressure gauge			-A8	
		Adapter plate for EN pressure gauge 1/4, without pressure gauge			-A4	
		Integrated pressure gauge, red-green scale			-RG	
		Pressure sensor with display, plug M8, 1 switch output PNP, 3-pin		2	-AD1	
		Pressure sensor with display, plug M8, 1 switch output NPN, 3-pin		2	-AD2	
		Pressure sensor with display, plug M12, 1 switch output PNP, 4-pin, analogue output 4 ... 20 mA		2	-AD3	
		Pressure sensor with display, plug M12, 1 switch output NPN, 4-pin, analogue output 4 ... 20 mA		2	-AD4	
		Pressure sensor with display, plug M8, 1 switch output PNP, 3-pin		2	-AD5	
		Pressure sensor with display, plug M12, 2 switch outputs PNP, 5-pin, analogue output 4 ... 20 mA		2	-AD6	
		Alternative pressure gauge scale	psi		3	-PSI
	MPa		3	-MPA		
	Pressure switch	Pressure switch PEV with display, socket, EN 175301, type A, cube		4	-X	
		Pressure switch PEV without display, socket, EN 175301, type A, cube		4	-Y	
		Pressure switch PEV without display, socket, round, M12, 4-pin		4	-M12	
	Type of mounting	Mounting bracket		5	-WP	
		Mounting bracket (for retro-fitting M-series)		5	-WPM	
		Mounting bracket			-WB	
		Mounting bracket			-WBM	
	Alternative flow direction	Flow direction from right to left			-Z	

- 1 I Not with pressure gauge alternatives AD5 or AD6
 2 AD1 ... AD6 Measuring range max. 10 bar
 3 PSI, MPA Only with pressure gauge alternatives AG or RG

- 4 X, Y, M12 Max. permissible input pressure P1 = 12 bar.
 Not with pressure gauge alternatives AD5 or AD6
 5 WP, WPM Only with connecting plate AGA, AGB, AGC, AGD or AGE

Transfer order code



- - - - - -

Distributor blocks MS4/MS6-FRM-FRZ, MS series

Technical data

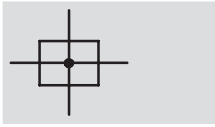
Function



-  - Flow rate
2,900 ... 14,600 l/min
-  - Temperature range
-10 ... +60 °C
-  - Operating pressure
0 ... 20 bar



- - Note

The distributor block MS4/6-FRM-FRZ has a half grid dimension width.

- Pneumatic manifold with 4 connections
- Outlet top and bottom
- Can be used as an intermediate distributor for varying air qualities
- Can be used as an intermediate distributor between two pressure regulators with large rotary knob with pressure gauge on size MS4

General technical data		
Size	MS4	MS6
Pneumatic connection 1, 2, 3, 4	G $\frac{1}{4}$	G $\frac{1}{2}$
Design	Branching module	
Type of mounting	Via accessories	
	In-line installation	
Assembly position	Any	

-  - Note: This product conforms with the ISO 1179-1 standard and the ISO 228-1 standard.

Standard nominal flow rate $q_{nN}^{1)}$ [l/min]		
Size	MS4	MS6
Pneumatic connection	G $\frac{1}{4}$	G $\frac{1}{2}$
In main flow direction 1 \rightarrow 2	4,050	14,600
Outlet at top	3,250	10,400
Outlet at bottom	2,900	9,850

1) Measured at $p_1 = 6$ bar and $p_2 = 5$ bar, $\Delta p = 1$ bar

Operating and environmental conditions		
Size	MS4	MS6
Operating pressure [bar]	0 ... 14	0 ... 20
Operating medium	Compressed air	
Ambient temperature [°C]	-10 ... +60	
Temperature of medium [°C]	-10 ... +60	
Storage temperature [°C]	-10 ... +60	
Corrosion resistance class CRC ¹⁾	2	

1) Corrosion resistance class 2 to Festo standard 940 070
Components subject to moderate corrosion stress. Externally visible parts with primarily decorative surface requirements which are in direct contact with a normal industrial environment or media such as coolants or lubricating agents.

Weight [g]		
Size	MS4	MS6
Distributor block	60	163

Distributor blocks MS4/MS6-FRM-FRZ, MS series

Technical data

Materials

Sectional view

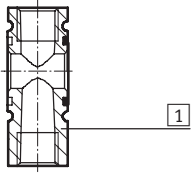

Distributor block		
1	Housing	Die-cast aluminium
Note on materials		Free of copper and PTFE

Dimensions

Download CAD data → www.festo.com

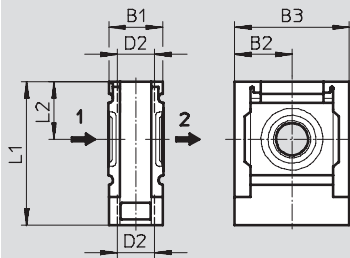

→ Flow direction

Type	B1	B2	B3	D2	L1	L2
MS4-FRM-FRZ	20	21	42	G $\frac{1}{4}$	52.5	21
MS6-FRM-FRZ	31	31	62	G $\frac{1}{2}$	76.5	31

- | - Note: This product conforms with the ISO 1179-1 standard and the ISO 228-1 standard.

Ordering data

Size	Connection	Part No.	Type
MS4	G $\frac{1}{4}$	549 336	MS4-FRM-FRZ¹⁾
MS6	G $\frac{1}{2}$	549 337	MS6-FRM-FRZ¹⁾

1) Free of copper and PTFE

Branching modules MS12-FRM, MS series

Peripherals overview

FESTO

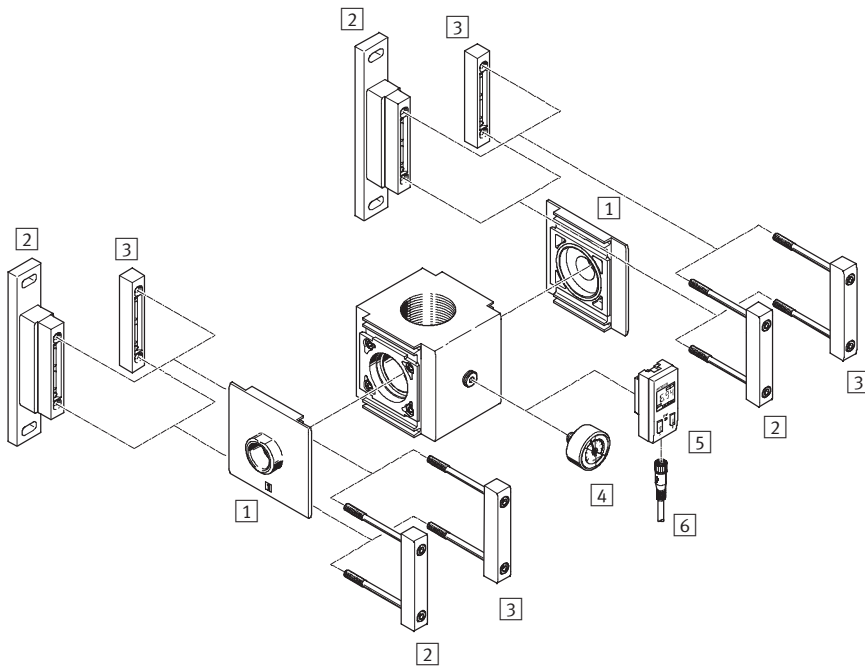

-  - Note
 Additional accessories:
 - Module connector for combination with size MS9 → Internet: armv

Mounting attachments and accessories		→ Page/Internet
1	Connecting plate MS12-AG...	ms12-ag
2	Mounting bracket MS12-WP	ms12-wp
3	Module connector MS12-MV	ms12-mv
4	Pressure gauge MA	25
5	Pressure sensor SDE1-...-R14/R18	25
6	Plug socket with cable SIM-M8-3.../SIM-M8-4.../SIM-M12-3...	sim

Branching modules MS12-FRM, MS series

Type codes

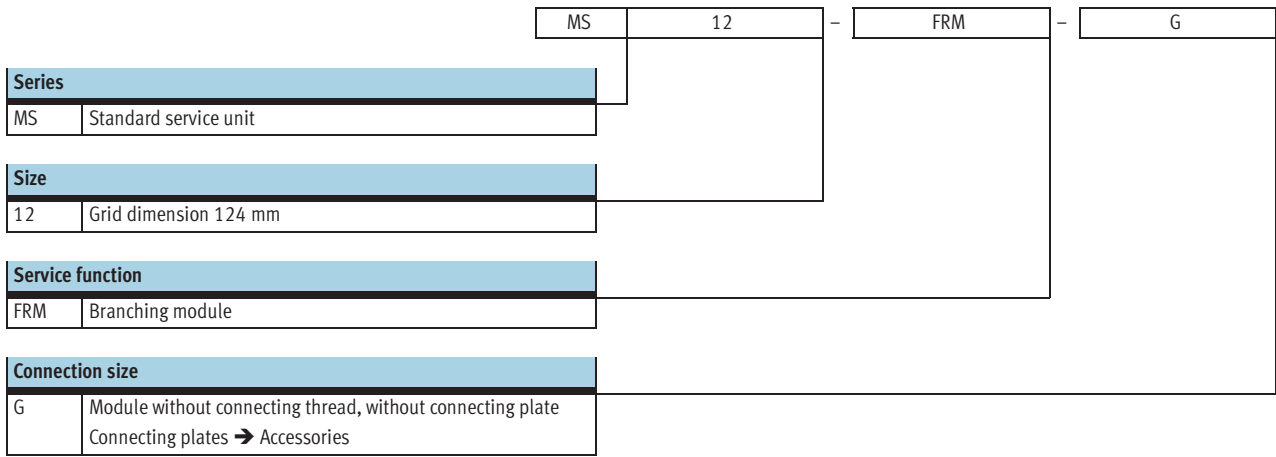

Further variants can be ordered using the modular system

Branching modules FRM → 24

- Connecting plates
- Type of mounting



Branching modules MS12-FRM, MS series

Technical data

FESTO

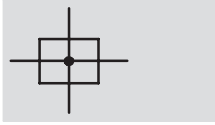
Function



-  - Flow rate
25,000 ... 42,000 l/min
-  - Temperature range
-10 ... +60 °C
-  - Operating pressure
0 ... 21 bar



- Pneumatic manifold with 4 connections
- Attachment facility for auxiliary modules
- Outlet top and bottom
- Can be used as an intermediate distributor for varying air qualities

General technical data

Pneumatic connection 1, 2 ¹⁾	G1	G1¼	G1½	G2
Pneumatic connection 3	G2			
Pneumatic connection 4	G1			
Design	Branching module			
Type of mounting	Via accessories			
	In-line installation			
Assembly position	Any			

- 1) Dependent on connecting plate selected, must be ordered separately as an accessory → Internet: ms12-ag
 -  Note: This product conforms with the ISO 1179-1 standard and the ISO 228-1 standard.

Standard nominal flow rate $q_{nN}^{1)}$ [l/min]

In main flow direction 1 → 2	25,000 ... 42,000
------------------------------	-------------------

- 1) Dependent on connecting plate selected, must be ordered separately as an accessory → Internet: ms12-ag
 Measured at $p_1 = 6$ bar and $p_2 = 5$ bar, $\Delta p = 1$ bar

Operating and environmental conditions

Operating pressure	[bar]	0 ... 21
Operating medium		Compressed air
Ambient temperature	[°C]	-10 ... +60
Temperature of medium	[°C]	-10 ... +60
Storage temperature	[°C]	-10 ... +60
Corrosion resistance	CRC ¹⁾	2

- 1) Corrosion resistance class 2 according to Festo standard 940 070
 Components requiring moderate corrosion resistance. Externally visible parts with primarily decorative surface requirements which are in direct contact with a normal industrial environment or media such as coolants or lubricating agents.

Branching modules MS12-FRM, MS series

Technical data

Weights [g]	
Branching module	3,000

Materials

Sectional view

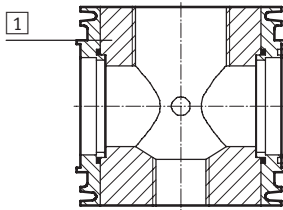

Branching module		
1	Body	Die-cast aluminium
-	Seals	Nitrile rubber
	Note on materials	Free of copper and PTFE

Dimensions – Standard

Download CAD data → www.festo.com

1) G $\frac{1}{4}$ Female thread in body, sealed with cover plate by default

→ Flow direction

Type	B1	B2	B3	D2	D3	D4	L1	L2
MS12-FRM	124	124	134	G2	G1	G $\frac{1}{4}$	122	61

-||- Note: This product conforms with the ISO 1179-1 standard and the ISO 228-1 standard.

Ordering data			
Size	Connection	Part No.	Type
MS12	G1 ... G2 ¹⁾	541 681	MS12-FRM-G²⁾

1) Connecting plate must be ordered separately as an accessory → Internet: ms12-ag

2) Free of copper and PTFE

-||- Note: This product conforms with the ISO 1179-1 standard and the ISO 228-1 standard.

Branching modules MS12-FRM, MS series

Ordering data – Modular products

M Mandatory data					O Options
Module No.	Series	Size	Function	Connection size	Type of mounting
535 035	MS	12	FRM	AGF AGG AGH AGI G	WP
Order example					
535 035	MS	12	- FRM	- AGF	- WP

Ordering table					
Grid dimension	[mm]	124	Condi- tions	Code	Enter code
M	Module No.	535 035			
	Series	Standard		MS	MS
	Size	12		12	12
	Function	Branching module		-FRM	-FRM
	Connection size	Connecting plate G1		-AGF	
		Connecting plate G1¼		-AGG	
		Connecting plate G1½		-AGH	
		Connecting plate G2		-AGI	
		Module without connecting thread, without connecting plate		-G	
O	Type of mounting	Mounting bracket	1	-WP	

1 WP Only with connecting plate AGF, AGG, AGH or AGI.

Transfer order code

535 035	MS	12	- FRM	-		-	
---------	----	----	-------	---	--	---	--

Branching modules/Distributor blocks MS-FRM, MS series

FESTO

Accessories

Ordering data – Pressure gauge MA					
	Nominal size	Pneumatic connection	Indicating range		Part No. Type
			[bar]	[psi]	
	Pressure gauge MA, DIN EN 837-1				Technical data → Internet: ma
	40	G $\frac{1}{4}$	0 ... 16	0 ... 232	183 901 MA-40-16-G $\frac{1}{4}$ -EN
	Pressure gauge MA, DIN EN 837-1, with red-green range				Technical data → Internet: ma
	40	R $\frac{1}{8}$	0 ... 16	–	525 726 MA-40-16-R $\frac{1}{8}$ -E-RG
	50	R $\frac{1}{4}$	0 ... 16	–	525 729 MA-50-16-R $\frac{1}{4}$ -E-RG

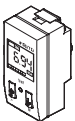
Ordering data – Pressure sensor SDE1					
	Pneumatic connection	Electrical output	Electrical connection	Display	Part No. Type
Pressure sensor SDE1 for direct mounting on the service unit with pressure gauge connection (adapter for pneumatic connection included in scope of delivery), pressure measuring range 0 ... 10 bar, relative pressure measurement					
	Male thread R $\frac{1}{8}$	1 switch output PNP	M8x1, 3-pin	LCD	192 026 SDE1-D10-G2-R18-C-P1-M8
			M8x1, 3-pin	Illuminated LCD	529 970 SDE1-D10-G2-R18-L-P1-M8
			M12x1, 3-pin	Illuminated LCD	534 064 SDE1-D10-G2-R18-L-P1-M12
		2 switch outputs PNP	M8x1, 4-pin	LCD	192 027 SDE1-D10-G2-R18-C-P2-M8
			M8x1, 4-pin	Illuminated LCD	529 971 SDE1-D10-G2-R18-L-P2-M8
			1 switch output PNP and 0 ... 10 V analogue	M8x1, 4-pin	LCD
	M8x1, 4-pin	Illuminated LCD		529 972 SDE1-D10-G2-R18-L-PU-M8	
	Male thread R $\frac{1}{4}$	1 switch output PNP	M8x1, 3-pin	LCD	192 028 SDE1-D10-G2-R14-C-P1-M8
			M8x1, 3-pin	Illuminated LCD	529 967 SDE1-D10-G2-R14-L-P1-M8
			M12x1, 3-pin	Illuminated LCD	534 157 SDE1-D10-G2-R14-L-P1-M12
		2 switch outputs PNP	M8x1, 4-pin	LCD	192 029 SDE1-D10-G2-R14-C-P2-M8
			M8x1, 4-pin	Illuminated LCD	529 968 SDE1-D10-G2-R14-L-P2-M8
1 switch output PNP and 0 ... 10 V analogue			M8x1, 4-pin	LCD	529 957 SDE1-D10-G2-R14-C-PU-M8
	M8x1, 4-pin	Illuminated LCD	529 969 SDE1-D10-G2-R14-L-PU-M8		

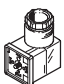
Ordering data – Angled socket PEV					
	Description	Operating voltage range	Electrical connection	Switching status display	Part No. Type
	for PEV- $\frac{1}{4}$ -...-OD	15 ... 30 V DC	4-pin	Yellow LED	164 274 PEV- $\frac{1}{4}$ -WD-LED-24
		≤ 230 V AC	4-pin	Yellow LED	164 275 PEV- $\frac{1}{4}$ -WD-LED-230
		≤ 180 V DC			

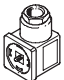
Ordering data – Plug socket MSSD					
	Description	Operating voltage range	Electrical connection	Type of mounting cable connection	Part No. Type
	for PEV- $\frac{1}{4}$ -...-OD	≤ 250 V AC/DC	3-pin	Clamping screws	171 157 MSSD-C-4P

Ordering data – Double nipple ESK					
	Description	Pneumatic connection		Part No. Type	
	Adjustable for angular compensation • For retro-fitting pressure switch PEV or pressure sensor SDE1 to branching module MS-FRM	R $\frac{1}{8}$	R $\frac{1}{4}$	534 151 ESK- $\frac{1}{8}$ - $\frac{1}{4}$	
		R $\frac{1}{4}$	R $\frac{1}{4}$	151 521 ESK- $\frac{1}{4}$ - $\frac{1}{4}$	
			R $\frac{1}{2}$	534 153 ESK- $\frac{1}{4}$ - $\frac{1}{2}$	