

Limit Valve

with Ball Actuator, Spring Return

Type SVK-3-PK-3

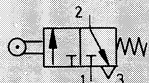

These valves are used as limit switches and end stops to produce a position-dependent signal.

They are particularly suitable for end-position sensing and position control where a high degree of accuracy is required.

The valve has a movable stem with a seal, which is actuated by the ball.

The permissible impact force (when the valve is used as a fixed stop) must not be exceeded.

Accessory:

(Order separately)

Mounting Block, Type SDA-12 x 1-B
Order No. 11541

Example:

Type SVK-3-PK-3

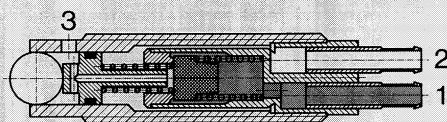

Type SVK-3-PK-3

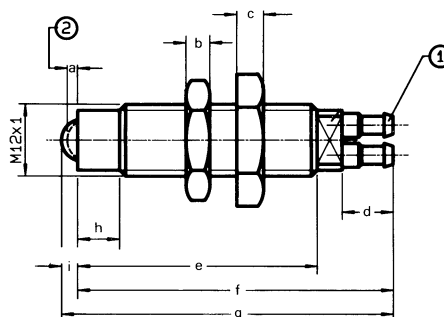

- ① Barbed fittings for 3 mm plastic tubing
- ② Switching point

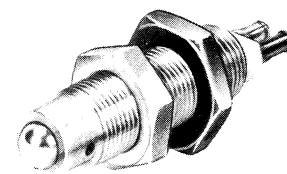

Dimensions

- a 0.07 in / 1.7 mm
- b 0.16 in / 4 mm
- c 0.18 in / 4.5 mm
- d 0.33 in / 8.5 mm
- e 1.57 in / 40 mm
- f 2.07 in / 52.7 mm
- g 2.18 in / 55.38 mm
- h 0.28 in / 7 mm
- i 0.10 in / 2.68 mm

- 1 (P) = Supply
- 2 (A) = Working or outlet Port
- 3 (R) = Exhaust

Type SDA-12 x 1-B

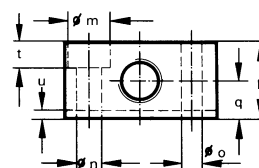
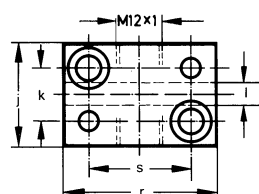

Dimensions

- j 1.06 in / 27 mm
- k 0.55 in / 14 mm
- l 0.24 in / 6 mm
- m 0.43 in / 11 mm
- n 0.26 in / 6.6 mm
- o 0.23 in / 5.8 mm
- p 0.79 in / 20 mm
- q 0.39 in / 10 mm
- r 1.57 in / 40 mm
- s 1.06 in / 27 mm
- t 0.27 in / 6.8 mm
- u 0.08 in / 2 mm

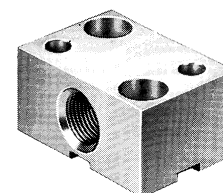

Permissible impact force

Type	Threaded into SDA and secured by lock nut ($v < 0.39$ in/s / 10 mm/s)	Through-hole with 2 mounting nuts ($v < 0.39$ in/s / 10 mm/s)
SVK-3-PK-3	1010 lbf / 4500 N	450 lbf / 2000 N

Order Number	Valve	12146 SVK-3-PK-3
Part No./Type	Mounting Block	11541 SDA-12 x 1-B
Medium		Compressed air (filtered, lubricated or unlubricated)
Design		Seat valve, non-crossing
Mounting		M 12 x 1 with mounting nuts
Mounting Clearance Hole Diameter		0.5 in / 12.5 mm
Connection		Barbed fittings for 3 mm tubing
Orifice Size		0.06 in / 1.5 mm
C_v Factor		0.050 C_v / 50 l/min
Pressure Range*		28.5 in Hg to 120 psi / -0.9 to +8 bar
End Stop Accuracy		± 0.001 in / 0.03 mm
Actuating Force at 90 psi / 6 bar		4.49 lbf / 20 N
Material		Stainless steel. Seals: Buna N.
Weight	Valve	0.242 lb / 0.110 kg
	Mounting Block	0.397 lb / 0.180 kg

* 14 to +176°F / -10 to +80°C, depending on tubing temperature range.