

Compressed Air Hose Type P-...



Pressure Range*		0 to 150 psi / 0 to 10 bar				
Temperature Range		-4 to 176°F / -20 to +80°C				
Tubing Color		Blue				
Order Number		I.D.	O.D.	Min. Allowable Radius	Material	Weight
Part No.	Type	in / mm	in / mm			lb/ft / kg/m
2231	P-6	0.24 / 6	0.51 / 13	1.51 / 40	Buna N	0.097 / 0.145
2232	P-9	0.35 / 9	0.63 / 16	1.97 / 50	Buna N with steel cord	0.124 / 0.185
2234	P-13	0.51 / 13	0.94 / 24	3.94 / 100		0.267 / 0.400
2235	P-19	0.75 / 19	1.18 / 30	7.87 / 200		0.483 / 0.719

Compressed Air Hose Type PC-...



Pressure Range*		0 to 150 psi / 0 to 10 bar			
Temperature Range		14 to 95°F / -10 to +35°C			
Tubing Color		Blue			
Order Number		I.D.	O.D.	Material	Weight
Part No.	Type	in / mm	in / mm		lb/ft / kg/m
5030	PC-6	0.24 / 6	0.47 / 12	PVC with fabric	0.097 / 0.144
5031	PC-9	0.35 / 9	0.59 / 15		0.093 / 0.139

*The max. pressure is permitted at the max. temperature.

Barbed Fitting - Male Type N-... with sealing ring

Brass Design
Type N-...-MS

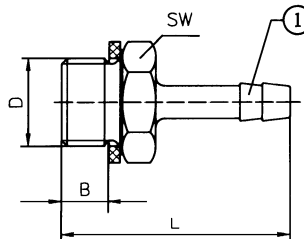

SW = wrench size (mm)

① Barbed fitting for plastic tubing

Order Number		For Tubing I.D. in / mm	Thread D	Orifice Size in / mm	Material	Weight lb / kg	Dimensions		
Part No.	Type						B in / mm	L in / mm	SW mm
3605	N-1/8-P-6	0.24 / 6	G 1/8 ISO	0.18 / 4.5	Al, blue anodized	0.031 / 0.014	0.20 / 5	1.42 / 36	13
3606	N-1/4-P-6	0.24 / 6	G 1/4 ISO	0.18 / 4.5		0.046 / 0.021	0.26 / 6.5	1.50 / 38	17
3607	N-1/4-P-9	0.35 / 9	G 1/4 ISO	0.26 / 6.5		0.053 / 0.024	0.26 / 6.5	1.50 / 38	17
3608	N-3/8-P-6	0.24 / 6	G 3/8 ISO	0.18 / 4.5		0.075 / 0.034	0.33 / 8.5	1.61 / 41	19
3609	N-3/8-P-9	0.35 / 9	G 3/8 ISO	0.31 / 8		0.068 / 0.031	0.33 / 8.5	1.61 / 41	19
36160	N-3/8-P-13	0.51 / 13	G 3/8 ISO	0.43 / 11		0.077 / 0.035	0.33 / 8.5	1.85 / 46.9	19
3610	N-1/2-P-9	0.35 / 9	G 1/2 ISO	0.31 / 8		0.134 / 0.061	0.45 / 11.5	1.73 / 43.9	24
3611	N-1/2-P-13	0.51 / 13	G 1/2 ISO	0.43 / 11		0.139 / 0.063	0.45 / 11.5	1.96 / 49.9	24
3612	N-3/4-P-13	0.51 / 13	G 3/4 ISO	0.43 / 11		0.249 / 0.113	0.47 / 12	2.06 / 52.4	32
3613	N-3/4-P-19	0.75 / 19	G 3/4 ISO	0.63 / 16		0.257 / 0.117	0.47 / 12	2.30 / 58.4	32

Order Number		For Tubing I.D. in / mm	Thread D	Orifice Size in / mm	Material	Weight lb / kg	Dimensions		
Part No.	Type						B in / mm	L in / mm	SW mm
15630	N-1/8-P-6-MS	0.24 / 6	G 1/8 ISO	0.18 / 4.5	Brass	0.022 / 0.010	0.20 / 5	1.42 / 36	13
15631	N-1/4-P-6-MS	0.24 / 6	G 1/4 ISO	0.18 / 4.5		0.033 / 0.015	0.26 / 6.5	1.50 / 38	17
15632	N-1/4-P-9-MS	0.35 / 9	G 1/4 ISO	0.26 / 6.5		0.044 / 0.020	0.26 / 6.5	1.50 / 38	17
15633	N-3/8-P-6-MS	0.24 / 6	G 3/8 ISO	0.18 / 4.5		0.066 / 0.030	0.33 / 8.5	1.61 / 41	19
15634	N-3/8-P-9-MS	0.35 / 9	G 3/8 ISO	0.30 / 7.6		0.077 / 0.035	0.33 / 8.5	1.61 / 41	19
36161	N-3/8-P-13-MS	0.51 / 13	G 3/8 ISO	0.43 / 11		0.088 / 0.040	0.33 / 8.5	1.85 / 46.9	19
15635	N-1/2-P-9-MS	0.35 / 9	G 1/2 ISO	0.31 / 8.0		0.110 / 0.050	0.45 / 11.5	1.73 / 43.9	24
15636	N-1/2-P-13-MS	0.51 / 13	G 1/2 ISO	0.43 / 11		0.121 / 0.055	0.45 / 11.5	1.96 / 49.9	24
15637	N-3/4-P-13-MS	0.51 / 13	G 3/4 ISO	0.43 / 11		0.220 / 0.100	0.47 / 12	2.06 / 52.4	32
15638	N-3/4-P-19-MS	0.75 / 19	G 3/4 ISO	0.65 / 16.5		0.231 / 0.105	0.47 / 12	2.30 / 58.4	32