

Adapter Type AD-...

With NPT Thread Male and ISO Thread Female

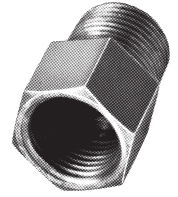
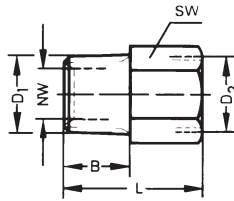

SW = wrench size (mm)

Order Number		Connection		Material	Weight lb / kg	Dimensions			
Part No.	Type	D ₁ Male	D ₂ Female			B in / mm	L in / mm	NW in / mm	SW in / mm
9624	AD-1/8 NPT-R1/8 I	1/8 NPT	G 1/8 ISO	Zinc plated steel with sealing ring	0.020 / 0.009	0.35 / 9	0.79 / 20	0.23 / 6	1/2 / 12.7
9625	AD-1/4 NPT-R1/4 I	1/4 NPT	G 1/4 ISO		0.048 / 0.022	0.5 / 13	1.05 / 27	0.3 / 8	11/16 / 17
9626	AD-3/8 NPT-R3/8 I	3/8 NPT	G 3/8 ISO		0.050 / 0.023	0.56 / 14.5	1.2 / 30.5	0.45 / 11.5	3/4 / 19
9627	AD-1/2 NPT-R1/2 I	1/2 NPT	G 1/2 ISO		0.100 / 0.047	0.7 / 12.5	1.44 / 36.5	0.56 / 14.3	15/16 / 24
546551	AD-3/4 NPT-R3/4-I-SA	3/4 NPT	G 3/4 ISO		0.33 / 0.150	0.7 / 18	1.68 / 43	0.75 / 19	17/16 / 36
546547	AD-1 NPT-R1-I-SA	1 NPT	G 1 ISO		—	—	—	—	—

Adapter Type AD-...

With ISO Thread Male and NPT Thread Female

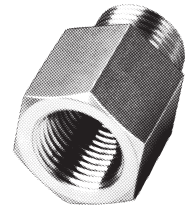
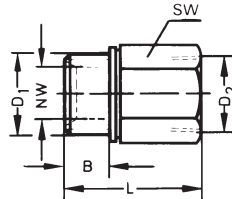

SW = wrench size (mm)

Order Number		Connection		Material	Weight lb / kg	Dimensions			
Part No.	Type	D ₁ Male	D ₂ Female			B in / mm	L in / mm	NW in / mm	SW in / mm
9395	AD-R1/8-1/8 NPT I	G 1/8 ISO	1/8 NPT	Zinc plated steel with sealing ring	0.022 / 0.010	0.19 / 5	0.81 / 20.5	0.23 / 6	1/2 / 12.7
9396	AD-R1/4-1/4 NPT I	G 1/4 ISO	1/4 NPT		0.052 / 0.024	0.25 / 6.5	1.04 / 26.5	0.3 / 8	11/16 / 17
9397	AD-R3/8-3/8 NPT I	G 3/8 ISO	3/8 NPT		0.052 / 0.024	0.33 / 8.5	1.10 / 28	0.45 / 11.5	3/4 / 19
9398	AD-R1/2-1/2 NPT I	G 1/2 ISO	1/2 NPT		0.108 / 0.049	0.45 / 11.5	1.41 / 36	0.56 / 14.5	15/16 / 24
546550	AD-R3/4-3/4NPT-I-SA	G 3/4 ISO	3/4 NPT		0.310 / 0.140	0.55 / 14	1.48 / 38	0.7 / 12.5	17/16 / 36
546546	AD-R1-1NPT-I-SA	G 1 ISO	1 NPT		0.420 / 0.190	0.63 / 16	1.71 / 44	0.95 / 24	15/8 / 41
215999	AD-1/8-1/8-NPT-I	G 1/8 ISO	1/8 NPT	Plastic	—	0.19 / 5	0.81 / 20.5	0.23 / 6	1/2 / 12.7
216000	AD-1/4-1/4-NPT-I	G 1/4 ISO	1/4 NPT		—	0.25 / 6.5	1.04 / 26.5	0.3 / 8	11/16 / 17

Hex Nipple Type E-...

Adapter Nipple
With ISO and NPT Thread

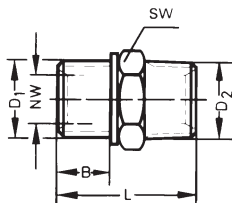

SW = wrench size (mm)

Order Number		Connection		Material	Weight lb / kg	Dimensions			
Part No.	Type	D ₁ Male	D ₂ Male			B in / mm	L in / mm	NW in / mm	SW in / mm
9630	E-R1/8-1/8 NPT I	G 1/8 ISO	1/8 NPT	Zinc plated steel with sealing ring	0.022 / 0.010	0.19 / 5	0.81 / 20.5	0.23 / 6	1/2 / 12.7
9631	E-R1/4-1/4 NPT I	G 1/4 ISO	1/4 NPT		0.044 / 0.020	0.25 / 6.5	1.03 / 26.5	0.3 / 7	11/16 / 17
9632	E-R3/8-3/8 NPT I	G 3/8 ISO	3/8 NPT		0.052 / 0.024	0.33 / 8.5	1.18 / 30	0.45 / 11.5	3/4 / 19
9633	E-R1/2-1/2 NPT I	G 1/2 ISO	1/2 NPT		0.103 / 0.047	0.45 / 11.5	1.42 / 36.5	0.56 / 14.5	15/16 / 24
546549	E-R3/4-3/4 NPT-SA	G 3/4 ISO	3/4 NPT		1.664 / 0.755	0.55 / 14	1.85 / 47	0.7 / 17.5	17/16 / 36