

# Coalescing Microfilter, Type LFMA

1/8" to 1" NPT, G 1/8 to G 1 ISO, INCH and Metric Series

## Coalescing Microfilter

0.01 micron average pore size

with Metal Bowl Guard  
with manual bowl drain

Type LFMA-...-D-...(-NPT)

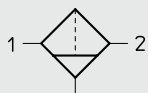

with integrated, automatic bowl drain

Type LFMA-...-D-...-A(-NPT)

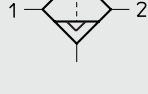

### Accessories:

Mounting brackets, Type HFOE-...  
(see page 67)

Replacement filter cartridge,  
Type LFMAP-D-... (see page 67)

Threaded bolt set, Type FRB-... used to  
combine the Microfilter with another D-Series  
unit (see page 66).

Type LFMA-...-D-...(-NPT)  
LFMA-...-D-...-A(-NPT)

Various branches of industry often require finely or very finely filtered air: chemical, pharmaceutical, process engineering, food processing, etc. In addition, finely and very finely filtered air is also required for low pressure controls.

Festo fine filters and microfilters remove almost all of even the smallest water and oil droplets as well as dirt particles from the compressed air. In this way, the compressed air is filtered to at least 99.999% (99.9999% when a microfilter is used).

To prevent the oil-water emulsion which collects in the foam jacket from being recombined with the compressed air, the flow rate recommended for the units should be observed.

When fine filters and microfilters are used, the compressed air should be pre-filtered (5 micron) to increase the service life of the borosilicate filter cartridge.



| Order Number<br>Part No. / Type    | Microfilter 0.01 micron<br>Manual bowl drain                                 | NPT | With Threaded Connection Plate      |                                     |                                     |                                     |                                     |                                     | 173736                              | 173738                            |
|------------------------------------|--|-----|-------------------------------------|-------------------------------------|-------------------------------------|-------------------------------------|-------------------------------------|-------------------------------------|-------------------------------------|-----------------------------------|
|                                    |  |     | 173724<br>LFMA-1/8-D-<br>MINI-NPT   | 173726<br>LFMA-1/4-D-<br>MINI-NPT   | 173728<br>LFMA-3/8-D-<br>MINI-NPT   | 173730<br>LFMA-3/8-D-<br>MIDI-NPT   | 173732<br>LFMA-1/2-D-<br>MIDI-NPT   | 173734<br>LFMA-3/4-D-<br>MIDI-NPT   |                                     |                                   |
|                                    |  | ISO | 162642<br>LFMA-1/8-D-<br>MINI       | 162643<br>LFMA-1/4-D-<br>MINI       | 162644<br>LFMA-3/8-D-<br>MINI       | 162645<br>LFMA-3/8-D-<br>MIDI       | 162646<br>LFMA-1/2-D-<br>MIDI       | 162647<br>LFMA-3/4-D-<br>MIDI       | 162648<br>LFMA-3/4-D-<br>MAXI       | 162649<br>LFMA-1-D-<br>MAXI       |
|                                    | Microfilter 0.01 micron<br>Automatic bowl drain                              | NPT | 173723<br>LFMA-1/8-D-<br>MINI-A-NPT | 173727<br>LFMA-1/4-D-<br>MINI-A-NPT | 173729<br>LFMA-3/8-D-<br>MINI-A-NPT | 173731<br>LFMA-3/8-D-<br>MIDI-A-NPT | 173733<br>LFMA-1/2-D-<br>MIDI-A-NPT | 173735<br>LFMA-3/4-D-<br>MIDI-A-NPT | 173737<br>LFMA-3/4-D-<br>MAXI-A-NPT | 173739<br>LFMA-1-D-<br>MAXI-A-NPT |
|                                    |  | ISO | 162650<br>LFMA-1/8-D-<br>MINI-A     | 162651<br>LFMA-1/4-D-<br>MINI-A     | 162652<br>LFMA-3/8-D-<br>MINI-A     | 162653<br>LFMA-3/8-D-<br>MIDI-A     | 162654<br>LFMA-1/2-D-<br>MIDI-A     | 162655<br>LFMA-3/4-D-<br>MIDI-A     | 162656<br>LFMA-3/4-D-<br>MAXI-A     | 162657<br>LFMA-1-D-<br>MAXI-A     |
| Medium                             | Prefiltered, compressed air  |     |                                     |                                     |                                     |                                     |                                     |                                     |                                     |                                   |
| Design                             | Filter with Borosilicate filter material                                     |     |                                     |                                     |                                     |                                     |                                     |                                     |                                     |                                   |
| Mounting                           | In-line assembly or mounting brackets  |     |                                     |                                     |                                     |                                     |                                     |                                     |                                     |                                   |
| Assembly Position                  | Vertical ± 5°  |     |                                     |                                     |                                     |                                     |                                     |                                     |                                     |                                   |
| Connection                         |  |     | 1/8 NPT /<br>G 1/8 ISO              | 1/4 NPT /<br>G 1/4 ISO              | 3/8 NPT /<br>G 3/8 ISO              | 3/8 NPT /<br>G 3/8 ISO              | 1/2 NPT /<br>G 1/2 ISO              | 3/4 NPT /<br>G 3/4 ISO              | 3/4 NPT /<br>G 3/4 ISO              | 1 NPT /<br>G 1 ISO                |
| Nominal Flow*                      |  |     | 4.59 scfm /<br>130 l/min            | 6.65 scfm /<br>160 l/min            | 6.36 scfm /<br>180 l/min            | 13.42 scfm /<br>380 l/min           | 14.12 scfm /<br>400 l/min           | 16.24 scfm /<br>460 l/min           | 31.78 scfm /<br>900 l/min           | 33.54 scfm /<br>950 l/min         |
| Filter Pore Size                   | micron   |     | 0.01                                |                                     |                                     |                                     |                                     |                                     |                                     |                                   |
| Residual Oil Concentration         | [mg/m <sup>3</sup> ]   |     | ≤0.01                               |                                     |                                     |                                     |                                     |                                     |                                     |                                   |
| Filter Efficiency                  | [%]  |     | 99.9999                             |                                     |                                     |                                     |                                     |                                     |                                     |                                   |
| Air Purity Class<br>per ISO 8573-1 | Particle   |     | 1                                   |                                     |                                     |                                     |                                     |                                     |                                     |                                   |
|                                    | Oil Aerosol  |     | 2                                   |                                     |                                     |                                     |                                     |                                     |                                     |                                   |
| Condensate Capacity                |  |     | 13 cu in / 22 ml                    |                                     |                                     | 26 cu in / 43 ml                    |                                     | 49 cu in / 80 ml                    |                                     |                                   |
| Primary Pressure Range             | Manual Bowl Drain  |     | 232 psi / max. 16 bar               |                                     |                                     |                                     |                                     |                                     |                                     |                                   |
|                                    | Automatic Bowl Drain**   |     | 22 to 180 psi / 1.5 to 12 bar       |                                     |                                     |                                     |                                     |                                     |                                     |                                   |
| Temperature Range                  | Medium   |     | 35 to 140°F / +1.5 to +60°C         |                                     |                                     |                                     |                                     |                                     |                                     |                                   |
|                                    | Ambient  |     | 14 to 140°F / -10 to +60°C          |                                     |                                     |                                     |                                     |                                     |                                     |                                   |
| Material                           | Housing: GD-Zn; Seals: NBR; Filter bowl: Polycarbonate; Metal bowl guard: Al |     |                                     |                                     |                                     |                                     |                                     |                                     |                                     |                                   |
| Weight                             |  |     | 0.551 lb /<br>0.250 kg              |                                     |                                     | 1.433 lb /<br>0.650 kg              |                                     | 2.425 lb /<br>1.100 kg              |                                     | 2.646 lb /<br>1.200 kg            |

Delivery: Short lead time

\* At upstream pressure of 90 psi / 6 bar and Δ p = 1.05 psi / 0.07 bar.

\*\* A minimum flow of 4 scfm / 125 l/min is required for the proper result.

# Coalescing Fine Filter, Type LFMB

1/8" to 1" NPT, G 1/8 to G 1 ISO, INCH and Metric Series

## Coalescing Fine Filter

1 micron

with Metal Bowl Guard  
with manual bowl drain

Type LFMB-...-D-...(-NPT)

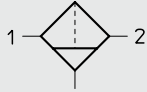

with integrated, automatic bowl drain  
Type LFMB-...-D-...-A(-NPT)

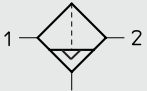

### Accessories:

Mounting brackets, Type HFOE-...  
(see page 67)

Replacement filter cartridge,  
Type LFMBP-D-... (see page 67)

Threaded bolt set, Type FRB-... used to  
combine the Fine Filter with another D-Series  
unit (see page 66).

Type LFMB-...-D-...(-NPT)  
LFMB-...-D-...-A(-NPT)

Various branches of industry often require finely or very finely filtered air: chemical, pharmaceutical, process engineering, food processing, etc. In addition, finely and very finely filtered air is also required for low pressure controls.

Festo fine filters and microfilters remove almost all of even the smallest water and oil droplets as well as dirt particles from the compressed air. In this way, the compressed air is filtered to at least 99.999% (99.9999% when a microfilter is used).

To prevent the oil-water emulsion which collects in the foam jacket from being recombined with the compressed air, the flow rate recommended for the units should be observed.

When fine filters and microfilters are used, the compressed air should be pre-filtered (5 micron) to increase the service life of the borosilicate filter cartridge.



| Order Number<br>Part No. / Type    | Microfilter 1 micron<br>Manual bowl drain                                    | NPT                           | With Threaded Connection Plate      |                                     |                                     |                                     |                                     |                                     |                                     |                                   |
|------------------------------------|--|-------------------------------|-------------------------------------|-------------------------------------|-------------------------------------|-------------------------------------|-------------------------------------|-------------------------------------|-------------------------------------|-----------------------------------|
|                                    |  |                               | 173708<br>LFMB-1/8-D-<br>MINI-NPT   | 173710<br>LFMB-1/4-D-<br>MINI-NPT   | 173712<br>LFMB-3/8-D-<br>MINI-NPT   | 173714<br>LFMB-3/8-D-<br>MIDI-NPT   | 173716<br>LFMB-1/2-D-<br>MIDI-NPT   | 173718<br>LFMB-3/4-D-<br>MIDI-NPT   | 173720<br>LFMB-3/4-D-<br>MAXI-NPT   | 173722<br>LFMB-1-D-<br>MAXI-NPT   |
|                                    |  | ISO                           | 162626<br>LFMB-1/8-D-<br>MINI       | 162627<br>LFMB-1/4-D-<br>MINI       | 162628<br>LFMB-3/8-D-<br>MINI       | 162629<br>LFMB-3/8-D-<br>MIDI       | 162630<br>LFMB-1/2-D-<br>MIDI       | 162631<br>LFMB-3/4-D-<br>MIDI       | 162632<br>LFMB-3/4-D-<br>MAXI       | 162633<br>LFMB-1-D-<br>MAXI       |
|                                    | Microfilter 1 micron<br>Automatic bowl drain                                 | NPT                           | 173709<br>LFMB-1/8-D-<br>MINI-A-NPT | 173711<br>LFMB-1/4-D-<br>MINI-A-NPT | 173713<br>LFMB-3/8-D-<br>MINI-A-NPT | 173715<br>LFMB-3/8-D-<br>MIDI-A-NPT | 173717<br>LFMB-1/2-D-<br>MIDI-A-NPT | 173719<br>LFMB-3/4-D-<br>MIDI-A-NPT | 173721<br>LFMB-3/4-D-<br>MAXI-A-NPT | 173723<br>LFMB-1-D-<br>MAXI-A-NPT |
|                                    |  | ISO                           | 162634<br>LFMB-1/8-D-<br>MINI-A     | 162635<br>LFMB-1/4-D-<br>MINI-A     | 162636<br>LFMB-3/8-D-<br>MINI-A     | 162637<br>LFMB-3/8-D-<br>MIDI-A     | 162638<br>LFMB-1/2-D-<br>MIDI-A     | 162639<br>LFMB-3/4-D-<br>MIDI-A     | 162640<br>LFMB-3/4-D-<br>MAXI-A     | 162641<br>LFMB-1-D-<br>MAXI-A     |
| Medium                             | Prefiltered, compressed air  |                               |                                     |                                     |                                     |                                     |                                     |                                     |                                     |                                   |
| Design                             | Filter with Borosilicate filter material                                     |                               |                                     |                                     |                                     |                                     |                                     |                                     |                                     |                                   |
| Mounting                           | In-line assembly or mounting brackets  |                               |                                     |                                     |                                     |                                     |                                     |                                     |                                     |                                   |
| Assembly Position                  | Vertical ± 5°  |                               |                                     |                                     |                                     |                                     |                                     |                                     |                                     |                                   |
| Connection                         |  |                               | 1/8 NPT /<br>G 1/8 ISO              | 1/4 NPT /<br>G 1/4 ISO              | 3/8 NPT /<br>G 3/8 ISO              | 3/8 NPT /<br>G 3/8 ISO              | 1/2 NPT /<br>G 1/2 ISO              | 3/4 NPT /<br>G 3/4 ISO              | 3/4 NPT /<br>G 3/4 ISO              | 1 NPT /<br>G 1 ISO                |
| Nominal Flow*                      |  |                               | 8.83 scfm /<br>250 l/min            | 10.59 scfm /<br>300 l/min           | 10.95 scfm /<br>310 l/min           | 24.72 scfm /<br>700 l/min           | 31.78 scfm /<br>900 l/min           | 35.31 scfm /<br>1000 l/min          | 42.39 scfm /<br>1200 l/min          | 44.14 scfm /<br>1250 l/min        |
| Filter Pore Size                   | micron   | 1                             |                                     |                                     |                                     |                                     |                                     |                                     |                                     |                                   |
| Residual Oil Concentration         | [mg/m <sup>3</sup> ]   | ≤0.05                         |                                     |                                     |                                     |                                     |                                     |                                     |                                     |                                   |
| Filter Efficiency                  | [%]  | 99.99                         |                                     |                                     |                                     |                                     |                                     |                                     |                                     |                                   |
| Air Purity Class<br>per ISO 8573-1 | Particle   | 2                             |                                     |                                     |                                     |                                     |                                     |                                     |                                     |                                   |
|                                    | Oil Aerosol  | 3                             |                                     |                                     |                                     |                                     |                                     |                                     |                                     |                                   |
| Condensate Capacity                |  |                               | 13 cu in / 22 ml                    |                                     |                                     | 26 cu in / 43 ml                    |                                     | 49 cu in / 80 ml                    |                                     |                                   |
| Primary Pressure Range             | Manual Bowl Drain  | 232 psi / max. 16 bar         |                                     |                                     |                                     |                                     |                                     |                                     |                                     |                                   |
|                                    | Automatic Bowl Drain**   | 22 to 180 psi / 1.5 to 12 bar |                                     |                                     |                                     |                                     |                                     |                                     |                                     |                                   |
| Temperature Range                  | Medium   | 35 to 140°F / +1.5 to +60°C   |                                     |                                     |                                     |                                     |                                     |                                     |                                     |                                   |
|                                    | Ambient  | 14 to 140°F / -10 to +60°C    |                                     |                                     |                                     |                                     |                                     |                                     |                                     |                                   |
| Material                           | Housing: GD-Zn; Seals: NBR; Filter bowl: Polycarbonate; Metal bowl guard: Al |                               |                                     |                                     |                                     |                                     |                                     |                                     |                                     |                                   |
| Weight                             |  |                               | 0.551 lb /<br>0.250 kg              |                                     | 1.433 lb /<br>0.650 kg              |                                     |                                     | 2.425 lb /<br>1.100 kg              |                                     | 2.646 lb /<br>1.200 kg            |

Delivery: Short lead time

\* At upstream pressure of 90 psi / 6 bar and Δ p = 1.05 psi / 0.07 bar.

\*\* A minimum flow of 4 scfm / 125 l/min is required for the proper result.

# Micro and Fine Filters, Types LFMA, LFMB

## Dimensions, INCH and Metric Series

Type LFMA-...-D-...  
LFMB-...-D-...

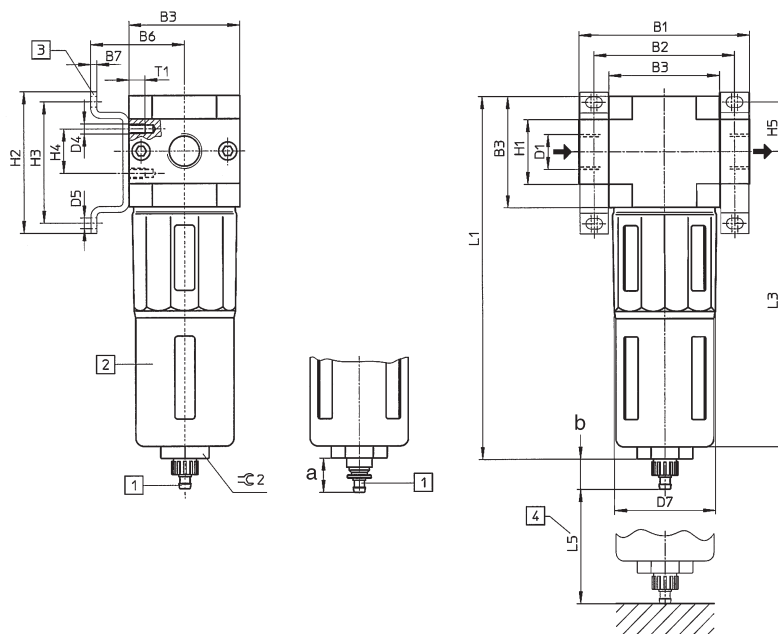

- 1 Drain connector for plastic tubing (Order number 7134 PCN-4)
  - 2 Metal bowl guard
  - 3 Mounting brackets Type HFOE (order separately)
  - 4 Clearance required to remove bowl for servicing
- ➔ Flow direction

### Dimensions

- a 0.59 in / 15 mm
- b 0.67 in / 17 mm

| Type<br>Inch and<br>Metric Series | B1<br>in / mm | B2<br>in / mm | B3<br>in / mm | B6<br>in / mm | B7<br>in / mm | D1<br>Inch / Metric | D4            | D5<br>dia<br>in / mm | D7<br>dia<br>in / mm |     |
|-----------------------------------|---------------|---------------|---------------|---------------|---------------|---------------------|---------------|----------------------|----------------------|-----|
| LFMA/B-1/8-D-MINI(A)              | 2.52 / 64     | 2.05 / 52     | 1.57 / 40     | 1.54 / 39     | 0.08 / 2      | 1/8 NPT / G 1/8 ISO | M4            | 0.17 / 4.3           | 1.50 / 38            |     |
| LFMA/B-1/4-D-MINI(A)              | 2.52 / 64     | 2.05 / 52     | 1.57 / 40     | 1.54 / 39     | 0.08 / 2      | 1/4 NPT / G 1/4 ISO | M4            | 0.17 / 4.3           | 1.50 / 38            |     |
| LFMA/B-3/8-D-MINI(A)              | 3.35 / 85     | 2.76 / 70     | 2.17 / 55     | 1.54 / 39     | 0.12 / 3      | 3/8 NPT / G 3/8 ISO | M5            | 0.21 / 5.3           | 1.50 / 38            |     |
| LFMA/B-3/8-D-MIDI(A)              | 3.35 / 85     | 2.76 / 70     | 2.17 / 55     | 1.85 / 47     | 0.12 / 3      | 3/8 NPT / G 3/8 ISO | M5            | 0.21 / 5.3           | 2.05 / 52            |     |
| LFMA/B-1/2-D-MIDI(A)              | 3.35 / 85     | 2.76 / 70     | 2.17 / 55     | 1.85 / 47     | 0.12 / 3      | 1/2 NPT / G 1/2 ISO | M5            | 0.21 / 5.3           | 2.05 / 52            |     |
| LFMA/B-3/4-D-MIDI(A)              | 3.78 / 96     | 3.15 / 80     | 2.60 / 66     | 1.85 / 47     | 0.12 / 3      | 3/4 NPT / G 3/4 ISO | M5            | 0.21 / 5.3           | 2.05 / 52            |     |
| LFMA/B-3/4-D-MAXI(A)              | 3.78 / 96     | 3.15 / 80     | 2.60 / 66     | 2.09 / 53     | 0.12 / 3      | 3/4 NPT / G 3/4 ISO | M5            | 0.21 / 5.3           | 2.56 / 65            |     |
| LFMA/B-1-D-MAXI(A)                | 4.57 / 116    | 3.58 / 91     | 2.60 / 66     | 2.09 / 53     | 0.12 / 3      | 1 NPT / G 1 ISO     | M5            | 0.21 / 5.3           | 2.56 / 65            |     |
| Type<br>Inch and<br>Metric Series | H1<br>in / mm | H2<br>in / mm | H3<br>in / mm | H4<br>in / mm | H5<br>in / mm | L1<br>in / mm       | L3<br>in / mm | L5<br>in / mm        | T1                   | ⌀ 2 |
| LFMA/B-1/8-D-MINI(A)              | 0.79 / 20     | 1.69 / 43     | 1.38 / 35     | 0.43 / 11     | 0.69 / 17.5   | 5.67 / 144          | 4.88 / 124    | 2.36 / 60            | 0.28 / 7             | 22  |
| LFMA/B-1/4-D-MINI(A)              | 0.79 / 20     | 1.69 / 43     | 1.38 / 35     | 0.43 / 11     | 0.69 / 17.5   | 5.67 / 144          | 4.88 / 124    | 2.36 / 60            | 0.28 / 7             | 22  |
| LFMA/B-3/8-D-MINI(A)              | 0.79 / 20     | 1.69 / 43     | 1.38 / 35     | 0.43 / 11     | 0.69 / 17.5   | 5.67 / 144          | 4.88 / 124    | 2.36 / 60            | 0.28 / 7             | 22  |
| LFMA/B-3/8-D-MIDI(A)              | 1.26 / 32     | 2.76 / 70     | 2.36 / 60     | 0.87 / 22     | 0.96 / 24.5   | 7.05 / 179          | 5.94 / 151    | 3.15 / 80            | 0.31 / 8             | 24  |
| LFMA/B-1/2-D-MIDI(A)              | 1.26 / 32     | 2.76 / 70     | 2.36 / 60     | 0.87 / 22     | 0.96 / 24.5   | 7.05 / 179          | 5.94 / 151    | 3.15 / 80            | 0.31 / 8             | 24  |
| LFMA/B-3/4-D-MIDI(A)              | 1.26 / 32     | 2.76 / 70     | 2.36 / 60     | 0.87 / 22     | 0.96 / 24.5   | 7.05 / 179          | 6.69 / 170    | 3.54 / 90            | 0.31 / 8             | 24  |
| LFMA/B-3/4-D-MAXI(A)              | 1.26 / 32     | 2.76 / 70     | 2.36 / 60     | 0.87 / 22     | 0.96 / 24.5   | 7.99 / 203          | 6.69 / 170    | 3.54 / 90            | 0.31 / 8             | 24  |
| LFMA/B-1-D-MAXI(A)                | 1.57 / 40     | 2.76 / 70     | 2.36 / 60     | 0.87 / 22     | 0.96 / 24.5   | 7.99 / 203          | 6.69 / 170    | 3.54 / 90            | 0.31 / 8             | 24  |

# Microfilters, Type LFMA

## Servicing Information

For economic considerations, the filter cartridge should be replaced when the pressure difference (pressure drop) of the filter is 6 psi / 0.41 bar. After disconnection of the compressed air supply, the filter bowl should be vented and removed, and the filter cartridge unscrewed from inside the filter housing.

### Pressure drop as a function of input pressure at different normal flow rates for Microfilters (0.01 micron)

Type LFMA-1/8-D-MINI  
LFMA-1/8-D-MINI-A

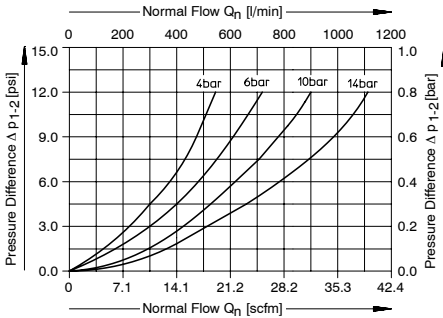

Type LFMA-1/4-D-MINI  
LFMA-1/4-D-MINI-A

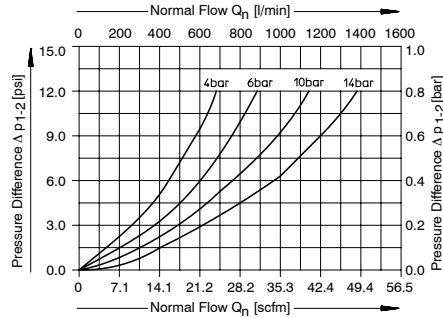

Type LFMA-3/8-D-MINI  
LFMA-3/8-D-MINI-A

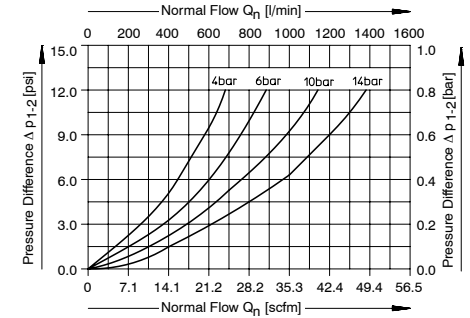

Type LFMA-3/8-D-MIDI  
LFMA-3/8-D-MIDI-A

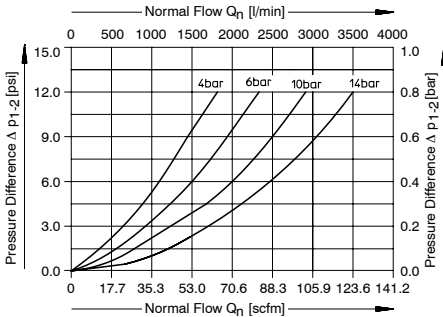

Type LFMA-3/4-D-MIDI  
LFMA-3/4-D-MIDI-A

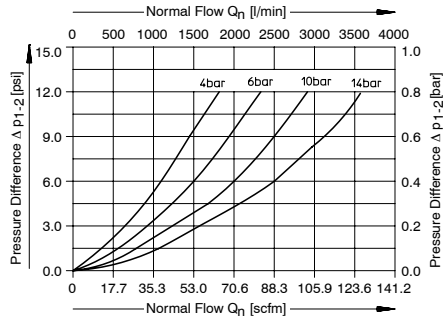

Type LFMA-1/2-D-MIDI  
LFMA-1/2-D-MIDI-A

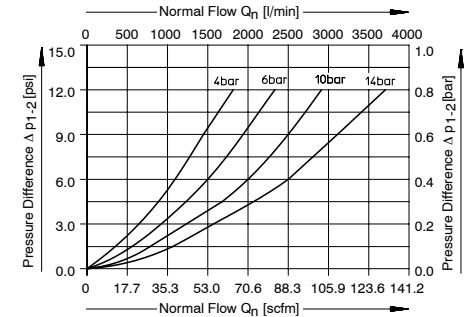

Type LFMA-3/4-D-MAXI  
LFMA-3/4-D-MAXI-A

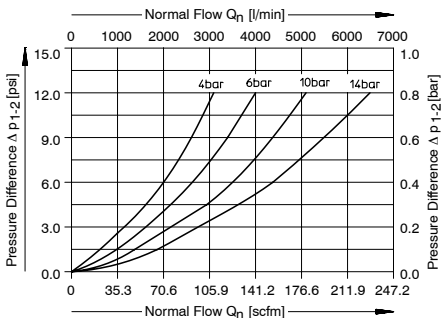

Type LFMA-1-D-MAXI  
LFMA-1-D-MAXI-A

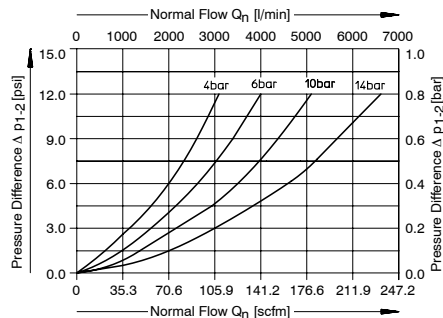

# Fine Filters, Type LFMB

## Servicing Information

For economic considerations, the filter cartridge should be replaced when the pressure difference (pressure drop) of the filter is 6 psi / 0.41 bar. After disconnection of the compressed air supply, the filter bowl should be vented and removed, and the filter cartridge unscrewed from inside the filter housing.

### Pressure drop as a function of input pressure at different normal flow rates for Fine Filters (1 micron)

Type LFMB-1/8-D-MINI  
LFMB-1/8-D-MINI-A

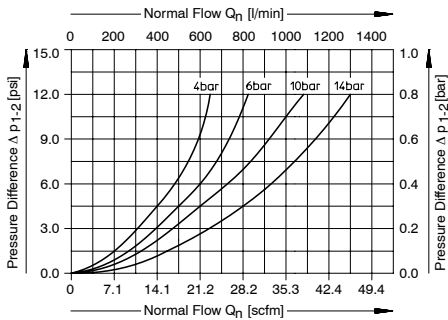

Type LFMB-1/4-D-MINI  
LFMB-1/4-D-MINI-A

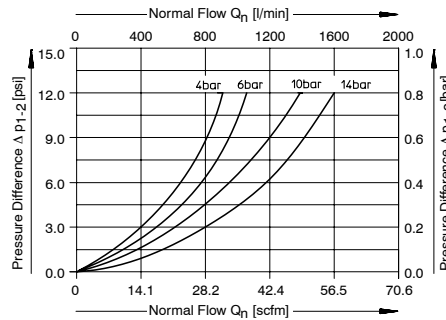

Type LFMB-3/8-D-MINI  
LFMB-3/8-D-MINI-A

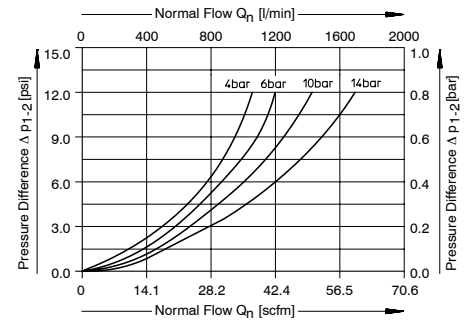

Type LFMB-3/8-D-MIDI  
LFMB-3/8-D-MIDI-A

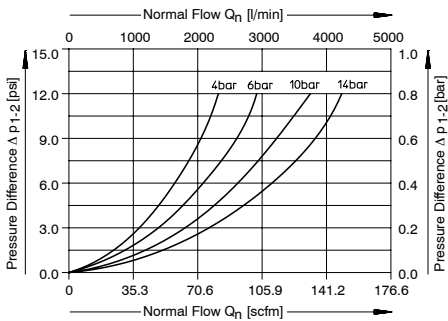

Type LFMB-1/2-D-MIDI  
LFMB-1/2-D-MIDI-A

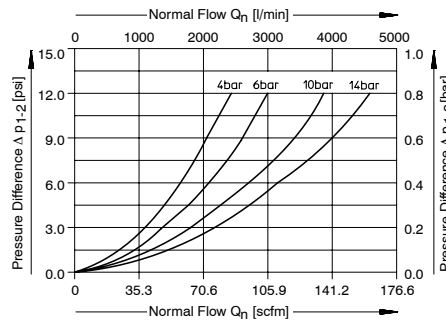

Type LFMB-3/4-D-MIDI  
LFMB-3/4-D-MIDI-A

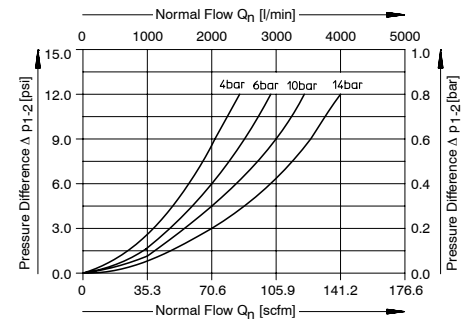

Type LFMB-3/4-D-MAXI  
LFMB-3/4-D-MAXI-A

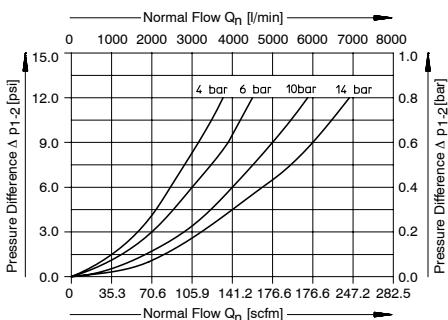

Type LFMB-1-D-MAXI  
LFMB-1-D-MAXI-A

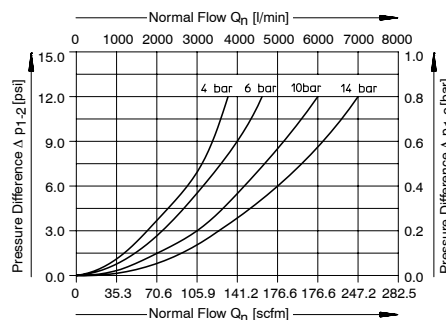

# Filter Combination, Type LFMB A

1/8" to 1" NPT, G 1/8 to G 1 ISO, INCH and Metric Series

## Filter Combination

0.01 micron average pore size  
with Metal Bowl Guards  
with manual bowl drains  
Type LFMB A-...-D-...(-NPT)



with integrated, automatic bowl drains  
Type LFMB A-...-D-...-A(-NPT)

### Accessories:

Mounting brackets, Type HFOE-...  
(see page 67)

Threaded bolt set, Type FRB-... used to  
combine the Filter Combination with  
another D-Series unit (see page 66).

Type LFMB-...-D-...(-NPT)  
LFMB-...-D-...-A(-NPT)



The combination of a fine filter (1 micron) and a microfilter (0.01 micron) provides 2-stage filtration of the compressed air. In this arrangement, the output of the fine filter cannot be used by any other system components.

| Order Number<br>Part No. / Type | Filter Combination<br>Manual Bowl Drains    | NPT | 173740   | 173742                        | 173744                      | 173746  | 173748                      | 173750                      | 173752                      | 173754                    |
|---------------------------------|---|-----|--|-------------------------------|-----------------------------|---|-----------------------------|-----------------------------|-----------------------------|---------------------------|
|                                 |   |     | LFMB A-1/8-<br>D-MINI-NPT  | LFMB A-1/4-<br>D-MINI-NPT     | LFMB A-3/8-<br>D-MINI-NPT   | LFMB A-3/8-<br>D-MIDI-NPT                               | LFMB A-1/2-<br>D-MIDI-NPT   | LFMB A-3/4-<br>D-MIDI-NPT   | LFMB A-3/4-<br>D-MAXI-NPT   | LFMB A-1-<br>D-MAXI-NPT   |
|                                 |   | ISO | 162658   | 162659                        | 162660                      | 162661  | 162662                      | 162663                      | 162664                      | 162665                    |
|                                 |   |     | LFMB A-1/8-<br>D-MINI  | LFMB A-1/4-<br>D-MINI         | LFMB A-3/8-<br>D-MINI       | LFMB A-3/8-<br>D-MIDI                                   | LFMB A-1/2-<br>D-MIDI       | LFMB A-3/4-<br>D-MIDI       | LFMB A-3/4-<br>D-MAXI       | LFMB A-1-<br>D-MAXI       |
|                                 | Filter Combination<br>Automatic Bowl Drains | NPT | 173741   | 173743                        | 173745                      | 173747  | 173749                      | 173751                      | 173753                      | 173755                    |
|                                 |   |     | LFMB A-1/8-<br>D-MINI-A-NPT  | LFMB A-1/4-D-<br>D-MINI-A-NPT | LFMB A-3/8-<br>D-MINI-A-NPT | LFMB A-3/8-<br>D-MIDI-A-NPT                             | LFMB A-1/2-<br>D-MIDI-A-NPT | LFMB A-3/4-<br>D-MIDI-A-NPT | LFMB A-3/4-<br>D-MAXI-A-NPT | LFMB A-1-<br>D-MAXI-A-NPT |
|                                 |   | ISO | 162666   | 162667                        | 162668                      | 162669  | 162670                      | 162671                      | 162672                      | 162673                    |
|                                 |   |     | LFMB A-1/8-<br>D-MINI-A  | LFMB A-1/4-D-<br>D-MINI-A     | LFMB A-3/8-<br>D-MINI-A     | LFMB A-3/8-<br>D-MIDI-A                                 | LFMB A-1/2-<br>D-MIDI-A     | LFMB A-3/4-<br>D-MIDI-A     | LFMB A-3/4-<br>D-MAXI-A     | LFMB A-1-<br>D-MAXI-A     |
| Mounting Brackets               |   |     | 159638 HFOE-D-MINI   |                               |                             | 159593 HFOE-D-MIDI/MAXI                                 |                             |                             |                             |                           |
| Threaded Bolt Set               |   |     | 159642 FRB-D-MINI  |                               |                             | 159595 FRB-D-MIDI                                       |                             |                             | 159643 FRB-D-MAXI           |                           |
| Filter Cartridge 1 micron       |   |     | 162677 LFMBP-D-MINI  |                               |                             | 162678 LFMBP-D-MIDI                                     |                             |                             | 162679 LFMBP-D-MAXI         |                           |
| Filter Cartridge 0.01 micron    |   |     | 162674 LFMAP-D-MINI  |                               |                             | 162675 LFMAP-D-MIDI                                     |                             |                             | 162676 LFMAP-D-MAXI         |                           |
| Medium                          |   |     | Prefiltered, compressed air  |                               |                             |   |                             |                             |                             |                           |
| Design                          |   |     | Filter with Borosilicate filter material                                     |                               |                             |   |                             |                             |                             |                           |
| Mounting                        |   |     | In-line assembly or mounting brackets  |                               |                             |   |                             |                             |                             |                           |
| Assembly Position               |   |     | Vertical ± 5°  |                               |                             |   |                             |                             |                             |                           |
| Connection                      |   |     | 1/8 NPT /<br>G 1/8 ISO   | 1/4 NPT /<br>G 1/4 ISO        | 3/8 NPT /<br>G 3/8 ISO      | 3/8 NPT /<br>G 3/8 ISO                                  | 1/2 NPT /<br>G 1/2 ISO      | 3/4 NPT /<br>G 3/4 ISO      | 3/4 NPT /<br>G 3/4 ISO      | 1 NPT /<br>G 1 ISO        |
| Normal Flow*                    |   |     | 4.41 scfm /<br>125 l/min   | 4.59 scfm /<br>130 l/min      | 4.94 scfm /<br>140 l/min    | 9.89 scfm /<br>280 l/min                                | 10.59 scfm /<br>300 l/min   | 12.36 scfm /<br>350 l/min   | 19.42 scfm /<br>550 l/min   | 21.19 scfm /<br>600 l/min |
| Filter Pore Size                |   |     | micron 1 and 0.01  |                               |                             |   |                             |                             |                             |                           |
| Residual Oil Concentration      |   |     | [mg/m <sup>3</sup> ] ≤ 0.01  |                               |                             |   |                             |                             |                             |                           |
| Filter Efficiency               |   |     | [%] 99.99  |                               |                             |   |                             |                             |                             |                           |
| Air Purity Class per ISO 8573-1 |   |     | Particle 1<br>Oil Aerosol 2  |                               |                             |   |                             |                             |                             |                           |
| Condensate Capacity             |   |     | 13 cu in / 22 ml   |                               |                             | 26 cu in / 43 ml  |                             | 49 cu in / 80 ml            |                             |                           |
| Primary Pressure Range          |   |     | Manual Bowl Drain<br>232 psi / max. 16 bar                                   |                               |                             | Automatic Bowl Drain**<br>22 to 180 psi / 1.5 to 12 bar |                             |                             |                             |                           |
| Temperature Range               |   |     | Medium 35 to 140°F / +1.5 to +60°C<br>Ambient 14 to 140°F / -10 to +60°C     |                               |                             |   |                             |                             |                             |                           |
| Material                        |   |     | Housing: GD-Zn; Seals: NBR; Filter bowl: Polycarbonate; Metal bowl guard: Al |                               |                             |   |                             |                             |                             |                           |
| Weight                          |   |     | 1.102 lb /<br>0.5 kg   |                               |                             | 2.866 lb /<br>1.3 kg                                    |                             | 4.850 lb /<br>2.2 kg        |                             | 5.291 lb /<br>2.4 kg      |

Delivery: Short lead time

\* At upstream pressure of 90 psi / 6 bar and Δ p = 1.05 psi / 0.07 bar.

\*\* A minimum flow of 4 scfm / 125 l/min is required for the proper result.

# Filter Combination, Type LFMBA

## Dimensions, INCH and Metric Series

Type LFMBA-...-D-...

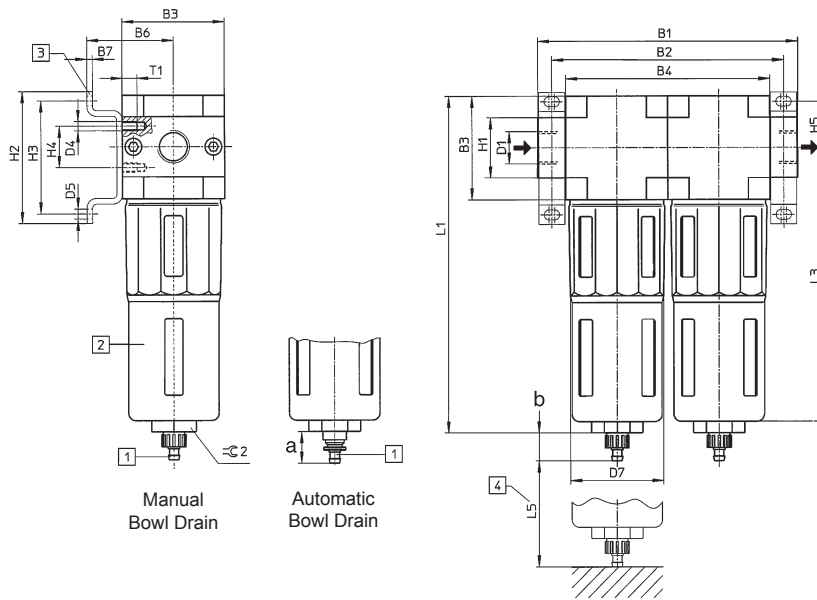

- 1 Drain connector for plastic tubing (Order number 7134 PCN-4)
- 2 Metal bowl guard
- 3 Mounting brackets Type HFOE (order separately)
- 4 Clearance required to remove bowl for servicing

### Dimensions

- a 0.59 in / 15 mm
- b 0.67 in / 17 mm

→ Flow direction

| Type<br>Inch and<br>Metric Series | B1<br>in / mm | B2<br>in / mm | B3<br>in / mm | B6<br>in / mm | B7<br>in / mm | D1                  | D4            | D5<br>dia<br>in / mm | D7<br>dia<br>in / mm |
|-----------------------------------|---------------|---------------|---------------|---------------|---------------|---------------------|---------------|----------------------|----------------------|
| LFMBA-1/8-D-MINI(A)               | 4.09 / 104    | 3.62 / 92     | 1.57 / 40     | 1.54 / 39     | 0.08 / 2      | 1/8 NPT / G 1/8 ISO | M4            | 0.17 / 4.3           | 1.50 / 38            |
| LFMBA-1/4-D-MINI(A)               | 4.09 / 104    | 3.62 / 92     | 1.57 / 40     | 1.54 / 39     | 0.08 / 2      | 1/4 NPT / G 1/4 ISO | M4            | 0.17 / 4.3           | 1.50 / 38            |
| LFMBA-3/8-D-MINI(A)               | 5.51 / 140    | 4.92 / 125    | 1.57 / 40     | 1.54 / 39     | 0.12 / 3      | 3/8 NPT / G 3/8 ISO | M5            | 0.17 / 4.3           | 1.50 / 38            |
| LFMBA-3/8-D-MIDI(A)               | 5.51 / 140    | 4.92 / 125    | 2.17 / 55     | 1.85 / 47     | 0.12 / 3      | 3/8 NPT / G 3/8 ISO | M5            | 0.21 / 5.3           | 2.05 / 52            |
| LFMBA-1/2-D-MIDI(A)               | 5.51 / 140    | 4.92 / 125    | 2.17 / 55     | 1.85 / 47     | 0.12 / 3      | 1/2 NPT / G 1/2 ISO | M5            | 0.21 / 5.3           | 2.05 / 52            |
| LFMBA-3/4-D-MIDI(A)               | 5.51 / 140    | 4.92 / 125    | 2.17 / 55     | 1.85 / 47     | 0.12 / 3      | 3/4 NPT / G 3/4 ISO | M5            | 0.21 / 5.3           | 2.05 / 52            |
| LFMBA-3/4-D-MAXI(A)               | 6.38 / 162    | 5.75 / 146    | 2.60 / 66     | 2.09 / 53     | 0.12 / 3      | 3/4 NPT / G 3/4 ISO | M5            | 0.21 / 5.3           | 2.56 / 65            |
| LFMBA-1-D-MAXI(A)                 | 7.17 / 182    | 6.18 / 157    | 2.60 / 66     | 2.09 / 53     | 0.12 / 3      | 1 NPT / G 1 ISO     | M5            | 0.21 / 5.3           | 2.56 / 65            |
| Type<br>Inch and<br>Metric Series | H1<br>in / mm | H2<br>in / mm | H3<br>in / mm | H4<br>in / mm | H5<br>in / mm | L1<br>in / mm       | L3<br>in / mm | T1<br>in / mm        | ∅ 2                  |
| LFMBA-1/8-D-MINI(A)               | 0.79 / 20     | 1.69 / 43     | 1.38 / 35     | 0.43 / 11     | 0.69 / 17.5   | 5.67 / 144          | 4.88 / 124    | 0.28 / 7             | 22                   |
| LFMBA-1/4-D-MINI(A)               | 0.79 / 20     | 1.69 / 43     | 1.38 / 35     | 0.43 / 11     | 0.69 / 17.5   | 5.67 / 144          | 4.88 / 124    | 0.28 / 7             | 22                   |
| LFMBA-3/8-D-MINI(A)               | 0.79 / 20     | 1.69 / 43     | 1.38 / 35     | 0.43 / 11     | 0.69 / 17.5   | 5.67 / 144          | 5.94 / 151    | 0.31 / 8             | 22                   |
| LFMBA-3/8-D-MIDI(A)               | 1.26 / 32     | 2.76 / 70     | 2.36 / 60     | 0.87 / 22     | 0.96 / 24.5   | 7.05 / 179          | 5.94 / 151    | 0.31 / 8             | 24                   |
| LFMBA-1/2-D-MIDI(A)               | 1.26 / 32     | 2.76 / 70     | 2.36 / 60     | 0.87 / 22     | 0.96 / 24.5   | 7.05 / 179          | 5.94 / 151    | 0.31 / 8             | 24                   |
| LFMBA-3/4-D-MIDI(A)               | 1.26 / 32     | 2.76 / 70     | 2.36 / 60     | 0.87 / 22     | 0.96 / 24.5   | 7.05 / 179          | 5.94 / 151    | 0.31 / 8             | 24                   |
| LFMBA-3/4-D-MAXI(A)               | 1.26 / 32     | 2.76 / 70     | 2.36 / 60     | 0.87 / 22     | 0.96 / 24.5   | 7.99 / 203          | 6.69 / 170    | 0.31 / 8             | 24                   |
| LFMBA-1-D-MAXI(A)                 | 1.57 / 40     | 2.76 / 70     | 2.36 / 60     | 0.87 / 22     | 0.96 / 24.5   | 7.99 / 203          | 6.69 / 170    | 0.31 / 8             | 24                   |



# Filter Combination, Type LFMBA

## Servicing Information

For economic considerations, the filter cartridge should be replaced when the pressure difference (pressure drop) of the filter is 6 psi / 0.41 bar. After disconnection of the compressed air supply, the filter bowl should be vented and removed, and the filter cartridge unscrewed from inside the filter housing.

**Pressure drop as a function of input pressure at different normal flow rates for Fine Combinations (1 micron and 0.01 micron)**

Type LFMBA-1/8-D-MINI  
LFMBA-1/8-D-MINI-A

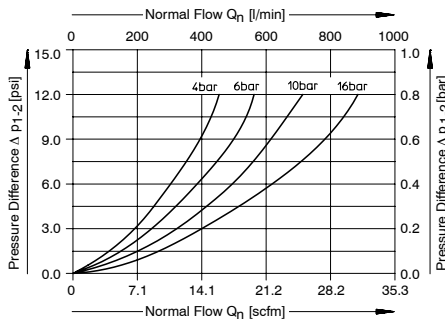

Type LFMBA-1/4-D-MINI  
LFMBA-1/4-D-MINI-A

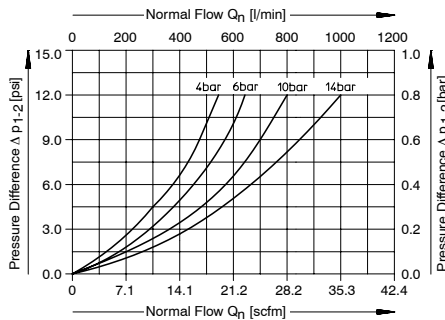

Type LFMBA-3/8-D-MINI  
LFMBA-3/8-D-MINI-A

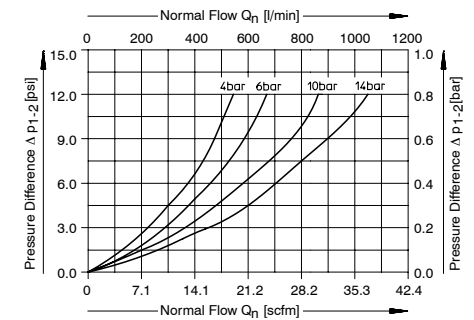

Type LFMBA-3/8-D-MIDI  
LFMBA-3/8-D-MIDI-A

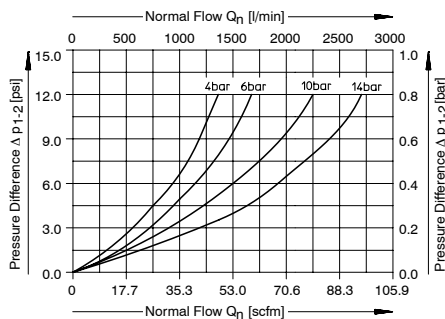

Type LFMBA-1/2-D-MIDI  
LFMBA-1/2-D-MIDI-A

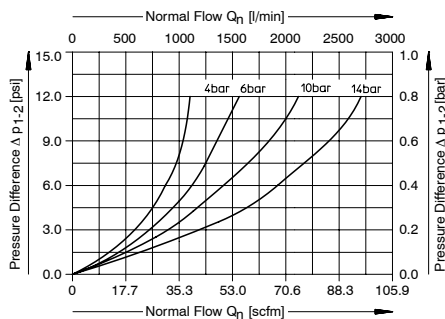

Type LFMBA-3/4-D-MIDI  
LFMBA-3/4-D-MIDI-A

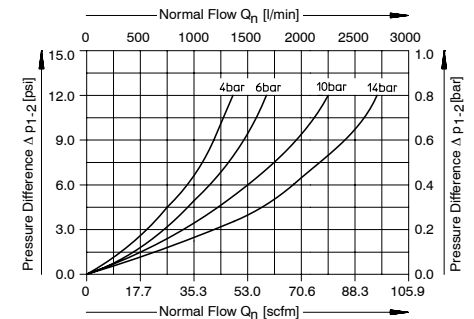

Type LFMBA-3/4-D-MAXI  
LFMBA-3/4-D-MAXI-A

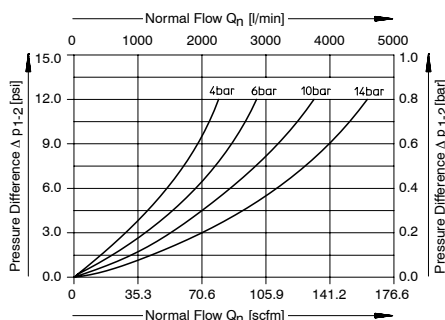

Type LFMBA-1-D-MAXI  
LFMBA-1-D-MAXI-A

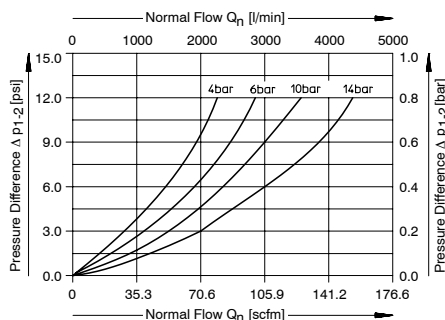



## Micro and Fine Filter Selector Guide

D-Series Service Units Port Sizes 1/8" to 3/8"

Ship From Stock

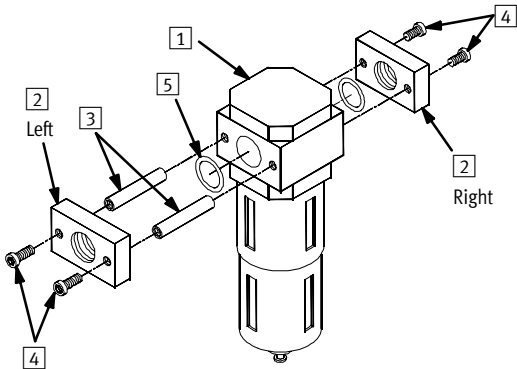

A complete filter assembly consists of the following items:

| Item | Description                      | Qty Required per Assy   |
|------|----------------------------------|-------------------------|
| 1    | Main Unit                        | 1                       |
| 2    | Port Block                       | 2 [one left, one right] |
| 3    | Single Unit Joining Rod          | 2                       |
| 4    | Port Block Screw                 | 4                       |
| 5    | Port Block Seal                  | 2                       |
| 6    | Mounting Bracket Kit [Not shown] | 1                       |

**Step 1:** Based upon the required Port Size, Maximum Flow, Filtration Level, Drain Type, and Thread Type, select the Main Unit [Item 1] and the Left and Right Port Block [Item 2]. Note the Product Type/Description for the next step.

| Port size | Max. Flow (l/min/sfcm) | Filtration Level (µm) | Drain | Item      |                            | Thread                      |                            |                             |                     | Product Type/Description |
|-----------|------------------------|-----------------------|-------|-----------|----------------------------|-----------------------------|----------------------------|-----------------------------|---------------------|--------------------------|
|           |                        |                       |       | 1         | 2                          | NPT Thread                  |                            | BSP Thread                  |                     |                          |
|           |                        |                       |       | Main Unit | Left Connection Port Block | Right Connection Port Block | Left Connection Port Block | Right Connection Port Block |                     |                          |
| 1/8       | 130/4.6                | 0.01                  | Man.  | 126 036   | 372 030                    | 372 038                     | 380 285                    | 380 287                     | LFMA-...-D-MINI-... |                          |
|           |                        |                       | Auto  | 126 038   |                            |                             |                            |                             | LFMB-...-D-MINI-... |                          |
|           | 250/8.8                | 1                     | Man.  | 126 037   |                            |                             |                            |                             |                     |                          |
|           |                        |                       | Auto  | 126 039   |                            |                             |                            |                             |                     |                          |
| 1/4       | 160/5.7                | 0.01                  | Man.  | 126 036   | 372 031                    | 372 039                     | 380 289                    | 380 291                     | LFMA-...-D-MINI-... |                          |
|           |                        |                       | Auto  | 126 038   |                            |                             |                            |                             |                     |                          |
|           | 380/13.4               |                       | Man.  | 126 040   | -                          | -                           | 380 902                    | 380 903                     | LFMA-...-D-MIDI-... |                          |
|           |                        |                       | Auto  | 126 043   |                            |                             |                            |                             |                     |                          |
|           | 300/10.6               | 1                     | Man.  | 126 037   | 372 031                    | 372 039                     | 380 289                    | 380 291                     | LFMB-...-D-MINI-... |                          |
|           |                        |                       | Auto  | 126 039   |                            |                             |                            |                             |                     |                          |
|           | 500/17.6               |                       | Man.  | 126 041   | -                          | -                           | 380 902                    | 380 903                     | LFMB-...-D-MIDI-... |                          |
|           |                        |                       | Auto  | 126 042   |                            |                             |                            |                             |                     |                          |
| 3/8       | 180/6.4                | 0.01                  | Man.  | 126 036   | 372 032                    | 372 040                     | 380 293                    | 380 295                     | LFMA-...-D-MINI-... |                          |
|           |                        |                       | Auto  | 126 038   |                            |                             |                            |                             |                     |                          |
|           | 380/13.4               |                       | Man.  | 126 040   | 372 035                    | 372 043                     | 380 297                    | 380 299                     | LFMA-...-D-MIDI-... |                          |
|           |                        |                       | Auto  | 126 043   |                            |                             |                            |                             |                     |                          |
|           | 310/10.9               | 1                     | Man.  | 126 037   | 372 032                    | 372 040                     | 380 293                    | 380 295                     | LFMB-...-D-MINI-... |                          |
|           |                        |                       | Auto  | 126 039   |                            |                             |                            |                             |                     |                          |
|           | 500/17.6               |                       | Man.  | 126 041   | 372 035                    | 372 043                     | 380 297                    | 380 299                     | LFMB-...-D-MIDI-... |                          |
|           |                        |                       | Auto  | 126 042   |                            |                             |                            |                             |                     |                          |

☐ Not available

Next...Step 2

# Micro and Fine Filter Selector Guide

D-Series Service Units Port Sizes 1/8" to 3/8"

Ship From Stock

**Step 2:** Based upon the Product Type/Description from Step 1, select the Joining Rods [Item 3], the Port Block Screws [Item 4], the Port Block Seals [Item 5], and the Mounting Bracket Kit [Item 6].

|                              | Item<br>3               | 4                | 5               | 6 [Not shown]        |
|------------------------------|-------------------------|------------------|-----------------|----------------------|
| Product Type/<br>Description | Single Unit Joining Rod | Port Block Screw | Port Block Seal | Mounting Bracket Kit |
| LFMA-...-D-MINI-...          | 359 787                 | 200 664          | 235 260         | 159 638              |
| LFMB-...-D-MINI-...          |                         |                  |                 |                      |
| LFMA-...-D-MIDI-...          | 369 989                 | 202 824          | 200 950         | 159 593              |
| LFMB-...-D-MIDI-...          |                         |                  |                 |                      |

**Step 3:** Determine the appropriate quantity of each Item.

**Ordering Example:**

Required: 1/4 port size, 250 l/min flow, 1 µm filtration, automatic drain, BSP threads.

|        | Item    | Part No. | Qty                  | Description             |
|--------|---------|----------|----------------------|-------------------------|
| Order: | 1       | 126 039  | 1                    | Main Unit               |
|        | 2       | 380 289  | 1                    | Left Port Block         |
|        |         | 380 291  | 1                    | Right Port Block        |
|        | 3       | 359 787  | 2                    | Single Unit Joining Rod |
|        | 4       | 200 664  | 4                    | Port Block Screws       |
|        | 5       | 235 260  | 3                    | Port Block Seals        |
| 6      | 159 638 | 1        | Mounting Bracket Kit |                         |

**Note:** For combination units please see pages 76 - 79.

## Micro and Fine Filter Selector Guide

D-Series Service Units Port Sizes 1/2" to 1"

Ship From Stock

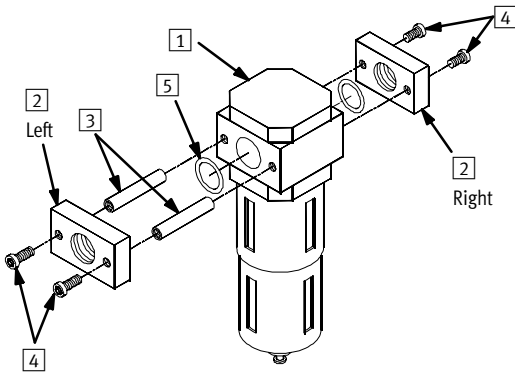

A complete filter assembly consists of the following items:

| Item | Description                      | Qty Required per Assy   |
|------|----------------------------------|-------------------------|
| 1    | Main Unit                        | 1                       |
| 2    | Port Block                       | 2 [one left, one right] |
| 3    | Single Unit Joining Rod          | 2                       |
| 4    | Port Block Screw                 | 4                       |
| 5    | Port Block Seal                  | 2                       |
| 6    | Mounting Bracket Kit [Not shown] | 1                       |

**Step 1:** Based upon the required Port Size, Maximum Flow, Filtration Level, Drain Type, and Thread Type, select the Main Unit [Item 1] and the Left and Right Port Block [Item 2]. Note the Product Type/Description for the next step.

| Port size | Max. Flow (l/min/sfcm) | Filtration Level [µm] | Drain | Item      |            | NPT Thread           |            |                       |                     | BSP Thread           |            |                       |  | Product Type/Description |
|-----------|------------------------|-----------------------|-------|-----------|------------|----------------------|------------|-----------------------|---------------------|----------------------|------------|-----------------------|--|--------------------------|
|           |                        |                       |       | Main Unit | NPT Thread | Left Connection Port |            | Right Connection Port |                     | Left Connection Port |            | Right Connection Port |  |                          |
|           |                        |                       |       |           |            | Block                | Port Block | Block                 | Port Block          | Block                | Port Block |                       |  |                          |
| 1/2       | 400/14.1               | 0.01                  | Man.  | 126 040   | 372 033    | 372 041              | 380 301    | 380 303               | LFMA-...-D-MIDI-... |                      |            |                       |  |                          |
|           |                        |                       | Auto  | 126 043   |            |                      |            |                       | LFMA-...-D-MAXI-... |                      |            |                       |  |                          |
|           | 750/24.5               | 1                     | Man.  | 126 044   | -          | -                    | 381 529    | 381 530               | LFMA-...-D-MAXI-... |                      |            |                       |  |                          |
|           |                        |                       | Auto  | 126 046   |            |                      |            |                       | LFMA-...-D-MAXI-... |                      |            |                       |  |                          |
|           | 900/31.8               | 1                     | Man.  | 126 041   | 372 033    | 372 041              | 380 301    | 380 303               | LFMB-...-D-MIDI-... |                      |            |                       |  |                          |
|           |                        |                       | Auto  | 126 042   |            |                      |            |                       | LFMB-...-D-MAXI-... |                      |            |                       |  |                          |
|           | 1150/40.6              | 1                     | Man.  | 126 045   | -          | -                    | 381 529    | 381 530               | LFMB-...-D-MAXI-... |                      |            |                       |  |                          |
|           |                        |                       | Auto  | 126 047   |            |                      |            |                       | LFMB-...-D-MAXI-... |                      |            |                       |  |                          |
| 3/4       | 460/16.2               | 0.01                  | Man.  | 126 040   | 372 034    | 372 042              | 380 305    | 380 307               | LFMA-...-D-MIDI-... |                      |            |                       |  |                          |
|           |                        |                       | Auto  | 126 043   |            |                      |            |                       | LFMA-...-D-MAXI-... |                      |            |                       |  |                          |
|           | 900/31.8               | 1                     | Man.  | 126 044   | 372 036    | 372 044              | 380 309    | 380 311               | LFMA-...-D-MAXI-... |                      |            |                       |  |                          |
|           |                        |                       | Auto  | 126 046   |            |                      |            |                       | LFMA-...-D-MAXI-... |                      |            |                       |  |                          |
|           | 1000/35.3              | 1                     | Man.  | 126 041   | 372 034    | 372 042              | 380 305    | 380 307               | LFMB-...-D-MIDI-... |                      |            |                       |  |                          |
|           |                        |                       | Auto  | 126 042   |            |                      |            |                       | LFMB-...-D-MAXI-... |                      |            |                       |  |                          |
|           | 1200/42.4              | 1                     | Man.  | 126 045   | 372 036    | 372 044              | 380 309    | 380 311               | LFMB-...-D-MAXI-... |                      |            |                       |  |                          |
|           |                        |                       | Auto  | 126 047   |            |                      |            |                       | LFMB-...-D-MAXI-... |                      |            |                       |  |                          |
| 1         | 460/16.2               | 0.01                  | Man.  | 126 044   | 372 037    | 372 045              | 380 313    | 380 315               | LFMA-...-D-MAXI-... |                      |            |                       |  |                          |
|           |                        |                       | Auto  | 126 046   |            |                      |            |                       | LFMA-...-D-MAXI-... |                      |            |                       |  |                          |
|           | 1000/35.3              | 1                     | Man.  | 126 045   |            |                      |            |                       | LFMB-...-D-MAXI-... |                      |            |                       |  |                          |
|           |                        |                       | Auto  | 126 047   |            |                      |            |                       | LFMB-...-D-MAXI-... |                      |            |                       |  |                          |

☐ Not available

Next...Step 2

# Micro and Fine Filter Selector Guide

D-Series Service Units Port Sizes 1/2" to 1"

Ship From Stock

**Step 2:** Based upon the Product Type/Description from Step 1, select the Joining Rods [Item **3**], the Port Block Screws [Item **4**], the Port Block Seals [Item **5**], and the Mounting Bracket Kit [Item **6**].

|                          | Item <b>3</b>           | <b>4</b>         | <b>5</b>        | <b>6</b> [Not shown] |
|--------------------------|-------------------------|------------------|-----------------|----------------------|
| Product Type/Description | Single Unit Joining Rod | Port Block Screw | Port Block Seal | Mounting Bracket Kit |
| LFMA-...-D-MIDI-...      | 369 989                 | 202 824          | 200 950         | 159 593              |
| LFMB-...-D-MIDI-...      |                         |                  |                 |                      |
| LFMA-...-D-MAXI-...      | 373 059                 |                  | 234 380         |                      |
| LFMB-...-D-MAXI-...      |                         |                  |                 |                      |

**Step 3:** Determine the appropriate quantity of each Item.

**Ordering Example:**

Required: 3/4 port size, 950 l/min flow, 1 µm filtration, automatic drain, BSP threads.

|          | Item     | Part No. | Qty                  | Description             |
|----------|----------|----------|----------------------|-------------------------|
| Order:   | <b>1</b> | 126 042  | 1                    | Main Unit               |
|          | <b>2</b> | 372 034  | 1                    | Left Port Block         |
|          |          | 372 042  | 1                    | Right Port Block        |
|          | <b>3</b> | 369 989  | 2                    | Single Unit Joining Rod |
|          | <b>4</b> | 200 824  | 4                    | Port Block Screws       |
|          | <b>5</b> | 200 950  | 3                    | Port Block Seals        |
| <b>6</b> | 159 593  | 1        | Mounting Bracket Kit |                         |

**Note:** For combination units please see pages 76 - 79.