

Pipe Plug Type B-...-NPT Inch Series

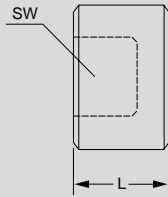

SW = internal hex for Allen wrench

| Order Number | | Connection D | Material | Weight lb / kg | Dimensions | |
|--------------|-----------|--------------|------------------|-------------------|--------------|----------|
| Part No. | Type | | | | L in / mm | SW in |
| 13002829 | B-1/8 NPT | 1/8 NPT | CuZn39Pb3 F44 | | 0.31 / 7.94 | 3/16 |
| 31783 | B-1/4 NPT | 1/4 NPT | | | 0.44 / 11.11 | 1/4 |
| 31785 | B-1/2 NPT | 1/2 NPT | | | 0.56 / 14.29 | 3/8 |
| 31786 | B-3/4 NPT | 3/4 NPT | | | 0.63 / 15.88 | 9/16 |
| 31787 | B-1 NPT | 1 NPT | | | 0.75 / 19.04 | 5/8 |



Pipe Plug Type B-... Per DIN 908 With sealing ring

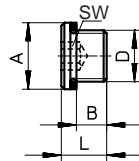

Type B-...

SW = wrench size, or internal hex for Allen wrench



Type B-M3-S9

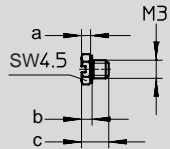

Dimensions

| | |
|---|-------------------|
| a | 0.06 in / 1.5 mm |
| b | 0.07 in / 1.75 mm |
| c | 0.18 in / 4.5 mm |

| Order Number | | Connection D | Material | Weight lb / kg | Dimensions | | | SW mm |
|--------------|----------|--------------|-----------|-------------------|--------------|--------------|--------------|----------|
| Part No. | Type | | | | A in / mm | B in / mm | L in / mm | |
| 30979 | B-M3-S9* | M 3 | X5CrNi189 | 0.002 / 0.001 | — | — | — | — |
| 3843 | B-M5 | M 5 | Al | 0.002 / 0.001 | — | 0.16 / 4 | 0.31 / 8 | 7 outer |
| 174309 | B-M7 | M 7 | Al | — | — | — | — | — |
| 3568 | B-1/8 | G 1/8 ISO | Steel | 0.011 / 0.005 | 0.55 / 14 | 0.26 / 6.5 | 0.43 / 11 | 5 |
| 3569 | B-1/4 | G 1/4 ISO | | 0.033 / 0.015 | 0.71 / 18 | 0.39 / 10 | 0.59 / 15 | 6 |
| 3570 | B-3/8 | G 3/8 ISO | | 0.048 / 0.022 | 0.87 / 22 | 0.39 / 10 | 0.59 / 15 | 8 |
| 3571 | B-1/2 | G 1/2 ISO | | 0.095 / 0.043 | 0.98 / 25 | 0.47 / 12 | 0.71 / 18 | 10 |
| 3572 | B-3/4 | G 3/4 ISO | | 0.161 / 0.073 | 1.26 / 32 | 0.55 / 14 | 0.79 / 20 | 12 |
| 5763 | B-1 | G 1 ISO | | 0.337 / 0.153 | 1.52 / 39 | 0.55 / 14 | 0.83 / 21 | 17 |

*Corrosion and acid resistant design.