

Servomotor EMMB-AS-40-01-K-S30SB

Broj artikla: 8097166

FESTO

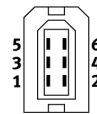
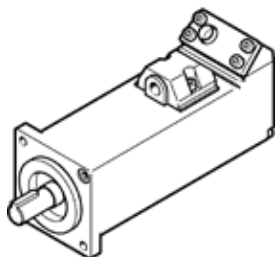

Tehnički podaci

Svojstvo	Vrednost
Temperatura okoline	-15 ... 40 °C
Note on ambient temperature	Up to 60° C with derating of -1.5% per degree Celsius
Max. installation height	4.000 m
Note on max. installation height	As of 1,000 m, only with derating of -1.0% per 100 m
Temperatura ležaja	-20 ... 55 °C
Relativna vlažnost vazduha	0 - 90 %
Odgovara standardu	IEC 60034
Termalna klasa prema EN 60034-1	F
Max. winding temperature	155 °C
Klasa dimenzionisanja prema EN 60034-1	S1
Nadzor temperature	Digital motor temperature transmission via Nikon A format
Motor type to EN 60034-7	IM B5 IM V1 IM V3
Položaj ugradnje	proizvoljno
Mehanička zaštita	IP65
Note on degree of protection	IP40 motor shaft without RWDR IP54 motor shaft with rotary shaft seal IP65 motor housing without connection
Concentricity, coaxiality, axial runout to DIN SPEC 42955	N
Balance quality	G 2,5
Storage lifetime under nominal conditions	20.000 h
Izvedba vratila sa ravnim klinom	DIN 6885 A 3 x 3 x 12
Electrical connection 1, connection type	Utikači
Electrical connection 1, connection technology	Connection pattern RE
Electrical connection 1, number of pins/wires	6
Stepen zagađenja	2
Materijal - napomena	RoHS komfornost
Klasa korozione otpornosti KBK	0 - No corrosion stress
PWIS conformity	VDMA24364 zone III
Otpornost na vibracije	Ispitivanje transporta sa stepenom težine 2 prema FN 942017-4 i EN 60068-2-6
Udarne čvrstoća	Shock test with severity level 2 in accordance with FN 942017-5 and EN 60068-2-27
Dozvola	c UL us - Recognized (OL)
CE znak (vidi izjavu o usklađenosti)	prema EU-EMV-smernici prema EU-niski napon-smernica in accordance with EU RoHS directive
UKCA marking (see declaration of conformity)	To UK instructions for electrical equipment To UK instructions for EMC To UK RoHS instructions
Mesto izdavanja sertifikata	UL E342973
Nazivni pogonski napon DC	300 V
Nazivni napon DC	300 V
Vrsta spajanja navoja	Zvezda unutrašnja

Svojtvo	Vrednost
Number of pole pairs	5
Obrtni moment mirovanja	0,352 Nm
Nazivni obrtni moment	0,32 Nm
Vršni obrtni moment	0,96 Nm
Nazivna brzina obrtanja	3.000 1/min
Maks. brzina obrtanja	6.000 1/min
Max. mechanical speed	10.000 1/min
Nazivna snaga motora	100 W
Trajna struja mirovanja	1,43 A
Nazivna struja, motor	1,3 A
Vršna struja	3,9 A
Motorska konstanta	0,268 Nm/A
Naponska konstanta, linijska	16,2 mVmin
Otpor navoja faza-faza	7,9 Ohm
Induktivnost navoja faza-faza	10,5 mH
Electric time constant	1,33 ms
Measuring flange	175 x 200 x 10, aluminium
Sveukupni moment inercije gonjene strane	0,063 kgcm ²
Težina proizvoda	770 g
Dozvoljeno aksijalno opterećenje vratila	60 N
Dozvoljeno radijalno opterećenje vratila	120 N
Senzor položaja rotora	Apsolutni encoder sa punim krugom
Rotor position sensor, manufacturer designation	SAR-ML50AJC00
Rotor position sensor, absolute detectable revolutions	1
Interface rotirajućeg enkodera	Nikon A format
Princip određivanja položaja rotirajućim enkoderom	optički
Rotor position sensor, DC operating voltage	5 V
Rotor position sensor, DC operating voltage range	4,75 ... 5,25 V
Rotor position sensor, position values per revolution	1.048.576
Okidački enkoder rotora	20 Bit
Rotor position sensor, system accuracy of angle measurement	-120 ... 120 arcsec
Moment držanja, kočnica	0,32 Nm
Pogonski napon DC, kočnica	24 V
Primljena snaga, kočnica	5,9 W