

# Spojni vod VMPA-KMS2-24-2.5-PUR

Broj artikla: 533501

FESTO

za multipol priključak na ventilski blok MPA-S, prikladan za energetska lanac.

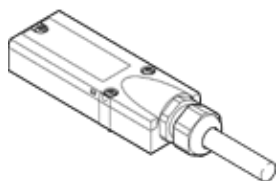
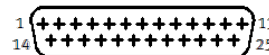

## Tehnički podaci

| Svojstvo   | Vrednost                             |
|--|--------------------------------------|
| Zasnovano na normi                                   | DIN 41652                            |
| Cable identification                                 | Without inscription label holder     |
| Frekvencija priključivanja                           | 50                                   |
| Težina proizvoda                                     | 411 g                                |
| Electrical connection 1, function                    | Field device side                    |
| Electrical connection 1, design                      | ugaono                               |
| Electrical connection 1, connection type             | Utičnica                             |
| Electrical connection 1, cable outlet                | Angled                               |
| Electrical connection 1, connection technology       | Sub-D                                |
| Electrical connection 1, number of pins/wires        | 25                                   |
| Electrical connection 1, occupied pins/wires         | 25                                   |
| Electrical connection 1, type of mounting            | 3x M3 screws                         |
| Electrical connection 2, function                    | Controller side                      |
| Electrical connection 2, connection type             | Kabl                                 |
| Electrical connection 2, connection technology       | otvoreni kraj                        |
| Electrical connection 2, number of pins/wires        | 25                                   |
| Electrical connection 2, occupied pins/wires         | 25                                   |
| Područje pogonskog napona DC                         | 0 ... 30 V                           |
| Nazivni pogonski napon DC                            | 24 V                                 |
| Dozvoljeno strujno opterećenje                       | 3 A                                  |
| Čvrstoća na udarno naprezanje                        | 1 kV                                 |
| Dužina kabla   | 2,5 m                                |
| Svojstvo kabla                                       | Suitable for energy chains           |
| Uslovi ispitivanja kabla                             | Uslovi ispitivanja na zahtev         |
| Bending radius, fixed cable installation             | 28,6 mm                              |
| Bending radius, flexible cable installation          | 49 mm                                |
| Navojni spoj kabla                                   | M20x1,5                              |
| Prečnik kabla  | 10,8 mm                              |
| Struktura kabla                                      | 25x0,25                              |
| Nazivni presek provodnika                            | 0,25 mm <sup>2</sup>                 |
| Krajevi žica   | Cut off bluntly                      |
| Mehanička zaštita                                    | IP65<br>prema IEC 60529              |
| Note on degree of protection                         | u montiranom stanju                  |
| Temperatura okoline                                  | -25 ... 80 °C                        |
| Temperatura okoline kod pokretnog postepenja kablova | -25 ... 80 °C                        |
| CE znak (vidi izjavu o usklađenosti)                 | in accordance with EU RoHS directive |
| UKCA marking (see declaration of conformity)         | To UK RoHS instructions              |
| PWIS conformity                                      | VDMA24364-B2-L                       |
| Materijal - napomena                                 | RoHS komformnost                     |
| Stepen zagađenja                                     | 3                                    |
| Klasa korozione otpornosti KBK                       | 2 - Moderate corrosion stress        |
| Material cable sheath                                | TPE-U(PUR)                           |

| Svojstvo                    | Vrednost                 |
|-----------------------------|--------------------------|
| Boja izolacije              | sivo                     |
| Material housing            | PA                       |
| Boja kućišta                | sivo                     |
| Material of union nut       | PA                       |
| Material seals              | CR<br>NBR                |
| Material electrical contact | Gold-plated copper alloy |