

螺桿軸 ELGT-BS-120-700-10P

料號: 8124459

FESTO

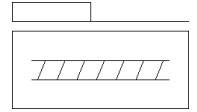

技術參數

特性	值
工作行程	700 mm
尺寸	120
備用行程	0 mm
反向空隙	$\leq 0.15 \mu\text{m}$
螺桿直徑	16 mm
螺桿螺距	10 mm/U
裝配位置	任何
導向	迴圈滾珠軸承導向
設計結構	機電式直線軸 具迴圈滾珠軸承螺桿
馬達類型	步進馬達 伺服馬達
螺桿類型	滾珠螺紋螺桿
多樣型	Recommended for production facilities for the manufacture of lithium-ion batteries
最大加速度	15 m/s ²
最高速度	3,000 1/min 0.5 m/s
重複精度	$\pm 0.02 \text{ mm}$
循環功率	100 %
PWIS conformity	VDMA24364 zone III
RSBP classification to CD-0033	F1a
無塵室等級	ISO class 8
防護等級	IP20
環境溫度	0 ... 50 °C
固定的輸送力	1,265 N
轉動面積矩 2nd 度ly	966E+03 mm ⁴
轉動面積矩 2nd 度lz	6,011E+03 mm ⁴
No-load torque at maximum travel speed	0.3 Nm
No-load torque at minimum travel speed	0.08 Nm
最大輸出力Fy	6,800 N
最大輸出力Fz	8,090 N
Fy with theoretical service life of 100 km (from a guide perspective only)	25,051 N
Fz with theoretical service life of 100 km (from a guide perspective only)	29,804 N
最大扭矩Mx	300 Nm
最大扭矩My	310 Nm
最大扭矩Mz	310 Nm
Mx with theoretical service life of 100 km (from a guide perspective only)	1,105 Nm
My with theoretical service life of 100 km (from a guide perspective only)	1,142 Nm
Mz with theoretical service life of 100 km (from a guide perspective only)	1,142 Nm
驅動軸的最大徑向力	290 N

特性	值
最大進給力 Fx	1,265 N
質量慣性扭矩	506E+03 mm ⁴
每公尺行程的質量慣性力矩 JH	0.3453 kgcm ²
每kg工作負荷的質量慣性力矩 JL	0.0253 kgcm ²
質量慣性力矩, JO	0.1306 kgcm ²
恆定進給	10 mm/U
運動質量	2,019 g
產品重量	13,927 g
0 mm行程時的基本重量	5,259 g
每 10 mm 行程所增加的重量	124 g
Dynamic deflection (load moved)	0.05% of the axis length, max. 0.5 mm
Static deflection (load at standstill)	0.1% of the axis length
Interface code, actuator	T46
Material of end caps	Die-cast aluminium, painted
Material of profile	Anodised wrought aluminium alloy
材料備註	符合 RoHS
Material drive cover	Die-cast aluminium, painted
Material guide slide	鋼
Material guide rail	鋼
Material slide	Anodised wrought aluminium alloy
Material spindle nut	鋼
Material spindle	鋼