

# 伺服馬達

## EMMT-AS-80-M-LS-RMB

料號: 5255436

FESTO

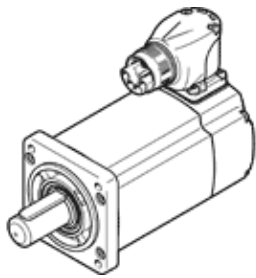

### 技術參數

| 特性  | 值  |
|---|--|
| 環境溫度  | -15 ... 40 °C  |
| Note on ambient temperature                               | up to 80°C with derating -1.5%/°C  |
| Max. installation height                                  | 4,000 m  |
| Note on max. installation height                          | As of 1,000 m, only with derating of -1.0% per 100 m   |
| 儲藏溫度  | -20 ... 70 °C  |
| 相對空氣濕度  | 0 - 90 %   |
| 符合標準  | IEC 60034  |
| 根據EN60034-1的熱量等級  | F  |
| Max. winding temperature                                  | 155 °C   |
| 根據EN60034-1的速率等級  | S1   |
| 溫度監控  | Digital motor temperature transmission via EnDat® 2.2  |
| Motor type to EN 60034-7                                  | IM B5<br>IM V1<br>IM V3  |
| 裝配位置  | 任何   |
| 防護等級  | IP40   |
| Note on degree of protection                              | IP40 motor shaft without RWDR<br>IP65 motor shaft with RWDR<br>IP67 for motor housing with connection technology |
| Concentricity, coaxiality, axial runout to DIN SPEC 42955 | N  |
| Balance quality   | G 2,5  |
| Detent torque   | <1.0% of peak torque   |
| Storage lifetime under nominal conditions                 | 20,000 h   |
| Interface code, motor out                                 | 80P  |
| Electrical connection 1, connection type                  | Hybrid plugs   |
| Electrical connection 1, connection technology            | M23x1  |
| Electrical connection 1, number of pins/wires             | 15   |
| 污染程度  | 2  |
| 材料備註  | 符合 RoHS  |
| 耐腐蝕等級 CRC   | 0 - No corrosion stress  |
| PWIS conformity   | VDMA24364 zone III   |
| 耐振動   | 傳送應用測試在安全等級 2 符合 FN 942017-4 及 EN 60068-2-6  |
| 耐衝擊   | Shock test with severity level 2 in accordance with FN 942017-5 and EN 60068-2-27                                |
| 授權  | RCM Mark<br>c UL us - Recognized (OL)  |
| CE 符號 (參見符合的標準)   | 根據 EU-EMV 指導原則<br>根據 EU 低電壓設備指導原則<br>in accordance with EU RoHS directive  |
| UKCA marking (see declaration of conformity)              | To UK instructions for electrical equipment<br>To UK instructions for EMC<br>To UK RoHS instructions             |
| 認證核發部門  | UL E342973   |
| 額定工作電壓 DC   | 325 V  |
| Type of winding switch                                    | Star inside  |
| Number of pole pairs                                      | 5  |

| 特性  | 值  |
|---|--|
| 靜止扭矩  | 2.6 Nm   |
| 額定扭矩  | 2.2 Nm   |
| 峰值 (最大) 扭矩  | 6.4 Nm   |
| 額定擺動速度  | 3,000 1/min  |
| 最高速度  | 6,150 1/min  |
| Max. mechanical speed                                       | 14,000 1/min                                       |
| 額定馬達功率  | 690 W  |
| 連續的開路電流   | 4.9 A  |
| 額定馬達電流  | 4.1 A  |
| 峰值 (最大) 電流  | 17.1 A   |
| 馬達恆定  | 0.54 Nm/A  |
| Standstill torque constant                                  | 0.62 Nm/A  |
| Voltage constant, phase-to-phase                            | 37.3 mVmin   |
| Phase-phase winding resistance                              | 2.04 Ohm   |
| Phase-phase winding inductance                              | 8.9 mH   |
| Winding longitudinal inductivity Ld (phase)                 | 5.4 mH   |
| Winding cross inductivity Lq (phase)                        | 6.6 mH   |
| Electric time constant                                      | 6.5 ms   |
| Thermal time constant                                       | 45 min   |
| Thermal resistance  | 0.78 K/W   |
| Measuring flange  | 250 x 250 x 15 mm, steel                           |
| 斷電時轉動慣量總和   | 1.285 kgcm <sup>2</sup>                            |
| 產品重量  | 3,360 g  |
| 容許的軸向驅動軸負載  | 120 N  |
| 容許的徑向軸負載  | 620 N  |
| 轉子位置感測器   | Absolute multi-turn encoder                        |
| Rotor position sensor, manufacturer designation             | EQI 1131   |
| Rotor position sensor, absolute detectable revolutions      | 4,096  |
| Rotary position encoder interface                           | EnDat 22   |
| Rotary position encoder measuring principle                 | 電感式  |
| Rotor position sensor, DC operating voltage                 | 5 V  |
| Rotor position sensor, DC operating voltage range           | 3.6 ... 14 V                                       |
| Rotor position sensor, position values per revolution       | 524,288  |
| 轉子位置編碼器起動裝置   | 19 Bit   |
| Rotor position sensor, system accuracy of angle measurement | -120 ... 120 arcsec                                |
| 剎車保持扭矩  | 4.5 Nm   |
| 制動裝置的DC工作電壓   | 24 V   |
| Brake current consumption                                   | 0.5 A  |
| 制動裝置的電力消耗   | 12 W   |
| Brake coil resistance                                       | 48 Ohm   |
| Brake coil inductivity                                      | 1,000 mH   |
| Brake separation time                                       | <= 55 ms   |
| Brake closing time  | <= 15 ms   |
| DC brake response delay                                     | <= 3 ms  |
| Max. brake no-load speed                                    | 10,000 1/min                                       |
| Max. brake friction work                                    | 8,200 J  |
| 剎車的質量慣性力矩   | 0.249 kgcm <sup>2</sup>                            |
| Switching cycles, holding brake                             | 10 million idle actuations (without friction work) |
| MTTF, subcomponent  | 190 years, rotor position sensor                   |
| Energy efficiency   | ENEFF (CN) / Class 2                               |