

伺服馬達

EMMT-AS-60-S-HS-RMB

料號: 5242203

FESTO

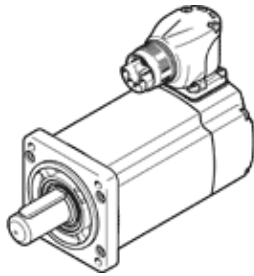
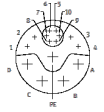

技術參數

| 特性 | 值 |
|---|--|
| 環境溫度 | -15 ... 40 °C |
| Note on ambient temperature | up to 80°C with derating -1.5%/°C |
| Max. installation height | 4,000 m |
| Note on max. installation height | As of 1,000 m, only with derating of -1.0% per 100 m |
| 儲藏溫度 | -20 ... 70 °C |
| 相對空氣濕度 | 0 - 90 % |
| 符合標準 | IEC 60034 |
| 根據EN60034-1的熱量等級 | F |
| Max. winding temperature | 155 °C |
| 根據EN60034-1的速率等級 | S1 |
| 溫度監控 | Digital motor temperature transmission via EnDat® 2.2 |
| Motor type to EN 60034-7 | IM B5 IM V1 IM V3 |
| 裝配位置 | 任何 |
| 防護等級 | IP40 |
| Note on degree of protection | IP40 motor shaft without RWDR IP65 motor shaft with RWDR IP67 for motor housing with connection technology |
| Concentricity, coaxiality, axial runout to DIN SPEC 42955 | N |
| Balance quality | G 2,5 |
| Detent torque | <1.0% of peak torque |
| Storage lifetime under nominal conditions | 20,000 h |
| Interface code, motor out | 60P |
| Electrical connection 1, connection type | Hybrid plugs |
| Electrical connection 1, connection technology | M23x1 |
| Electrical connection 1, number of pins/wires | 15 |
| 污染程度 | 2 |
| 材料備註 | 符合 RoHS |
| 耐腐蝕等級 CRC | 0 - No corrosion stress |
| PWIS conformity | VDMA24364 zone III |
| 耐振動 | 傳送應用測試在安全等級 2 符合 FN 942017-4 及 EN 60068-2-6 |
| 耐衝擊 | Shock test with severity level 2 in accordance with FN 942017-5 and EN 60068-2-27 |
| 授權 | RCM Mark c UL us - Recognized (OL) |
| CE 符號 (參見符合的標準) | 根據 EU-EMV 指導原則 根據 EU 低電壓設備指導原則 in accordance with EU RoHS directive |
| UKCA marking (see declaration of conformity) | To UK instructions for electrical equipment To UK instructions for EMC To UK RoHS instructions |
| 認證核發部門 | UL E342973 |
| 額定工作電壓 DC | 680 V |
| Type of winding switch | Star inside |
| Number of pole pairs | 5 |

| 特性 | 值 |
|---|--|
| 靜止扭矩 | 0.66 Nm |
| 額定扭矩 | 0.6 Nm |
| 峰值 (最大) 扭矩 | 1.6 Nm |
| 額定擺動速度 | 3,000 1/min |
| 最高速度 | 15,000 1/min |
| Max. mechanical speed | 16,000 1/min |
| 額定馬達功率 | 190 W |
| 連續的開路電流 | 1.6 A |
| 額定馬達電流 | 1.4 A |
| 峰值 (最大) 電流 | 5.4 A |
| 馬達恆定 | 0.41 Nm/A |
| Standstill torque constant | 0.49 Nm/A |
| Voltage constant, phase-to-phase | 29.9 mV/min |
| Phase-phase winding resistance | 11.7 Ohm |
| Phase-phase winding inductance | 38 mH |
| Winding longitudinal inductivity Ld (phase) | 15.5 mH |
| Winding cross inductivity Lq (phase) | 19 mH |
| Electric time constant | 2.1 ms |
| Thermal time constant | 41 min |
| Thermal resistance | 1.5 K/W |
| Measuring flange | 250 x 250 x 15 mm, steel |
| 斷電時轉動慣量總和 | 0.257 kgcm ² |
| 產品重量 | 1,500 g |
| 容許的軸向驅動軸負載 | 70 N |
| 容許的徑向軸負載 | 350 N |
| 轉子位置感測器 | Absolute multi-turn encoder |
| Rotor position sensor, manufacturer designation | EQI 1131 |
| Rotor position sensor, absolute detectable revolutions | 4,096 |
| Rotary position encoder interface | EnDat 22 |
| Rotary position encoder measuring principle | 電感式 |
| Rotor position sensor, DC operating voltage | 5 V |
| Rotor position sensor, DC operating voltage range | 3.6 ... 14 V |
| Rotor position sensor, position values per revolution | 524,288 |
| 轉子位置編碼器起動裝置 | 19 Bit |
| Rotor position sensor, system accuracy of angle measurement | -120 ... 120 arcsec |
| 剎車保持扭矩 | 2.5 Nm |
| 制動裝置的DC工作電壓 | 24 V |
| Brake current consumption | 0.46 A |
| 制動裝置的電力消耗 | 11 W |
| Brake coil resistance | 52.4 Ohm |
| Brake coil inductivity | 700 mH |
| Brake separation time | <= 35 ms |
| Brake closing time | 10 ms |
| DC brake response delay | <= 2 ms |
| Max. brake no-load speed | 10,000 1/min |
| Max. brake friction work | 5,600 J |
| 剎車的質量慣性力矩 | 0.074 kgcm ² |
| Switching cycles, holding brake | 10 million idle actuations (without friction work) |
| MTTF, subcomponent | 190 years, rotor position sensor |