

# Servomotor EMMT-AS-60-S-LS-RSB

Broj artikla: 5242198

FESTO

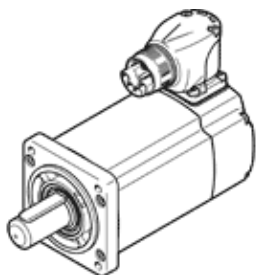

## Tehnički podaci

Svojstvo	Vrednost
Temperatura okoline	-15 ... 40 °C
Note on ambient temperature	up to 80°C with derating -1.5%/°C
Max. installation height	4.000 m
Note on max. installation height	As of 1,000 m, only with derating of -1.0% per 100 m
Temperatura ležaja	-20 ... 70 °C
Relativna vlažnost vazduha	0 - 90 %
Odgovara standardu	IEC 60034
Termalna klasa prema EN 60034-1	F
Max. winding temperature	155 °C
Klasa dimenzionisanja prema EN 60034-1	S1
Nadzor temperature	Digital motor temperature transmission via EnDat® 2.2
Motor type to EN 60034-7	IM B5 IM V1 IM V3
Položaj ugradnje	proizvoljno
Mehanička zaštita	IP40
Note on degree of protection	IP40 motor shaft without RWDR IP65 motor shaft with RWDR IP67 for motor housing with connection technology
Concentricity, coaxiality, axial runout to DIN SPEC 42955	N
Balance quality	G 2,5
Detent torque	<1.0% of peak torque
Storage lifetime under nominal conditions	20.000 h
Interface code, motor out	60P
Electrical connection 1, connection type	Hybrid plugs
Electrical connection 1, connection technology	M23x1
Electrical connection 1, number of pins/wires	15
Stepen zagađenja	2
Materijal - napomena	RoHS komfornost
Klasa korozione otpornosti KBK	0 - No corrosion stress
PWIS conformity	VDMA24364 zone III
Otpornost na vibracije	Ispitivanje transporta sa stepenom težine 2 prema FN 942017-4 i EN 60068-2-6
Udarna čvrstoća	Shock test with severity level 2 in accordance with FN 942017-5 and EN 60068-2-27
Dozvola	RCM Mark c UL us - Recognized (OL)
CE znak (vidi izjavu o usklađenosti)	prema EU-EMV-smernici prema EU-niski napon-smernica in accordance with EU RoHS directive
UKCA marking (see declaration of conformity)	To UK instructions for electrical equipment To UK instructions for EMC To UK RoHS instructions
Mesto izdavanja sertifikata	UL E342973
Nazivni pogonski napon DC	325 V
Vrsta spajanja navoja	Zvezda unutrašnja

Svojstvo	Vrednost
Number of pole pairs	5
Obrtni moment mirovanja	0,66 Nm
Nazivni obrtni moment	0,6 Nm
Vršni obrtni moment	1,6 Nm
Nazivna brzina obrtanja	3.000 1/min
Maks. brzina obrtanja	7.100 1/min
Max. mechanical speed	16.000 1/min
Nazivna snaga motora	190 W
Trajna struja mirovanja	1,6 A
Nazivna struja, motor	1,4 A
Vršna struja	5,4 A
Motorska konstanta	0,41 Nm/A
Standstill torque constant	0,49 Nm/A
Naponska konstanta, linijska	29,9 mVmin
Otpor navoja faza-faza	11,7 Ohm
Induktivnost navoja faza-faza	38 mH
Winding longitudinal inductivity Ld (phase)	15,5 mH
Winding cross inductivity Lq (phase)	19 mH
Electric time constant	2,1 ms
Thermal time constant	41 min
Thermal resistance	1,5 K/W
Measuring flange	250 x 250 x 15 mm, steel
Sveukupni moment inercije gonjene strane	0,257 kgcm <sup>2</sup>
Težina proizvoda	1.500 g
Dozvoljeno aksijalno opterećenje vratila	70 N
Dozvoljeno radijalno opterećenje vratila	350 N
Senzor položaja rotora	Apsolutni encoder sa punim krugom
Rotor position sensor, manufacturer designation	ECI 1118
Rotor position sensor, absolute detectable revolutions	1
Interface rotirajućeg enkodera	EnDat 22
Princip određivanja položaja rotirajućim enkoderom	induktivno
Rotor position sensor, DC operating voltage	5 V
Rotor position sensor, DC operating voltage range	3,6 ... 14 V
Rotor position sensor, position values per revolution	262.144
Okidački enkoder rotora	18 Bit
Rotor position sensor, system accuracy of angle measurement	-120 ... 120 arcsec
Moment držanja, kočnica	2,5 Nm
Pogonski napon DC, kočnica	24 V
Brake current consumption	0,46 A
Primljena snaga, kočnica	11 W
Brake coil resistance	52,4 Ohm
Brake coil inductivity	700 mH
Brake separation time	≤ 35 ms
Brake closing time	10 ms
DC brake response delay	≤ 2 ms
Max. brake no-load speed	10.000 1/min
Max. brake friction work	5.600 J
Moment inercije kočnice	0,074 kgcm <sup>2</sup>
Switching cycles, holding brake	10 million idle actuations (without friction work)
MTTF, subcomponent	190 years, rotor position sensor