

# Linear actuator DFPC-200-350-D

Part number: 8133105

FESTO

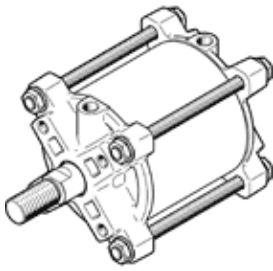

## Data sheet

Feature	Value
Size of actuator	200
Flange hole pattern	F10
Stroke	350 mm
Piston diameter	200 mm
Fitting connection conforms to standard	ISO 5210
Cushioning	P: Flexible cushioning rings/plates at both ends
Assembly position	Any
Mode of operation	double-acting
Design structure	Piston Piston rod Tie rod Cylinder barrel
Position detection	For proximity sensor
Operating pressure MPa	0.06 ... 0.8 MPa
Working pressure	0.6 ... 8 bar
Operating pressure	8.7 ... 116 psi
Nominal operating pressure	0.6 MPa
Nominal working pressure	6 bar
Nominal operating pressure (psi)	87 psi
Operating medium	Compressed air in accordance with ISO8573-1:2010 [7:4:4]
Note on operating and pilot medium	Lubricated operation possible (subsequently required for further operation)
Vibration resistance	Transport application test with severity level 1 as per FN 942017-4 and EN 60068-2-6
Shock resistance	Shock test with severity level 1 in accordance with FN 942017-5 and EN 60068-2-27
PWIS conformity	VDMA24364 zone III
Ambient temperature	-20 ... 80 °C
Impact energy in end positions	4.8 J
Theoretical force at 0.6 MPa (6 bar, 87 psi), retracting	18,096 N
Theoretical force at 0.6 MPa (6 bar, 87 psi), advance	18,850 N
Air consumption returning per 10 mm stroke	2.111 l
Air consumption advancing per 10 mm stroke	2.199 l
Moving mass with 0 mm stroke	3,575.4 g
Additional mass factor per 10 mm of stroke	105.31 g
Product weight	19,210 g
Basic weight for 0 mm stroke	10,258.2 g
Additional weight per 10 mm stroke	255.79 g
Mounting type	On flange as per ISO 5210 With spacer bolt Optional
Pneumatic connection	G1/4
Materials note	Conforms to RoHS
Material cover	Gravity die-cast aluminium
Material piston rod	High alloy steel, non-corrosive
Material piston rod wiper seal	TPE-U(PU)
Material nut	High alloy steel, non-corrosive
Material static seals	NBR
Material tie rod	High alloy steel, non-corrosive
Material cylinder barrel	Smooth-anodised wrought aluminium alloy