

# Common supply manifold PAL-1/8-1/4-4

Part number: 5872

FESTO

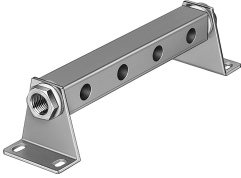

## Data sheet

| Feature                     | Value          |
|-----------------------------|----------------|
| Max. no. of valve positions | 4              |
| LABS (PWIS) conformity      | VDMA24364-B2-L |
| Note on materials           | RoHS-compliant |