

# Guide cylinder

## DFM-N-40-125-B-P-A-GF

Part number: 570591  
Product to be discontinued

FESTO

With integral guide.

The proximity switch, type SMTSO-8E, can be used with this product with stroke lengths equal to or greater than 50 mm. The corresponding mounting kit, type SMB-8E, is mounted inwardly or outwardly.

Type to be discontinued. Available until 2022. See Support Portal for alternative products.

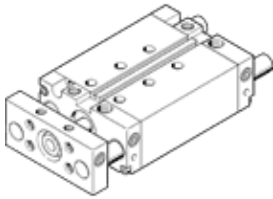

## Data sheet

Feature	Value
Stroke	125 mm
Piston diameter	40 mm
Operating mode of drive unit	Yoke
Cushioning	P: Flexible cushioning rings/plates at both ends
Assembly position	Any
Guide	Plain-bearing guide
Design structure	Guide
Position detection	For proximity sensor
Working pressure	1.5 ... 10 bar
Mode of operation	double-acting
Operating medium	Compressed air in accordance with ISO8573-1:2010 [7:4:4]
Note on operating and pilot medium	Lubricated operation possible (subsequently required for further operation)
Corrosion resistance classification CRC	2 - Moderate corrosion stress
Ambient temperature	-20 ... 80 °C
Theoretical force at 0.6 MPa (6 bar, 87 psi), retracting	686 N
Theoretical force at 0.6 MPa (6 bar, 87 psi), advance	754 N
alternative connections	See product drawing
Pneumatic connection	1/8 NPT
Materials note	Conforms to RoHS
Material cover	Wrought Aluminum alloy
Material seals	NBR
Material housing	Wrought Aluminum alloy
Material piston rod	High alloy steel, non-corrosive