

Ball valve

VZBM-11/4-RP-25-D-2-F03-B2B3

Part number: 4405651

FESTO

Brass, 2/2-way, nominal width 11/2", head flange F03, PN25, thread EN 10226-1.

Festo is only a retailer of this product, not the manufacturer.

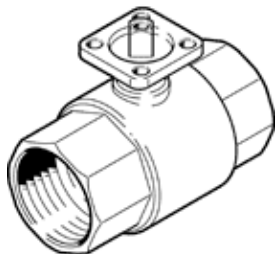

Data sheet

| Feature | Value |
|---|---|
| Design structure | 2-way ball valve |
| Type of actuation | mechanical |
| Sealing principle | soft |
| Assembly position | Any |
| Mounting type | Line installation |
| Process valve connection | Rp1 1/4 |
| Switching position indicator | Slot direction = flow direction |
| Flange hole pattern | F03 |
| Inside diameter | 32 mm |
| Nominal diameter DN | 32 |
| Valve function | 2/2 |
| Flow direction | reversible |
| Nominal pressure of process valve | 25 |
| Breakaway torque at differential pressure, nominal pressure, process valve PN | 7.5 Nm |
| Based on the standard | EN 10226-1 ISO 5211 |
| Medium | Compressed air in accordance with ISO8573-1:2010 [-:--] Inert gases Water (no water vapour) Neutral fluids |
| Medium temperature | -15 ... 90 °C |
| Flow rate Kv | 84 m3/h |
| Materials note | Conforms to RoHS |
| PWIS conformity | VDMA24364 zone III |
| Material housing | Brass Nickel plated |
| Material number for housing | CW617N |
| Material seals | FPM HNBR PTFE |
| Material ball | Brass Chromed-plated |
| Material number for ball | CW617N |
| Material shaft | Brass |
| Material number for shaft | CW617N |
| Product weight | 730 g |
| CE symbol (see declaration of conformity) | according to EU printing device guideline |
| Corrosion resistance classification CRC | 1 - Low corrosion stress |