

Semi-rotary actuator DRQ-100-270-PPV-A

Part number: 30598
Product to be discontinued

FESTO

For proximity sensing, with adjustable end position cushioning and backlash-compensating gearing.

Type to be discontinued. Available until 2017. See Support Portal for alternative products.

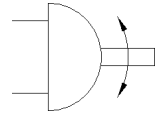
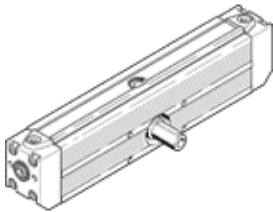

Data sheet

Feature	Value
Size	100
Cushioning angle	52 deg
Swivel angle	270 deg
End-position tolerance	3 deg
Cushioning	PPV: Pneumatic cushioning adjustable at both ends
Assembly position	Any
Design structure	Rack and pinion
Position detection	For proximity sensor
Working pressure	2.5 ... 10 bar
Max. swivel frequency at 6 bar	0.5 Hz
Mode of operation	double-acting
Operating medium	Compressed air in accordance with ISO8573-1:2010 [7:-:-]
Ambient temperature	-10 ... 60 °C
Theoretical torque at 6 bar	150 Nm
Permissible mass moment of inertia	0.2 kgm ²
Product weight	34,200 g
Mounting type	with internal (female) thread
Pneumatic connection	G1/2
Materials information for drive shaft	Case-hardened steel
Materials information for seals	TPE-U(PU)