

# Pneumatic interface

## CPX-GP-03-4,0

Part number: 195738

FESTO

Connects the valve manifold VIMP/VIFB Midi/Maxi to a modular electric manifold CPX.

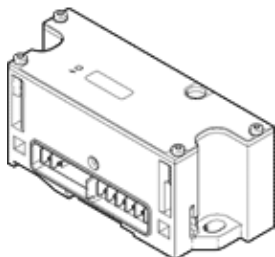

## Data sheet

Feature	Value
Valve manifold interface	Type 03, MIDI/MAXI
Diagnosis	- Undervoltage of valves
Max. number of valve positions	26 for monostable valves
LED displays	- 1 Group diagnosis - Channel status on valves
Parameters configuring	Failsafe per channel Forces per channel Idle mode per channel Module monitoring
Protection (short circuit)	Internal electronic fuse protection per valve output
Operating voltage range DC	21.6 ... 26.4 V
Intrinsic current consumption at operating voltage	Typically 15 mA (power supply for electronics) Typically 30 mA (load voltage supply for valve)
Max. power supply per channel	0,2 A
Max. resultant current per module	4 A
Nominal operating voltage DC	24 V
Electrical isolation channel – internal bus	Yes, for additional power supply
Corrosion resistance classification CRC	0 - No corrosion stress
Protection class	IP65
Ambient temperature	-5 ... 50 °C
Product weight	390 g
Electrical connection	Fieldbus
Materials information for cover	Steel
Materials information, housing	Aluminum die cast